

Tabelle planimetriche AV-AC

TRACK A V PLAN A.7				TRACK A V PLAN A.8			
X	1695587.368	Az	57.265321	X	1695586.346	Az	57.265321
Y	5044923.404	Av	57.265321	Y	5044923.404	Av	57.265321
R	-284.000	t'	0.000000	R	-284.000	t'	0.000000
S	43.254	V	130	S	43.254	V	130
Afc	0.877488	RPa	48.000	Afc	0.877488	RPa	48.000
Afg	1.885647	m	0.044	Afg	1.885647	m	0.044
T	21.927	H	5.0	T	21.927	H	5.0

TRACK A V PLAN A.9			
X	1695586.281	Az	54.896066
Y	5045306.102	Av	57.252229
R	2198.000	t'	0.000000
S	40.174	V	130
Afc	1.184844	RPa	48.000
Afg	2.558162	m	0.044
T	20.088	H	7.0

Tabelle altimetriche AV-AC

V ALT A.5		V ALT A.7		V ALT A.8		V ALT A.9	
Pr	46180.997	Pr	46595.000	Pr	47000.002	Pr	47200.001
Op	38.500	Op	37.180	Op	35.800	Op	35.200
Pa	-0.00000	Pa	0.00184	Pa	-0.00200	Pa	-0.00200
Pu	0.00164	Pu	-0.00380	Pu	-0.00200	Pu	0.00085
Dp	0.00250	Dp	-0.00550	Dp	0.00190	Dp	0.00270
Rv	10000.000	Rv	-10000.000	Rv	6000.000	Rv	5000.000
t	11.199	t	27.719	t	5.104	t	6.831
f	0.008	f	0.003	f	0.004	f	0.004
Pr,J	46189.798	Pr,J	46587.281	Pr,J	46994.298	Pr,J	47183.370
Pr,I	46192.137	Pr,I	46582.718	Pr,I	47000.290	Pr,I	47208.631

Tabelle planimetriche LS

Tabelle altimetriche LS

TRACK B V PLAN B.5				TRACK B V PLAN B.6			
X	1695586.365	Az	57.265820	X	1695586.365	Az	57.265820
Y	5045220.368	Av	56.102091	Y	5045220.368	Av	56.102091
R	-6000.000	t'	0.000000	R	-6000.000	t'	0.000000
S	43.119	V	0	S	43.119	V	0
Afc	0.892564	RPa	30.000	Afc	0.892564	RPa	30.000
Afg	1.163728	m	0.009	Afg	1.163728	m	0.009
T	21.560	H	0.0	T	21.560	H	0.0

V ALT B.6		V ALT B.7		V ALT B.8		V ALT B.9	
Pr	2248.130	Pr	2844.998	Pr	3087.004	Pr	3287.001
Op	35.500	Op	37.180	Op	35.800	Op	35.200
Pa	-0.00260	Pa	0.00171	Pa	-0.00374	Pa	-0.00200
Pu	0.00171	Pu	-0.00374	Pu	-0.00200	Pu	0.00085
Dp	0.00250	Dp	-0.00550	Dp	0.00170	Dp	0.00260
Rv	10000.000	Rv	-10000.000	Rv	6000.000	Rv	5000.000
t	11.588	t	27.287	t	5.232	t	6.823
f	0.007	f	0.007	f	0.004	f	0.004
Pr,J	2238.982	Pr,J	2817.711	Pr,J	3081.772	Pr,J	3280.378
Pr,I	2259.987	Pr,I	2822.286	Pr,I	3072.937	Pr,I	3275.635

Tabelle planimetriche Mercì

TRACK C V PLAN C.7				TRACK C V PLAN C.8			
X	1695614.038	Az	60.439021	X	1695614.038	Az	60.439021
Y	5044928.091	Av	57.265820	Y	5044928.091	Av	57.265820
R	-600.000	t'	0.000000	R	-600.000	t'	0.000000
S	28.812	V	0	S	28.812	V	0
Afc	3.163201	RPa	0.000	Afc	3.163201	RPa	0.000
Afg	3.163201	m	0.000	Afg	3.163201	m	0.000
T	14.909	H	0.0	T	14.909	H	0.0

TRACK C V PLAN C.9				TRACK C V PLAN C.10			
X	1695614.038	Az	54.823540	X	1695614.038	Az	54.823540
Y	5045299.246	Av	55.577236	Y	5045299.246	Av	55.577236
R	-600.000	t'	0.000000	R	-600.000	t'	0.000000
S	63.978	V	0	S	63.978	V	0
Afc	0.952888	RPa	0.000	Afc	0.952888	RPa	0.000
Afg	0.952888	m	0.000	Afg	0.952888	m	0.000
T	4.490	H	0.0	T	4.490	H	0.0

Tabelle altimetriche Mercì

V ALT C.7		V ALT C.8		V ALT C.9		V ALT C.10	
Pr	900.000	Pr	996.311	Pr	371.800	Pr	1699.989
Op	38.500	Op	37.180	Op	34.300	Op	34.300
Pa	-0.00082	Pa	0.00164	Pa	-0.00972	Pa	-0.00972
Pu	-0.00082	Pu	0.00164	Pu	-0.00972	Pu	0.00079
Dp	-0.01150	Dp	0.00230	Dp	-0.01140	Dp	0.01550
Rv	-3000.000	Rv	3000.000	Rv	-3000.000	Rv	3000.000
t	17.285	t	2.401	t	17.051	t	23.265
f	0.050	f	0.002	f	0.048	f	0.098
Pr,J	882.719	Pr,J	992.810	Pr,J	1392.835	Pr,J	1678.734
Pr,I	817.284	Pr,I	999.711	Pr,I	1427.038	Pr,I	1723.284

PLANIMETRIA DI PROGETTO

SCALA 1:1000

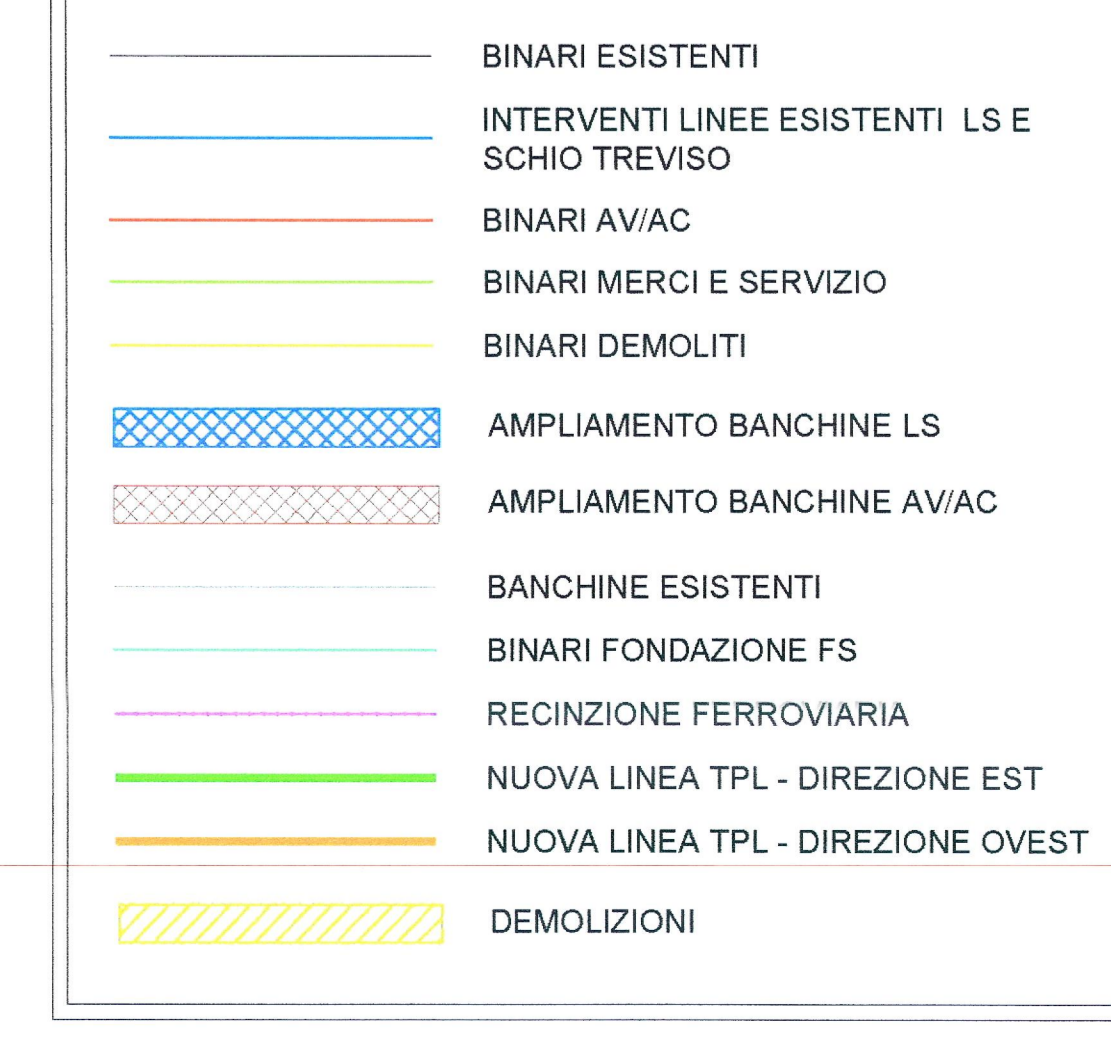
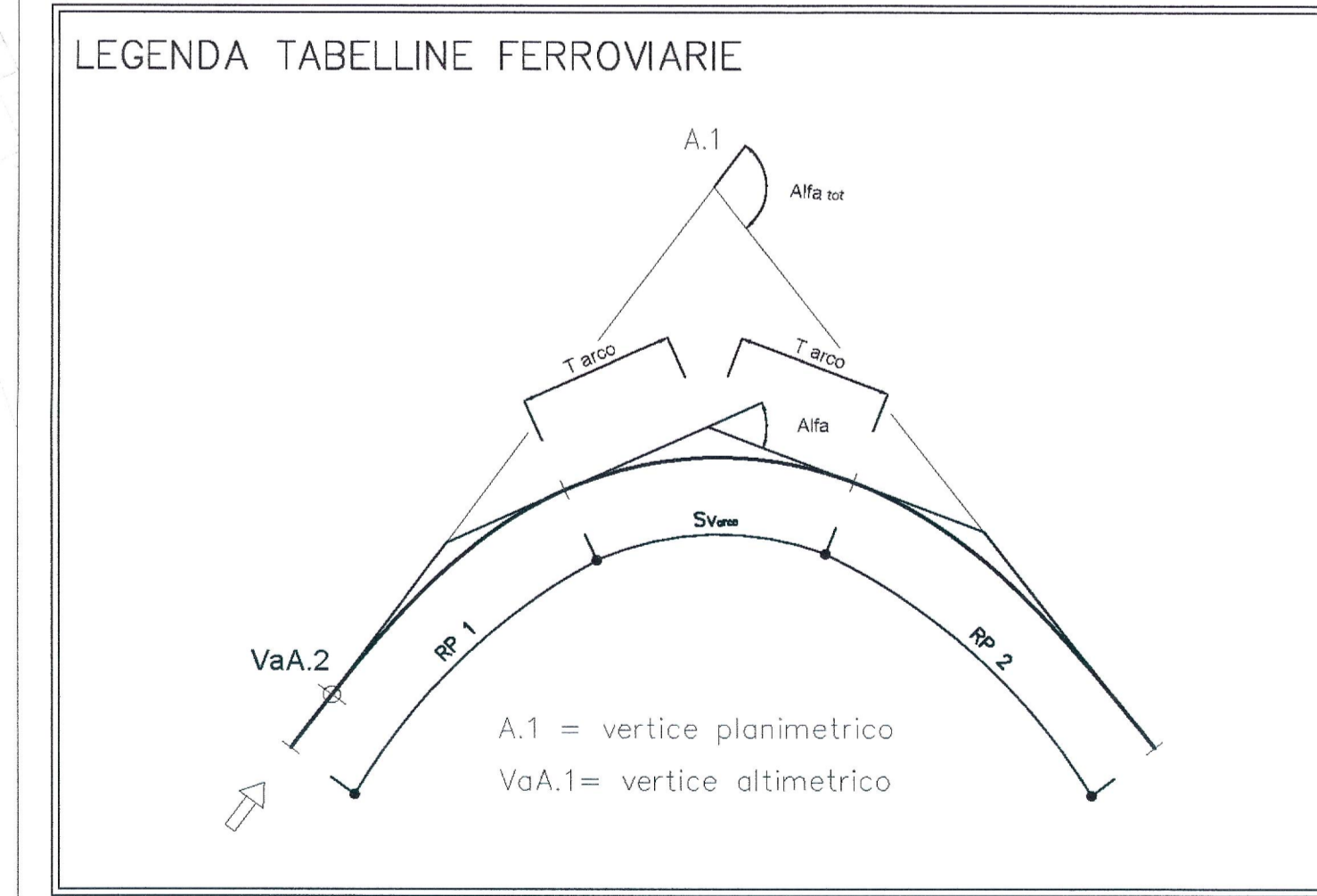
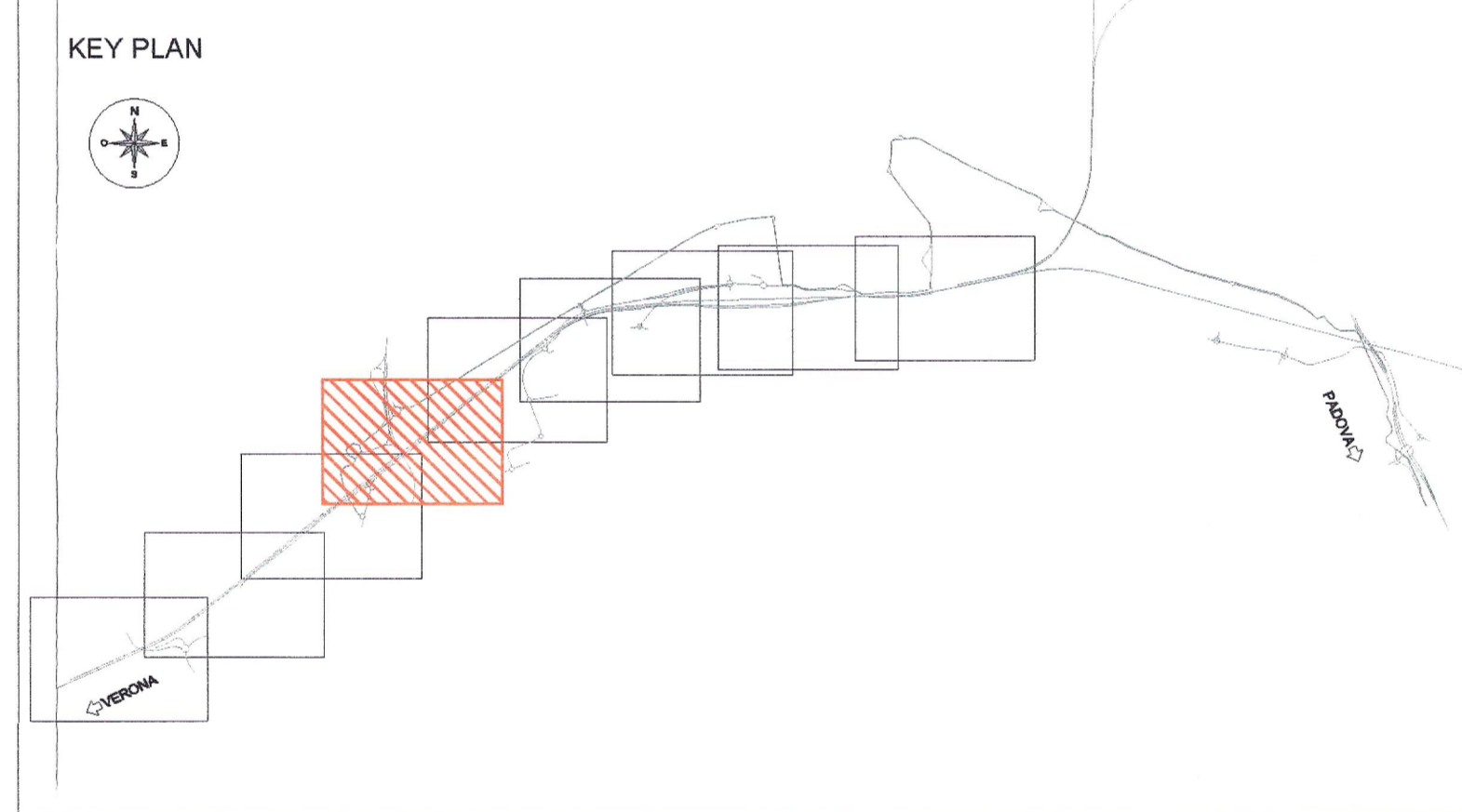
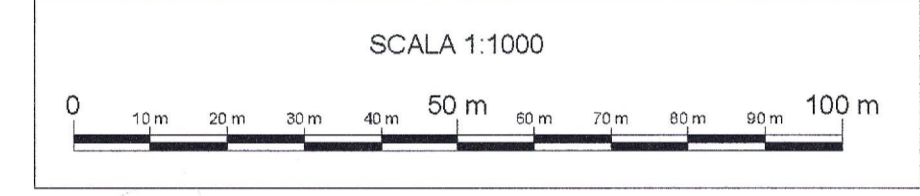
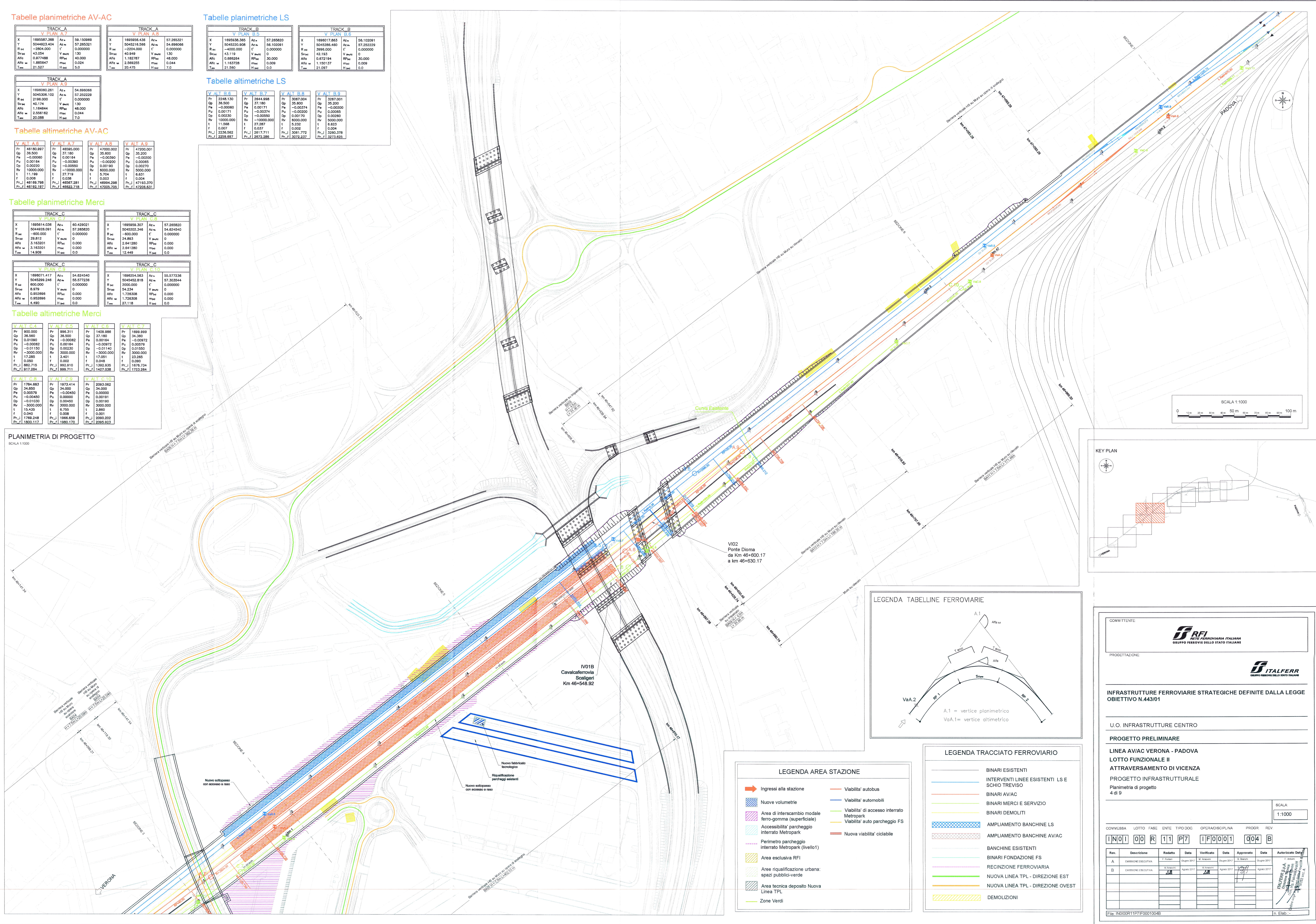

COMITENTE: **RFI** RETE FERROVIARIA ITALIANA GRUPPO FERROVIE DELLO STATO ITALIANO

PROGETTAZIONE: **ITALFERR** GRUPPO FERROVIE DELLO STATO ITALIANO

INFRASTRUTTURE FERROVIARIE STRATEGICHE DEFINITE DALLA LEGGE OBIETTIVO N.443/01

U.O. INFRASTRUTTURE CENTRO

PROGETTO PRELIMINARE

LINEA AV/AC VERONA - PADOVA

LOTTO FUNZIONALE II

ATTRAVERSAMENTO DI VICENZA

PROGETTO INFRASTRUTTURALE

Planimetria di progetto

4 di 9

SCALA: 1:1000

Rev.	Descrizione	Redatto	Data	Verificato	Data	Approvato	Data	Autorizzato	Data
A	EMMISSIONE DESCRITTIVA	[Firma]	08/08/2017	[Firma]	08/08/2017	[Firma]	08/08/2017	[Firma]	08/08/2017
B	EMMISSIONE ESECUTIVA	[Firma]	08/08/2017	[Firma]	08/08/2017	[Firma]	08/08/2017	[Firma]	08/08/2017

File: IN0100R11P7\F0001004B