

Area di Esondazione Ante Operam

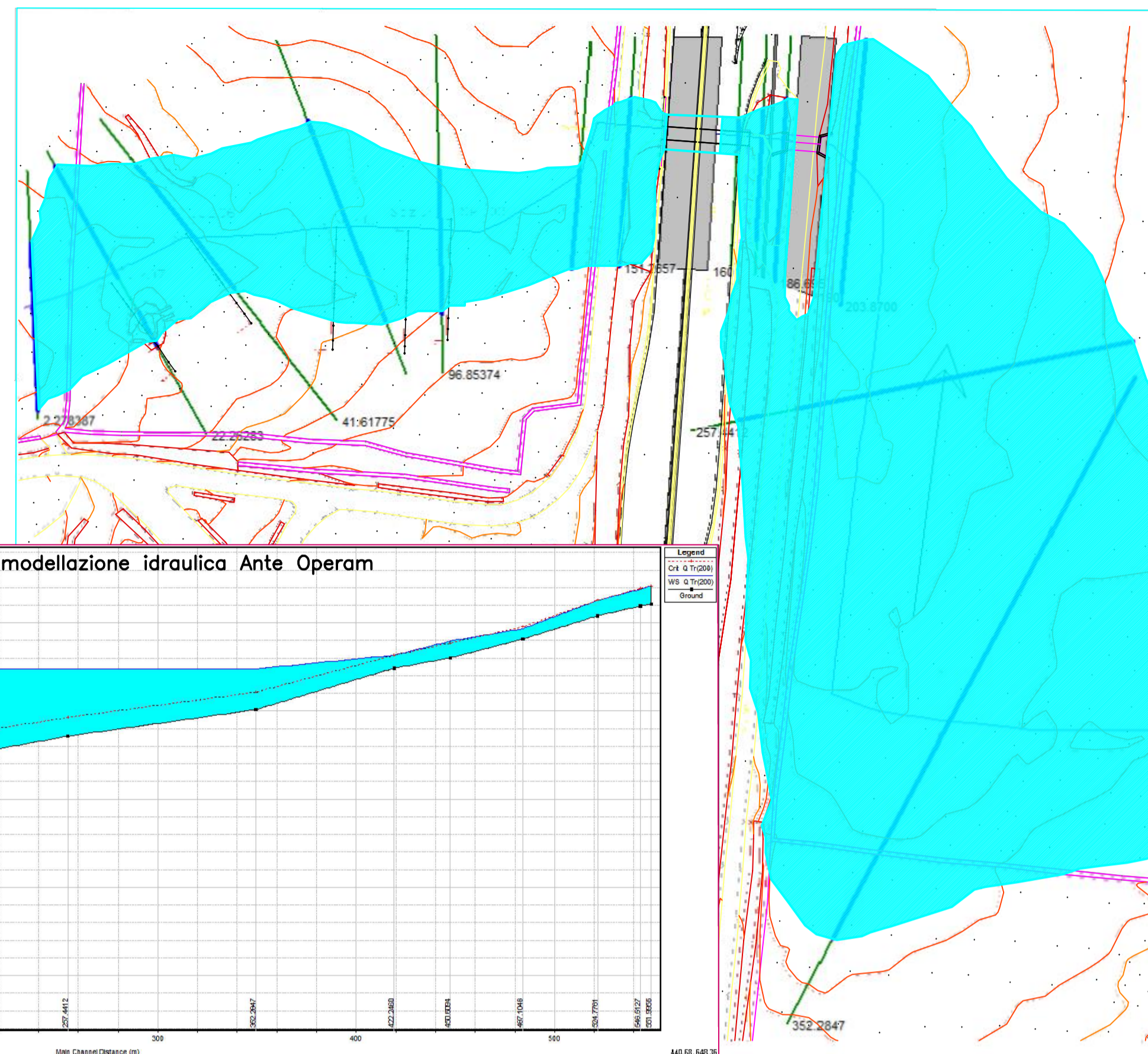

Visualizzazione 3D Ante Operam

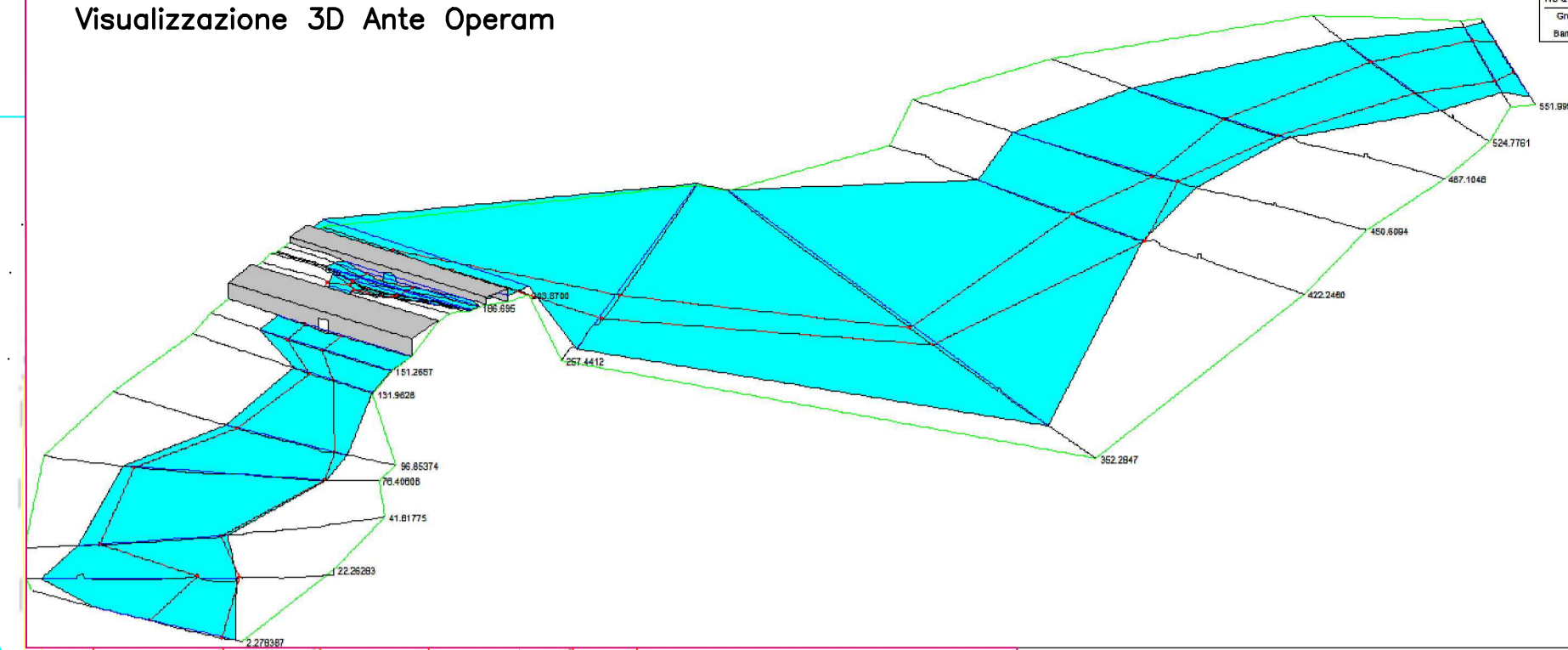

Profilo di modellazione idraulica Ante Operam

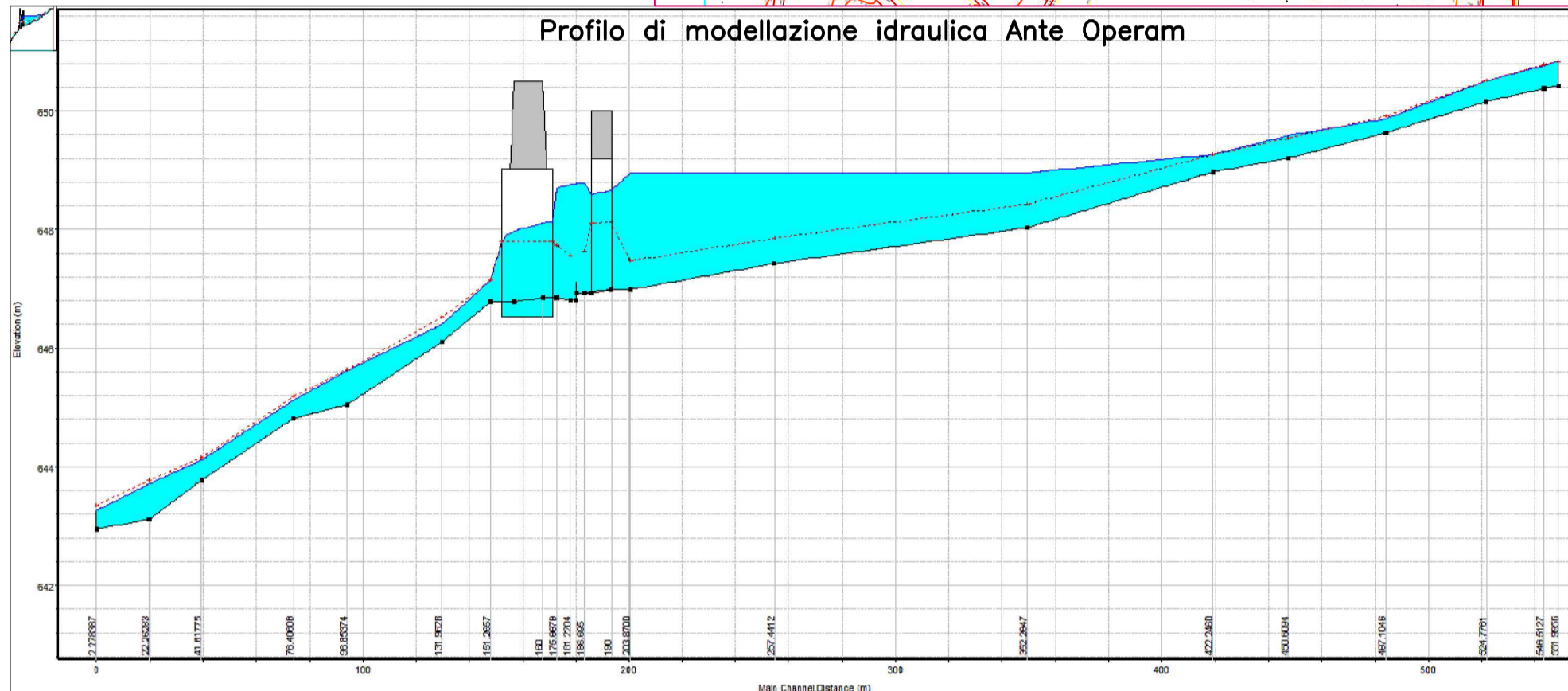

Area di Esondazione Post Operam

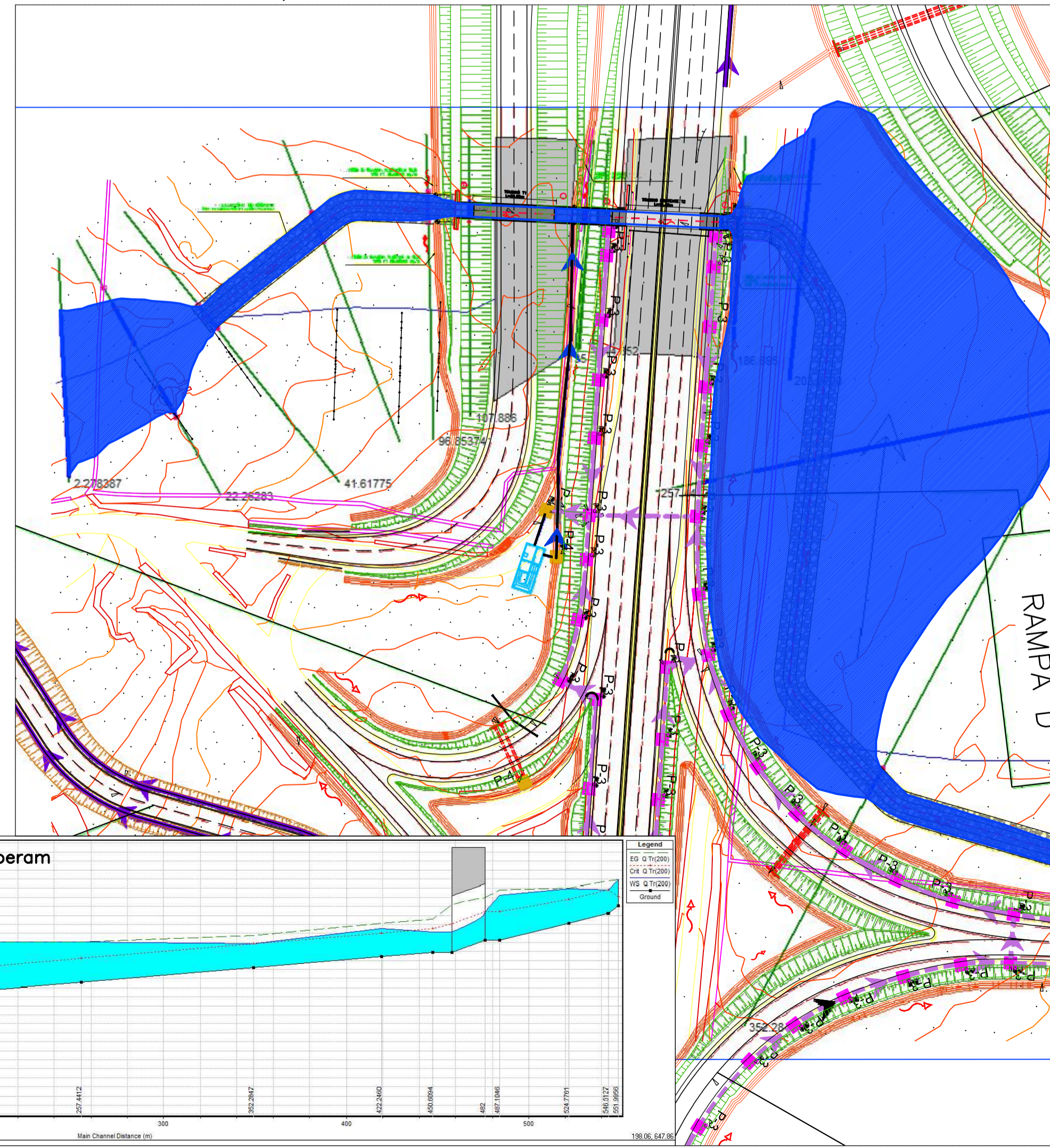

Visualizzazione 3D Post Operam

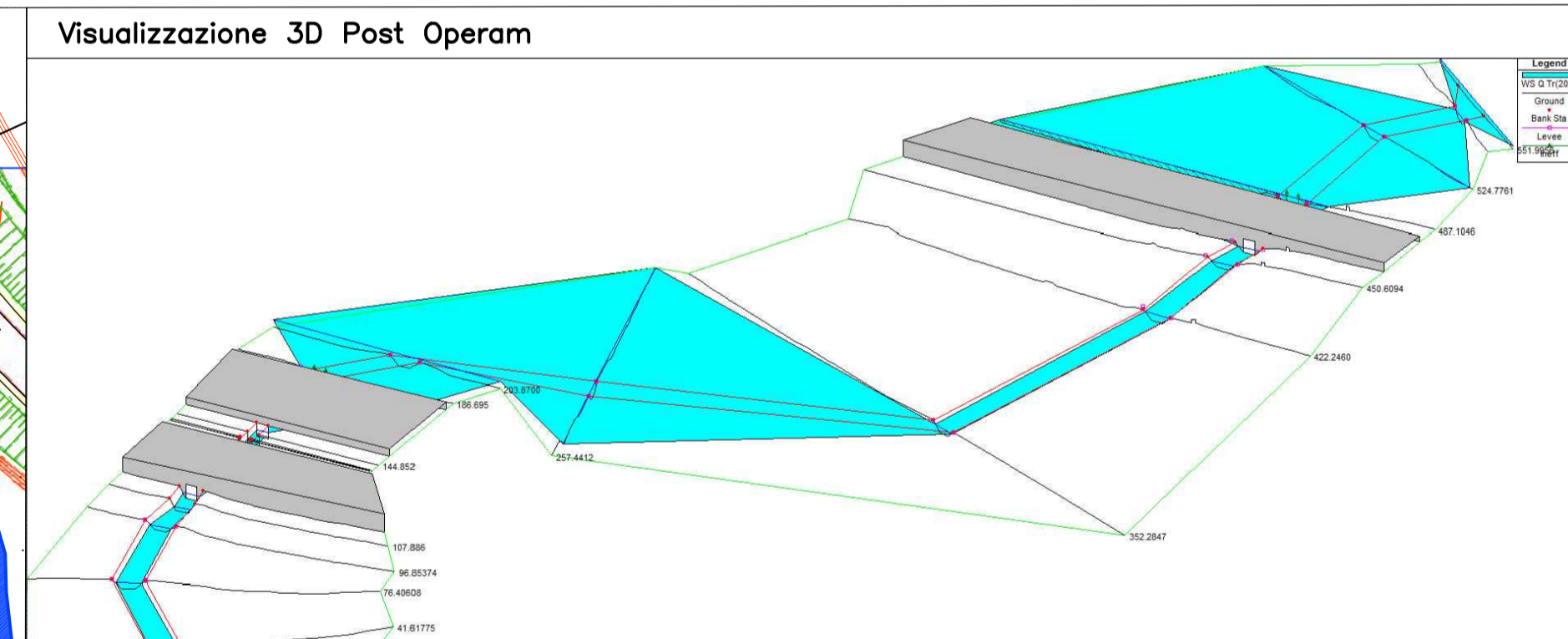

Profilo di modellazione idraulica Post Operam

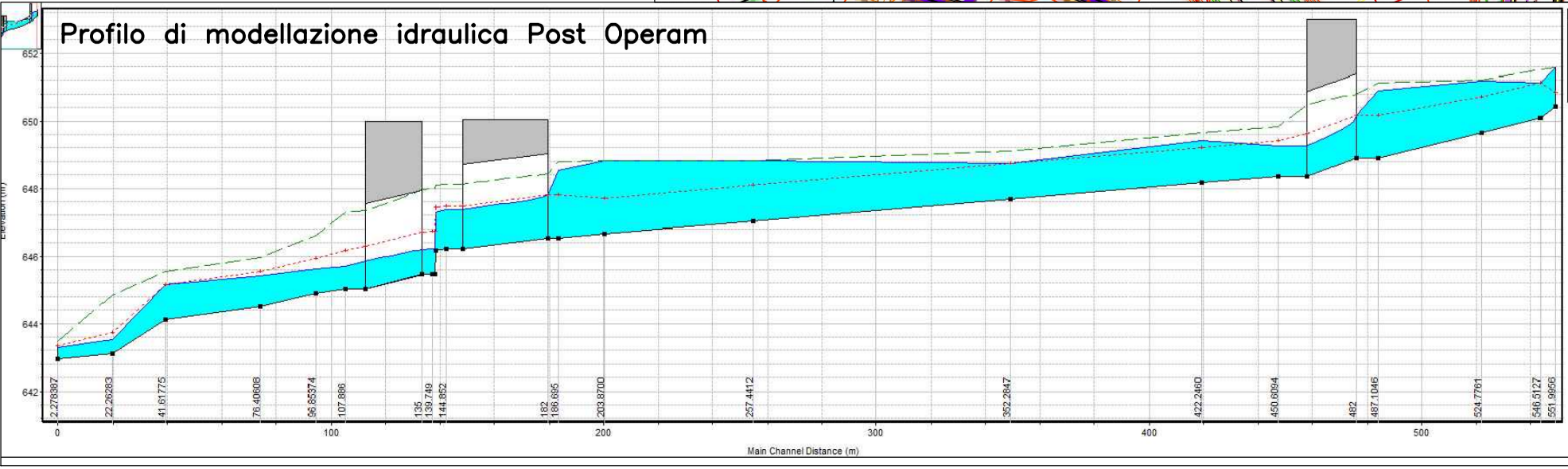

Tabulati di calcolo Tr=200anni Ante Operam

River Sta	Profile	Q Total (m3/s)	Min Ch El (m)	W.S. Elev (m)	Crit W.S. (m)	E.G. Elev (m)	Vel Chnl (m/s)	Froude # Chl
552.00	Q Tr(200)	13.27	650.43	650.84	650.84	650.84	1.72	0.90
546.51	Q Tr(200)	13.27	650.38	650.76	650.78	650.90	1.74	0.99
524.78	Q Tr(200)	13.27	650.17	650.52	650.52	650.63	1.63	0.94
487.10	Q Tr(200)	13.27	649.63	649.88	649.91	650.02	1.53	1.21
450.61	Q Tr(200)	13.27	649.21	649.60	649.56	649.67	1.16	0.78
422.25	Q Tr(200)	13.27	648.97	649.27	649.27	649.37	1.54	0.98
352.28	Q Tr(200)	13.27	648.03	648.96	648.44	648.97	0.21	0.07
257.44	Q Tr(200)	13.27	647.43	648.96	647.86	648.96	0.21	0.06
203.87	Q Tr(200)	13.27	647.00	648.96	647.48	648.96	0.15	0.03
190.00	Bridge							
186.70	Q Tr(200)	13.27	646.93	648.79	647.64	648.79	0.46	0.11
185.00	Inl Struct							
181.22	Q Tr(200)	13.27	646.82	648.78	647.56	648.79	0.54	0.13
175.89	Q Tr(200)	13.27	646.86	648.69	647.74	648.78	1.29	0.32
160.00	Culvert							
151.27	Q Tr(200)	13.27	646.79	647.15	647.15	647.27	1.73	0.99
131.96	Q Tr(200)	13.27	646.12	646.40	646.52	646.82	3.01	1.94
96.85	Q Tr(200)	13.27	645.06	645.63	645.65	645.79	1.78	1.08
76.41	Q Tr(200)	13.27	644.82	645.13	645.18	645.31	1.86	1.51
41.62	Q Tr(200)	13.27	643.78	644.11	644.17	644.30	1.93	1.27
22.26	Q Tr(200)	13.27	643.12	643.71	643.78	643.92	2.36	1.16
2.28	Q Tr(200)	13.27	642.95	643.27	643.35	643.51	2.28	1.40

Tabulati di calcolo Tr=200anni Post Operam

River Sta	Profile	Q Total (m3/s)	Min Ch El (m)	W.S. Elev (m)	Crit W.S. (m)	E.G. Elev (m)	Vel Chnl (m/s)	Froude # Chl
552.00	Q Tr(200)	13.27	650.43	651.56	650.84	651.57	0.35	0.11
546.51	Q Tr(200)	13.27	650.09	651.14	651.14	651.53	2.75	0.99
524.78	Q Tr(200)	13.27	649.66	651.18	650.70	651.21	0.89	0.27
487.10	Q Tr(200)	13.27	648.90	650.89	650.16	651.14	2.22	0.50
482.00	Culvert							
450.61	Q Tr(200)	13.27	648.36	649.26	649.41	649.84	3.38	1.30
422.25	Q Tr(200)	13.27	648.16	649.42	649.21	649.66	2.15	0.72
352.28	Q Tr(200)	13.27	647.68	648.73	648.73	649.12	2.76	1.00
257.44	Q Tr(200)	13.27	647.03	648.81	648.08	648.81	0.38	0.10
203.87	Q Tr(200)	13.27	646.66	648.81	647.71	648.81	0.19	0.05
186.70	Q Tr(200)	13.27	646.54	648.54	647.80	648.79	2.22	0.50
182.00	Culvert							
144.85	Q Tr(200)	13.27	646.22	647.38	647.47	648.12	3.82	1.13
140.77	Q Tr(200)	13.27	646.18	647.29	647.43	648.10	3.97	1.20
140.67	Q Tr(200)	13.27	645.48	646.23	646.73	648.00	5.89	2.17
140.57	Q Tr(200)	13.27	645.48	646.23	646.73	648.00	5.88	2.17
130.75	Q Tr(200)	13.27	645.48	646.24	646.73	647.98	5.85	2.15
135.00	Culvert							
107.89	Q Tr(200)	13.27	645.04	645.71	646.17	647.28	5.55	2.32
96.85	Q Tr(200)	13.27	644.89	645.63	645.94	646.60	4.38	1.83
76.41	Q Tr(200)	13.27	644.50	645.43	645.55	645.97	3.25	1.24
41.62	Q Tr(200)	13.27	644.11	645.16	645.16	645.55	2.77	1.00
22.26	Q Tr(200)	13.27	643.12	643.53	643.74	644.84	5.07	4.40
2.28	Q Tr(200)	13.27	642.95	643.29	643.34	643.46	1.88	1.20



Anas SpA

Direzione Progettazione e Realizzazione Lavori

S.S. 131 di "Carlo Felice"
Adeguamento e messa in sicurezza della S.S.131
Risoluzione dei nodi critici - 1° stralcio
dal km 158+000 al km 162+700

PROGETTO ESECUTIVO

CA283

PROGETTAZIONE: ANAS-Direzione Progettazione e Realizzazione Lavori

PROGETTISTI:
Dott. Ing. Achille DEVOTFRANCESCHI Dott. Ing. Alessandra MICHELI
Ordine Ing. di Roma n. 19116 Ordine Ing. di Roma n. 19645

IL GEOLOGO

Dott. Geol. Serena MAJETTA
Ordine Geol. Lazio n. 928

COORDINATORE PER LA SICUREZZA IN FASE DI PROGETTAZIONE
Geom. Fabio QUONDAM

VISTO: IL RESP. DEL PROCEDIMENTO
Dott. Ing. Salvatore FRASCA

PROTOCOLLO DATA

IDROLOGIA ED IDRAULICA

NUOVI SVINCOLI-Completamento/adeguamento svincolo di Bonorva sud al Km 158+650
Tomlini scatarli T1-T2-T3 - Aree di esondazione planimetria e profili

CODICE PROGETTO	NOME FILE	REVISIONE	SCALA:
PROGETTO LW. PROG. N. PROG.	VO11D00IDRPP03A	A	Varie
LOPLSP E 1701	CODICE ELAB. VO11D00IDRPP03		
D			
C			
B			
A	EMISSIONE		
REV.	DESCRIZIONE	DATA	REDATTO VERIFICATO APPROVATO