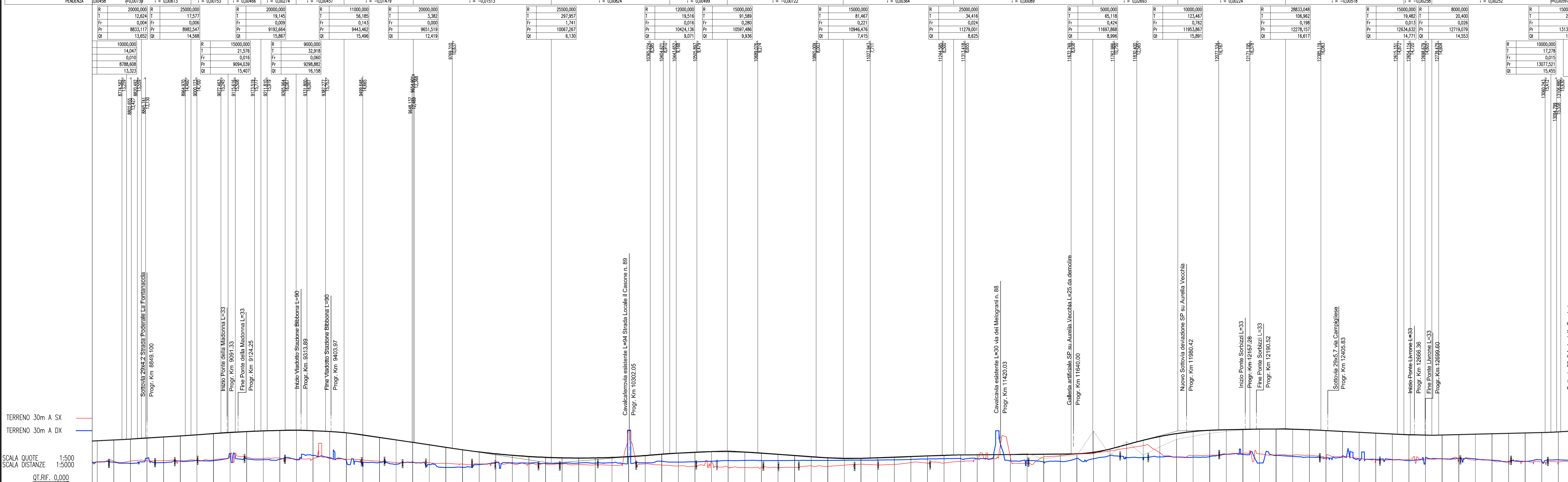

Table with 12 columns of technical data including elevation (h), length (L), and other parameters for different sections of the project.



Technical data table with columns for QUOTE PROGETTO, QUOTE TERRENO, DIMENSIONI, DIST. PARZIALI, and other project metrics.

Project information block including SAT logo, company name (Società Autostrada Tirrenica p.A.), project title (AUTOSTRADA (A12) : ROSIGNANO - CIVITAVECCHIA LOTTO 2), and contact details.