

TABELLA MATERIALI

Table with columns: MATERIALE, DESCRIZIONE, QUANTITÀ, UNITÀ DI MISURA, PREZZO UNITARIO, TOTALE. Includes materials like ACCIAIO PER CEMENTO ARMATO, ACCIAIO PER BARRELLA ANTIURTO, etc.

Table with columns: DESCRIZIONE, QUANTITÀ, UNITÀ DI MISURA, PREZZO UNITARIO, TOTALE. Includes materials like CEMENTO, SABBIA, etc.

Table with columns: DESCRIZIONE, QUANTITÀ, UNITÀ DI MISURA, PREZZO UNITARIO, TOTALE. Includes materials like MICROPIALI, etc.

Table with columns: BARRIERA, h BARRIERA, PR. INIZIO (B.P.), PR. FINE (B.P.), TIPO DI INTERFERENZA, Ponticello di 1,00 m, etc.

Table with columns: DESCRIZIONE, QUANTITÀ, UNITÀ DI MISURA, PREZZO UNITARIO, TOTALE. Includes materials like MICROPIALI, etc.

Administrative section containing logos (FALFAPI, CAR, SCSUBAU), project details (COMMITTEE, DIREZIONE LAVORI, APPALTATORE), and a technical drawing (SEZIONE A-A) of a barrier cross-section.

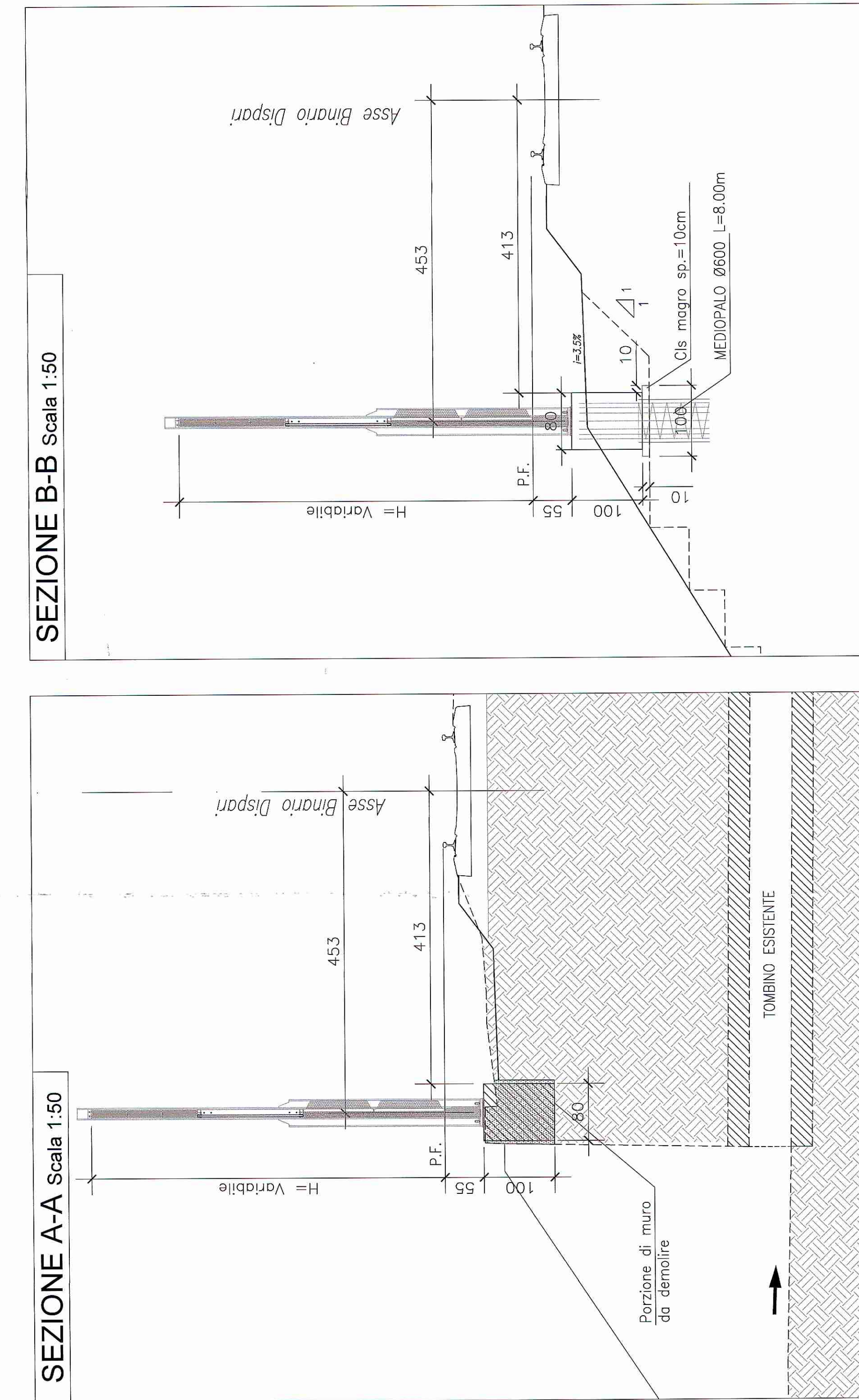
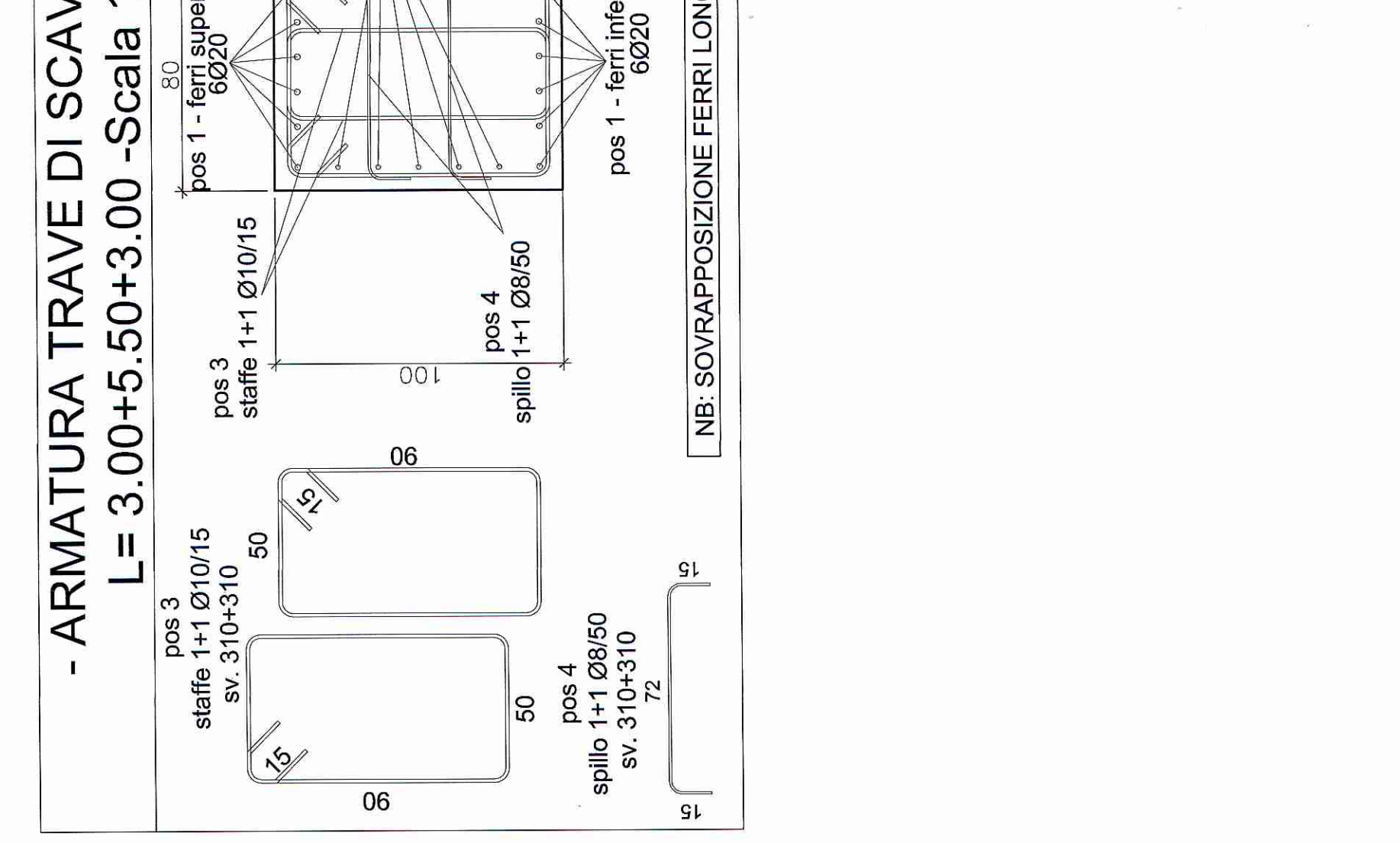
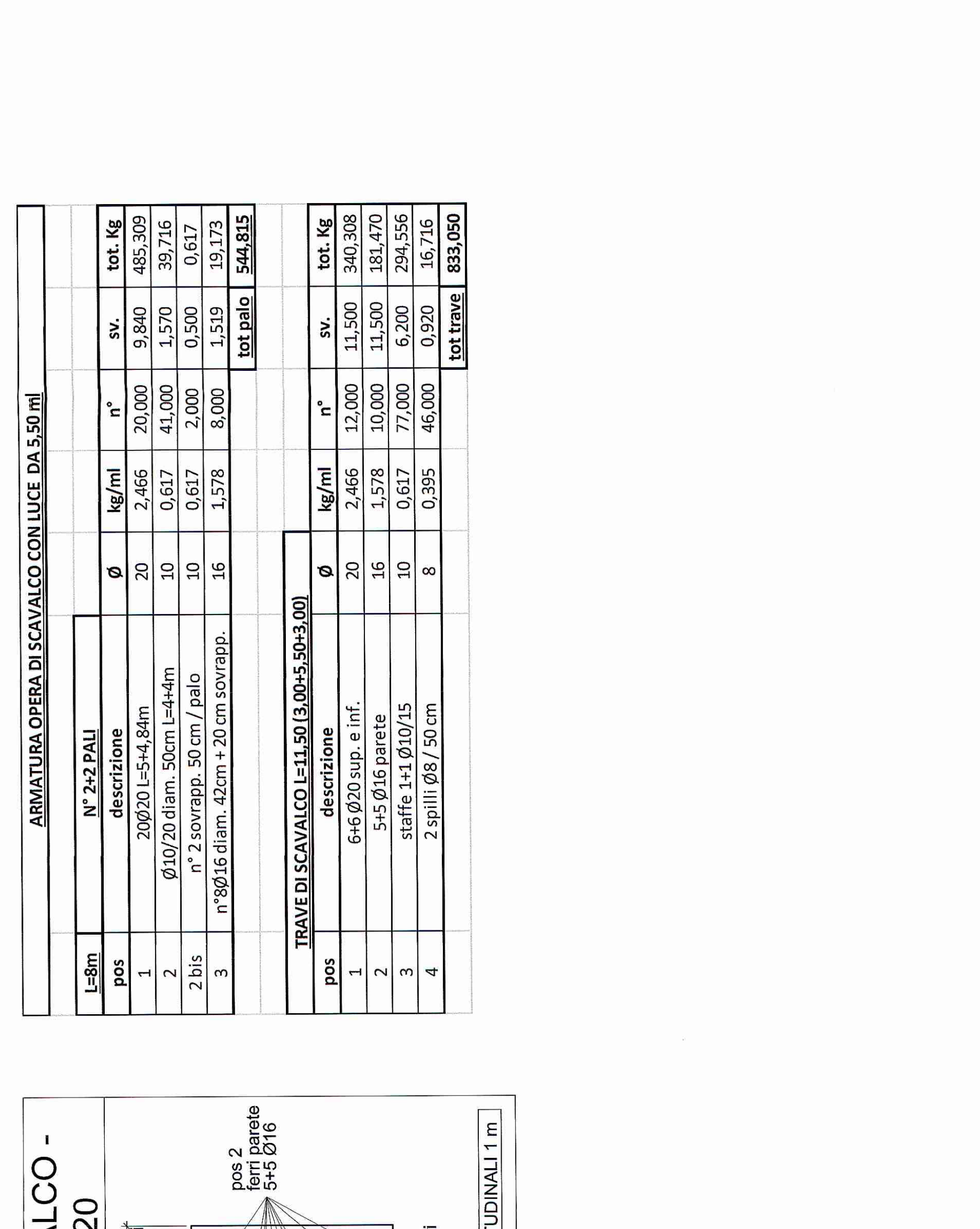
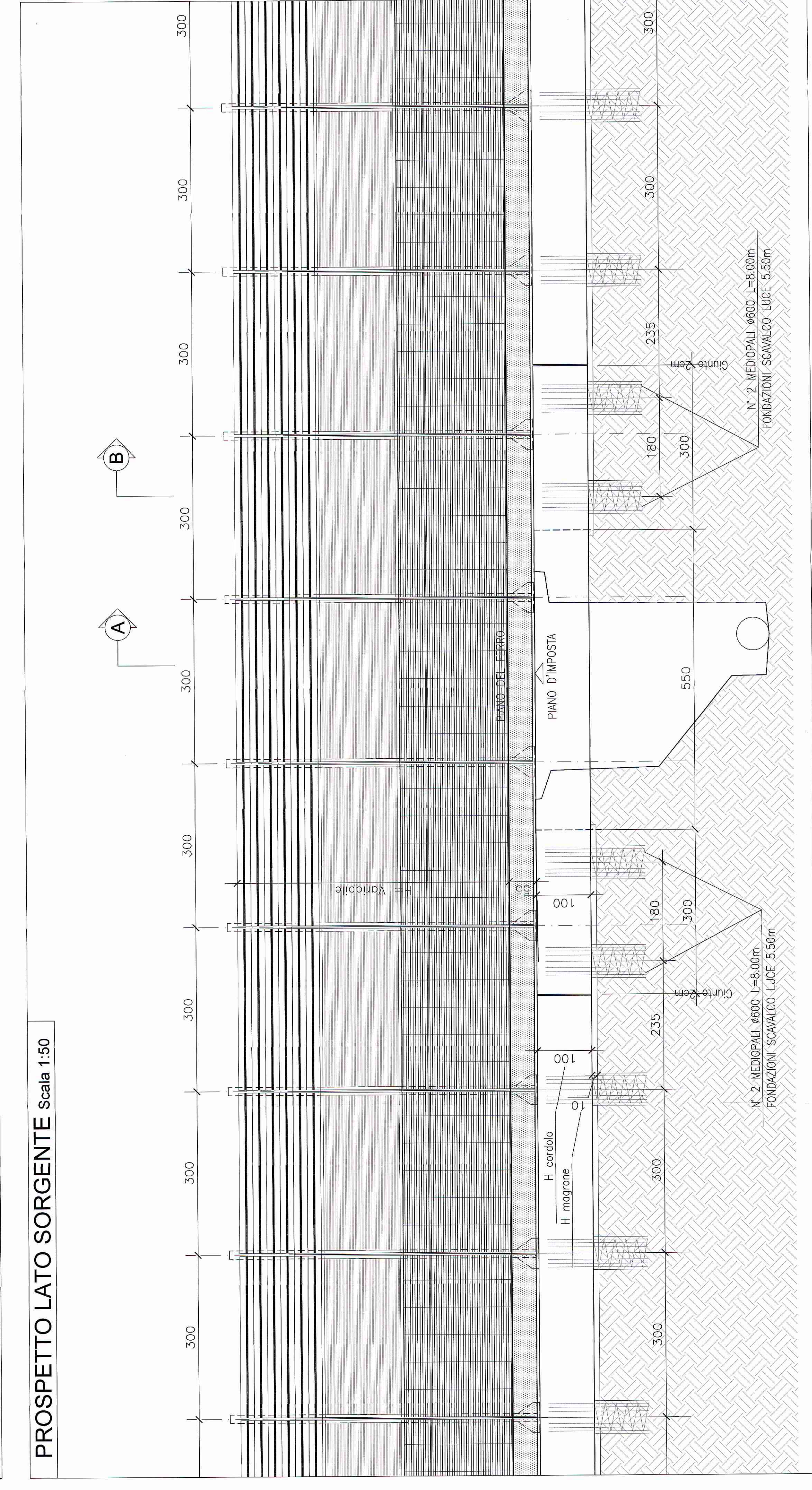
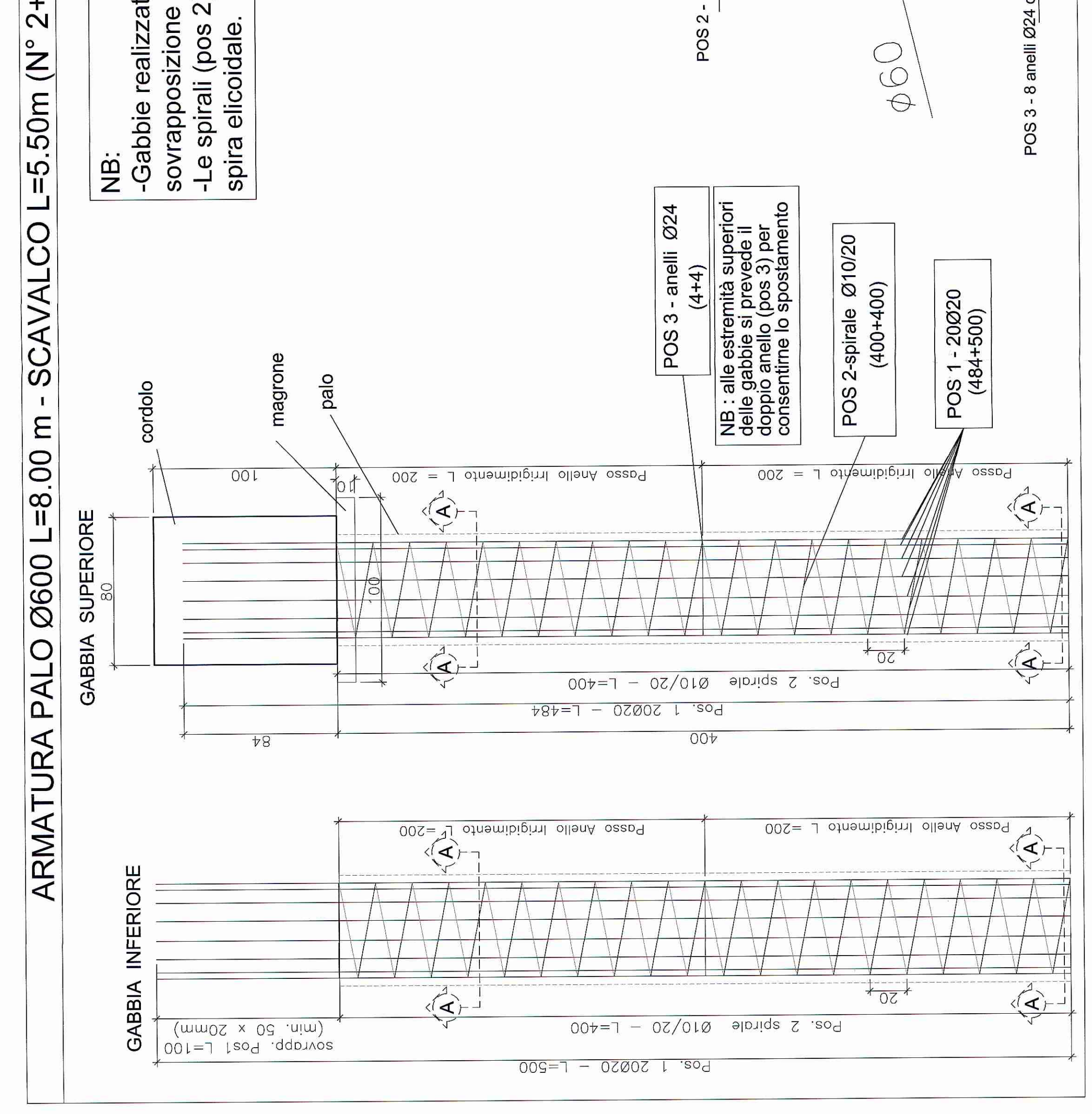
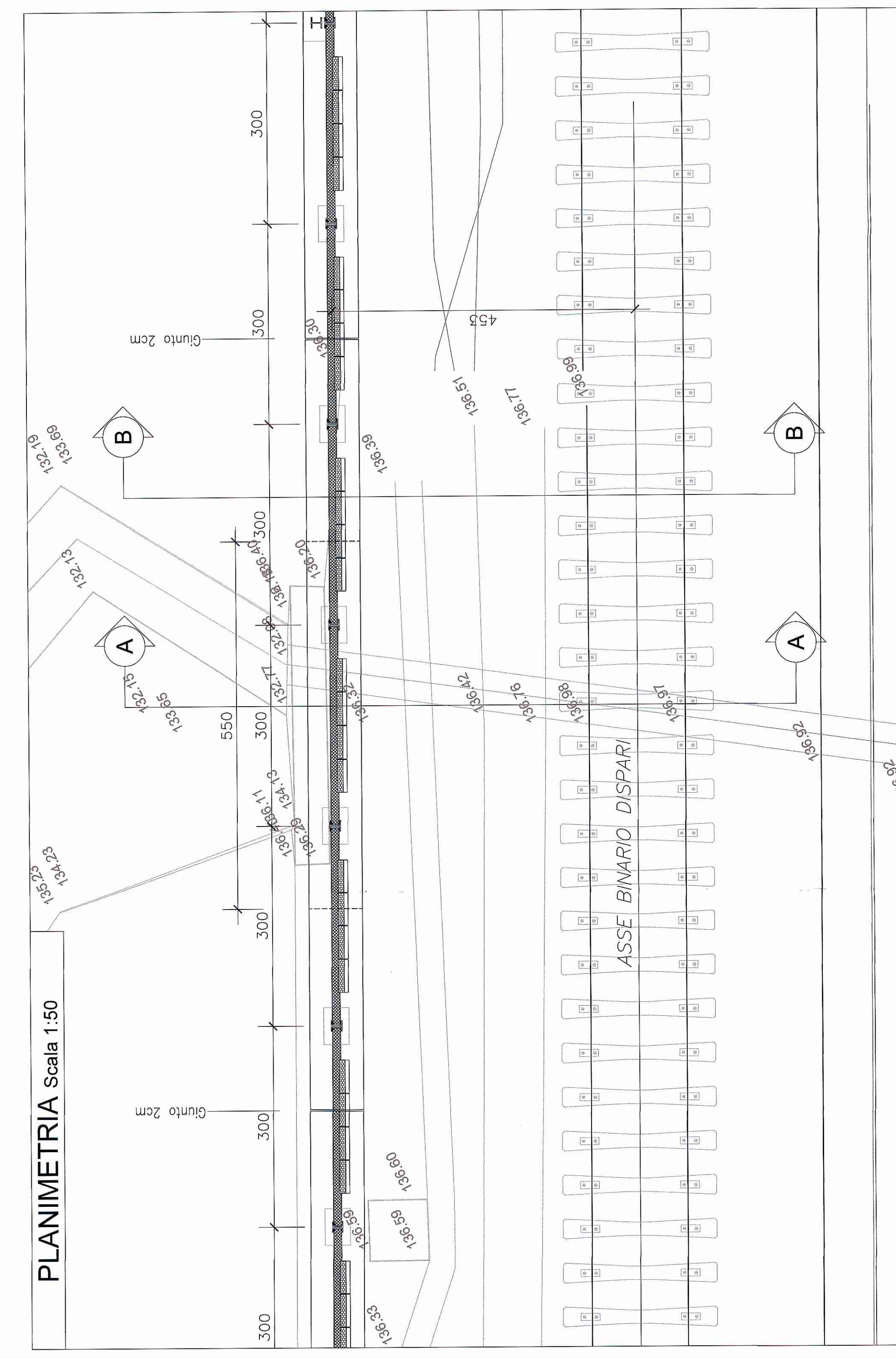
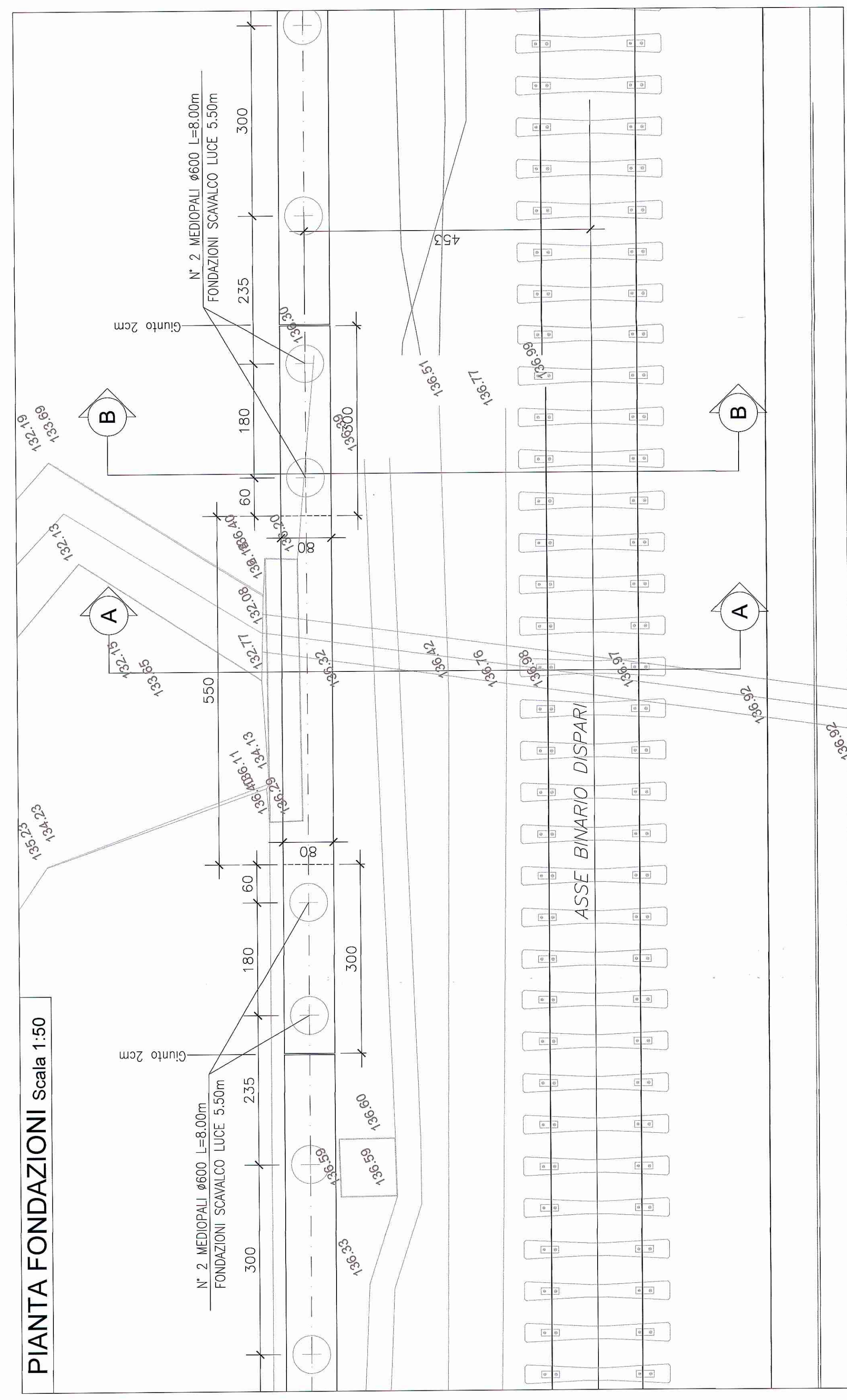

ARMATURA OPERA DI SCAVALCO CON LUCE DA 5,50 m. Table listing reinforcement specifications for the pier, including bar type, length, and weight.

TRAVE DI SCAVALCO L=5,50 (0+5,50+5,50). Table listing reinforcement specifications for the pier beam, including bar type, length, and weight.