

Planimetria di progetto Scala 1:2000

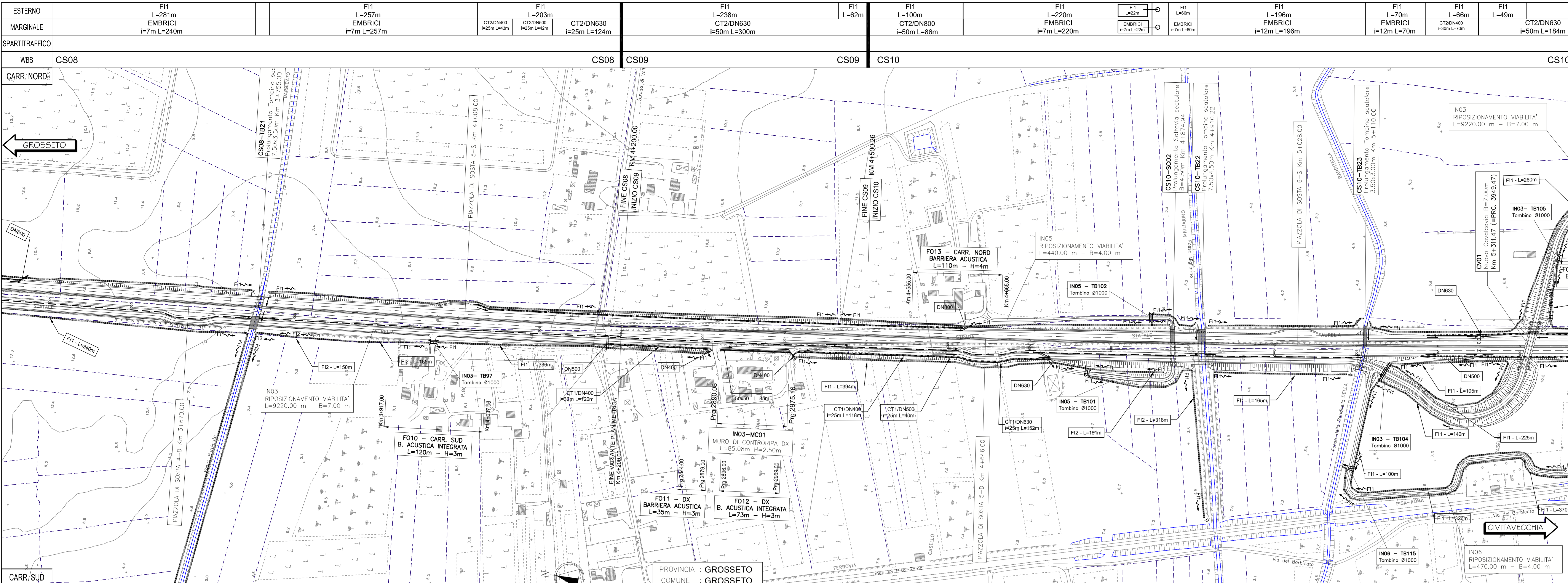

Table of hydraulic data for the top section, including marginal, external, and internal canal specifications (width, length, depth) and manhole details.

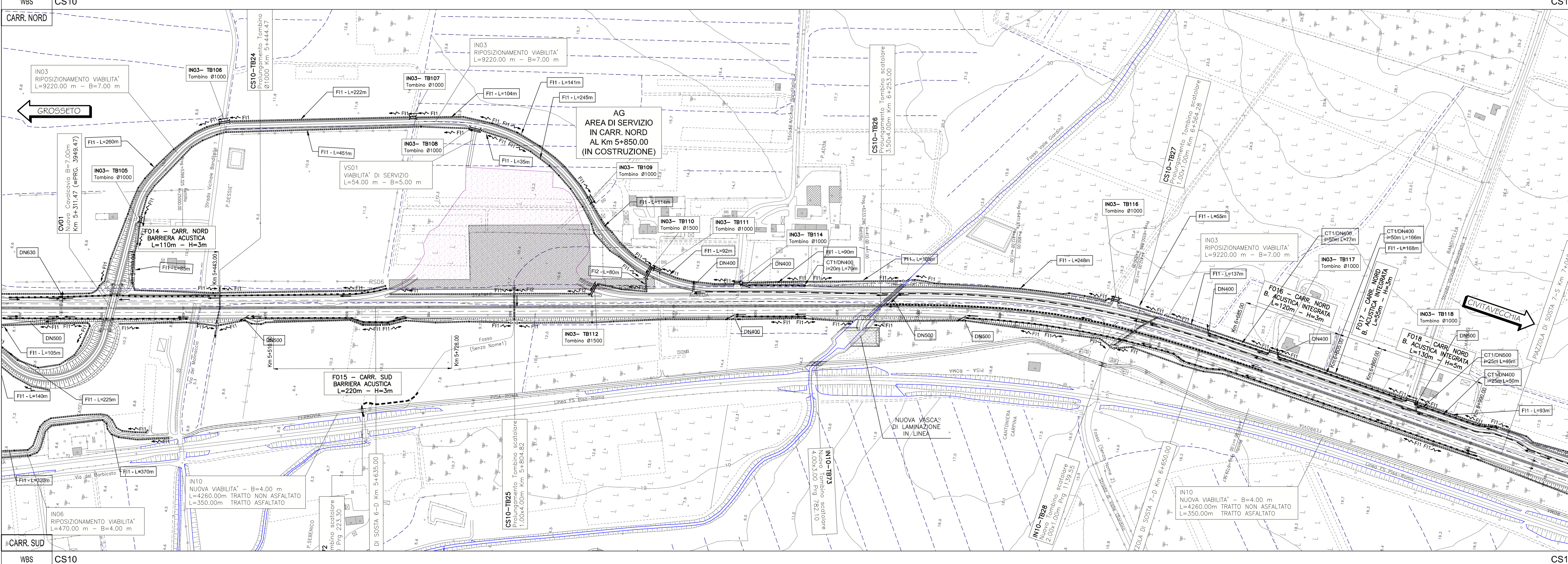
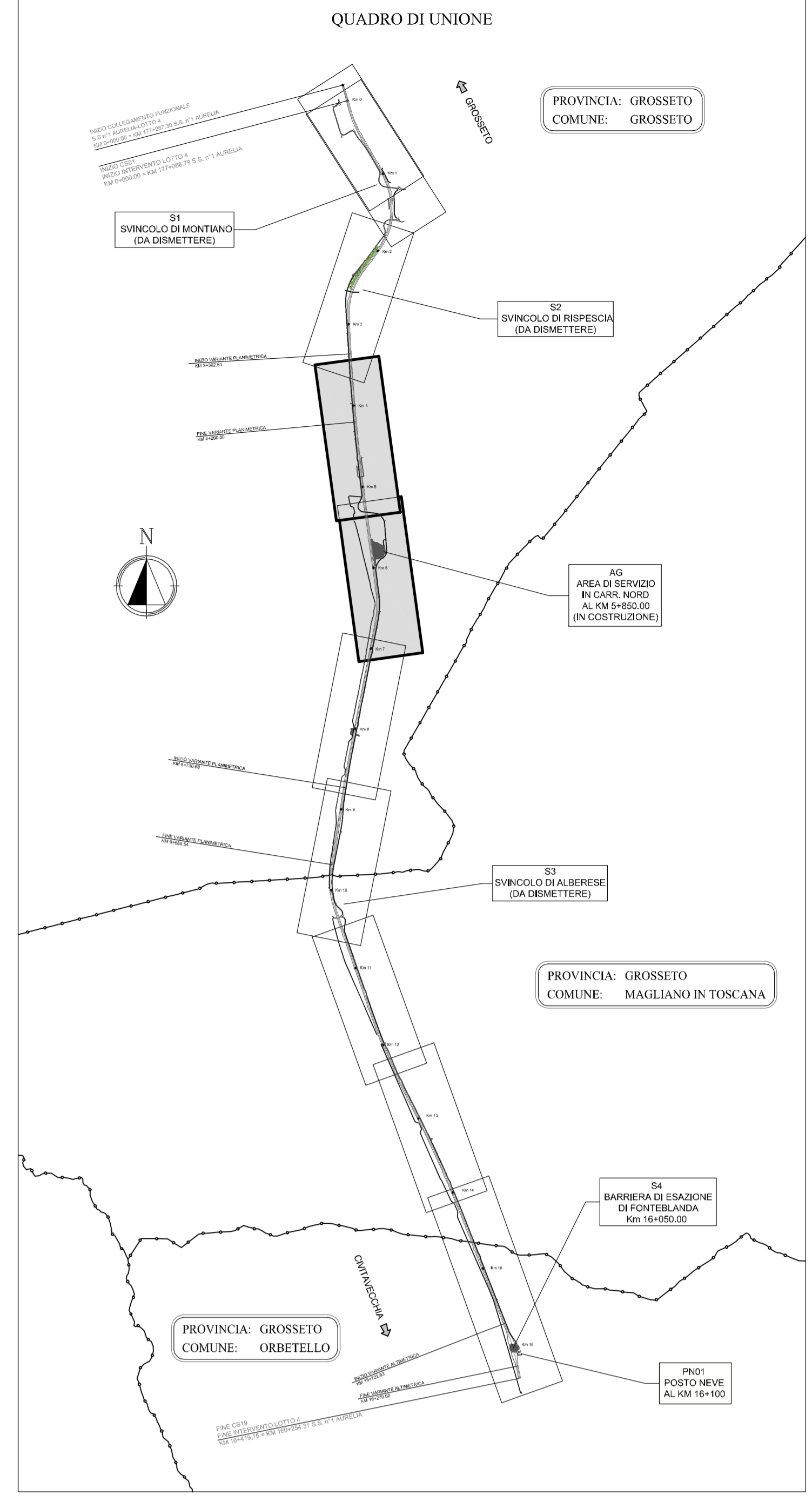

Table of hydraulic data for the bottom section, including marginal, external, and internal canal specifications and manhole details.



Technical specifications for the drainage system, including a legend for hydraulic planimetry, canalization types, manholes, and inspection grates.

Project information block including the company name (SAT), project title (AUTOSTRADA A12), lot number (LOTTO 4), and project status (PROGETTO DEFINITIVO).

Administrative and technical details including the responsible project engineer, date (FEBBRAIO 2011), scale (1:2000), and company logos (spea, ingegneria europea, SAT).