

BARRIERA IN LEGNO SU OPERA H_{FUORI TERRA} = 3m
 SCALA 1:50
 Barriere: MT-13a, MT-13b

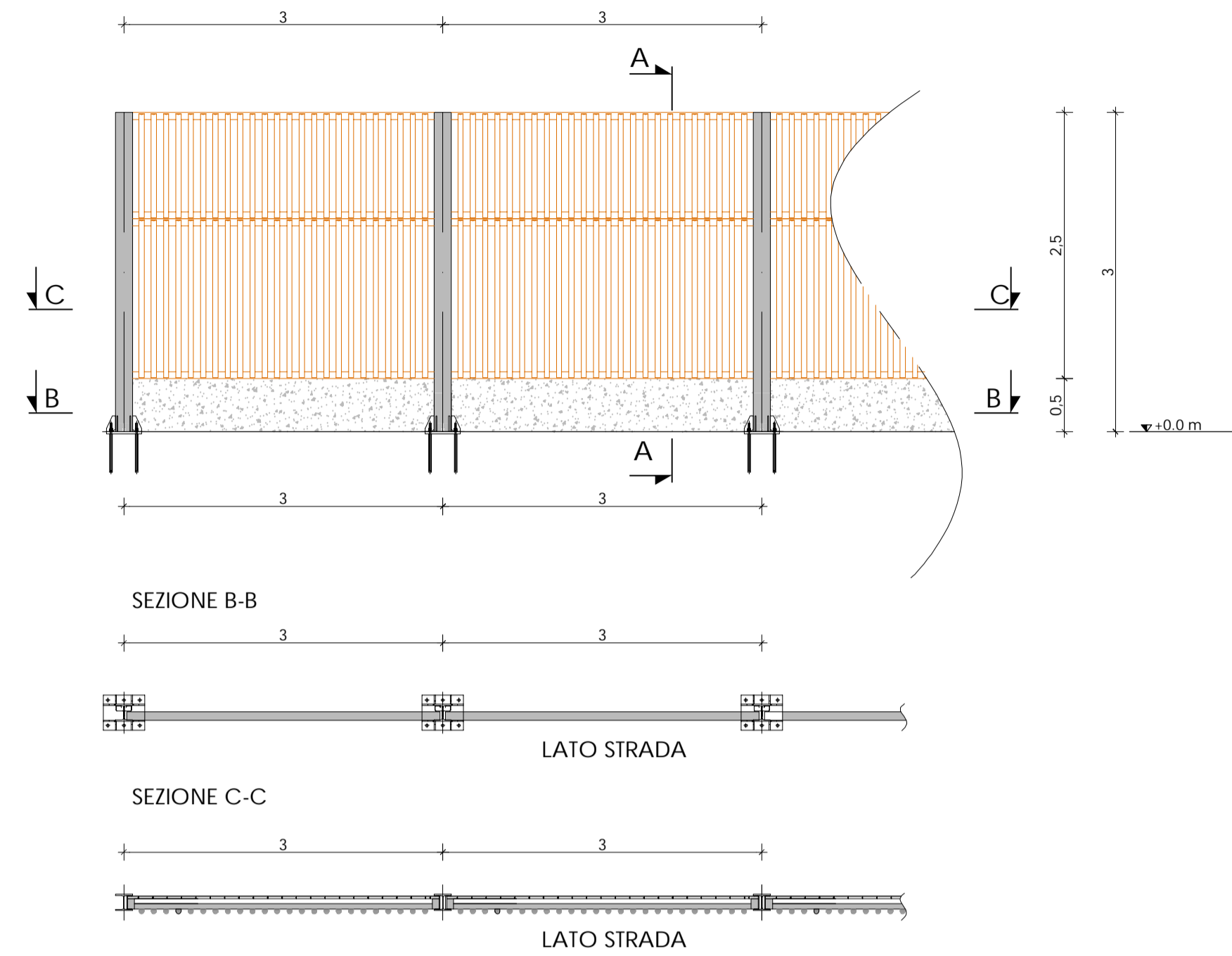

SEZIONE A-A
 SCALA 1:50

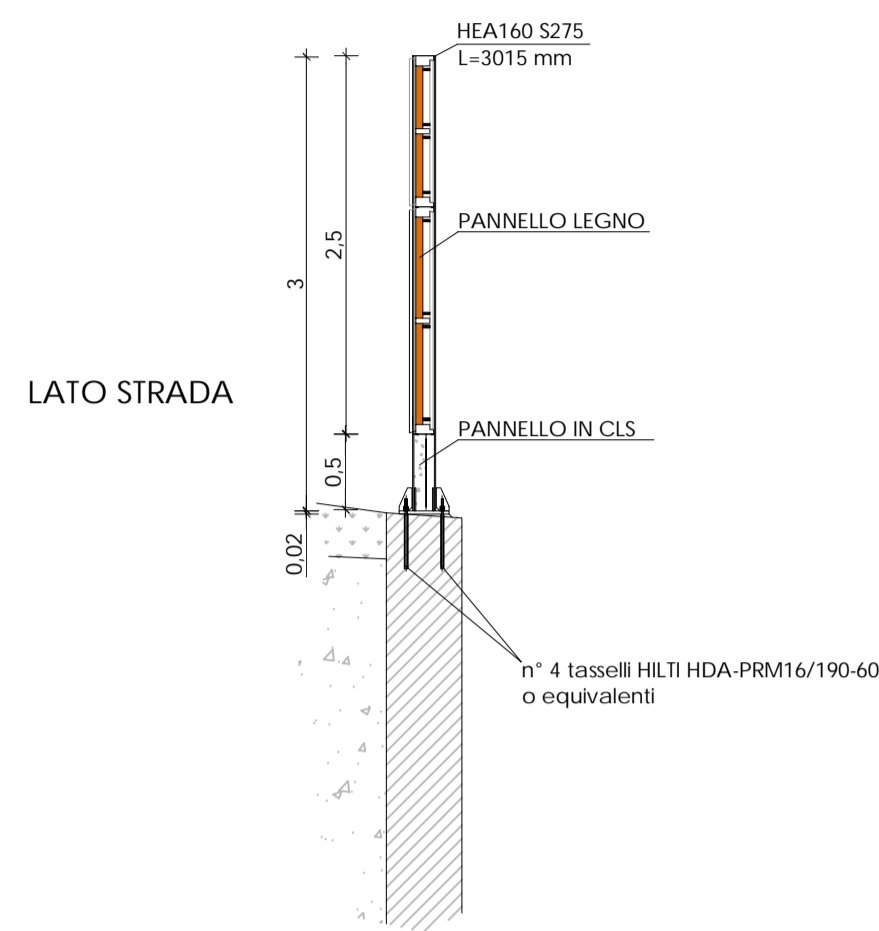

CARPENTERIA: ACCIAIO S275JR
 ZINCATURA A CALDO
 VERNICIATURA RAL 6001

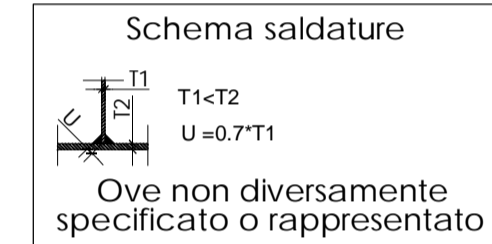

POSIZIONAMENTO BARRIERA SU MURO D'ALA SPALLA
 SCALA 1:50

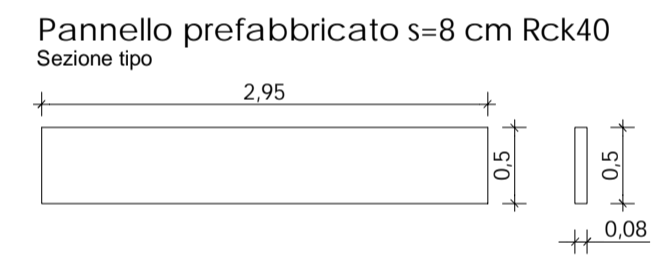
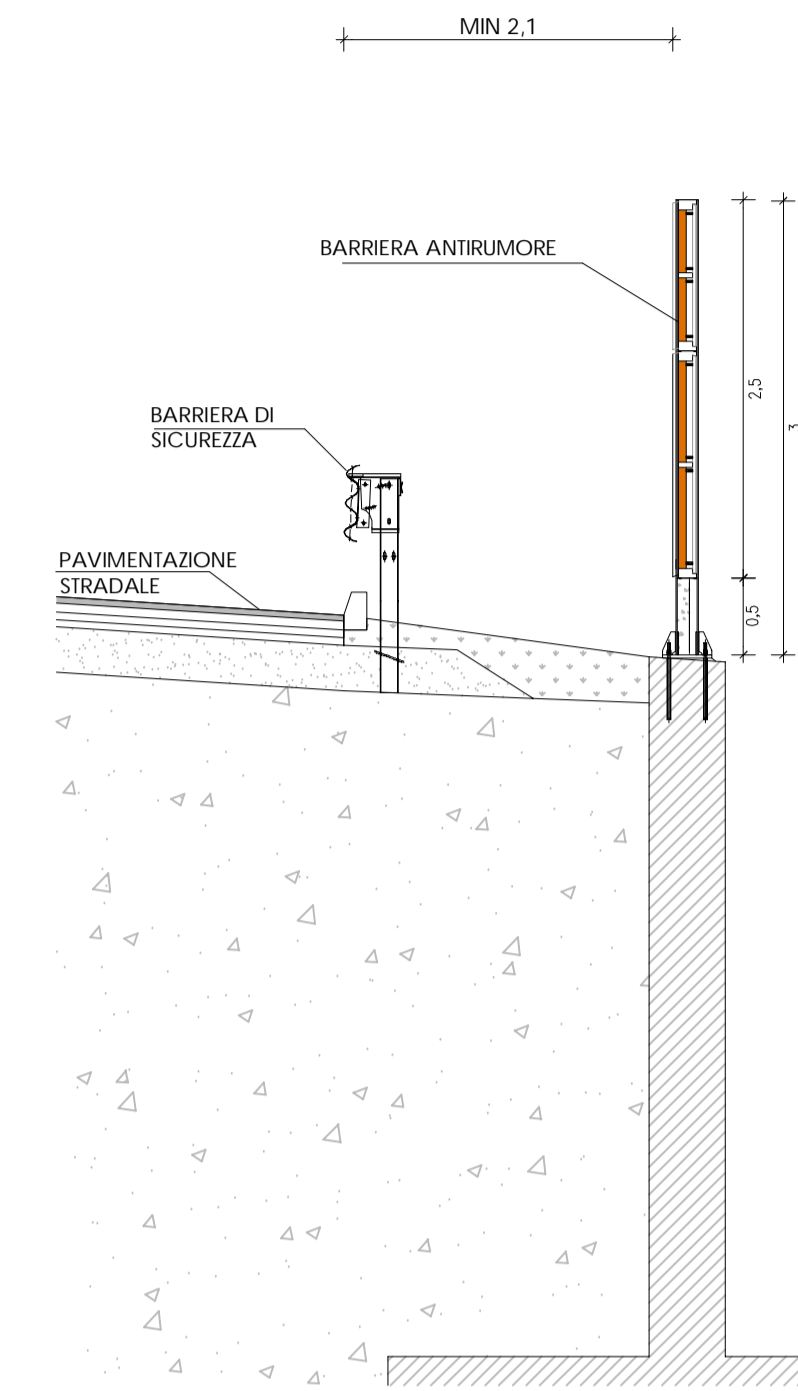

Colonna Scala 1:5
 Quote [mm]

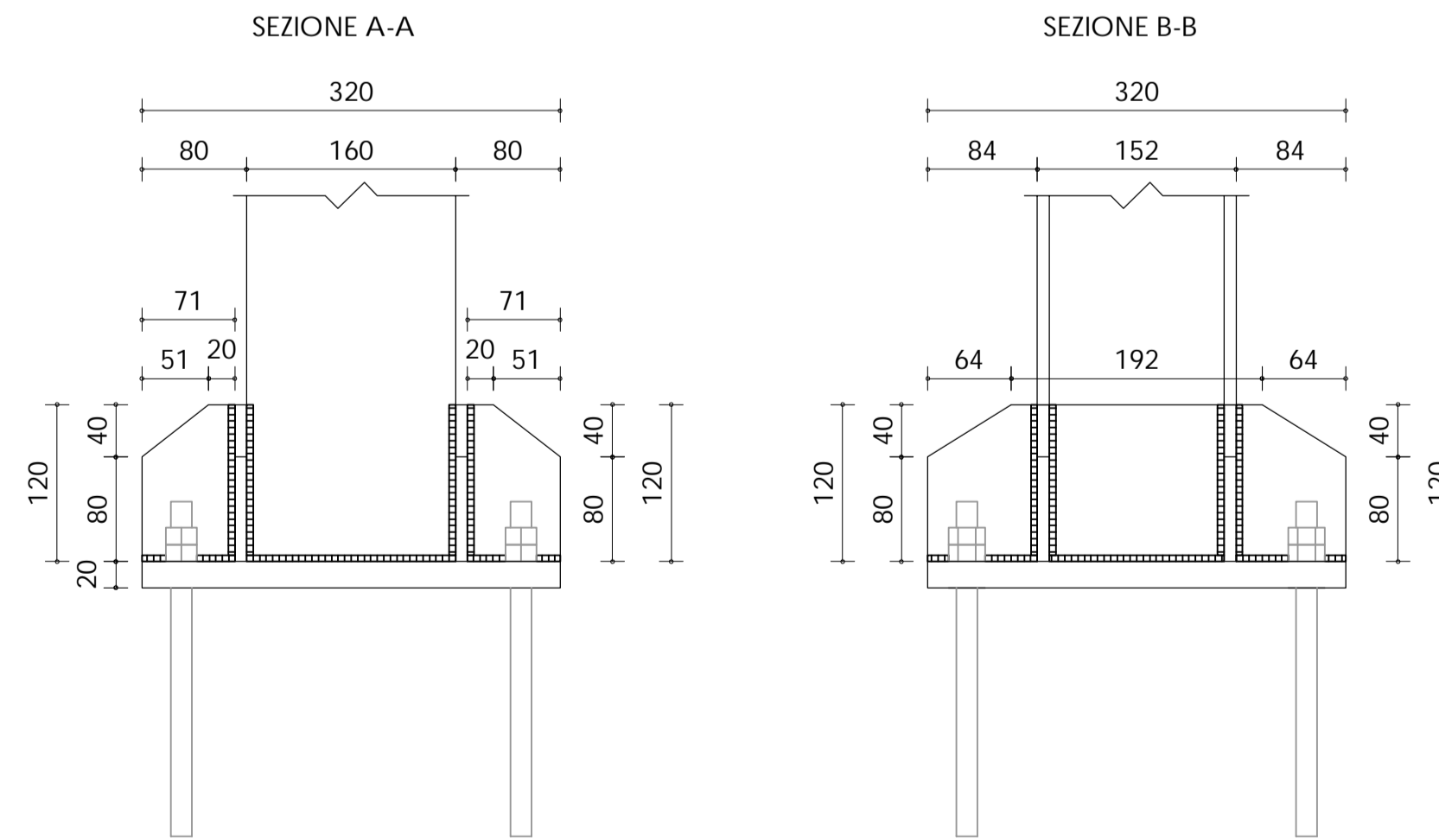
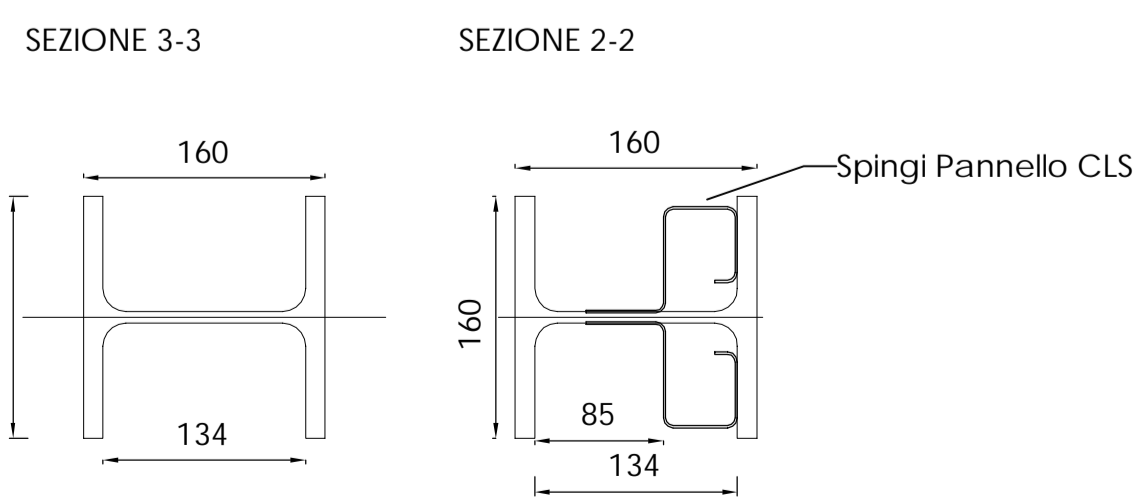
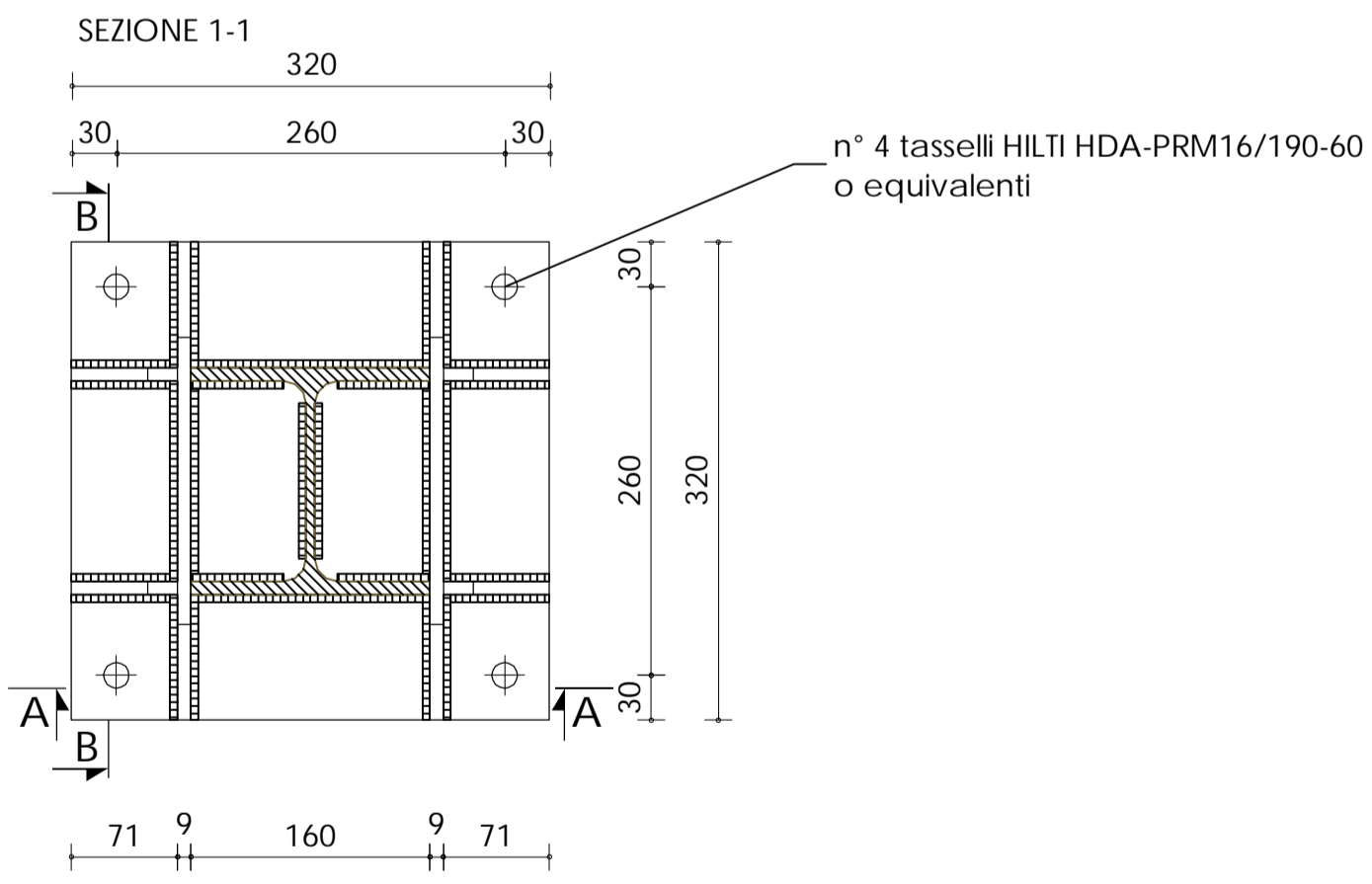
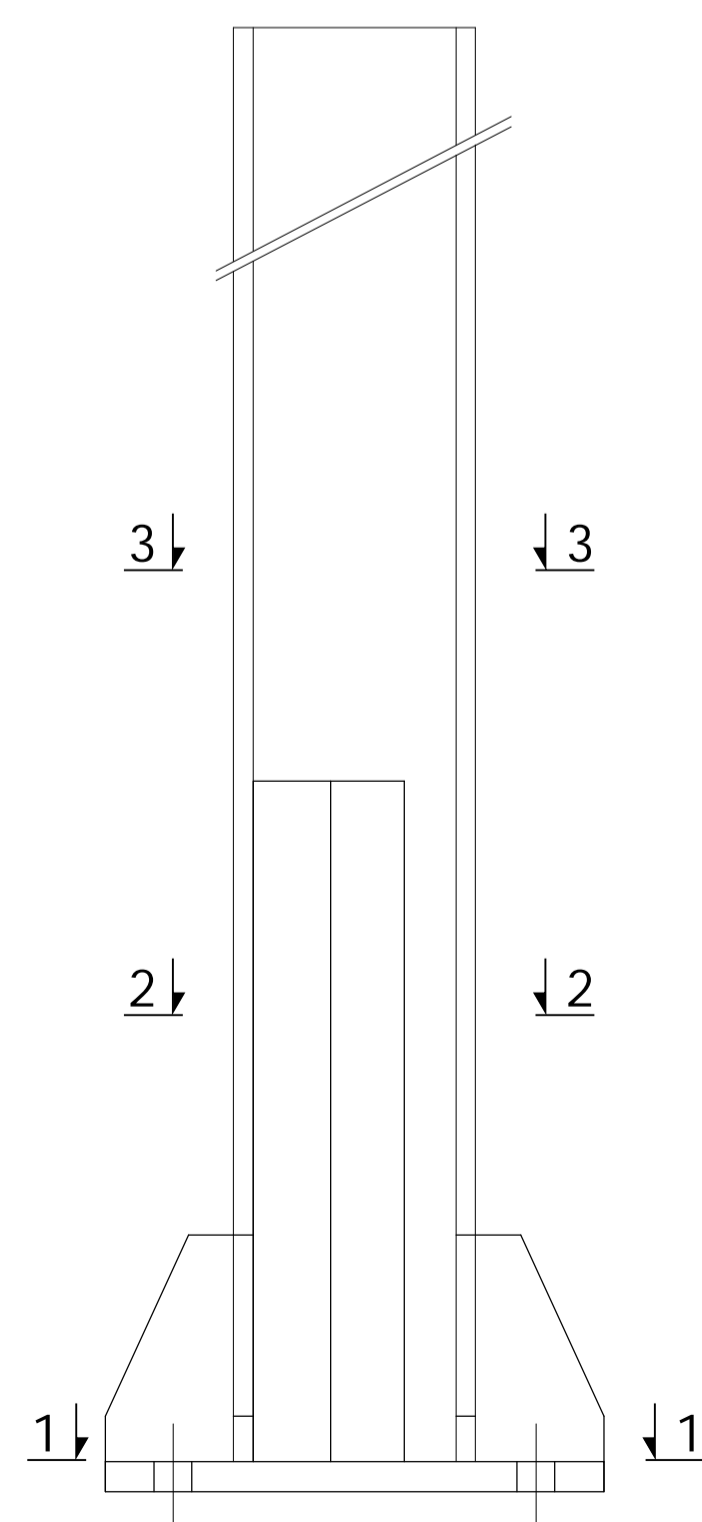

Anas S.p.A.



AUTOSTRADA A4 - VARIANTE DI MESTRE
**PASSANTE
 AUTOSTRADALE**
 (L. 443/2001 D.Lgs. 20.08.2002 n°190)

- PROGETTO ESECUTIVO -

Progetto:
**INTERVENTI ANTIRUMORE PASSANTE DI MESTRE
 CASELLO DI MARTELLAGO-SCORZE'**

Progettista:



IGQ
 Via Venezia n° 59 int. 15 Scalo C
 35131 PADOVA
 tel. +39 049 869111 fax. +39 049 8691199
 E-mail: info@igq.it
 Prof. Ing. M. STRADA

| | | | |
|---|--|-----------------|--|
| Descrizione elaborato: | | Nome elaborato: | |
| BARRIERE ANTIRUMORE Barriere antirumore in legno su opera Particolari costruttivi | | R0402 | |
| Scala: | | Varie | |

| | | | | | |
|-----------|-------------|-----------------|--------------|---------------|-----------|
| 04 | | | | | |
| 03 | | | | | |
| 02 | | | | | |
| 01 | | | | | |
| 00 | Maggio 2015 | Prima emissione | G. Vendramin | A. Crivellaro | M. Strada |
| Revisione | Data | Descrizione | Redatto | Controllato | Approvato |

Nome file: 01023ESgr0401-06-00_PC_