

Pila UP6
Scala 1:100

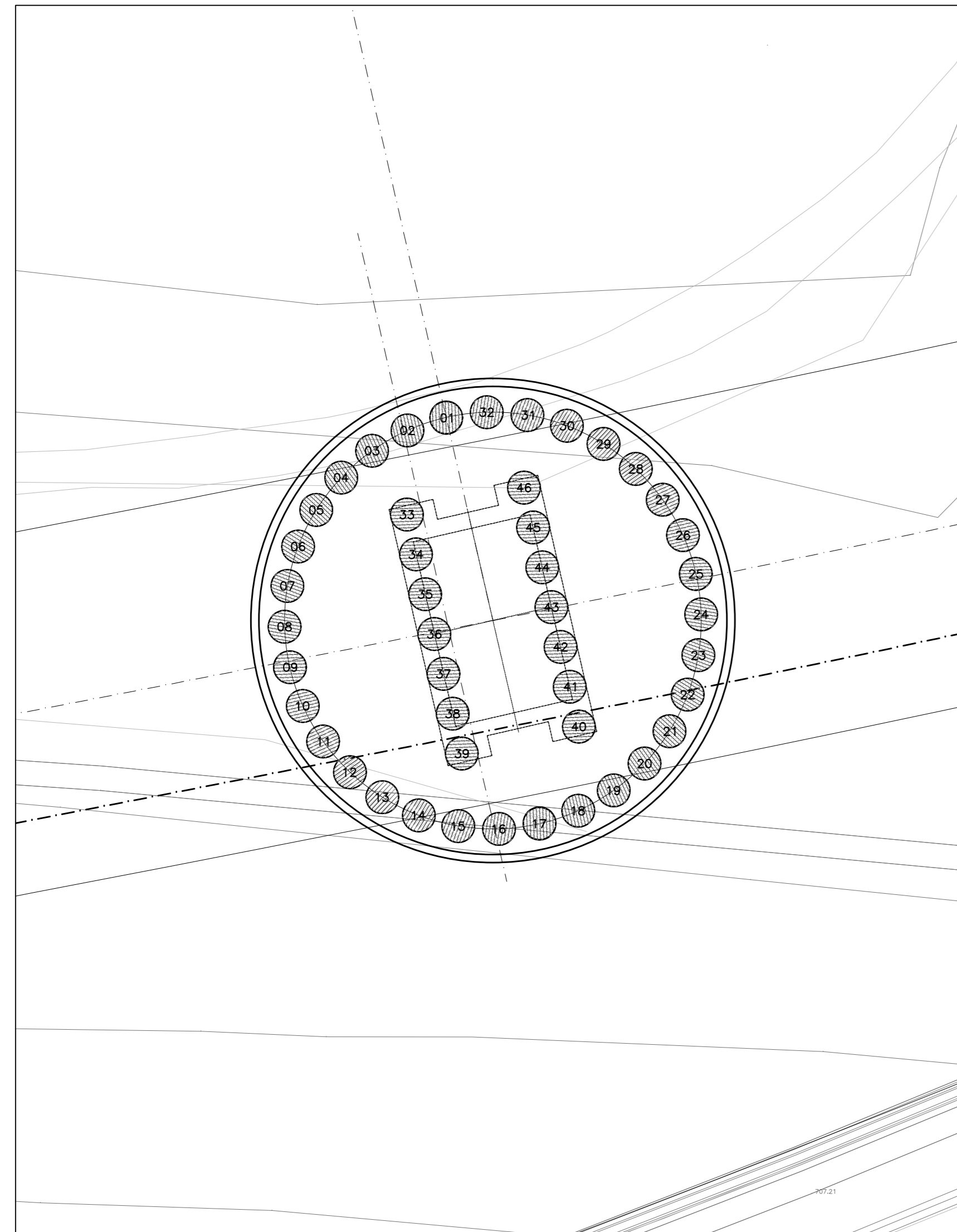

Pila UP7
Scala 1:100

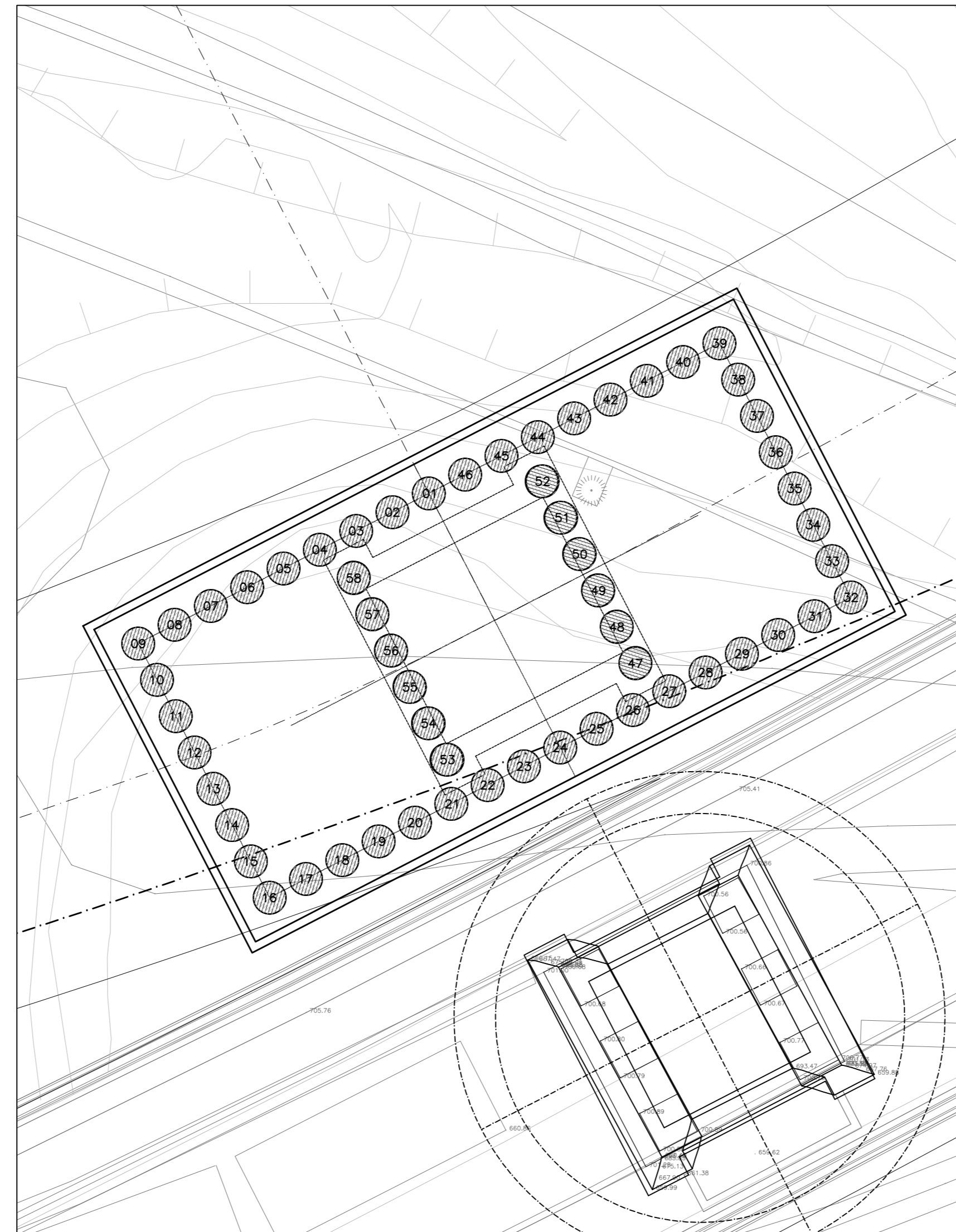

NOTA
- Le coordinate si riferiscono ai centri dei pali.
- Le coordinate topografiche sono riferite al sistema Gauss-Boaga Roma 1940 E 12'W.

PILA / SPALLA	N-PALO	Posizione X	Posizione Y	TIPO
UP6	01	13420246042	4992757311	A
UP6	02	13420239541	4992743223	A
UP6	03	13420227866	4992743258	A
UP6	04	13420220287	4992738891	A
UP6	05	13420214214	4992728765	A
UP6	06	13420207922	4992718628	A
UP6	07	13420191423	4992708502	A
UP6	08	1342018454	4992700206	A
UP6	09	1342017823	4992692312	A
UP6	10	13420171927	4992682911	A
UP6	11	1342016567	4992672136	A
UP6	12	13420159423	4992661361	A
UP6	13	1342015317	4992650586	A
UP6	14	1342014692	4992639811	A
UP6	15	1342014067	4992629036	A
UP6	16	1342013442	4992618261	A
UP6	17	1342012817	4992607486	A
UP6	18	1342012192	4992596711	A
UP6	19	1342011567	4992585936	A
UP6	20	1342010942	4992575161	A
UP6	21	1342009317	4992564386	A
UP6	22	1342008692	4992553611	A
UP6	23	1342008067	4992542836	A
UP6	24	1342007442	4992532061	A
UP6	25	1342006817	4992521286	A
UP6	26	1342006192	4992510511	A
UP6	27	1342005567	4992499736	A
UP6	28	1342004942	4992488961	A
UP6	29	1342004317	4992478186	A
UP6	30	1342003692	4992467411	A
UP6	31	1342003067	4992456636	A
UP6	32	1342002442	4992445861	A
UP6	33	1342001817	4992435086	A
UP6	34	1342001192	4992424311	A
UP6	35	1342000567	4992413536	A
UP6	36	1341999942	4992402761	A
UP6	37	1341999317	4992391986	A
UP6	38	1341998692	4992381211	A
UP6	39	1341998067	4992370436	A
UP6	40	1341997442	4992359661	A
UP6	41	1341996817	4992348886	A
UP6	42	1341996192	4992338111	A
UP6	43	1341995567	4992327336	A
UP6	44	1341994942	4992316561	A
UP6	45	1341994317	4992305786	A
UP6	46	1341993692	4992295011	A

PILA / SPALLA	N-PALO	Posizione X	Posizione Y	TIPO
UP6	01	13421042521	4993024208	A
UP6	02	1342103603	4993014065	A
UP6	03	1342102954	4993003922	A
UP6	04	1342102305	4992993779	A
UP6	05	1342101656	4992983636	A
UP6	06	1342101007	4992973493	A
UP6	07	1342100358	4992963350	A
UP6	08	1342099709	4992953207	A
UP6	09	1342099060	4992943064	A
UP6	10	1342098411	4992932921	A
UP6	11	1342097762	4992922778	A
UP6	12	1342097113	4992912635	A
UP6	13	1342096464	4992902492	A
UP6	14	1342095815	4992892349	A
UP6	15	1342095166	4992882206	A
UP6	16	1342094517	4992872063	A
UP6	17	1342093868	4992861920	A
UP6	18	1342093219	4992851777	A
UP6	19	1342092570	4992841634	A
UP6	20	1342091921	4992831491	A
UP6	21	1342091272	4992821348	A
UP6	22	1342090623	4992811205	A
UP6	23	1342089974	4992801062	A
UP6	24	1342089325	4992790919	A
UP6	25	1342088676	4992780776	A
UP6	26	1342088027	4992770633	A
UP6	27	1342087378	4992760490	A
UP6	28	1342086729	4992750347	A
UP6	29	1342086080	4992740204	A
UP6	30	1342085431	4992730061	A
UP6	31	1342084782	4992719918	A
UP6	32	1342084133	4992709775	A
UP6	33	1342083484	4992699632	A
UP6	34	1342082835	4992689489	A
UP6	35	1342082186	4992679346	A
UP6	36	1342081537	4992669203	A
UP6	37	1342080888	4992659060	A
UP6	38	1342080239	4992648917	A
UP6	39	1342080090	4992638774	A
UP6	40	1342079441	4992628631	A
UP6	41	1342078792	4992618488	A
UP6	42	1342078143	4992608345	A
UP6	43	1342077494	4992598202	A
UP6	44	1342076845	4992588059	A
UP6	45	1342076196	4992577916	A
UP6	46	1342075547	4992567773	A
UP6	47	1342074898	4992557630	A
UP6	48	1342074249	4992547487	A
UP6	49	1342073600	4992537344	A
UP6	50	1342072951	4992527201	A
UP6	51	1342072302	4992517058	A
UP6	52	1342071653	4992506915	A
UP6	53	1342071004	4992496772	A
UP6	54	1342070355	4992486629	A

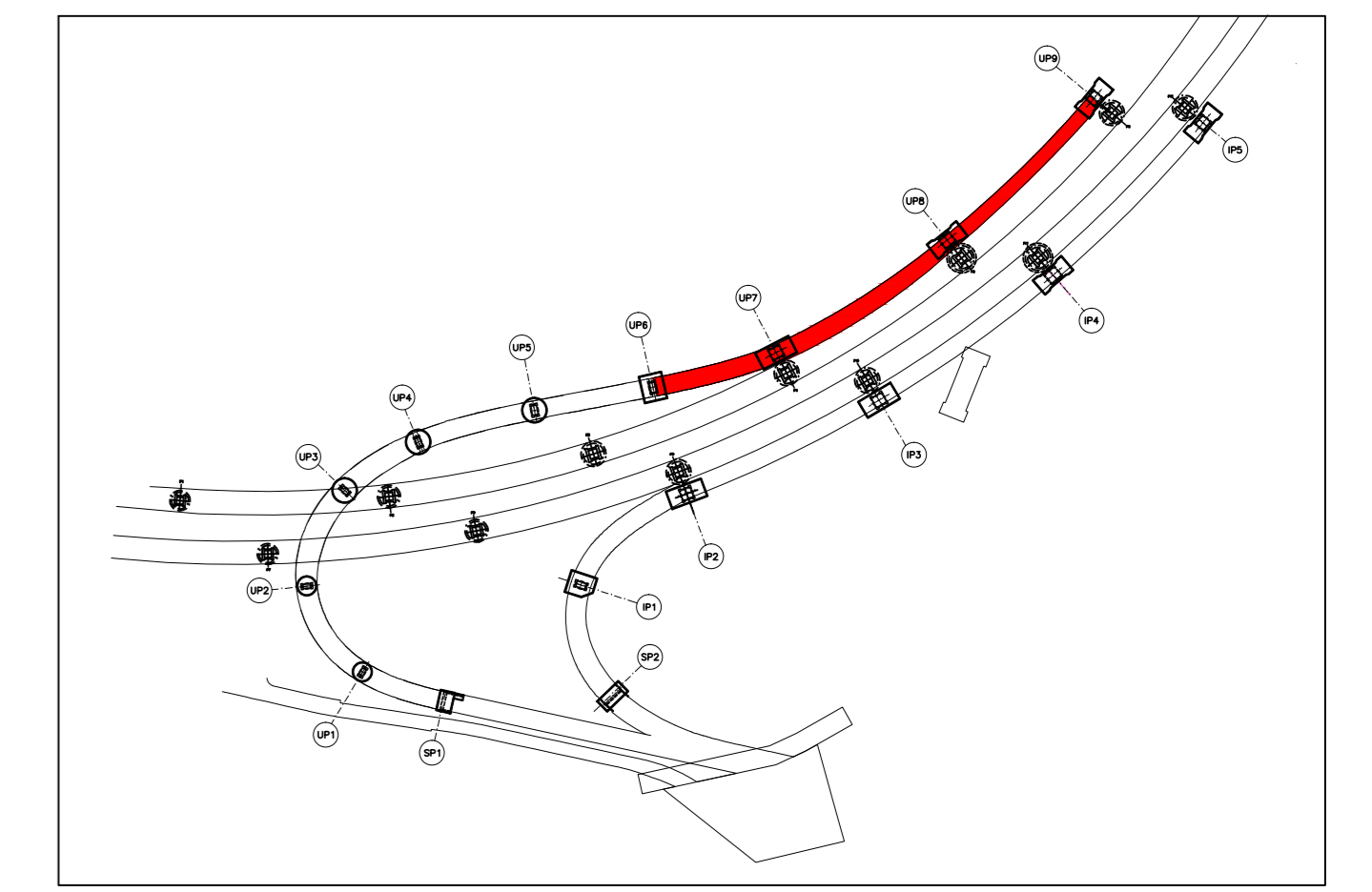

NOTA
- Per lo stato di esecuzione pali vedere carpenteria pilati di fondazione.
- Per opere provvisorie e scavi per esecuzione fondazioni vedere elaborati di dettaglio nel capitolo "OPERE D'ARTE MINORI".

PALI TIPOLOGICI

TIPO PALO	DIAMETRO	LUNGHEZZA
[-]	[m]	[m]
A	0.80	12.0
B	0.80	14.0
C	0.80	20.0

Pila UP8
Scala 1:100

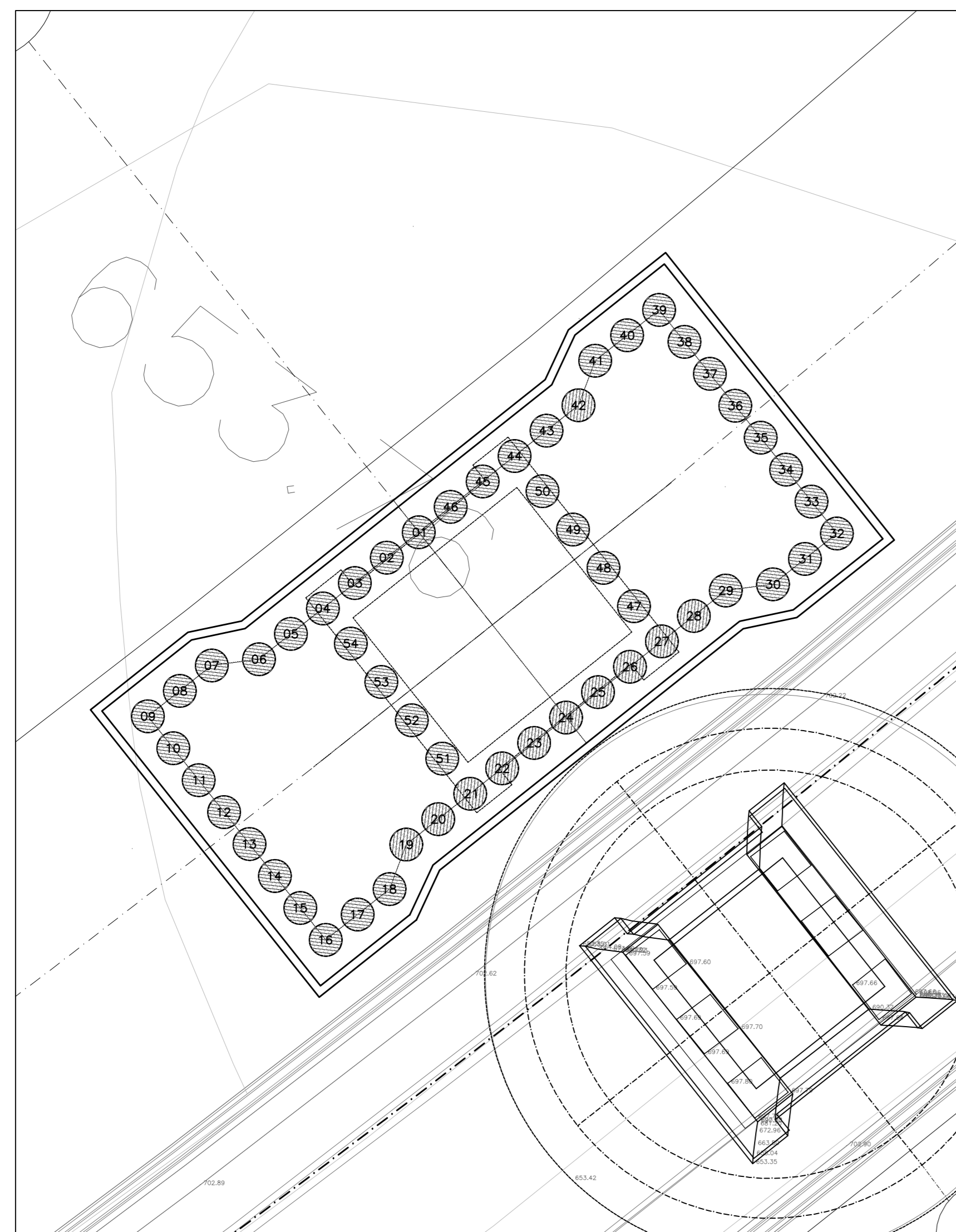

Pila UP9
Scala 1:100

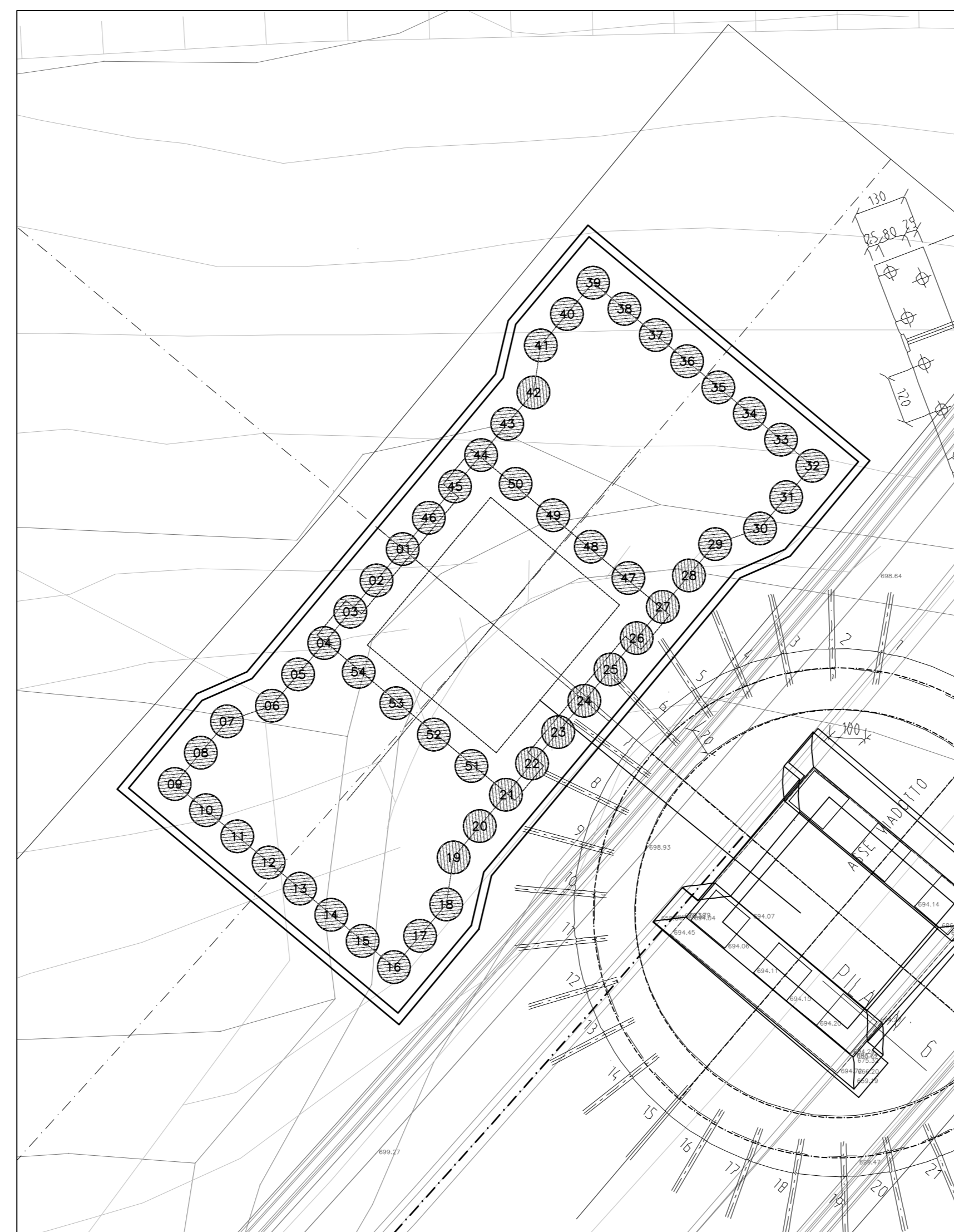

PILA / SPALLA	N-PALO	Posizione X	Posizione Y	TIPO
UP7	01	1342078086	4992679136	A
UP7	02	1342077457	4992668993	A
UP7	03	1342076828	4992658850	A
UP7	04	1342076199	4992648707	A
UP7	05	1342075570	4992638564	A
UP7	06	1342074941	4992628421	A
UP7	07	1342074312	4992618278	A
UP7	08	1342073683	4992608135	A
UP7	09	1342073054	4992597992	A
UP7	10	1342072425	4992587849	A
UP7	11	1342071796	4992577706	A
UP7	12	1342071167	4992567563	A
UP7	13	1342070538	4992557420	A
UP7	14	1342070000	4992547277	A
UP7	15	1342069371	4992537134	A
UP7	16	1342068742	4992526991	A
UP7	17	1342068113	4992516848	A
UP7	18	1342067484	4992506705	A
UP7	19	1342066855	4992496562	A
UP7	20	1342066226	4992486419	A
UP7	21	1342065597	4992476276	A
UP7	22	1342064968	4992466133	A
UP7	23	1342064339	4992455990	A
UP7	24	1342063710	4992445847	A
UP7	25	1342063081	4992435704	A
UP7	26	1342062452	4992425561	A
UP7	27	1342061823	4992415418	A
UP7	28	1342061194	4992405275	A
UP7	29	1342060565	4992395132	A
UP7	30	1342059936	4992384989	A
UP7	31	1342059307	4992374846	A
UP7	32	1342058678	4992364703	A
UP7	33	1342058049	4992354560	A
UP7	34	1342057420	4992344417	A
UP7	35	1342056791	4992334274	A
UP7	36	1342056162	4992324131	A
UP7	37	1342055533	4992313988	A
UP7	38	1342054904	4992303845	A
UP7	39	1342054275	4992293702	A
UP7	40	1342053646	4992283559	A
UP7	41	1342053017	4992273416	A
UP7	42	1342052388	4992263273	A
UP7	43	1342051759	4992253130	A
UP7	44	1342051130	4992242987	A
UP7	45	1342050501	4992232844	A
UP7	46	1342049872	4992222701	A
UP7	47	1342049243	4992212558	A
UP7	48	1342048614	4992202415	A
UP7	49	1342047985	4992192272	A
UP7	50	1342047356	4992182129	A
UP7	51	1342046727	4992171986	A
UP7	52	1342046098	4992161843	A
UP7	53	1342045469	4992151700	A
UP7	54	1342044840	4992141557	A

PILA / SPALLA	N-PALO	Posizione X	Posizione Y	TIPO
UP8	01	13422038978	4993000316	A
UP8	02	1342203249	4992990173	A
UP8	03	1342202601	4992979930	A
UP8	04	1342201953	4992969687	A
UP8	05	1342201305	4992959444	A
UP8	06	1342200657	4992949201	A
UP8	07	1342200009	4992938958	A
UP8	08	1342199361	4992928715	A
UP8	09	1342198713	4992918472	A
UP8	10	1342198065	4992908229	A
UP8	11	1342197417	4992897986	A
UP8	12	1342196769	4992887743	A
UP8	13	1342196121	4992877500	A
UP8	14	1342195473	4992867257	A
UP8	15	1342194825	4992857014	A
UP8	16	1342194177	4992846771	A
UP8	17	1342193529	4992836528	A
UP8	18	1342192881	4992826285	A
UP8	19	1342192233	4992816042	A
UP8	20	1342191585	4992805799	A
UP8	21	1342190937	4992795556	A
UP8	22	1342190289	4992785313	A
UP8	23	1342190000	4992775070	A
UP8	24	1342189352	4992764827	A
UP8	25	1342188704	4992754584	A
UP8	26	1342188056	4992744341	A
UP8	27	1342187408	4992734098	A
UP8	28	1342186760	4992723855	A
UP8	29	1342186112	4992713612	A
UP8	30	1342185464	4992703369	A
UP8	31	1342184816	4992693126	A
UP8	32	1342184168	4992682883	A
UP8	33	1342183520	4992672640	A
UP8	34	1342182872	4992662397	A
UP8	35	1342182224	4992652154	A
UP8	36	1342181576	4992641911	A
UP8	37	1342180928	4992631668	A
UP8	38	1342180280	4992621425	A
UP8	39	1342179632	4992611182	A
UP8	40	1342178984	4992600939	A
UP8	41	1342178336	4992590696	A
UP8	42	1342177688	4992580453	A
UP8	43	1342177040	4992570210	A
UP8	44	1342176392	4992559967	A
UP8	45	1342175744	4992549724	A
UP8	46	1342175096	4992539481	A
UP8	47	1342174448	4992529238	A
UP8	48	1342173800	4992518995	A
UP8	49	1342173152	4992508752	A
UP8	50	1342172504	4992498509	A