

# REGIONE PUGLIA

## PORTO DI SAN FOCA S.P.A. Porto Turistico-Stazionamento

PROGETTO DEFINITIVO PER L'AMPLIAMENTO E COMPLETAMENTO  
DEL PORTO DI SAN FOCA ADEGUATO ALLE RISULTANZE DELLE  
PROVE SUL MODELLO FISICO REALIZZATO DAL POLITECNICO DI BARI

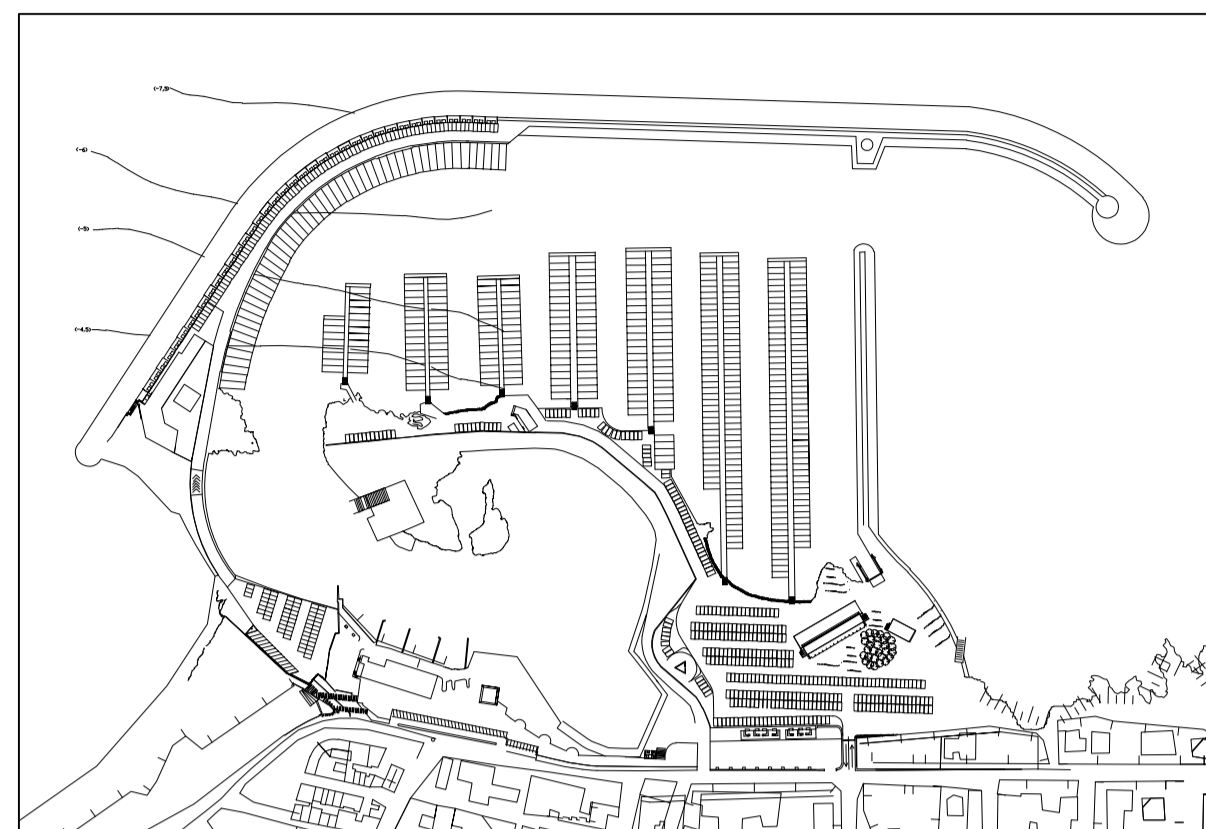

OPERE DI ADEGUAMENTO SULLA BASE DEGLI  
APPROFONDIMENTI SUL MODELLO FISICO

### PROGETTISTI

Ing. Antonio Candido   Ing. Donato Candido   Ing. Luigi Del Grosso   Ing. Franco Gallo

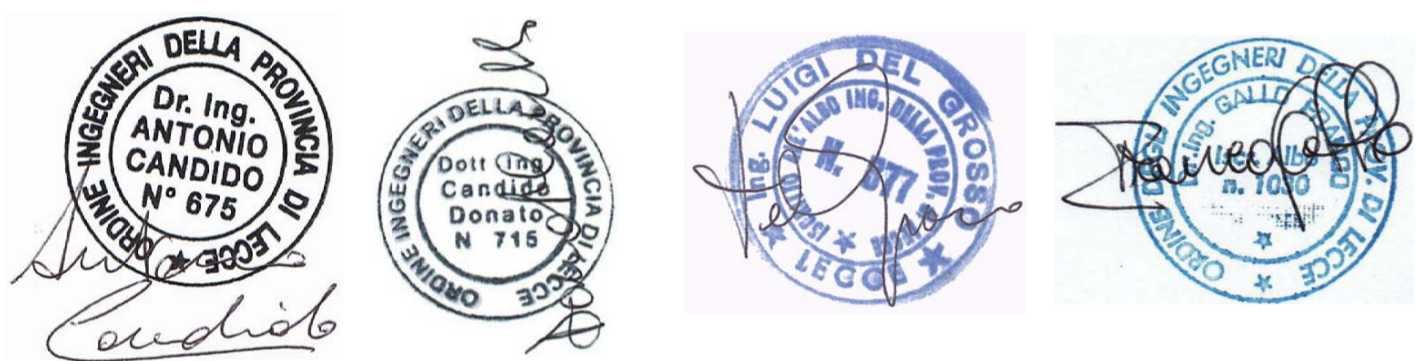

SETTEMBRE 2018

TAV. PC6

Rev.

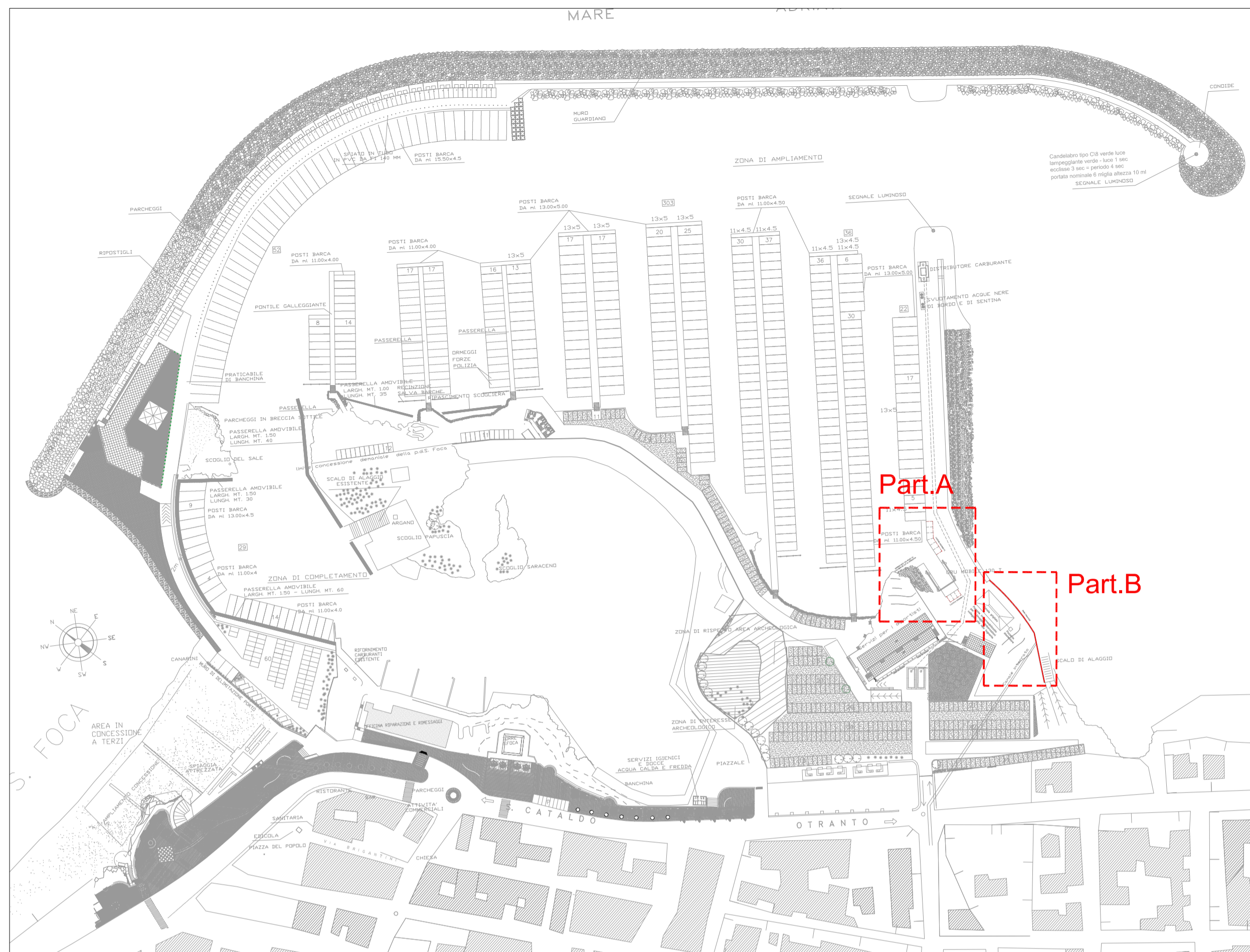

Planimetria Generale di Ampliamento e Completamento - rapp. 1:2000

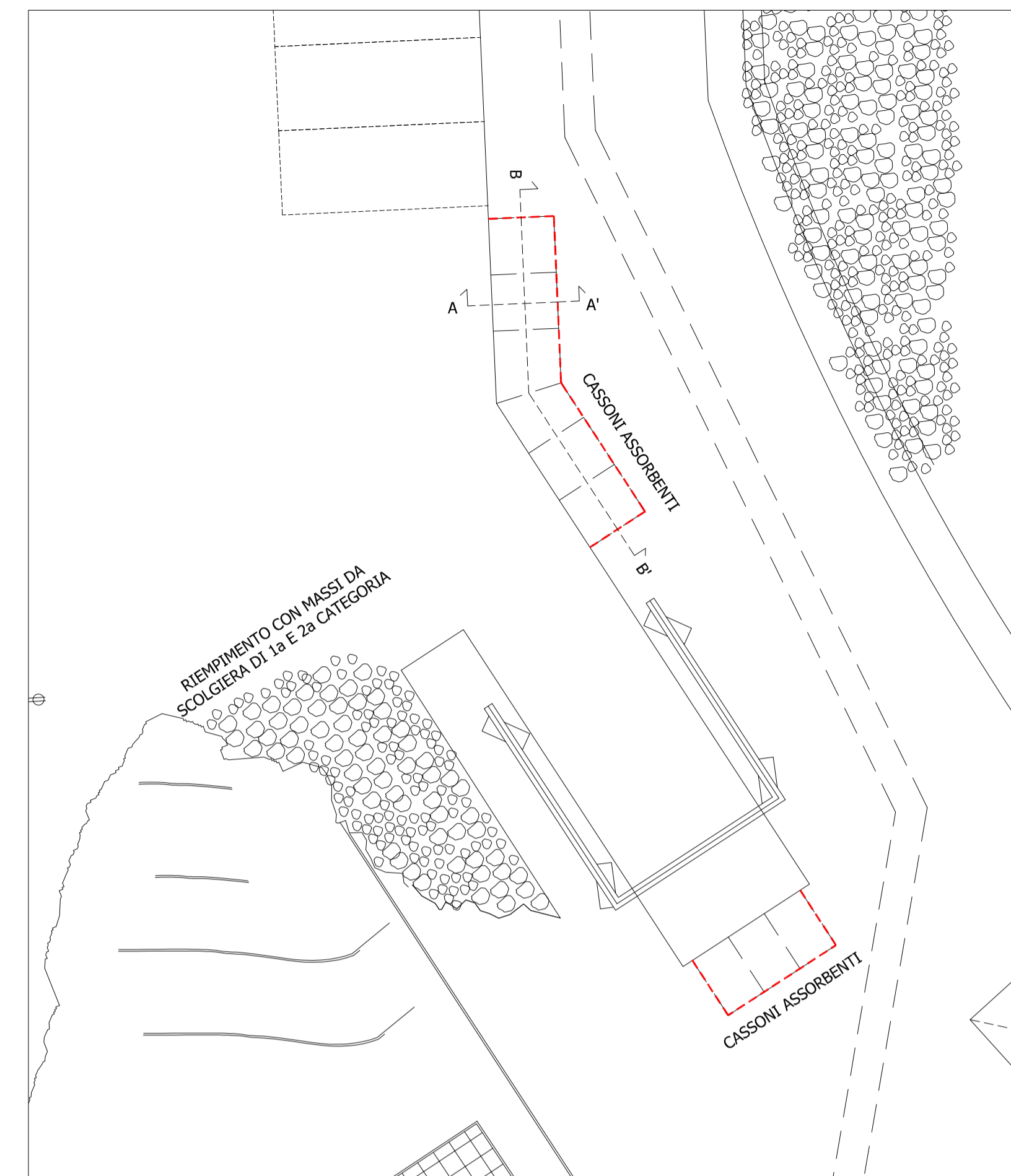

Part.A - rapp. 1:500

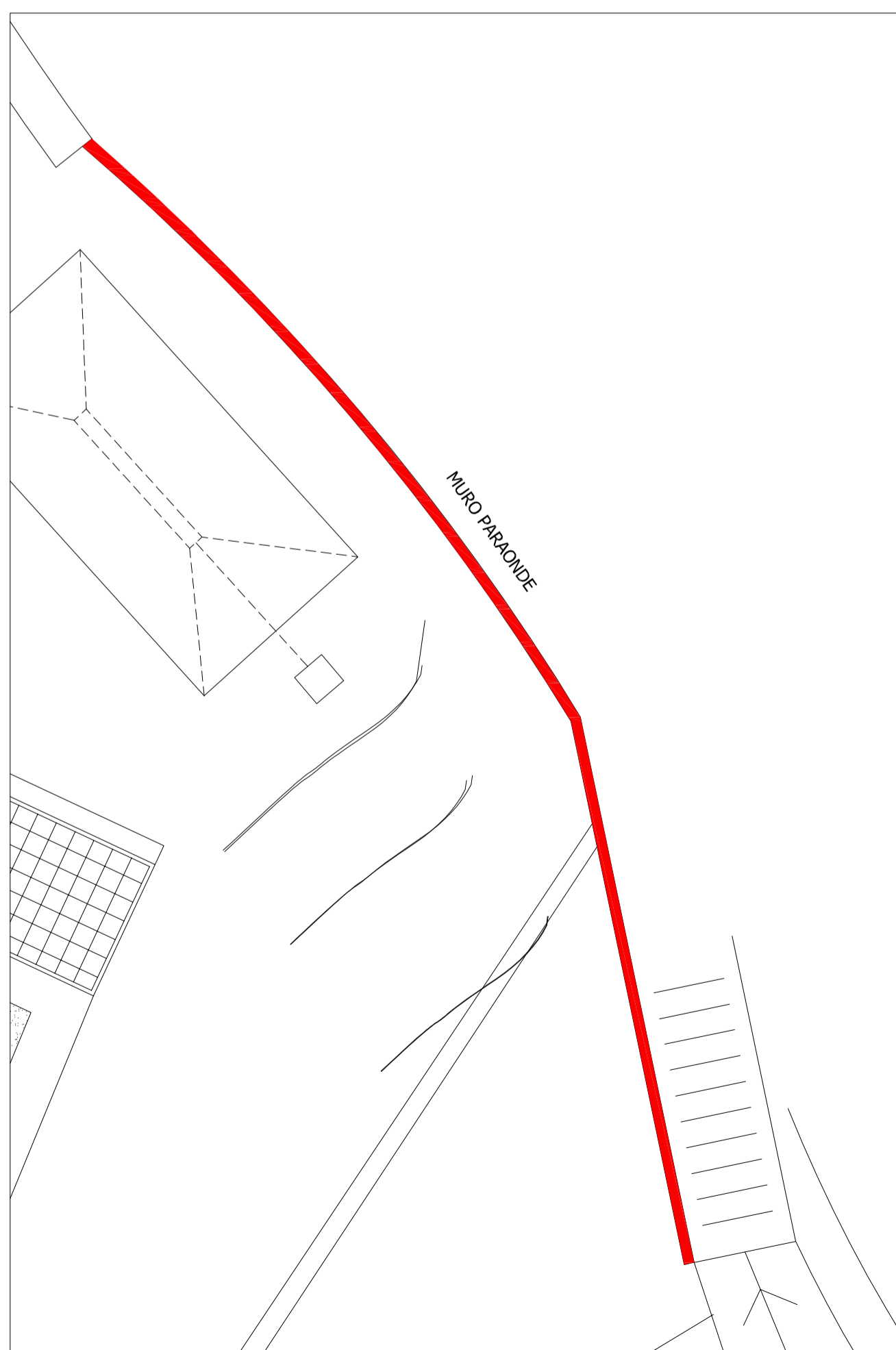

Prolungamento muro paraonde  
Part.B - rapp. 1:500

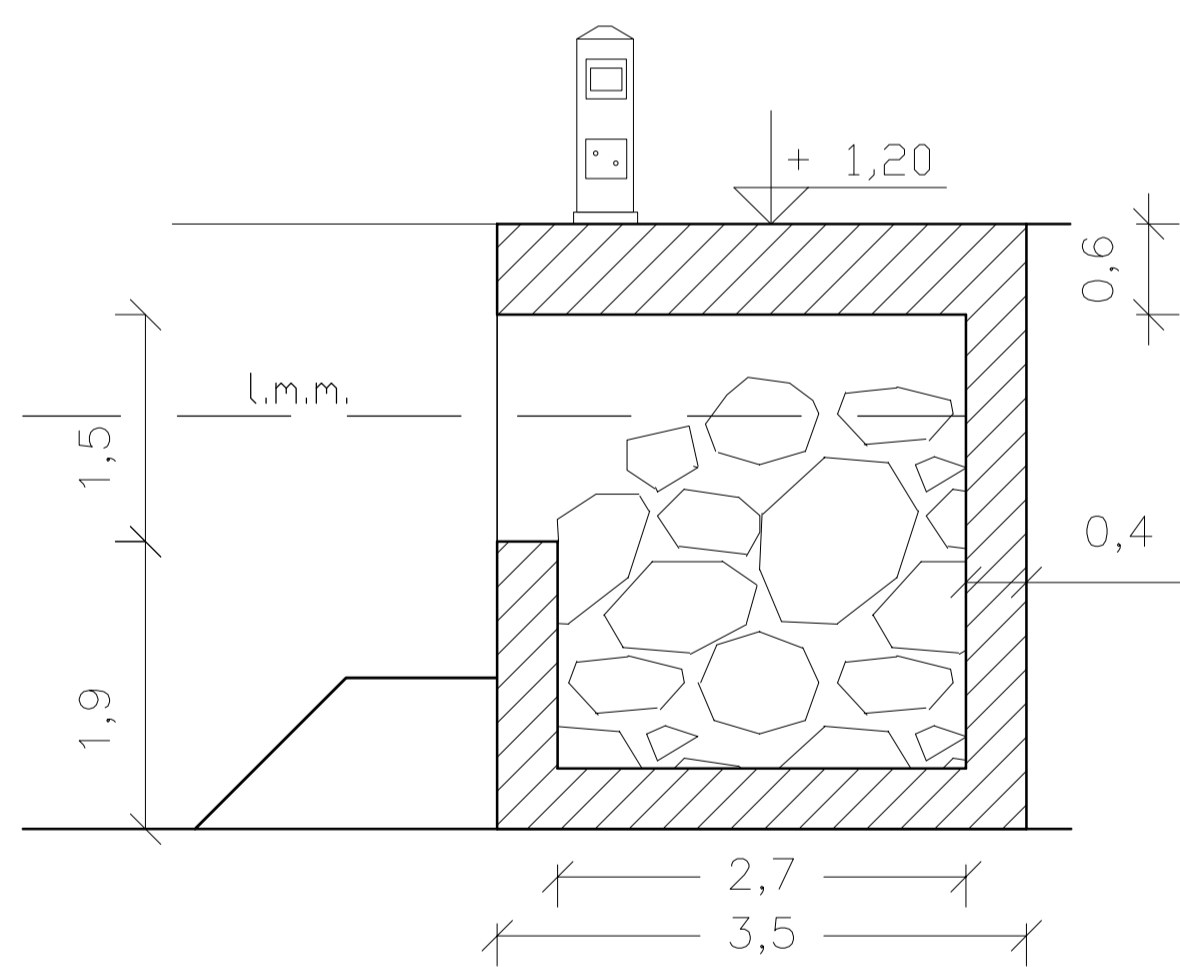

Sez.A-A' - rapp. 1:50

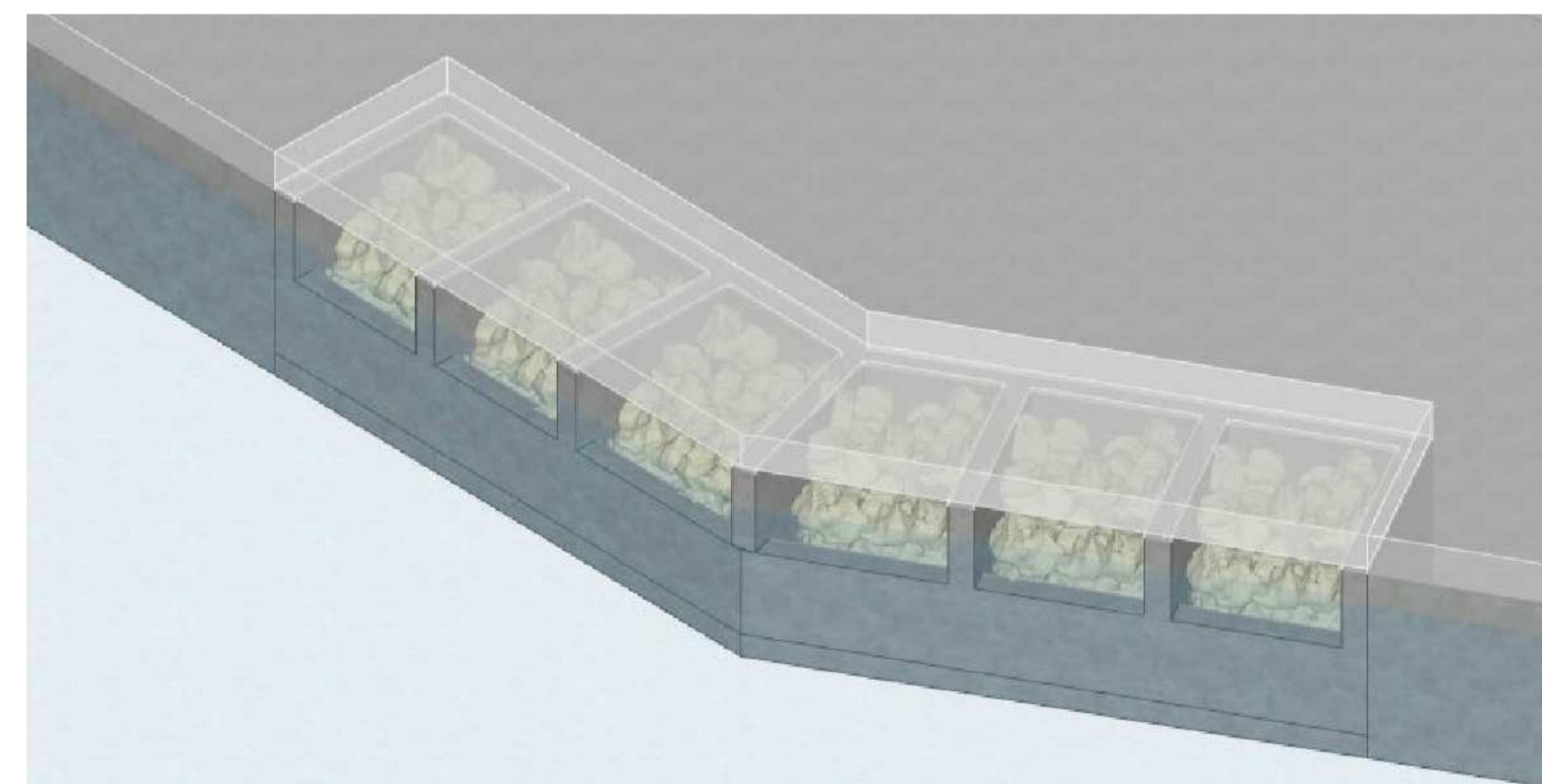

n6. Cassoni assorbenti  
molo sottoflutto

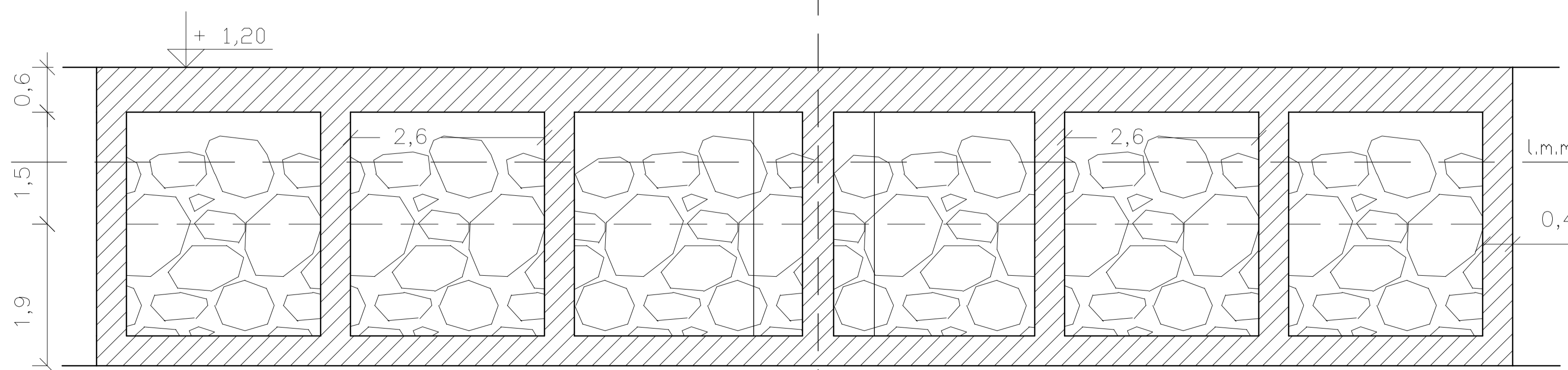

Sez.B-B' - rapp. 1:50

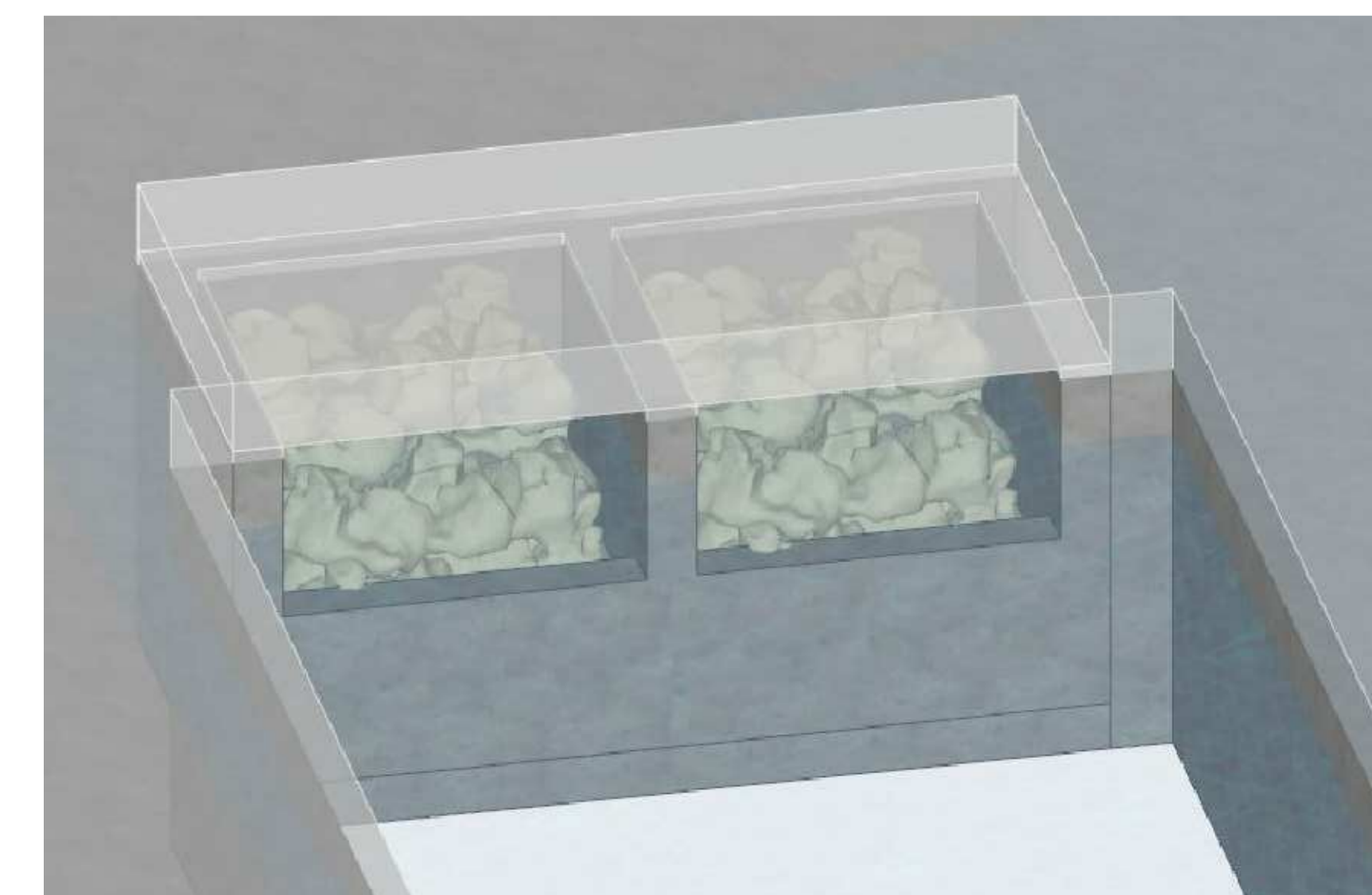

n.2 Cassoni assorbenti