

S-L0 NODI I1-I10  
1 : 5

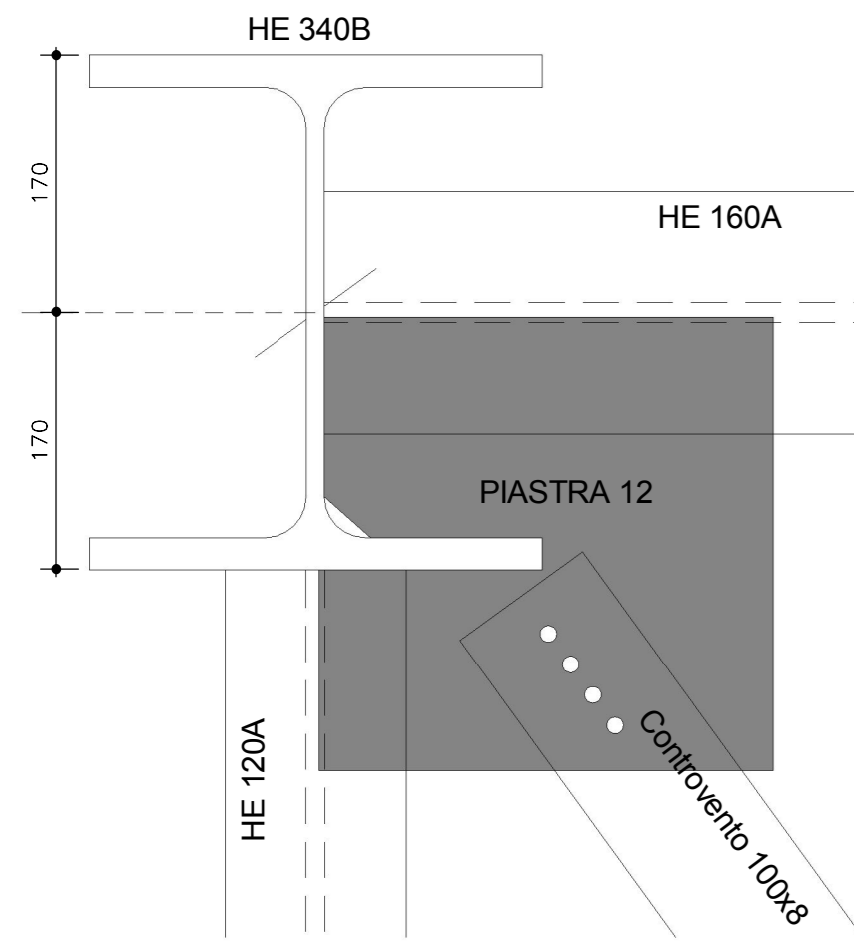

S-L0 NODI I3-I4-I6-I8  
1 : 5

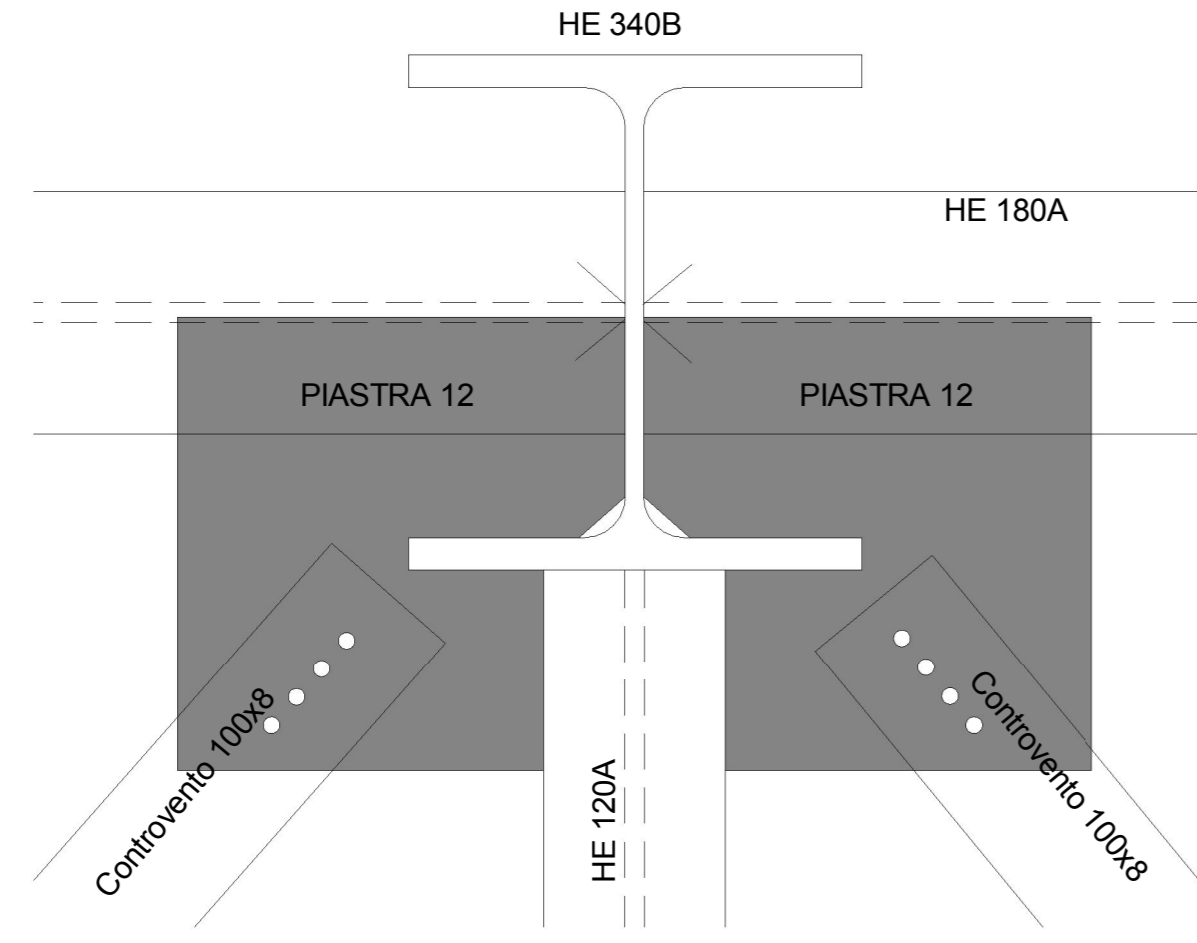

S-L0 NODI I2-I5-I7-I9  
1 : 5

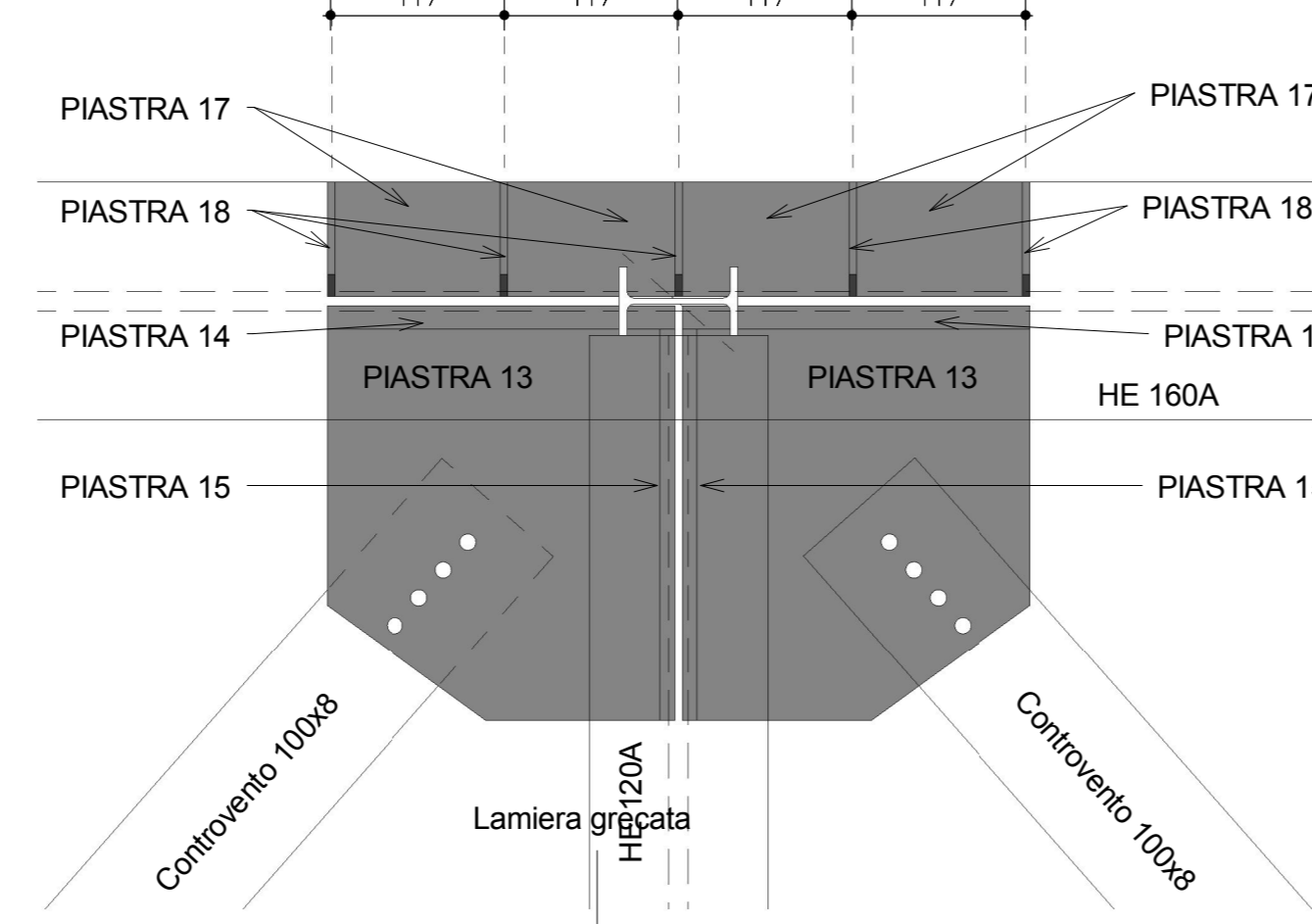

S-L0 NODI I11-I21  
1 : 5

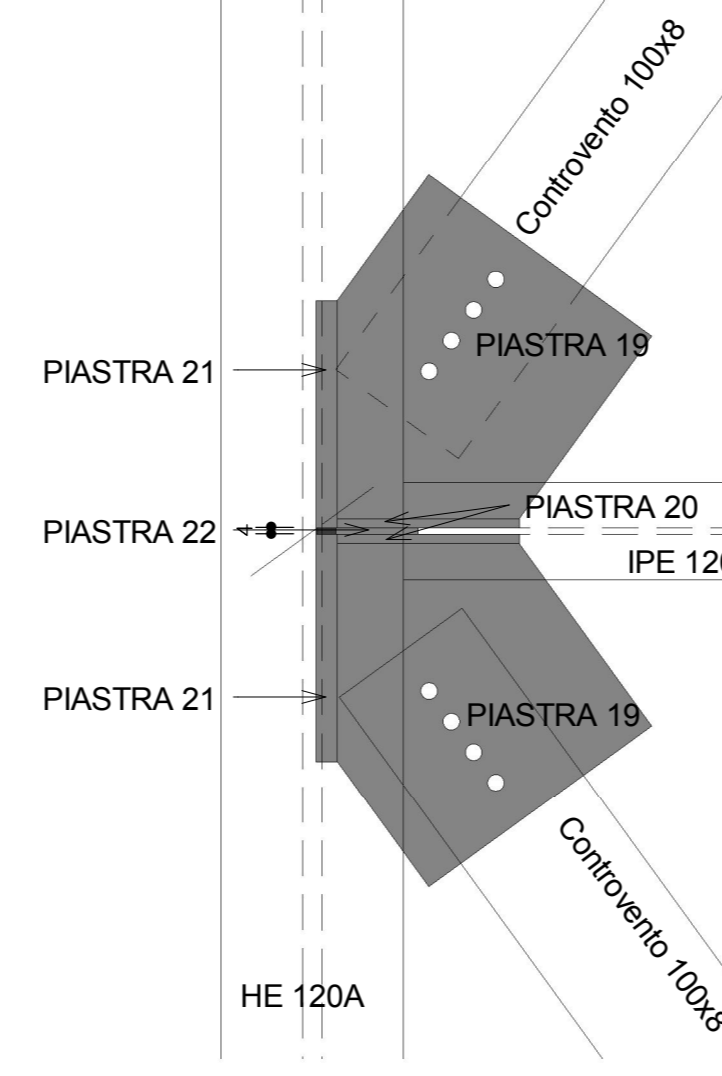

S-L0 NODI I12-I20  
1 : 5

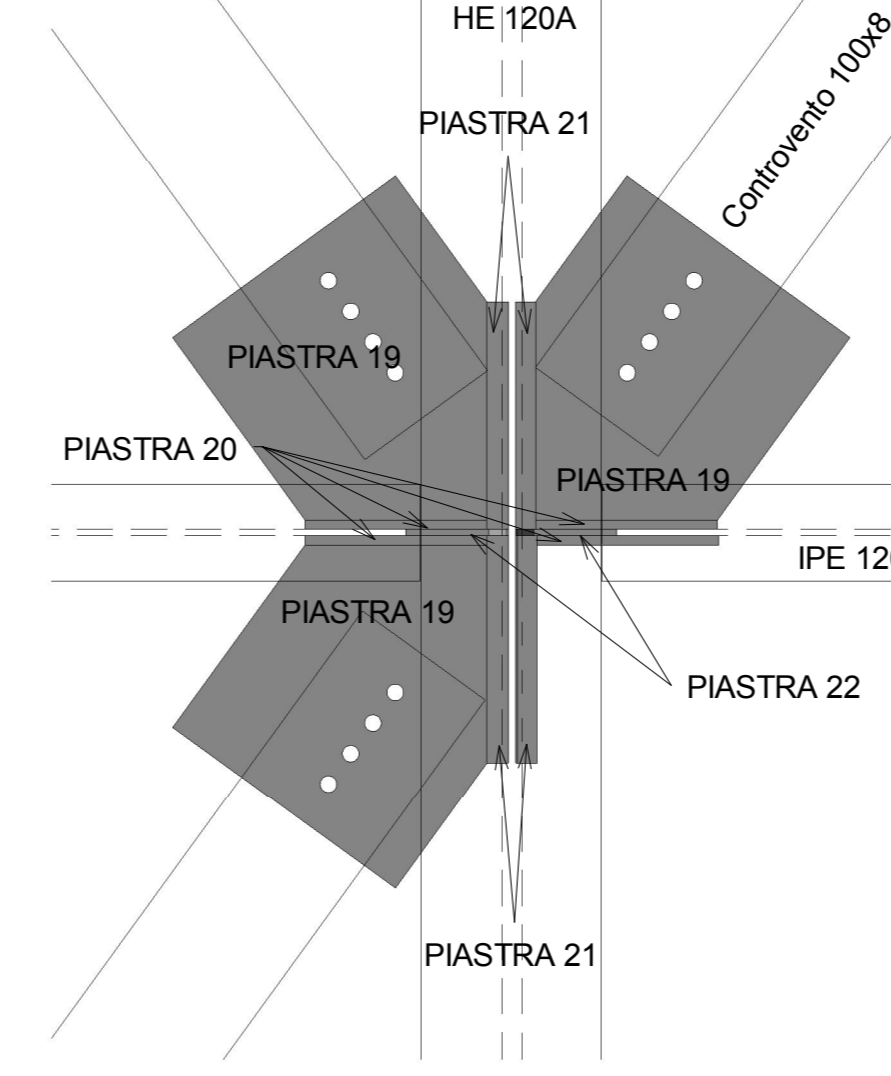

S-L0 NODI I13-I14-I15-I16-I17-I18-I19  
1 : 5

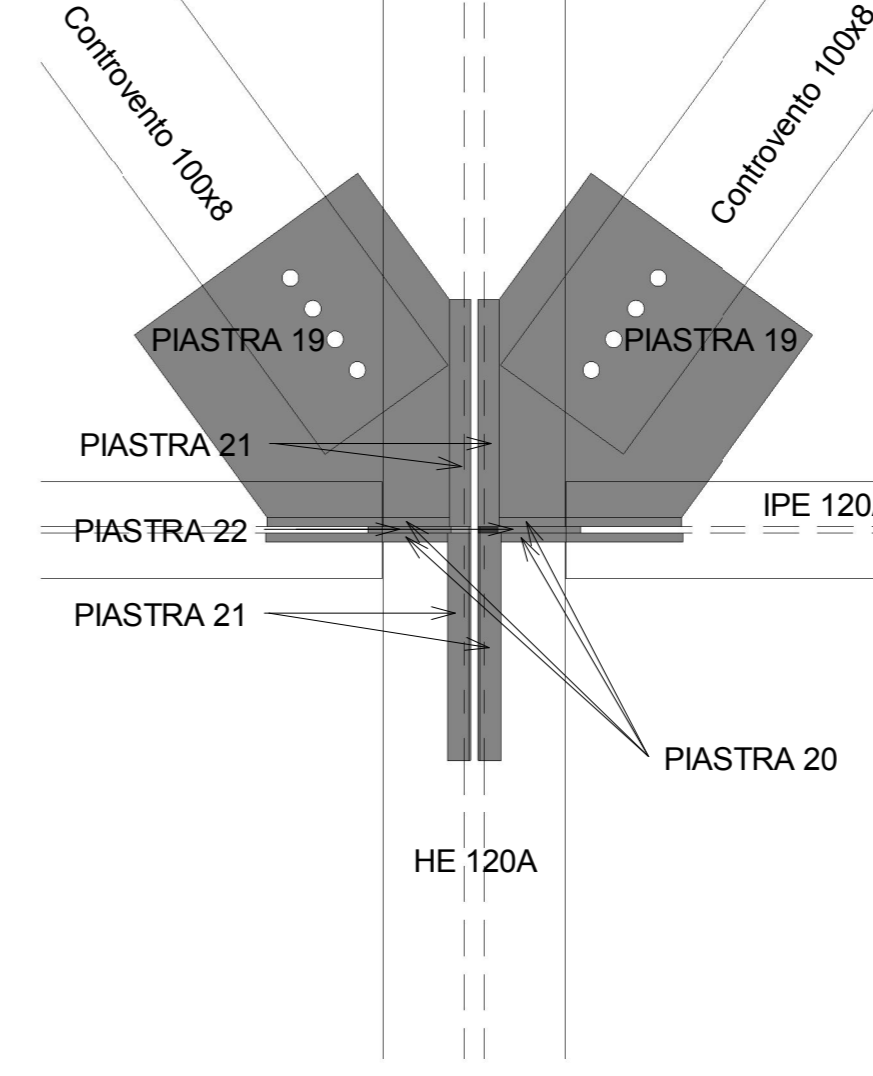

S-L0 NODI I22-I24  
1 : 5

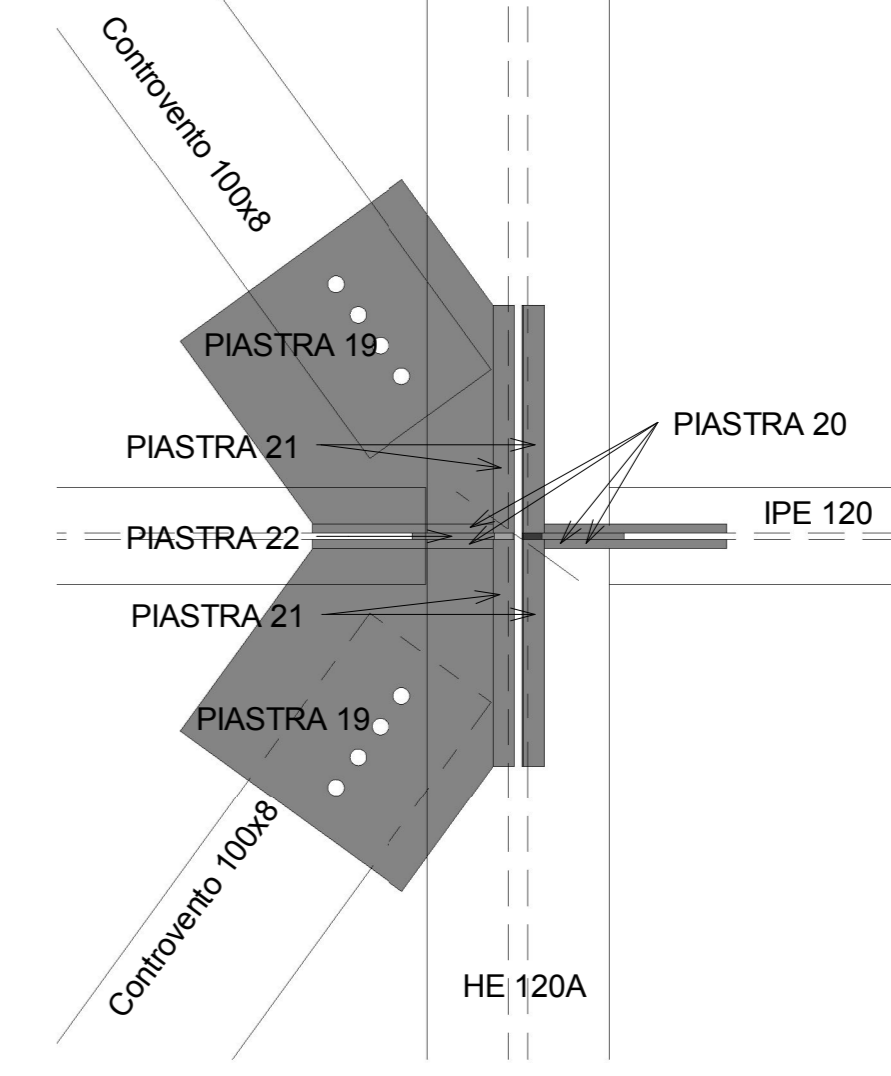

S-L0 NODI I23  
1 : 5

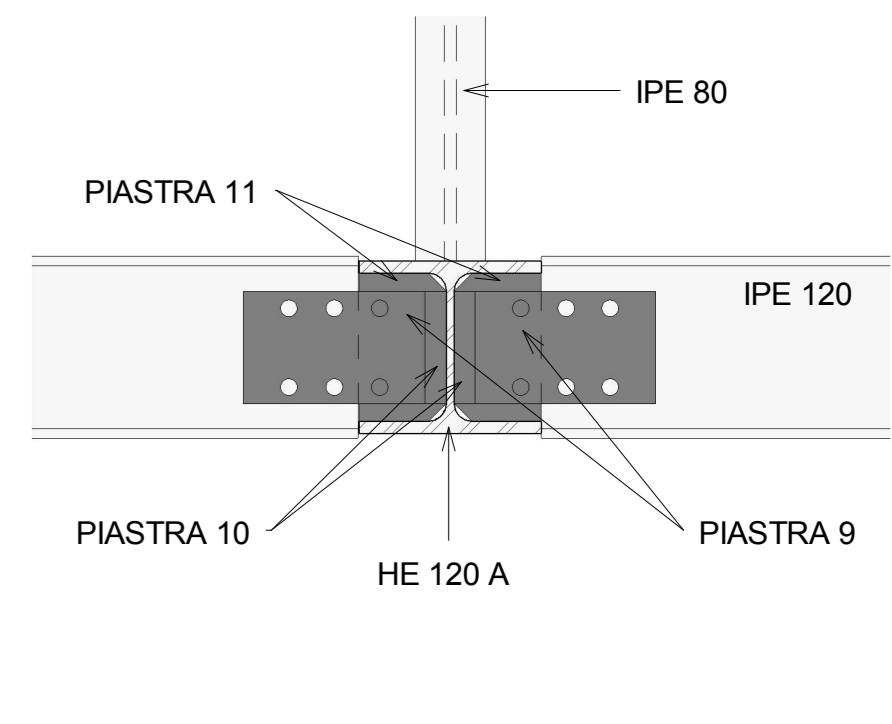
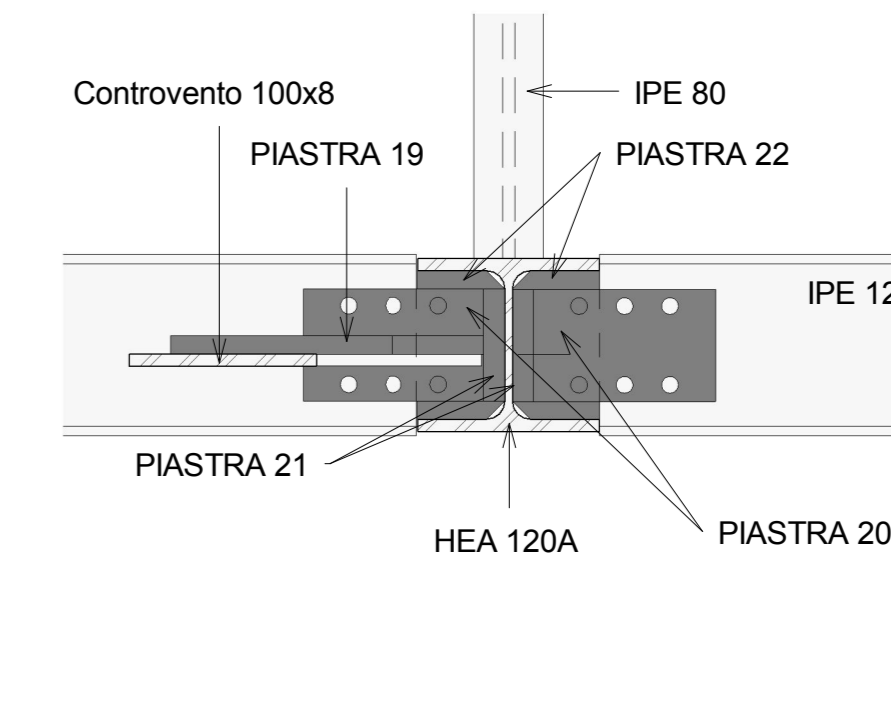
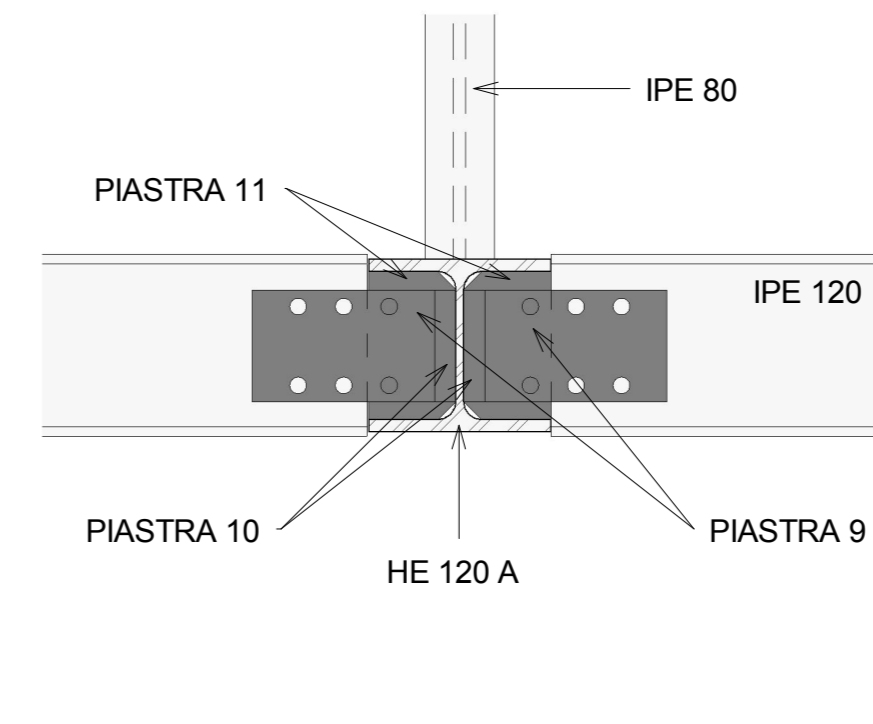
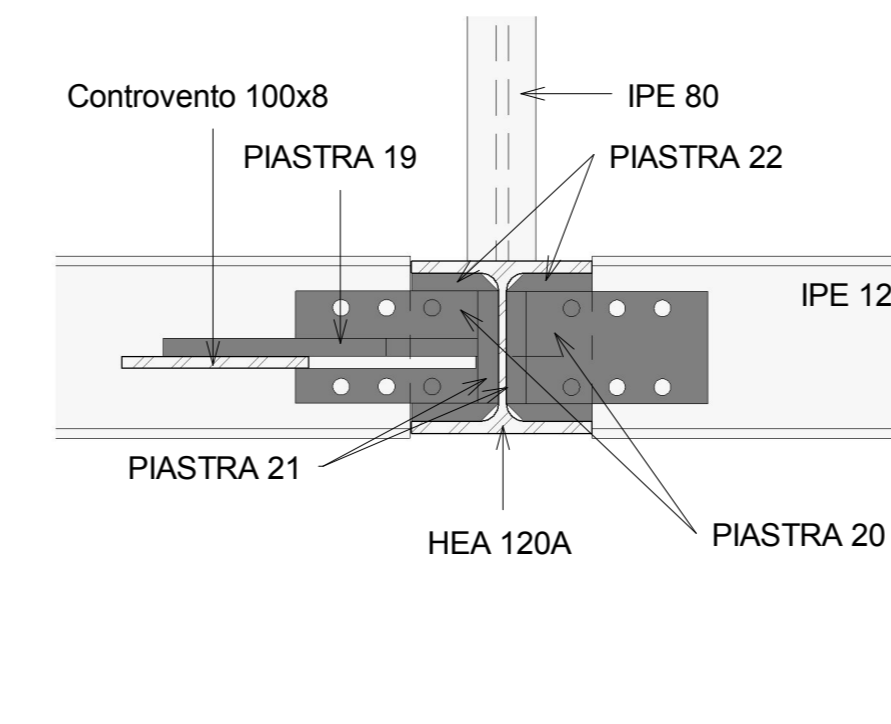
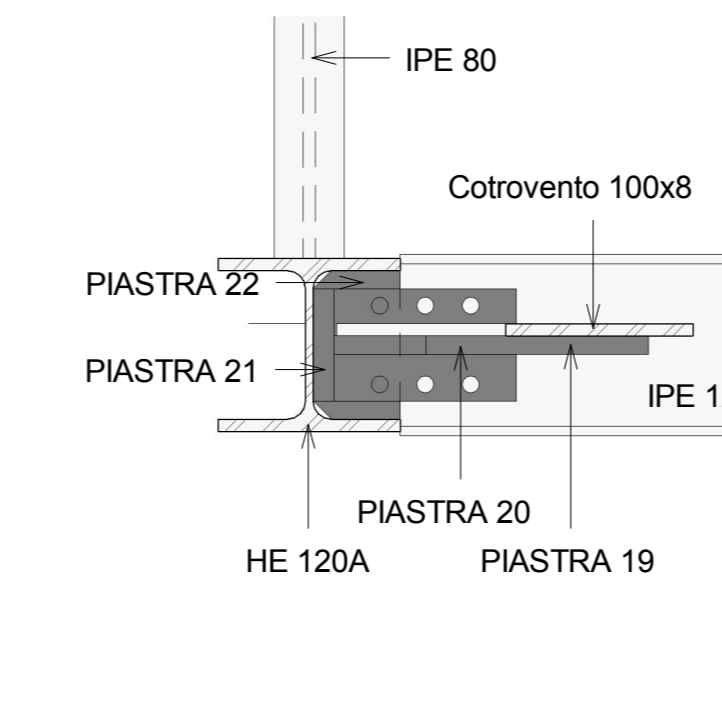
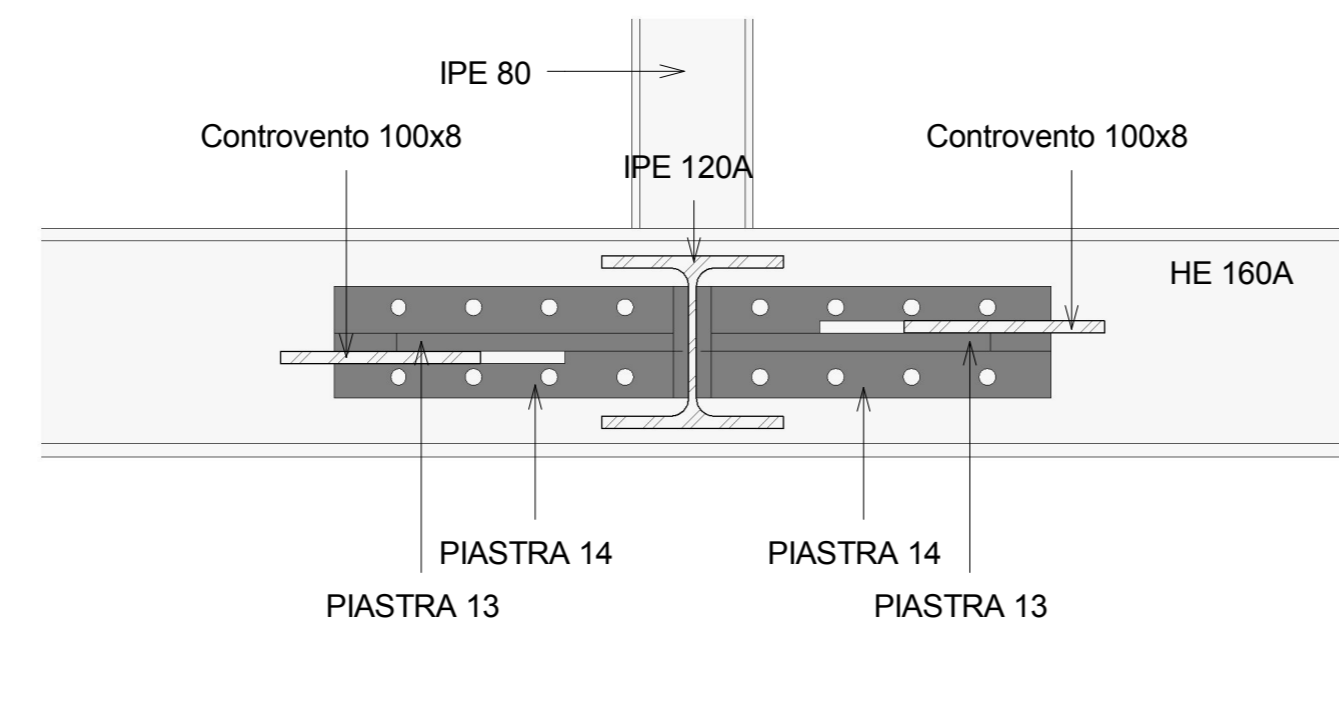
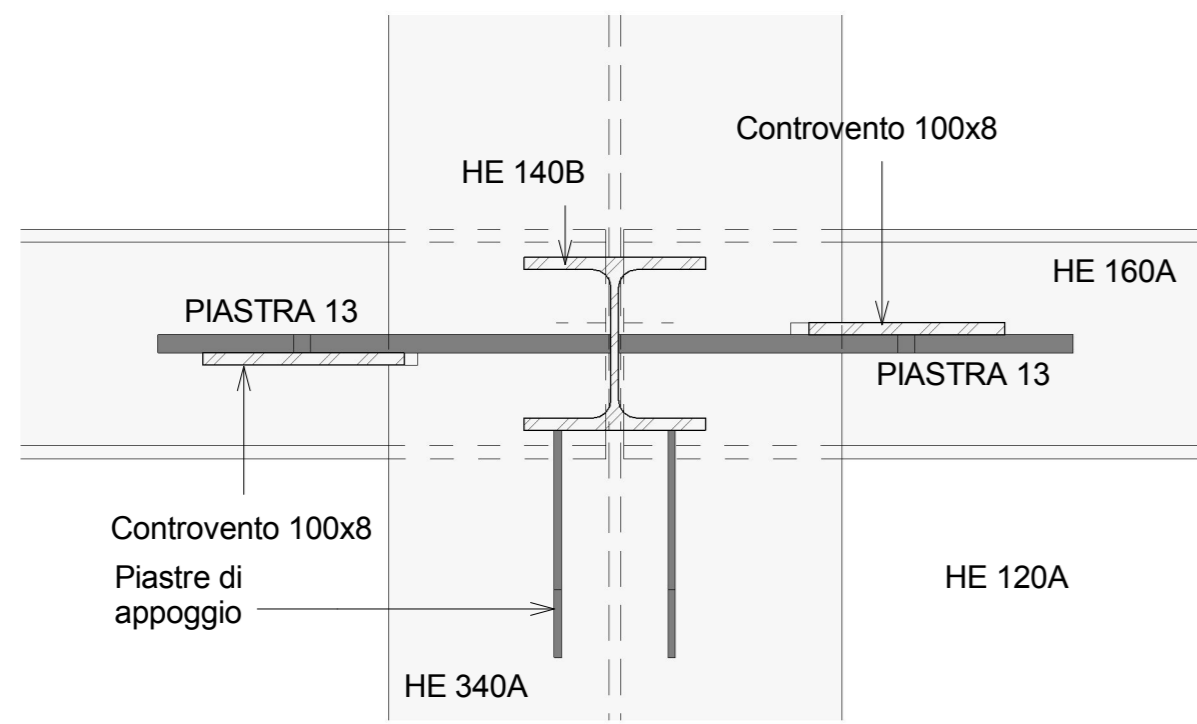
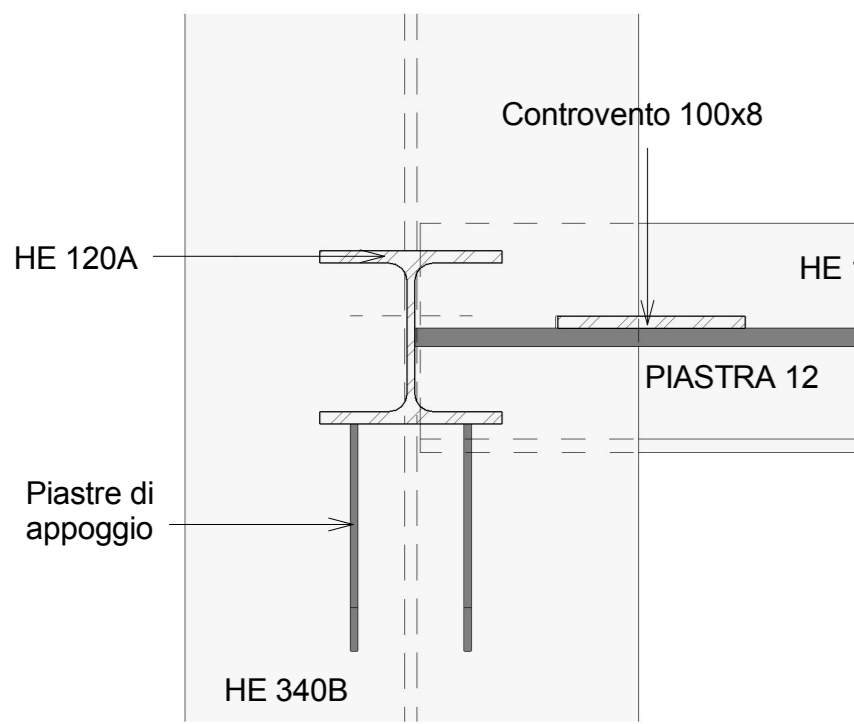
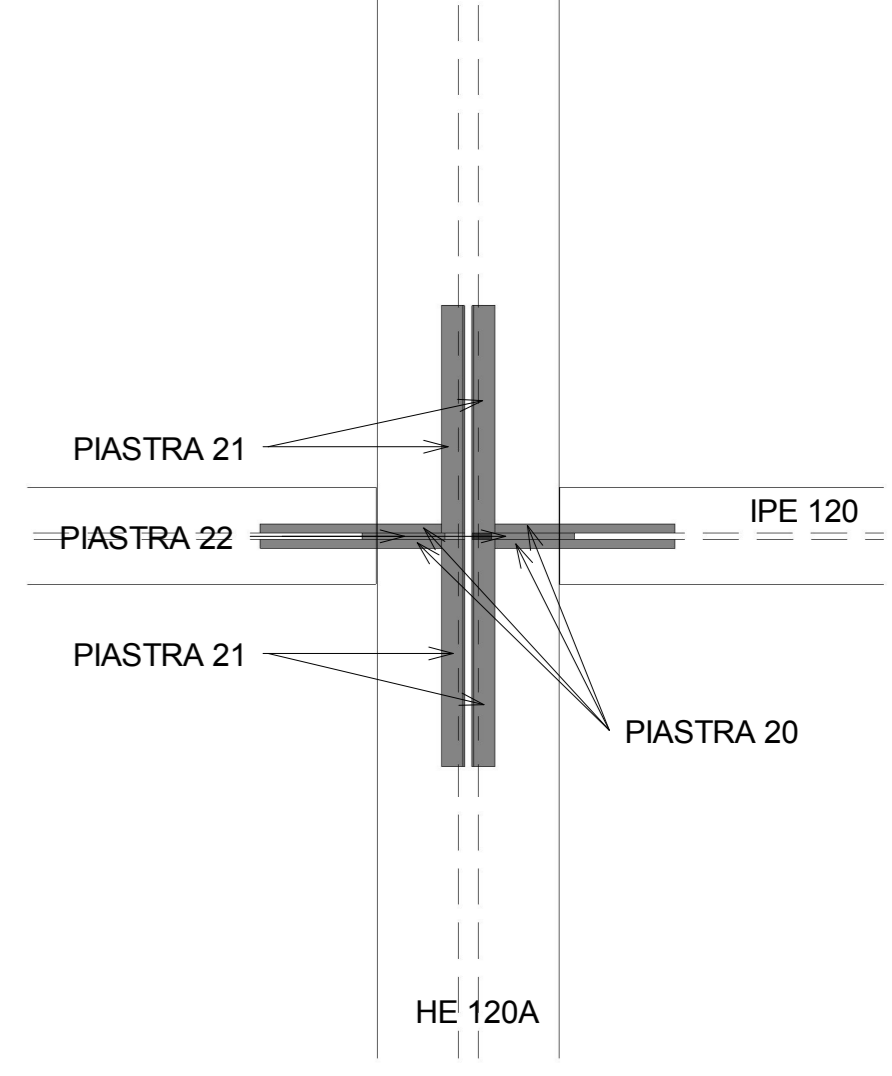

S-NODI I1-I10  
1 : 5

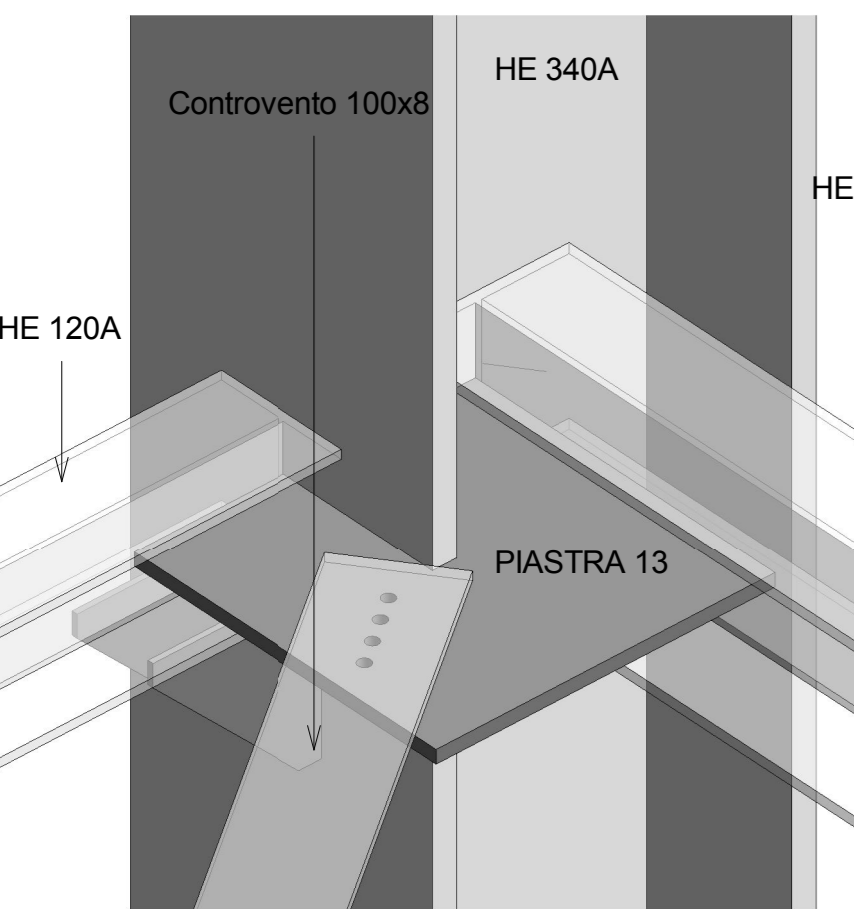

S-NODI I3-I4-I6-I8  
1 : 5

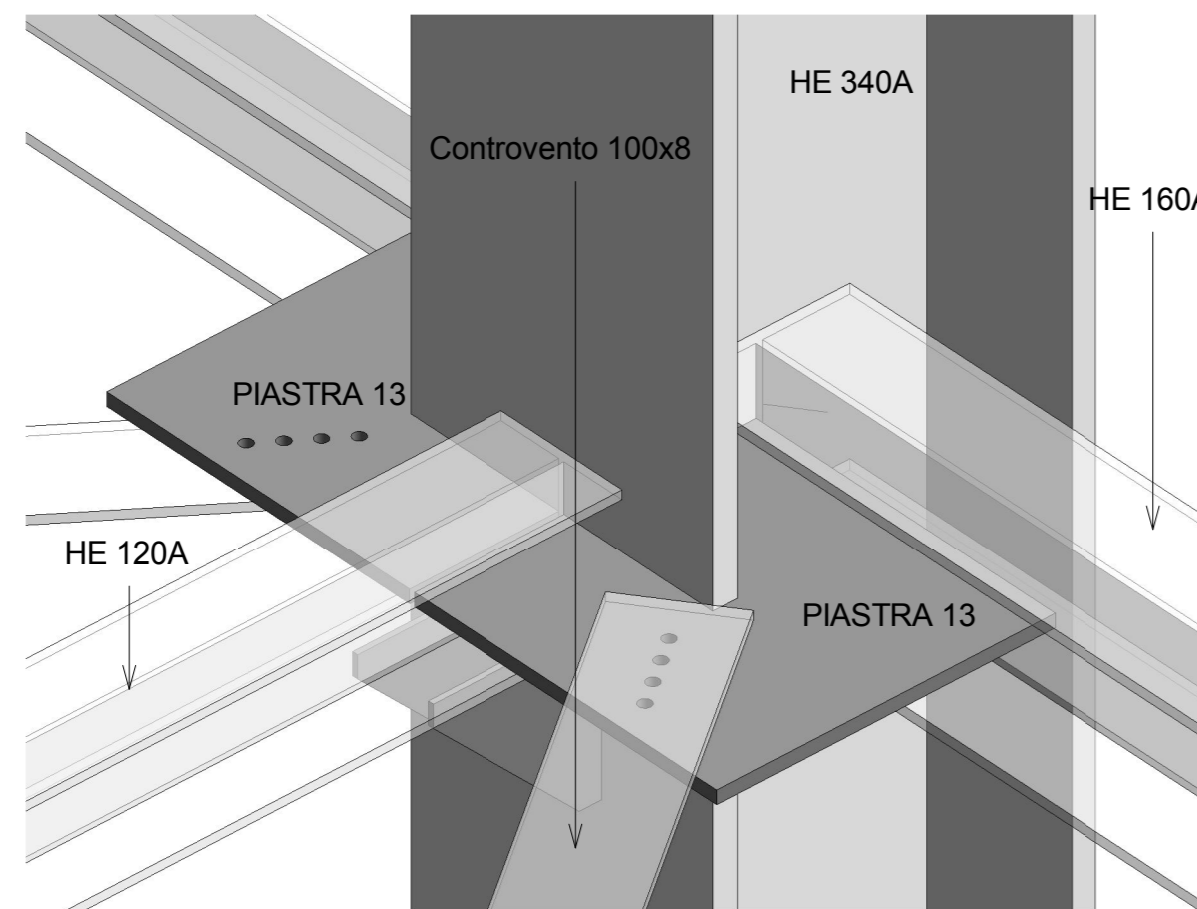

S-NODI I2-I5-I7-I9  
1 : 5

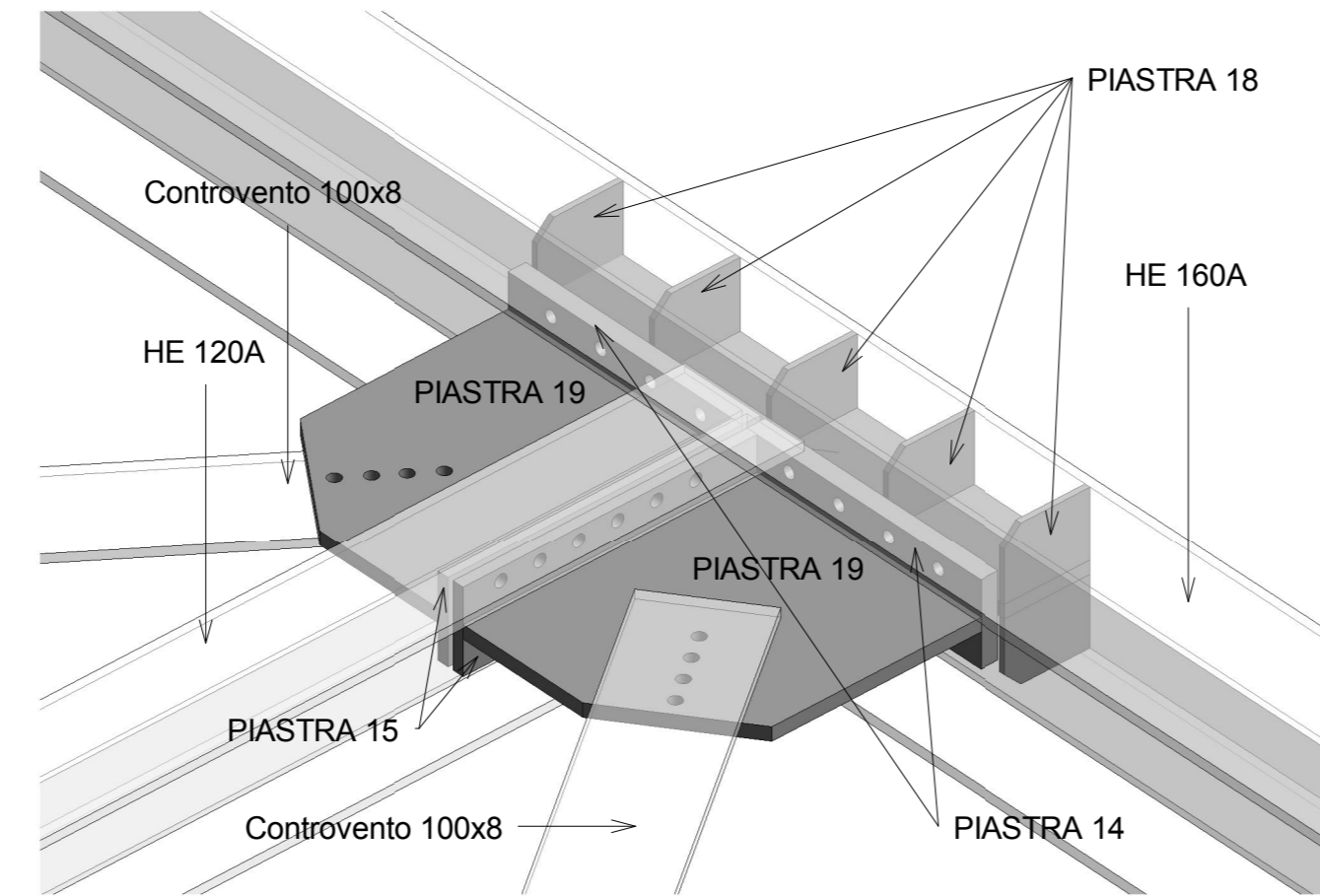

S-NODI I11-I21  
1 : 5

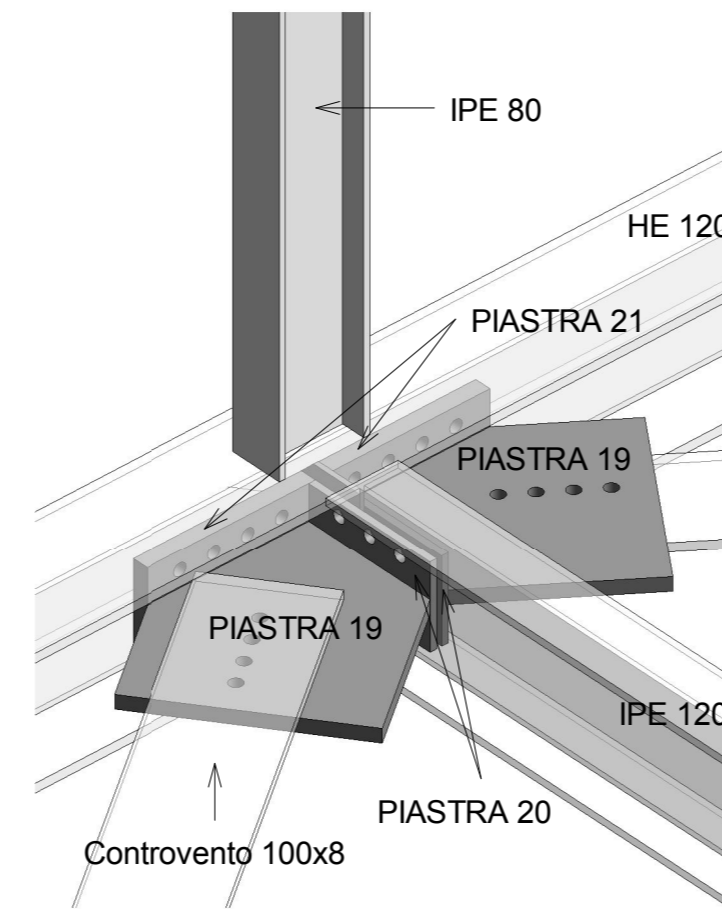

S-NODI I12-I20  
1 : 5

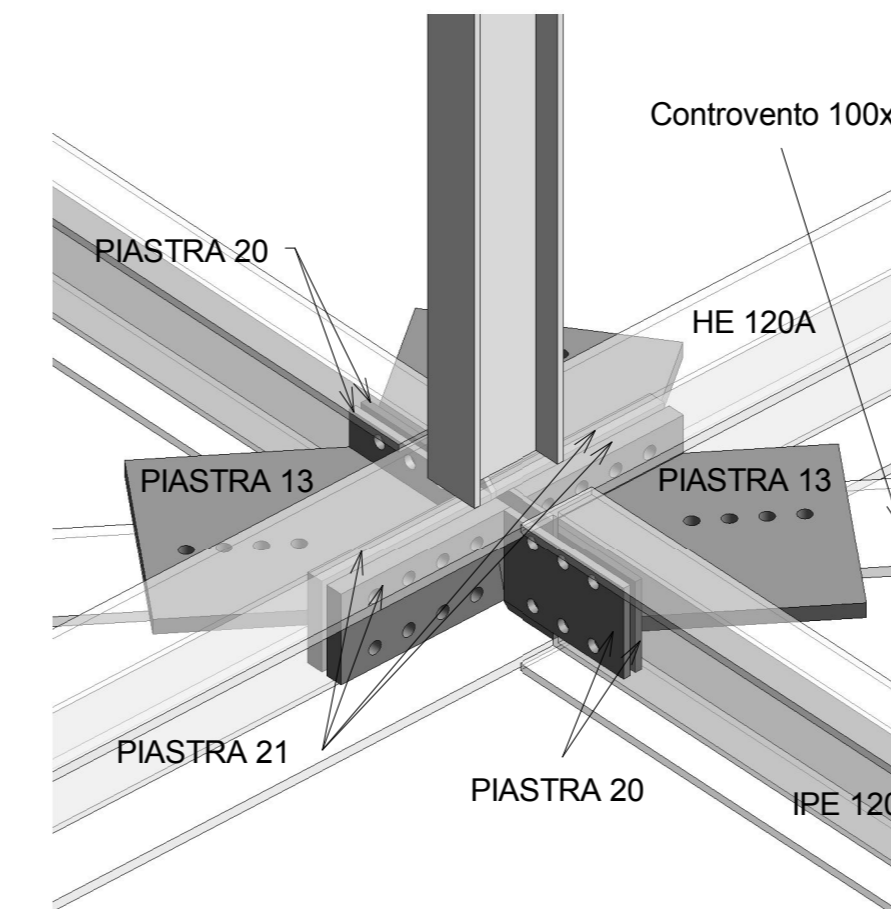

S-NODI I13-I14-I15-I16-I17-I18-I19  
1 : 5

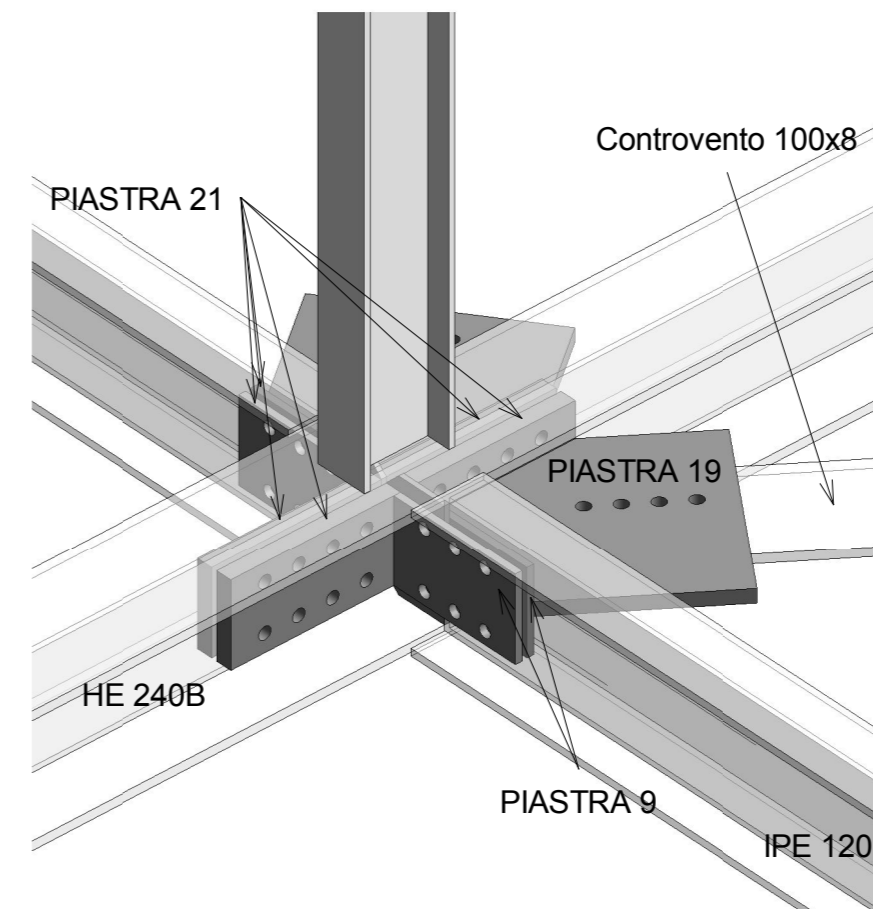

S-NODI I22-I24  
1 : 5

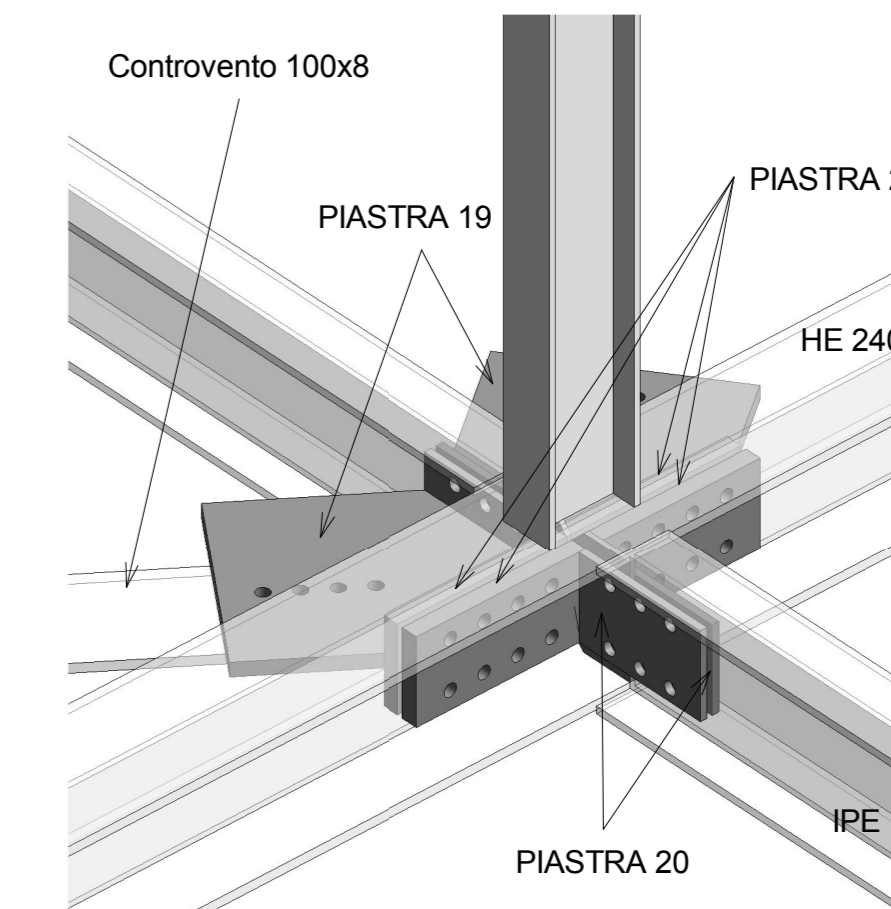

S-NODI I23  
1 : 5

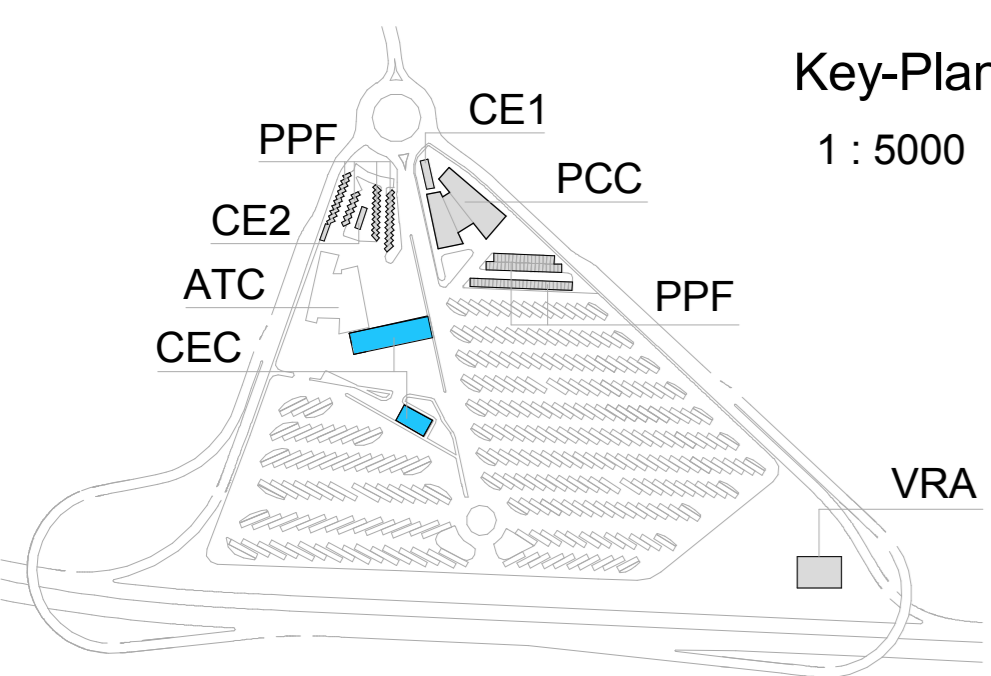
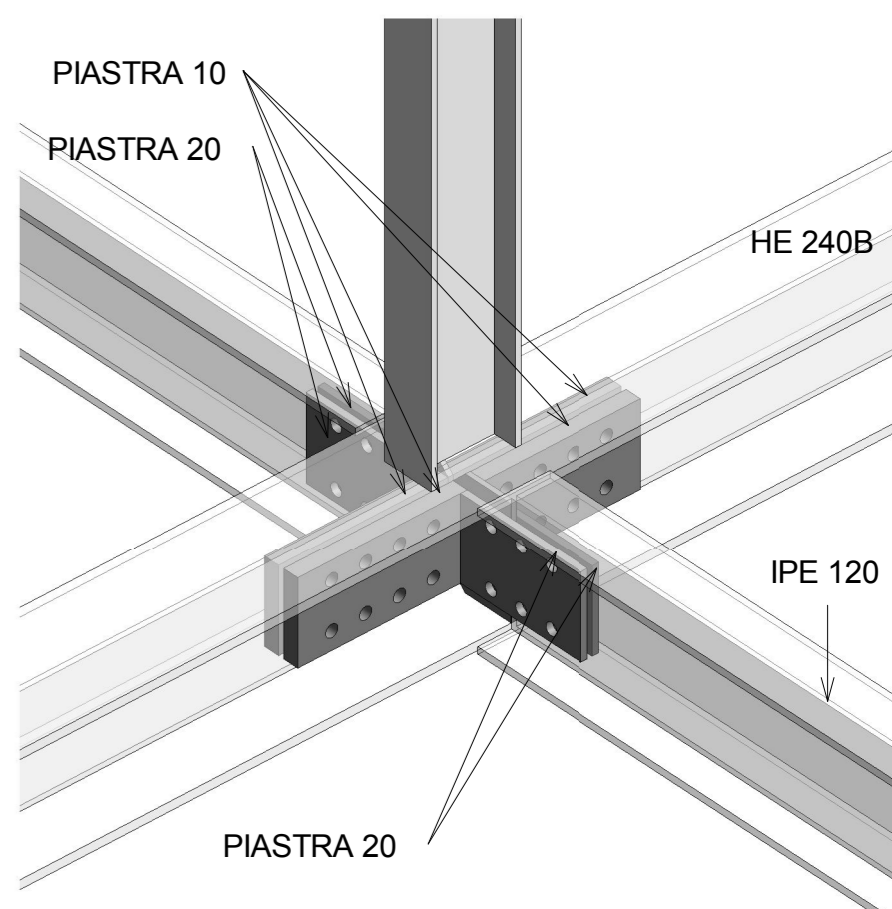

Key-Plan  
1 : 5000

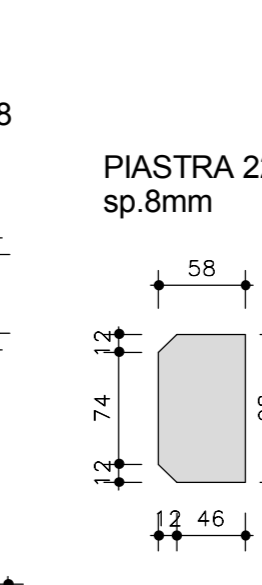
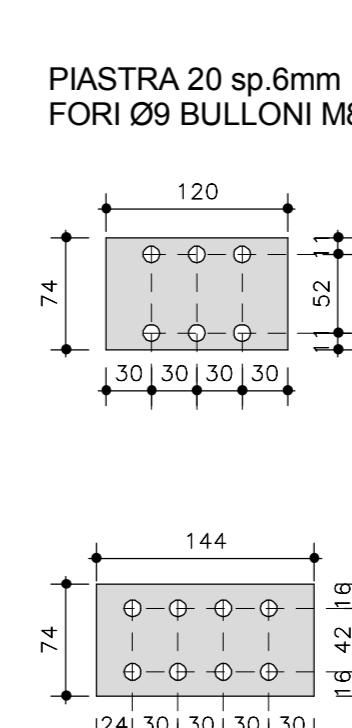
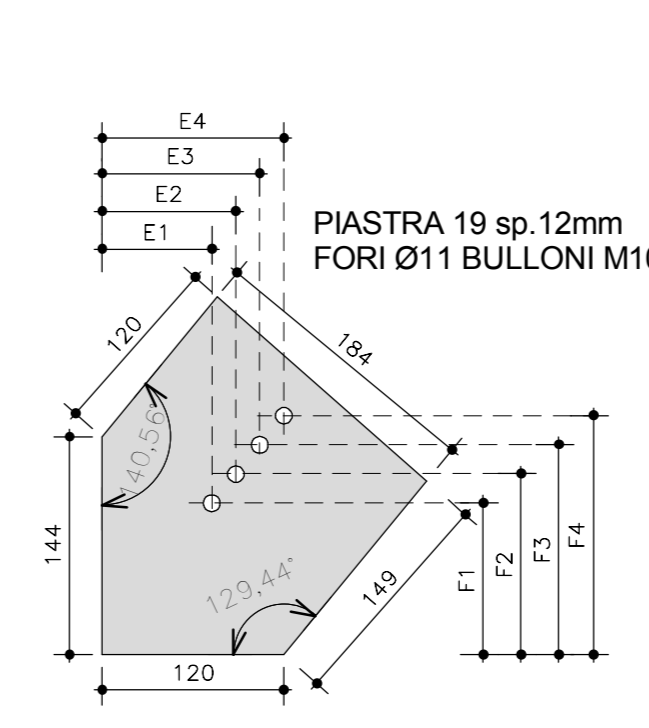
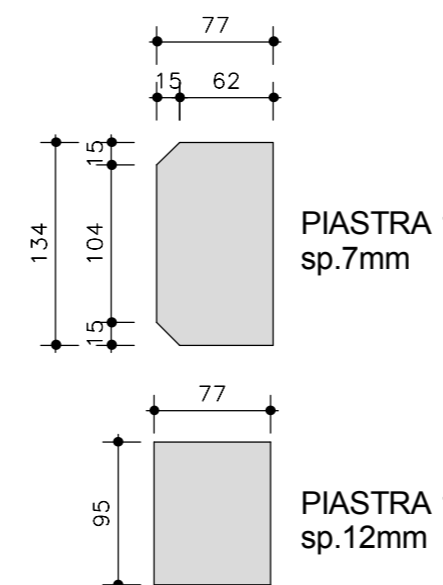
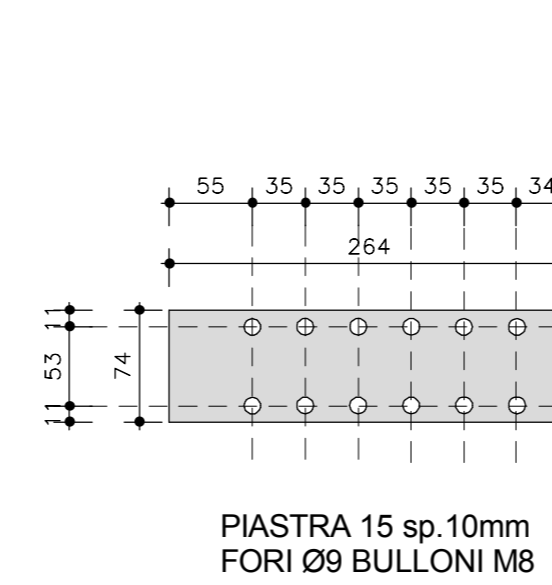
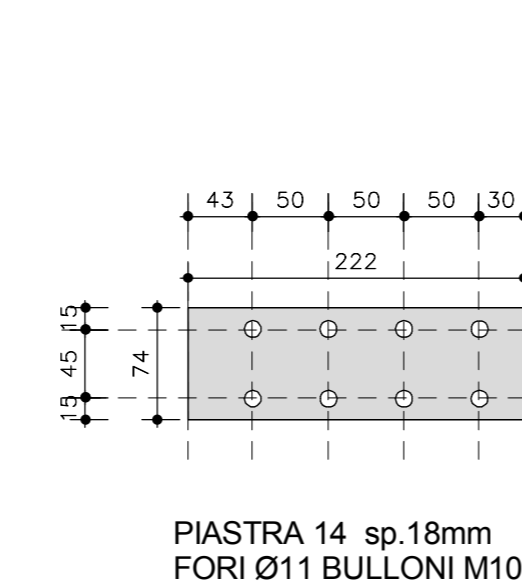
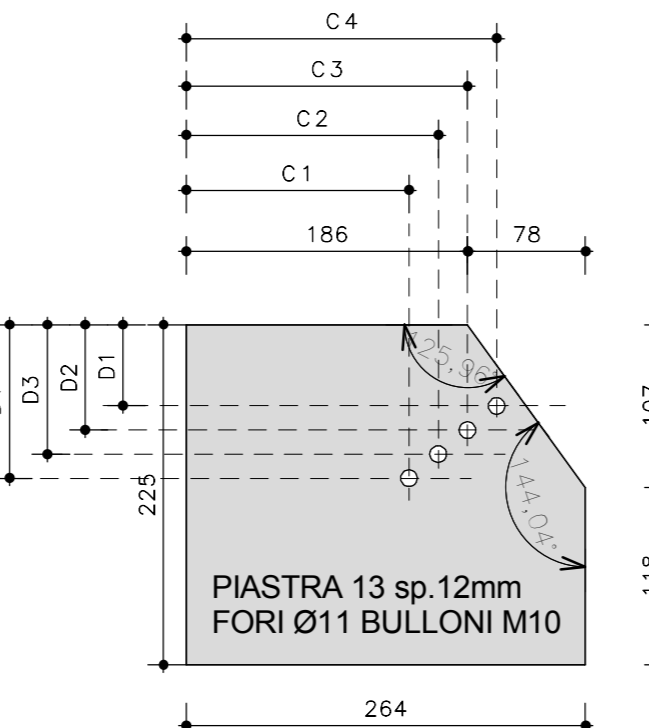
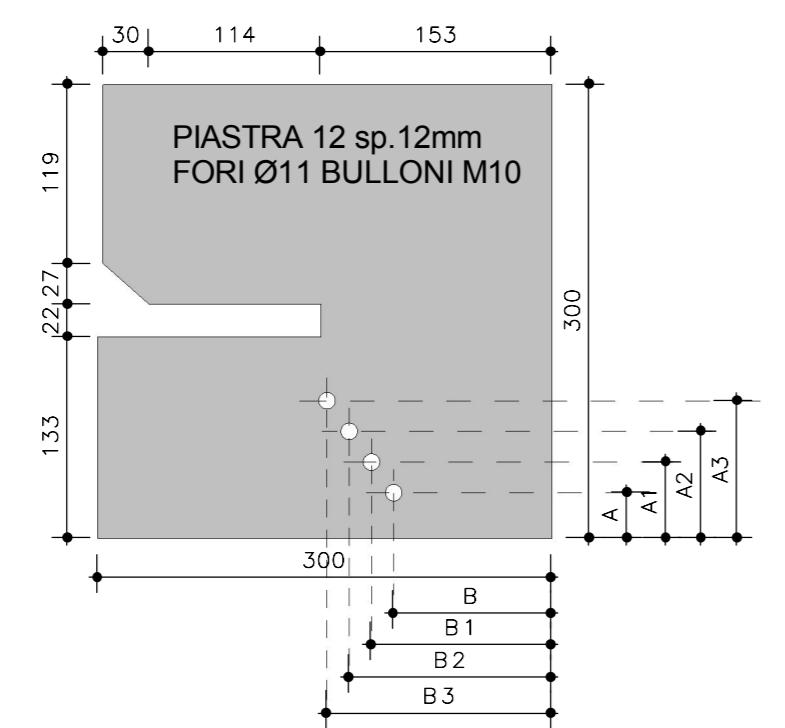

ELEMENTO STRUTTURALE	CLASSE R <sub>ck</sub> / N/mm <sup>2</sup>	CLASSE DI COPRIFERRO ESPOSIZ.	DIAM. MAX. A.C.	RAPP. A.C.	CLASSE DI CONSIST.
SOTTOFONDAZIONI	C12/15	15	-	-	-
FONDAZIONI	C25/30	30	XC2	40	S4
ELEMENTI PREFABBRICATI	C45/55	55	XC1	25	S4
ELEVAZIONI GETTATE IN OPERA	C28/35	35	XC1XC3	40	S4

**ACCIAIO PER C.A.**  
- IN BARRE B450 C CONTROLATO IN STABILIMENTO  
- R.E S CLASSE B 450 C

**ACCIAIO PER CARPENTERIA METALLICA - PROFILI COMMERCIALI**  
- ACCIAIO TIPO S275J0  
- LIMITE DI SNERVAMENTO f<sub>y</sub> > 275 N/mm<sup>2</sup>  
- LIMITE DI ROTTURAZIONE F<sub>t</sub> > 430 N/mm<sup>2</sup>

**ACCIAIO PER CARPENTERIA METALLICA - PIASTRE DI NODI SALDATI O IMBULLONATI**  
- ACCIAIO TIPO S355J0  
- LIMITE DI SNERVAMENTO f<sub>y</sub> > 355 N/mm<sup>2</sup>  
- LIMITE DI ROTTURAZIONE F<sub>t</sub> > 510 N/mm<sup>2</sup>

**UNIONI**  
- BULLONI AD ALTA RESISTENZA CLASSE 8.8  
- DOVE NON DIVERSAMENTE SPECIFICATO LE SALDATURE SONO DA INTENDERSI A COMPLETA PENETRAZIONE

I MATERIALI E I COPRIFERRI INDICATI IN TABELLA SODDISFANO, DOVE NECESSARIO, I REQUISITI DI RESISTENZA AL FUOCO. LA CUI VERIFICA È RIPORTATA NELLE RISPETTIVE RELAZIONI DI CALCOLO

**NOTE GENERALI**  
- TUTTE LE MISURE SONO ESPRESSE IN MILLIMETRI  
- TUTTI GLI ANGOLI SONO ESPRESSE IN GRADI DECIMALI  
- DOVE NON DIVERSAMENTE SPECIFICATO SOVRAPPORZIONE MINIMA DELLE BARRE PARI A 70 diam.  
- DOVE NON DIVERSAMENTE SPECIFICATO SI PRESCRIVONO I SEGUENTI DIAMETRI MINIMI DI PIEGATURA:

DIAM. BARRA	DIAMETRO MINIMO DI PIEGATURA
> 16mm	7 diam.
< 16mm	4 diam.

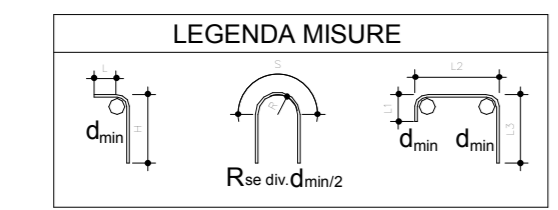

- LE DIMENSIONI INDICATE PER LA SAGOMA DELLE ARMATURE SONO RIFERITE ALL'ASSE BARRA

ABACO DIMENSIONI PIASTRA 12									
Controssegno	CAMPATA TIPO	A	A1	A2	A3	B	B1	B2	B3
Nodo "11"	A	30	50	70	91	104	119	134	149
Nodo "13"	A	30	50	70	91	104	119	134	149
Nodo "14"	B	30	50	70	90	97	112	127	142
Nodo "14"	A	30	50	70	91	104	119	134	149
Nodo "16"	C	30	49	68	86	62	79	95	112
Nodo "16"	B	30	50	70	90	97	112	127	142
Nodo "18"	C	30	49	68	86	62	79	95	112
Nodo "18"	D	30	50	69	88	78	94	110	126
Nodo "110"	D	30	50	69	88	78	94	110	126

ABACO DIMENSIONI PIASTRA 13							
Controssegno	CAMPATA TIPO	C1	C2	C3	C4	D1	D2
Nodo "12"	A	155	175	196	216	66	80
Nodo "15"	B	152	172	192	212	61	76
Nodo "17"	C	143	162	180	199	46	63
Nodo "19"	D	147	166	186	205	54	70

ABACO DIMENSIONI PIASTRA 19									
Controssegno	CAMPATA TIPO	E1	E2	E3	E4	F1	F2	F3	F4
Nodo "11"	A	61	75	90	105	97	118	138	158
Nodo "12"	A	61	75	90	105	97	118	138	158
Nodo "13"	A	61	75	90	105	97	118	138	158
Nodo "14"	A	61	75	90	105	97	118	138	158
Nodo "14"	B	66	81	96	111	101	121	141	161
Nodo "15"	B	66	81	96	111	101	121	141	161
Nodo "16"	B	66	81	96	111	101	121	141	161
Nodo "16"	C	77	93	110	126	97	116	135	154
Nodo "17"	C	77	93	110	126	97	116	135	154
Nodo "18"	C	73	88	104	120	100	119	139	158
Nodo "18"	D	77	93	110	126	97	116	135	154
Nodo "19"	D	73	88	104	120	100	119	139	158
Nodo "20"	D	73	88	104	120	100	119	139	158
Nodo "21"	A	61	75	90	105	97	118	138	158
Nodo "22"	D	73	88	104	120	100	119	139	158

ZONE NODI	
CAMPATA TIPO	DIMENSIONE INTERASSE
A	2800
B	2900
C	3175
D	3400

NOME NODO	NUMERO NODI
11	2
12	12
13	2
14	2
15	4
16	2
17	4
18	2
19	6
110	2
111	3
112	2
113	12
114	2
115	4
116	2
117	4
118	2
119	4
120	2
121	3
122	1
123	15
123	1

LEGENDA SALDATURE  
1 : 100

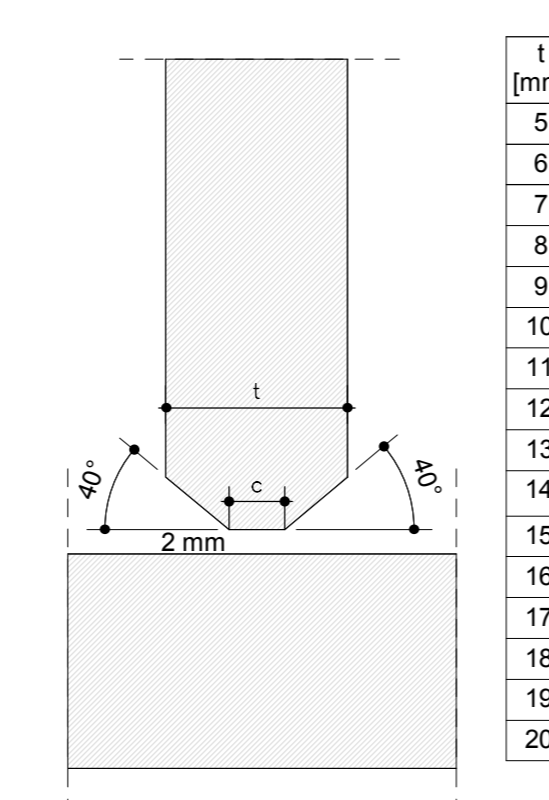

INQUADRAMENTO - NODI INFERIORI  
1 : 150

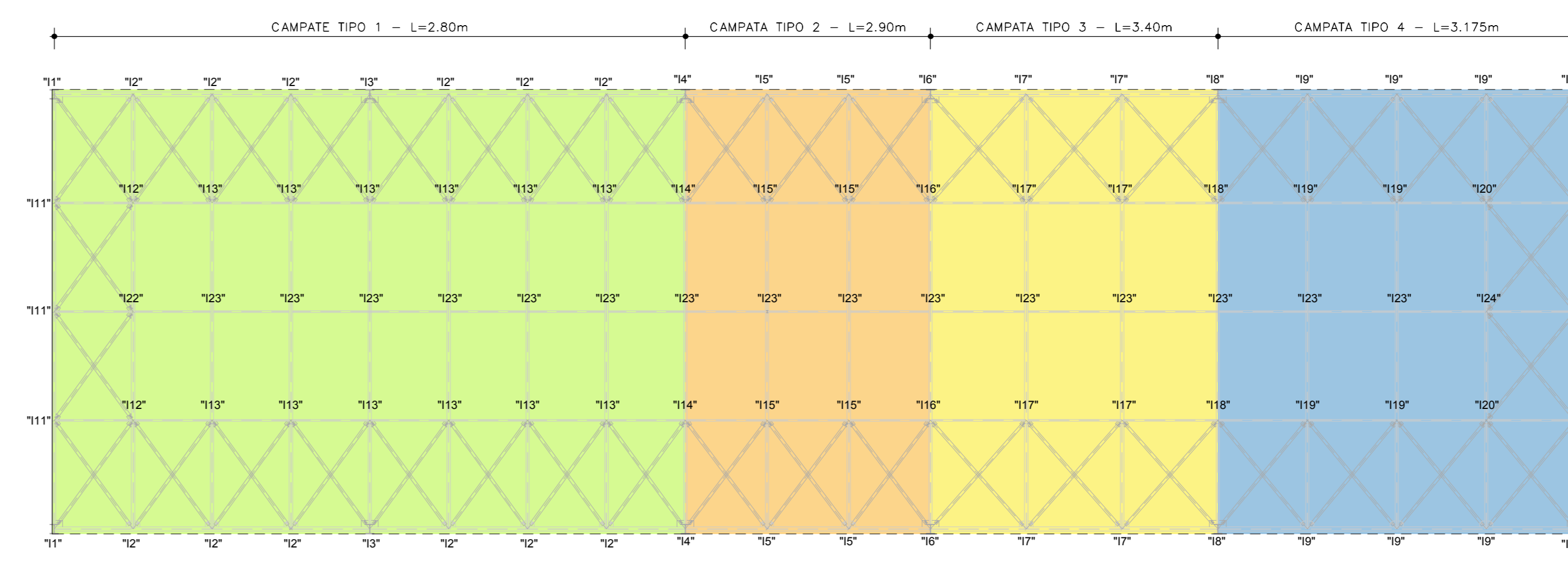

TUNNEL EURALP I - LYON TURIN  
SIATF spa

NUOVA LINEA TORINO LIONE - NOUVELLE LIGNE LYON TURIN  
PARTE COMUNE ITALO-FRANCESE - PARTIE COMMUNE FRANCO-ITALIENNE

LOTTO COSTRUTTIVO 1 LOT DE CONSTRUCTION 1  
CANTIERE OPERATIVO 02C / CHANTIER DE CONSTRUCTION 02C  
RILOCALIZZAZIONE DELL'AUTOPORTO DI SUSA  
DEPLACEMENT DE L'AUTOPORTO DE SUSE  
PROGETTO ESECUTIVO - ETUDES D'EXECUTION  
CUP C11J05000030001 - CIG 682325367F

FABBRICATI  
CEC - CARBURANTI E CASSE  
Pensilina Distributore - Dettagli nodi - Tav.2

MESS	DATA	MODIFICAZIONE	REVISIONE	REVISIONE	REVISIONE
0	30/04/2015	Procedimento di verifica	REDACTA	F. ALBERTI (ING.)	F. DI GIACOMO (ING.)

1 0 2 C C 1 6 1 6 7 F A A 1 0 G EST PL 1 8 2 1 0

SCALA / ECHELLE

IL PROGETTISTA E DESIGNER  
IL PIASTRELLA E IMPRESARIO  
IL DIRETTORE DI LAVORO INTERIORE

TUNNEL EURALP I - LYON TURIN  
SIATF spa