

CARPENTERIA SPALLA 1

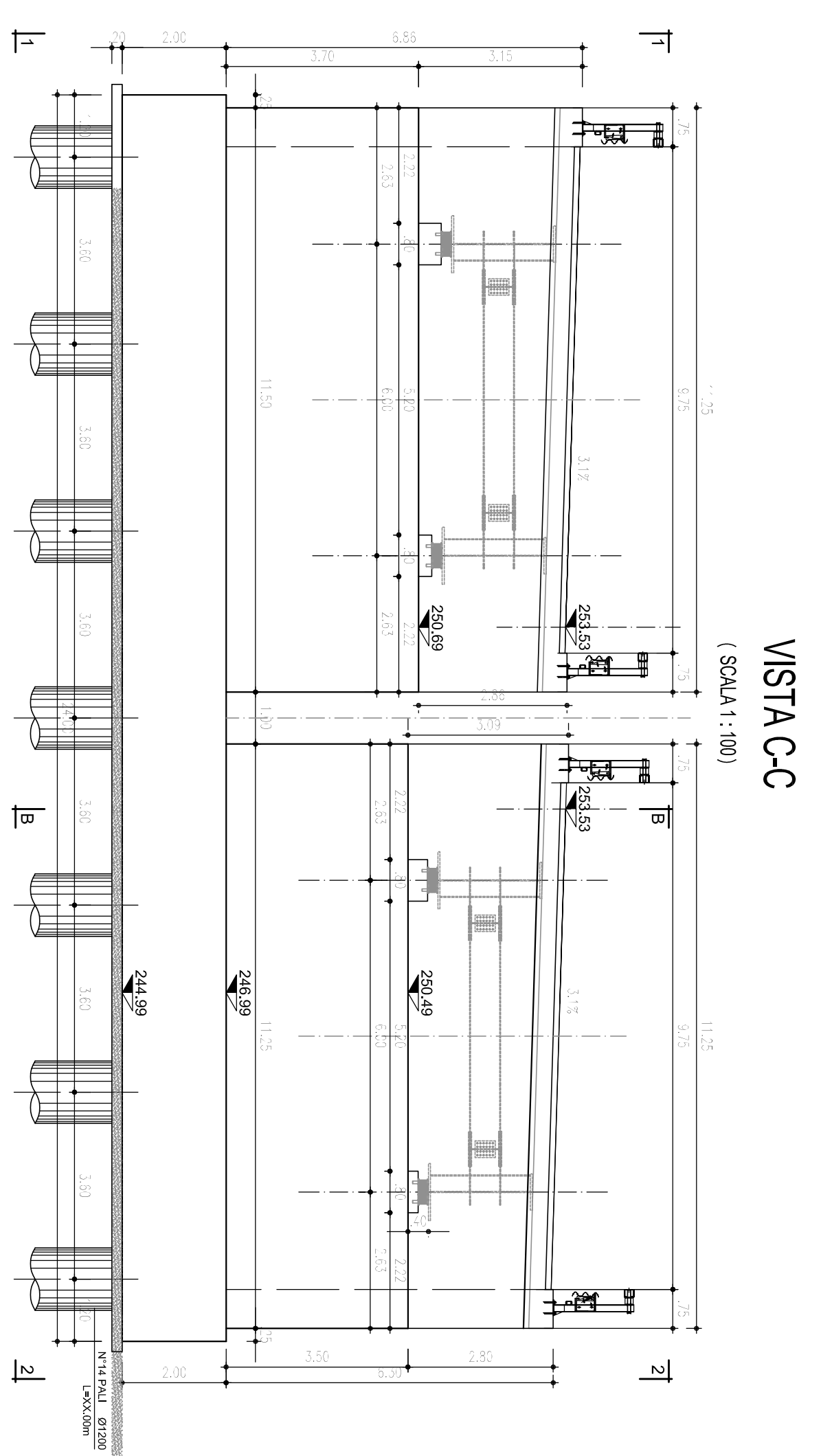

VISTA C-C
(SCALA 1:100)

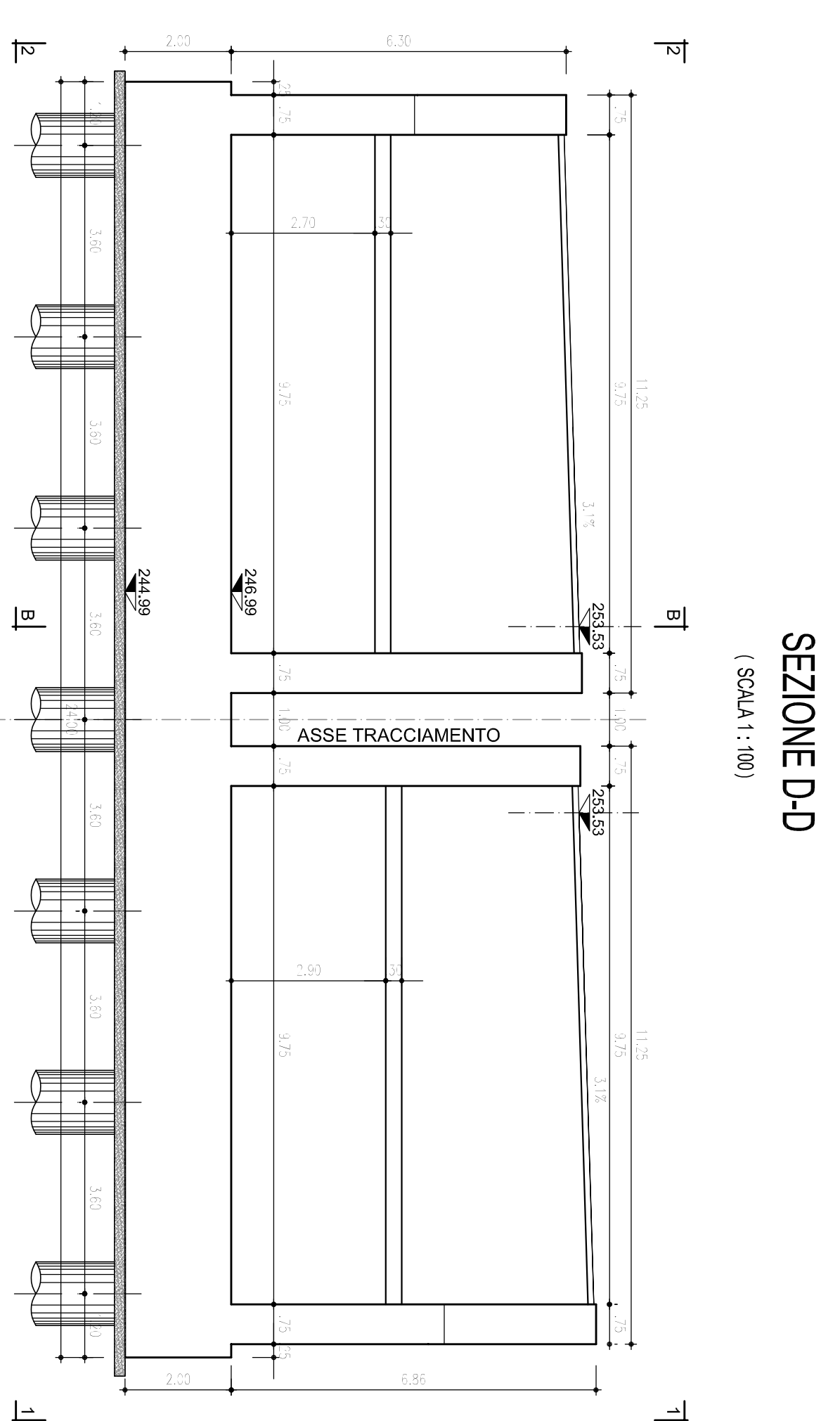

SEZIONE D-D
(SCALA 1:100)

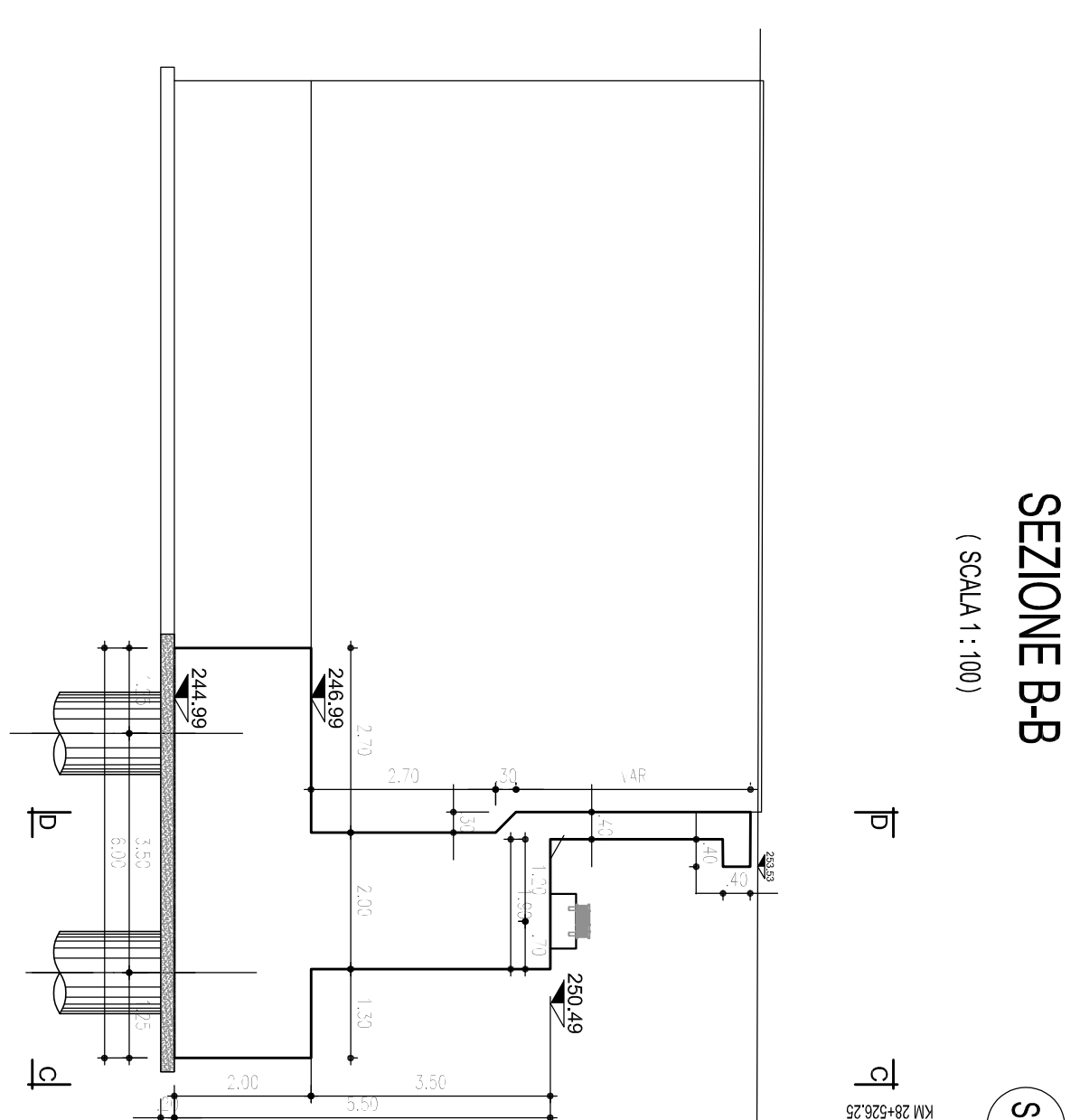

SEZIONE B-B
(SCALA 1:100)

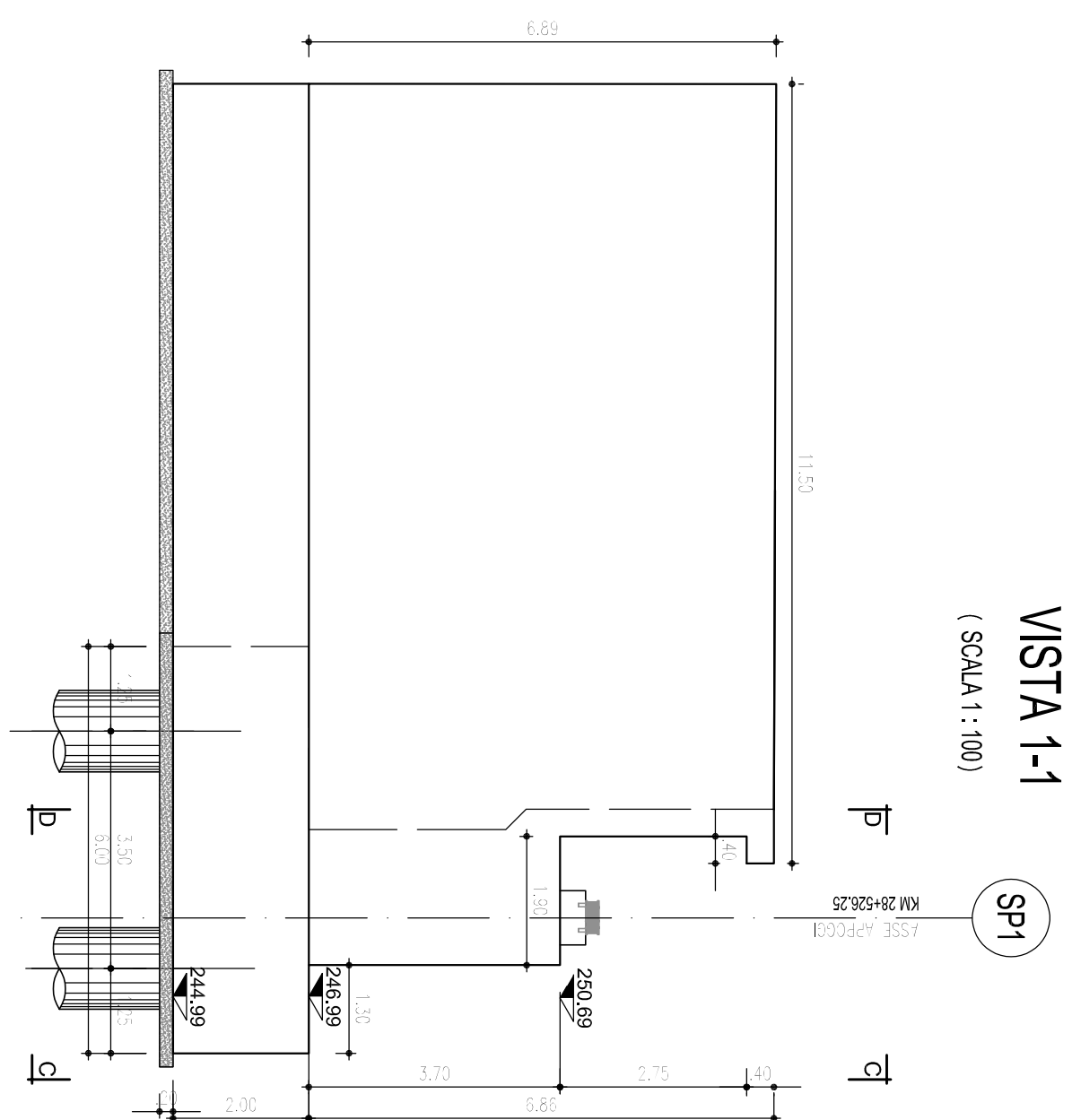

VISTA 1-1
(SCALA 1:100)

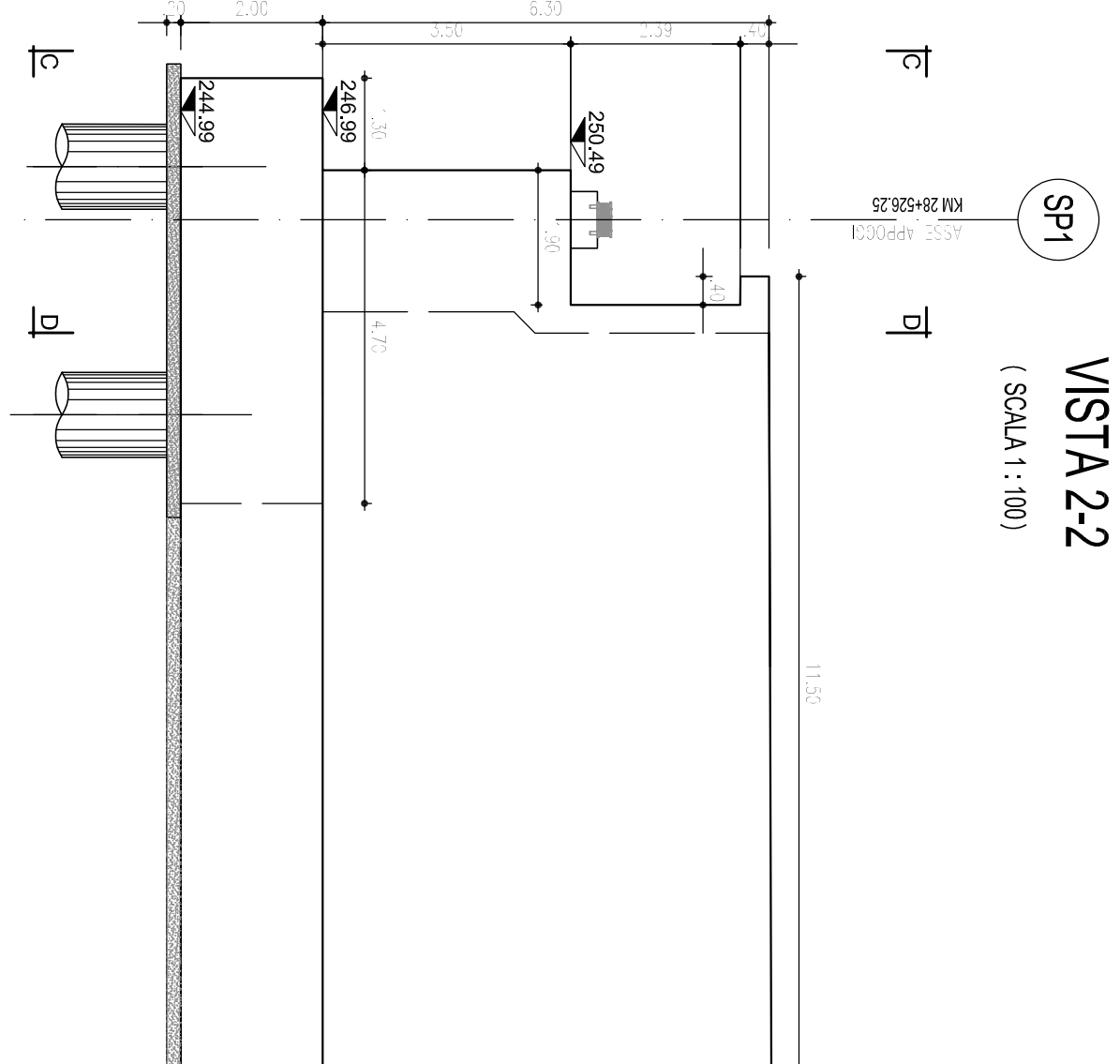

VISTA 2-2
(SCALA 1:100)

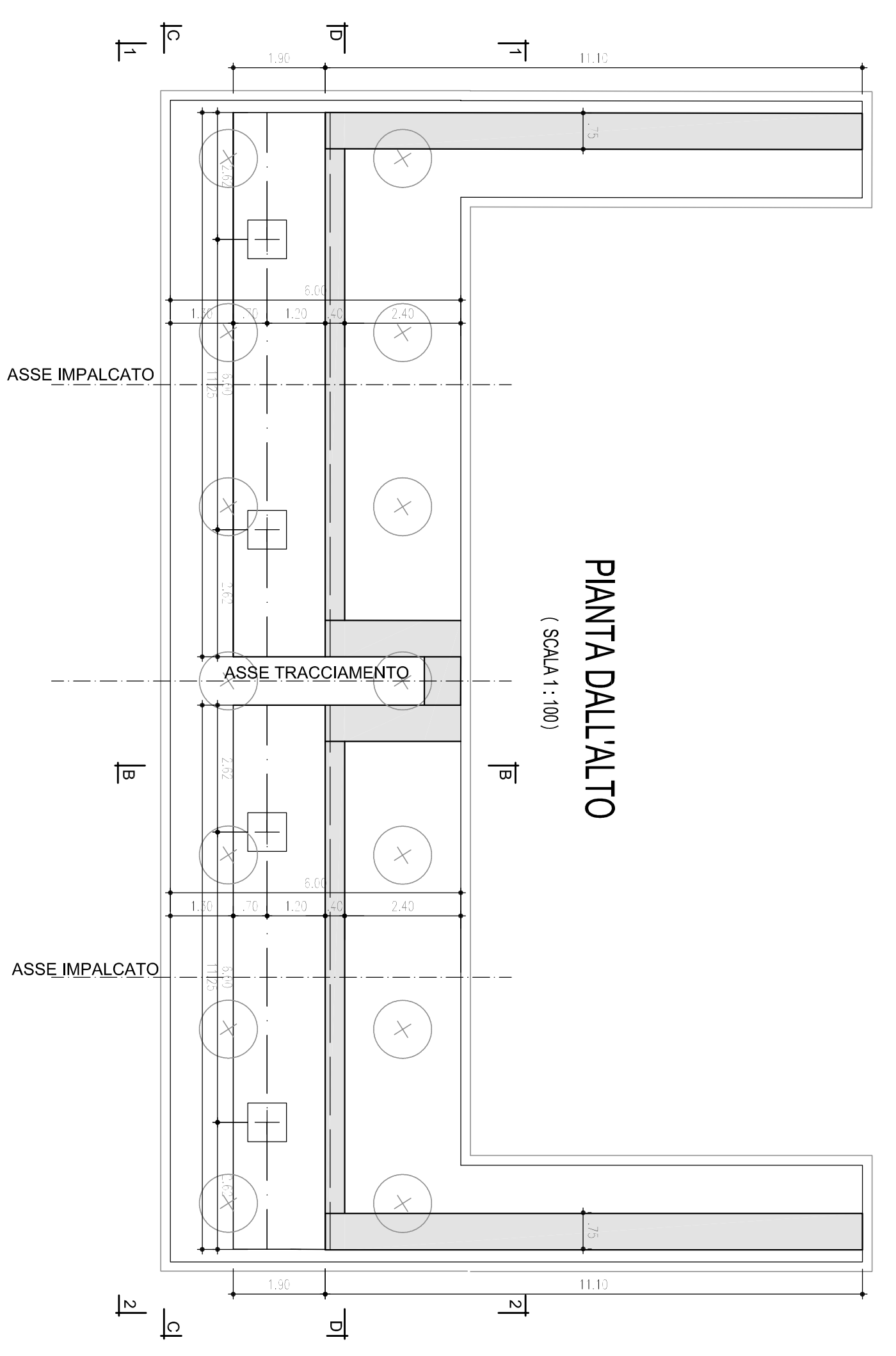

PIANTA DALL'ALTO
(SCALA 1:100)

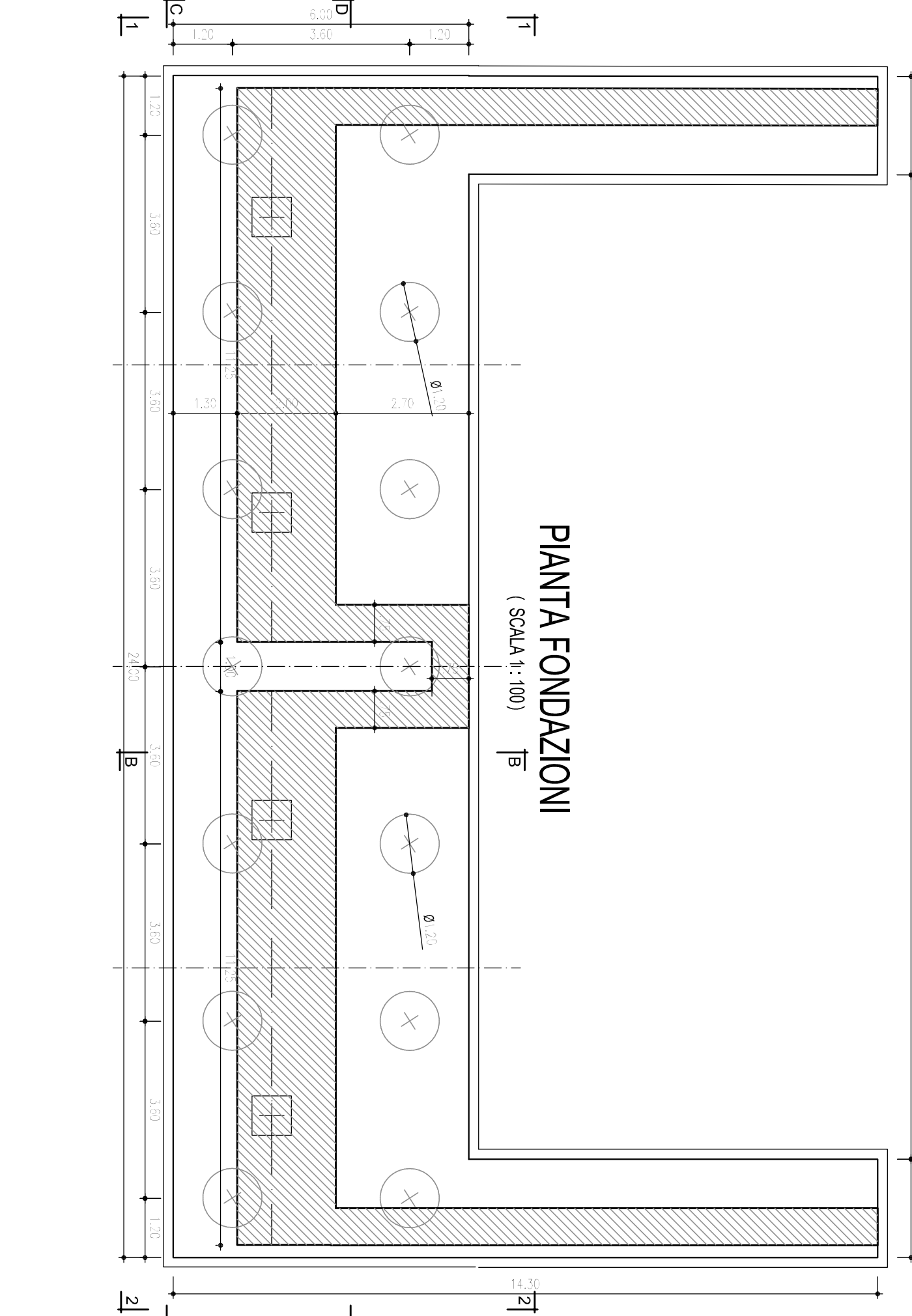

PIANTA FONDAZIONI
(SCALA 1:100)

CARPENTERIA SPALLA 2

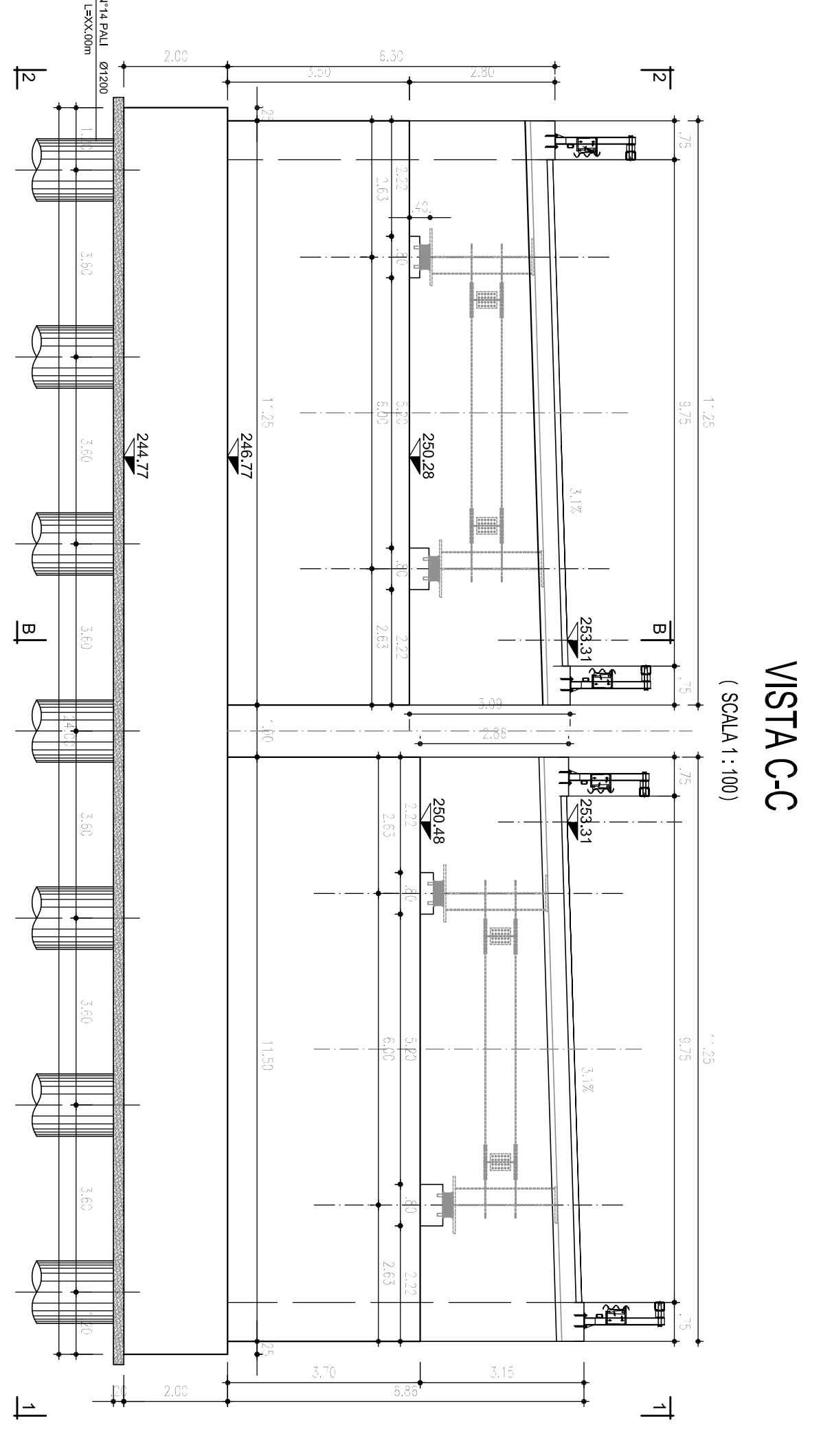

VISTA C-C
(SCALA 1:100)

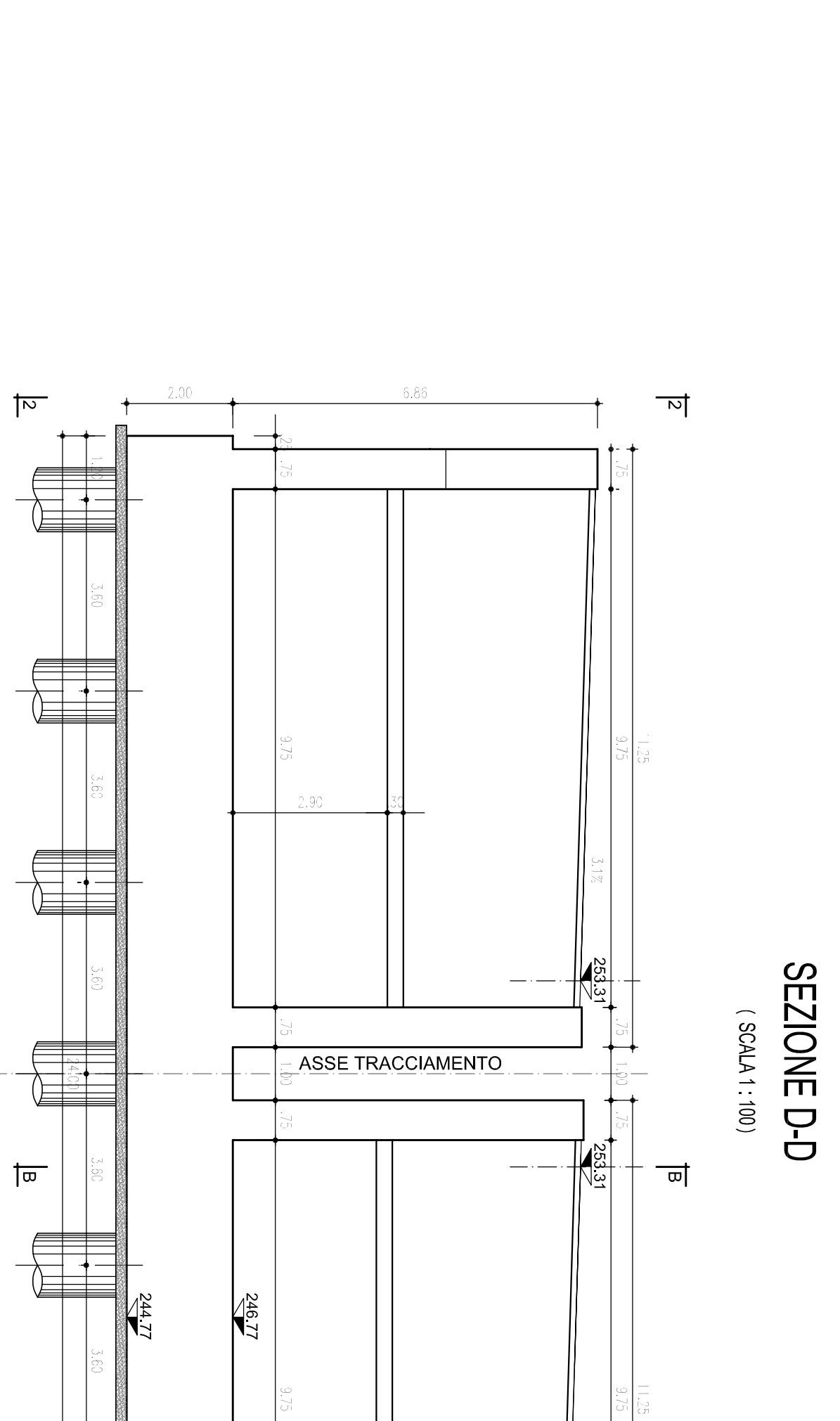

SEZIONE D-D
(SCALA 1:100)

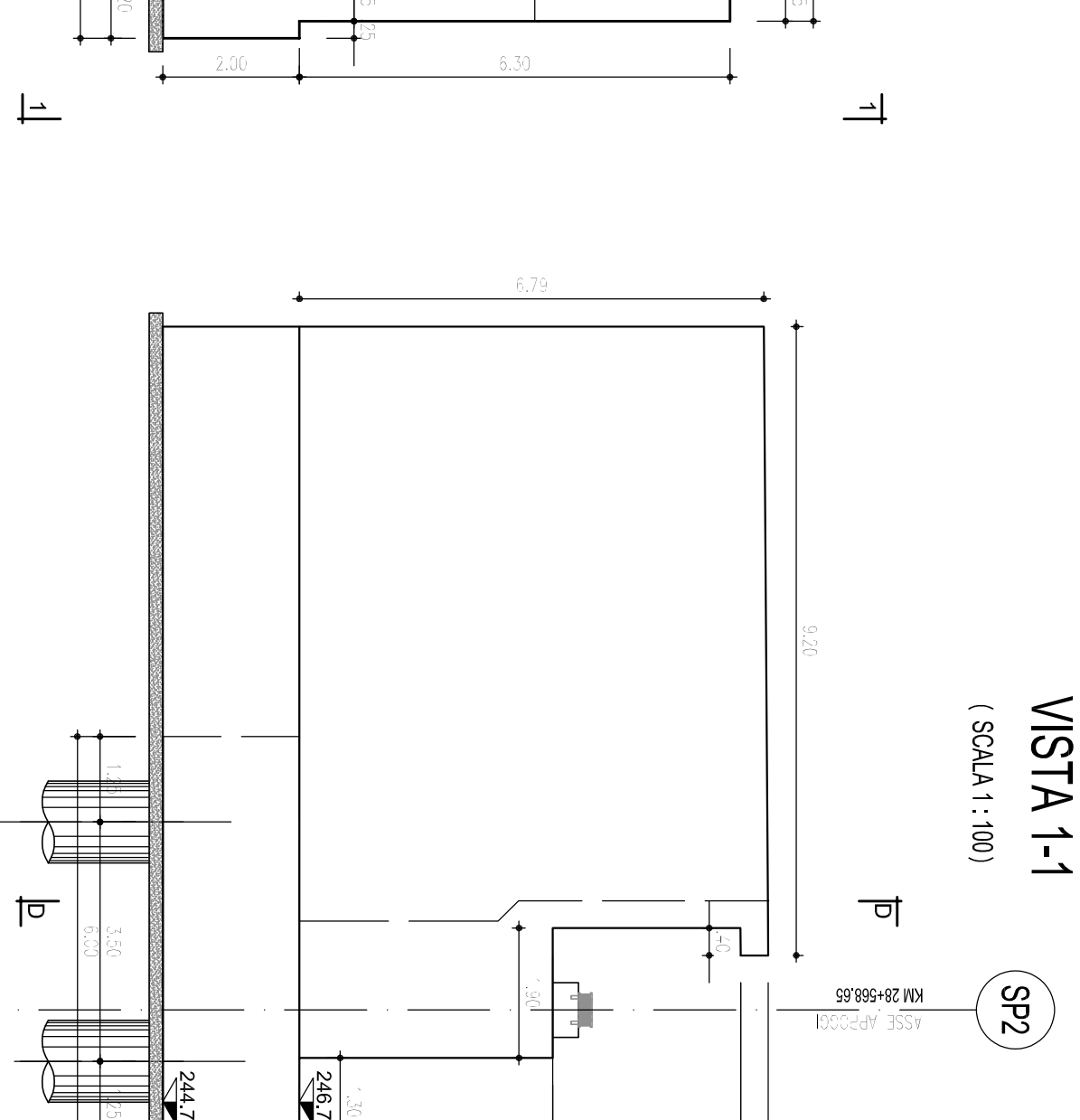

VISTA 1-1
(SCALA 1:100)

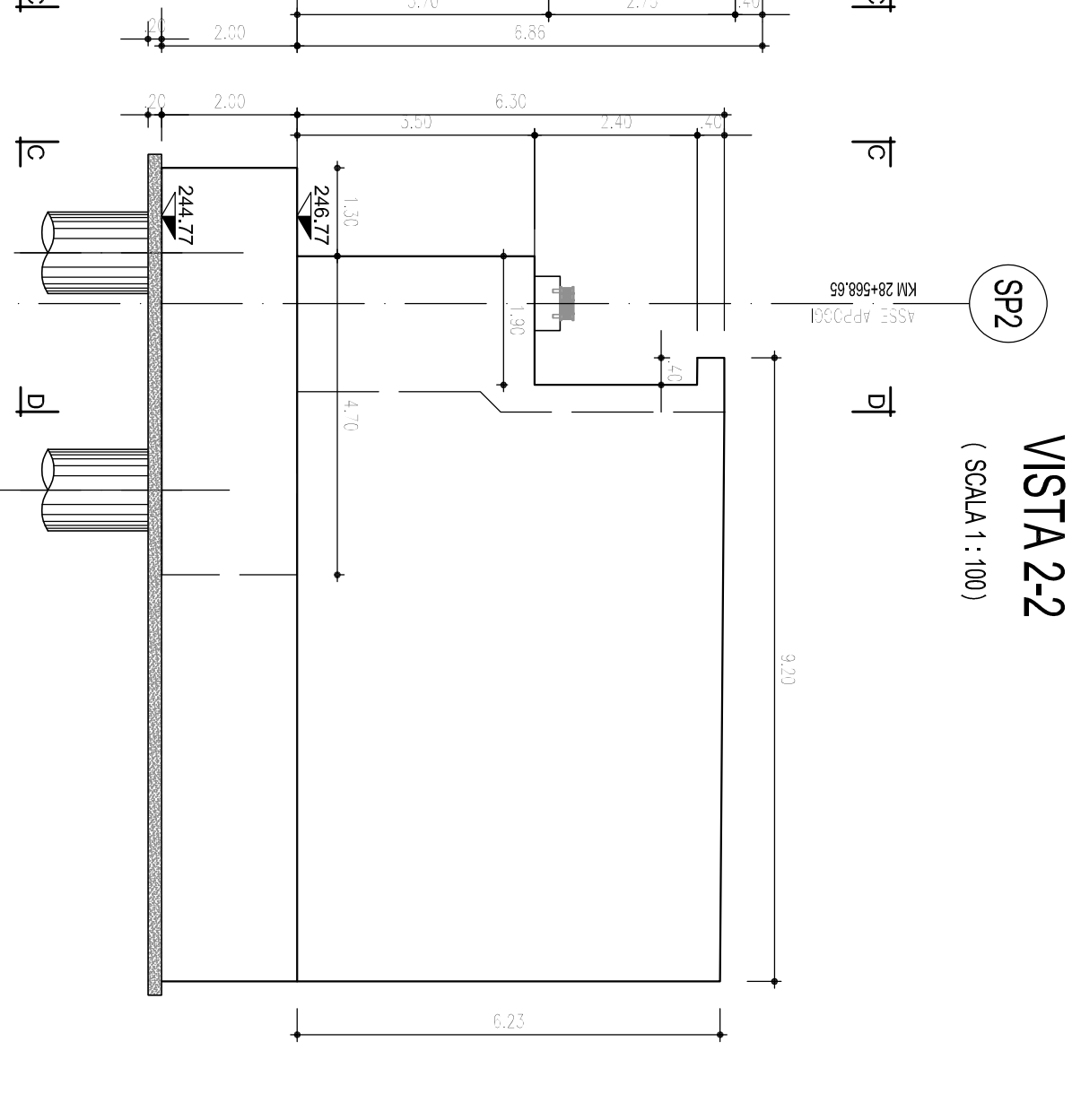

VISTA 2-2
(SCALA 1:100)

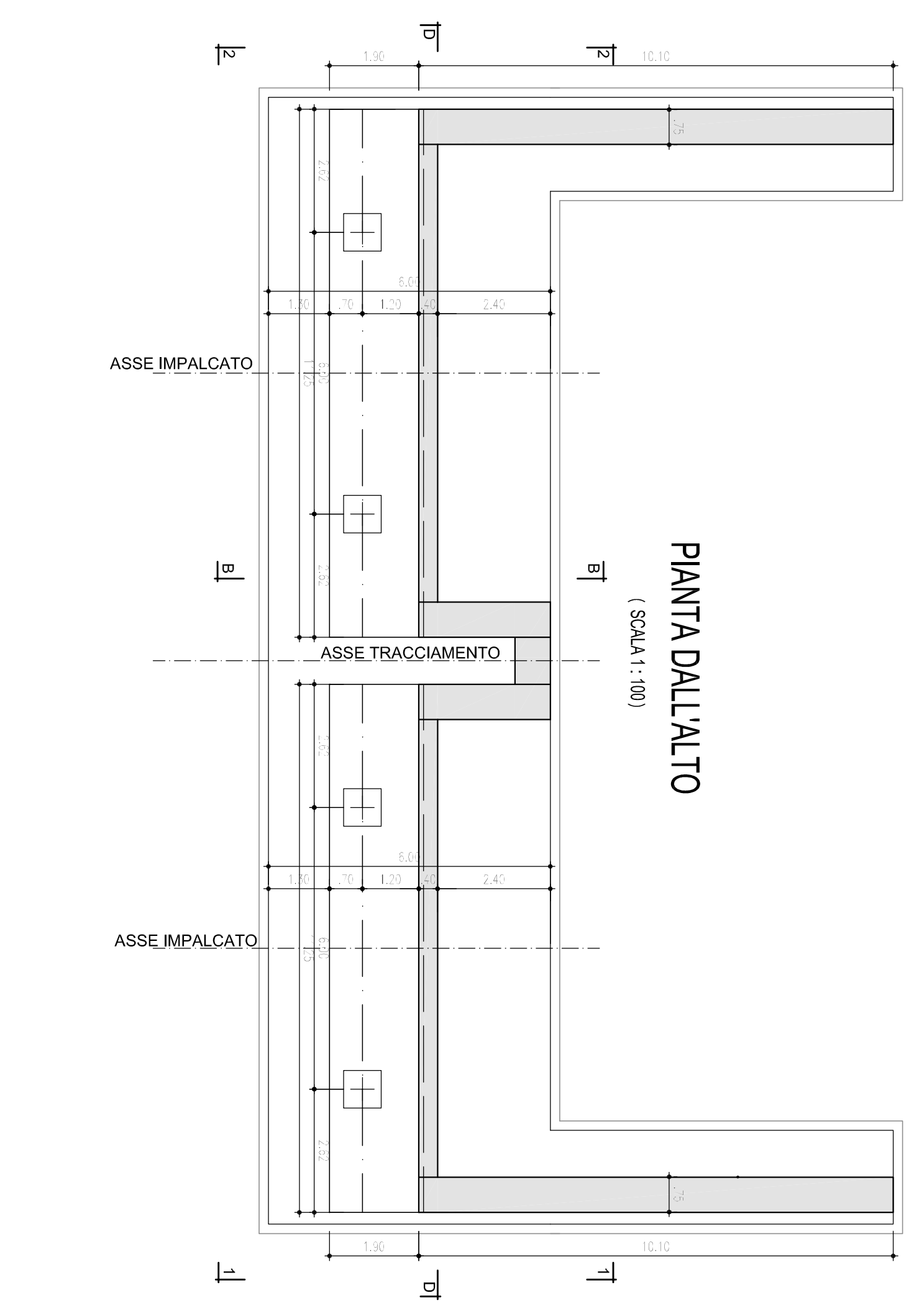

PIANTA DALL'ALTO
(SCALA 1:100)

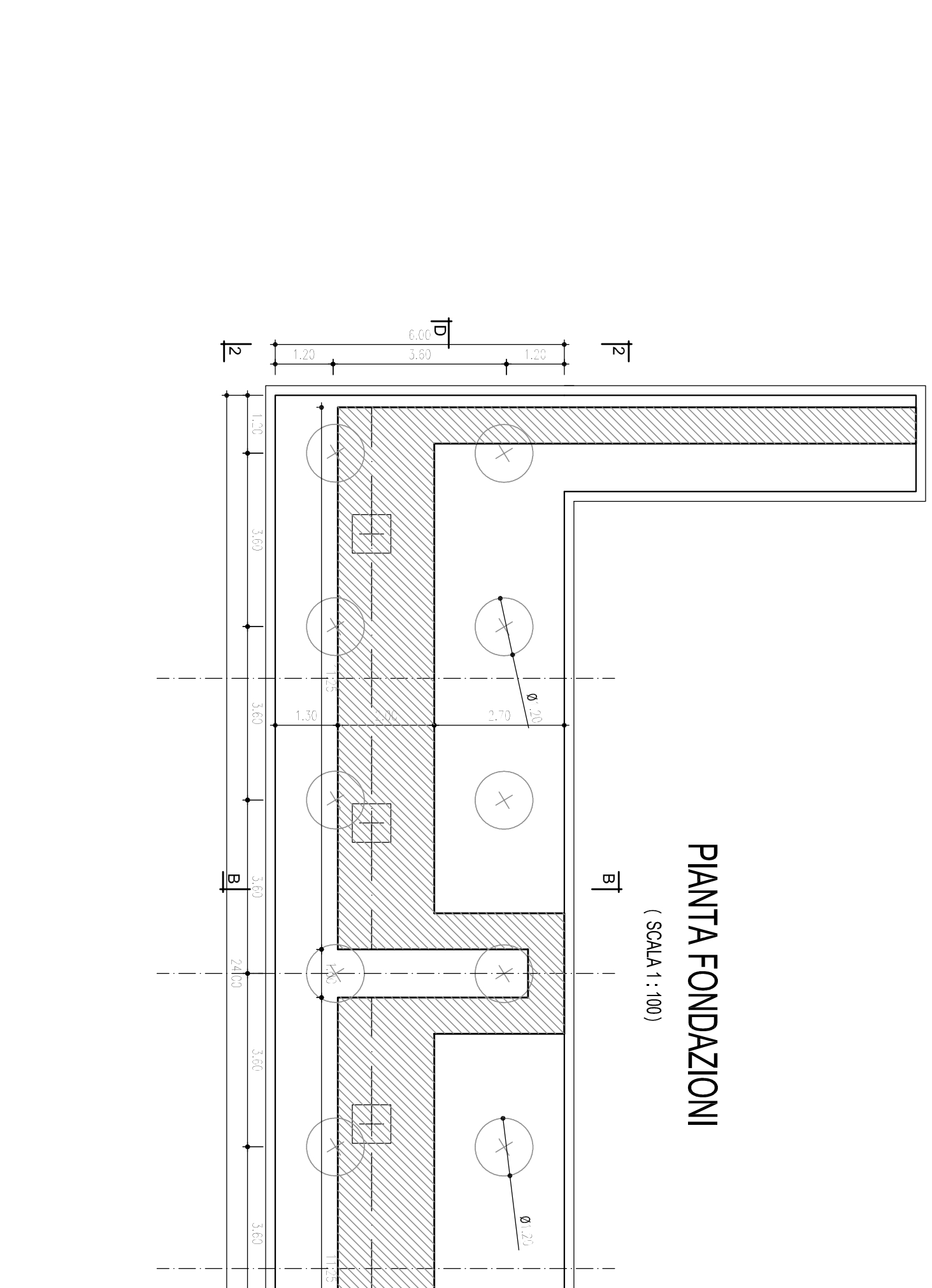

PIANTA FONDAZIONI
(SCALA 1:100)

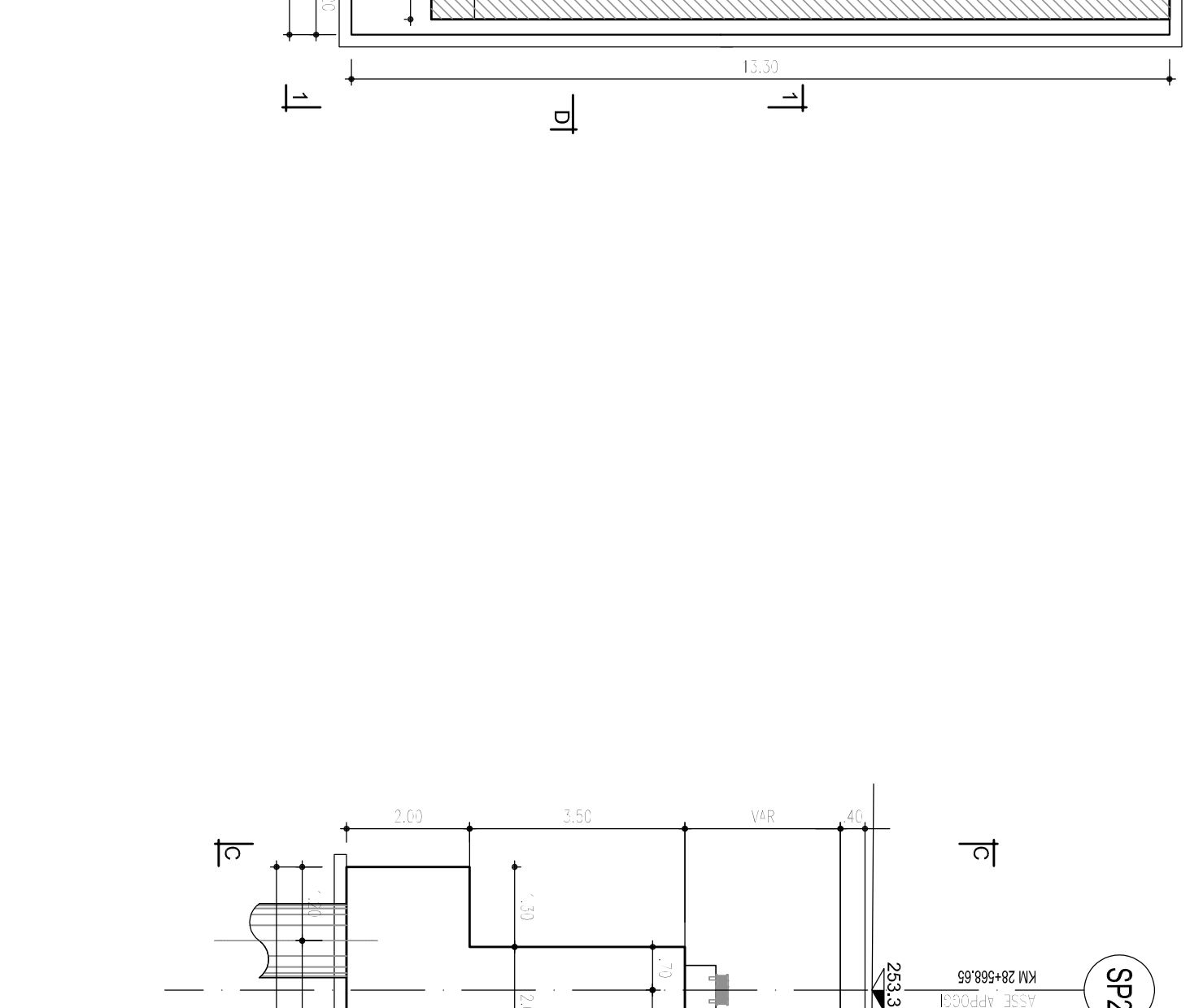

SEZIONE B-B
(SCALA 1:100)

 Direzione Progettazione e Realizzazione Lavori		PROGETTO DEFINITIVO		COG.
Progettazione: ANAS - DIREZIONE PROGETTAZIONE E REALIZZAZIONE LAVORI				
Collegamento tra l'A4 (Torino-Milano) in località Santhia, Biella, Gattorna e l'A26 (Genova Voltri-Cravellona) in località Ghemme. Lotto 1				
WCI - Sime Spa Garibone Carpenteria Spalla				
CODICE PROGETTO DPT1007	N. REVISIONE B	CODICE C.A.M. 17/01	REGIONE A	SCALA 1:100
AUTORE A	VERIFICATORE A	DATA 17/01	STATO APPROVATO	APPROVATO APPROVATO