

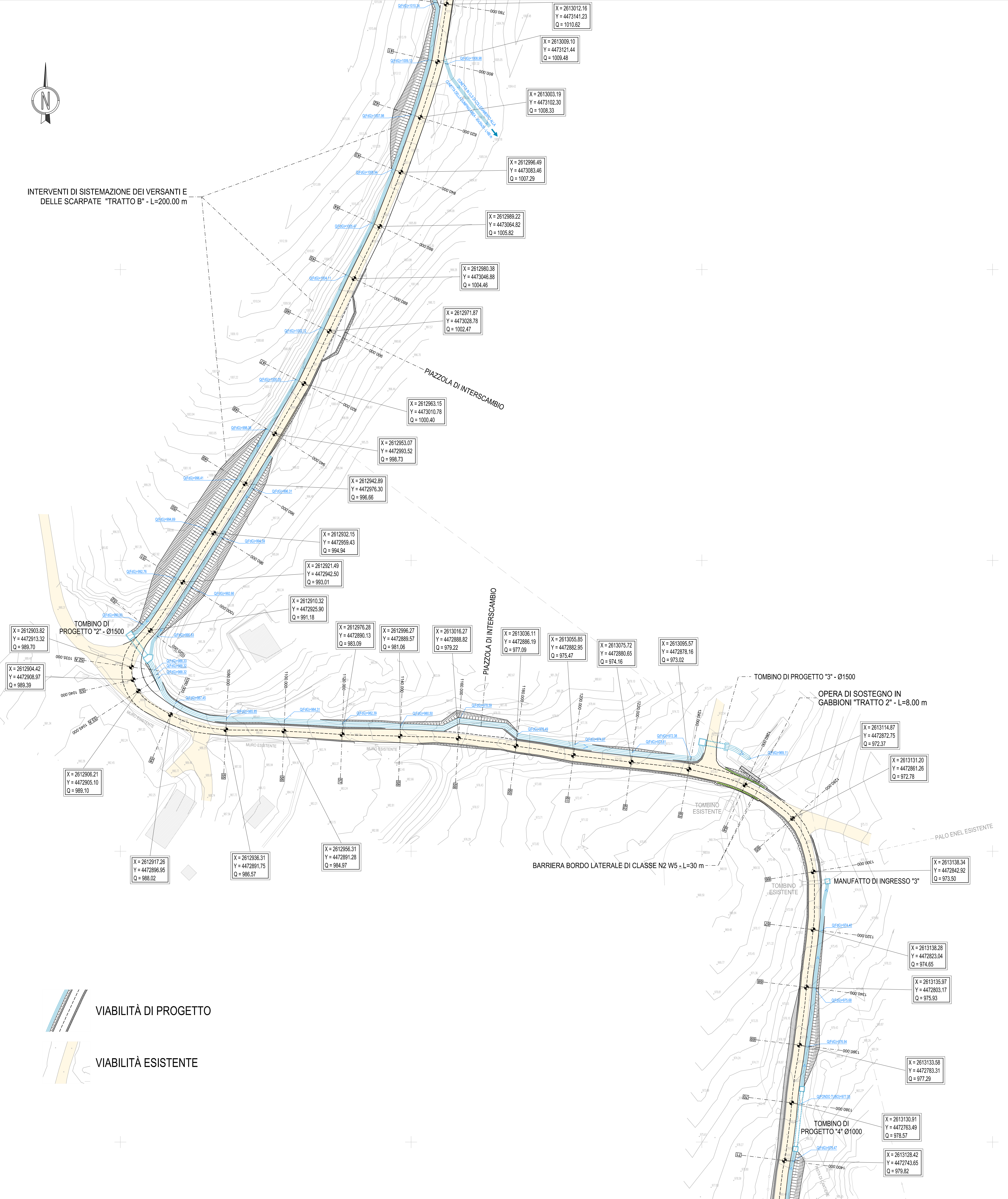

INTERVENTI DI SISTEMAZIONE DEI VERSANTI E DELLE SCARPATE "TRATTO B" - L=200.00 m



X = 2612903.82
Y = 4472913.32
Q = 989.70

X = 2612904.42
Y = 4472906.97
Q = 989.39

X = 2612906.21
Y = 4472905.10
Q = 989.10

X = 2612917.26
Y = 4472896.95
Q = 988.02

X = 2612936.31
Y = 4472891.75
Q = 986.57

X = 2612956.31
Y = 4472891.28
Q = 984.97

X = 2612921.49
Y = 4472942.50
Q = 993.01

X = 2612932.15
Y = 4472959.43
Q = 994.94

X = 2612942.89
Y = 4472976.30
Q = 996.66

X = 2612963.07
Y = 4472993.52
Q = 998.73

X = 2612963.15
Y = 4473010.78
Q = 1000.40

X = 2612971.87
Y = 4473028.78
Q = 1002.47

X = 2612980.38
Y = 4473046.88
Q = 1004.46

X = 2612989.22
Y = 4473064.82
Q = 1005.82

X = 2612996.49
Y = 4473083.46
Q = 1007.29

X = 2613003.19
Y = 4473102.30
Q = 1008.33

X = 2613009.10
Y = 4473121.44
Q = 1009.48

X = 2613012.16
Y = 4473141.23
Q = 1010.62

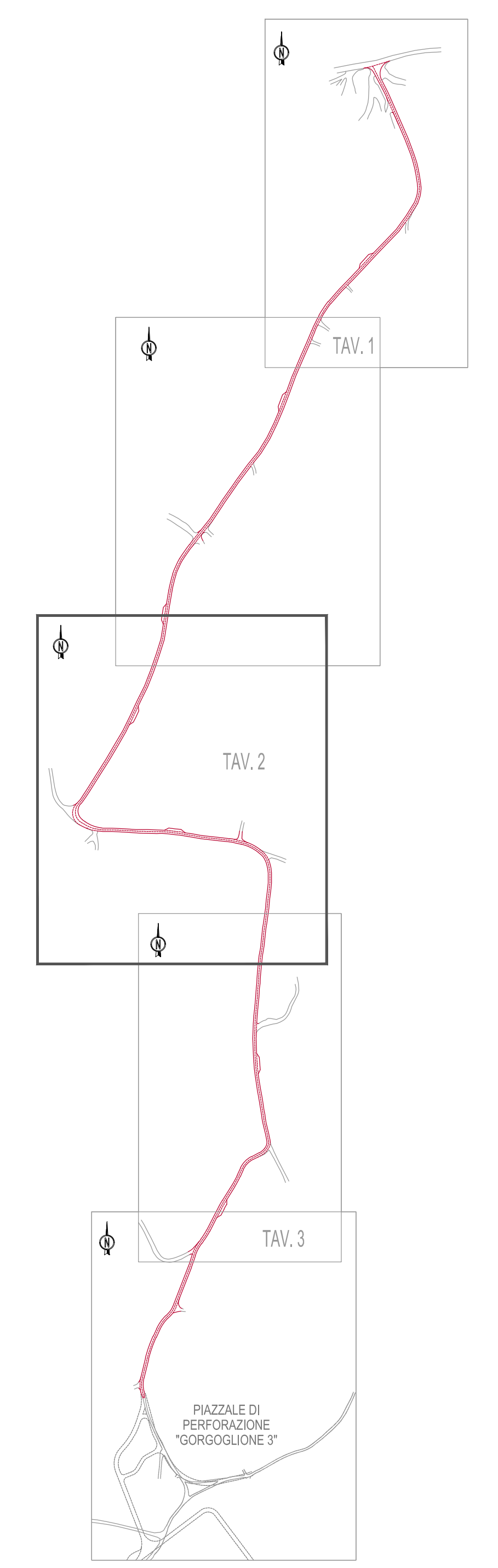

 VIABILITÀ DI PROGETTO

 VIABILITÀ ESISTENTE

BARRIERA BORDO LATERALE DI CLASSE N2 W5 - L=30 m

OPERA DI SOSTEGNO IN GABBIONI "TRATTO 2" - L=8.00 m

TOMBINO DI PROGETTO "4" Ø1000

X = 2613130.91
Y = 4472763.49
Q = 978.57

X = 2613128.42
Y = 4472743.65
Q = 979.52

X = 2613138.28
Y = 4472823.04
Q = 974.65

X = 2613135.97
Y = 4472803.17
Q = 975.93

X = 2613133.58
Y = 4472783.31
Q = 977.29

X = 2613131.20
Y = 4472861.26
Q = 972.78

X = 2613114.87
Y = 4472872.75
Q = 972.37

X = 2613095.57
Y = 4472878.16
Q = 973.02

X = 2613075.72
Y = 4472880.65
Q = 974.16

X = 2613055.85
Y = 4472882.95
Q = 975.47

X = 2613036.11
Y = 4472886.19
Q = 977.09

X = 2612988.82
Y = 4472888.82
Q = 979.22

X = 2612966.27
Y = 4472889.57
Q = 981.06

X = 2612976.28
Y = 4472890.13
Q = 983.09

X = 2612910.32
Y = 4472925.90
Q = 991.18

X = 2612942.89
Y = 4472976.30
Q = 996.66

X = 2612963.07
Y = 4472993.52
Q = 998.73

X = 2612963.15
Y = 4473010.78
Q = 1000.40

X = 2612971.87
Y = 4473028.78
Q = 1002.47

X = 2612980.38
Y = 4473046.88
Q = 1004.46

X = 2612989.22
Y = 4473064.82
Q = 1005.82

X = 2612996.49
Y = 4473083.46
Q = 1007.29

X = 2613003.19
Y = 4473102.30
Q = 1008.33

X = 2613009.10
Y = 4473121.44
Q = 1009.48

X = 2613012.16
Y = 4473141.23
Q = 1010.62

00			30/06/2017	IFC	Issued For Comments	COLLUZZI	AZZAROLI	BONADIES
Revision	Date	Status	Revision memo			Issued by	Checked by	Approved by
 Exploration Production  								
<small>This document is the property of TOTAL and shall not be disclosed to third parties or reproduced without permission of the owner. This document has been generated by an Electronic Document Management System. When printed it is considered as a for information only copy. The controlled copy is the screen version and it is the holder's responsibility that he/she holds the latest valid version.</small>								
PROGETTO ESECUTIVO								
STRADA DI ACCESSO POZZO GG3								
PLANIMETRIA DI PROGETTO - FOGLIO 2 DI 3								
Doc. Type:	DRW	Syst. / S-Syst.:	NA			Discipline:	CIV	
COMPANY Document N.	IT-TPR-WS-RPA-002208_rev00			Rev.	00	Scale	1/500	
Contractor Document N.	IT-TPR-WS-RPA-002208_rev00.dwg			Format	A0	Folio	2 of 3	