

OPERE DI PROTEZIONE DEI VERSANTI E DELLE SCARPATE "TRATTO B" - L=200.00 m

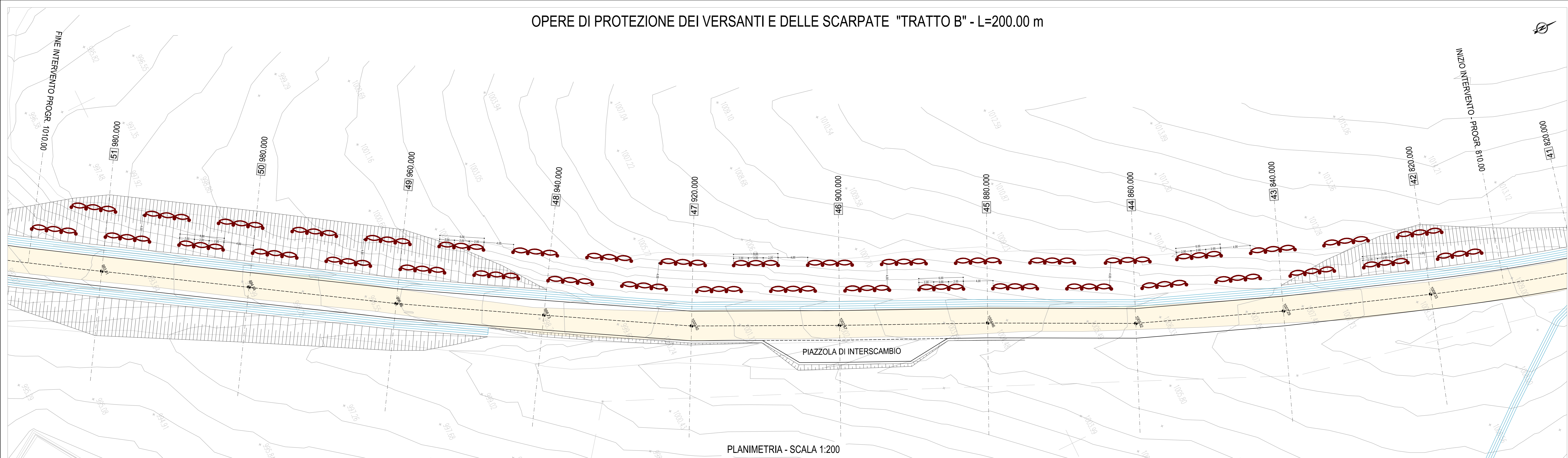

SEZIONE TIPOLOGICA
INTERVENTI DI SISTEMAZIONE DELLE SCARPATE

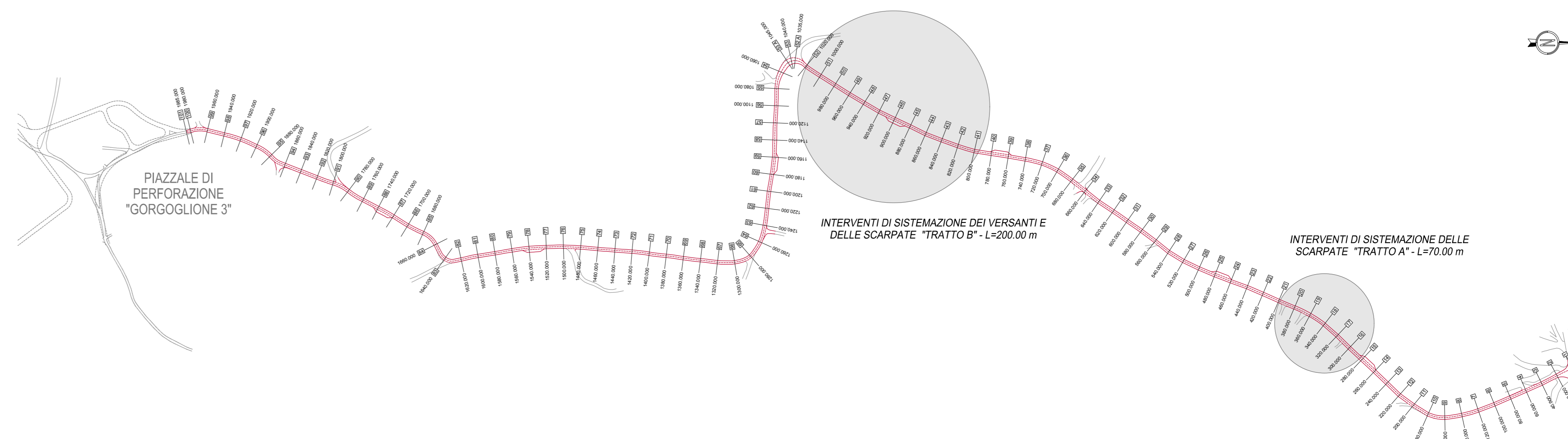
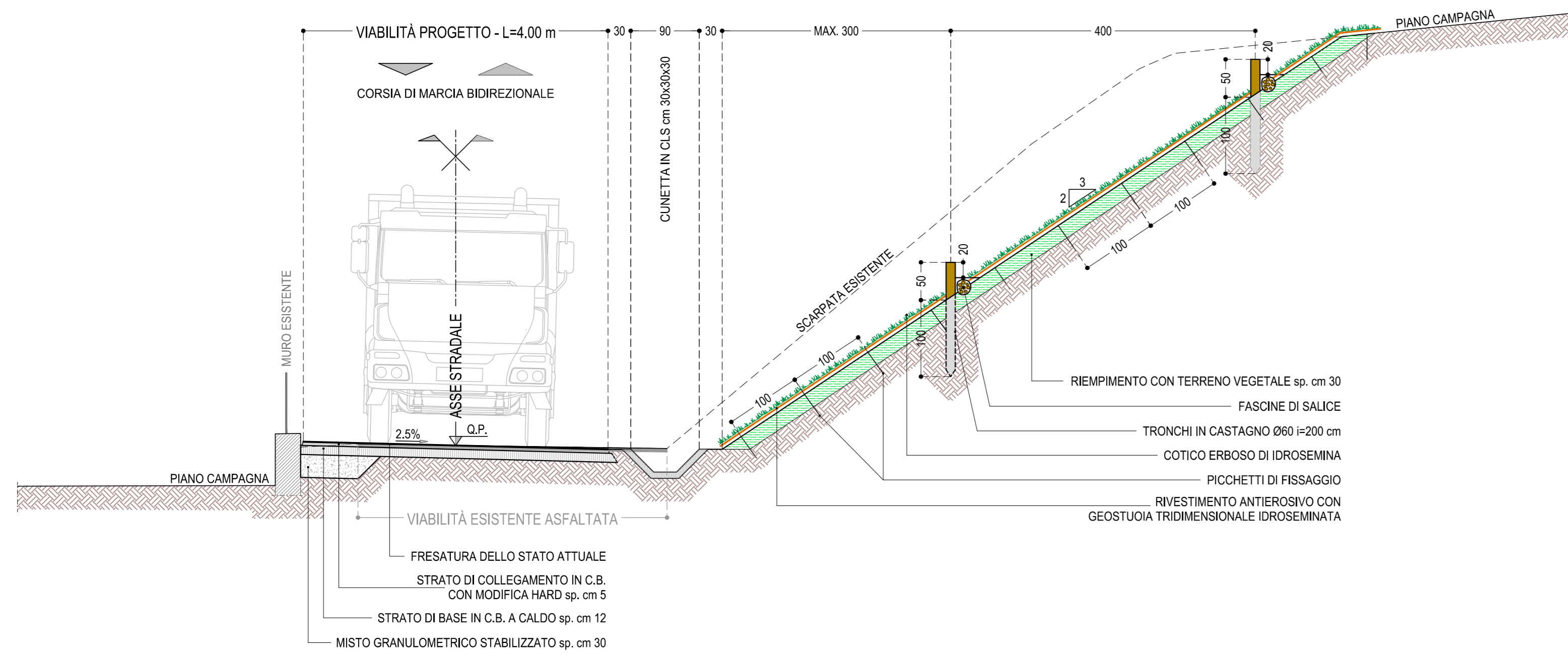

OPERE DI PROTEZIONE DELLE SCARPATE "TRATTO A" - L=70.00 m

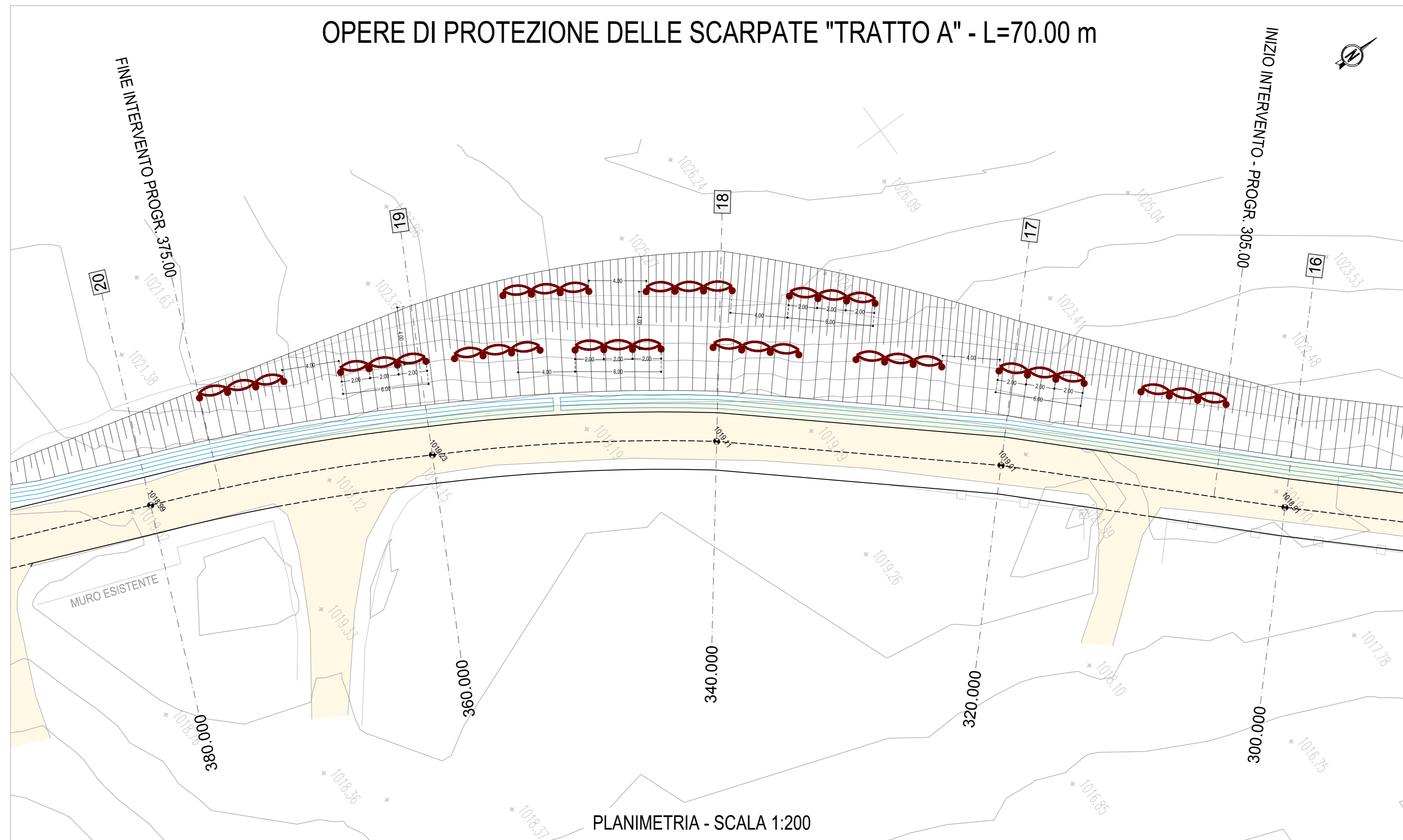

SEZIONE TIPOLOGICA
INTERVENTI DI SISTEMAZIONE DEI VERSANTI

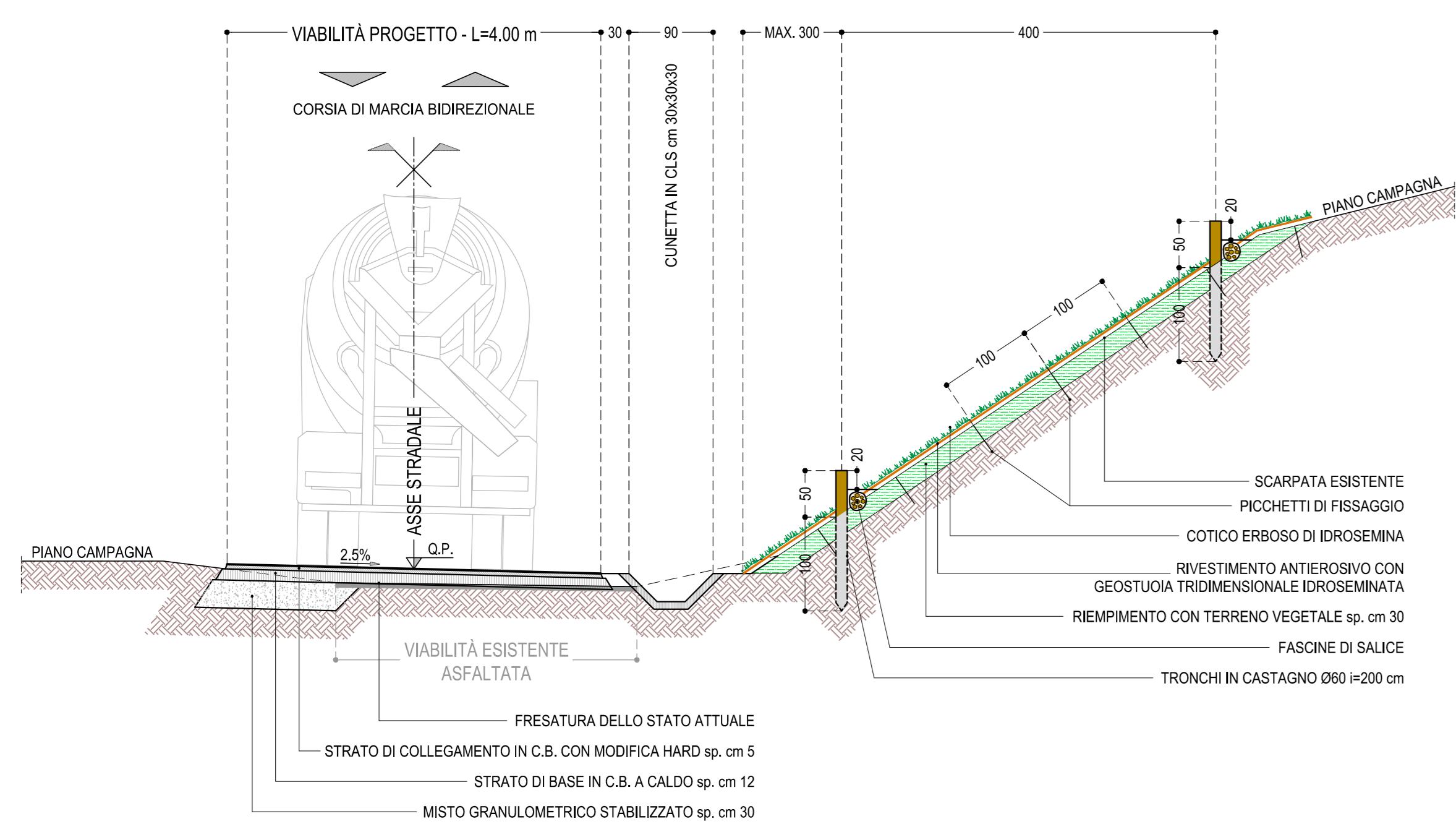

Revision	Date	Status	Revision memo	Issued by	Checked by	Approved by
00	30/06/2017	IFC	Issued For Comments	COLUZZI	AZZAROLI	BONADIES

Exploration Production

This document is the property of TOTAL and shall not be disclosed to third parties or reproduced without permission of the owner.
 This document has been generated by an Electronic Document Management System. When printed it is considered as a for 25/06/2017 only copy. The controlled copy is the screen version and it is the holder's responsibility that he/she holds the latest valid version.

PROGETTO ESECUTIVO
 STRADA DI ACCESSO POZZO GG3
 OPERE DI PROTEZIONE DELLE SCARPATE

Doc. Type:	DRW	Syst. / S- Syst.:	NA	Discipline:	CIV	Electronic File Name:	IT-TPR-WS-RPA-002222_rev00.dwg
COMPANY Document N.:	IT-TPR-WS-RPA-002222_rev00	Rev.:	00	Scale:	1/200		
Contractor Document N.:	IT-TPR-WS-RPA-002222_rev00.dwg	Format:	A0	Folio:	1 of 1		