

Deviazione ROGGIA VOLPINA

Planimetria TRATTO A

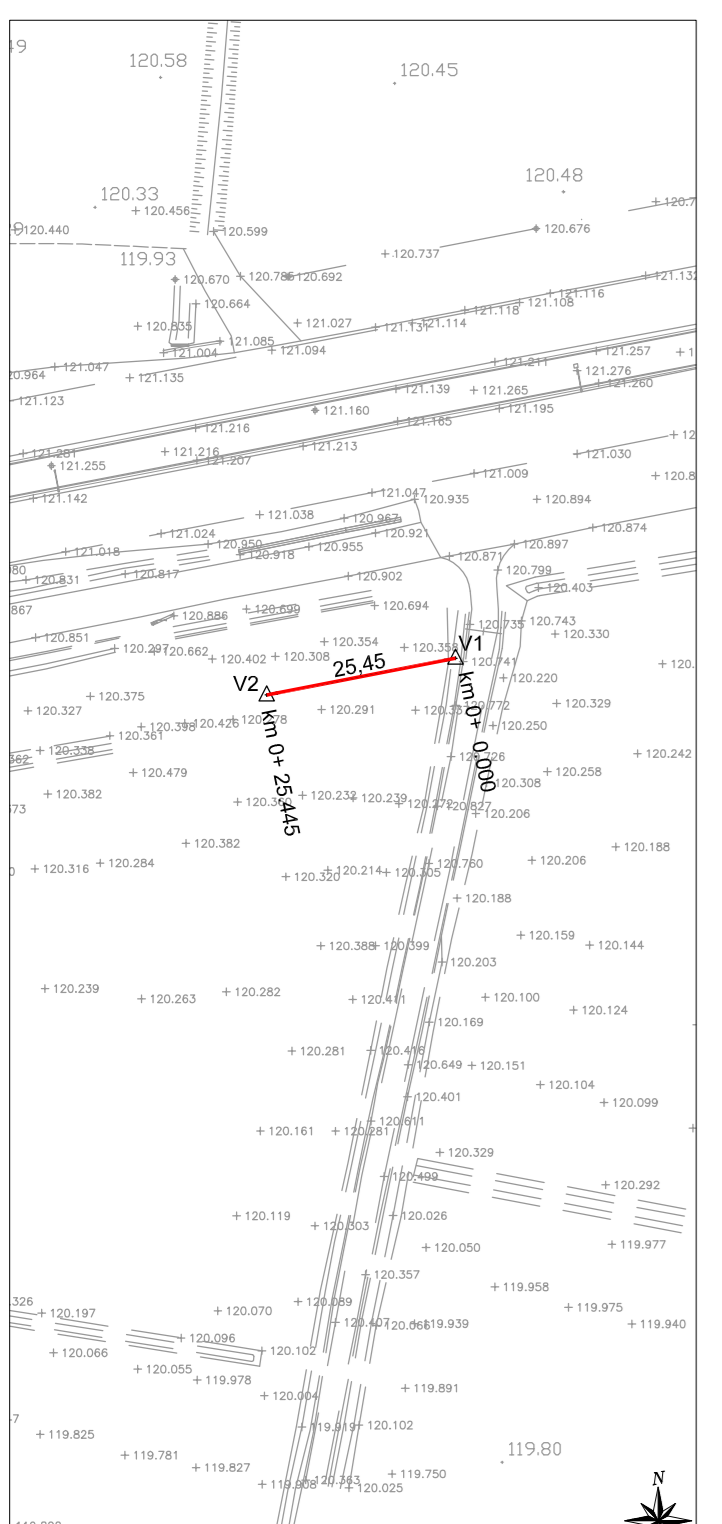

V1	152425.187	V2	152430.211
	5038459.213		5038463.347

Planimetria TRATTO B

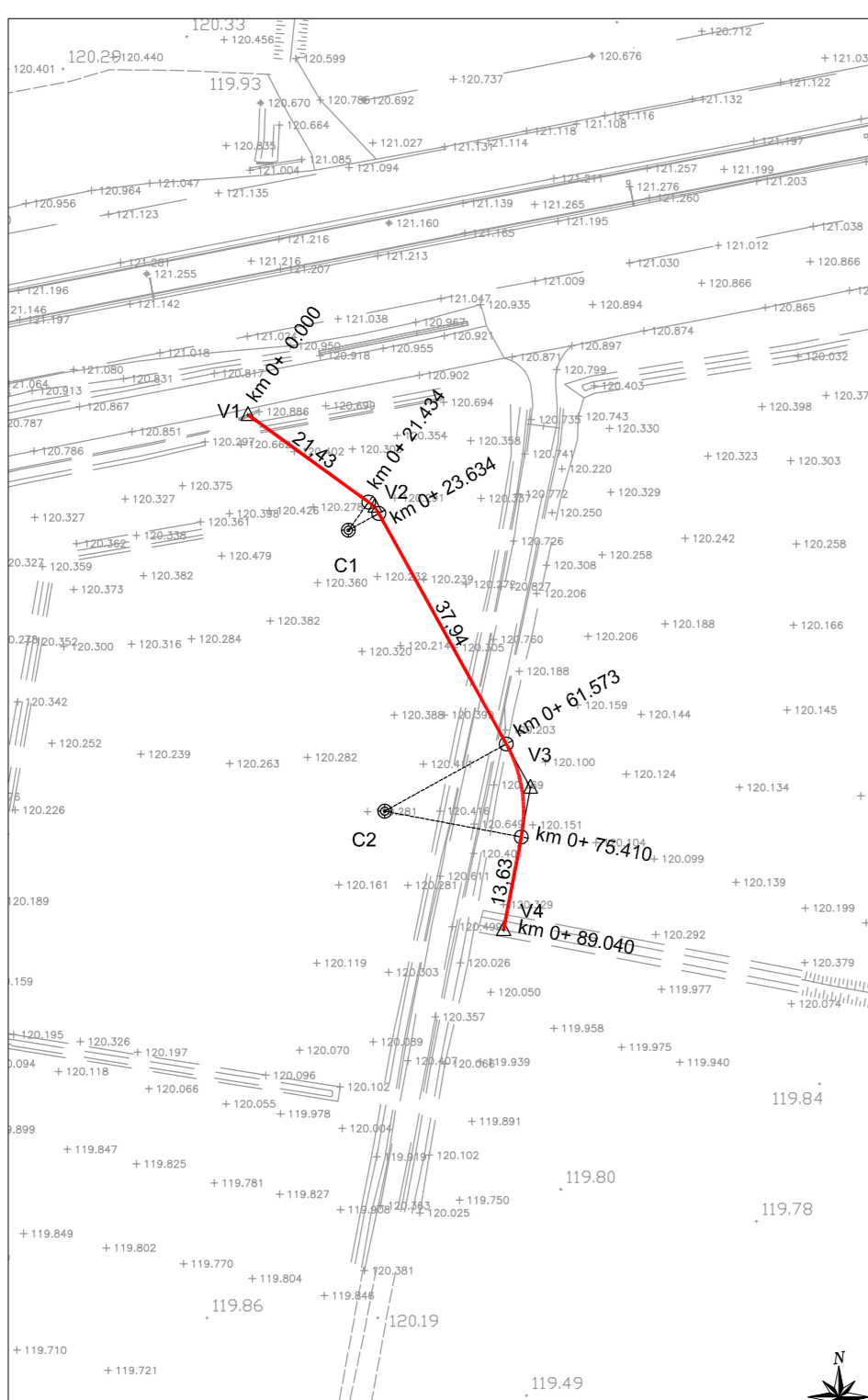

V1	152446.320	V2	152450.611	V3	152452.006	V4	152452.140
	5038473.373		5038466.170		5038419.685		5038399.208

Planimetria TRATTO C

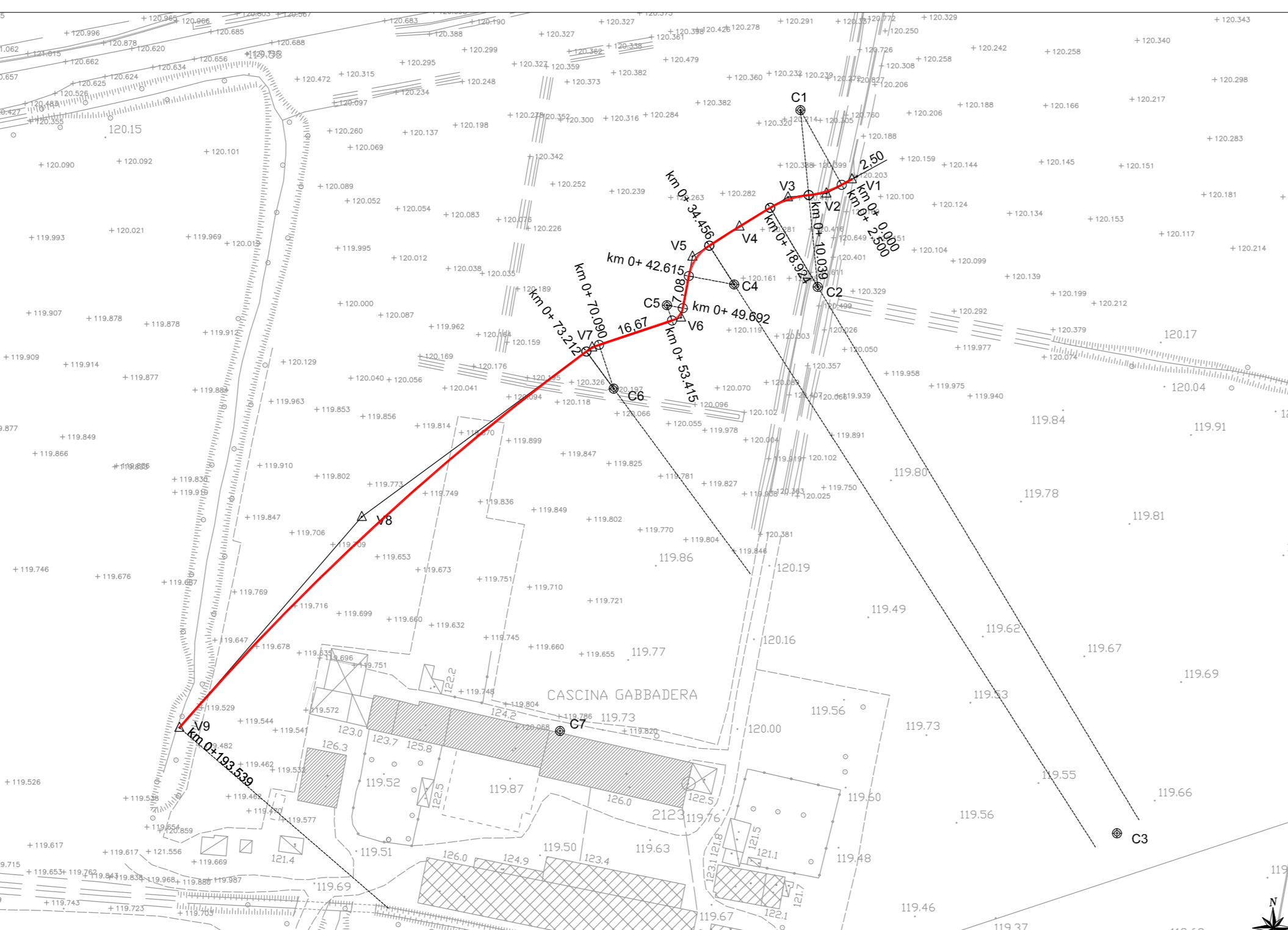

V1	152452.686	V2	152459.054	V3	152448.531	V4	152446.358	V5	152446.891	V6	152445.891	V7	152446.632	V8	152446.731	V9	152437.217
	5038427.132		5038423.072		5038416.820		5038410.391		5038397.161		5038390.718		5038390.718		5038353.844		5038306.244

Planimetria TRATTO D

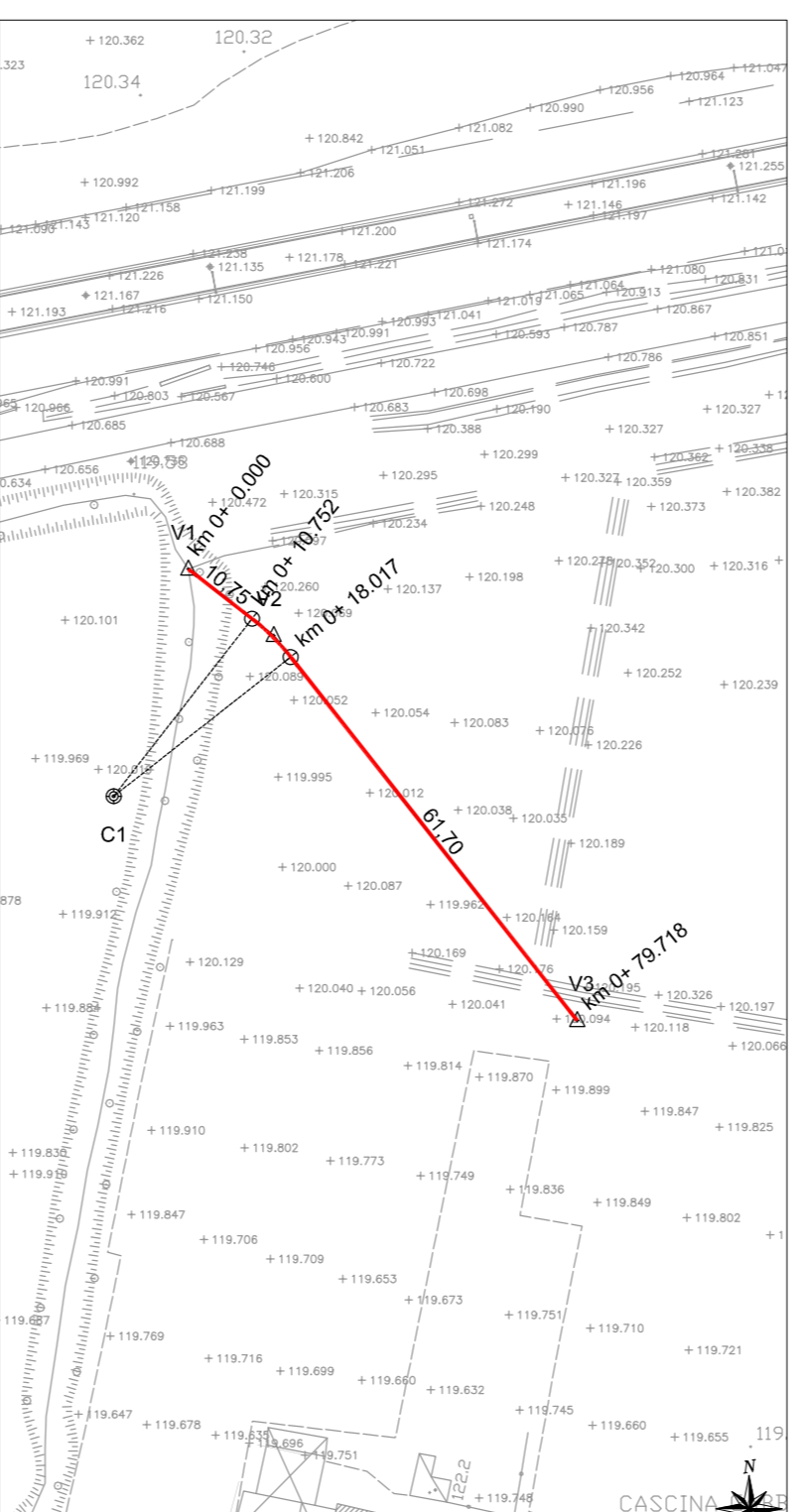

V1	152449.538	V2	152441.020	V3	152441.132
	5038439.914		5038431.005		5038379.721

Deviazione ROGGIA VOLPINA E

Planimetria

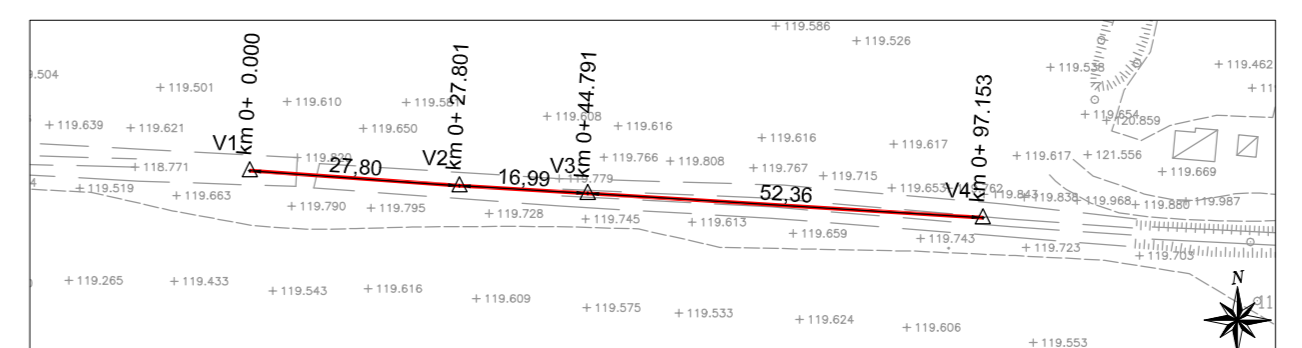

V1	152426.715	V2	152427.448	V3	152434.406	V4	152436.668
	5038279.256		5038277.270		5038276.260		5038273.033

Deviazione CANALE via CELLINI

Planimetria

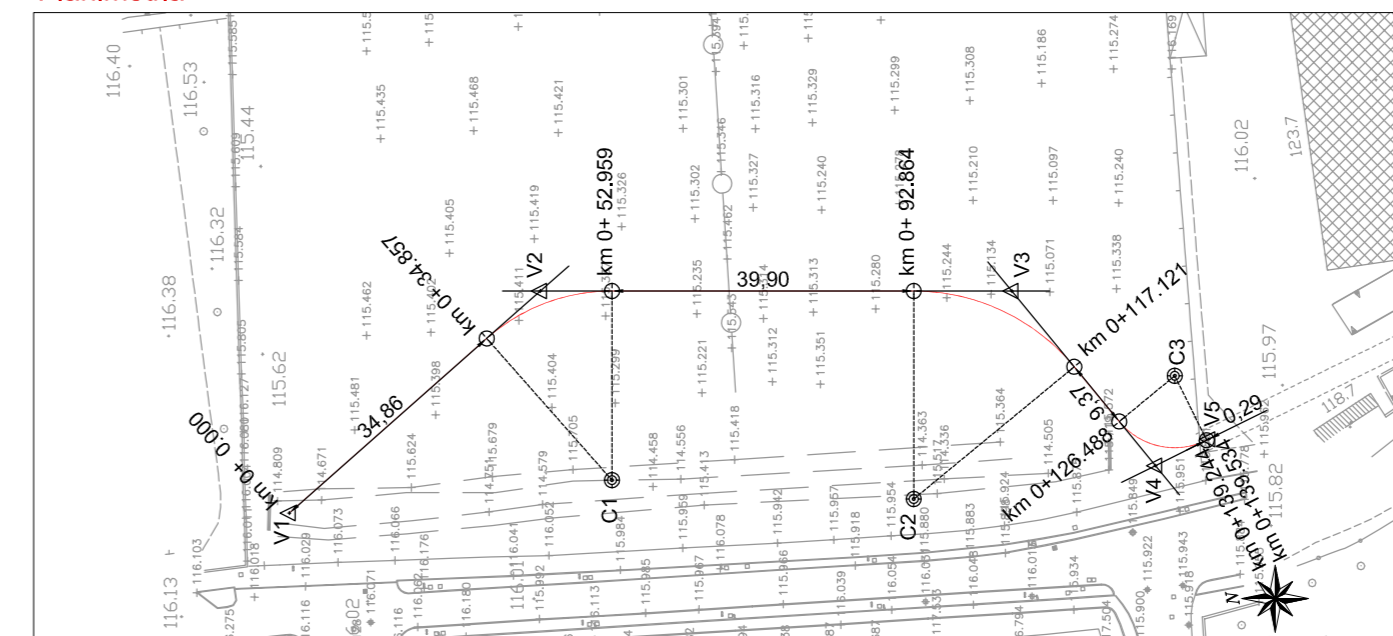

V1	1523248.737	V2	1523278.196	V3	1523278.376	V4	1523255.349	V5	1523256.853
	5037900.707		5038067.587		5038095.233		5038486.166		5038475.156

Deviazione FONTANILE MARCELLINA

Planimetria

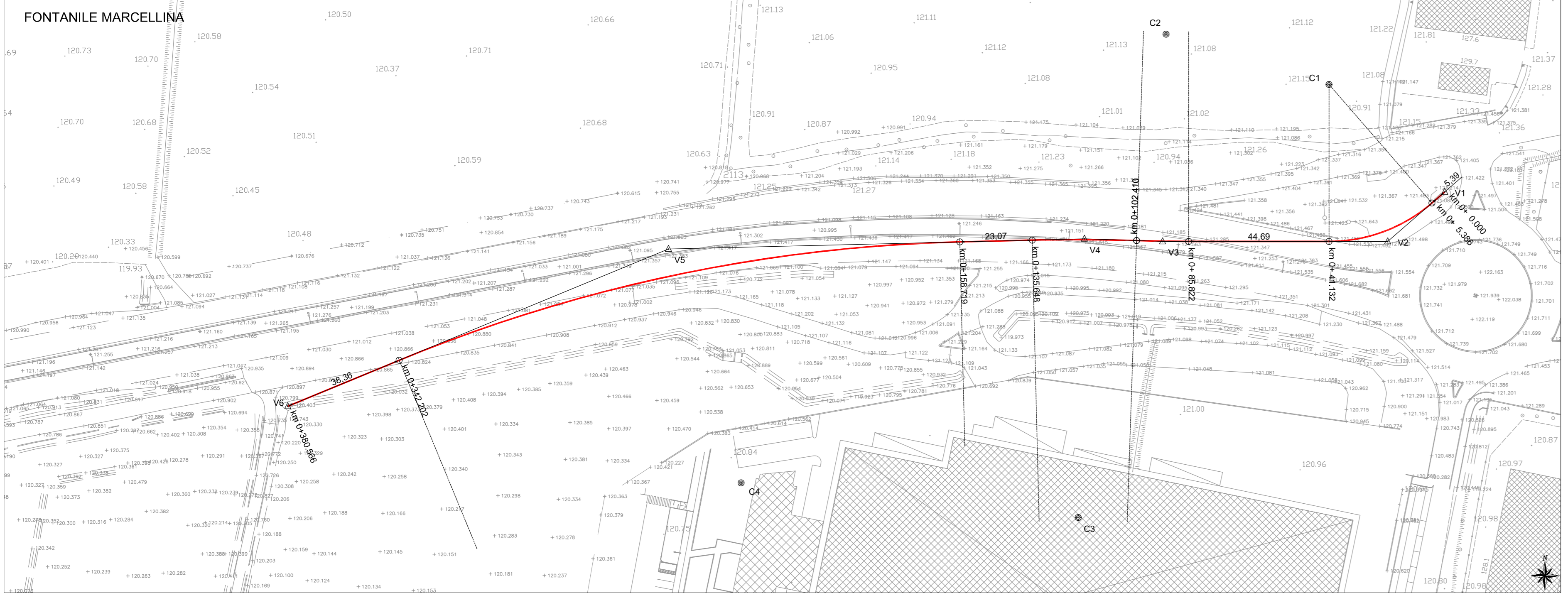

V1	1524902.970	V2	1524884.800	V3	1524813.140	V4	1524786.235	V5	1524655.796	V6	1524534.574
	5038545.474		5038529.700		5038529.700		5038529.700		5038527.264		5038477.200

Deviazione ROGGIA GABBADERA D

Planimetria

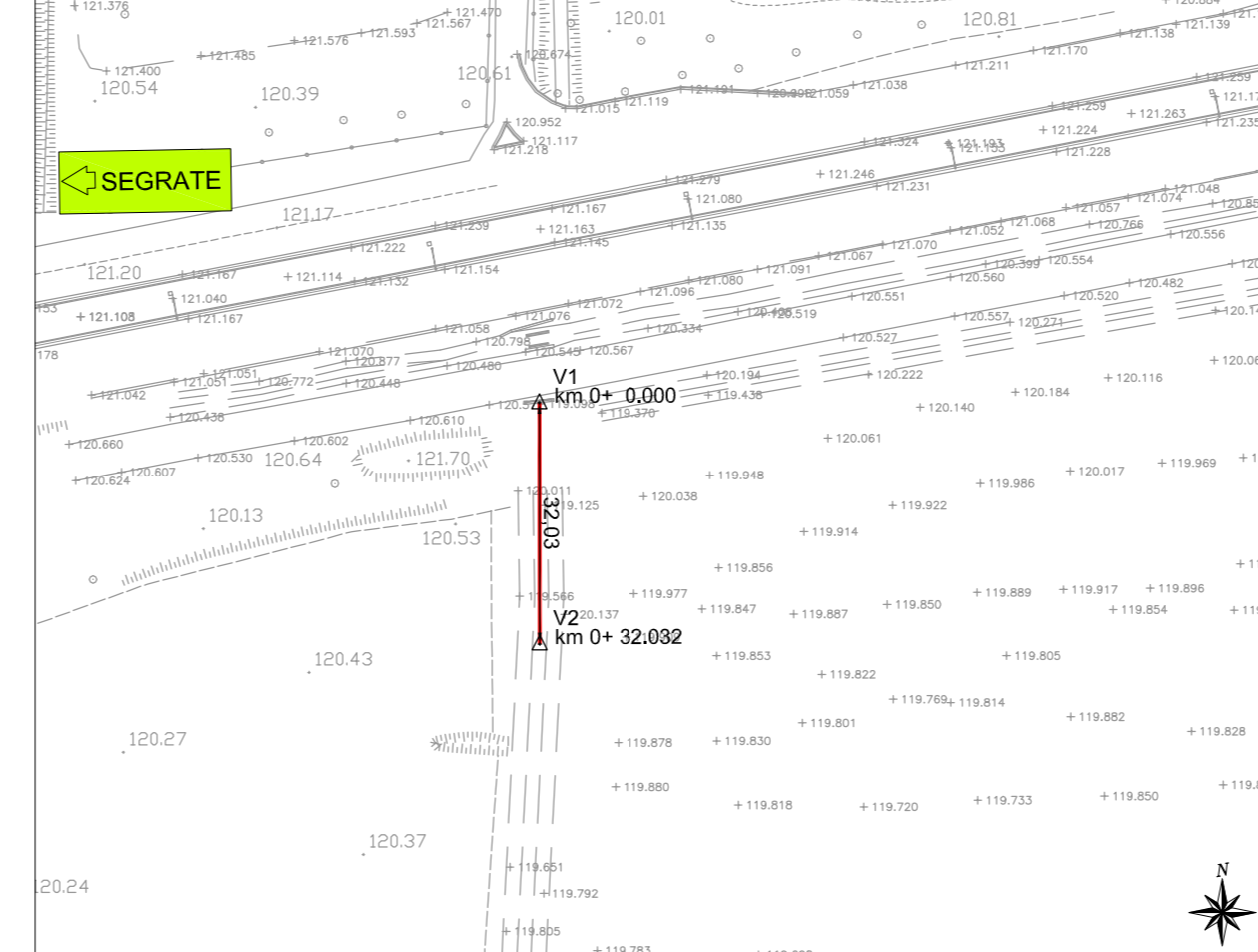

V1	1524208.337	V2	1524208.388
	5038418.630		5038386.586

Deviazione CAVO SPAGNOLO 1

Planimetria

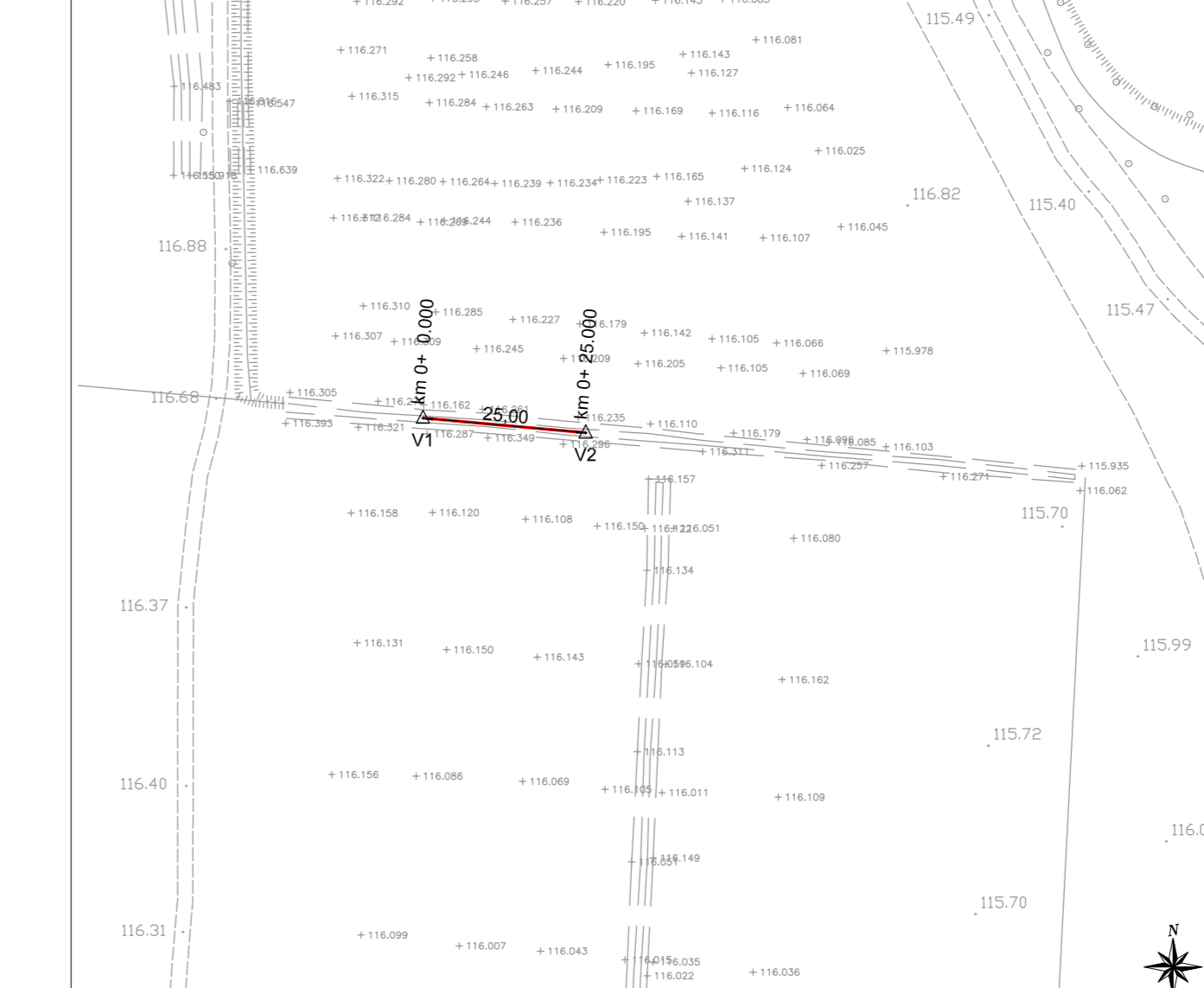

V1	1523820.081	V2	1523854.890
	5037367.319		5037385.072

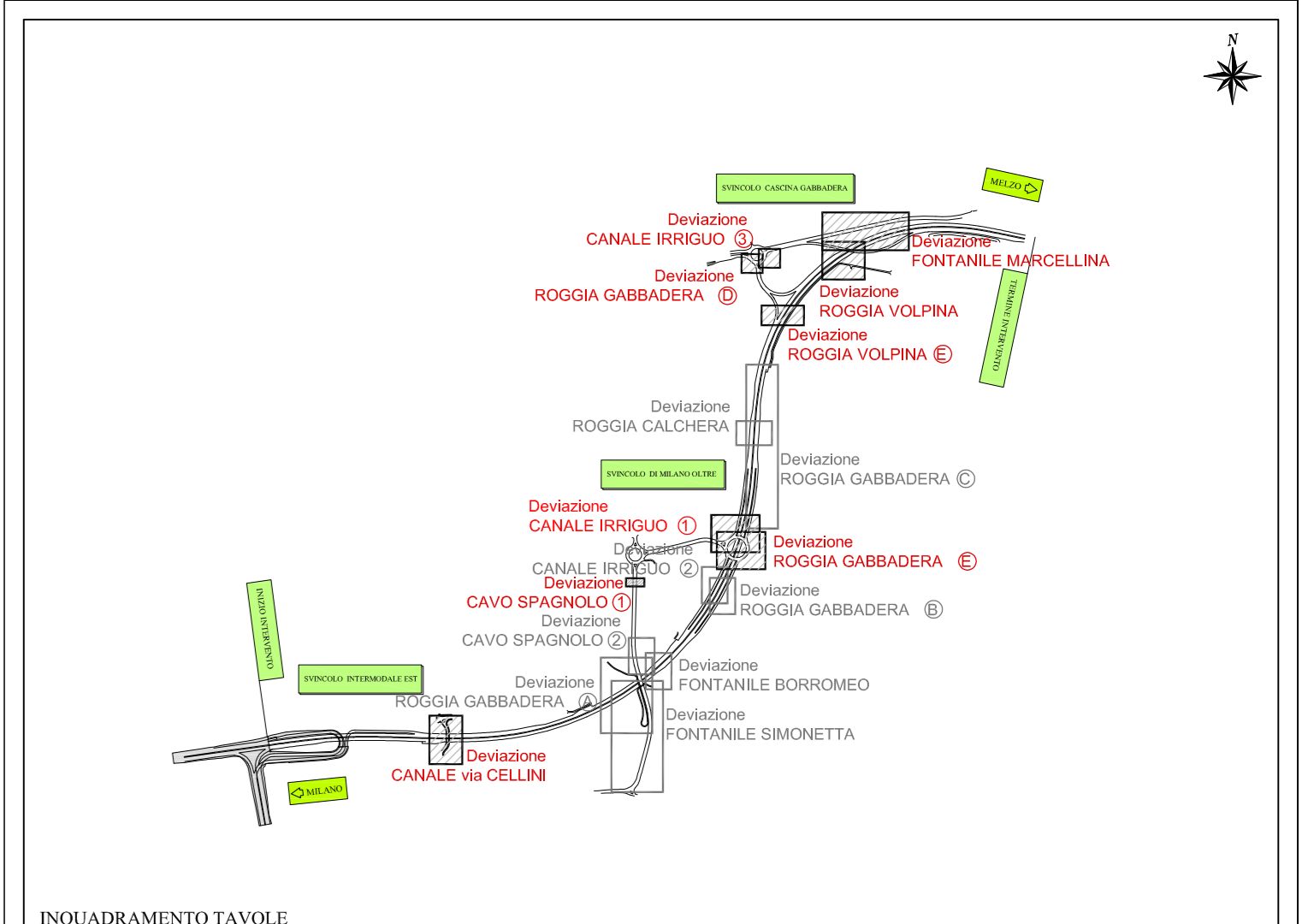

Deviazione CANALE IRRIGUO 1

Planimetria

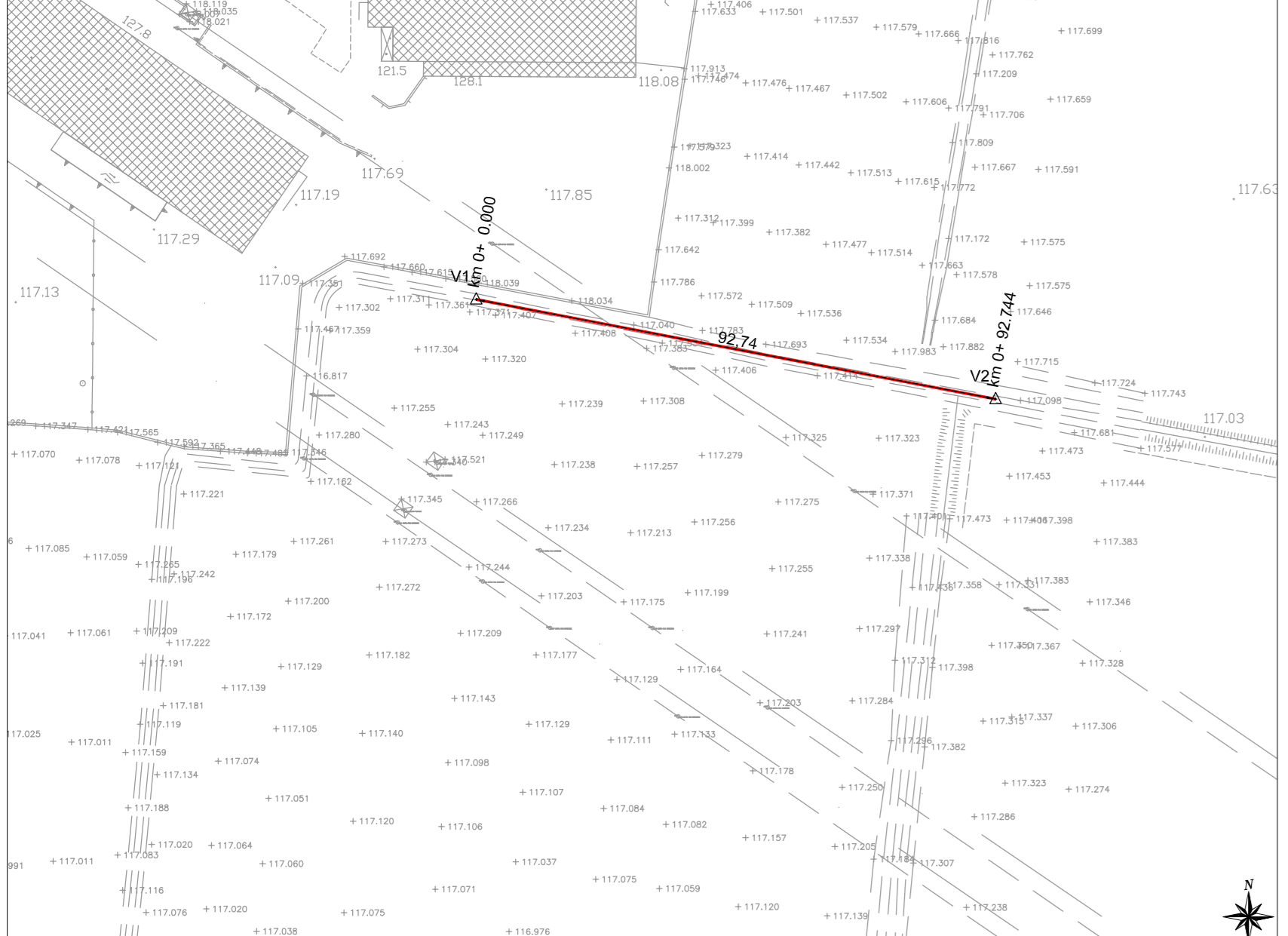

V1	1524128.460	V2	1524219.550
	5037585.460		5037567.978

Deviazione CANALE IRRIGUO 2

Planimetria



V1	1524071.802	V2	1524071.328	V3	1524091.806	V4	1524105.572	V5	1524098.942
	5037509.498		5037510.064		5037516.402		5037561.478		5037573.771

Deviazione ROGGIA GABBADERA E

Planimetria

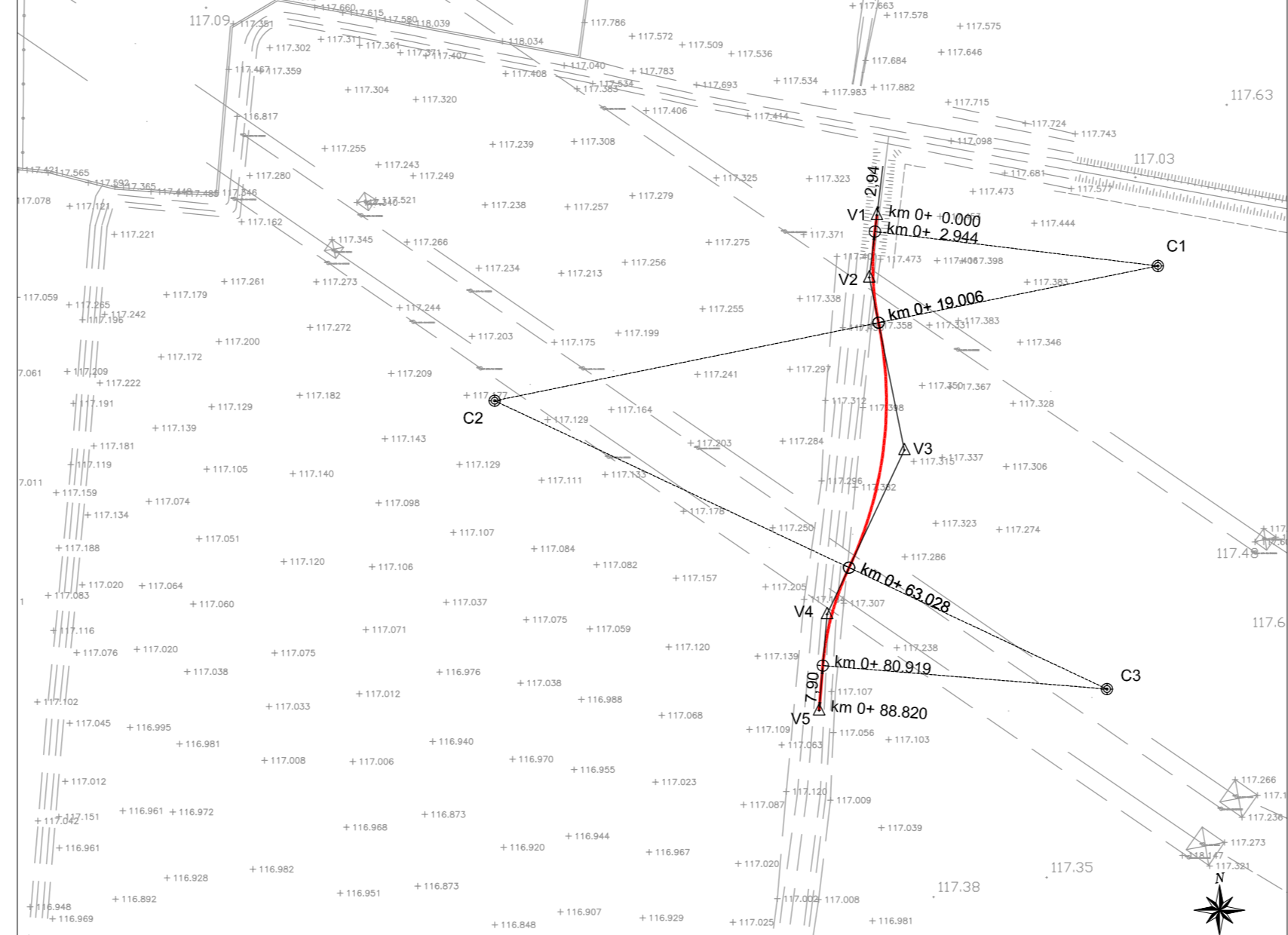

V1	1524018.918	V2	1524009.588	V3	1524016.741	V4	1524020.175	V5	1524020.782
	5037544.752		5037543.791		5037513.513		5038404.708		5037467.824

Deviazione CANALE IRRIGUO 3

Planimetria

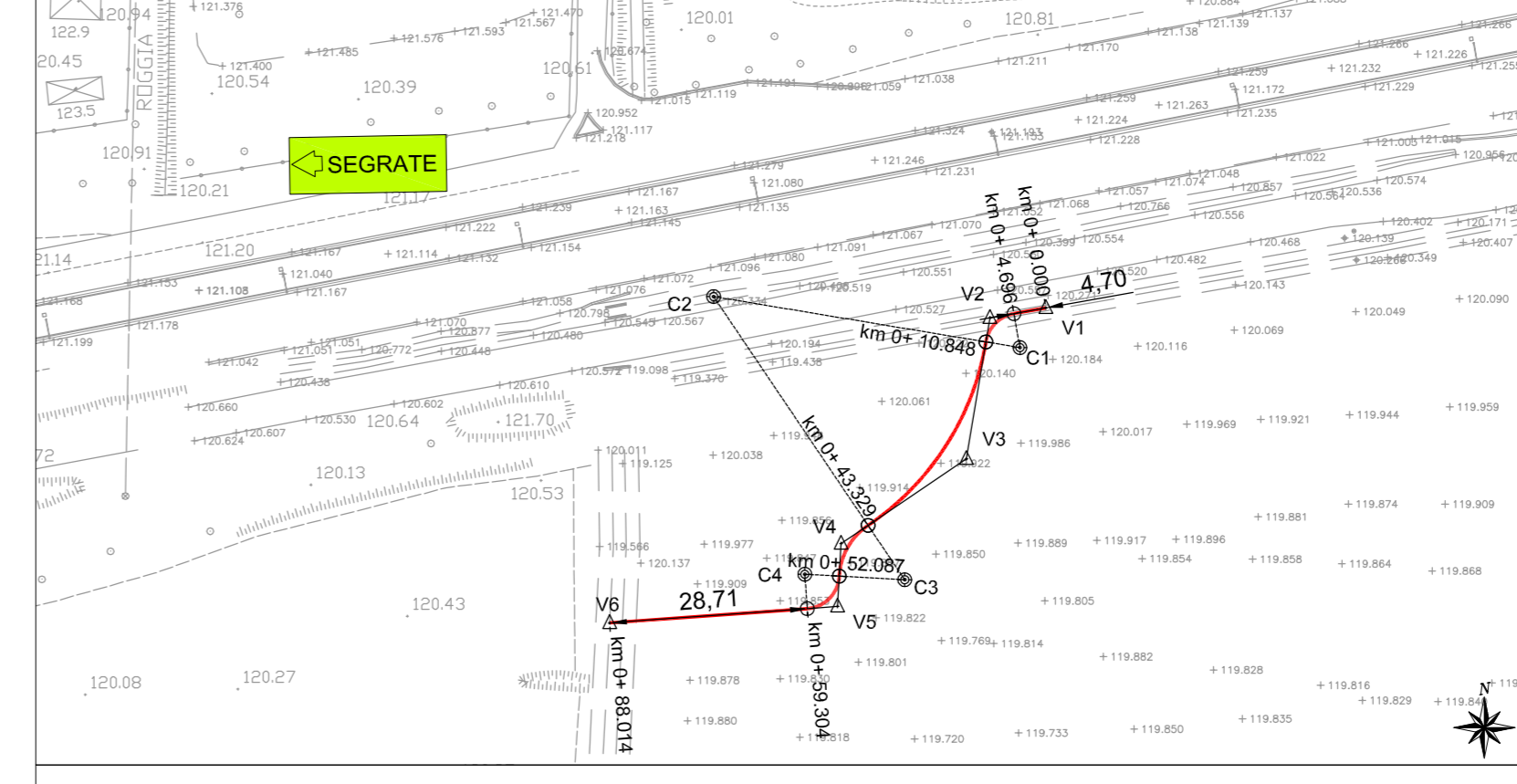

V1	1524270.383	V2	1524292.280	V3	1524258.876	V4	1524240.713	V5	1524241.211
	5038427.486		5038426.090		5038405.652		5038393.341		5038384.236

WESTFIELD MILAN S.p.a.
C.so Giacomo Matteotti, 10
20121 Milano

ACCORDO DI PROGRAMMA
(APPROVATO CON D.P.G.R. DEL 22.05.2009 N.5095)
PRIMO ATTO INTEGRATIVO
(APPROVATO CON D.P.G.R. DEL 29.03.2010 N.3148)

**POTENZIAMENTO DELLA S.P. N.103
"ANTICA DI CASSANO"
1° LOTTO - 2° STRALCIO
TRATTA B**

PROGETTO ESECUTIVO

STUDI E INDAGINI IDROLOGIA E IDRAULICA Planimetrie di tracciamento ricostruzione reticolo idrico esistente Tav.2/2	Cod. Elaborato: B.02.02.06																									
CODICE WM: WM-ERR-TB-00-M2-C-52048	Scala: 1:1000																									
<table border="1" style="width: 100%;"> <tr> <th>Redatto</th> <th>Convalidato</th> <th>Approvato</th> <th>Data:</th> </tr> <tr> <td>TERRIBILE</td> <td>VISCHIONI</td> <td>RINALDI</td> <td>Maggio 2015</td> </tr> </table>	Redatto	Convalidato	Approvato	Data:	TERRIBILE	VISCHIONI	RINALDI	Maggio 2015																		
Redatto	Convalidato	Approvato	Data:																							
TERRIBILE	VISCHIONI	RINALDI	Maggio 2015																							
<table border="1" style="width: 100%;"> <tr> <th>Revisioni</th> <th>Redatto</th> <th>Convalidato</th> <th>Approvato</th> <th>DATA:</th> </tr> <tr> <td>A</td> <td>TERRIBILE</td> <td>VISCHIONI</td> <td>RINALDI</td> <td>VERIFICA - SETT. 2015</td> </tr> <tr> <td>B</td> <td></td> <td></td> <td></td> <td></td> </tr> <tr> <td>C</td> <td></td> <td></td> <td></td> <td></td> </tr> <tr> <td>D</td> <td></td> <td></td> <td></td> <td></td> </tr> </table>	Revisioni	Redatto	Convalidato	Approvato	DATA:	A	TERRIBILE	VISCHIONI	RINALDI	VERIFICA - SETT. 2015	B					C					D					
Revisioni	Redatto	Convalidato	Approvato	DATA:																						
A	TERRIBILE	VISCHIONI	RINALDI	VERIFICA - SETT. 2015																						
B																										
C																										
D																										

Progettazione: **CIRPA** S.p.A.
C.so Giacomo Matteotti, 10 - 20121 Milano - Tel. 02 4848022 - Fax 02 4848023 - e-mail: info@cirpa.com - P.I. 02 4848022

Il Direttore Tecnico
Dott. **Antonio Rinaldi**

Visto: **WESTFIELD MILAN S.p.a.**
C.so Giacomo Matteotti, 10
20121 Milano