

**PLANIMETRIA CANALETTA**  
**IMPIANTO TRATTAMENTO 4 - RAMO 4B - RAMO 4C**  
 - Scala: 1:1000 -

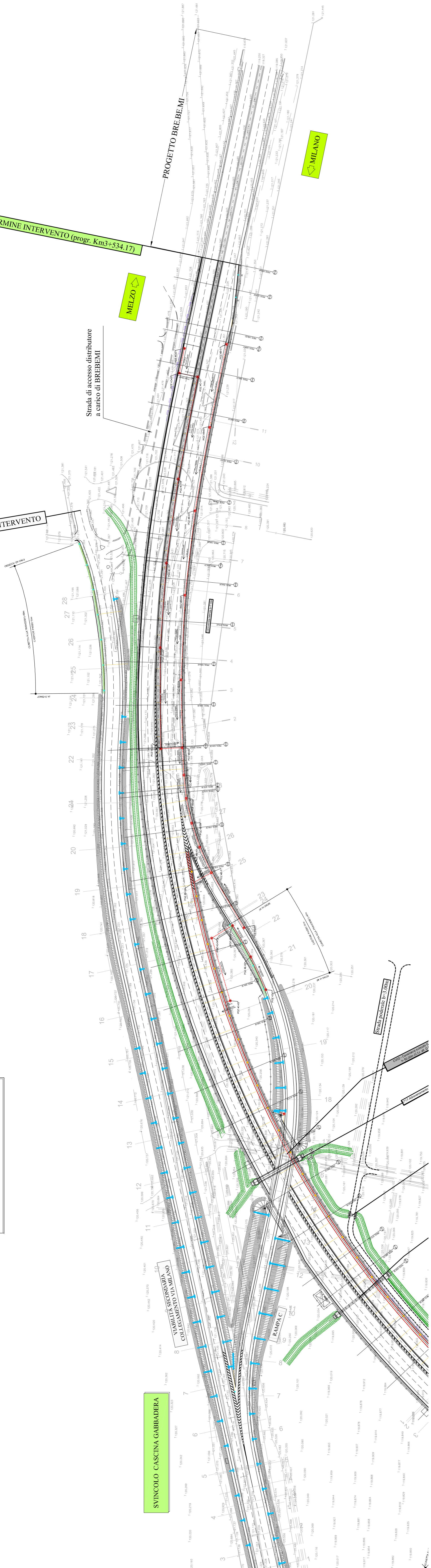

**PROFILO CANALETTA**  
**IMPIANTO TRATTAMENTO 4 - RAMO 4B**  
 - Scala: 1:1000/1:100 -

| TRATTI    | PROZZETTI - SEZIONI | COORDINATA EST | COORDINATA NORD |
|-----------|---------------------|----------------|-----------------|
| 503874.86 | 4B-1                | 1524993.87     | 4B-1            |
| 503848.87 | 4B-2                | 1524950.88     | 4B-2            |
| 503843.51 | 4B-3                | 1524901.64     | 4B-3            |
| 503836.41 | 4B-4                | 1524851.39     | 4B-4            |
| 503830.03 | 4B-5                | 1524795.91     | 4B-5            |
| 503826.08 | 4B-6                | 1524732.20     | 4B-6            |
| 503817.54 | 4B-7                | 1524671.54     | 4B-7            |
| 503809.76 | 4B-8                | 1524610.30     | 4B-8            |
| 503804.09 | 4B-9                | 1524548.29     | 4B-9            |
| 503800.00 | 4B-10               | 1524482.45     | 4B-10           |

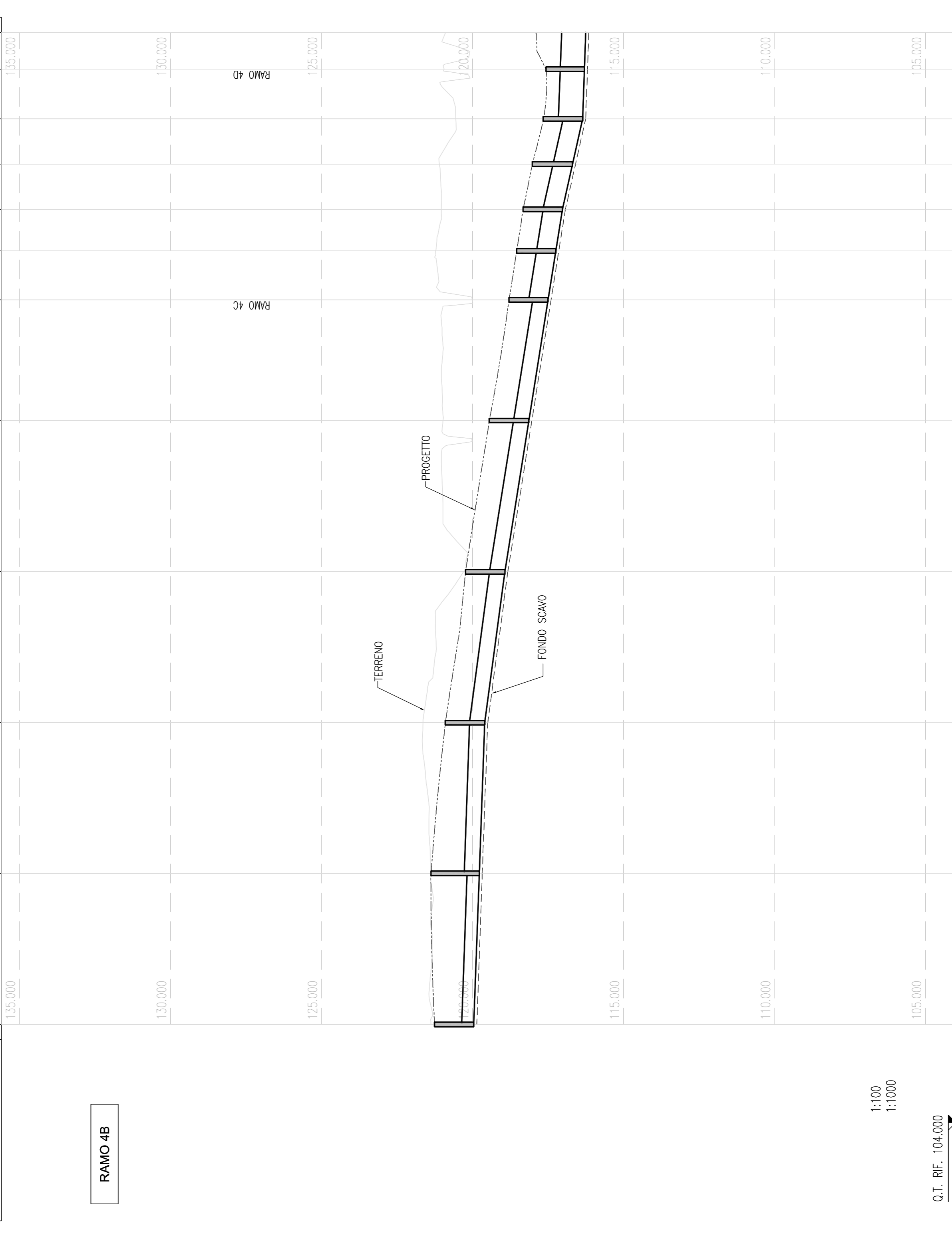

| Q.T. REF. 1:04.000 | RAVANO         | RAVANO         | RAVANO         | RAVANO         |
|--------------------|----------------|----------------|----------------|----------------|
|                    | PELO CORR. SNE | PELO CORR. SNE | PELO CORR. SNE | PELO CORR. SNE |
| 121.290            | 121.271        | 120.898        | 120.898        | 120.898        |
| 119.958            | 119.958        | 120.000        | 120.000        | 120.000        |
| 119.278            | 119.278        | 50.000         | 50.000         | 50.000         |
| 118.530            | 118.530        | 150.000        | 150.000        | 150.000        |
| 118.229            | 118.229        | 120.898        | 120.898        | 120.898        |
| 117.503            | 117.503        | 118.229        | 118.229        | 118.229        |
| 117.246            | 117.246        | 118.530        | 118.530        | 118.530        |
| 116.892            | 116.892        | 118.229        | 118.229        | 118.229        |
| 116.306            | 116.306        | 118.019        | 118.019        | 118.019        |
| 116.250            | 116.250        | 117.586        | 117.586        | 117.586        |
| 116.250            | 116.250        | 117.586        | 117.586        | 117.586        |
| 116.250            | 116.250        | 117.586        | 117.586        | 117.586        |

**PROFILO CANALETTA**  
**IMPIANTO TRATTAMENTO 4 - RAMO 4C**  
 - Scala: 1:1000/1:100 -

| TRATTI    | PROZZETTI - SEZIONI | COORDINATA EST | COORDINATA NORD |
|-----------|---------------------|----------------|-----------------|
| 503899.74 | 4C-1                | 1524997.46     | 4C-1            |
| 503892.75 | 4C-2                | 1524982.87     | 4C-2            |
| 503891.90 | 4C-3                | 1524980.63     | 4C-3            |
| 503891.04 | 4C-4                | 1524970.89     | 4C-4            |
| 503891.04 | 4C-5                | 1524970.89     | 4C-5            |
| 503891.04 | 4C-6                | 1524970.89     | 4C-6            |
| 503891.04 | 4C-7                | 1524970.89     | 4C-7            |
| 503891.04 | 4C-8                | 1524970.89     | 4C-8            |
| 503891.04 | 4C-9                | 1524970.89     | 4C-9            |
| 503891.04 | 4C-10               | 1524970.89     | 4C-10           |

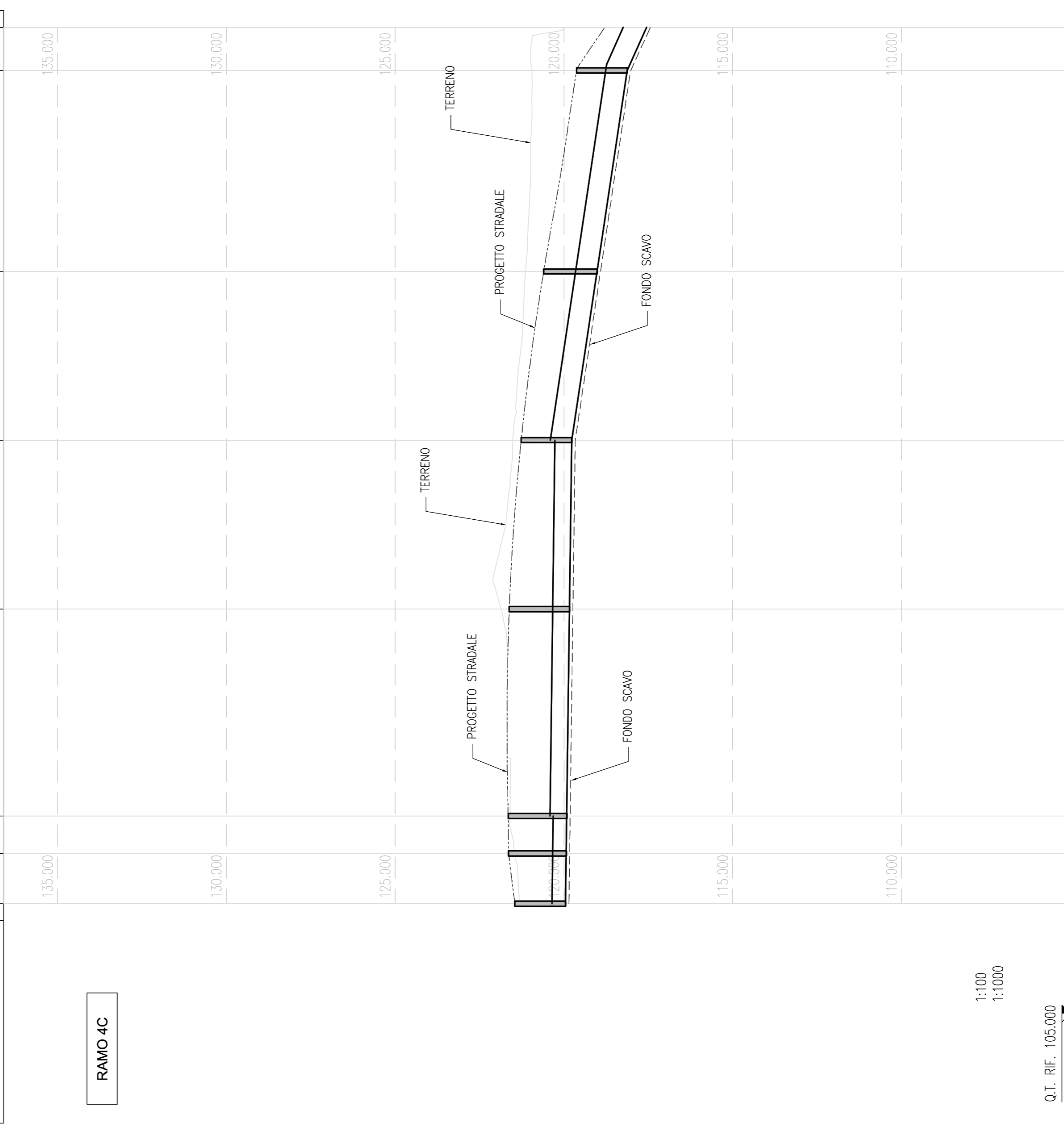

| Q.T. REF. 1:05.000 | RAVANO         | RAVANO         | RAVANO         | RAVANO         |
|--------------------|----------------|----------------|----------------|----------------|
|                    | PELO CORR. SNE | PELO CORR. SNE | PELO CORR. SNE | PELO CORR. SNE |
| 121.450            | 121.450        | 121.450        | 121.450        | 121.450        |
| 119.958            | 119.958        | 121.450        | 121.450        | 121.450        |
| 119.958            | 119.958        | 121.450        | 121.450        | 121.450        |
| 119.958            | 119.958        | 121.450        | 121.450        | 121.450        |
| 119.958            | 119.958        | 121.450        | 121.450        | 121.450        |
| 119.958            | 119.958        | 121.450        | 121.450        | 121.450        |
| 119.958            | 119.958        | 121.450        | 121.450        | 121.450        |
| 119.958            | 119.958        | 121.450        | 121.450        | 121.450        |
| 119.958            | 119.958        | 121.450        | 121.450        | 121.450        |
| 119.958            | 119.958        | 121.450        | 121.450        | 121.450        |

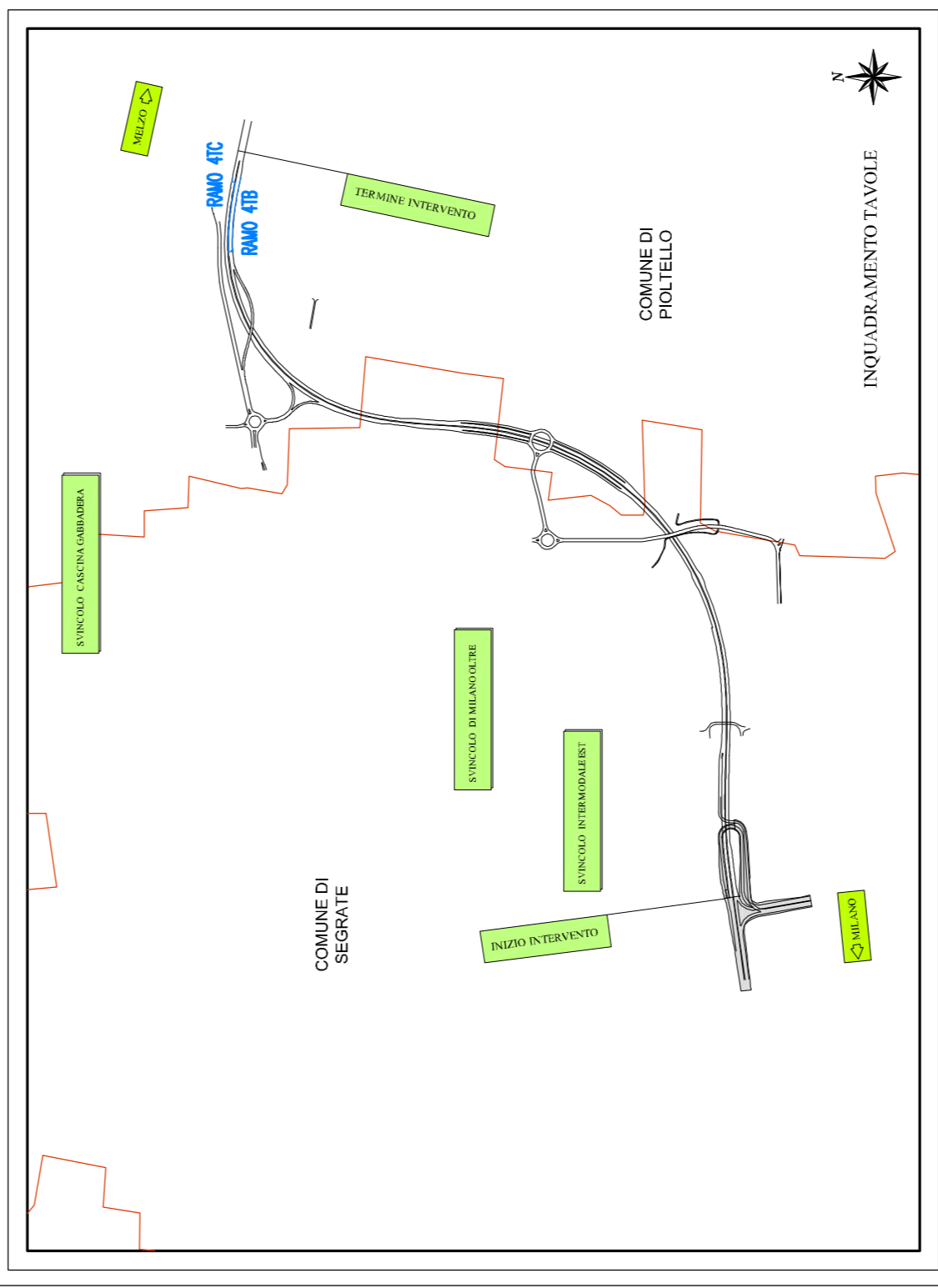

Project Number XXX

ACCORDO DI PROGRAMMA  
 (APPROVATO CON D.P.G.R. DEL 22.05.2009 N.5095)  
 INTERVENTO DI POTENZIAMENTO E STRALCIO  
 (APPROVATO CON D.P.G.R. DEL 23.03.2010 N.3.148)

POTENZIAMENTO DELLA S.P. N.103  
 "ANTICA DI CASSANO"  
 1° LOTTO - 2° STRALCIO  
 TRATTA B

**PROGETTO ESECUTIVO**

| Progetto |                    | Cantierista |                         | Data      |             |
|----------|--------------------|-------------|-------------------------|-----------|-------------|
| Progetto | PROGETTO ESECUTIVO | Cantierista | WM-ERRI-TB-00-M2-C-8019 | Data      | Maggio 2015 |
| Autore   | IDEA               | Concedente  | CARFANI                 | Approvato |             |
| Autore   | IDEA               | Concedente  | CARFANI                 | Approvato |             |
| Autore   | IDEA               | Concedente  | CARFANI                 | Approvato |             |
| Autore   | IDEA               | Concedente  | CARFANI                 | Approvato |             |
| Autore   | IDEA               | Concedente  | CARFANI                 | Approvato |             |

Westfield MILAN S.p.A.  
 Via Cassanese, 10  
 20121 Milano