

FASE 1:
SCALA 1:200

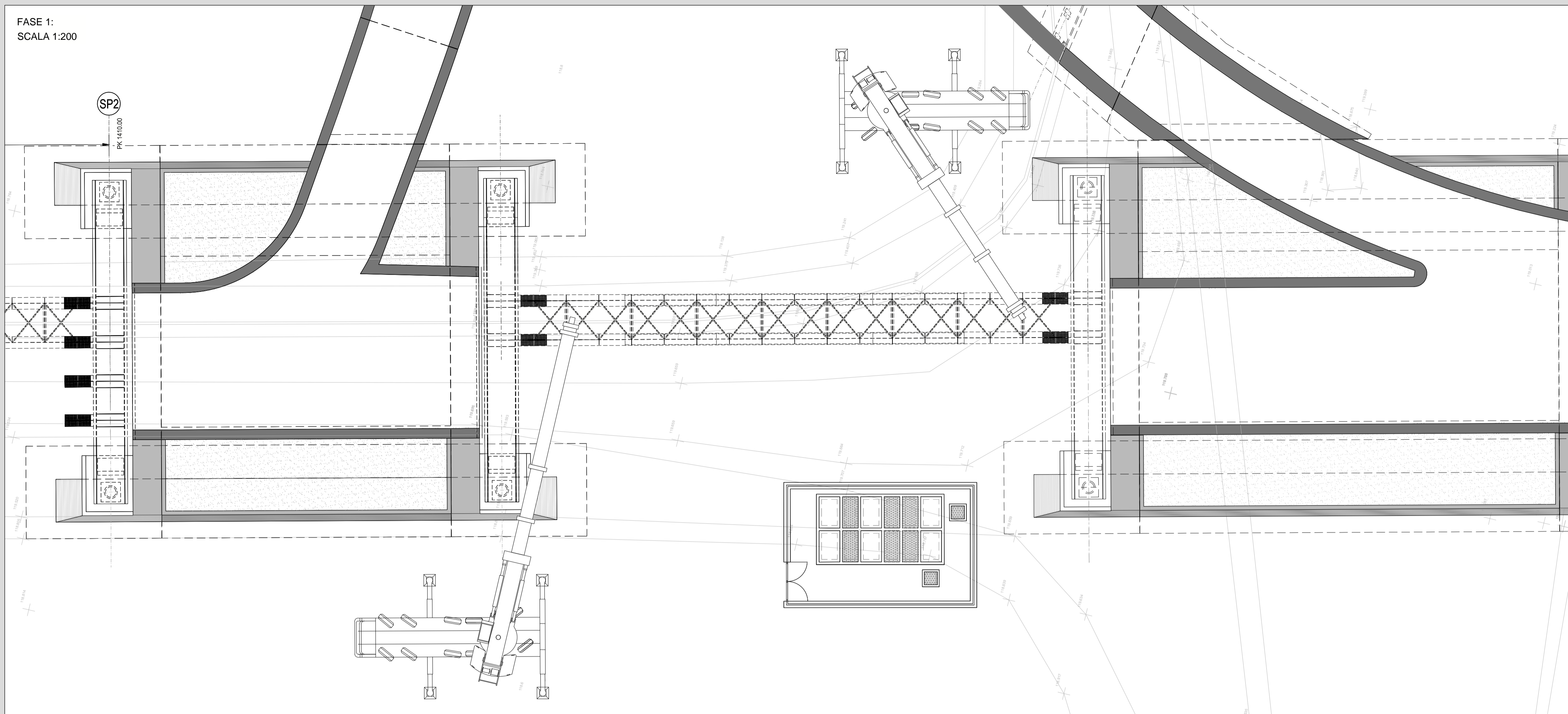

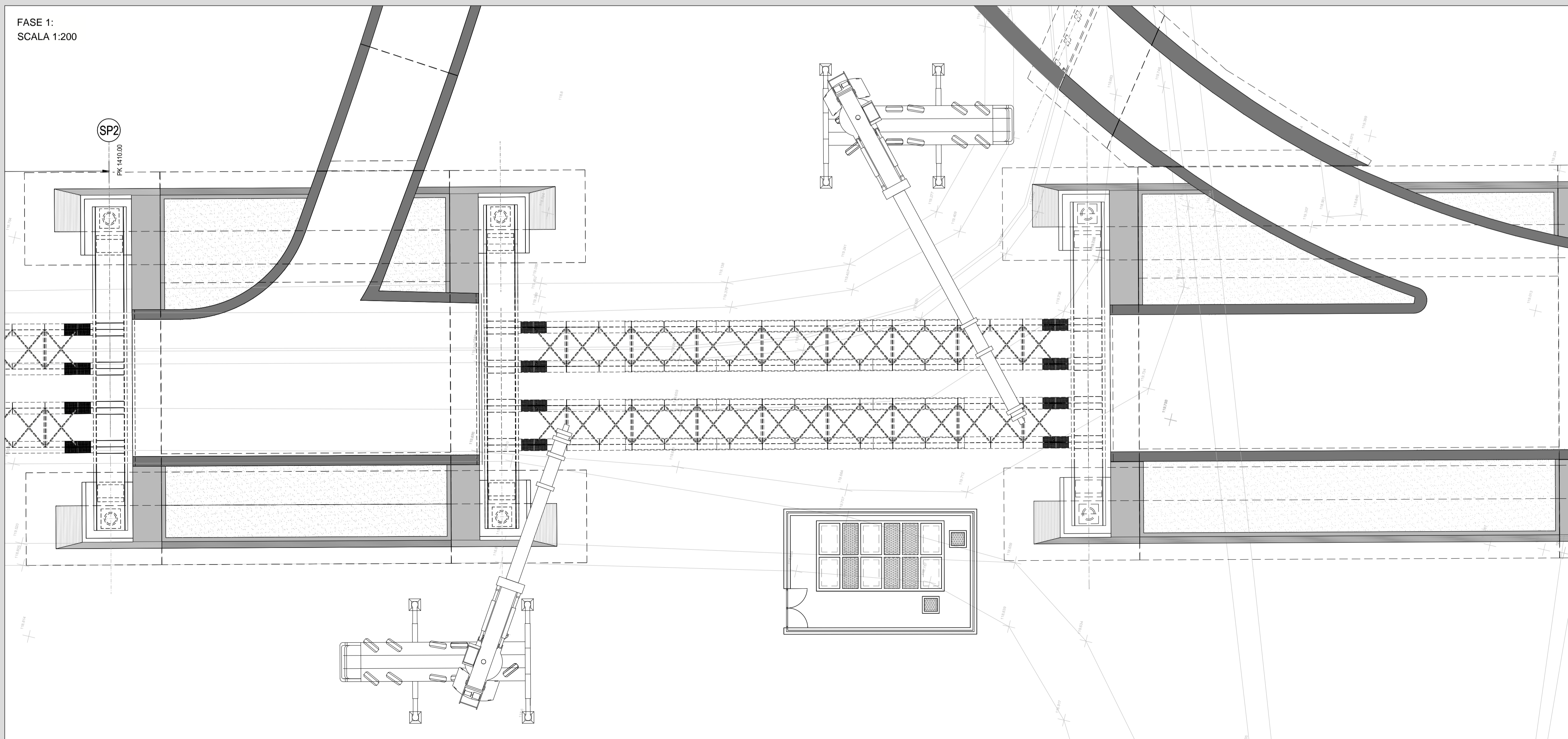







FASE 1:
SCALA 1:200

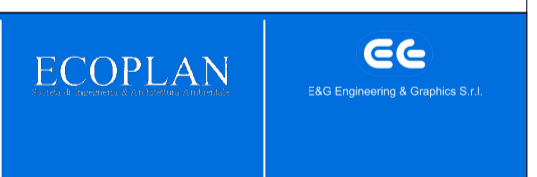
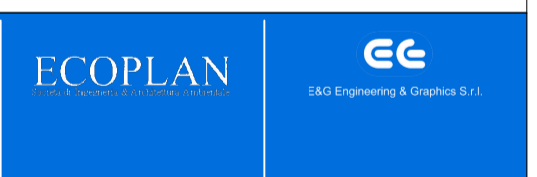

LAVORI DI COLLEGAMENTO TRA LA S.S.11 A MAGENTA E LA TANGENZIALE OVEST DI MILANO
VARIANTE DI ABBIEGRASSO E ADEGUAMENTO IN SEDE DEL TRATTO ABBIEGRASSO-VIGEVANO FINO AL PONTE SUL FIUME TICINO
1° STRALCIO DA MAGENTA A VIGEVANO - TRATTA C

PROGETTO ESECUTIVO

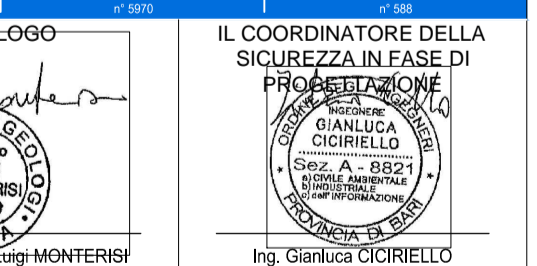
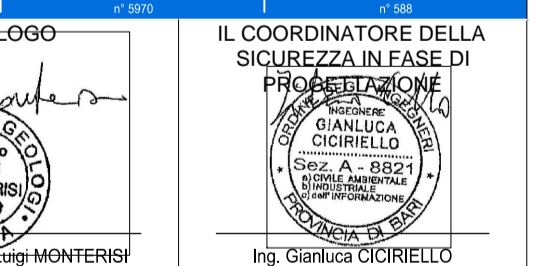
 Ing. Renato Vaira Piazzale Varesini, 4 Trevi (TV) 31040	 Ing. Renato Del Prete Viale degli Alpini, 4 Bari (BA) 70121	 Arch. Nicoletta Fratini Viale degli Alpini, 4 Bari (BA) 70121	 Ing. Gabriele Inocenti Viale degli Alpini, 4 Bari (BA) 70121
 Ing. Renato Vaira Piazzale Varesini, 4 Trevi (TV) 31040	 Prof. Ing. Luigi Montershi Viale degli Alpini, 4 Bari (BA) 70121	 Ing. Gioacchino Angarano Viale degli Alpini, 4 Bari (BA) 70121	 Dott. Geol. Danilo Gallo Viale degli Alpini, 4 Bari (BA) 70121
 Dott. Ing. Giuseppe Danilo MALGERI	 Ing. Valerio BAJETTI	 Prof. Ing. Luigi MONTERSISI	 Ing. Gianluca CICIRELLO

NA23

N - CANTIERIZZAZIONE
NA - CANTIERIZZAZIONE OPERE MAGGIORI
VI03 - VADOTTO N.03 - VARO

CODICE PROGETTO	NOME FILE	REVISIONE	SCALA:
PROGETTO	NA23-T00CA01CANPE16_A.dwg	A	1:200
PROG. N. PROG.	CODICE ELAB.	DATA	REDDATO
LO203 E 1801	T00CA01CANPE16	MAGGIO 2019	ING. GAETANO RANIERI
C			ING. VALERIO BAJETTI
B			
A	EMMISSIONE A SEGUITO DI RAPPORTO INTERMEDIO DI VERIFICA ITC-C186001-01-ATF-RA-00001		
REV.	DESCRIZIONE	DATA	VERIFICATO
			APPROVATO