

PIANTA SPICCATO - Scala 1:50

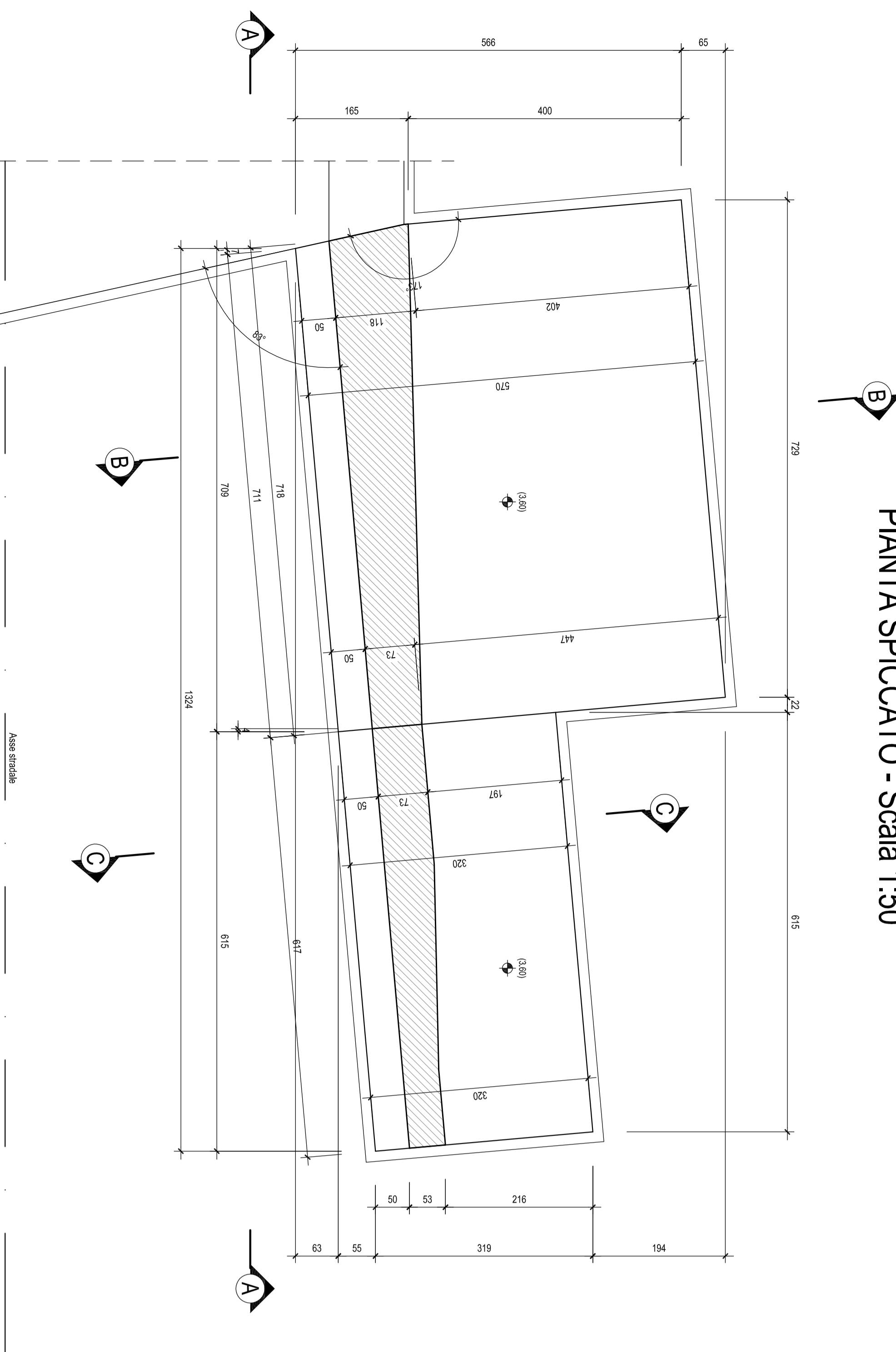

VISTA DALL'ALTO - Scala 1:50

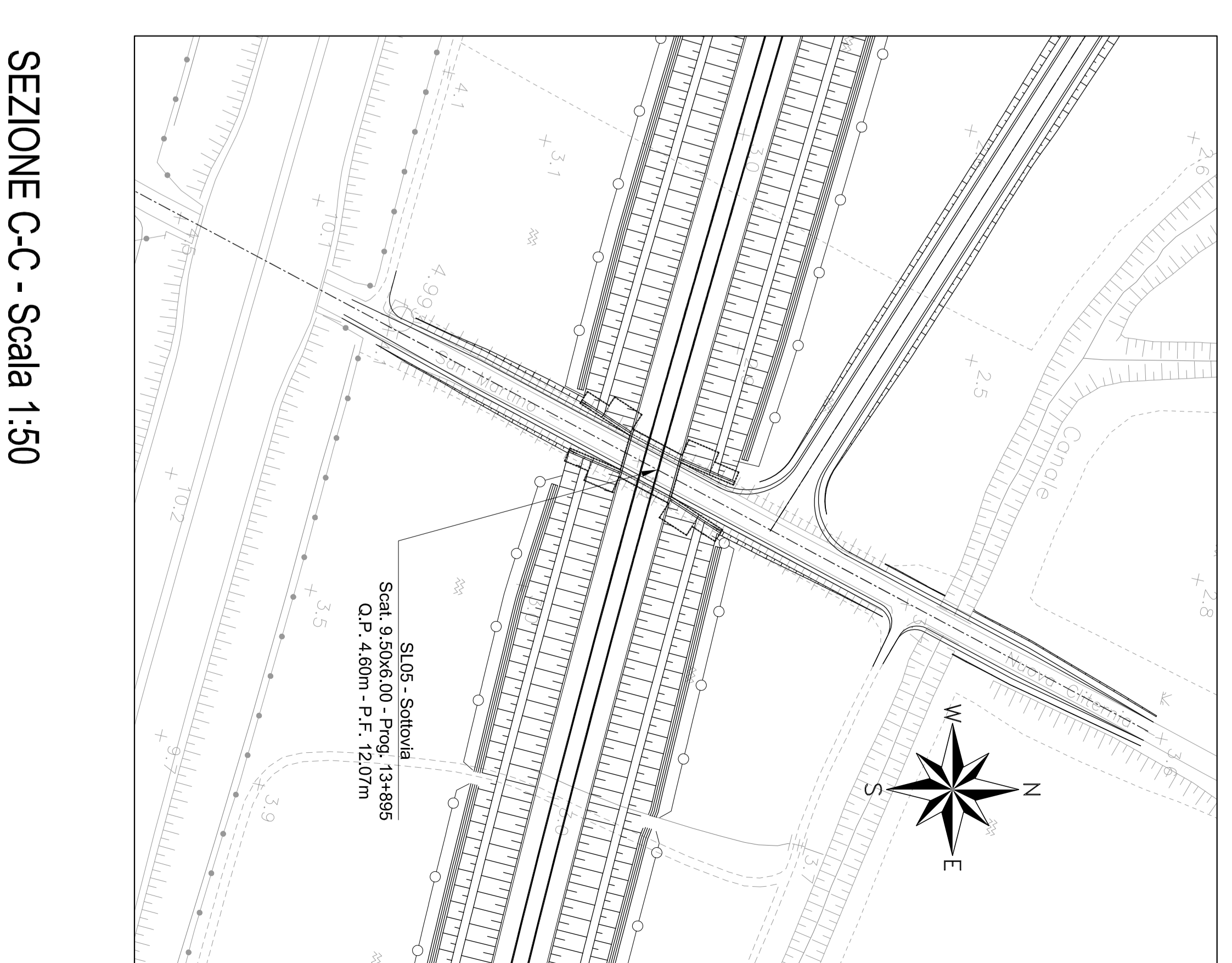
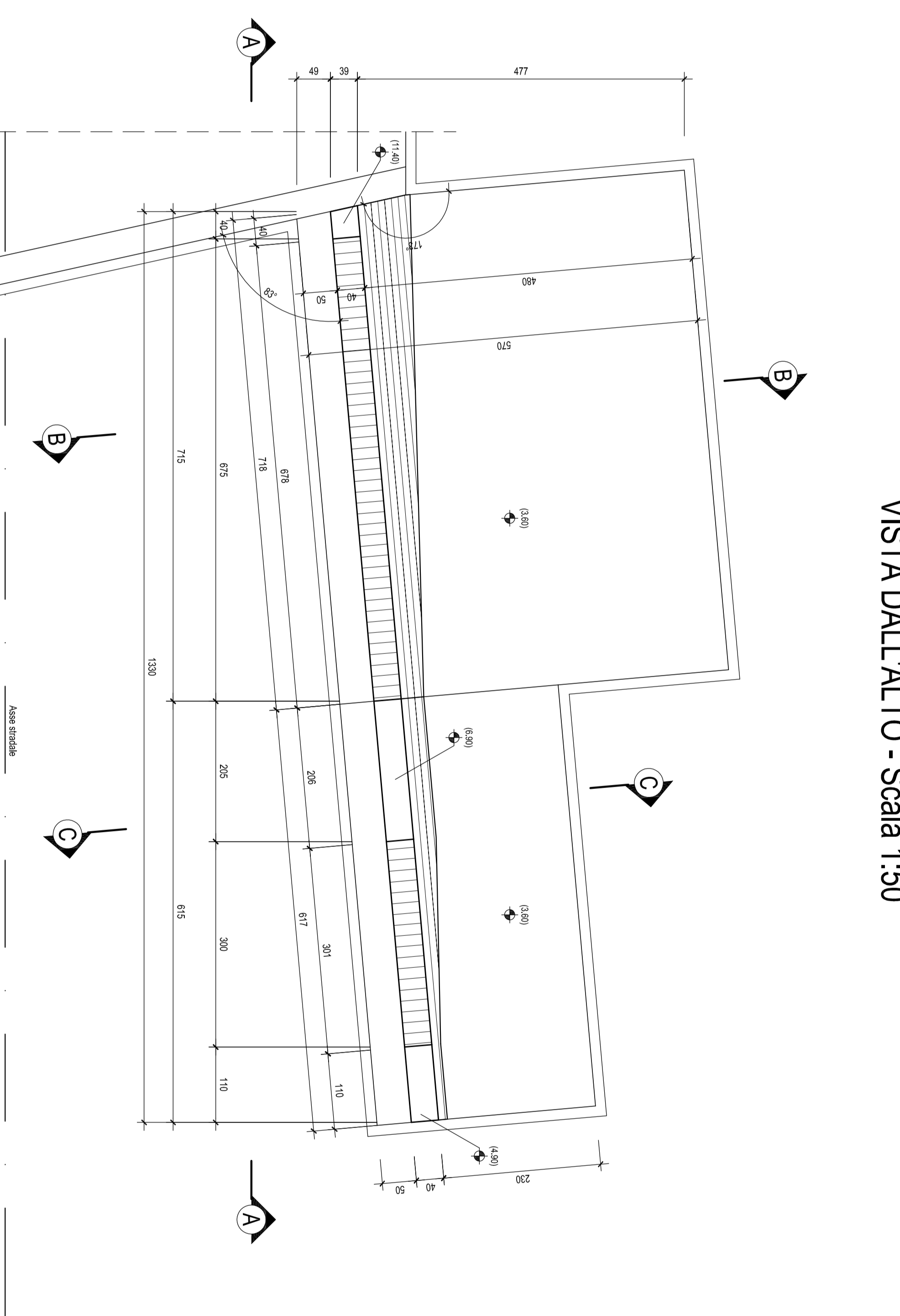

SEZIONE C-C - Scala 1:50

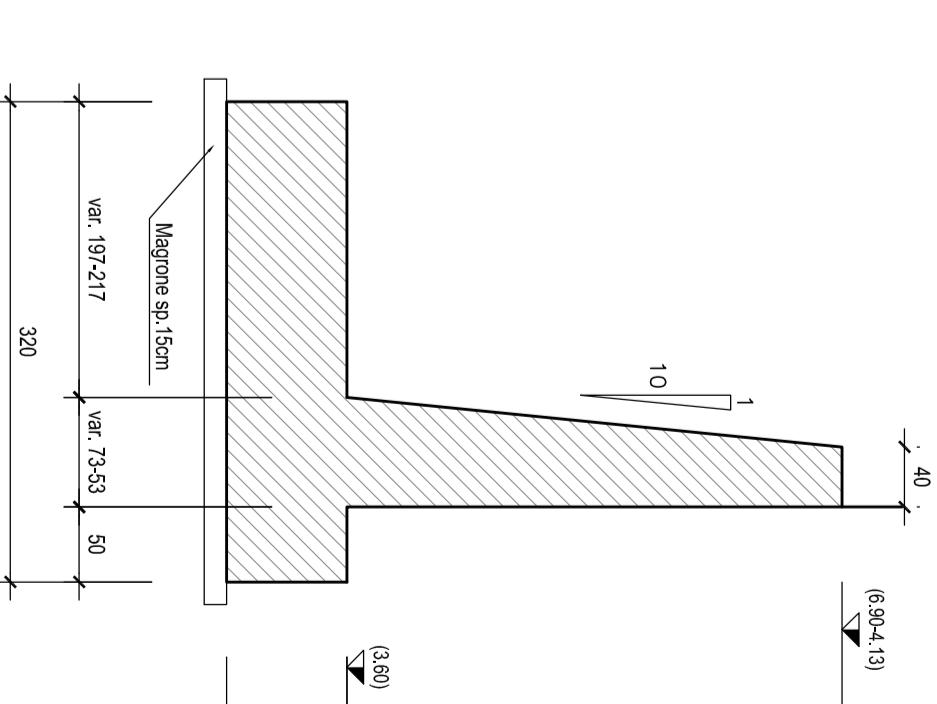
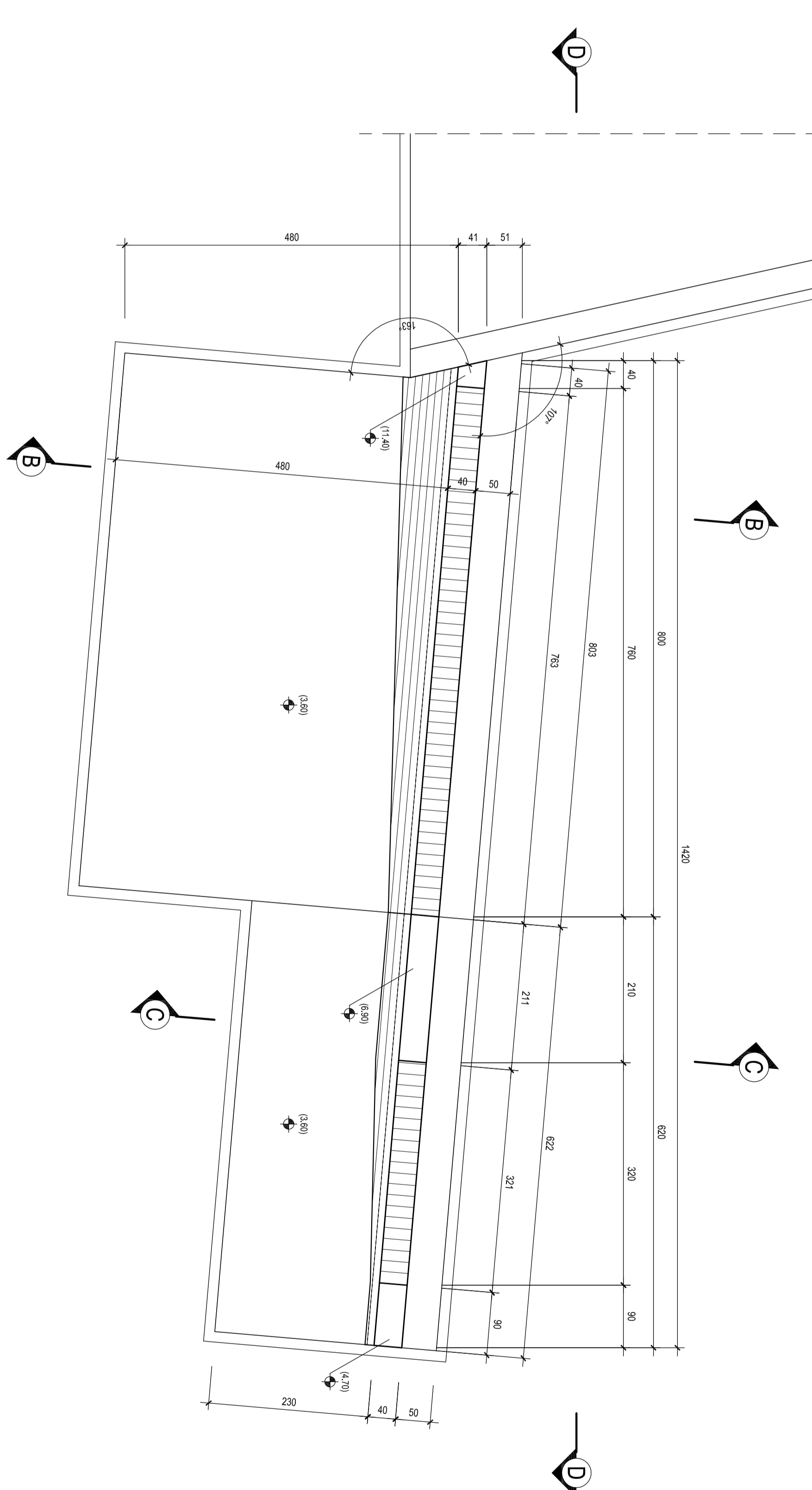
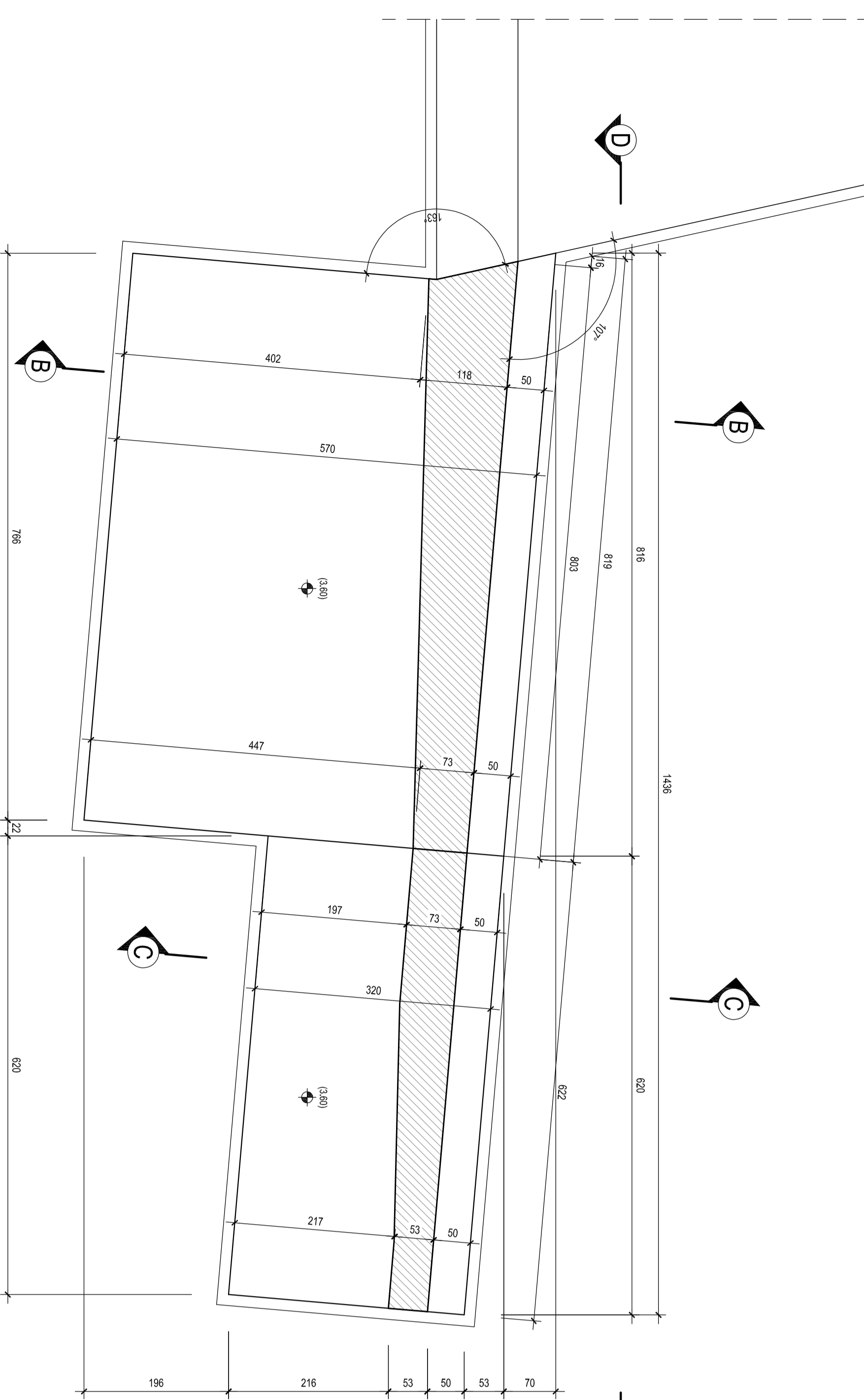

VISTA D-D - Scala 1:50

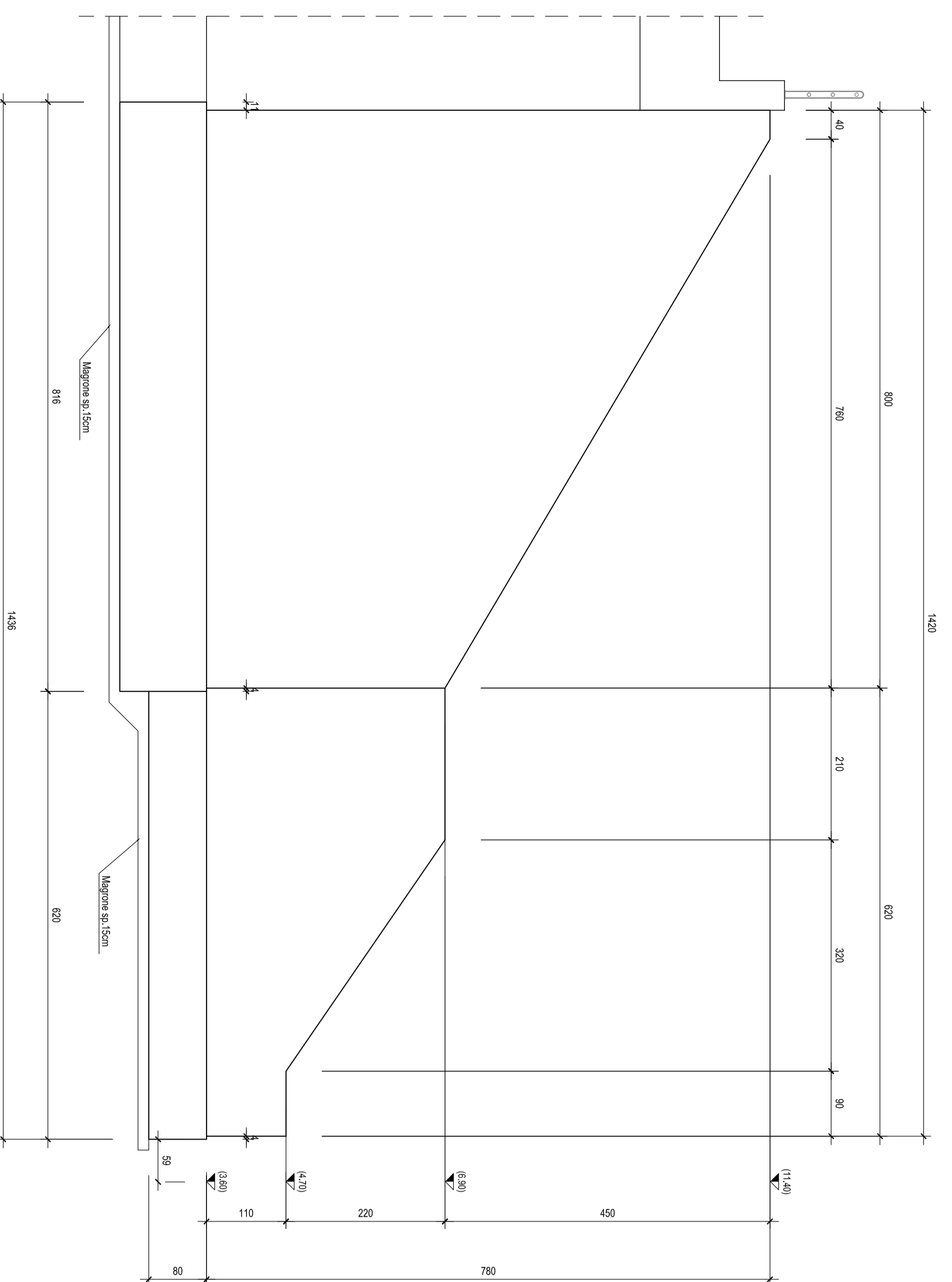

VISTA A-A - Scala 1:50

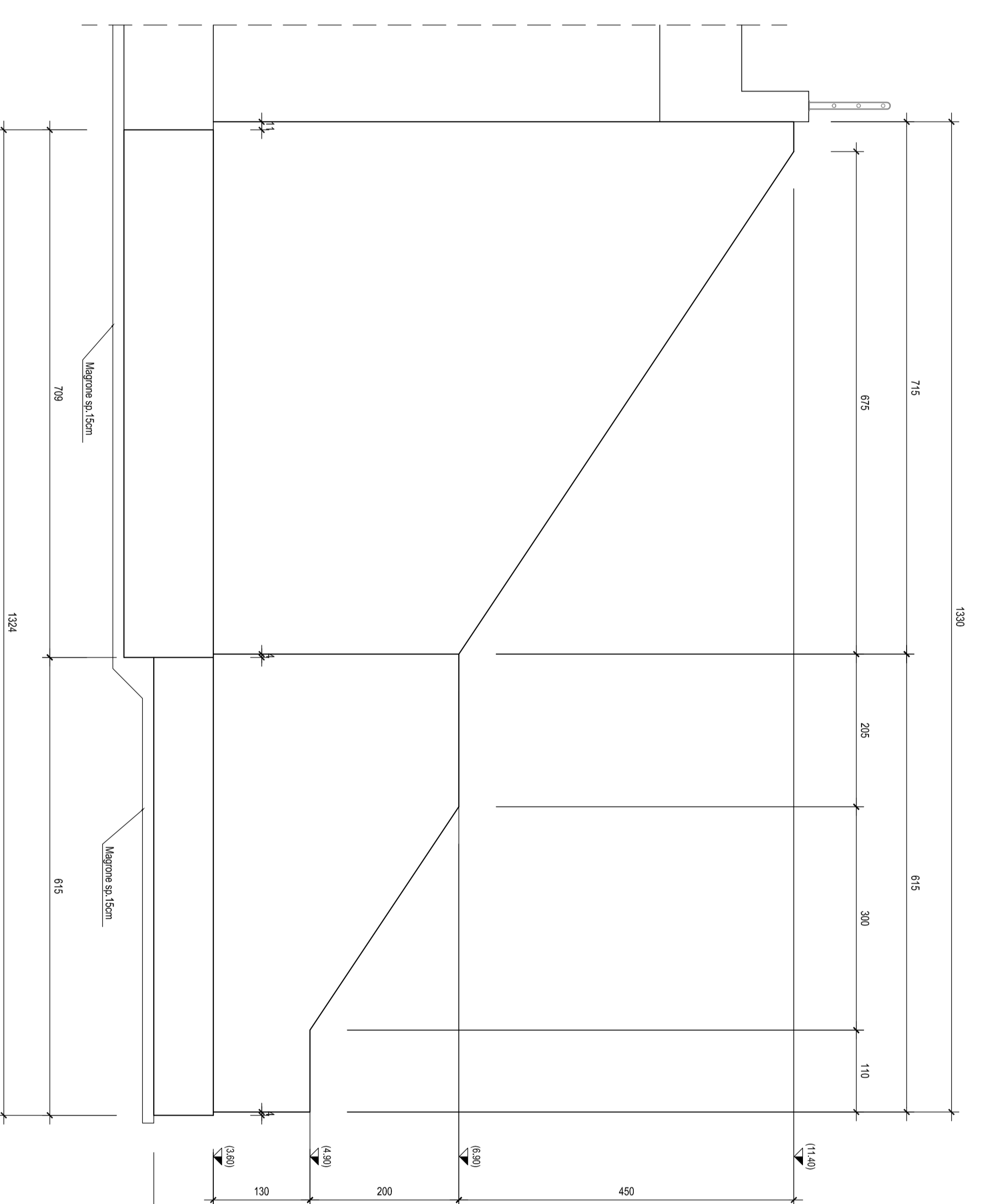

SEZIONE B-B - Scala 1:50

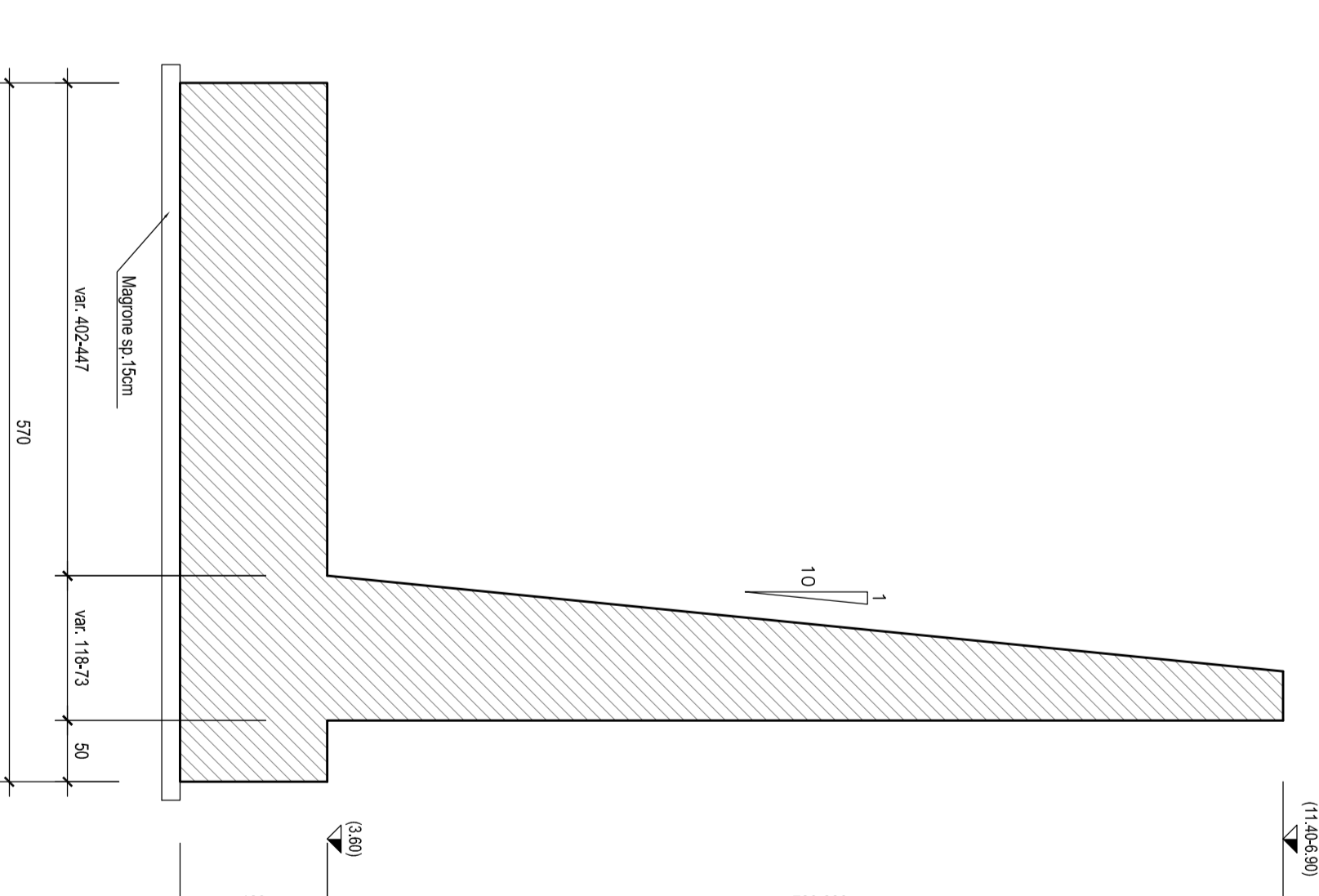

N.B.: Per la tabella materiali e incidenze armature delle Opere Civili si rimanda all'elaborato LI0202 D78 RH OC00000 001

COMITENTE:			
PROGETTAZIONE:			
<p>INFRASTRUTTURE FERROVIARIE STRATEGICHE DEFINITE DALLA LEGGE OBIETTIVO 4.4301</p>			
<p>U.O. INFRASTRUTTURE SUD</p>			
<p>PROGETTO DEFINITIVO</p>			
<p>LINEA PESCARA - BARI</p>			
<p>RADDOPPIO DELLA TRATTA FERROVIARIA TERMOLI - LESINA</p>			
<p>LOTTI 2 e 3 - RADDOPPIO TERMOLI - RIPALTA</p>			
<p>Opere D'Arti Minori - Solivola e Galliera Artificiali</p>			
<p>S.U.5 km 13+854 VASILLITA NV11</p>			
<p>Caratteristiche man. Inv.2</p>			
COMMESSA		LOTTO	FASE
L1102		02	D
Riv.		02	D
Deduzione tecnica		76	B
Riv.		02	D
Data		15/05/00	
Verificato		002	A
Data			
Approvato			
Data			
Autorezzato			
Data			
L. E. B. N.:		SCALA:	
		1:50	