

PIANTA SPICCATO - Scala 1:50

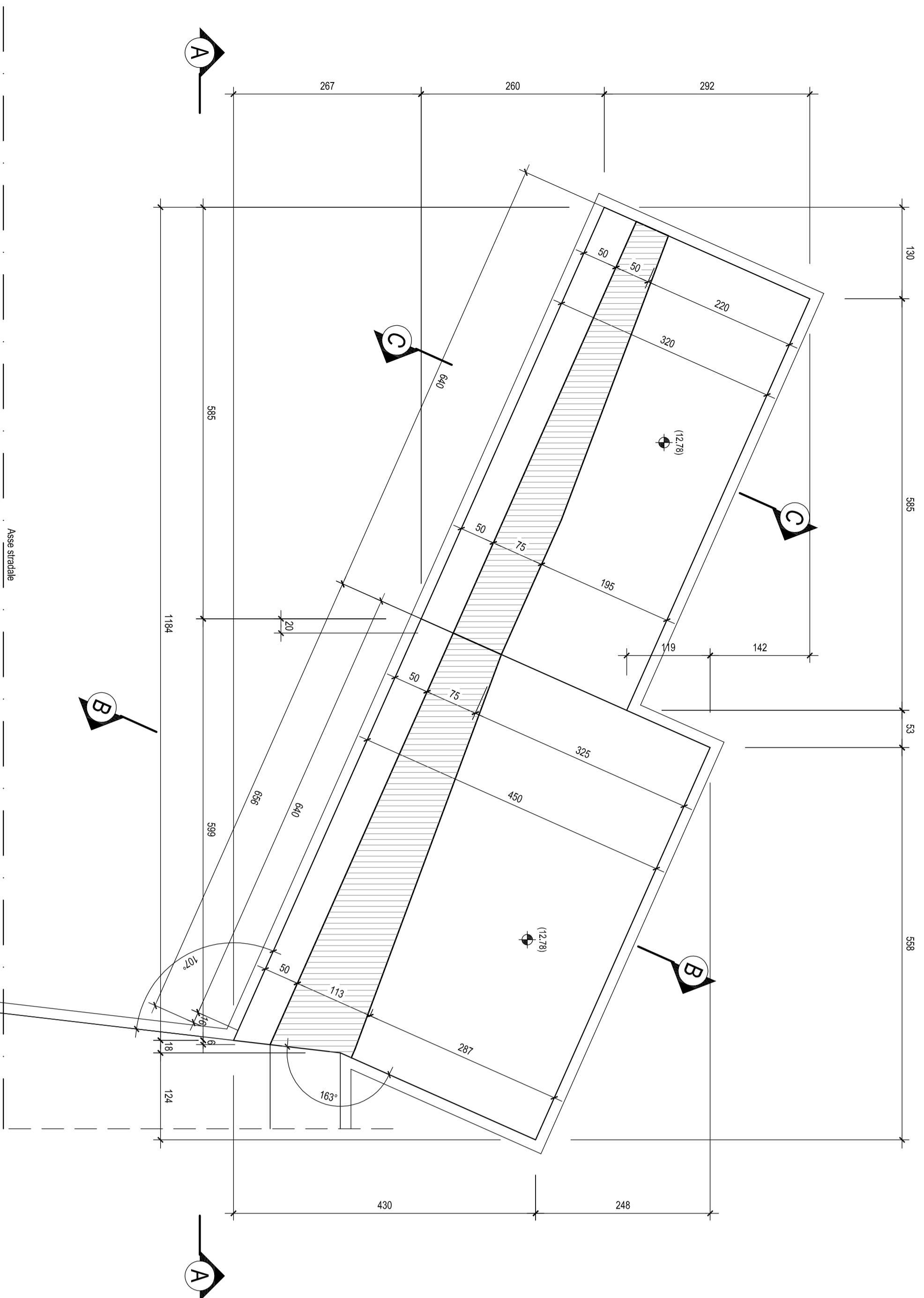

VISTA DALL'ALTO - Scala 1:50

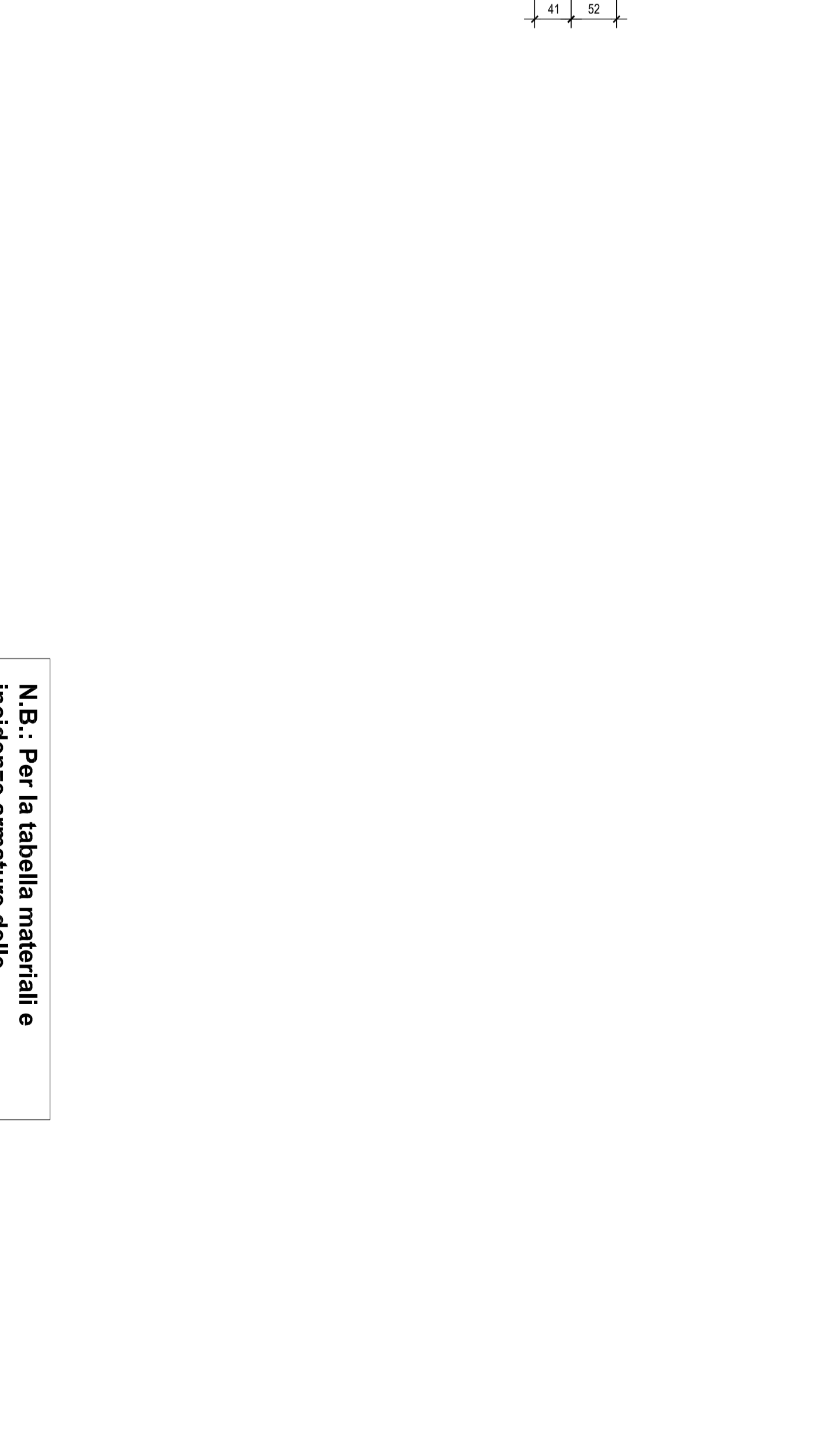
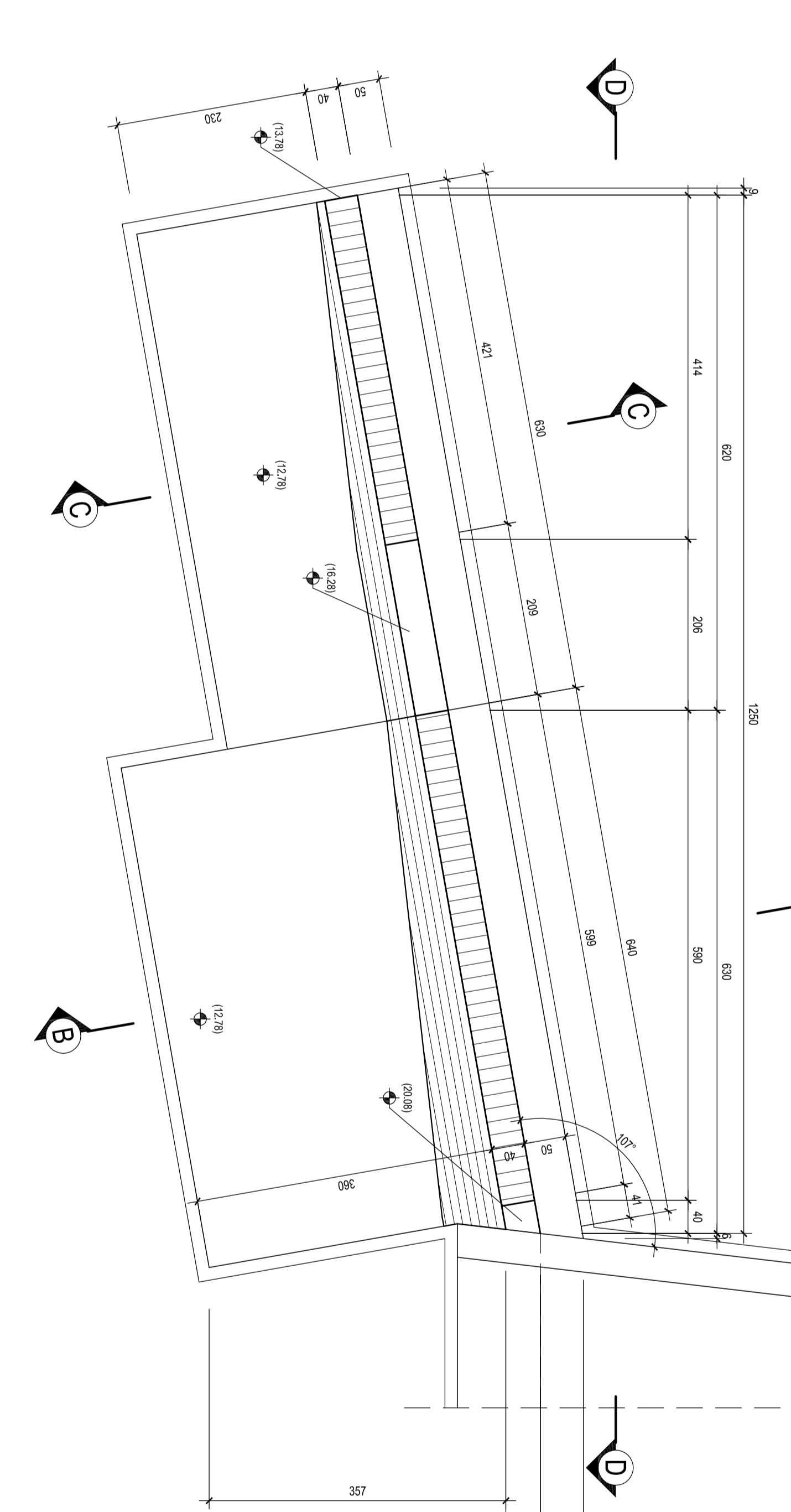
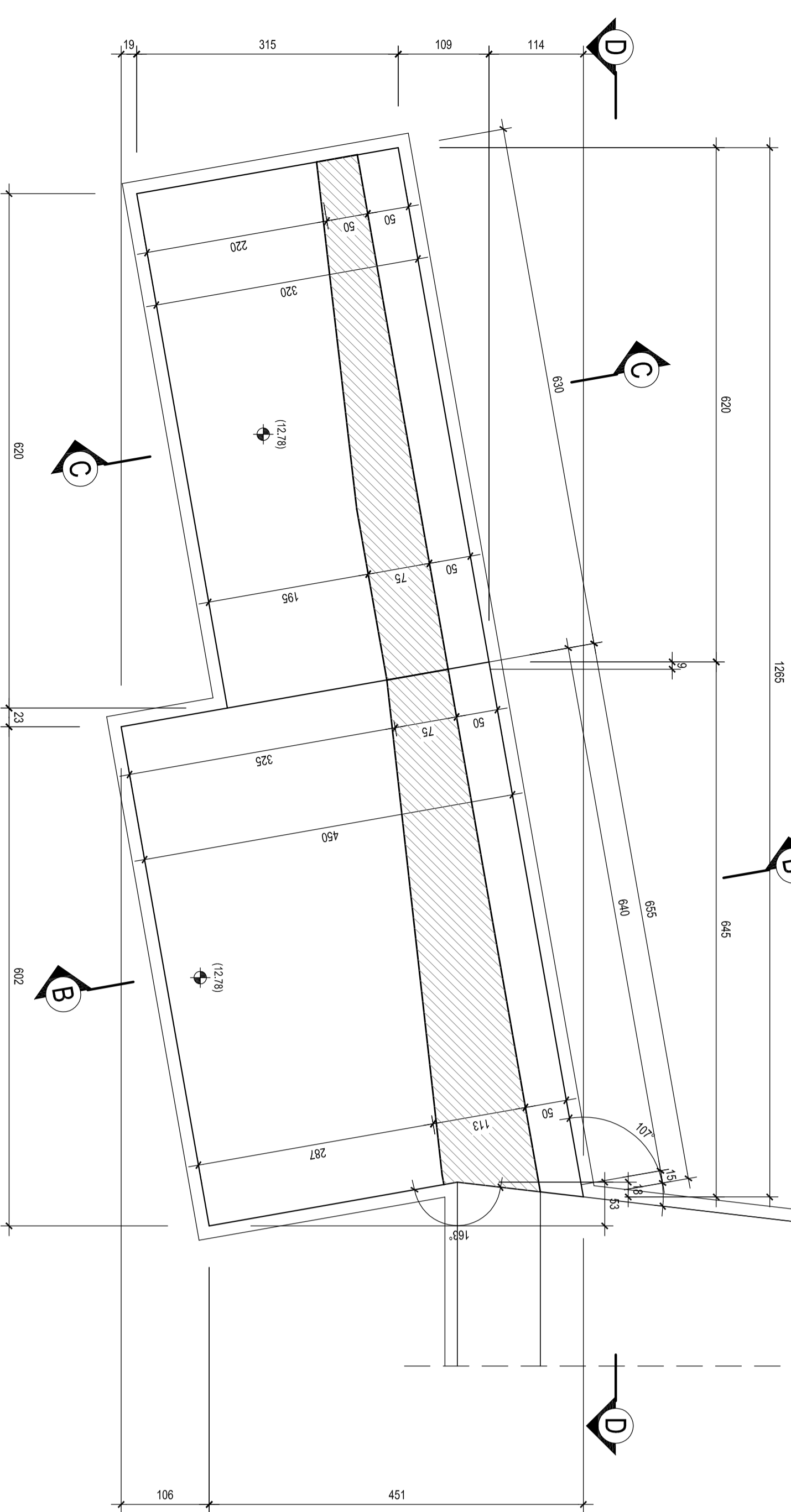
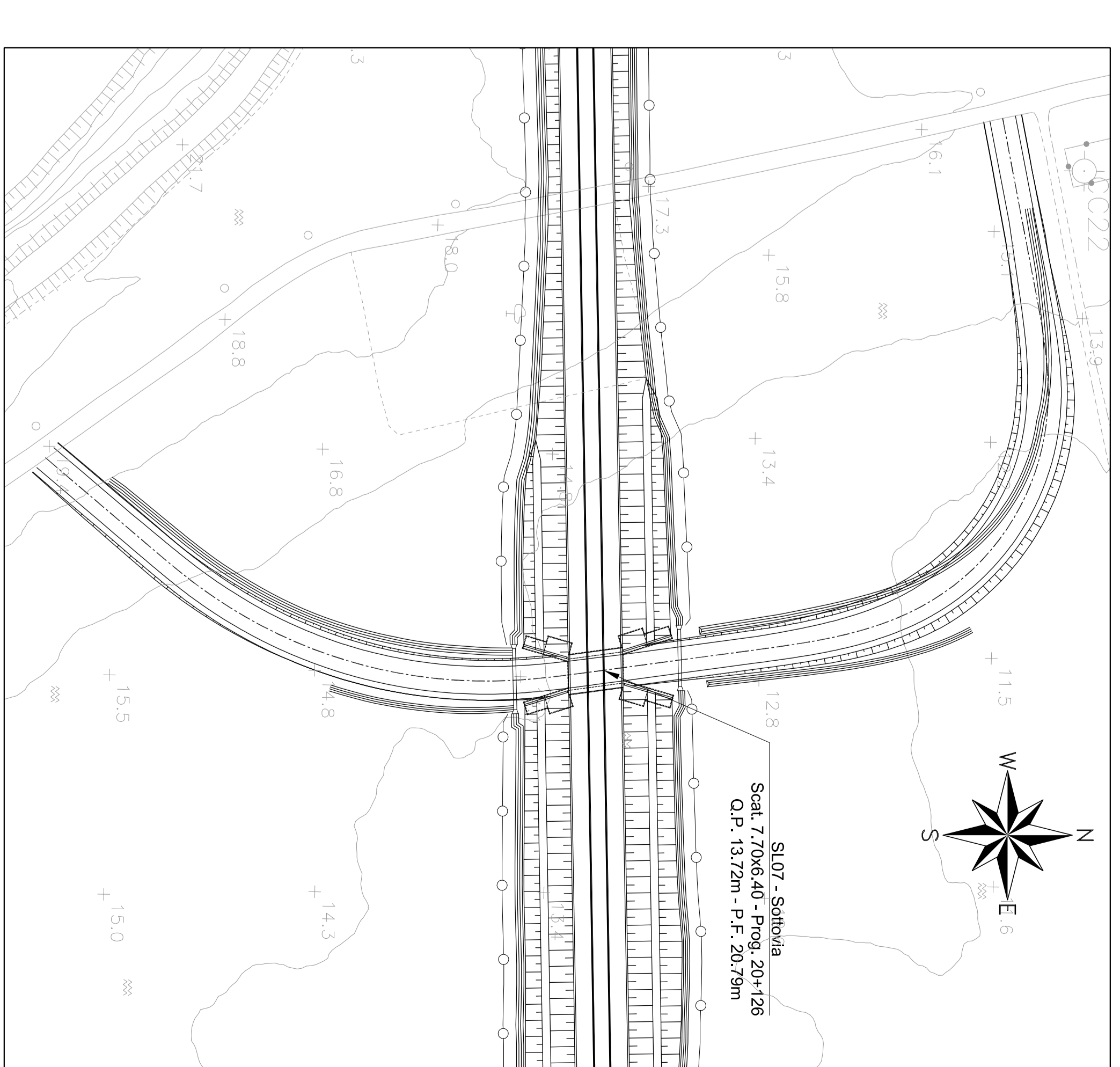
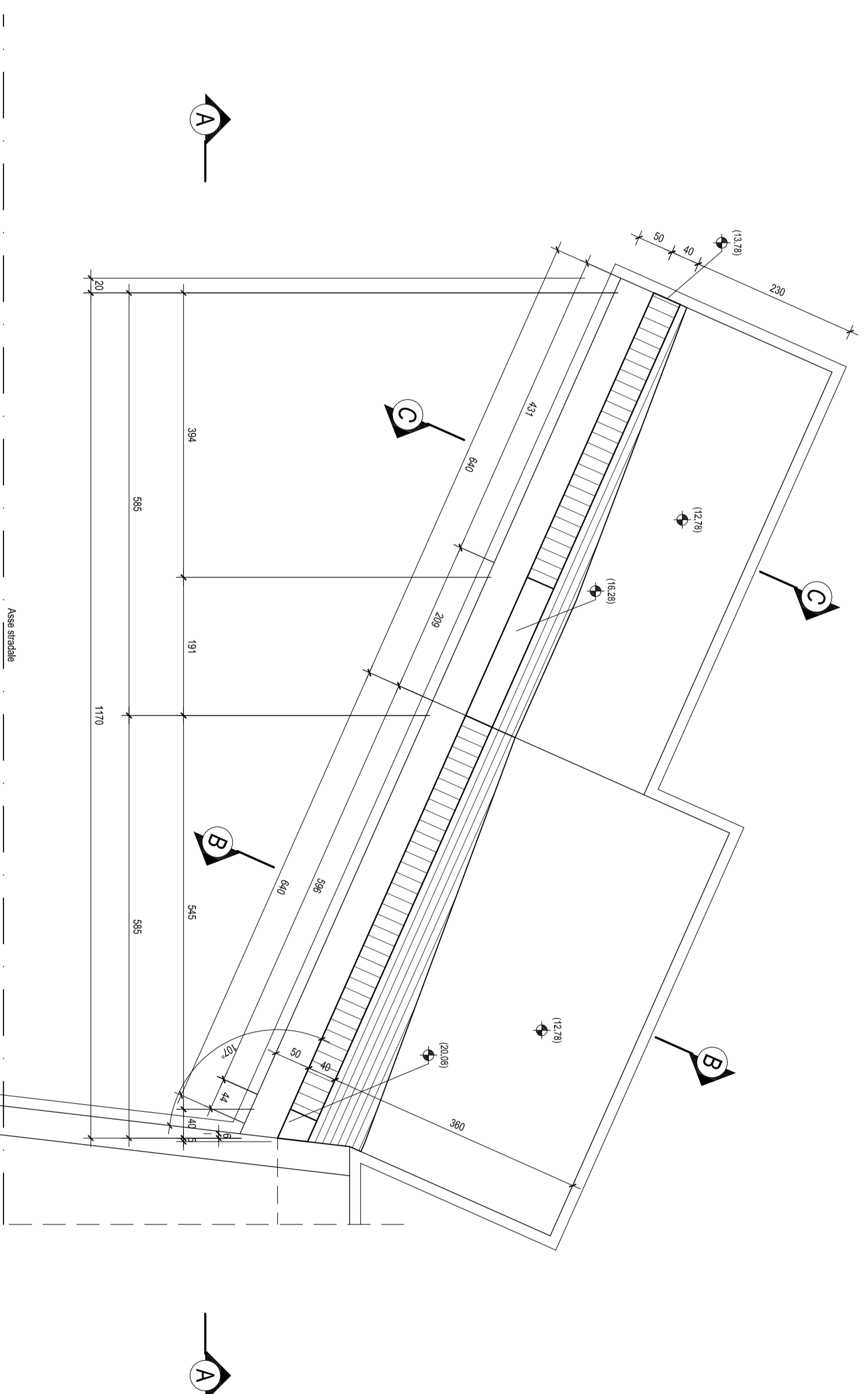

VISTA A-A - Scala 1:50

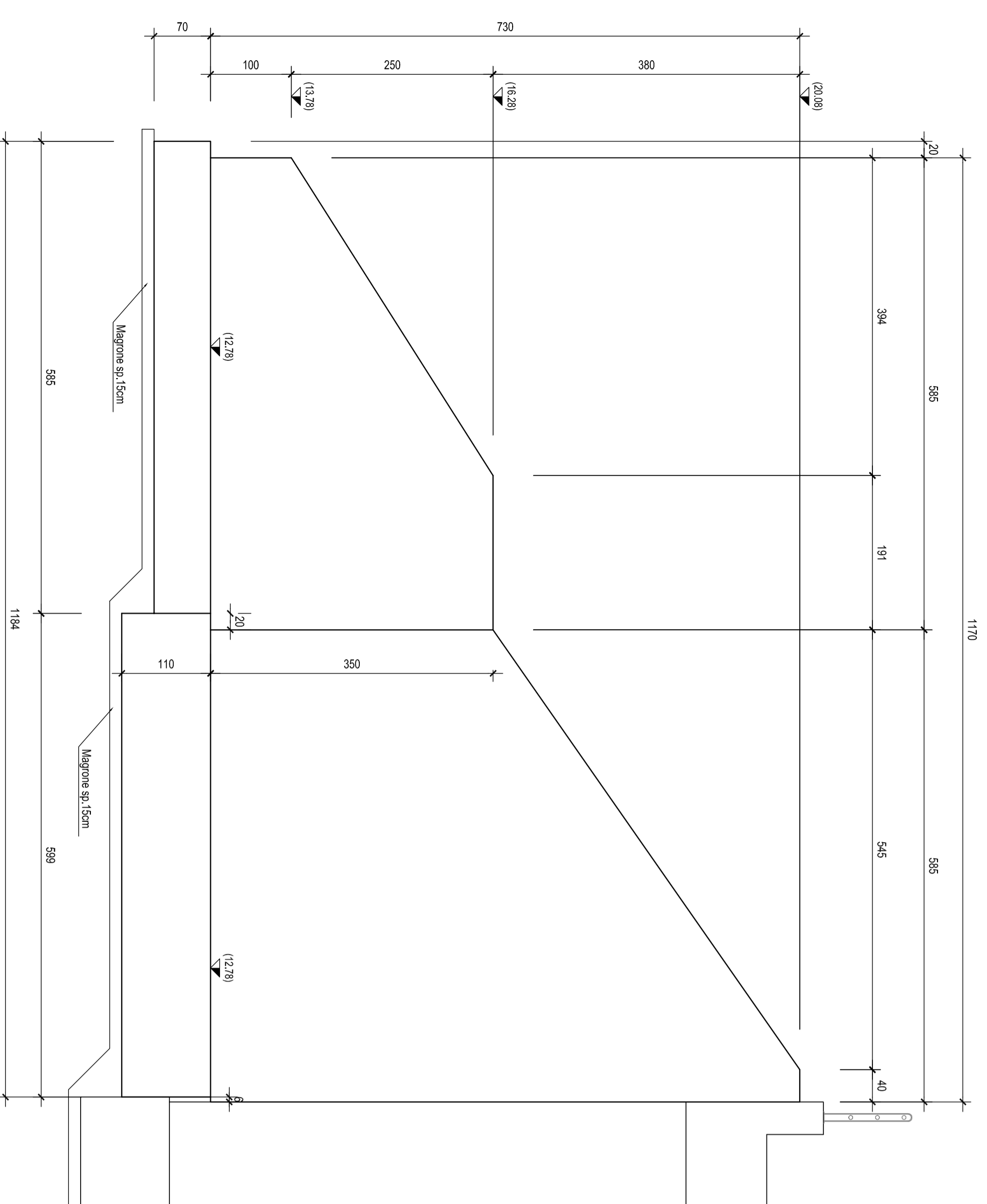

VISTA D-D - Scala 1:50

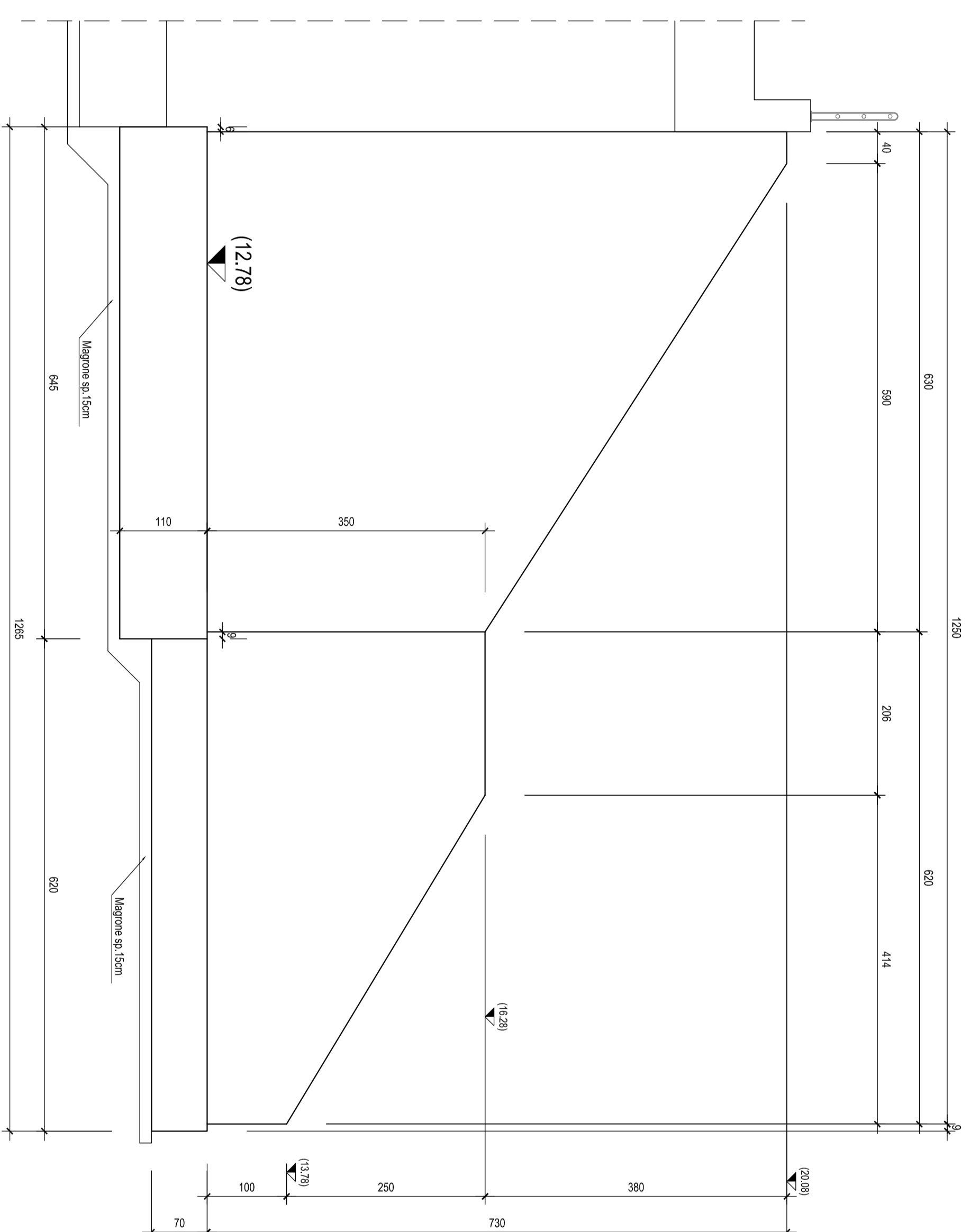

SEZIONE B-B - Scala 1:50

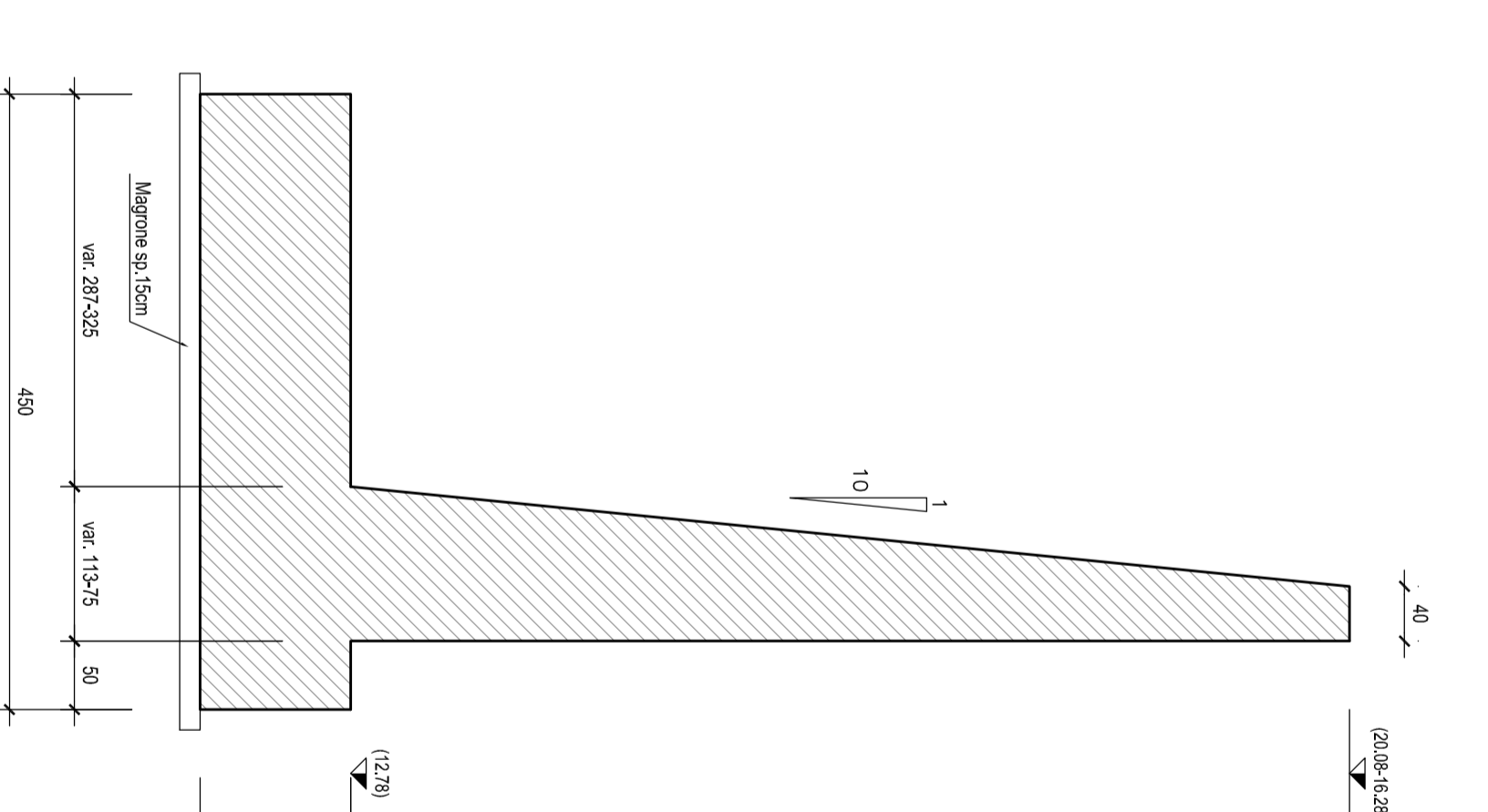

SEZIONE C-C - Scala 1:50

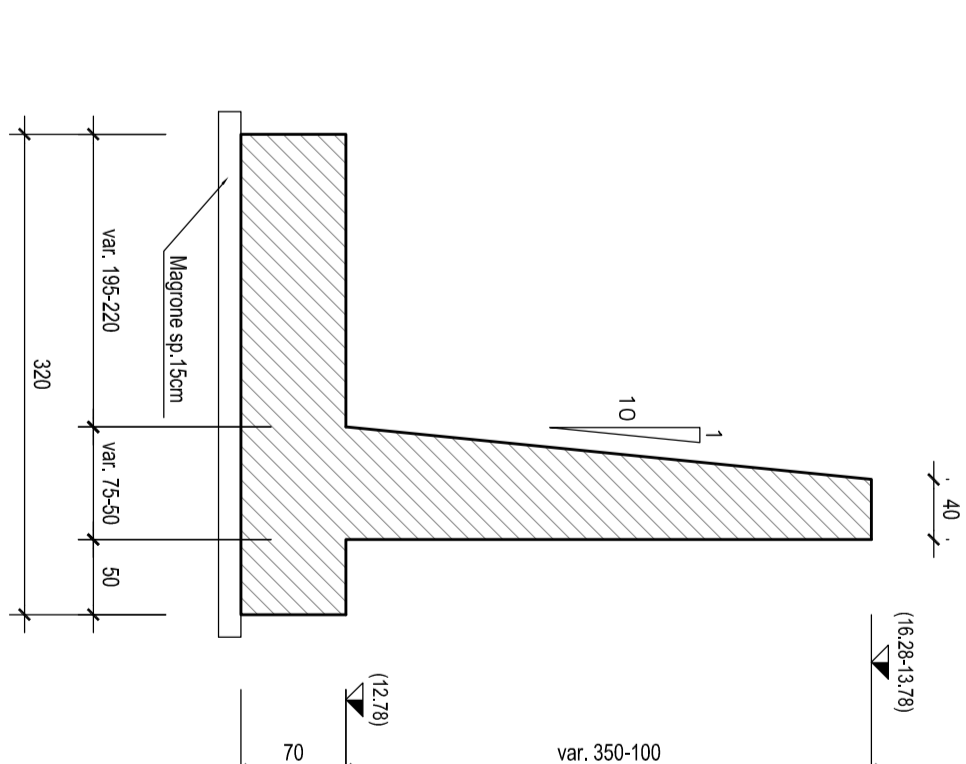

N.B.: Per la tabella materiali e
incidenze armature delle
Opere Civili si rimanda all'elaborato
LI0202 D78 RH OC0000 001

| | | | | | |
|--|--|--|---------------|---|-------------|
| COMITANTE: | | FRFI FEDERAZIONE RILEVANTI ITALIANI SOCIETA' ITALIANA DEL RILEVAMENTO | | ITALFER SOCIETA' ITALIANA FERROVIARIA | |
| PROGETTAZIONE: | | | | | |
| INFRASTRUTTURE FERROVIARIE STRATEGICHE DEFINITE DALLA LEGGE OGGETTIVO A.43/01 | | | | | |
| U.O. INFRASTRUTTURE SUD | | | | | |
| PROGETTO DEFINITIVO | | | | | |
| LINEA PESCARA - BARI | | | | | |
| RADDOPPIO DELLA TRATTA FERROVIARIA TERMOLI - LESINA | | | | | |
| LOTTI 2 e 3 - RADDOPPIO TERMOLI - RIPALTA | | | | | |
| Opere D'Atti Minori - Solitoia e Galliera Anticelli | | | | | |
| S.U.O. SOTTOVIA VASBITTA NV/S15 KM 20+125 | | | | | |
| Carpenteria mani (rv.1) | | | | | |
| CONMESSA | | LOTTO FASE | ENTE TIPOLOG. | OPERAZIONE/UNA | PROGR. REV. |
| LI02 | | 02 | D | 7/6 | B/B |
| SIL07 | | 00 | 00 | 00 | 01 |
| A | | Scheda tecnica | | X. Data | |
| Riv. | | Disegnata | | Data | |
| A | | Verificata | | Data | |
| A | | Approvata | | Data | |
| A | | Autorezzata | | Data | |
| SCALA: 1:50 | | | | | |
| FILE: LI0202D78RH01000014.DWG | | | | | |