

Provincia										
Comune										
L =	54.220	133.970	179.024	118.196	362.138	472.906				
DISL =	-0.007	0.082	-0.048	-0.090	-0.449	-0.062				
p =	0.120	0.610	0.270	0.764	1.240	0.131				
Progr. Livellette	16987.600	17121.570	17300.594	17418.790	17780.928	18253.834				

PR =16933.380 QV =91.608	PR =16987.600 QV =91.601 DP =-0.073 R =43000.000 T =15.695 F =-0.003	PR =17121.570 QV =91.683 DP =-0.088 R =40000.000 T =17.600 F =-0.004	PR =17300.594 QV =91.634 DP =-0.049 R =50000.000 T =12.348 F =-0.002	PR =17418.790 QV =91.544 DP =-0.048 R =45000.000 T =10.712 F =-0.001	PR =17780.928 QV =91.095 DP =-0.111 R =18000.000 T =9.985 F =-0.003	PR =18253.834 QV =91.033 DP =-0.106 R =30000.000 T =15.851 F =-0.004
-----------------------------	---	---	---	---	--	---

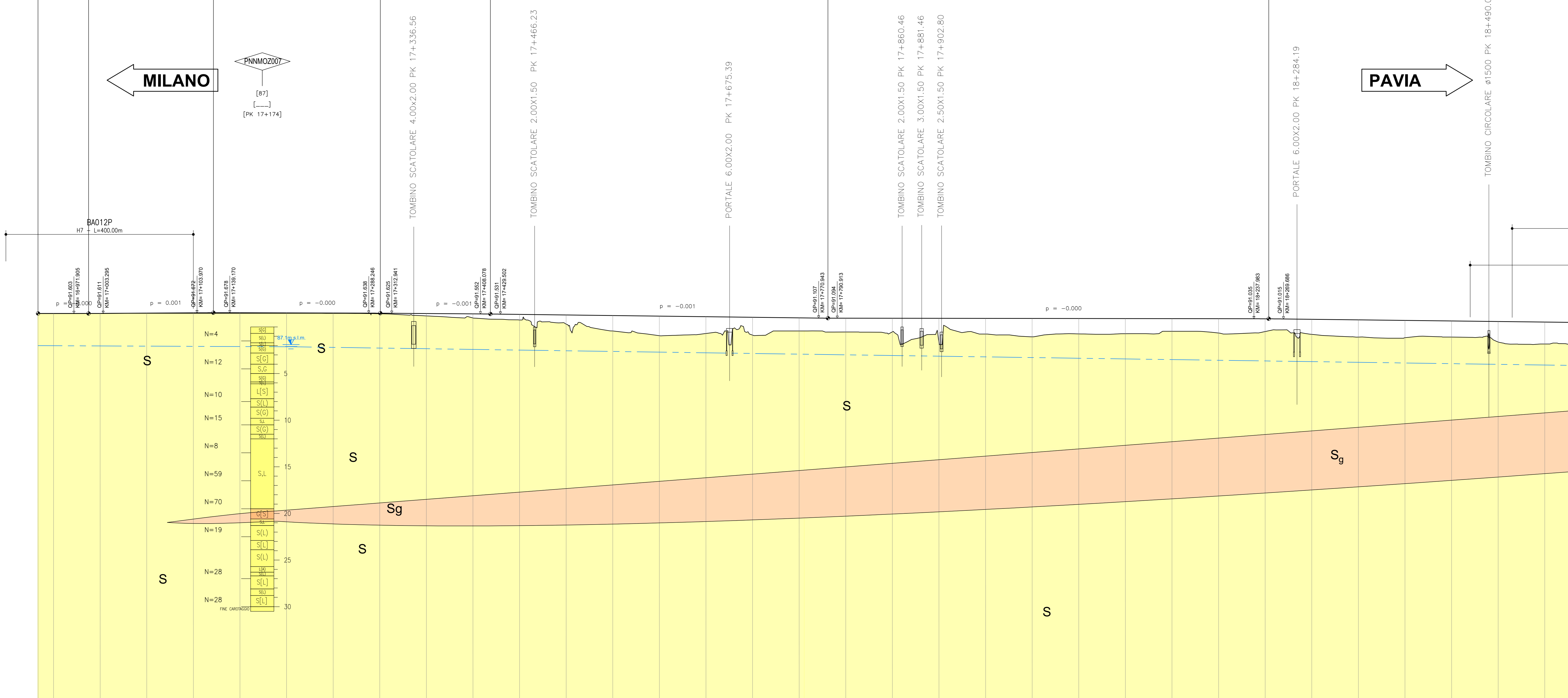

**LEGENDA**

S	Sabbia fine / Sabbia limosa
S <sub>g</sub>	Sabbia media e grossolana

**TABELLA PARAMETRI GEOTECNICI**

ZONA	SONDAGGIO DI RIFERIMENTO	PROFONDITA'	UNETA' TERRENO	τ <sub>v</sub> (kN/m <sup>2</sup> )		φ' (°)		c <sub>v</sub> (kN/m <sup>2</sup> )		v <sub>v</sub> (%)		c <sub>v</sub> (kN/m <sup>2</sup> )	
				max	min	max	min	max	min	max	min		
11	PNM02007	5	5	20	17	30	22	42	4	356	325	283	32
12	52	5	5	35	30	27	27	32	10	350	302	43	43

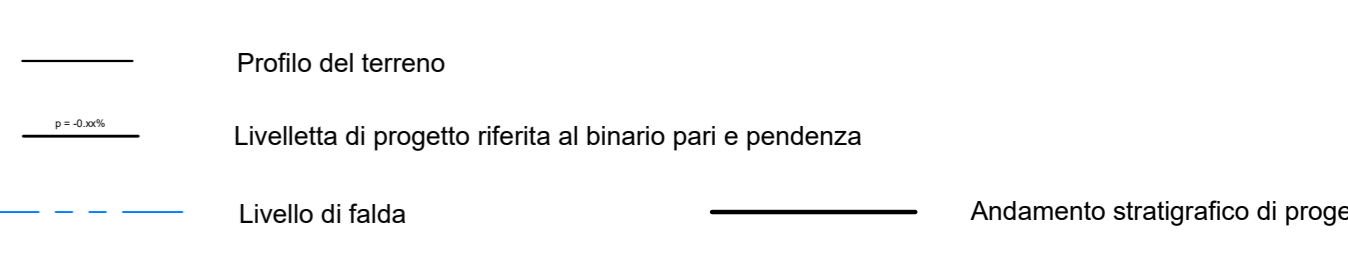

**SONDAGGI/POZZI**

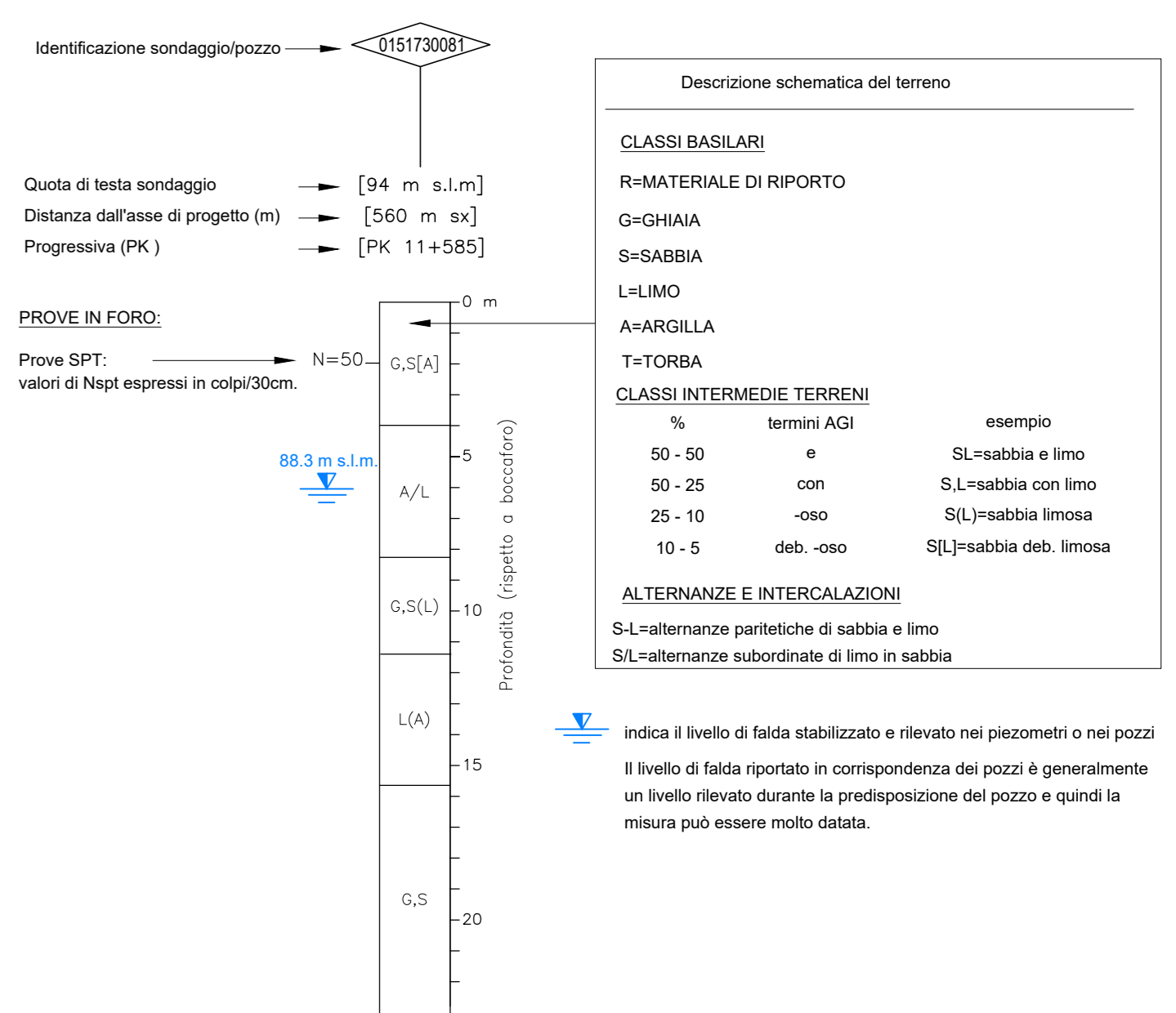

1:200  
 Q. R. = 50.00 m

ANNO DI ESECUZIONE SONDAGGIO	2018																																			
SOTTOZONA OMOGENEA	ZONA 11																																			
QUOTE PROGETTO	91.608	91.606	91.609	91.639	91.670	91.675	91.682	91.648	91.633	91.597	91.598	91.505	91.443	91.381	91.319	91.257	91.195	91.133	91.093	91.066	91.090	91.073	91.046	91.040	91.031	90.979	90.919	90.866	90.800	90.741	90.682					
QUOTE TERRENO	91.592	91.592	91.594	91.622	91.622	91.622	91.622	91.612	91.589	91.541	91.528	90.904	90.464	90.227	90.222	89.456	89.284	89.228	89.162	89.029	89.466	89.396	89.102	89.411	89.433	89.033	89.693	89.508	89.660	89.364	89.072	89.002	89.074	89.543	89.330	90.882
ETTOMETRICHE	900	500	100	200	300	400	300	500	700	800	900	500	100	200	300	400	500	600	700	800	900	500	100	200	300	400	500	600	700	800	900	500	100	200	300	
DIST. PARZIALI	17	30	50	50	50	50	50	50	50	50	50	50	50	50	50	50	50	50	50	50	50	50	50	50	50	50	50	50	50	50	50	50	50	50	50	50
PROGRESSIVE	16933.38	16950.00	17000.00	17050.00	17100.00	17150.00	17200.00	17250.00	17300.00	17350.00	17400.00	17450.00	17500.00	17550.00	17600.00	17650.00	17700.00	17750.00	17800.00	17850.00	17900.00	17950.00	18000.00	18050.00	18100.00	18150.00	18200.00	18250.00	18300.00	18350.00	18400.00	18450.00	18500.00	18550.00	18600.00	
ANDAMENTO PLANIMETRICO	L = 225.49										L = 224.74										L = 1517.58															
VELOCITA'																																				

COMMITTENTE: **RFI** RETE FERROVIARIA ITALIANA GRUPPO FERROVIE DELLO STATO ITALIANE

PROGETTAZIONE: **ITALFER** GRUPPO FERROVIE DELLO STATO ITALIANE

CUP: J4710900030009

**U.O. INFRASTRUTTURE NORD**

**PROGETTO DEFINITIVO**

**POTenziAMENTO DELLA LINEA MILANO - GENOVA**  
**QUADRUPPLICAMENTO TRATTA MILANO ROGGERO - PAVIA**  
**FASE 1 - QUADRUPPLICAMENTO MI ROGGERO - PIEVE EMANUELE**

ELABORATI GENERALI - GEOTECNICA  
 Profilo Geotecnico - Tav. 8/10

SCALA: 1:2000/200

COMMESSA	LOTTO	FASE	ENTE	TIPO DOC.	OPERA/DISCIPLINA	PROGR.	REV.
NM0Z	10	D	26	F6	OC0001	008	A

Rev.	Descrizione	Redatto	Data	Verificato	Data	Approvato	Data	Autografo
A	EMISSIONE ESECUTIVA	2020/01/20	2018	2020/01/20	2018	[Firma]	2018	[Firma]

File: NM0Z10D26F6OC0001008A.DWG n. Elab.: \_\_\_\_\_