

NOTE GENERALI

NOTE: TUTTE LE DIMENSIONI SONO IN MILLIMETRI, SALVO OVE DIVERSAMENTE INDICATO.
1. NON PRESSO LE TRAVI TRASVERSALI

ELABORATI DI RIFERIMENTO:

CG1000-P4ADPT-E200000000-01: LEGENDA
CG1000-P3PDPIT-E200000000-01: SISTEMI DI DISTRIBUZIONE PONTE
CG1000-P3PDPIT-E200000000-03: SISTEMI DI DISTRIBUZIONE IMPALCATO

NOTES:

DIMENSIONS ARE IN MILLIMETRES UNLESS OTHERWISE NOTED.

1. NOT AT CROSS BEAMS

REFERENCES:

CG1000-P4ADPT-E200000000-02: LEGEND
CG1000-P3PDPIT-E200000000-01: CABLEWAYS ON BRIDGE - GENERAL
CG1000-P3PDPIT-E200000000-03: CABLEWAYS IN ORDER

CABLE WAYS:

- 1 HORIZONTAL CABLE LADDER 600mm FOR LOW VOLTAGE POWER, LIGHT AND SIGNAL/DATA CABLES.
- 2 CABLE TRAY FOR LOW VOLTAGE LIGHT AND SIGNAL CABLES.
- 3 STEEL PENETRATION (AIR TIGHT) - TYPE BRATBERG.
- 4 STEEL CONDUITS Ø25-40 FOR LOW VOLTAGE POWER OUTLETS AND LOW VOLTAGE LIGHT CABLES.
- 5 MOUNTING PLATE/AREA FOR LIGHT CONTROL AND SERVICE OUTLETS (15m INTERVAL).
- 6 HORIZONTAL CABLE LADDER 200mm FOR HIGH VOLTAGE CABLES.
- 7 EQUIPMENT PLATFORM WITH SUBSTATION.
- 8 HORIZONTAL CABLE LADDER 300mm FOR LOW VOLTAGE LIGHT CABLES.
- 9 HORIZONTAL CABLE LADDER FOR HIGH VOLTAGE CABLES.

SEZIONE TRASVERSALE
CROSS SECTION
SCALE 1:100

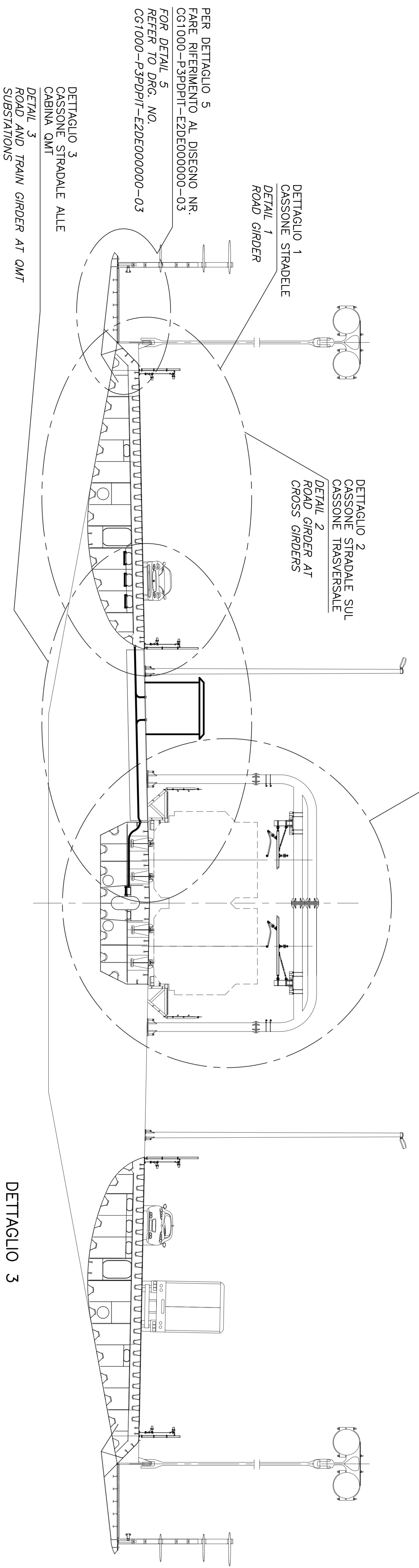

PER DETTAGLIO 4 FARE RIFERIMENTO AL DISEGNO NR. CG1000-P3PDPIT-E200000000-03 FOR DETAIL 4 REFER TO DRG. NO. CG1000-P3PDPIT-E200000000-03

PER DETTAGLIO 5 FARE RIFERIMENTO AL DISEGNO NR. CG1000-P3PDPIT-E200000000-03 FOR DETAIL 5 REFER TO DRG. NO. CG1000-P3PDPIT-E200000000-03

DETTAGLIO 1
CASSONE STRADALE
DETAIL 1
ROAD GIRDER

DETTAGLIO 2
CASSONE STRADALE SUI CASSONE TRASVERSALE
DETAIL 2
ROAD GIRDER AT CROSS GIRDERS

DETTAGLIO 3
CASSONE STRADALE ALLE CABINE D'AMM.
DETAIL 3
ROAD AND TRAIN GIRDER AT OMT SUBSTATIONS

DETTAGLIO 4
CASSONE STRADALE ALLE CABINE D'AMM.
DETAIL 4
ROAD AND TRAIN GIRDER AT OMT SUBSTATIONS

DETTAGLIO 5
CASSONE STRADALE ALLE CABINE D'AMM.
DETAIL 5
ROAD AND TRAIN GIRDER AT OMT SUBSTATIONS

DETTAGLIO 6
CASSONE STRADALE ALLE CABINE D'AMM.
DETAIL 6
ROAD AND TRAIN GIRDER AT OMT SUBSTATIONS

DETTAGLIO 7
CASSONE STRADALE ALLE CABINE D'AMM.
DETAIL 7
ROAD AND TRAIN GIRDER AT OMT SUBSTATIONS

DETTAGLIO 8
CASSONE STRADALE ALLE CABINE D'AMM.
DETAIL 8
ROAD AND TRAIN GIRDER AT OMT SUBSTATIONS

DETTAGLIO 9
CASSONE STRADALE ALLE CABINE D'AMM.
DETAIL 9
ROAD AND TRAIN GIRDER AT OMT SUBSTATIONS

DETTAGLIO 1
CASSONE STRADALE TIPICO
DETAIL 1
TYPICAL ROAD GIRDER

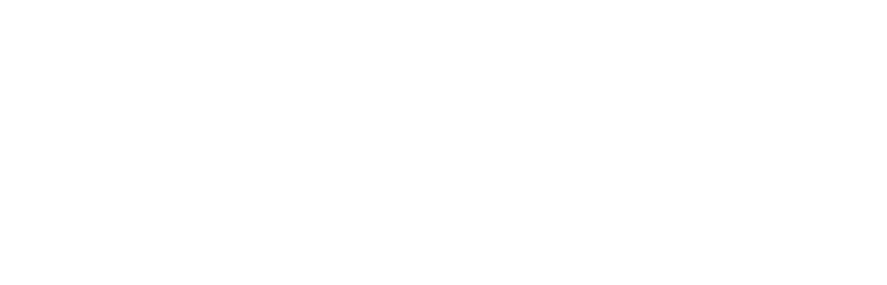
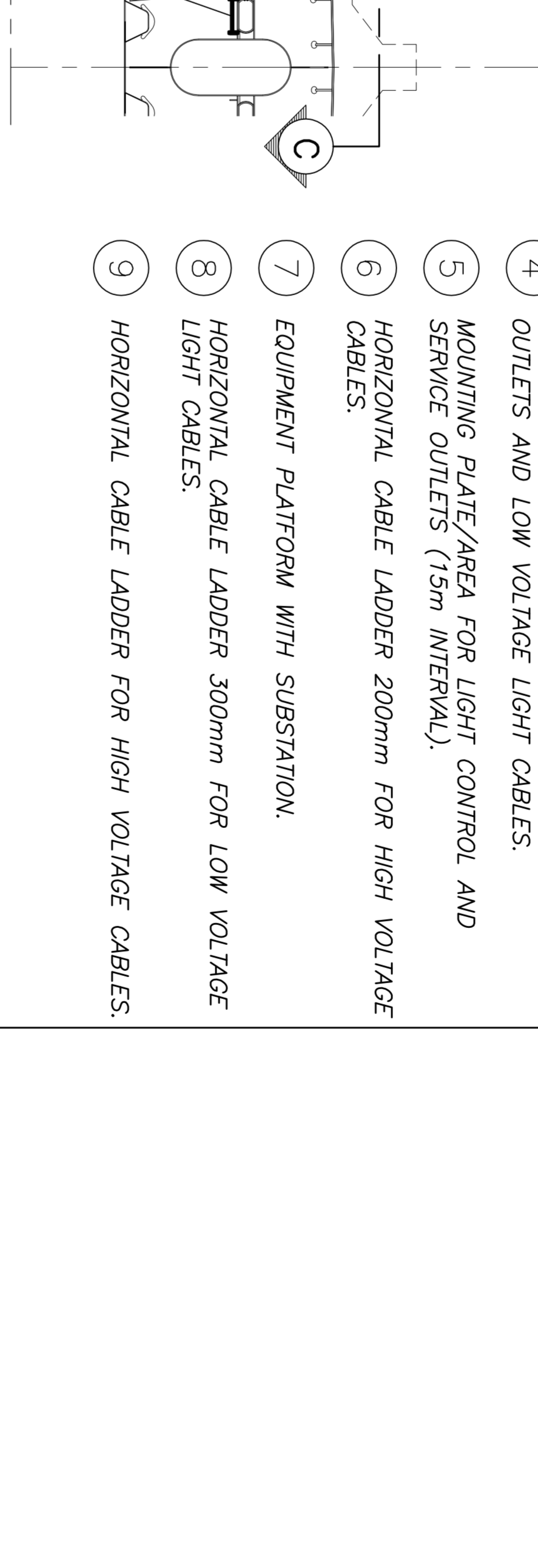
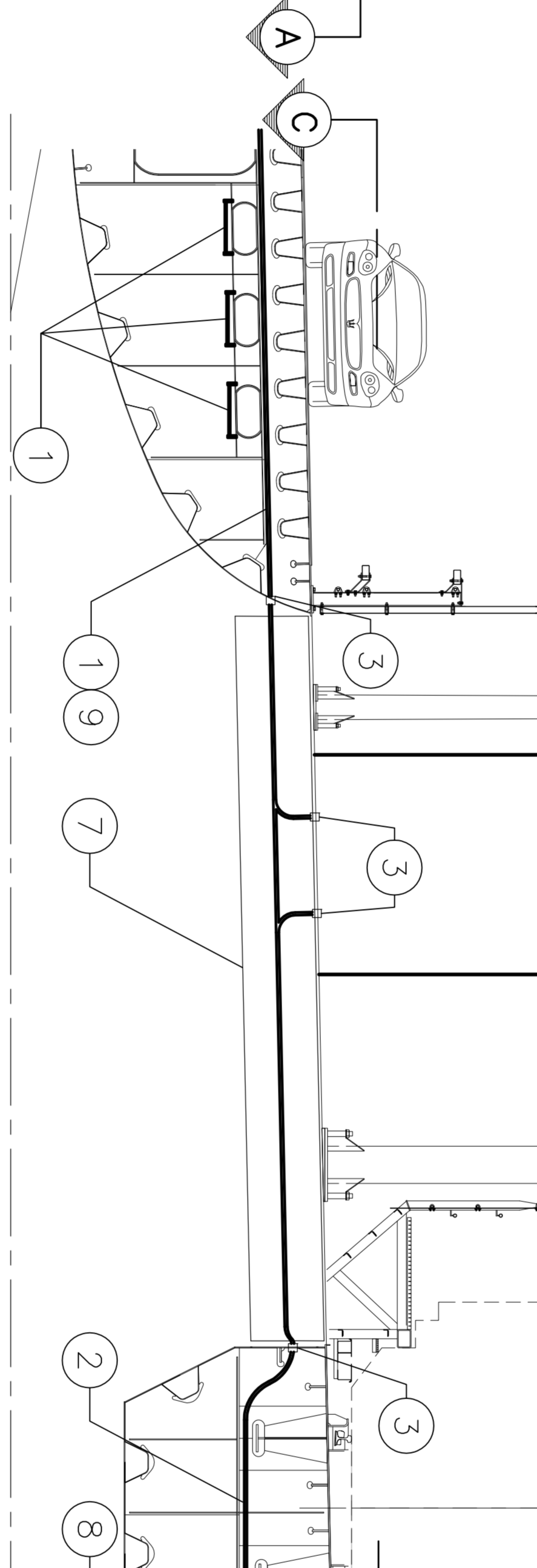
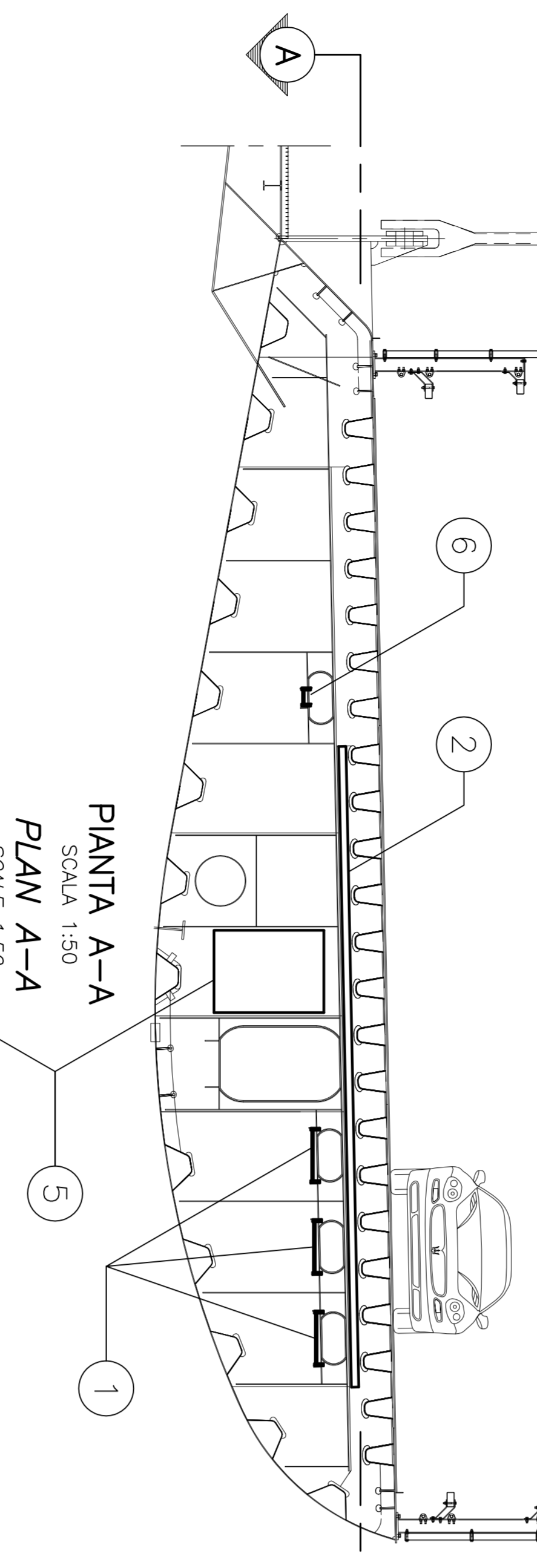

DETTAGLIO 1
CASSONE STRADALE TIPICO
DETAIL 1
TYPICAL ROAD GIRDER

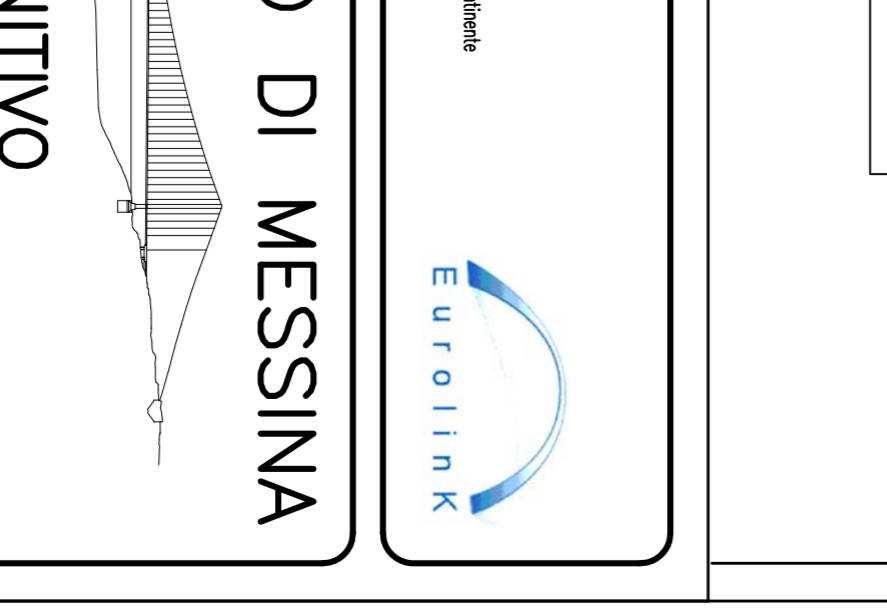
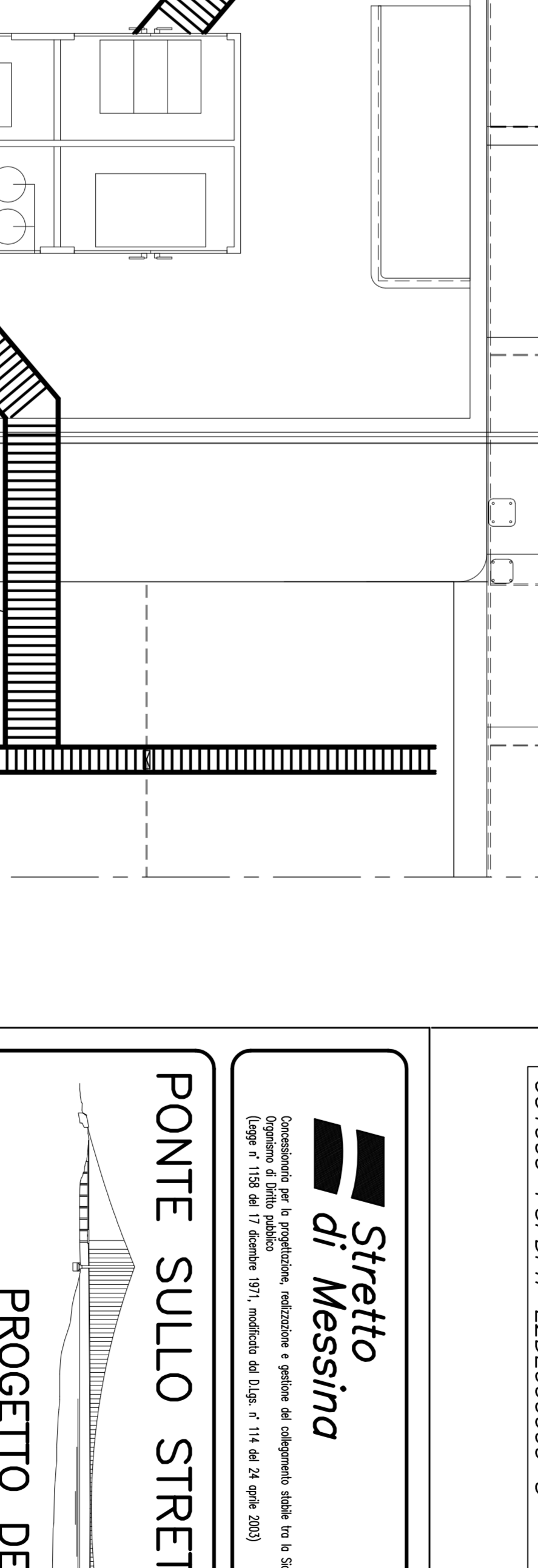
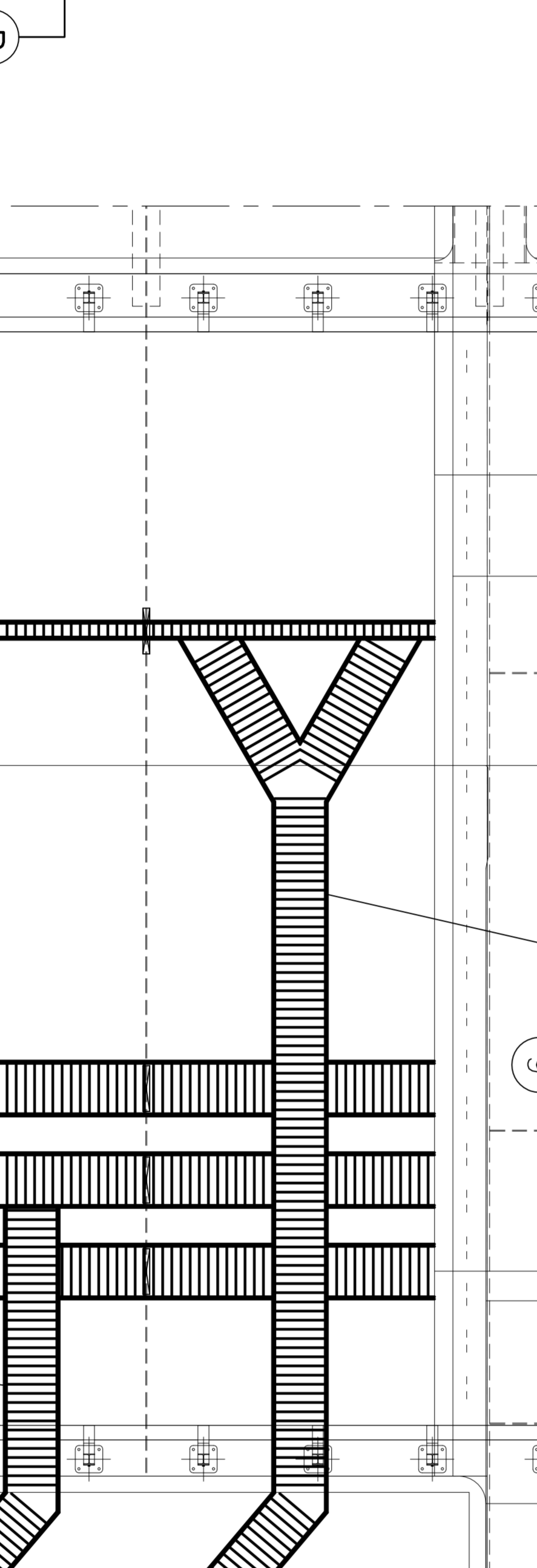
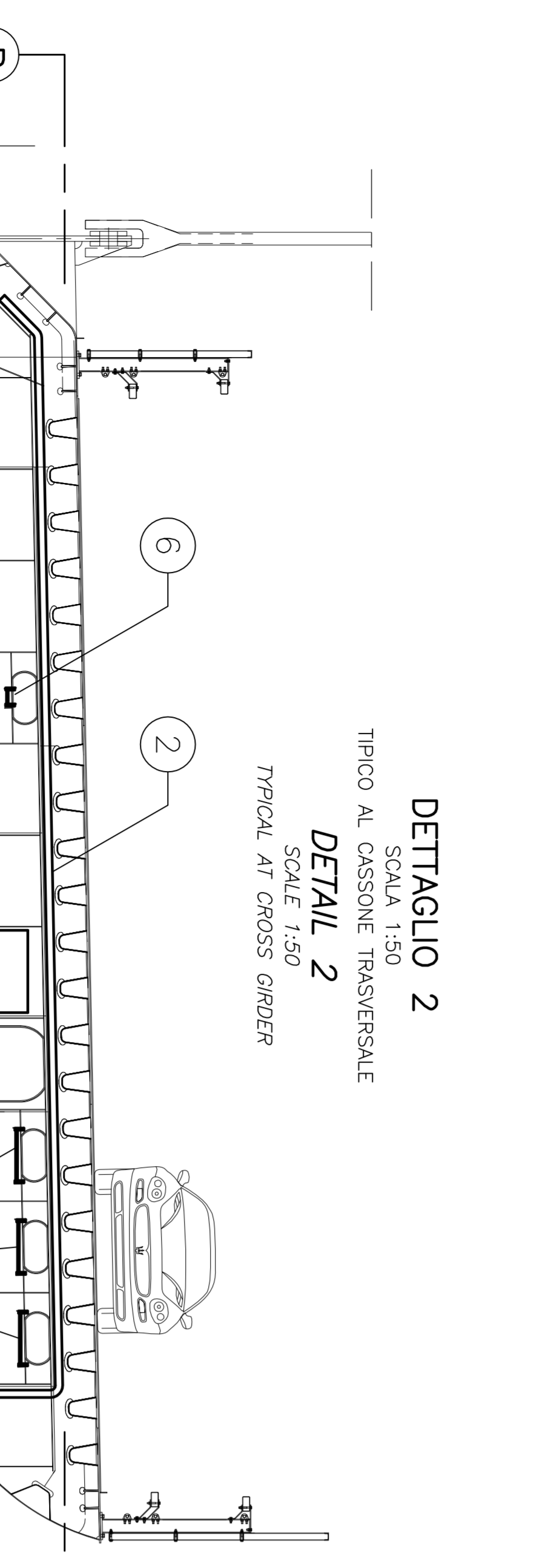

DETTAGLIO 2
TIPO AL CASSONE TRASVERSALE
DETAIL 2
TYPICAL AT CROSS GIRDER

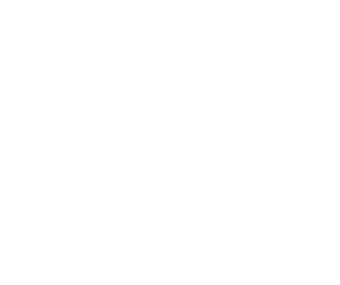
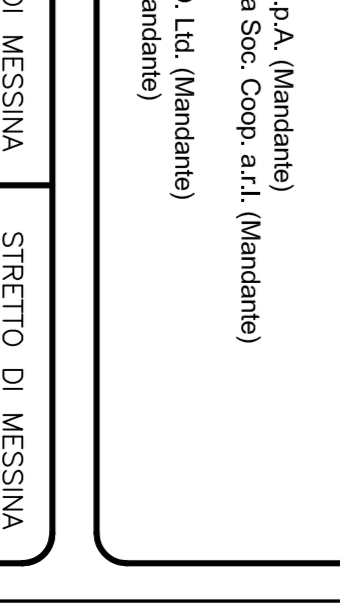
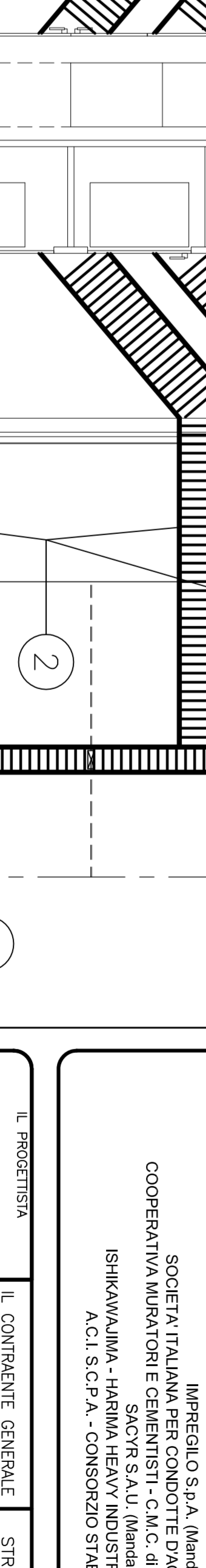
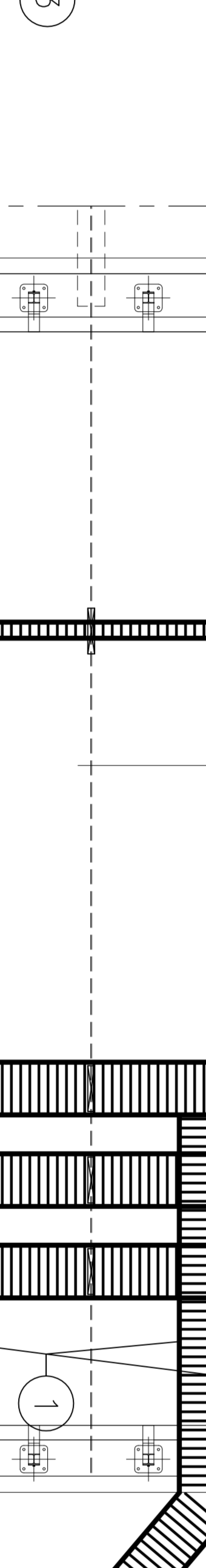
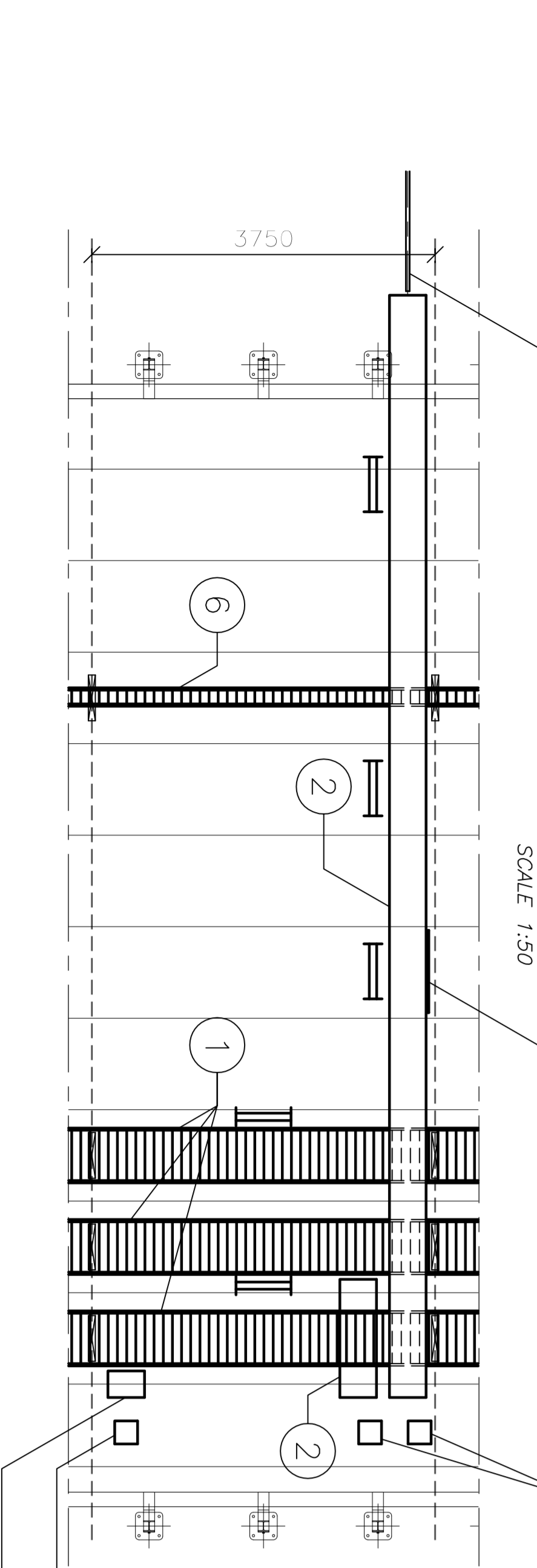

PIANTA A-A
SCALE 1:50

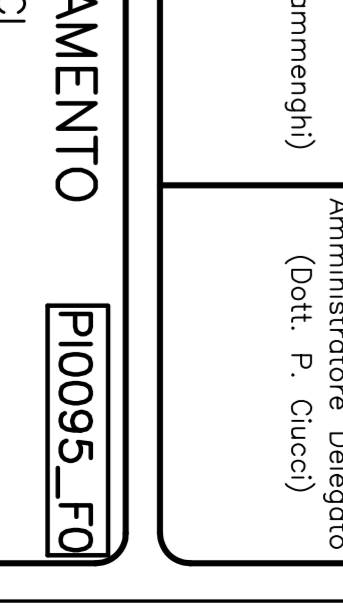
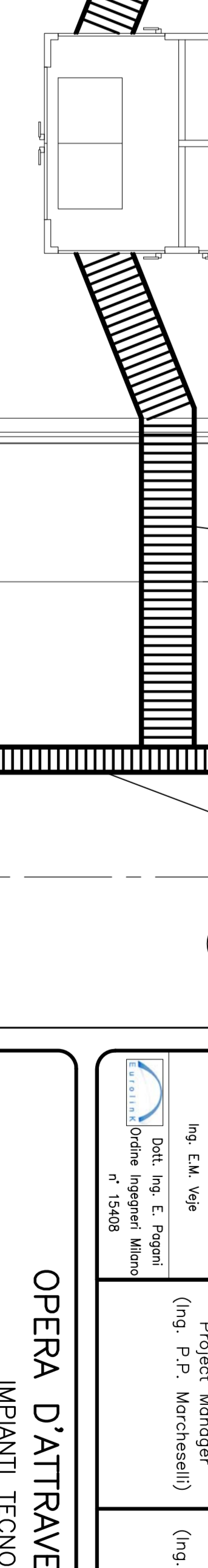
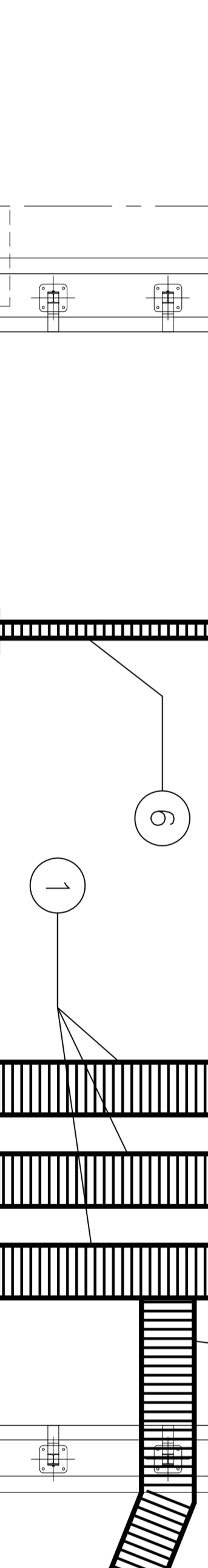
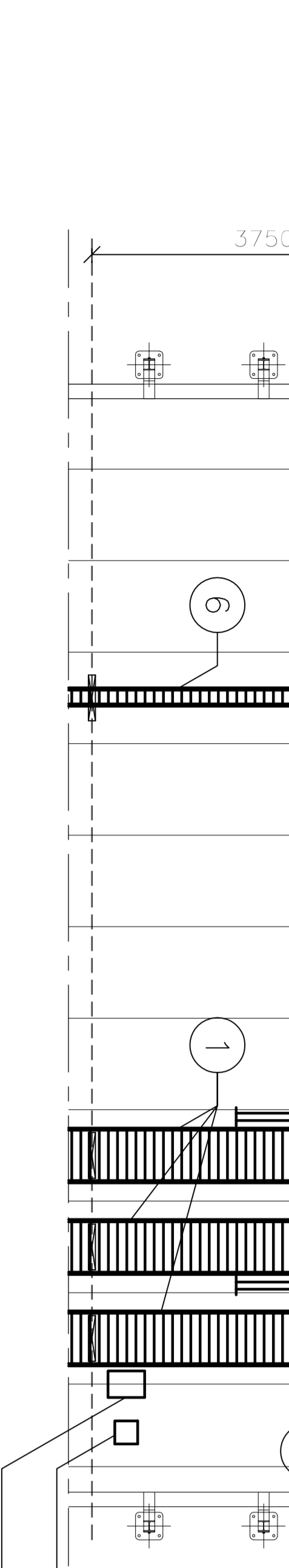

NOTE GENERALI

NOTE: TUTTE LE DIMENSIONI SONO IN MILLIMETRI, SALVO OVE DIVERSAMENTE INDICATO.
1. NON PRESSO LE TRAVI TRASVERSALI

ELABORATI DI RIFERIMENTO:

CG1000-P4ADPT-E200000000-01: LEGENDA
CG1000-P3PDPIT-E200000000-01: SISTEMI DI DISTRIBUZIONE PONTE
CG1000-P3PDPIT-E200000000-03: SISTEMI DI DISTRIBUZIONE IMPALCATO

NOTES:

DIMENSIONS ARE IN MILLIMETRES UNLESS OTHERWISE NOTED.

1. NOT AT CROSS BEAMS

REFERENCES:

CG1000-P4ADPT-E200000000-02: LEGEND
CG1000-P3PDPIT-E200000000-01: CABLEWAYS ON BRIDGE - GENERAL
CG1000-P3PDPIT-E200000000-03: CABLEWAYS IN ORDER

CABLE WAYS:

- 1 HORIZONTAL CABLE LADDER 600mm FOR LOW VOLTAGE POWER, LIGHT AND SIGNAL/DATA CABLES.
- 2 CABLE TRAY FOR LOW VOLTAGE LIGHT AND SIGNAL CABLES.
- 3 STEEL PENETRATION (AIR TIGHT) - TYPE BRATBERG.
- 4 STEEL CONDUITS Ø25-40 FOR LOW VOLTAGE POWER OUTLETS AND LOW VOLTAGE LIGHT CABLES.
- 5 MOUNTING PLATE/AREA FOR LIGHT CONTROL AND SERVICE OUTLETS (15m INTERVAL).
- 6 HORIZONTAL CABLE LADDER 200mm FOR HIGH VOLTAGE CABLES.
- 7 EQUIPMENT PLATFORM WITH SUBSTATION.
- 8 HORIZONTAL CABLE LADDER 300mm FOR LOW VOLTAGE LIGHT CABLES.
- 9 HORIZONTAL CABLE LADDER FOR HIGH VOLTAGE CABLES.

QUESTO ELABORATO GRATICO VA LETTO INSIEME A:
CG1000-P3PDPIT-E200000000-03
THIS DRAWING TO BE READ IN CONJUNCTION WITH:
CG1000-P3PDPIT-E200000000-03

Stretto di Messina
EUROLINK S.C.A. - IMPREGIATO S.p.A. (Membro della IRI - IRI SpA) - IRI SpA (Membro della IRI - IRI SpA) - IRI SpA (Membro della IRI - IRI SpA)

PROGETTO DEFINITIVO

PONTE SULLO STRETTO DI MESSINA

EUROLINK S.C.A.
SOCIETA' ITALIANA PER CONDOTTE ENOVIA S.p.A. (Membro della IRI - IRI SpA) - IRI SpA (Membro della IRI - IRI SpA) - IRI SpA (Membro della IRI - IRI SpA)

PROGETTO DEFINITIVO

OPERA D'ATTRAVERSAMENTO
DISTRIBUZIONE ELETTRICA MT/BT
IMPIANTI TECNOLOGICI

OPERA D'ATTRAVERSAMENTO
DISTRIBUZIONE ELETTRICA MT/BT
IMPIANTI TECNOLOGICI

PI0095_F0

VEI CAVI NELL'IMPALCATO - SISTEMI DI DISTRIBUZIONE IMPALCATO

REV.	DATA	REVISIONE	REVISIONE
1	20/06/2011	EMISSIONE FINALE	PROGETTO