

Sistemazione a verde perimetrale

Doppio filare perimetrale di Populus spp.

Ingresso principale

Ingresso centrale Sorgeria Power esistente

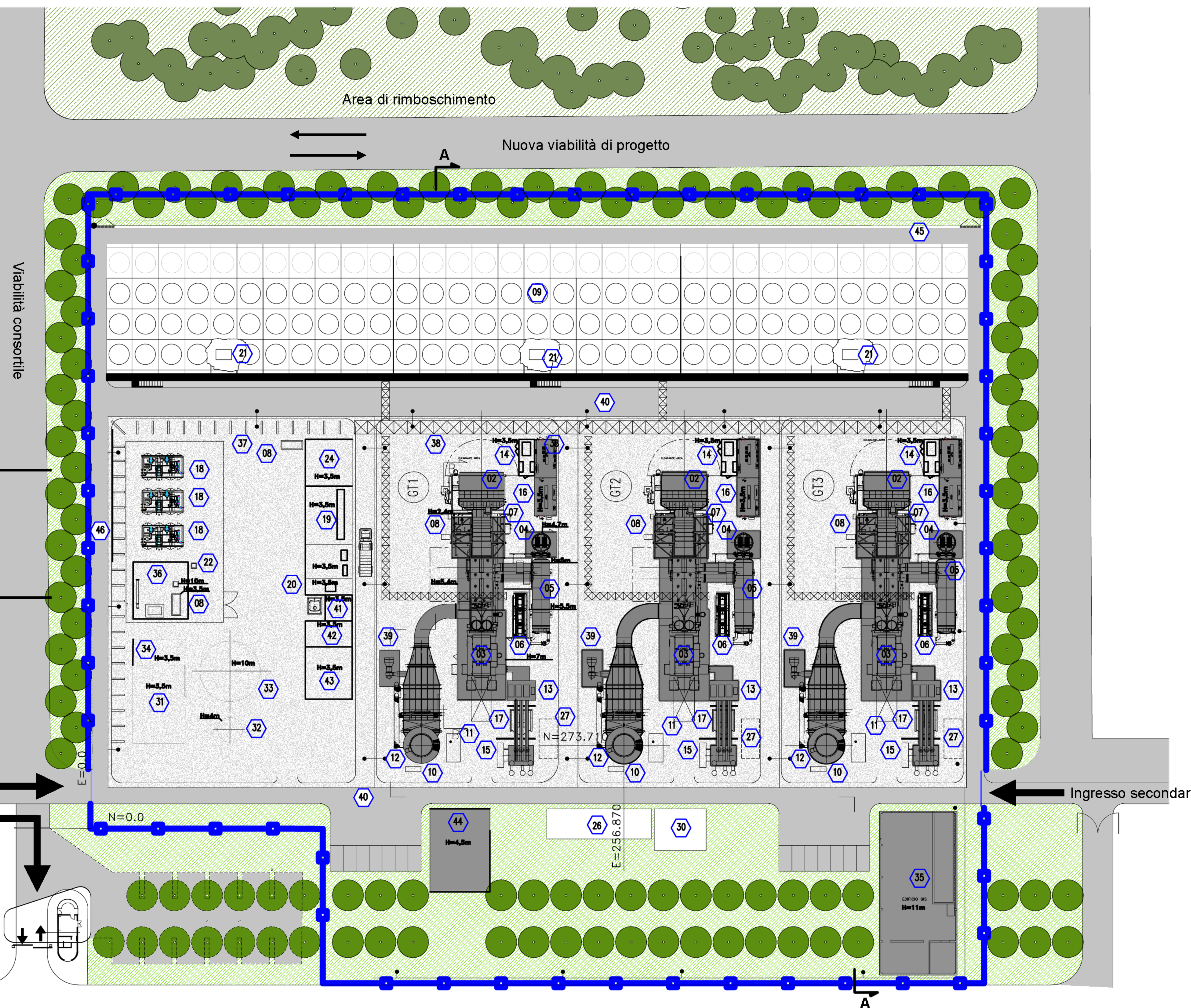

Planimetria generale

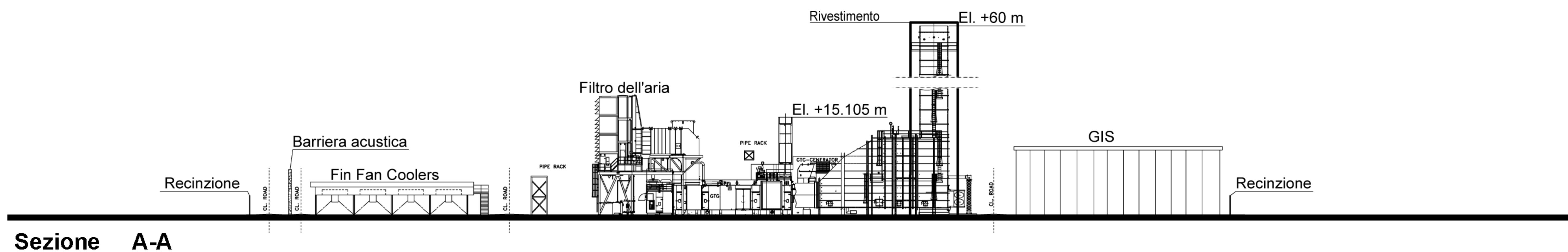

Sezione A-A

- | N. | Description |
|----|---|
| 01 | GT - MAIN UNIT |
| 02 | AIR FILTER (Air Intake) |
| 03 | GTG - GENERATOR |
| 04 | VBV EXHAUST DUCT |
| 05 | INTERCOOLER - HEAT EXCHANGER |
| 06 | WATER SKID |
| 07 | AUXILIARY SKID |
| 08 | C02 FIRE SKID |
| 09 | FIN FAN COOLERS |
| 10 | CEMS |
| 11 | AMMONIA SKID |
| 12 | EXHAUST STACK |
| 13 | 11.5 kV SWITCHGEAR FOR GTG |
| 14 | ELECTRICAL BLDG FOR UNIT SERVICES |
| 15 | GT STEP-UP TRANSFORMER |
| 16 | POWER CONTROL MODULE FOR GTG |
| 17 | AUXILIARY UNIT TRANSFORMER |
| 18 | GAS FUEL COMPRESSOR SKID |
| 19 | ELECTRICAL BLDG FOR GAS COMPRESSORS & MCC |
| 20 | BATTERY ROOM |
| 21 | ELECTRICAL BLDG FOR FIN FAN COOLERS |
| 22 | N2 BOTTLES |
| 24 | AIR COMPRESSORS |
| 26 | WASTE WATER/OIL PIT |
| 27 | TRANSFORMER OIL PIT |
| 30 | RAIN WATER PIT |
| 31 | PUMP HOUSE (DEMI-POTABLE-FIN FAN COOLER) |
| 32 | INDUSTRIAL WATER TANK |
| 33 | DEMI WATER TANK |
| 34 | EXCHANGERS FOR LINES HEATING |
| 35 | S/S GIS |
| 36 | GAS RECEIVING AND MEASUREMENT STATION |
| 37 | SLEEPER WAY |
| 38 | PIPE RACK |
| 39 | TEMPERING AIR SILENCER & FILTER |
| 40 | FIRE FIGHTING RING |
| 41 | SERVICES (wc) |
| 42 | EMERGENCY DIESEL & TANK |
| 43 | WAREHOUSE |
| 44 | OFFICE & CONTROL ROOM |
| 45 | SILENT WALL |
| 46 | REI120 WALL |
- Confine dell'impianto IPB Sorgeria in progetto

PLANIMETRIA GENERALE DI PROGETTO
Centrale IPB Sorgeria

Cod. IDENTIFICATIVO
C.001.6_Planimetria_Generale

SCALA
1:1.000

TAVOLA N.
4