

CARPENTERIA SPALLA A
Scala 1:100

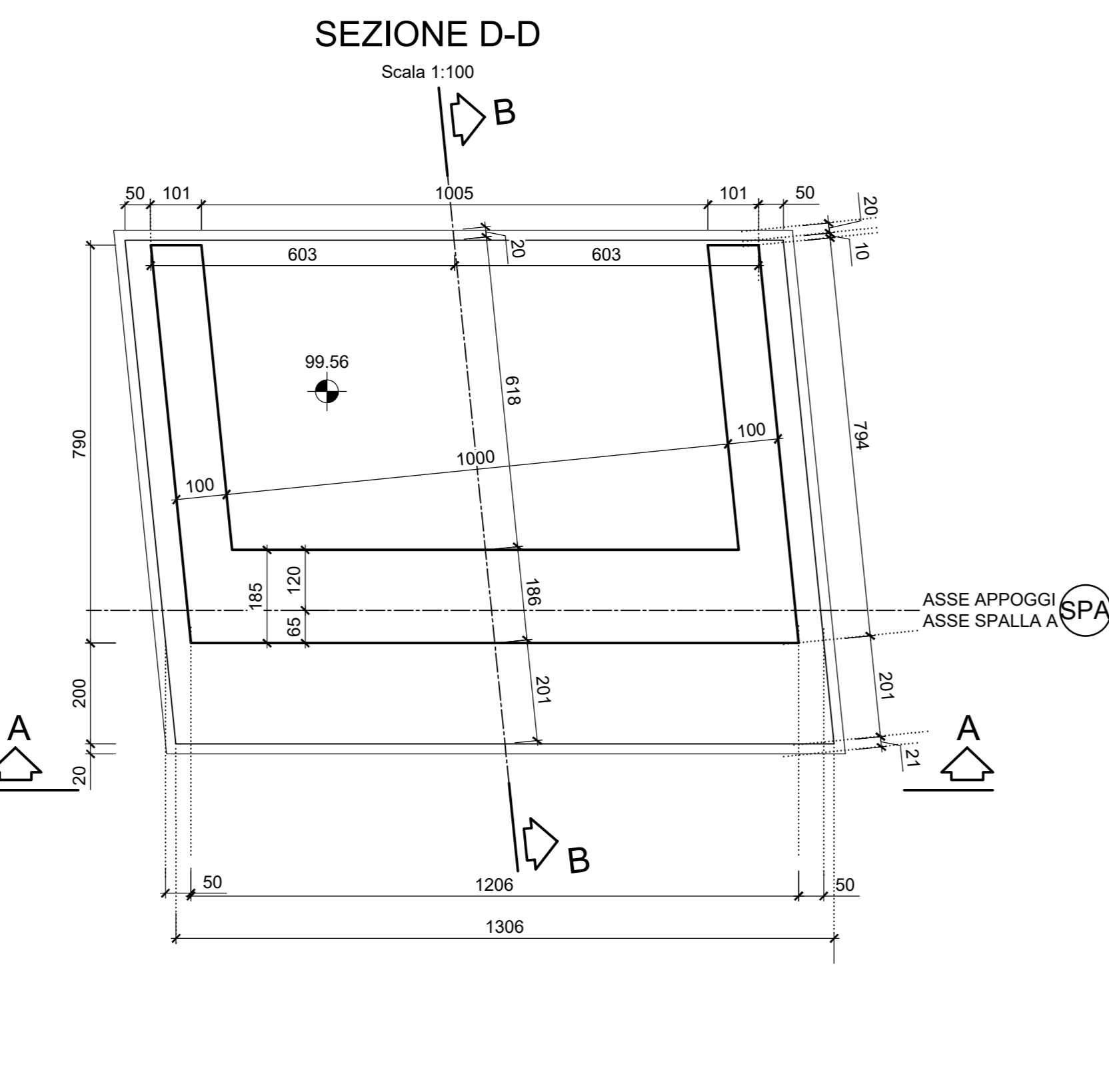

CARPENTERIA SPALLA B
Scala 1:100

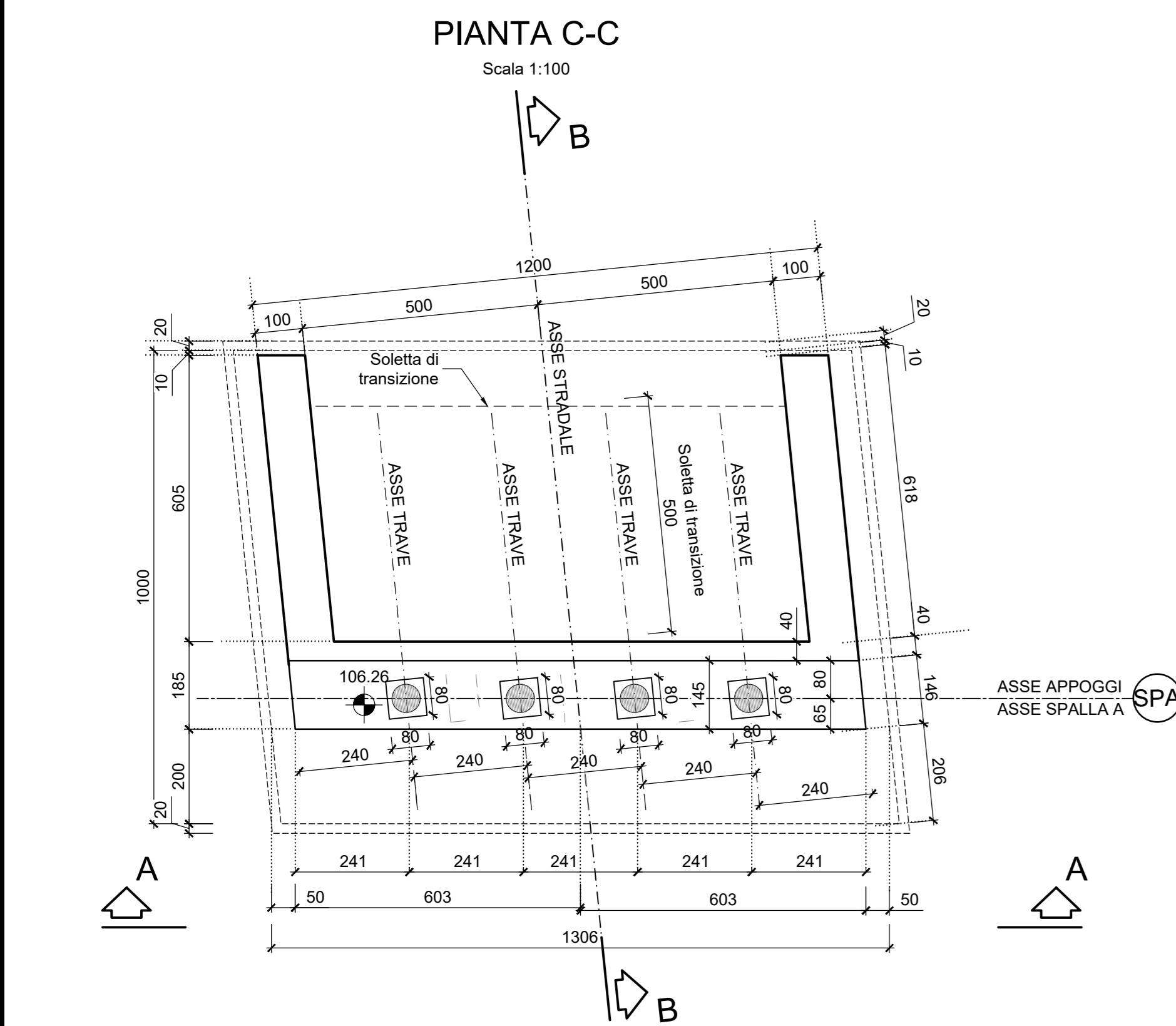
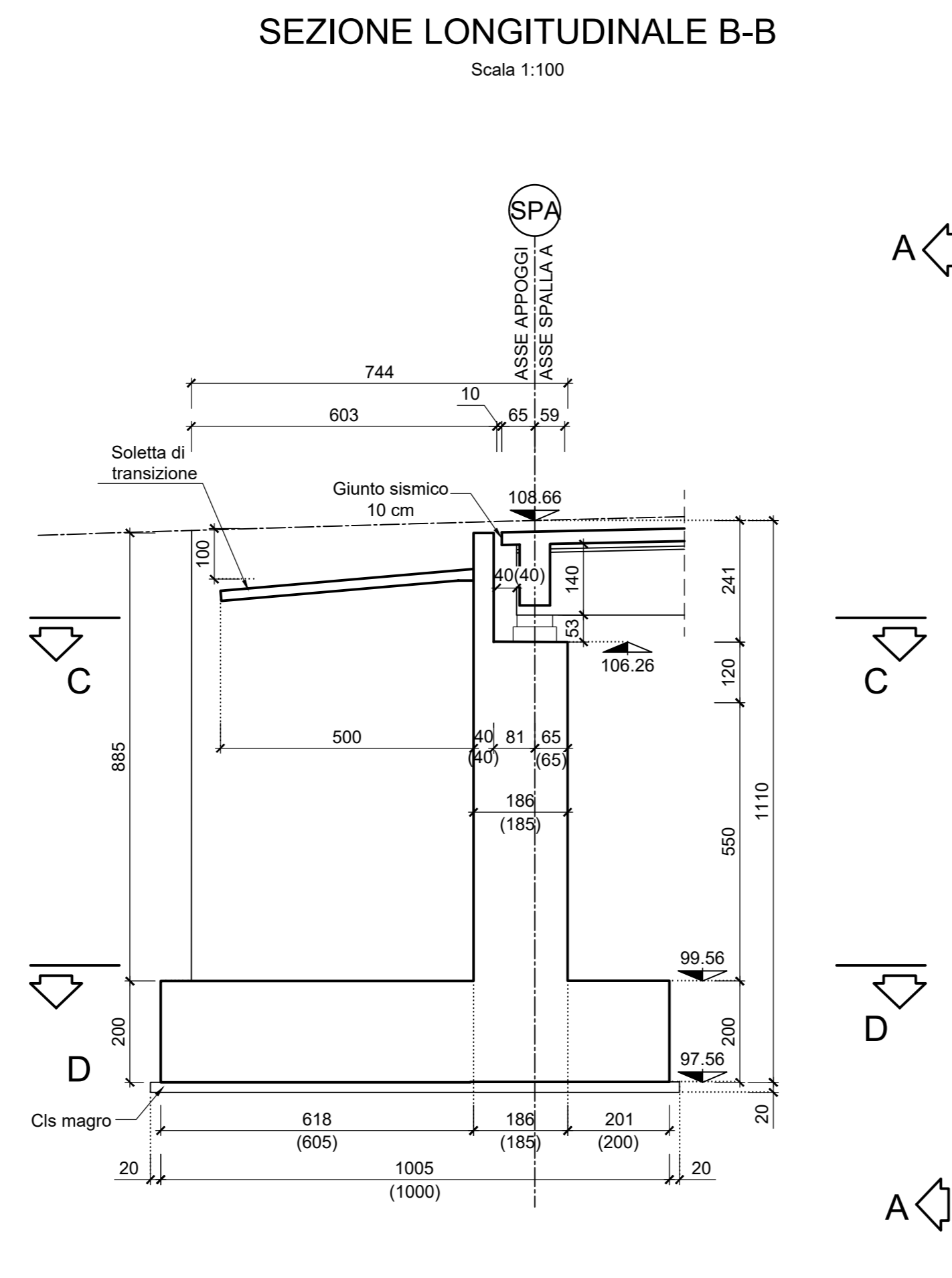
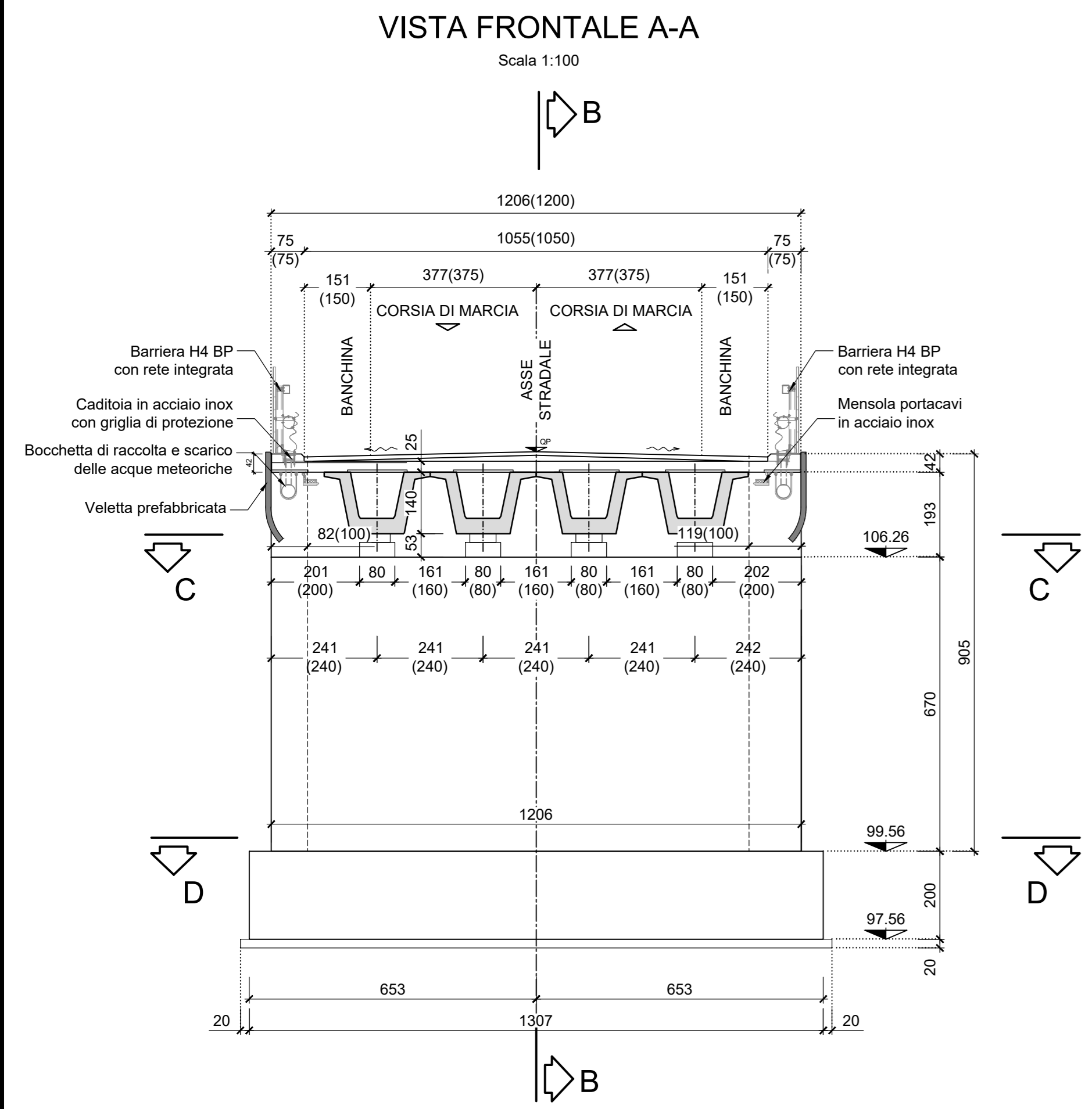
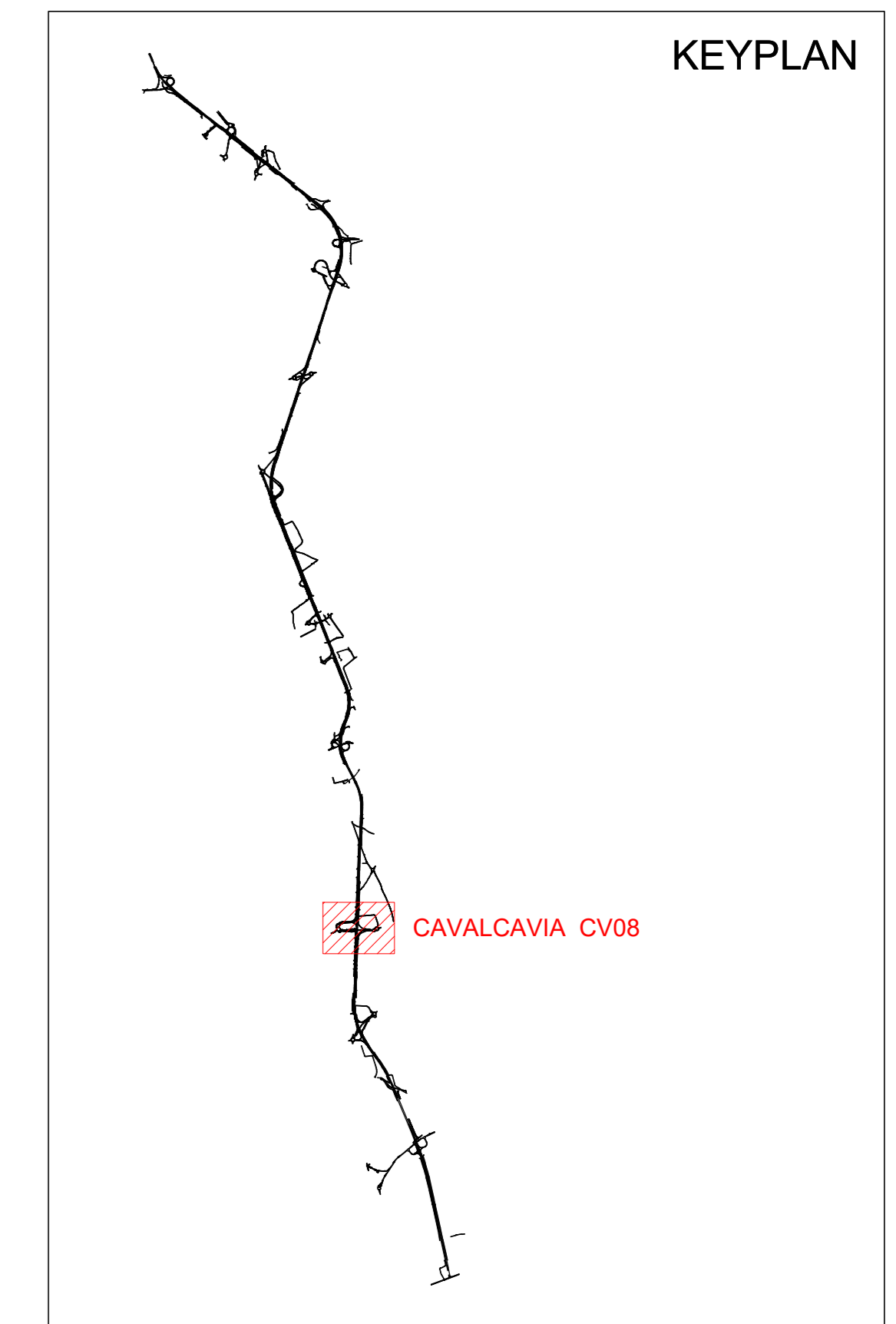
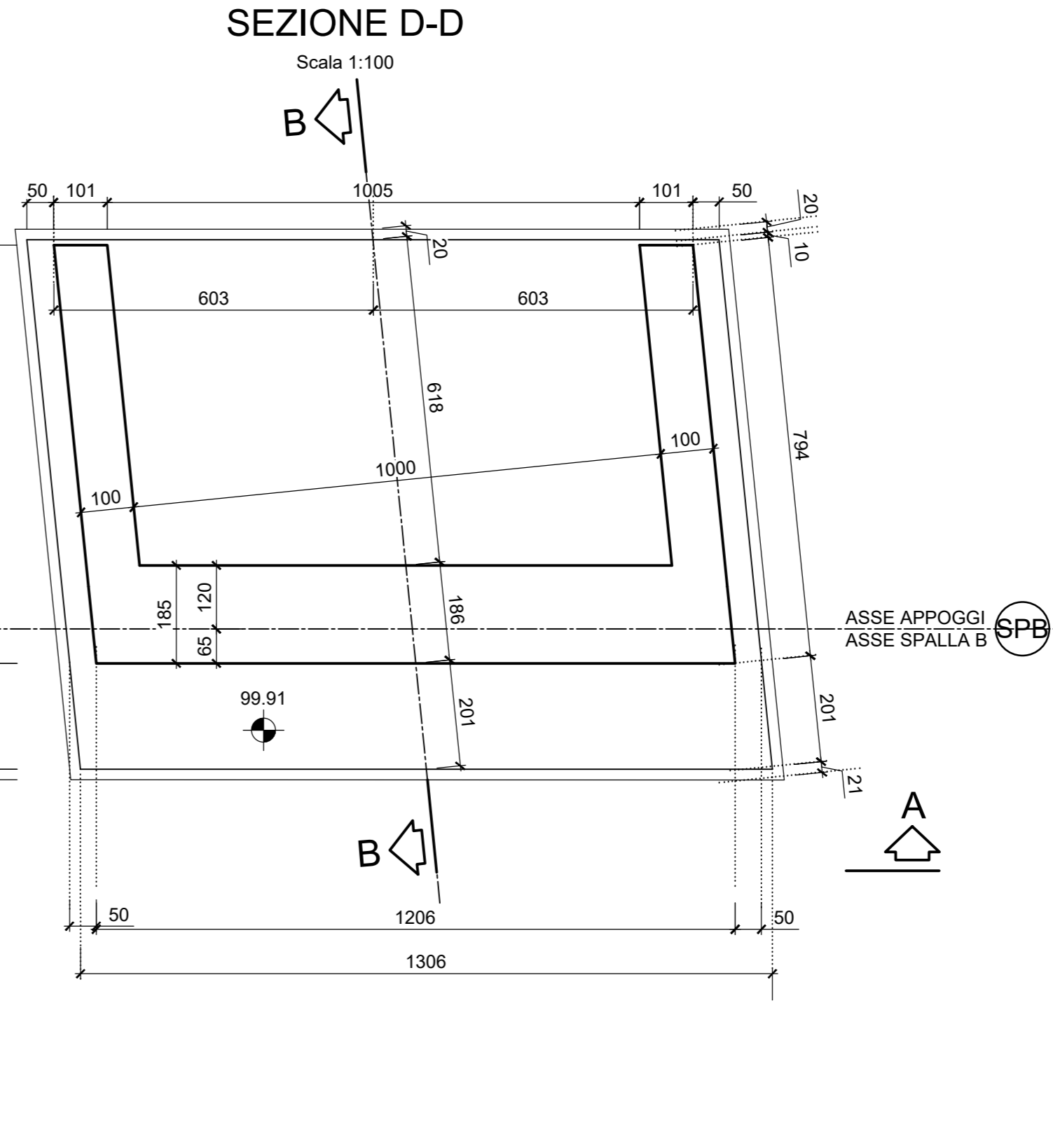
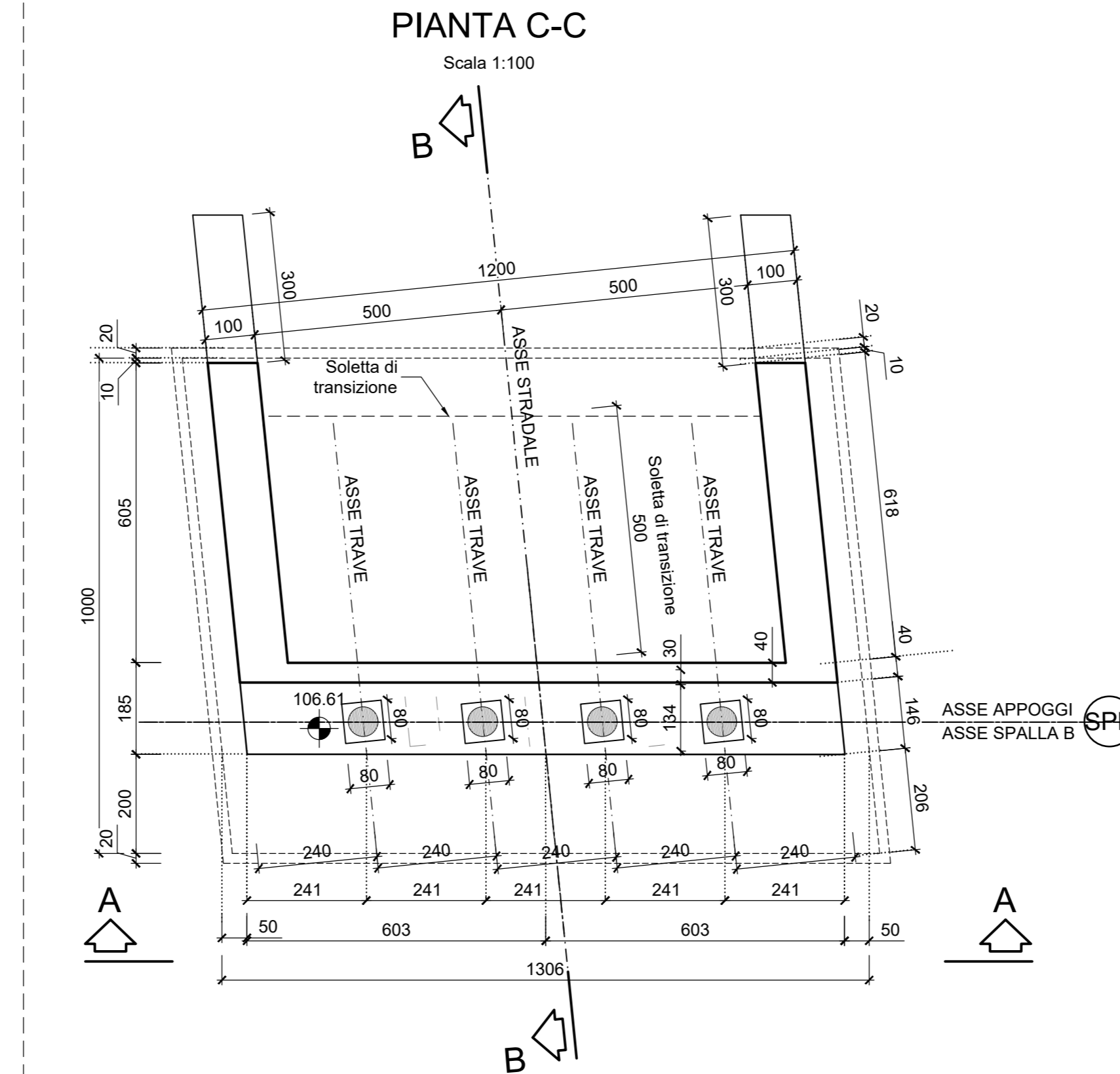
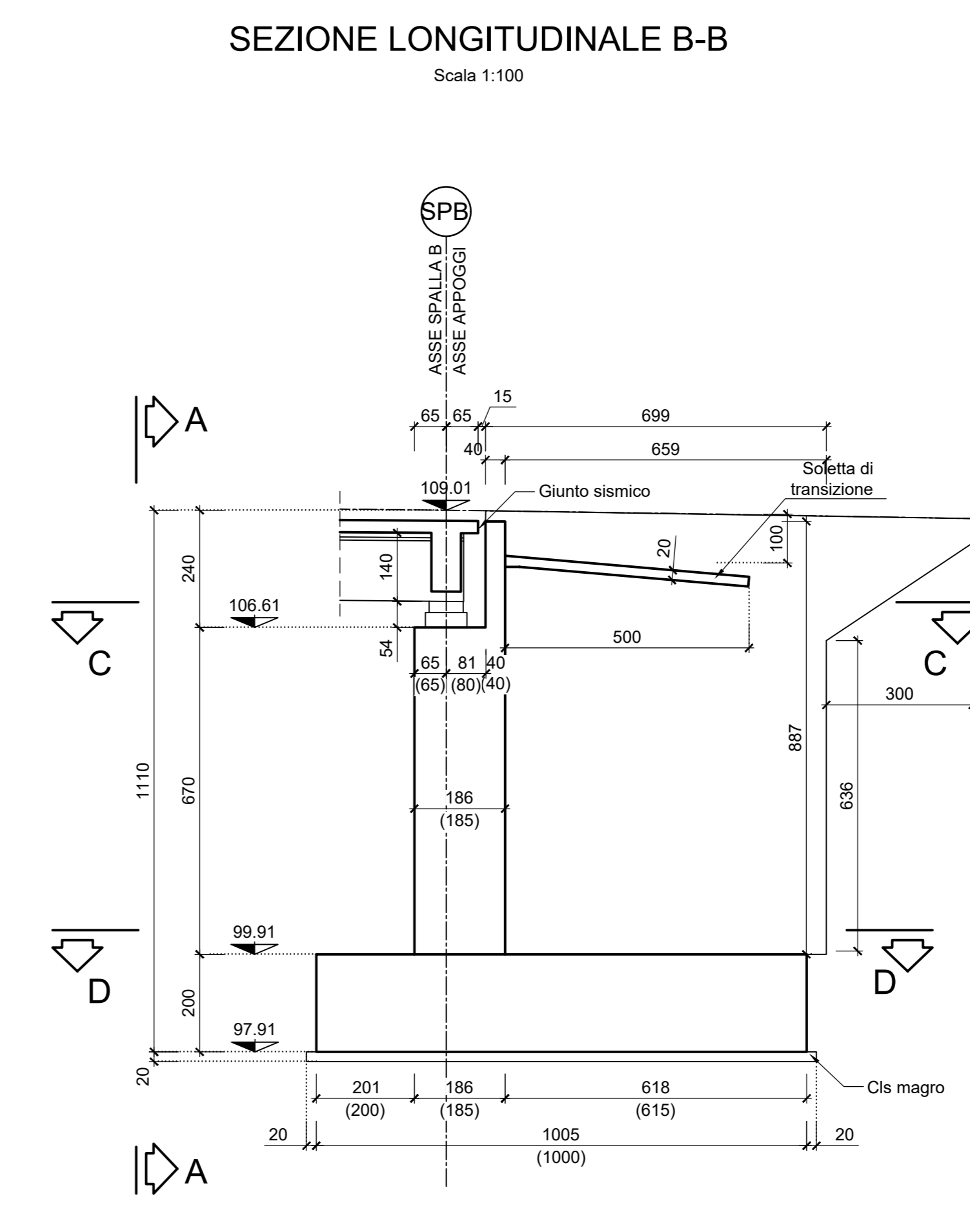
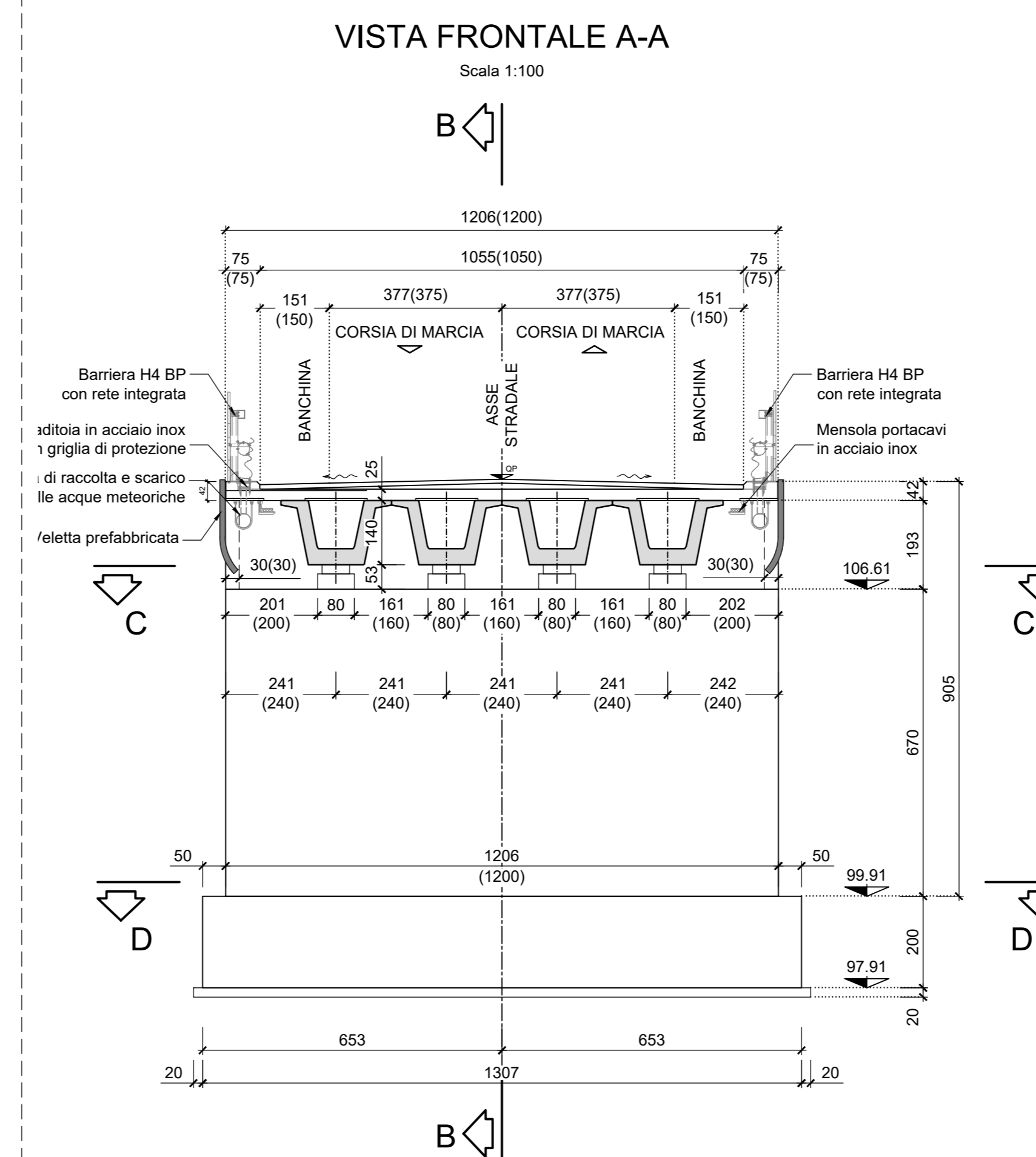

CARPENTERIA PILE
Scala 1:100

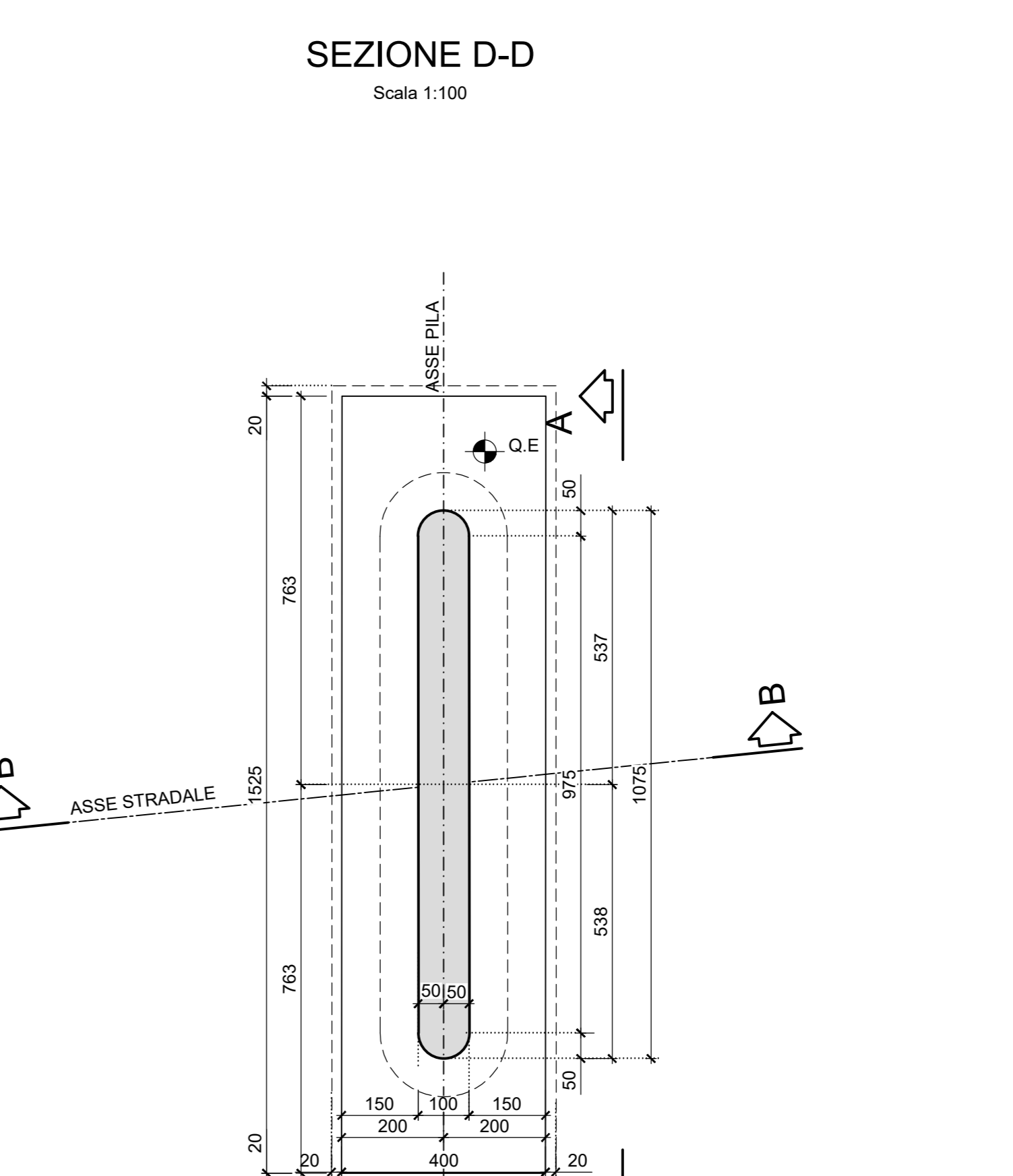
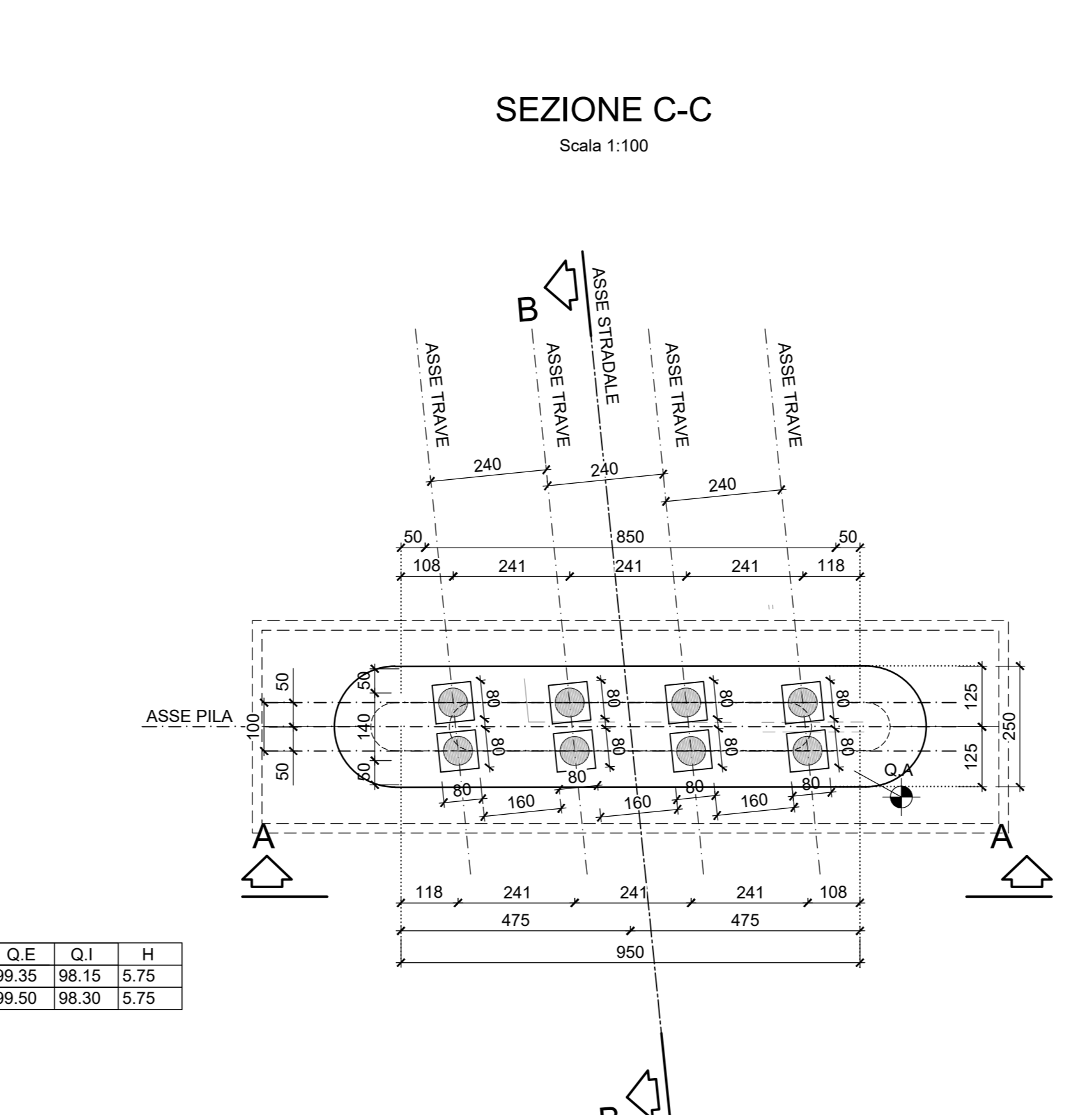
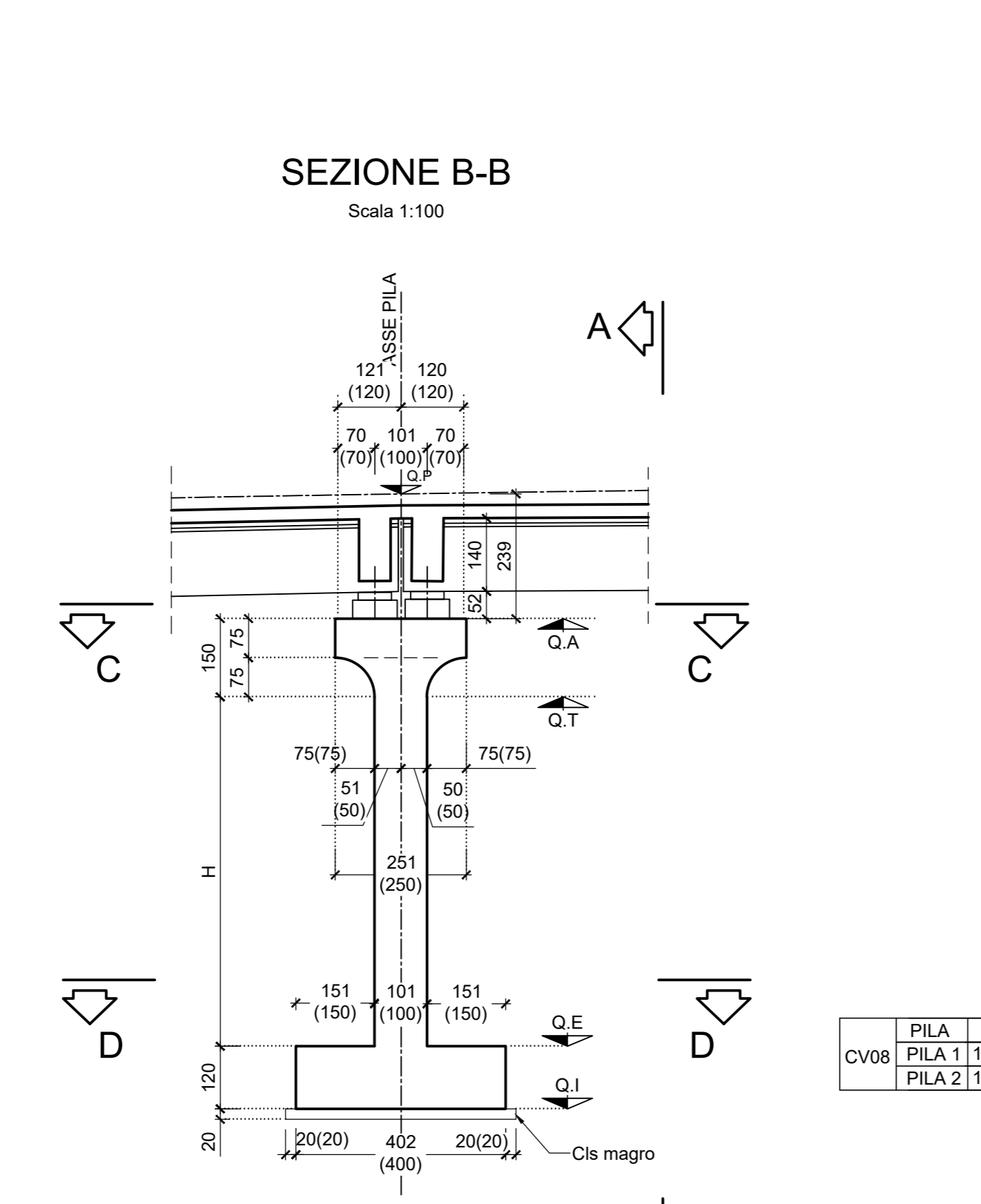
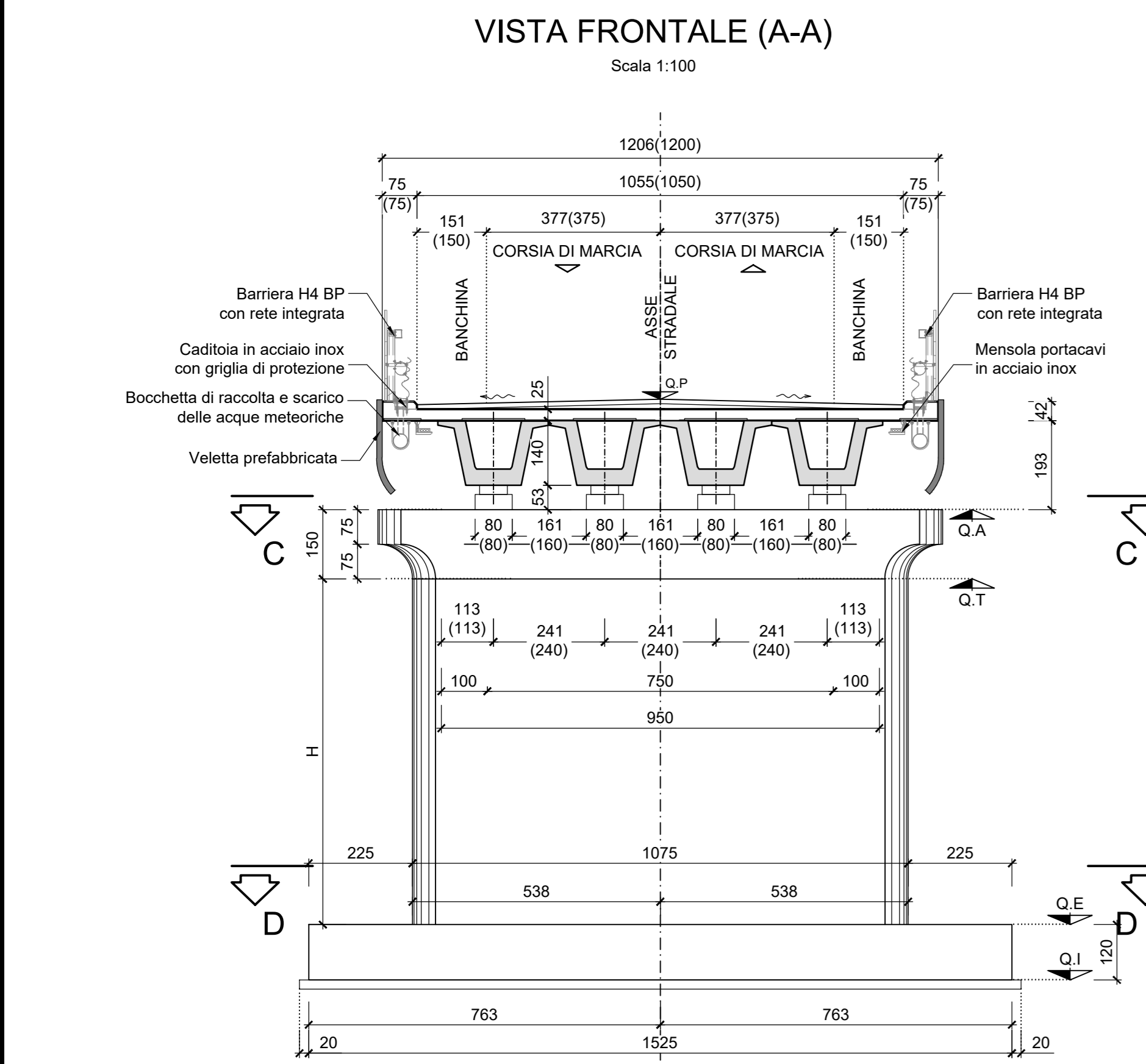

| PILA | Q.P. | Q.A. | Q.T. | Q.E. | Q.I. | H |
|-------------|--------|--------|--------|-------|-------|------|
| CV08 PILA 1 | 109.00 | 106.60 | 105.10 | 99.35 | 98.15 | 5.75 |
| PILA 2 | 108.15 | 105.75 | 105.25 | 99.50 | 98.30 | 5.75 |

Sanas GRUPPO FS ITALIANE Direzione Progettazione e Realizzazione Lavori

CORRIDOIO PLURIMODALE ADRIATICO
ITINERARIO MAGLIE - SANTA MARIA DI LEUCA
S.S. N° 275 "DI S. MARIA DI LEUCA"
LAVORI DI AMMODERNAMENTO E ADEGUAMENTO ALLA SEZ. B DEL D.M. 5.11.2001
S.S. 16 dal km 981+700 al km 985+386 - S.S. 275 dal km 0+000 al km 37+000
1° Lotto: Dal Km 0+000 di prog. al Km 23+300 di prog.

PROGETTO DEFINITIVO COD. BA283

PROGETTAZIONE: ANAS - COORDINAMENTO TERRITORIALE ABRUZZA

PROGETTISTI:
Ing. Alberto SANCHEZ - Proprietario e Coordinatore
Ing. Simone MARCOLLO - Progettista

COLLABORATORI:
Geom. Andrea DELL'ANNA
Geom. Massimo MARRINO
Geom. Giuseppe CALO'

INGEGNERI:
Rita Pasquale SCORCIA

COORDINATORE IN FASE DI PROGETTAZIONE:
Ing. Alberto SANCHEZ

RESPONSABILE DEL PROCEDIMENTO:
Ing. Gianfranco PAGLIARUSA

RESPONSABILE PROJECT MANAGEMENT PUGLIA:
Ing. Nicola MARO'

GEODATA ENGINEERING
Alpina
NET ENGINEERING

08 - OPERE D'ARTE MAGGIORI - VIADOTTI E PONTI
Cavalcavia (Comune di Surano)
CV 8 - al km 16+994.00
Carpenteria spalle e pile

| PROGETTO | LIV. PROG. | N. PROG. | REVISIONE | SCALA: |
|----------|------------|----------|-----------|--------|
| 10503A | 0 | 1701 | B | 1:100 |

| REV. | DESCRIZIONE | DATA | REDATTO | VERIFICATO | APPROVATO |
|------|--|-------------|------------------|------------|-----------|
| B | OTTIMIZZAZIONE PARERE AdB Puglia - PARERE CSLPPP | Aprile 2019 | N. Bono | | |
| A | REVISIONE DEL PROGETTO DEFINITIVO | Giugno 2018 | Ing. C. Beltrami | | |