

PIANTA FONDAZIONI
Scala 1:100

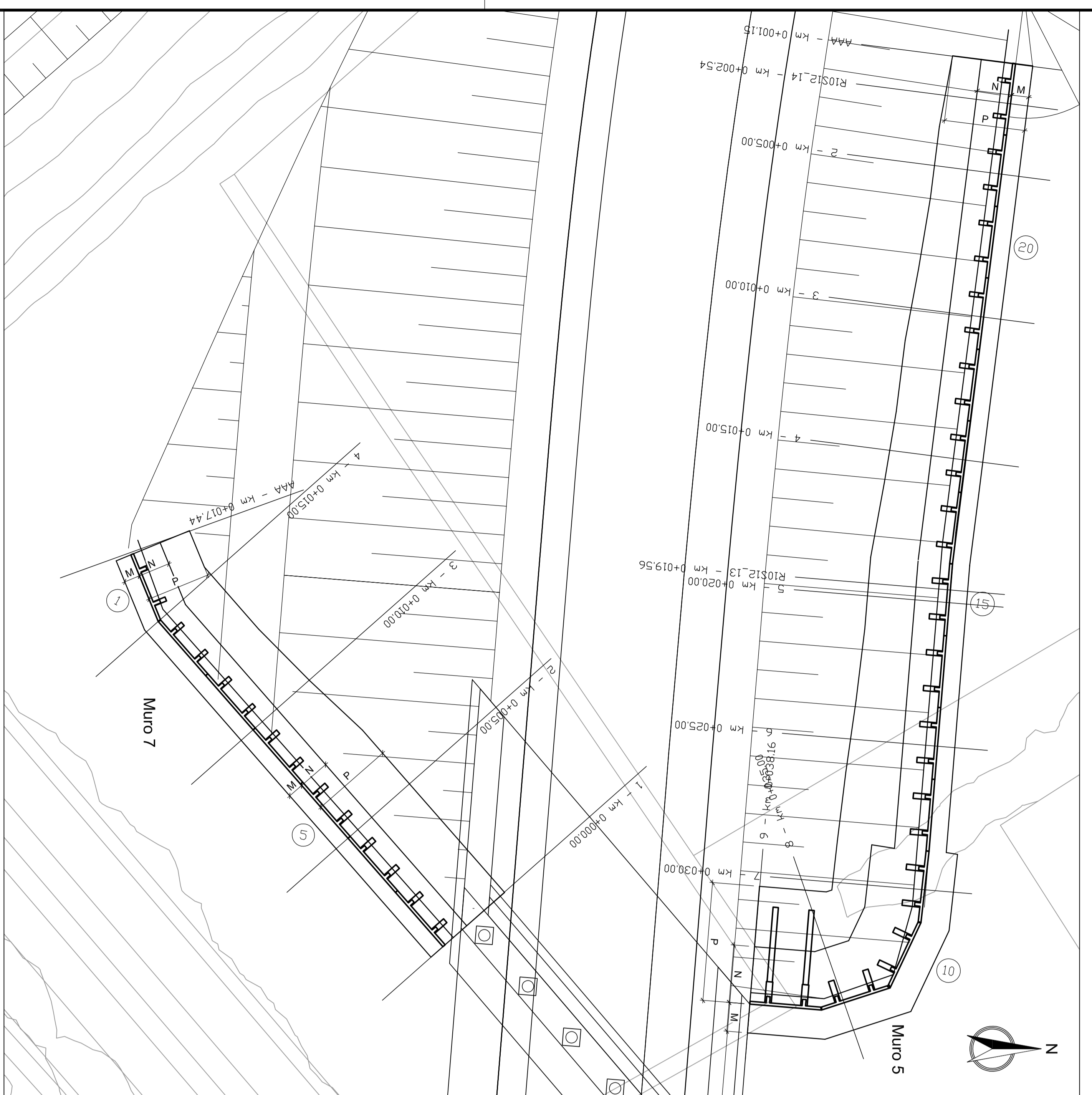

SEZIONE TIPO MURI
Scala 1:50

Dimensioni della struttura

Appl. n°	Palaia			Fondazione			Condolo			Volume galleria			Insieme
	H0	P	C	F	M	N	Paia	Paia	Paia	Paia	Paia	Paia	
1/10	1.50	1.10	1.00	0.60	0.35	0.55	0.50	0.50	0.50	0.50	0.50	0.50	6.00
1/11	1.40	1.00	1.00	0.60	0.35	0.55	0.78	0.60	0.60	0.60	0.60	0.60	6.14
1/12	1.30	1.00	1.00	0.60	0.35	0.55	0.78	0.60	0.60	0.60	0.60	0.60	6.14
1/13	1.20	1.00	1.00	0.60	0.35	0.55	0.78	0.60	0.60	0.60	0.60	0.60	6.14
1/14	1.10	1.00	1.00	0.60	0.35	0.55	0.78	0.60	0.60	0.60	0.60	0.60	6.14
1/15	1.00	1.00	1.00	0.60	0.35	0.55	0.78	0.60	0.60	0.60	0.60	0.60	6.14
1/16	0.90	1.00	1.00	0.60	0.35	0.55	0.78	0.60	0.60	0.60	0.60	0.60	6.14
1/17	0.80	1.00	1.00	0.60	0.35	0.55	0.78	0.60	0.60	0.60	0.60	0.60	6.14
1/18	0.70	1.00	1.00	0.60	0.35	0.55	0.78	0.60	0.60	0.60	0.60	0.60	6.14
1/19	0.60	1.00	1.00	0.60	0.35	0.55	0.78	0.60	0.60	0.60	0.60	0.60	6.14
1/20	0.50	1.00	1.00	0.60	0.35	0.55	0.78	0.60	0.60	0.60	0.60	0.60	6.14
1/21	0.40	1.00	1.00	0.60	0.35	0.55	0.78	0.60	0.60	0.60	0.60	0.60	6.14
1/22	0.30	1.00	1.00	0.60	0.35	0.55	0.78	0.60	0.60	0.60	0.60	0.60	6.14
1/23	0.20	1.00	1.00	0.60	0.35	0.55	0.78	0.60	0.60	0.60	0.60	0.60	6.14
1/24	0.10	1.00	1.00	0.60	0.35	0.55	0.78	0.60	0.60	0.60	0.60	0.60	6.14

KEYPLAN

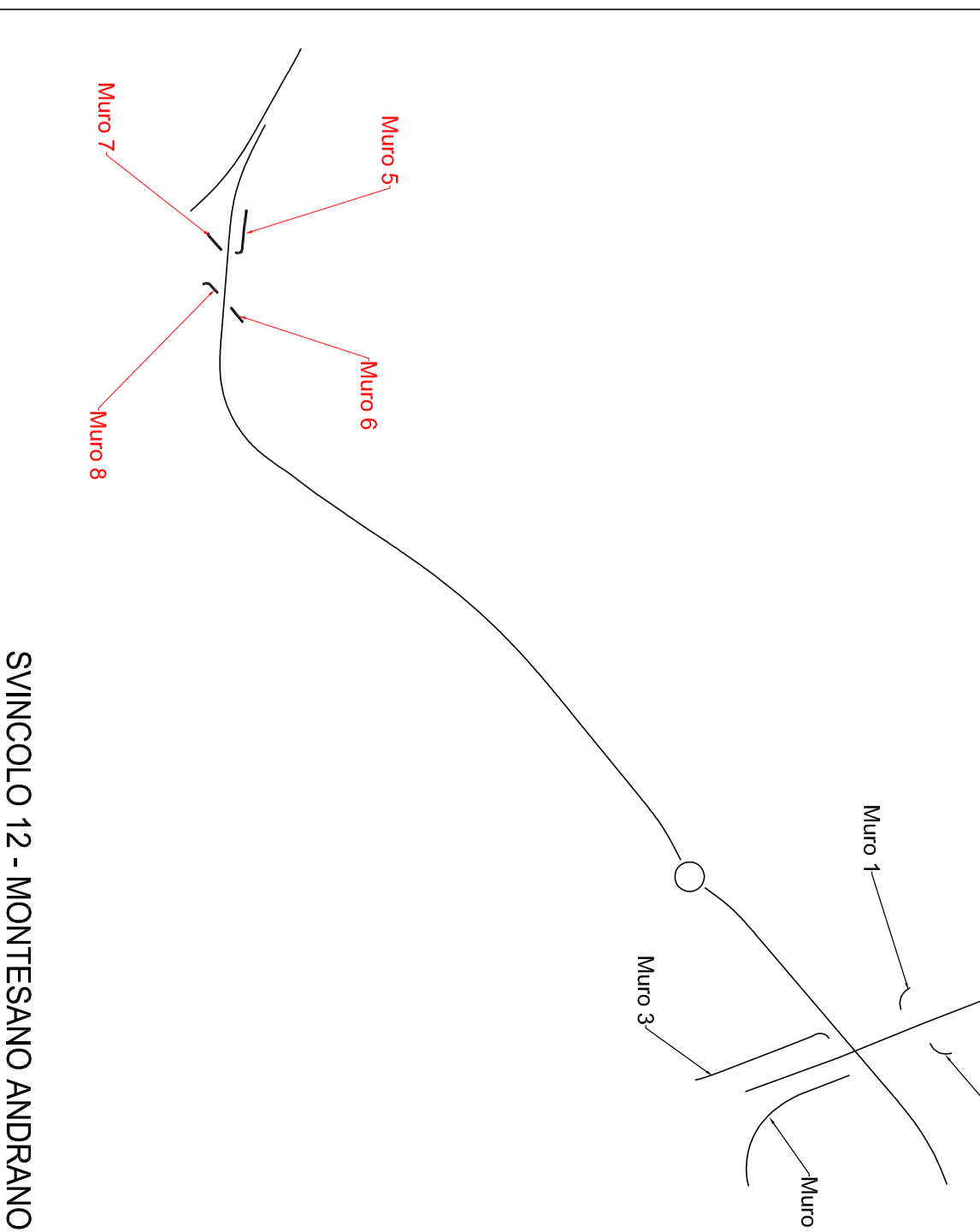

MURO 5:	SCAVO	m² 92,389
MURO 6:	SEZIONE OBBLIGATA	m² 84,132
MURO 7:	SEZIONE OBBLIGATA	m² 30,150
MURO 8:	SEZIONE OBBLIGATA	m² 24,750
MURO 9:	SEZIONE OBBLIGATA	m² 24,750
MURO 1:	SCAVO	m² 47,060
MURO 2:	SEZIONE OBBLIGATA	m² 24,344
MURO 3:	SCAVO	m² 28,775
MURO 4:	SEZIONE OBBLIGATA	m² 47,072

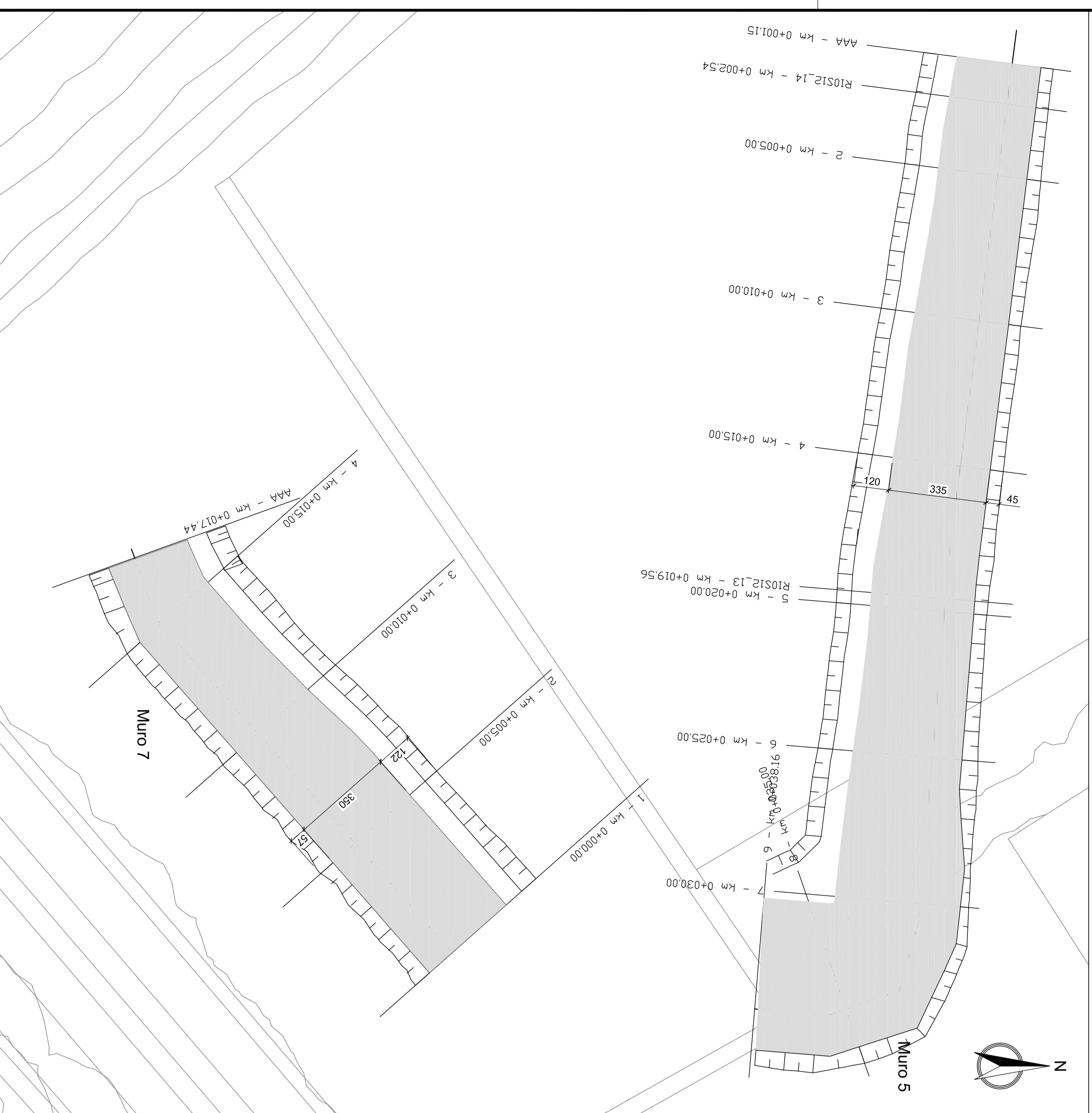
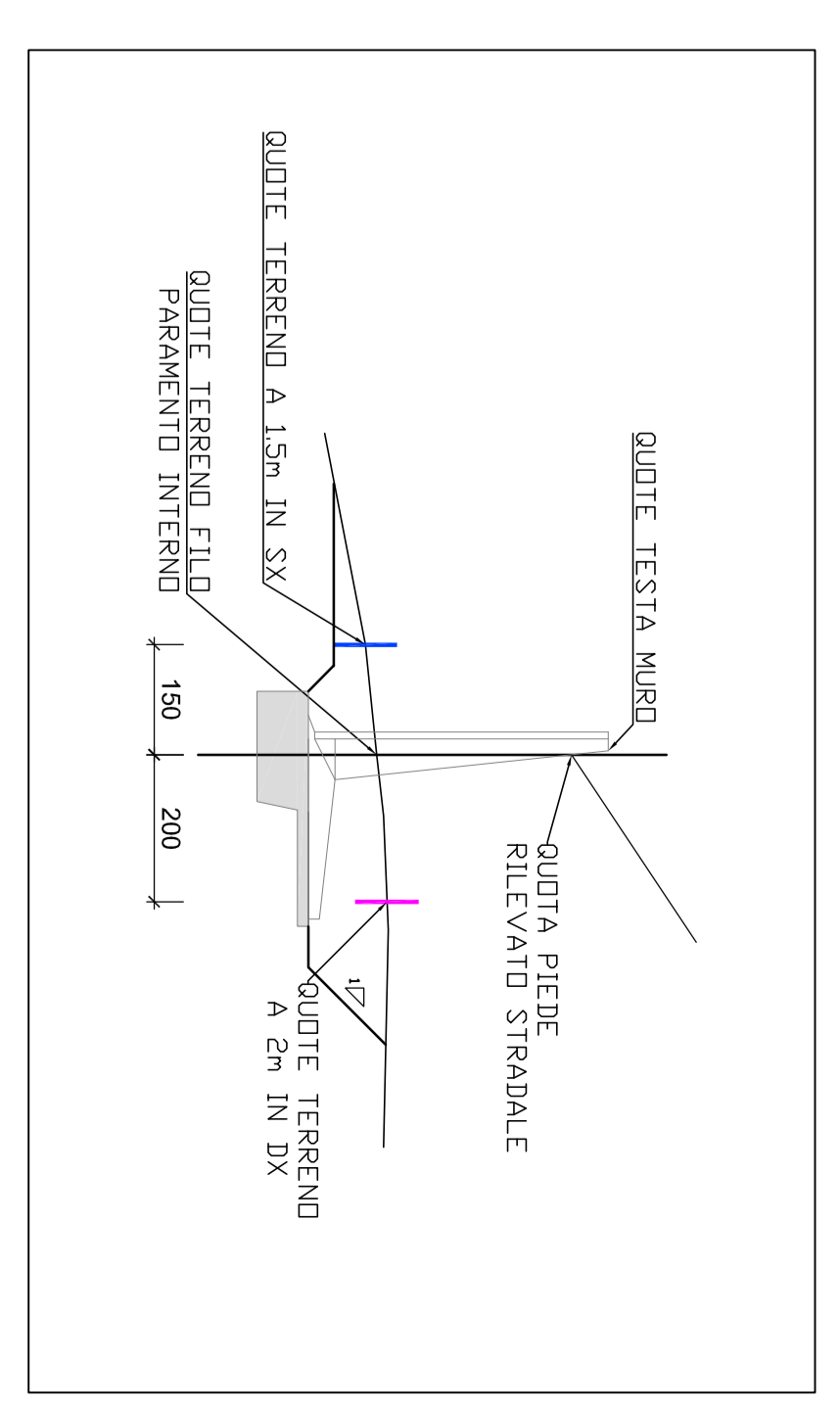

SEZIONE TIPO MURI
Scala 1:50

Dimensioni della struttura

Appl. n°	Palaia			Fondazione			Condolo			Volume galleria			Insieme
	H0	P	C	F	M	N	Paia	Paia	Paia	Paia	Paia	Paia	
1/10	1.50	1.10	1.00	0.60	0.35	0.55	0.50	0.50	0.50	0.50	0.50	0.50	6.00
1/11	1.40	1.00	1.00	0.60	0.35	0.55	0.78	0.60	0.60	0.60	0.60	0.60	6.14
1/12	1.30	1.00	1.00	0.60	0.35	0.55	0.78	0.60	0.60	0.60	0.60	0.60	6.14
1/13	1.20	1.00	1.00	0.60	0.35	0.55	0.78	0.60	0.60	0.60	0.60	0.60	6.14
1/14	1.10	1.00	1.00	0.60	0.35	0.55	0.78	0.60	0.60	0.60	0.60	0.60	6.14
1/15	1.00	1.00	1.00	0.60	0.35	0.55	0.78	0.60	0.60	0.60	0.60	0.60	6.14
1/16	0.90	1.00	1.00	0.60	0.35	0.55	0.78	0.60	0.60	0.60	0.60	0.60	6.14
1/17	0.80	1.00	1.00	0.60	0.35	0.55	0.78	0.60	0.60	0.60	0.60	0.60	6.14
1/18	0.70	1.00	1.00	0.60	0.35	0.55	0.78	0.60	0.60	0.60	0.60	0.60	6.14
1/19	0.60	1.00	1.00	0.60	0.35	0.55	0.78	0.60	0.60	0.60	0.60	0.60	6.14
1/20	0.50	1.00	1.00	0.60	0.35	0.55	0.78	0.60	0.60	0.60	0.60	0.60	6.14
1/21	0.40	1.00	1.00	0.60	0.35	0.55	0.78	0.60	0.60	0.60	0.60	0.60	6.14
1/22	0.30	1.00	1.00	0.60	0.35	0.55	0.78	0.60	0.60	0.60	0.60	0.60	6.14
1/23	0.20	1.00	1.00	0.60	0.35	0.55	0.78	0.60	0.60	0.60	0.60	0.60	6.14
1/24	0.10	1.00	1.00	0.60	0.35	0.55	0.78	0.60	0.60	0.60	0.60	0.60	6.14

ananas Direzione Progettazione e Realizzazione Lavori

CORRIDOIO PLURIMODALE ADRIATICO
ITINERARIO MAGLIE - SANTA MARIA DI LEUCA

LAVORI DI AMMODERNAMENTO E ADEGUAMENTO ALLA SEZ. B DEL D.M. 5.11.2001

S.S. 16 del km 981+700 al km 985+386 - S.S. 275 del km 0+000 al km 3+000
1° Lotto: Dal km 0+000 di Prog. al km 23+300 di Prog.

PROGETTO DEFINITIVO

09 - OPERE D'ARTE MINORI
Muro Opere complementari al Cavalcavia Ferroviario Montesano-Andrano ST25-OS22

Pianta fondazioni e scavi

PROGETTAZIONE: **ananas** - **CONSORZIO TERRITORIALE ADRIATICO**
RTP: **Lombardi Ingegneria S.r.l.** - **Struttura**
Technoproget S.r.l. - **Scienze**

SCALE: 1:100

REVISIONE: **ananas**

CONFERMA PROGETTO: **ananas**

CONFERMA OPERE: **ananas**

CONFERMA POSIZIONE: **ananas**

CONFERMA QUANTITÀ: **ananas**

CONFERMA NOTE: **ananas**

CONFERMA ALTRI: **ananas**

CONFERMA MATERIALI: **ananas**

CONFERMA COSTI: **ananas**

CONFERMA TEMPI: **ananas**

CONFERMA ALTRI: **ananas**

CONFERMA MATERIALI: **ananas**

CONFERMA COSTI: **ananas**

CONFERMA TEMPI: **ananas**