

PLANIMETRIA DI PROGETTO
SCALA 1:1000

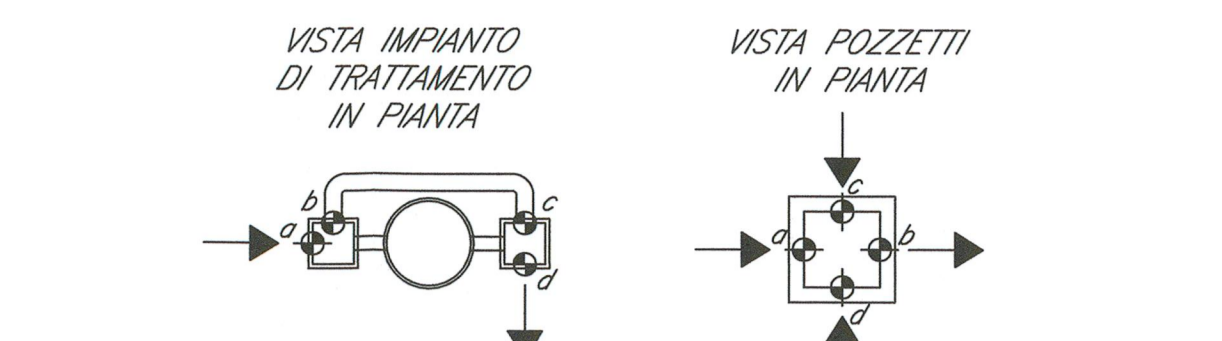
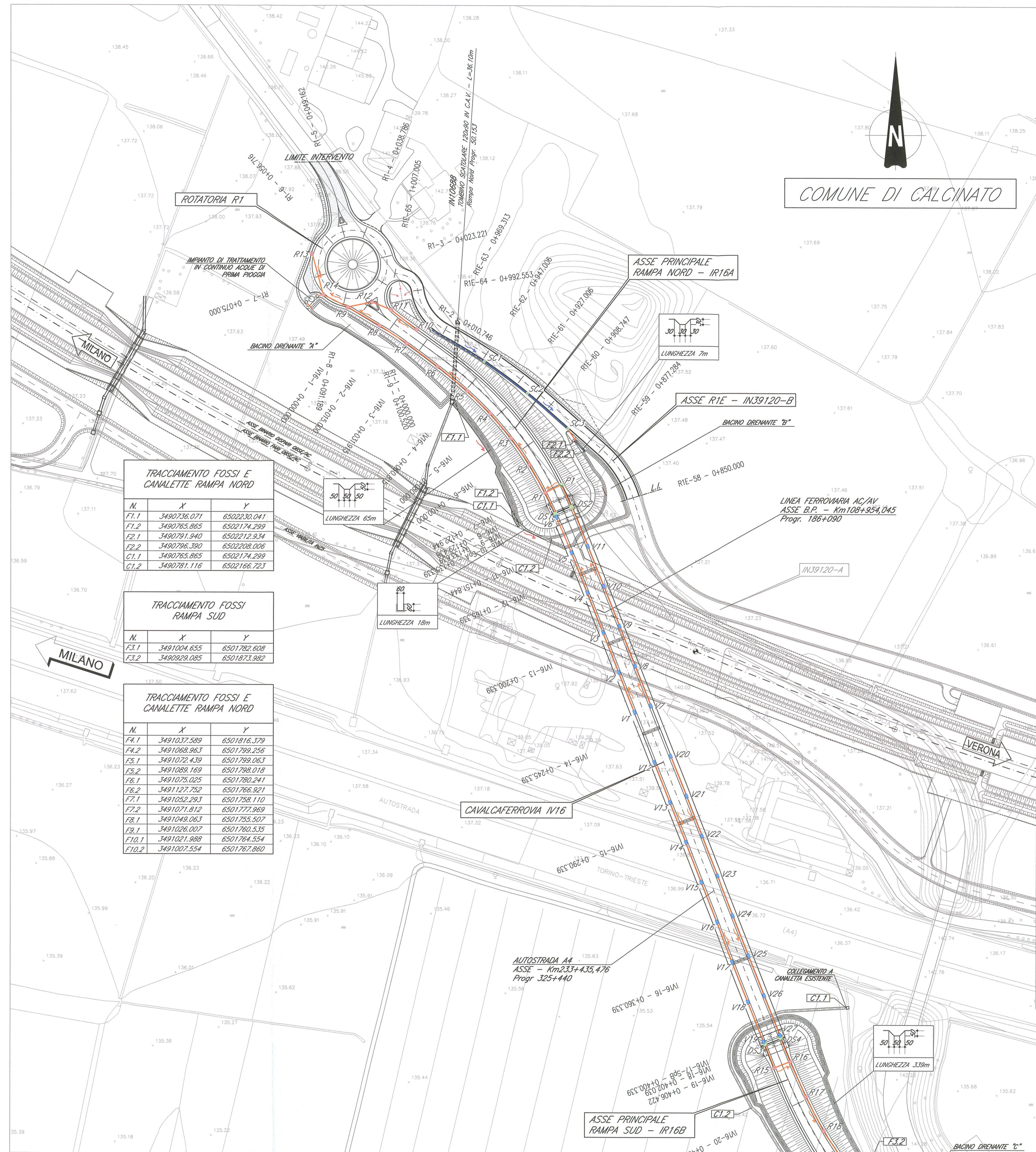

IMPIANTO DI TRATTAMENTO DELLE ACQUE DI PRIMA PIOGGIA

Impianto	quota "a"	quota "b"	quota "c"	quota "d"
Impianto "A" - Rampa Nord	137,431	137,503	137,413	137,381
Impianto "B" - Rampa Sud	135,020	135,115	135,082	134,970

QUOTE DI POSA TUBAZIONI DI DRENAGGIO

Fogetto	DATA TRACCIAMENTO	quota "a"	quota "b"	quota "c"	quota "d"
R1	349076.549	6502182.302	144,689	144,747	144,191
R2	349076.282	6502188.454	143,942	143,942	144,191
R3	349076.036	6502201.628	143,222	143,222	144,191
R4	349076.040	6502213.859	142,292	142,292	144,191
R5	349075.710	6502225.415	141,362	141,362	144,191
R6	349074.535	6502235.890	140,432	140,432	144,191
R7	349072.652	6502247.380	139,362	139,362	144,191
R8	349071.312	6502258.148	138,420	138,420	144,191
R9	349070.031	6502266.374	137,885	137,885	144,191
R10	349068.794	6502274.990	137,611	137,611	137,757
R11	349071.843	6502284.517	138,532	138,532	137,757
R12	349070.800	6502273.713	137,997	137,997	137,757
R13	349069.594	6502266.351	137,885	137,885	137,757
R14	349068.294	6502258.148	137,885	137,885	137,757
R15	349066.994	6502249.842	137,885	137,885	137,757
R16	349065.694	6502241.536	137,885	137,885	137,757
R17	349064.394	6502233.230	137,885	137,885	137,757
R18	349063.094	6502224.924	137,885	137,885	137,757
R19	349061.794	6502216.618	137,885	137,885	137,757
R20	349060.494	6502208.312	137,885	137,885	137,757
R21	349059.194	6502200.006	137,885	137,885	137,757
R22	349057.894	6502191.700	137,885	137,885	137,757
R23	349056.594	6502183.394	137,885	137,885	137,757
R24	349055.294	6502175.088	137,885	137,885	137,757
R25	349053.994	6502166.782	137,885	137,885	137,757
R26	349052.694	6502158.476	137,885	137,885	137,757
R27	349051.394	6502150.170	137,885	137,885	137,757
R28	349050.094	6502141.864	137,885	137,885	137,757
R29	349048.794	6502133.558	137,885	137,885	137,757
R30	349047.494	6502125.252	137,885	137,885	137,757
R31	349046.194	6502116.946	137,885	137,885	137,757
R32	349044.894	6502108.640	137,885	137,885	137,757
R33	349043.594	6502100.334	137,885	137,885	137,757
R34	349042.294	6502092.028	137,885	137,885	137,757
R35	349040.994	6502083.722	137,885	137,885	137,757
R36	349039.694	6502075.416	137,885	137,885	137,757
R37	349038.394	6502067.110	137,885	137,885	137,757
R38	349037.094	6502058.804	137,885	137,885	137,757
R39	349035.794	6502050.498	137,885	137,885	137,757
R40	349034.494	6502042.192	137,885	137,885	137,757
R41	349033.194	6502033.886	137,885	137,885	137,757
R42	349031.894	6502025.580	137,885	137,885	137,757
R43	349030.594	6502017.274	137,885	137,885	137,757
R44	349029.294	6502008.968	137,885	137,885	137,757
R45	349027.994	6502000.662	137,885	137,885	137,757
R46	349026.694	6501992.356	137,885	137,885	137,757
R47	349025.394	6501984.050	137,885	137,885	137,757
R48	349024.094	6501975.744	137,885	137,885	137,757
R49	349022.794	6501967.438	137,885	137,885	137,757
R50	349021.494	6501959.132	137,885	137,885	137,757
R51	349020.194	6501950.826	137,885	137,885	137,757
R52	349018.894	6501942.520	137,885	137,885	137,757
R53	349017.594	6501934.214	137,885	137,885	137,757
R54	349016.294	6501925.908	137,885	137,885	137,757
R55	349014.994	6501917.602	137,885	137,885	137,757
R56	349013.694	6501909.296	137,885	137,885	137,757
R57	349012.394	6501900.990	137,885	137,885	137,757
R58	349011.094	6501892.684	137,885	137,885	137,757
R59	349009.794	6501884.378	137,885	137,885	137,757
R60	349008.494	6501876.072	137,885	137,885	137,757
R61	349007.194	6501867.766	137,885	137,885	137,757
R62	349005.894	6501859.460	137,885	137,885	137,757
R63	349004.594	6501851.154	137,885	137,885	137,757
R64	349003.294	6501842.848	137,885	137,885	137,757
R65	349001.994	6501834.542	137,885	137,885	137,757
R66	348999.694	6501826.236	137,885	137,885	137,757
R67	348998.394	6501817.930	137,885	137,885	137,757
R68	348997.094	6501809.624	137,885	137,885	137,757
R69	348995.794	6501801.318	137,885	137,885	137,757
R70	348994.494	6501793.012	137,885	137,885	137,757
R71	348993.194	6501784.706	137,885	137,885	137,757
R72	348991.894	6501776.400	137,885	137,885	137,757
R73	348990.594	6501768.094	137,885	137,885	137,757
R74	348989.294	6501759.788	137,885	137,885	137,757
R75	348987.994	6501751.482	137,885	137,885	137,757
R76	348986.694	6501743.176	137,885	137,885	137,757
R77	348985.394	6501734.870	137,885	137,885	137,757
R78	348984.094	6501726.564	137,885	137,885	137,757
R79	348982.794	6501718.258	137,885	137,885	137,757
R80	348981.494	6501709.952	137,885	137,885	137,757
R81	348980.194	6501701.646	137,885	137,885	137,757
R82	348978.894	6501693.340	137,885	137,885	137,757
R83	348977.594	6501685.034	137,885	137,885	137,757
R84	348976.294	6501676.728	137,885	137,885	137,757
R85	348974.994	6501668.422	137,885	137,885	137,757
R86	348973.694	6501660.116	137,885	137,885	137,757
R87	348972.394	6501651.810	137,885	137,885	137,757
R88	348971.094	6501643.504	137,885	137,885	137,757
R89	348969.794	6501635.198	137,885	137,885	137,757
R90	348968.494	6501626.892	137,885	137,885	137,757
R91	348967.194	6501618.586	137,885	137,885	137,757
R92	348965.894	6501610.280	137,885	137,885	137,757
R93	348964.594	6501601.974	137,885	137,885	137,757
R94	348963.294	6501593.668	137,885	137,885	137,757
R95	348961.994	6501585.362	137,885	137,885	137,757
R96	348960.694	6501577.056	137,885	137,885	137,757
R97	348959.394	6501568.750	137,885	137,885	137,757
R98	348958.094	6501560.444	137,885	137,885	137,757
R99	348956.794	6501552.138	137,885	137,885	137,757
R100	348955.494	6501543.832	137,885	137,885	137,757

TUBAZIONI DI DRENAGGIO

Tetto	Ø (mm)	lunghezza (m)	Tipologia
VI-D51	250	100,00	PVC-SM4
VI-D52	250	100,00	PVC-SM4
VI-D53	250	111,20	PVC-SM4
PI-R1	315	8,40	PVC-SM8
DS1-R8	315	111,20	PVC-SM4
RS-R9	400	95,00	PVC-SM4
R10-R12	400	25,00	PVC-SM4
R12-R9	250	11,70	PVC-SM8
RS-R14	400	14,50	PVC-SM4
RI-R14	200	18,50	PVC-SM4
R14-ingresso Impianto A	400	1,80	PVC-SM4
Bypass Impianto A	400	9,00	PVC-SM4
Scarico Impianto A	400	3,50	PVC-SM4
VI-D53	250	141,50	PVC-SM4
V20-D54	250	141,50	PVC-SM4
DS3-R15	315	12,00	PVC-SM4
R15-R16	250	8,00	PVC-SM8
DS4-R22	315	111,00	PVC-SM4
R22-R24	400	30,00	PVC-SM4
RS-R28	500	58,00	PVC-SM4
R30-R29	200	14,00	PVC-SM4
R30-R29	250	11,00	PVC-SM4
PS-R28	250	15,10	PVC-SM8
R31-R33	200	42,00	PVC-SM8
R33-R34	250	20,20	PVC-SM8
RS-R34	315	21,00	PVC-SM8
RS-R38	315	3,30	PVC-SM4
R38-ingresso Impianto B	500	9,00	PVC-SM4
Bypass Impianto B	500	9,00	PVC-SM4
Scarico Impianto B	500	1,80	PVC-SM4
SC1-Hacca drenante B"	250	51,00	PVC-SM4

BACINI DRENANTI
SCALA 1:500

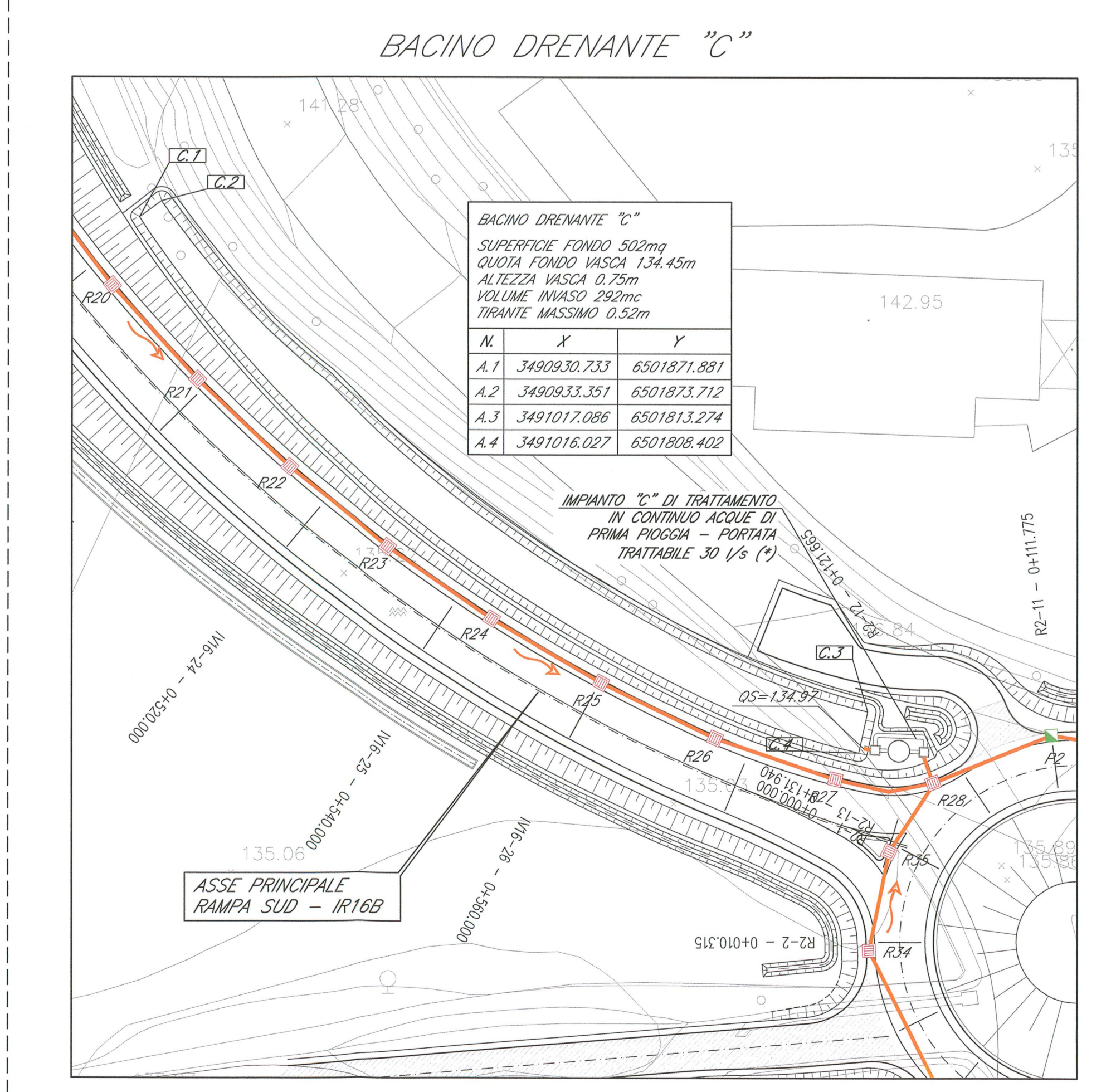
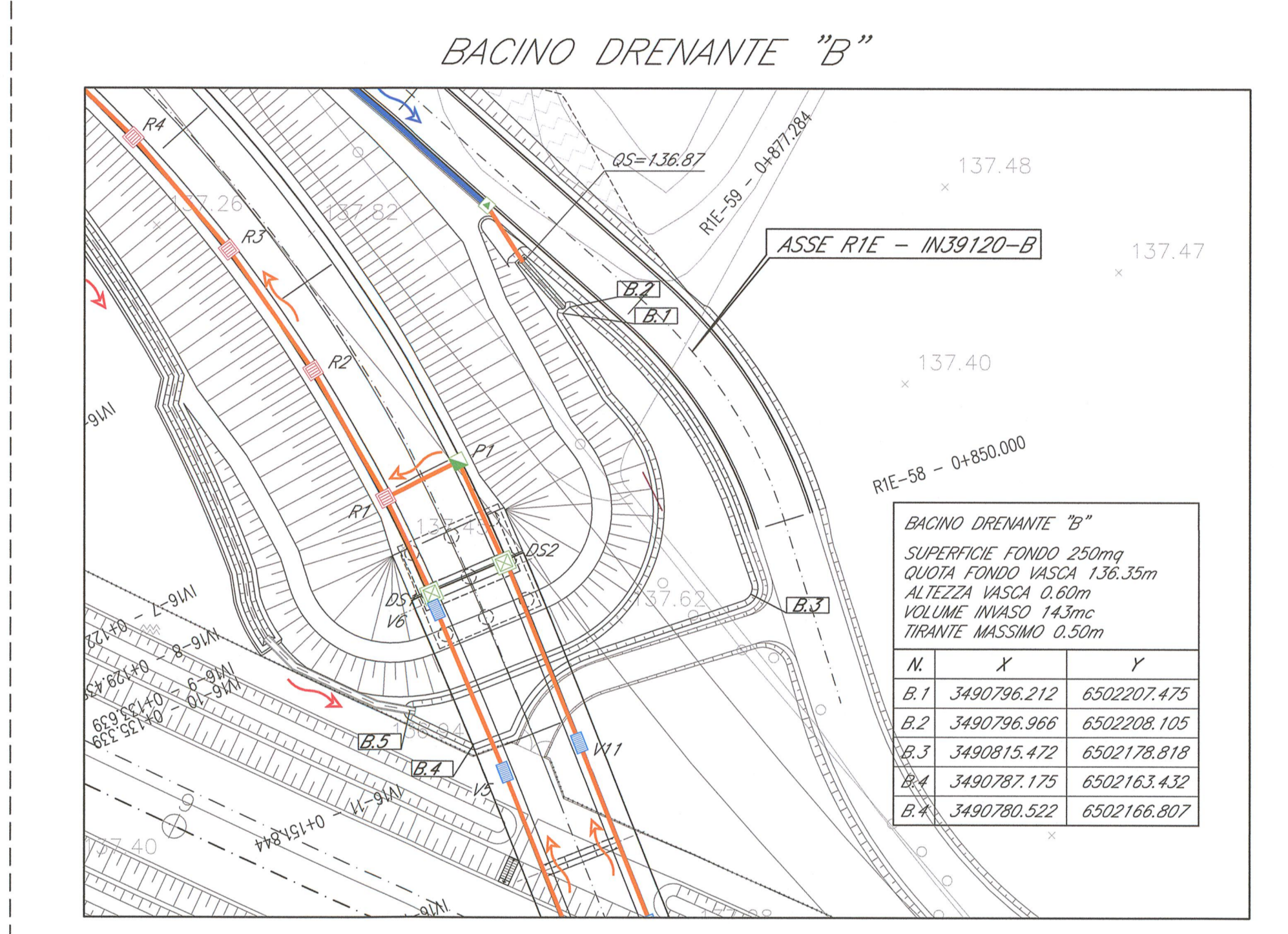
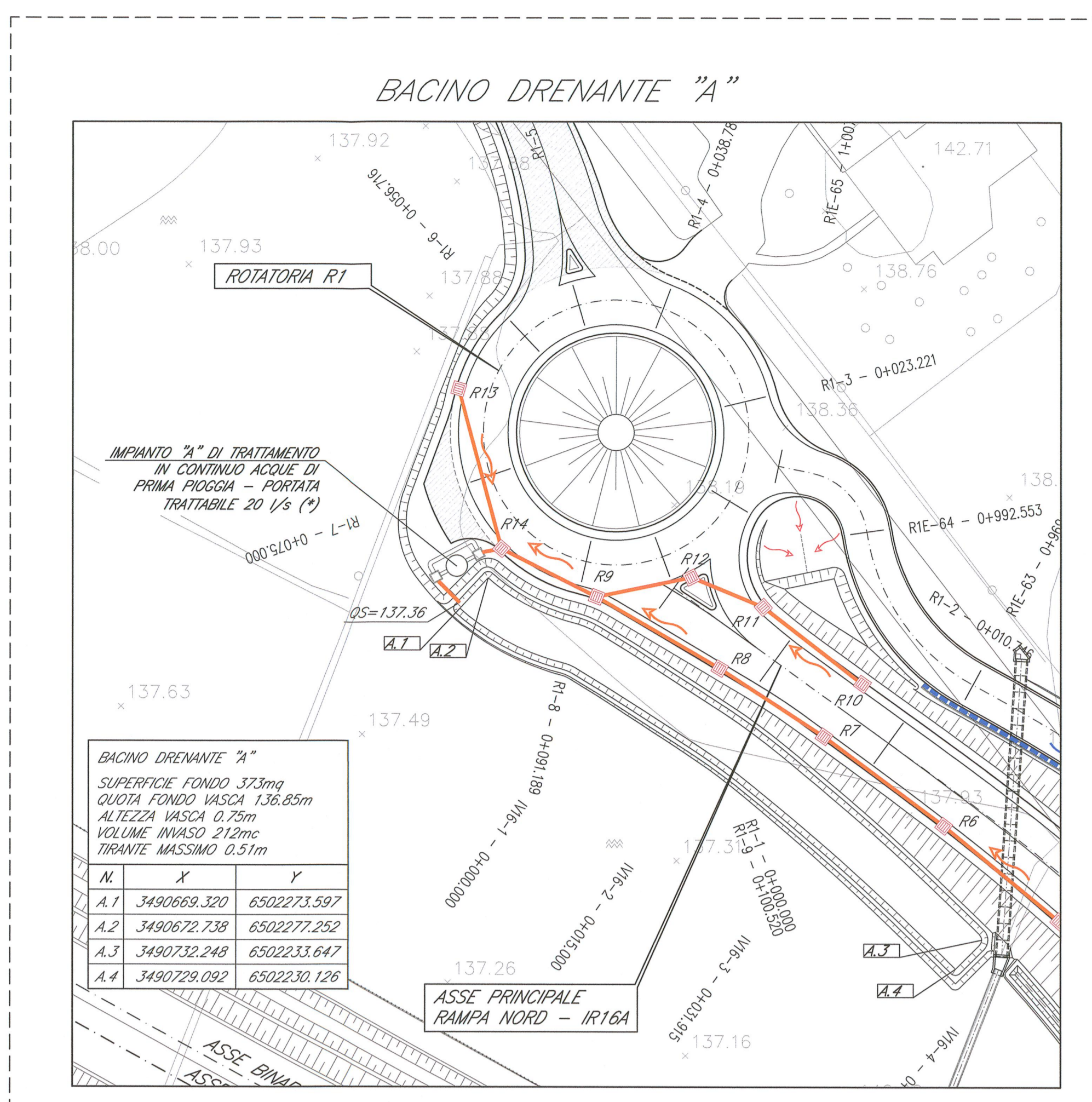

TRACCIAMENTO CAVALETTE IRRIGUE - ROTATORIA R2
SCALA 1:500

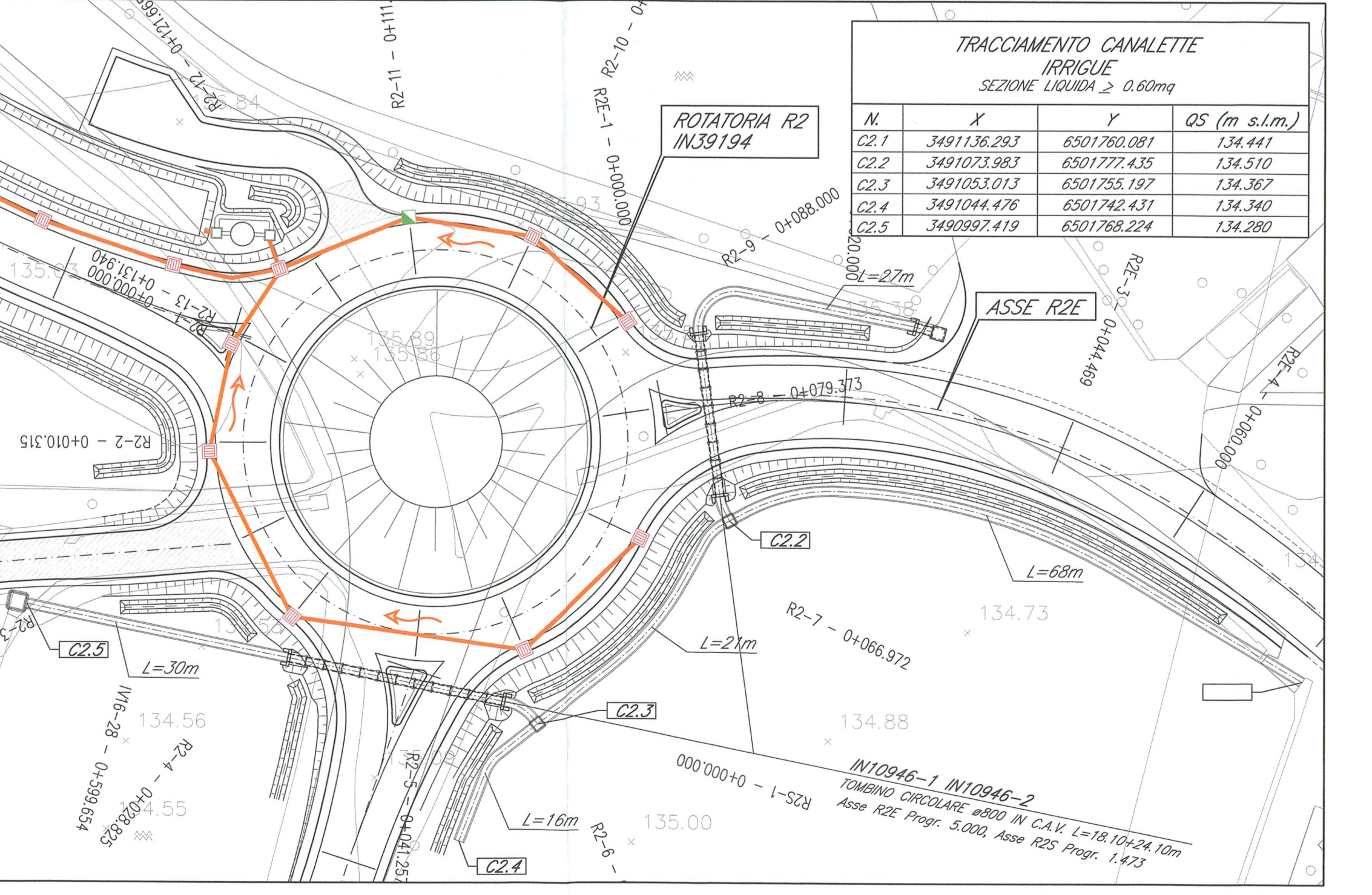

DOCUMENTI DI RIFERIMENTO

DESCRIZIONE	CODICE
8/00 - ELABORATI DI TRACCIAMENTO LINEA A.V./I.C. RELAZIONE TECNICA DEL TRACCIAMENTO	IN011EE2P001000001
8/07 - RELATIVO COLLEG. GISE-A.V./I.C. DA PK 107+680,000 A PK 109+134,000 - PLANIMETRIA DI PROGETTO - TAVOLA 4	IN011EE2P001000004
8/00 - CAVALCAFERROVIA TIPOLOGICO PRESCRIZIONI MATERIALI E AZIENDA GENERALI	IN011EE2P001000001
STRADA CATEGORIA P3 - CARPENTERIA IMPALCATO - DETTAGLI	IN011EE2P001000001
SMALTIMENTO ACQUE METEORICHE - CANTINA CON BOLLICINO	IN011EE2P001000001
SMALTIMENTO ACQUE METEORICHE - ELEMENTO DI DISCONNESSIONE TIPO B	IN011EE2P001000002
1/16 - CAVALCAFERROVIA VIA BRESCIA - PK 108+954,045	IN011EE2P001000005
PIANTA FONDAZIONI E PAVI IMPALCATO - DIV. 1/2	IN011EE2P001000002
PIANTA FONDAZIONI E PAVI IMPALCATO - DIV. 2/2	IN011EE2P001000002
SEZIONE LONGITUDINALE, PROSPETTO LONGITUDINALE E SEZIONI TRASVERSALI - DIV. 1/2	IN011EE2P001000002
SEZIONE LONGITUDINALE, PROSPETTO LONGITUDINALE E SEZIONI TRASVERSALI - DIV. 1/2	IN011EE2P001000002
CARPENTERIA SPALLA A	IN011EE2P001000001
CARPENTERIA SPALLA B	IN011EE2P001000001
CARPENTERIA METALLICA IMPALCATO - TRAVERSI - DIV. 1/2	IN011EE2P001000001
CARPENTERIA METALLICA IMPALCATO - TRAVERSI - DIV. 2/2	IN011EE2P001000001
8/00 - RAMPE CAVALCAFERROVIA TIPOLOGICO PRESCRIZIONI MATERIALI E AZIENDA GENERALI	IN011EE2P001000001
STRADA DI CATEGORIA P3 - SEZIONI TIPO E DETTAGLI TAVOLA 1/2	IN011EE2P001000001
STRADA DI CATEGORIA P3 - SEZIONI TIPO E DETTAGLI TAVOLA 2/2	IN011EE2P001000001
SMALTIMENTO ACQUE METEORICHE PARTICOLARI TAVOLA 1/3	IN011EE2P001000001
SMALTIMENTO ACQUE METEORICHE PARTICOLARI TAVOLA 2/3	IN011EE2P001000001
SMALTIMENTO ACQUE METEORICHE PARTICOLARI TAVOLA 1/3	IN011EE2P001000001
PARTICOLARI ASSOLUZIONE INTERFERENZE CON CAVALETTE IRRIGUE	IN011EE2P001000001
1/16 - RAMPE CAVALCAFERROVIA VIA BRESCIA - PK 108+954,045	IN011EE2P001000005
RELAZIONE TECNICA GENERALE RAMPE	IN011EE2P001000001
PLANIMETRIA SESTO DI STATO	IN011EE2P001000001
PLANIMETRIA DI PROGETTO	IN011EE2P001000001
PROSPETTO LONGITUDINALE TAVOLA 1/2	IN011EE2P001000001
PROSPETTO LONGITUDINALE TAVOLA 2/2	IN011EE2P001000001
ASSE PRINCIPALE SEZIONI TRASVERSALI TAVOLA 1/4	IN011EE2P001000001
ASSE PRINCIPALE SEZIONI TRASVERSALI TAVOLA 1/4	IN011EE2P001000001
ASSE PRINCIPALE SE	