

Table with 2 columns: Quota (m) and Area (m²) for various terrain and project elements.

SEZIONE N. : 444
Q. PROGETTO : 142,23
DIST.PROG. : 24+150,00

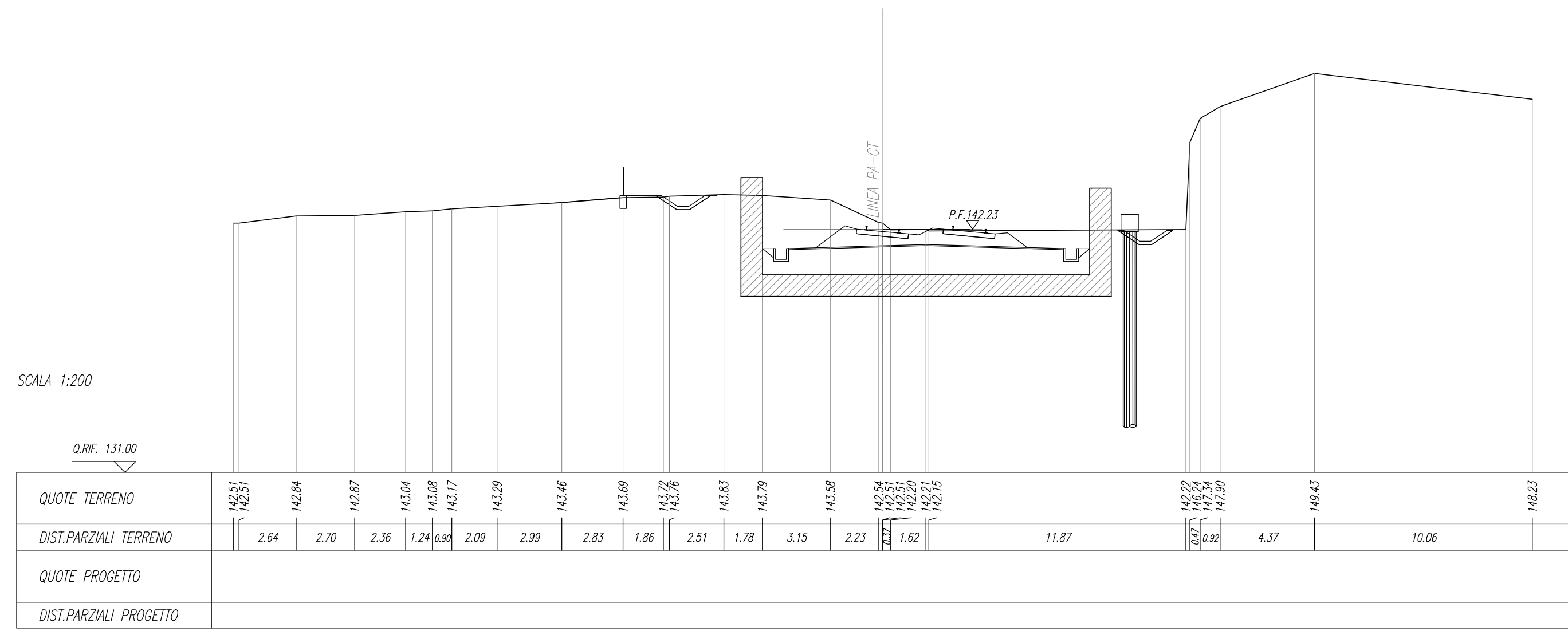

Table with 2 columns: Quota (m) and Area (m²) for various terrain and project elements.

SEZIONE N. : 448
Q. PROGETTO : 141,99
DIST.PROG. : 24+380,00

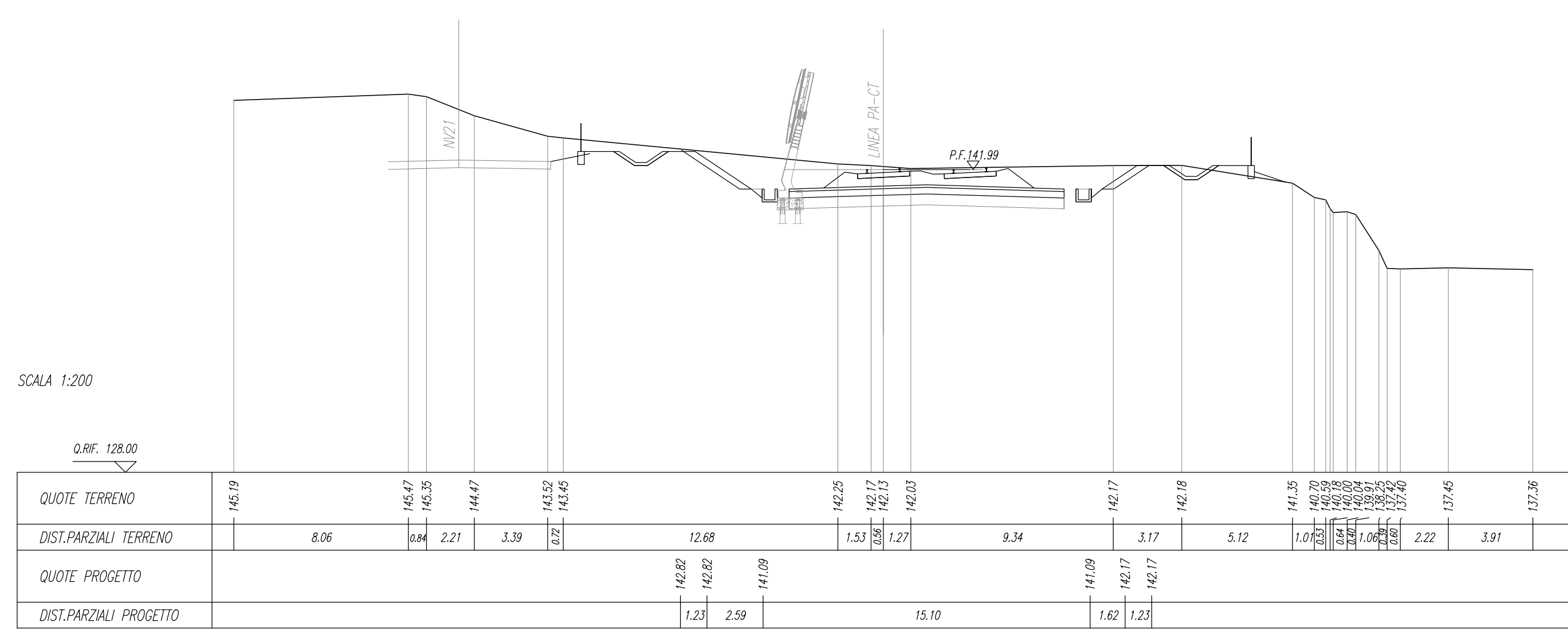

Table with 2 columns: Quota (m) and Area (m²) for various terrain and project elements.

SEZIONE N. : 445
Q. PROGETTO : 142,17
DIST.PROG. : 24+200,00

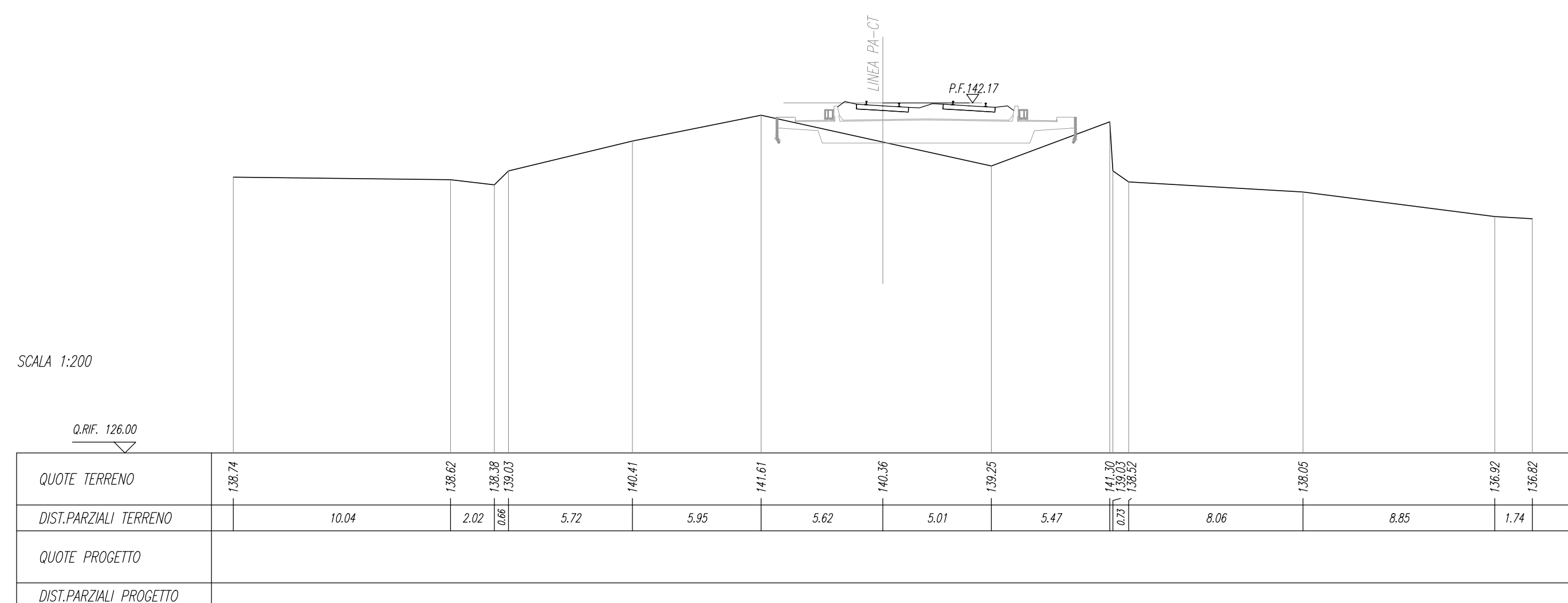

Table with 2 columns: Quota (m) and Area (m²) for various terrain and project elements.

SEZIONE N. : 449
Q. PROGETTO : 141,93
DIST.PROG. : 24+400,00

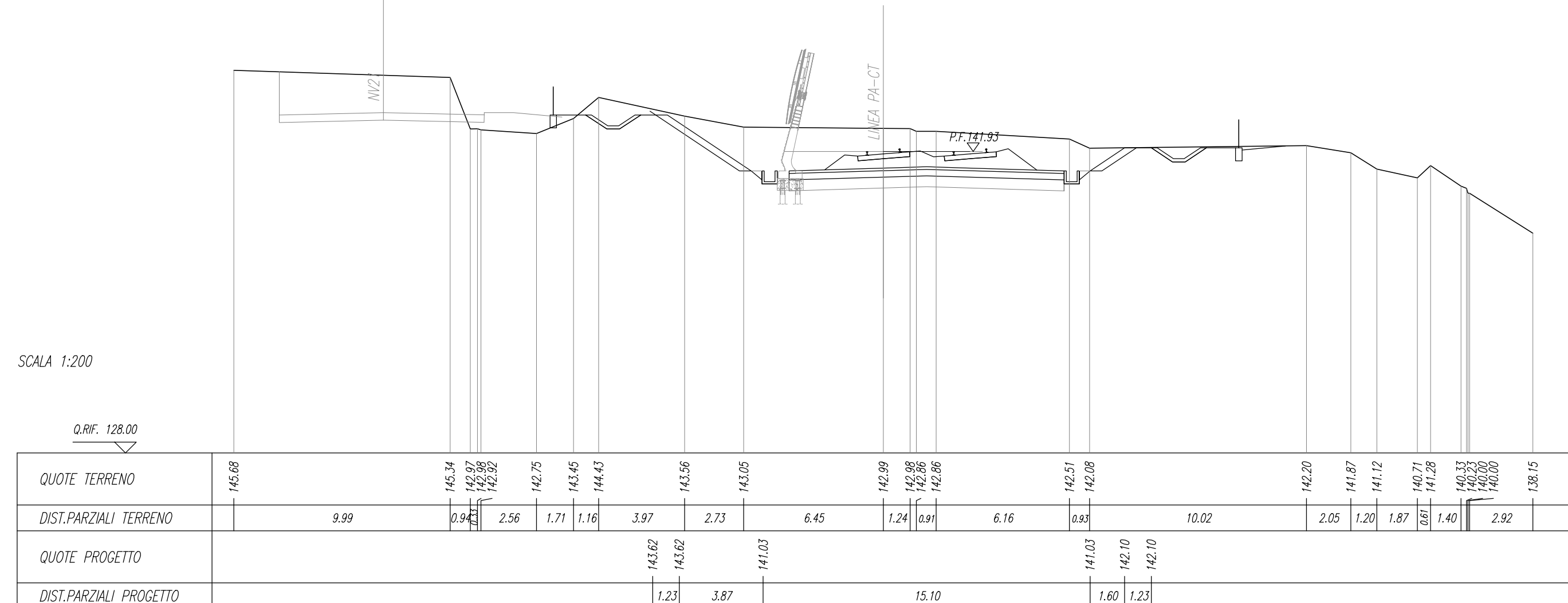

Table with 2 columns: Quota (m) and Area (m²) for various terrain and project elements.

SEZIONE N. : 446
Q. PROGETTO : 142,11
DIST.PROG. : 24+250,00

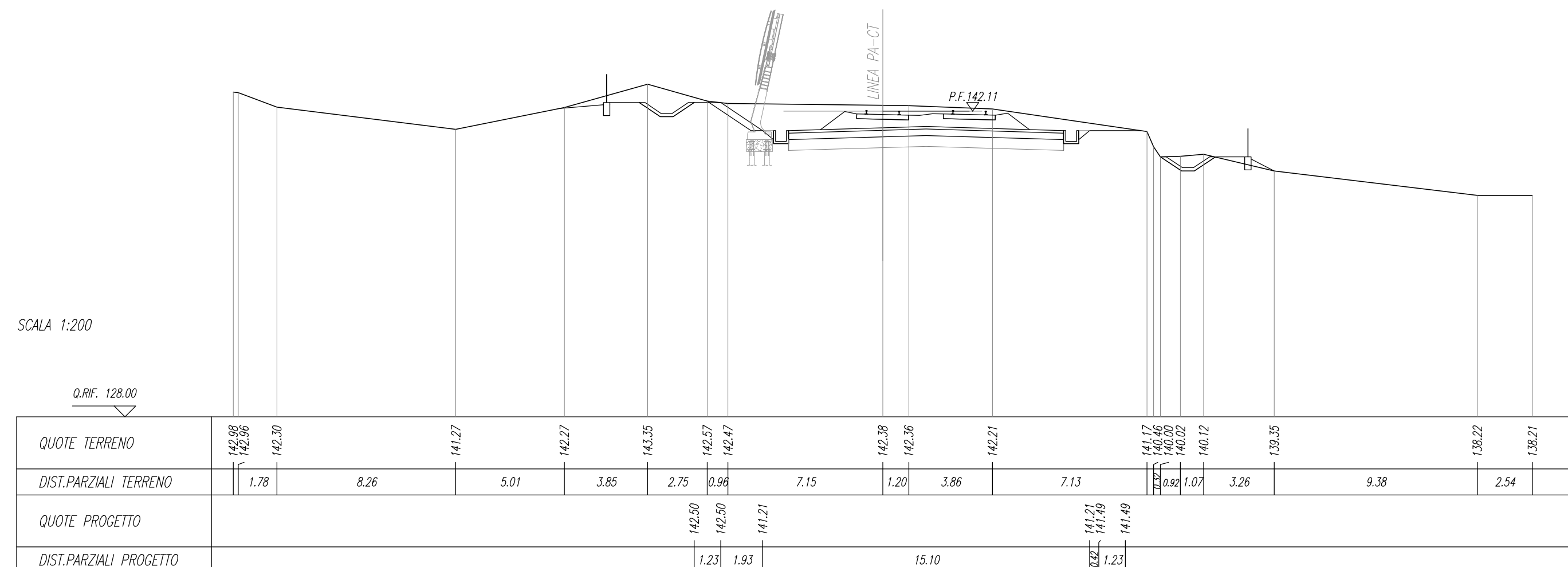

Table with 2 columns: Quota (m) and Area (m²) for various terrain and project elements.

SEZIONE N. : 450
Q. PROGETTO : 141,92
DIST.PROG. : 24+450,00

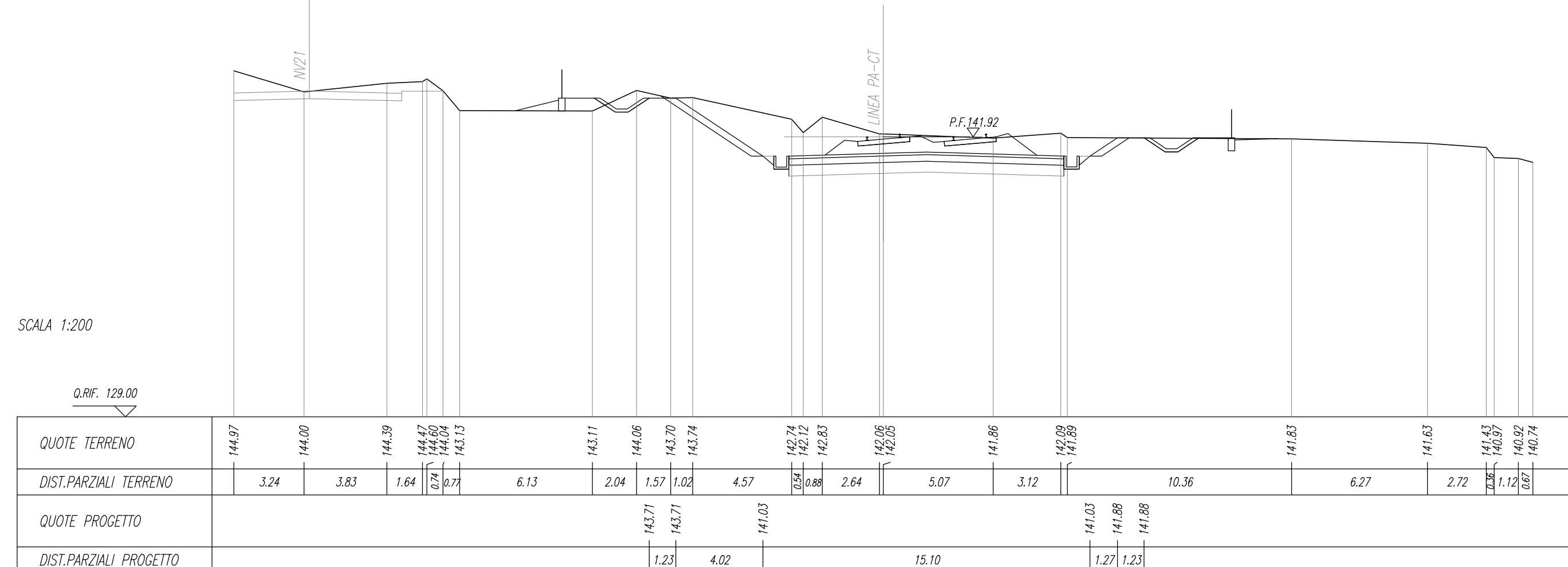

Table with 2 columns: Quota (m) and Area (m²) for various terrain and project elements.

SEZIONE N. : 447
Q. PROGETTO : 142,05
DIST.PROG. : 24+300,00

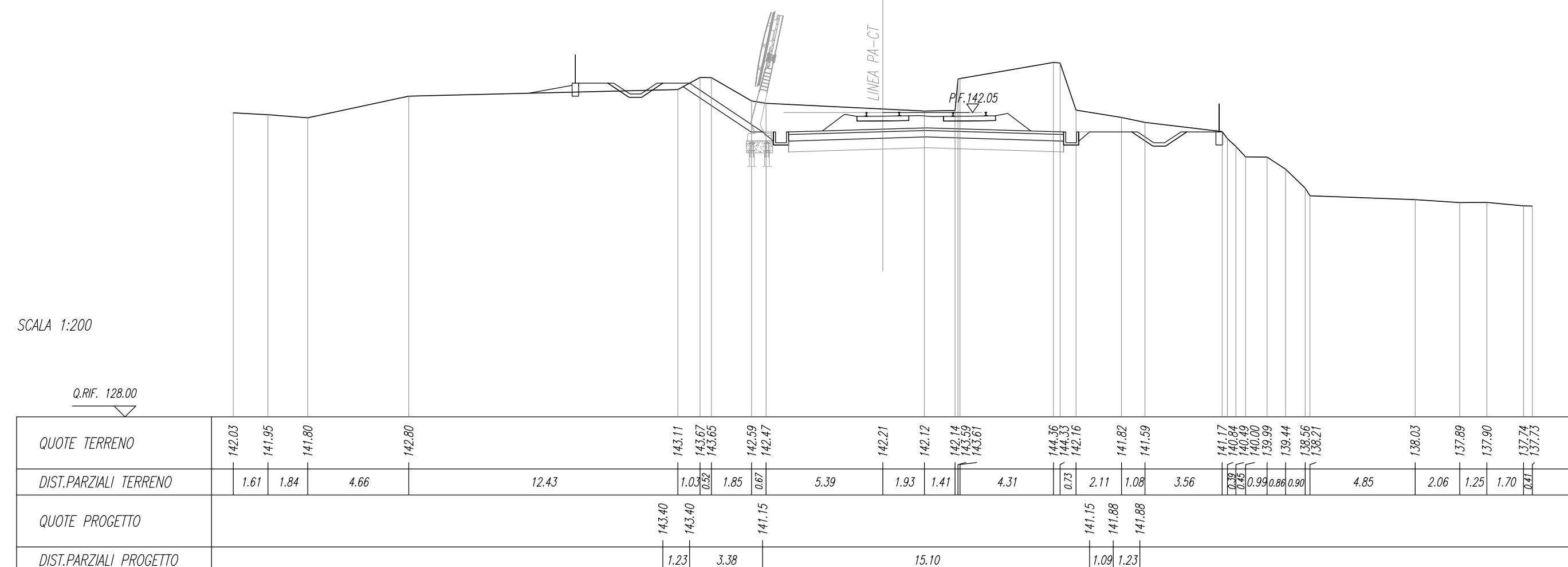
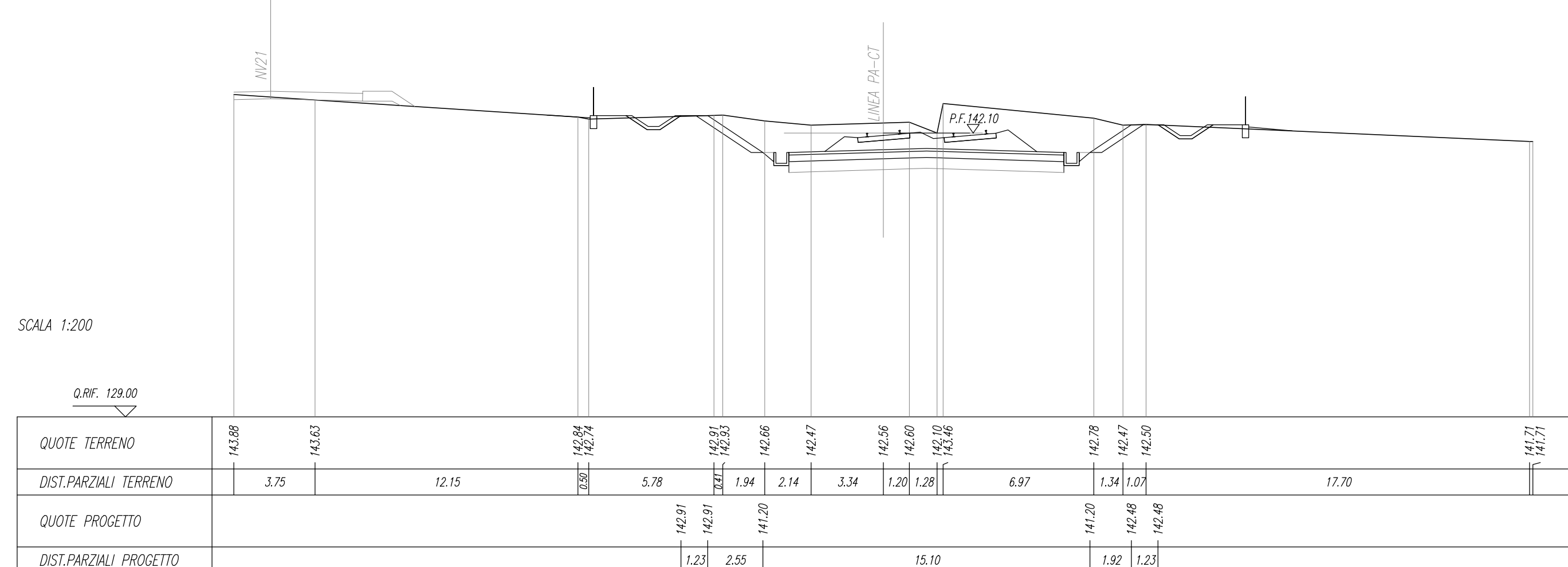

Table with 2 columns: Quota (m) and Area (m²) for various terrain and project elements.

SEZIONE N. : 451
Q. PROGETTO : 142,10
DIST.PROG. : 24+500,00



DIRETTRICE FERROVIARIA MESSINA - CATANIA - PALERMO
NUOVO COLLEGAMENTO PALERMO - CATANIA

U.O. INFRASTRUTTURE SUD

PROGETTO DEFINITIVO

TRATTA DITTAINO - CATENANUOVA

INFRASTRUTTURA FERROVIARIA

Linea
Sezioni trasversali

Sezioni trasversali - 52 di 53

SCALA:
1:200

Table with columns: Commessa, Lotto, Fase, Ente, Tipo Doc., Operatività/Disiplina, Progr., Rev.

Table with columns: RSE, 50, D, 78, W9, IFO, 101, 031, A

Table with columns: Rev., Descrizione, Redatto, Data, Verificato, Data, Approvato, Data, Autorizzato, Data.

File: RSE50078W9F0101031A.dwg n. Etab.: 394