

**AREA DI LAVORO A TERRA PER ATTIVITA' DI TOC / ONSHORE WORKING AREA FOR HDD ACTIVITIES**  
SCALA LUNGHEZZE / LENGTH SCALE 1: 400

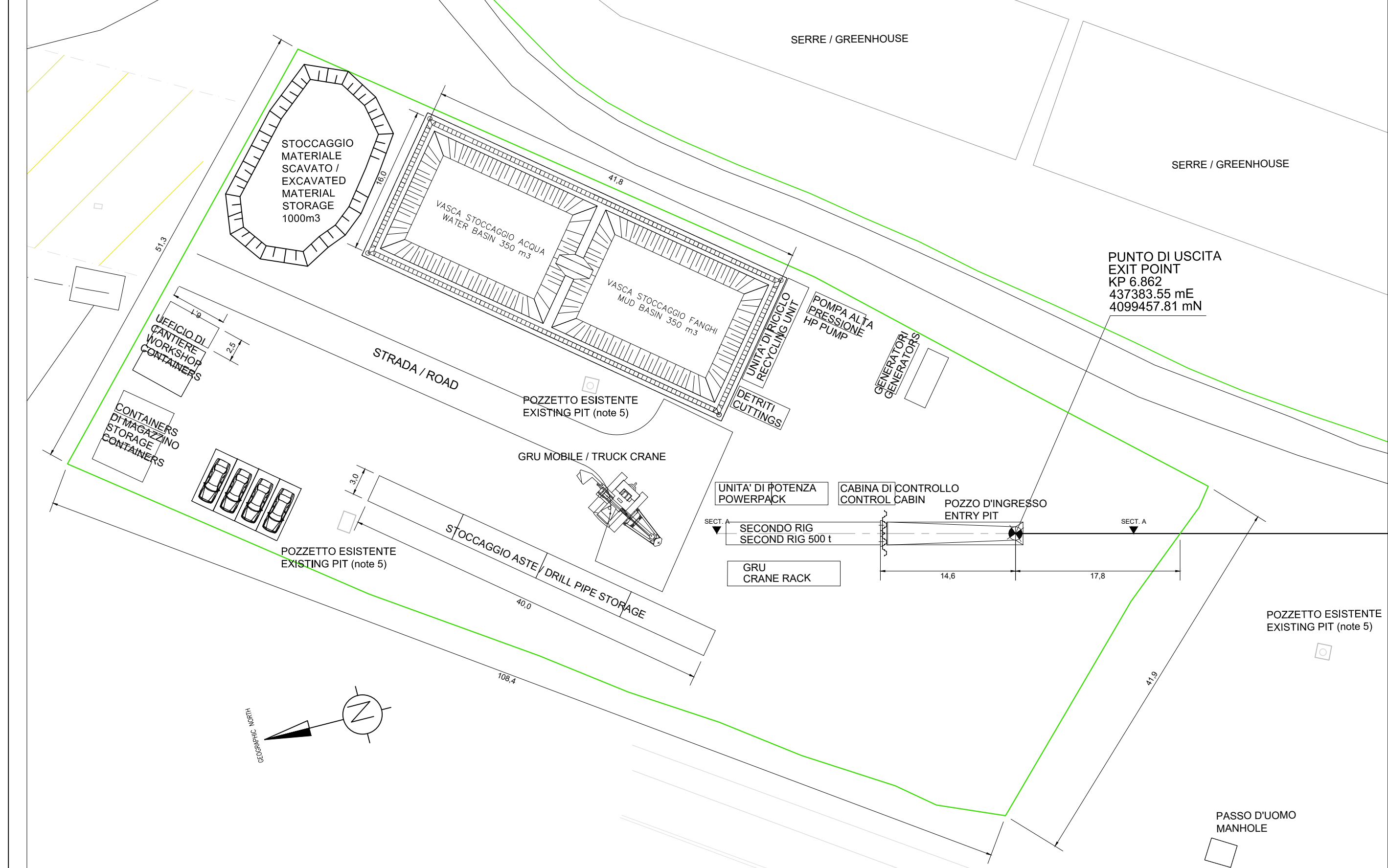

**AREA DI LAVORO A MARE PER ATTIVITA' DI TOC / OFFSHORE WORKING AREA FOR HDD ACTIVITIES**  
SCALA LUNGHEZZE / LENGTH SCALE 1: 400

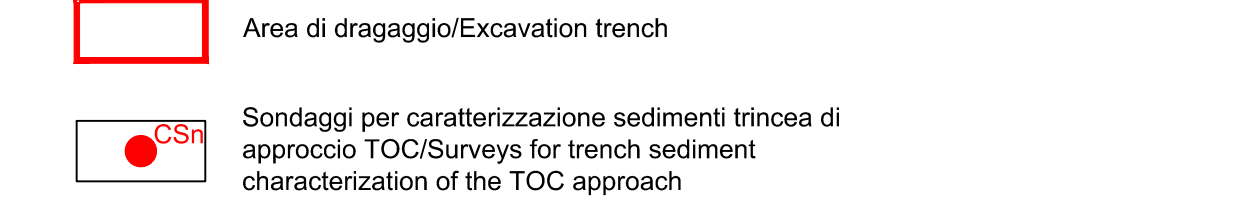
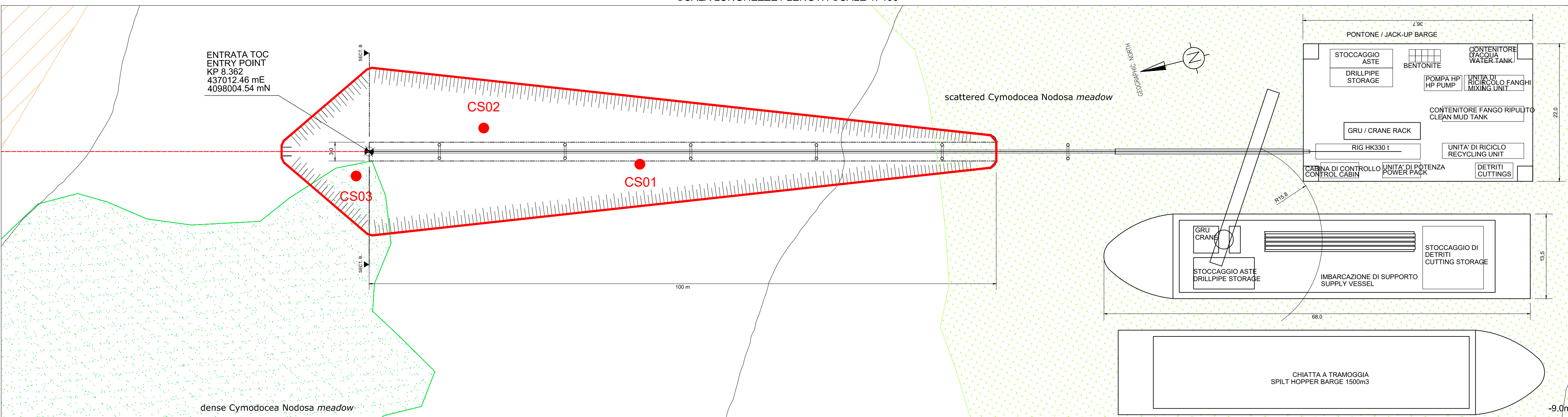

**DIMENSIONAMENTO TRINCEA DI SCAVO PER HDD / DIMENSIONING OF EXCAVATION TRENCH FOR HDD**

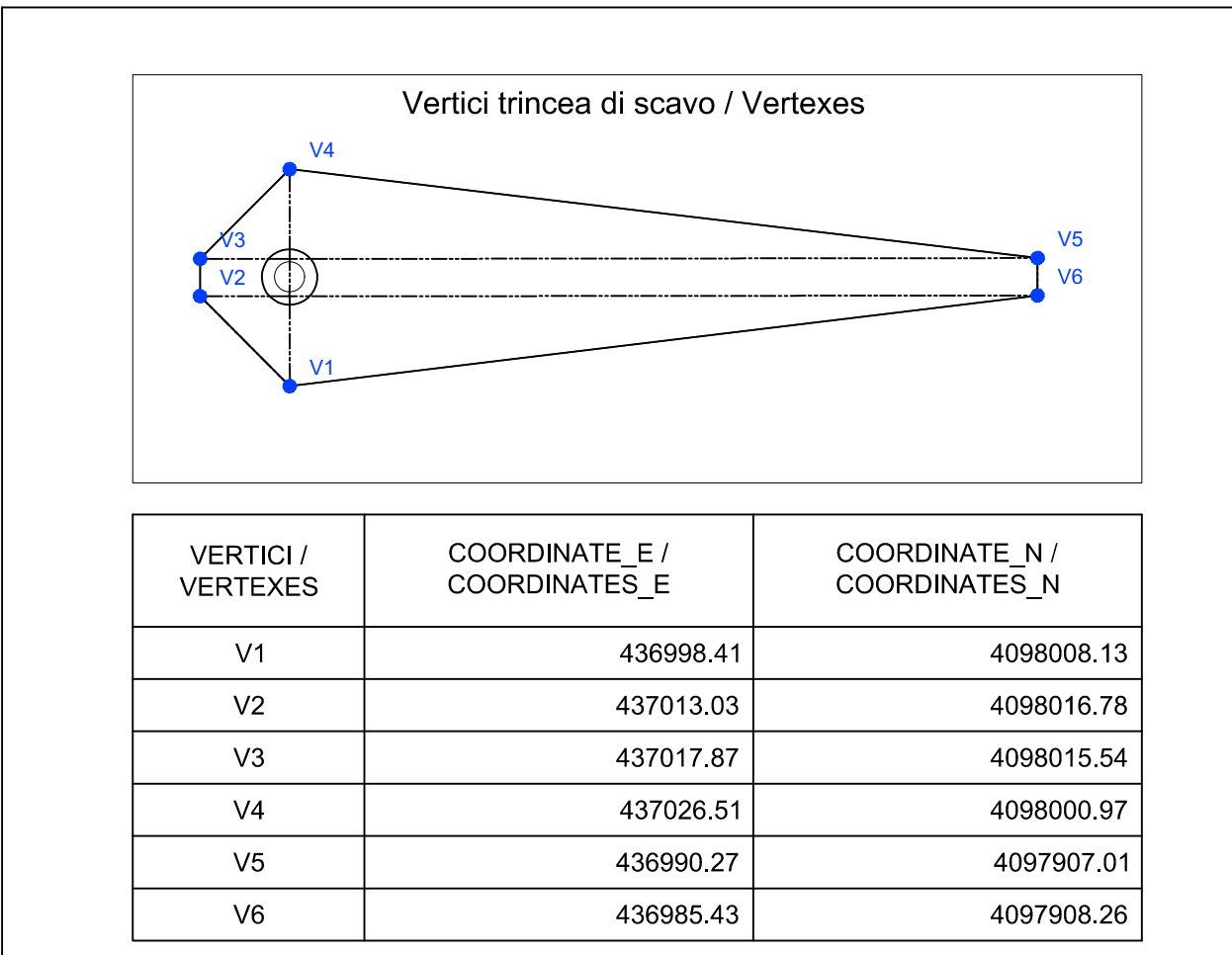

**SEZIONE B-B TRASVERSALE SCAVO / TRENCH CROSS SECTION B-B**  
SCALA LUNGHEZZE / LENGTH SCALE 1: 200

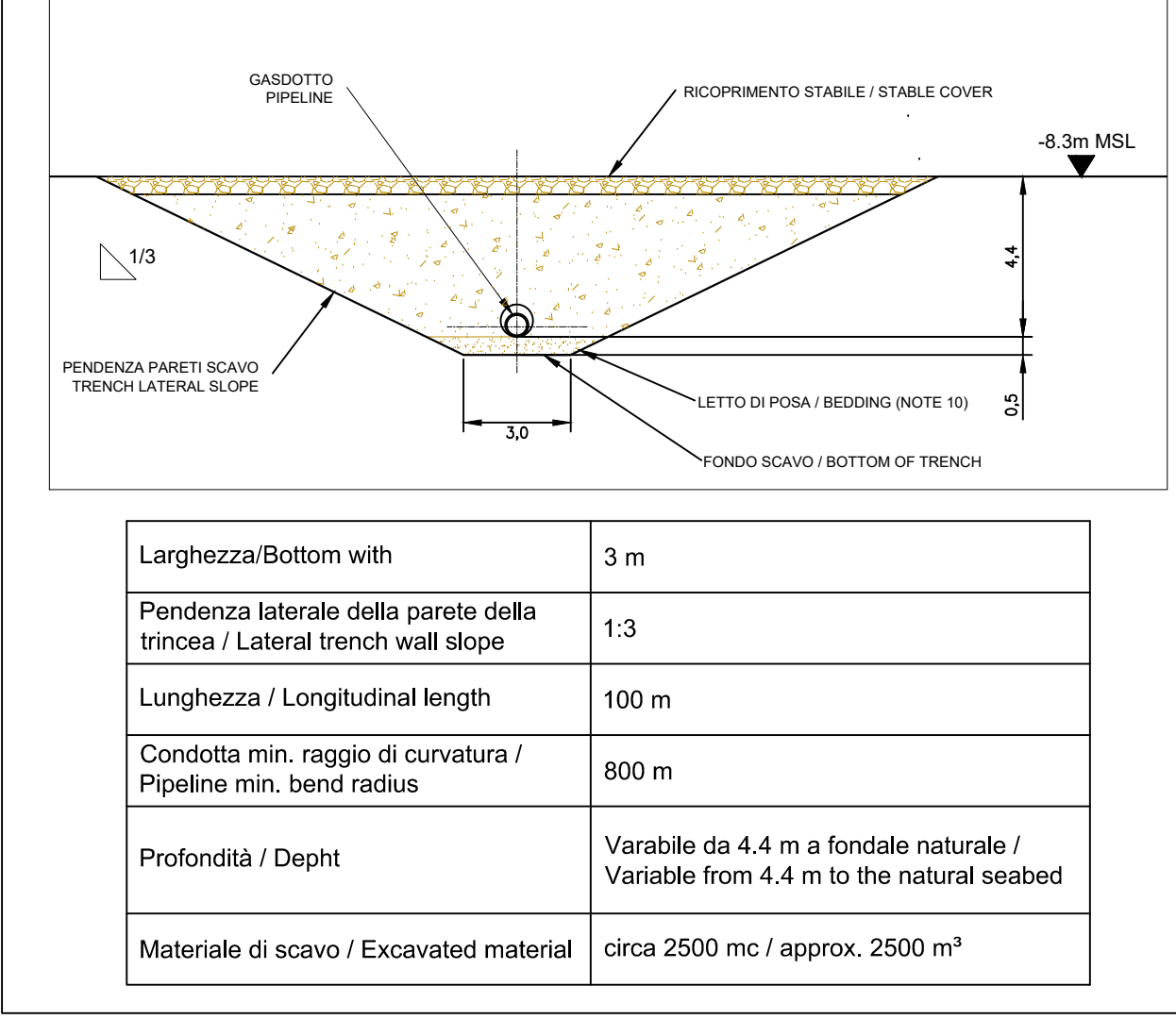

**CONFIGURAZIONE DEL RIG A MARE E SEZIONE SCAVO LONGITUDINALE / OFFSHORE HDD RIG SET UP AND LONGITUDINAL TRENCH SECTION**  
SCALA LUNGHEZZE / LENGTH SCALE 1: 400

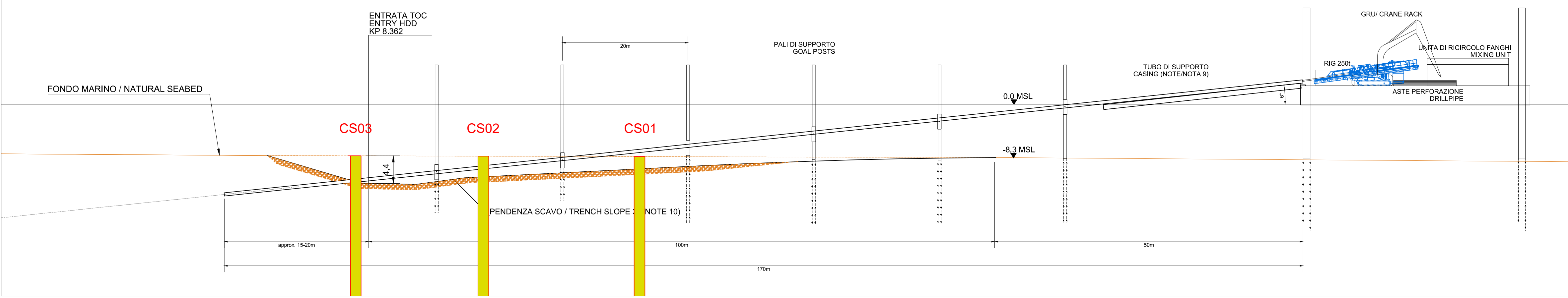

**Title:**  
Piano di gestione dei sedimenti/Sediment management plan  
Tavola 1  
Planimetria e dettagli dell'area di dragaggio  
Map 1  
Plan and details of the dredging area

**Drawing No:** D\_PGS\_Tav.01

**Scale:** Varie

**Rev:** 4-AFD **Date:** 01/06/2020

**Approved by:** CESI-VDP **Date:** June 2020

**Quote or Job No.:** CT3109/2018 **Revision Date:** n/a