

LIVELLETTA

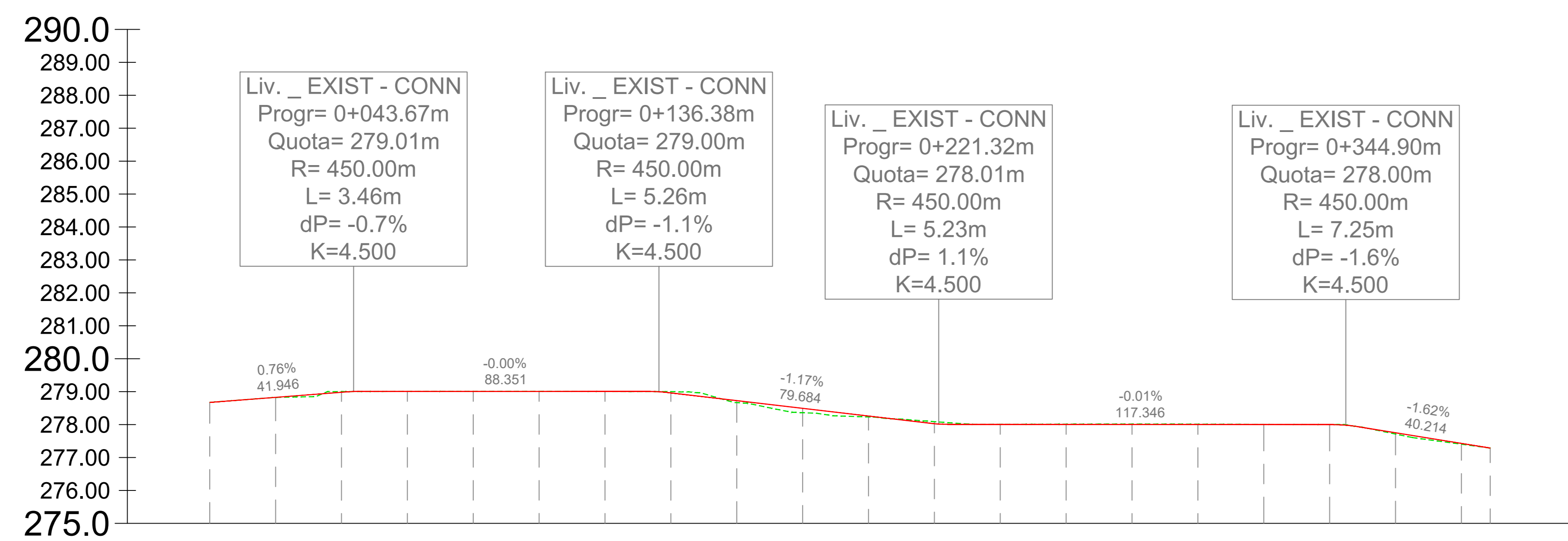
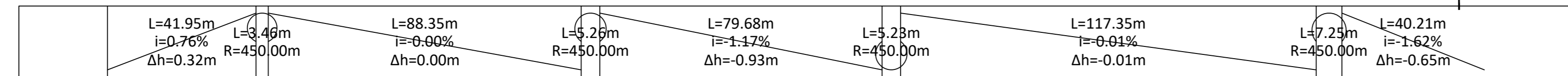

Profilo: EXIST\_CONN  
Scala : 1000:100  
Q.Rif. : 275.00

|                   |
|-------------------|
| NUMERO SEZIONE    |
| DISTANZE PROGR.   |
| DISTANZE PARZIALI |
| QUOTE PROGETTO    |
| QUOTE TERRENO     |
| ANDAMENTO PLAN.   |
| ANDAMENTO CIGLI   |
| ETTOMETRICHE      |

|                                      |          |               |          |          |          |          |          |          |          |          |          |                      |          |                      |          |              |          |          |          |          |
|--------------------------------------|----------|---------------|----------|----------|----------|----------|----------|----------|----------|----------|----------|----------------------|----------|----------------------|----------|--------------|----------|----------|----------|----------|
| 1                                    | 2        | 3             | 4        | 5        | 6        | 7        | 8        | 9        | 10       | 11       | 12       | 13                   | 14       | 15                   | 16       | 17           | 18       | 19       | 20       | 21       |
| 0+000.00                             | 0+020.00 | 0+040.00      | 0+060.00 | 0+080.00 | 0+100.00 | 0+120.00 | 0+140.00 | 0+160.00 | 0+180.00 | 0+200.00 | 0+220.00 | 0+240.00             | 0+260.00 | 0+280.00             | 0+300.00 | 0+320.00     | 0+340.00 | 0+360.00 | 0+380.00 | 0+388.74 |
| 20,00                                | 20,00    | 20,00         | 20,00    | 20,00    | 20,00    | 20,00    | 20,00    | 20,00    | 20,00    | 20,00    | 20,00    | 20,00                | 20,00    | 20,00                | 20,00    | 20,00        | 20,00    | 20,00    | 20,00    | 8,74     |
| 278,67                               | 278,83   | 278,98        | 279,01   | 279,01   | 279,01   | 279,01   | 278,96   | 278,73   | 278,49   | 278,26   | 278,03   | 278,01               | 278,00   | 278,00               | 278,00   | 278,00       | 277,75   | 277,43   | 277,29   | 277,29   |
| L=77.63m<br>R=70.00m<br>Lrett=40.00m |          | Lrett=101.39m |          |          |          |          |          |          |          |          |          | L=10.94m<br>R=70.00m |          | L=20.58m<br>R=70.00m |          | Lrett=38.85m |          |          |          |          |
| 00 01 02 03 03                       |          |               |          |          |          |          |          |          |          |          |          |                      |          |                      |          |              |          |          |          |          |

QUADRO D'UNIONE (scala 1:50.000)

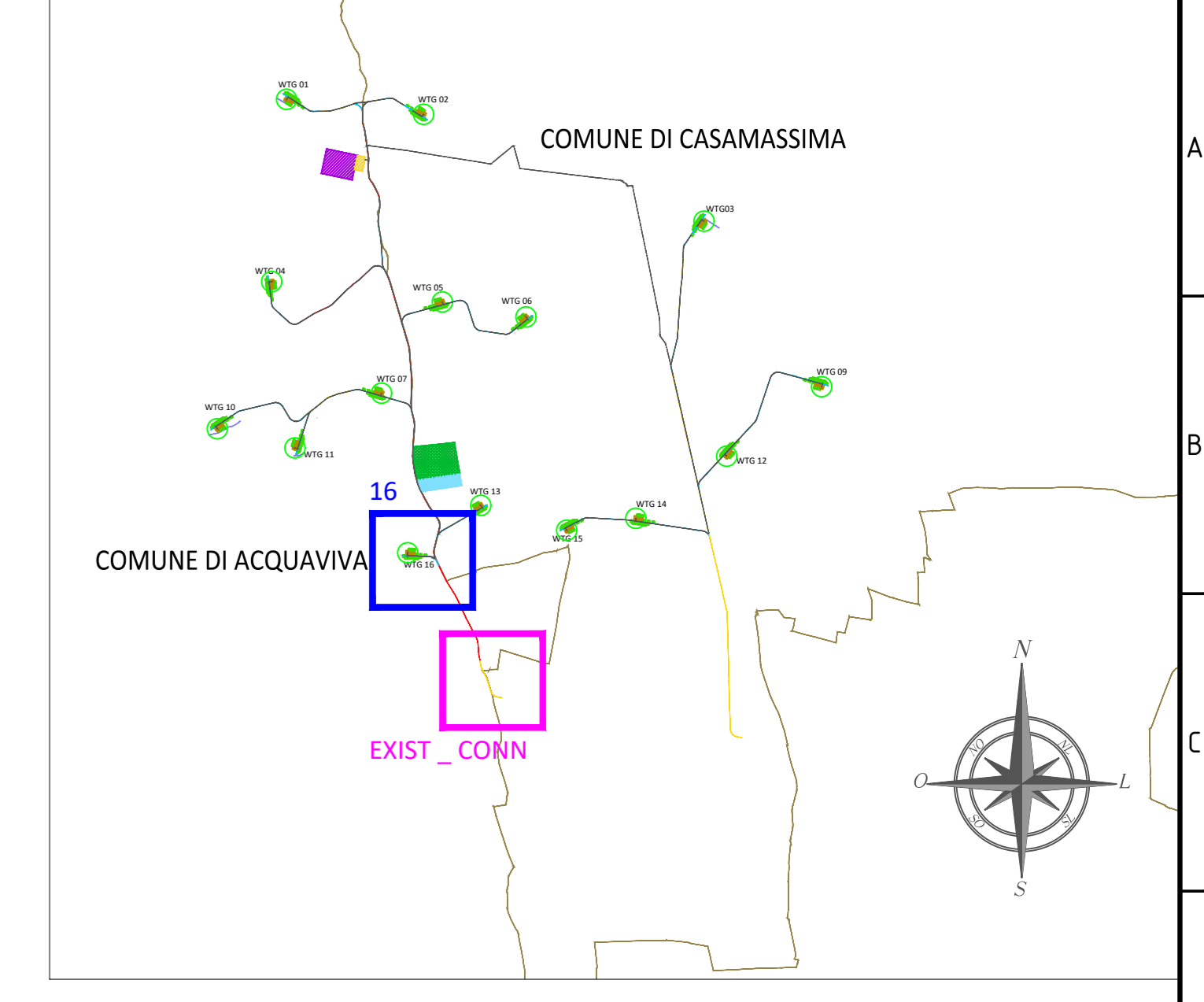

LEGENDA

--- Terreno  
--- Livelletta

Elementi disegnati in profilo longitudinale:

Progr - progressiva  
Quota - quota del vertice  
R - raggio raccordo verticale  
L - lunghezza orizzontale  
dP - differenza di pendenza

Raccordo verticale

L - lunghezza orizzontale  
i - percentuale della pendenza  
Δh - differenza di altezza

elementi della livelletta

LIVELLETTA

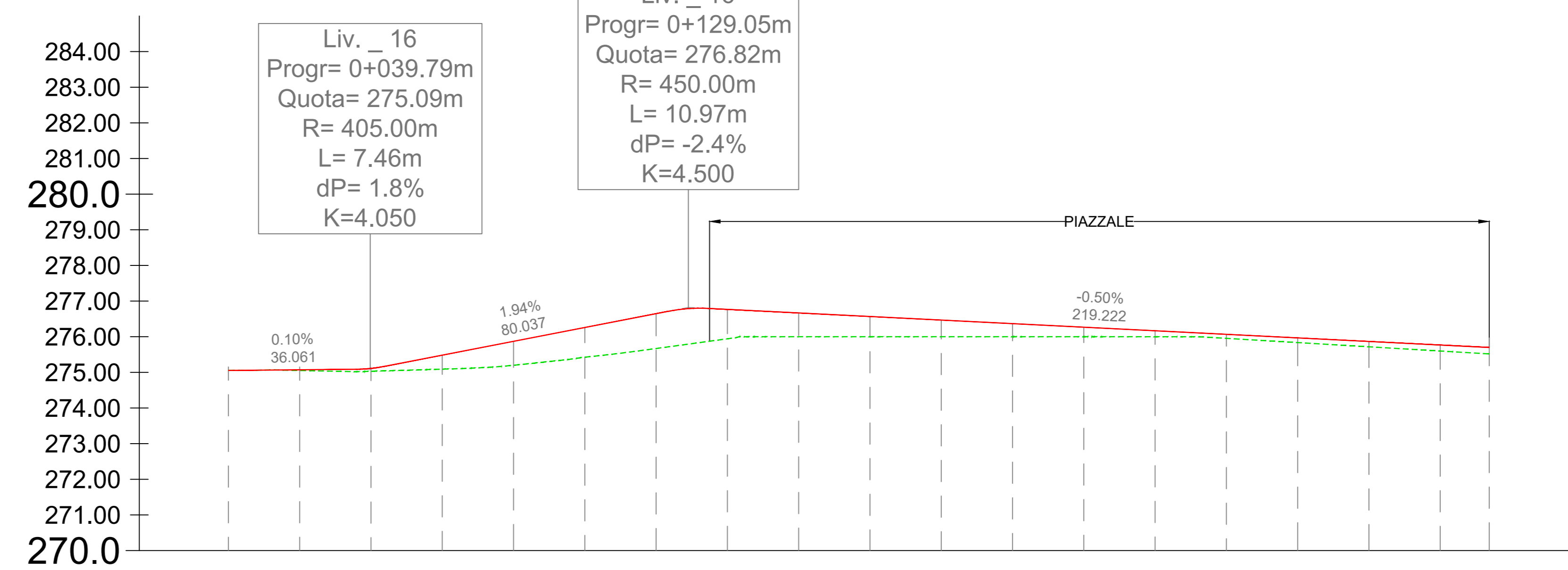
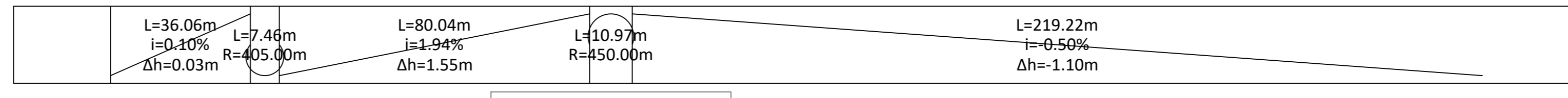

Profilo: 16  
Scala : 1000:100  
Q.Rif. : 270.00

|                   |
|-------------------|
| NUMERO SEZIONE    |
| DISTANZE PROGR.   |
| DISTANZE PARZIALI |
| QUOTE PROGETTO    |
| QUOTE TERRENO     |
| ANDAMENTO PLAN.   |
| ANDAMENTO CIGLI   |
| ETTOMETRICHE      |

|                |          |                      |          |          |          |          |          |          |          |          |          |               |          |          |          |          |          |          |
|----------------|----------|----------------------|----------|----------|----------|----------|----------|----------|----------|----------|----------|---------------|----------|----------|----------|----------|----------|----------|
| 1              | 2        | 3                    | 4        | 5        | 6        | 7        | 8        | 9        | 10       | 11       | 12       | 13            | 14       | 15       | 16       | 17       | 18       | 19       |
| 0+000.00       | 0+020.00 | 0+040.00             | 0+060.00 | 0+080.00 | 0+100.00 | 0+120.00 | 0+140.00 | 0+160.00 | 0+180.00 | 0+200.00 | 0+220.00 | 0+240.00      | 0+260.00 | 0+280.00 | 0+300.00 | 0+320.00 | 0+340.00 | 0+353.76 |
| 20,00          | 20,00    | 20,00                | 20,00    | 20,00    | 20,00    | 20,00    | 20,00    | 20,00    | 20,00    | 20,00    | 20,00    | 20,00         | 20,00    | 20,00    | 20,00    | 20,00    | 20,00    | 13,76    |
| 275,05         | 275,07   | 275,11               | 275,48   | 275,87   | 276,26   | 276,65   | 276,77   | 276,67   | 276,57   | 276,47   | 276,37   | 276,27        | 276,17   | 276,07   | 275,97   | 275,87   | 275,77   | 275,70   |
| 275,05         | 275,05   | 275,03               | 275,09   | 275,20   | 275,43   | 275,67   | 275,94   | 276,00   | 276,00   | 276,00   | 276,00   | 276,00        | 276,00   | 275,95   | 275,84   | 275,72   | 275,60   | 275,52   |
| Lrett=41.50m   |          | L=74.95m<br>R=70.00m |          |          |          |          |          |          |          |          |          | Lrett=237.30m |          |          |          |          |          |          |
| 00 01 02 03 03 |          |                      |          |          |          |          |          |          |          |          |          |               |          |          |          |          |          |          |

|   |            |   |   |                  |                 |
|---|------------|---|---|------------------|-----------------|
| 00  | 16/12/2020 | first issue   | SCS ingegneria                              | SCS ingegneria   | SCS ingegneria  |
| REV.  | DATE       | DESCRIPTION   | DESIGNED                                    | CHECKED          | APPROVED        |
| C. Caporale   |            |   |   |                  | A. Sestini      |
| PROJECT: IMPIANTO EOLICO DELLA POTENZA COMPLESSIVA 90 MW, COMUNI DI ACQUAVIVA DELLE FONTI (BA) E CASAMASSIMA (BA) |            |   | FILE NAME: GRE.EEC.D.25.ITW.14622.00.093.00 |                  |                 |
| CLASSIFICATION: WIND FARM   |            | FORMAT: A0  | SCALE: 1:1.000                              | PLLOT SCALE: 1:1 | SHEET: 13 di 21 |
| UTILIZATION SCOPE: Iter Autorizzativo   |            | TITLE: 8PSY7B1_Elaborato Grafico_43 - Profili longitudinali della viabilità di impianto |   |                  |                 |
| VALIDATION  |            |   |   |                  |                 |
| VERIFIED BY: [Signature]  |            |   |   |                  |                 |
| GROUP: GRE.EEC.D.25   |            |   |   |                  |                 |
| FUNCTION: ITW   |            |   |   |                  |                 |
| TYPE: 14622   |            |   |   |                  |                 |
| COUNTRY: 00   |            |   |   |                  |                 |
| PLANT: 093  |            |   |   |                  |                 |
| SYSTEM: 00  |            |   |   |                  |                 |
| REVISION: 30  |            |   |   |                  |                 |