

PIANTA RECINZIONE - SCALA 1:100

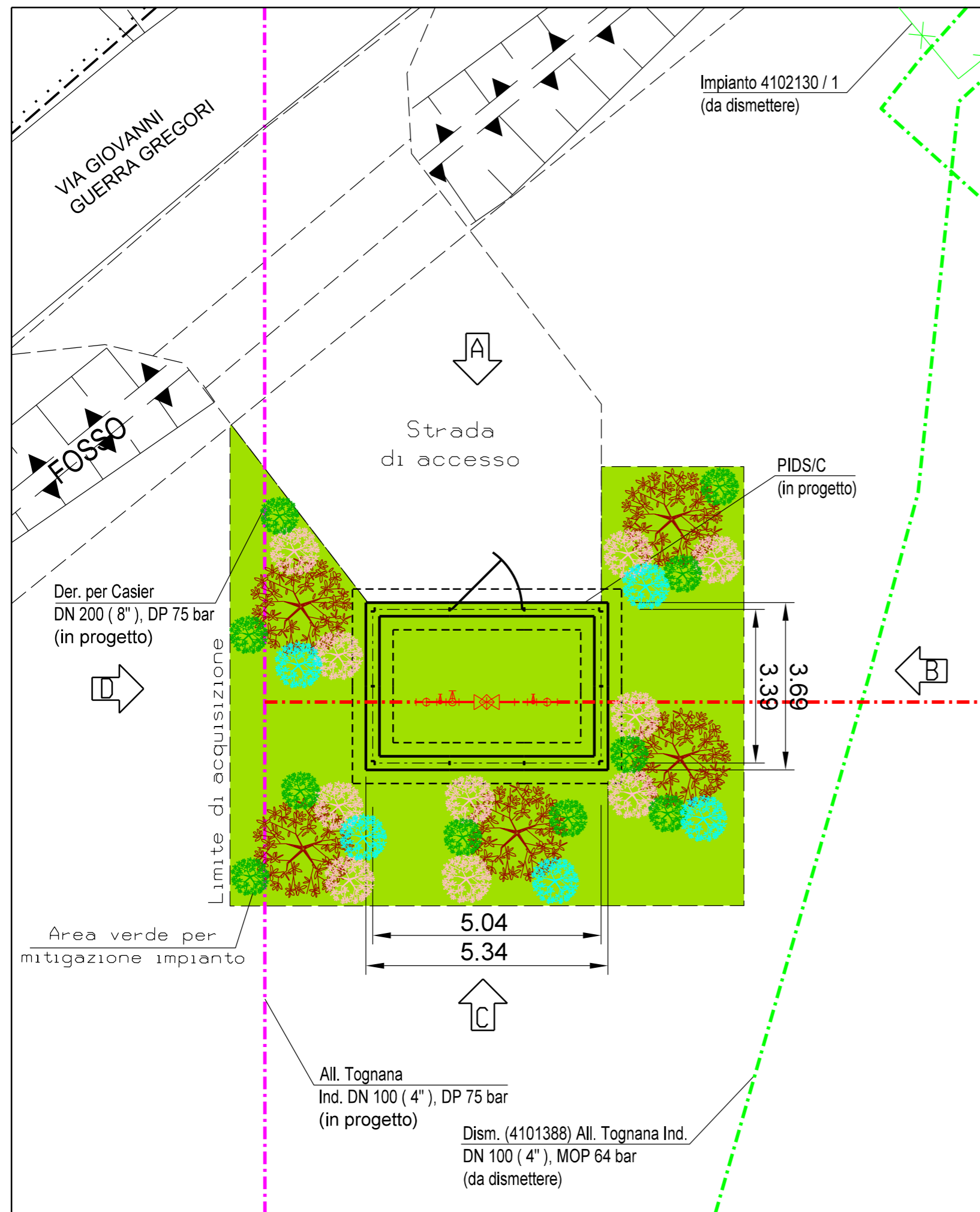

PIDS/C

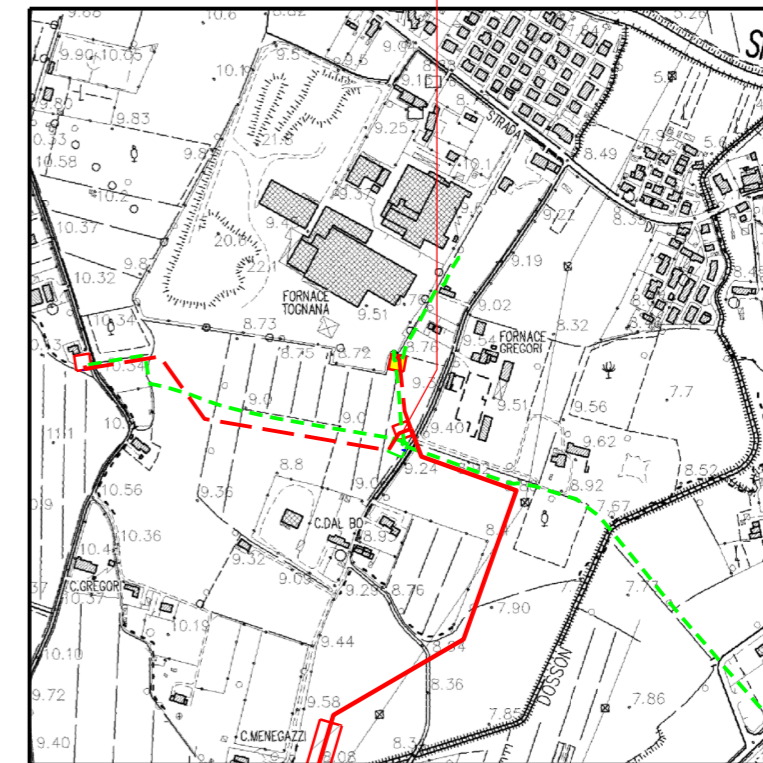

COROGRAFIA 1:10000
CTR 105160

Legenda

- Tubazioni in esercizio ---
- Tubazioni in progetto -.-.-
- Tubazioni da dismettere -.-.-

0	20/02/2020	EMISSIONE		TARINI	RAGGI	SABBATINI
Rev.	DATA	DESCRIZIONE	ELABORATO	VERIFICATO	APPROVATO	
CLIENTE			PROGETTISTA			WBS CLIENTE NR/17157/R-L09 COD. TEC. 20077 COMM. SAIPEM 023088
(20077) ALLACCIAMENTO COMUNE DI TREVISO 3° PRESA DN 150 (6") DP 75 bar			DISEGNO LB-D-70570 ALLEGATO 5/B-B			UNITA' 110
PIDS/C - Comune di Treviso - Planimetrie di Progetto per la Mitigazione Visiva e Paesaggistica degli Impianti di Linea -			REVISIONE 0			
			FG. 1	DI 2		
			SCALA 1:100			

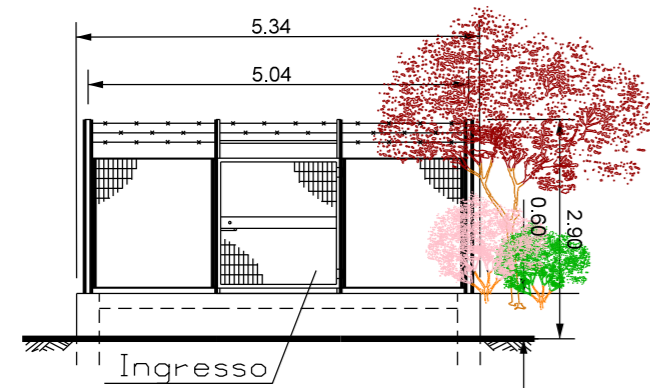

PROSPETTO A - SCALA 1:100

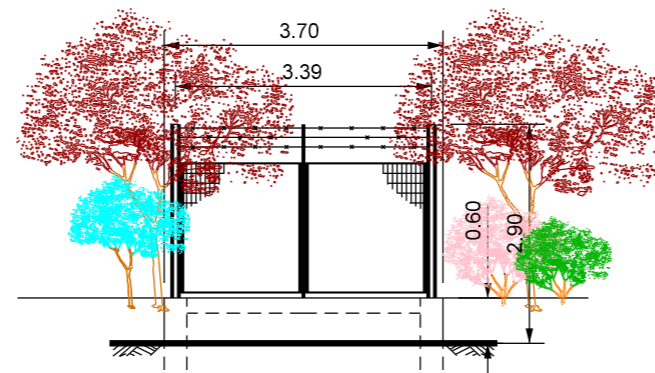

PROSPETTO B - SCALA 1:100

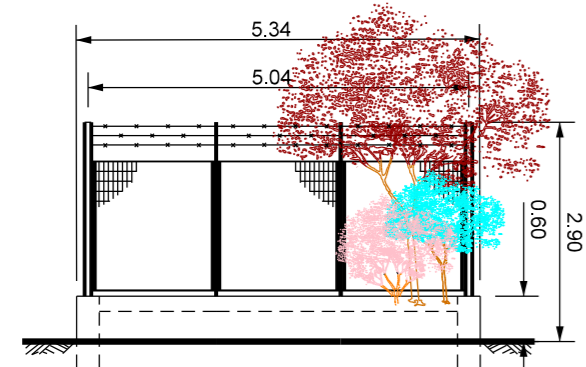

PROSPETTO C - SCALA 1:100

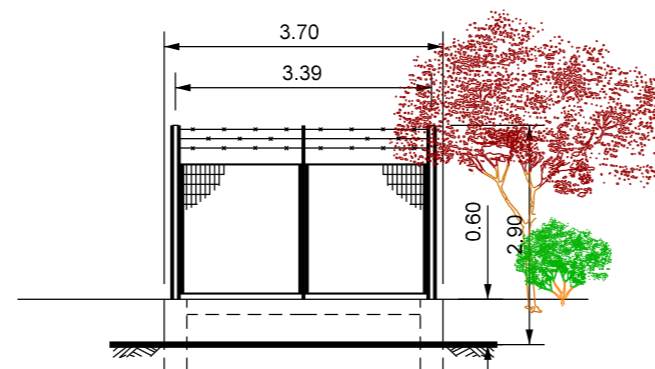

PROSPETTO D - SCALA 1:100

LEGENDA

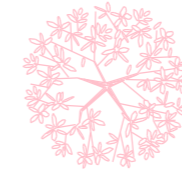

Prunus spinosa (Prugnolo)

(n.10 p.te)

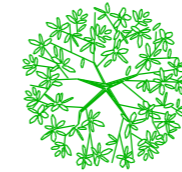

Rhamnus cathartica (Spino cervino)

(n.10 p.te)

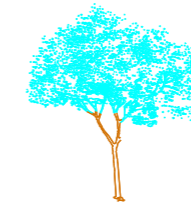

Viburnum opulus (Viburno)

(n.5 p.te)

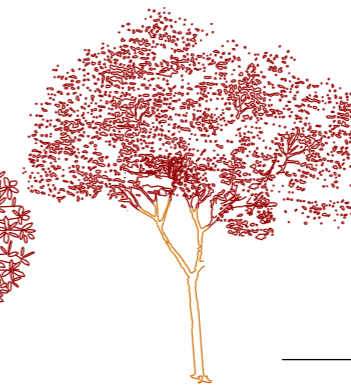
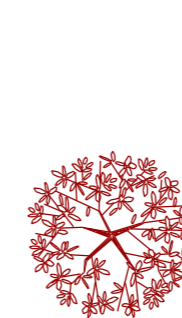

Prunus avium (Ciliegio)

(n.5 p.te)

Totale (30 piante)

NOTE:

- Mettere a dimora le piante come riportate in planimetria
- Utilizzare piante h 0.60 - 0.80 m
- Le misure sono espresse in metri