

PIANTA RECINZIONE - SCALA 1:100

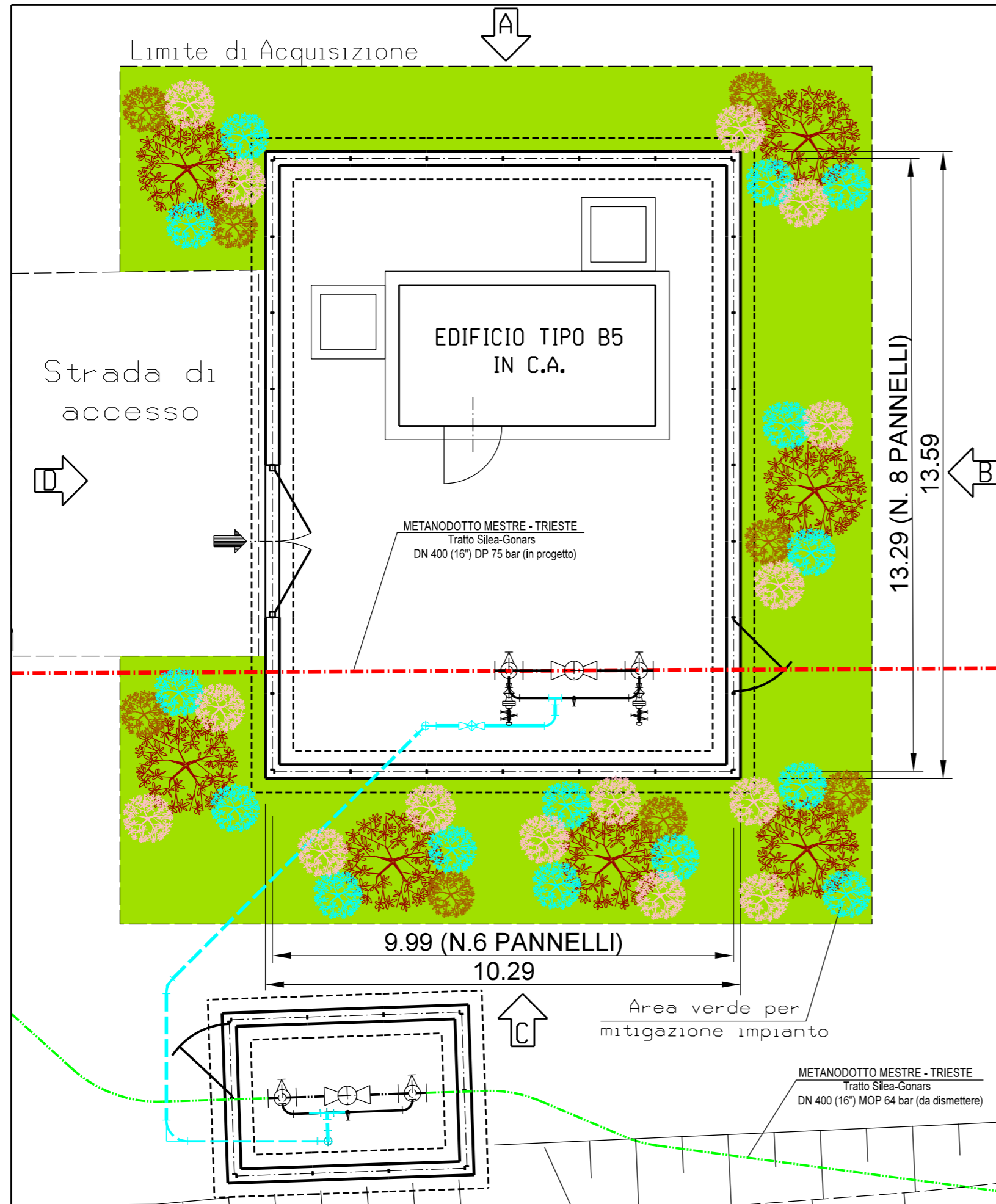

PIL-TC n.7

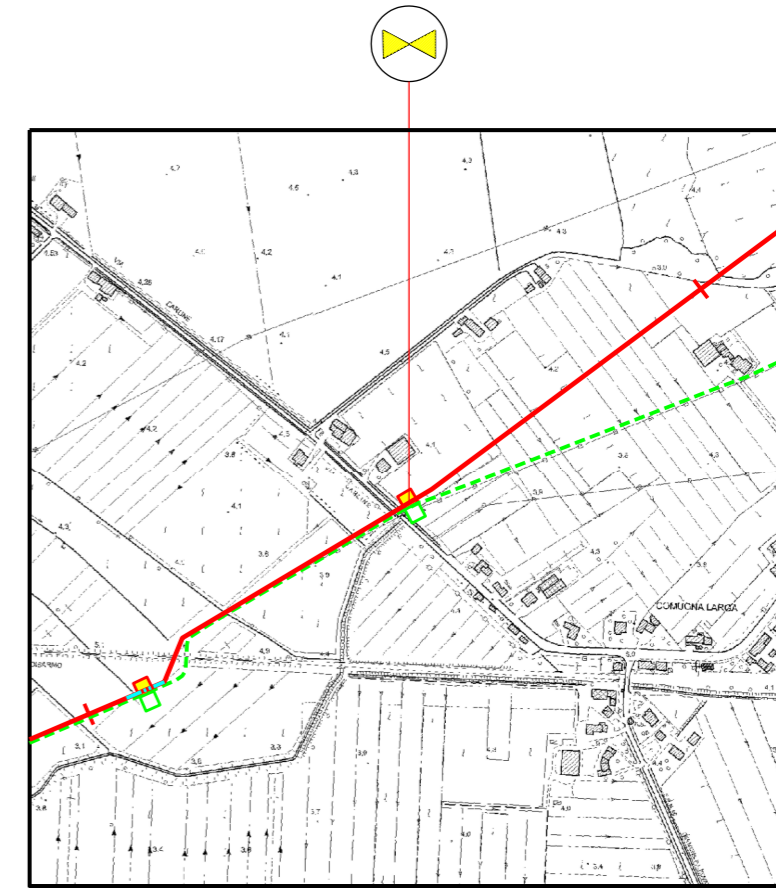

COROGRAFIA 1:10000
CTR 107010

Legenda

- Tubazioni in esercizio ---
- Tubazioni in progetto ---
- Tubazioni da dismettere ---

0	20/02/2020	EMISSIONE				TARINI	RAGGI	SABBATINI
Rev.	DATA	DESCRIZIONE	ELABORATO	VERIFICATO	APPROVATO			
CLIENTE			PROGETTISTA			WBS CLIENTE NR/17157/R-L01 COD. TEC. 20083 COMM. SAIPEM 023088		UNITA' 100
Impianto: MET. MESTRE - TRIESTE (20083) RIF. TRATTO SILEA-GONARS DN 400 (16"), DP 75 bar 6° TRATTO: da P.608 a P.722						DISEGNO LB-D-81379 ALLEGATO 5/H		
PUNTO DI INTERCETTAZIONE DI LINEA (PIL-TC) n.7 Localita' "Comugna Larga" - (Prog. Km 34+635) - Planimetrie di Progetto per la Mitigazione Visiva e Paesaggistica degli Impianti di Linea -						REVISIONE 0 FG 1 DI 2 SCALA 1100		

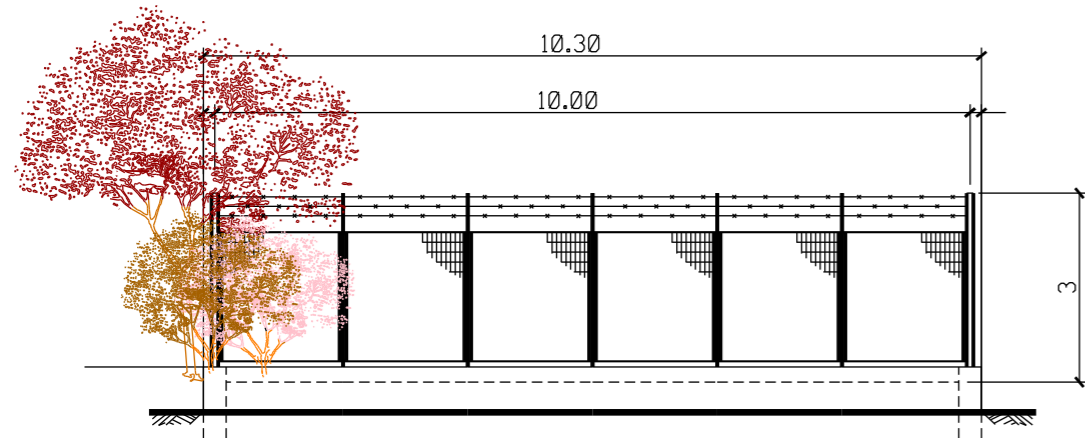

PROSPETTO A - SCALA 1:100

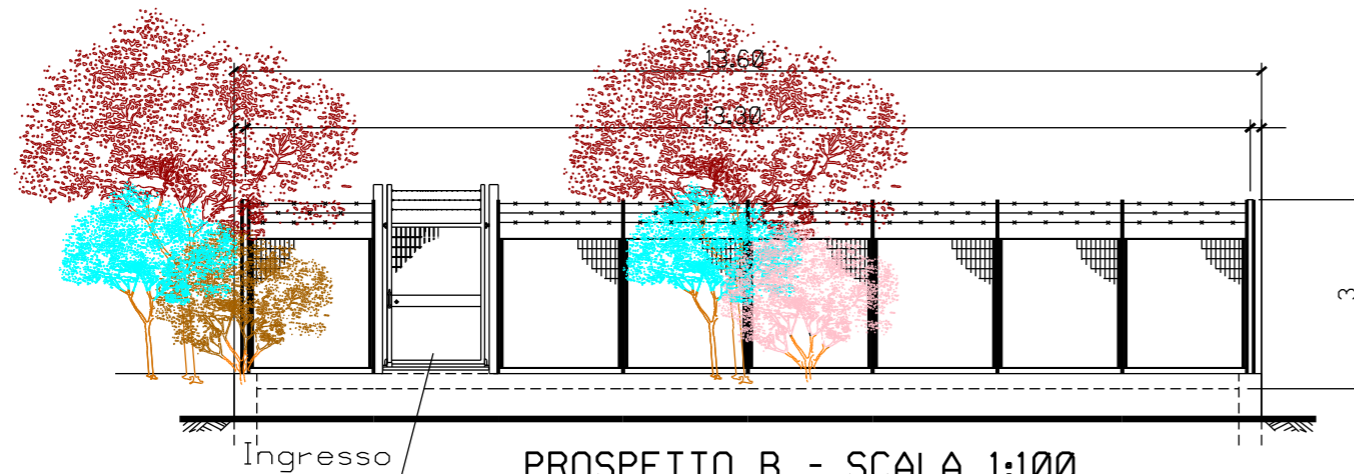

PROSPETTO B - SCALA 1:100

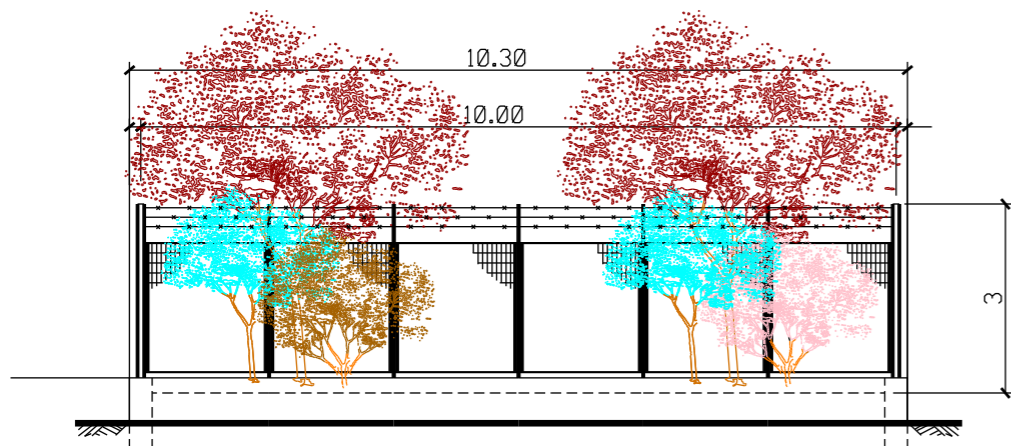



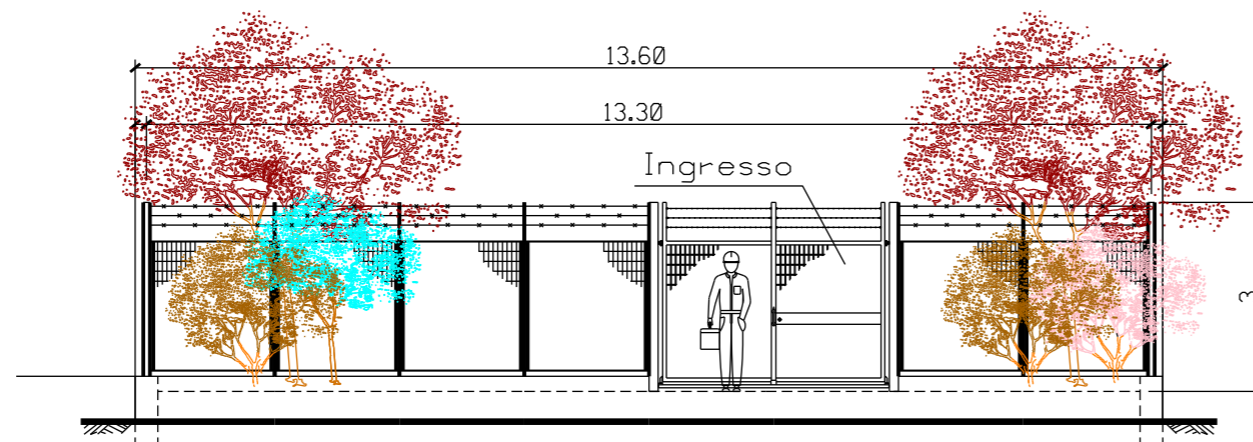





PROSPETTO C - SCALA 1:100



PROSPETTO D - SCALA 1:100

LEGENDA

		Prunus spinosa (Prugnolo)	(n.15 p.te)
		Viburnum opalus (Viburno)	(n.15 p.te)
		Corylus avellana (Nocciolo)	(n.8 p.te)
		Prunus avium (Ciliegio)	(n.7 p.te)
			Totale (45 piante)

NOTE:

- Mettere a dimora le piante come riportate in planimetria
- Utilizzare piante h 0.60 - 0.80 m
- Le misure sono espresse in metri