

AR - ARBUSTETO

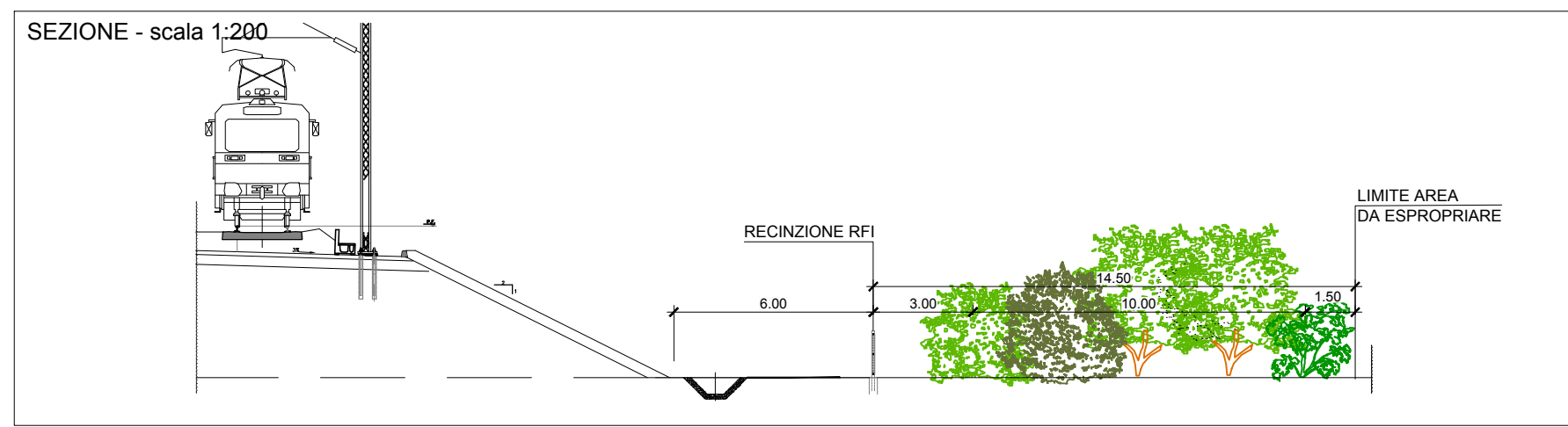

SA - SIEPE ARBUSTIVA

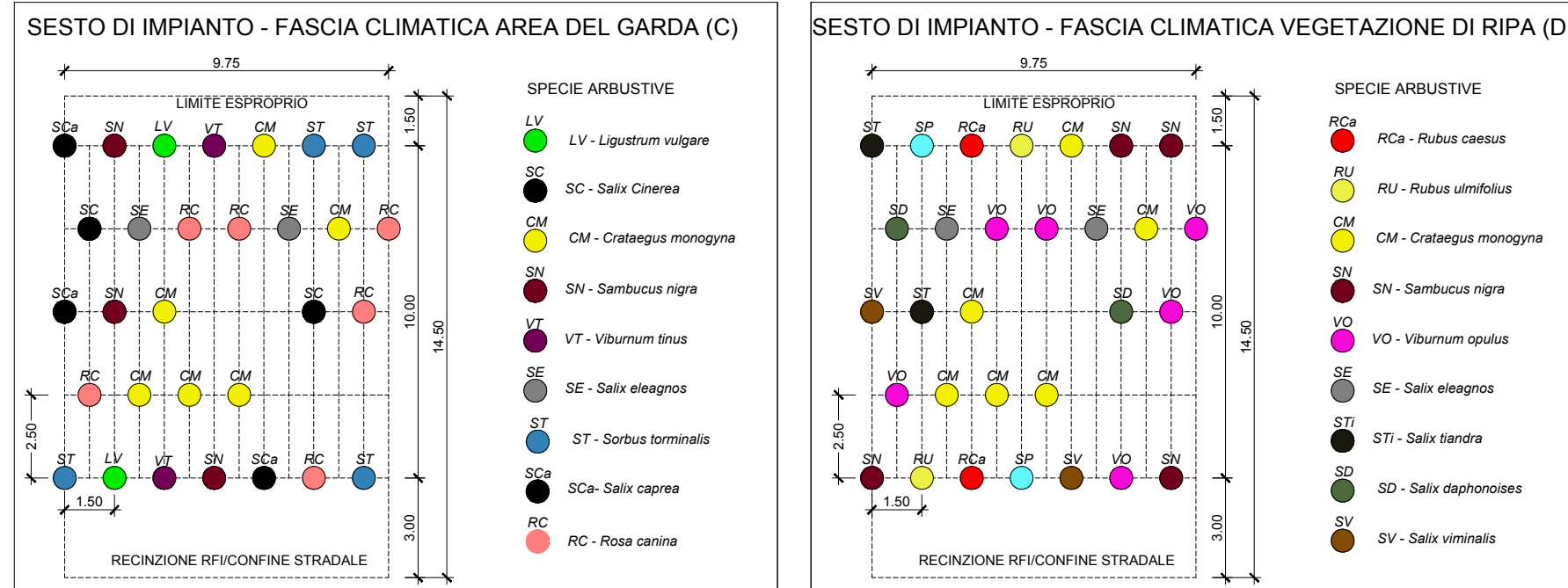
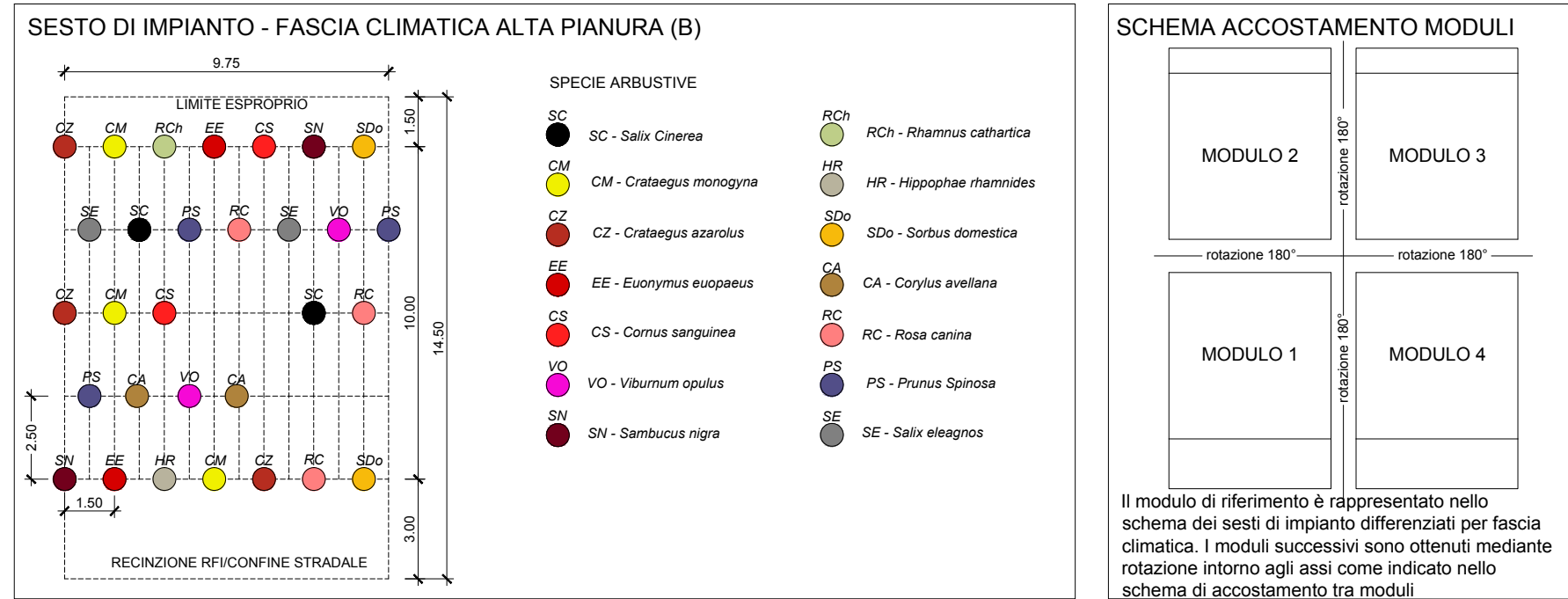
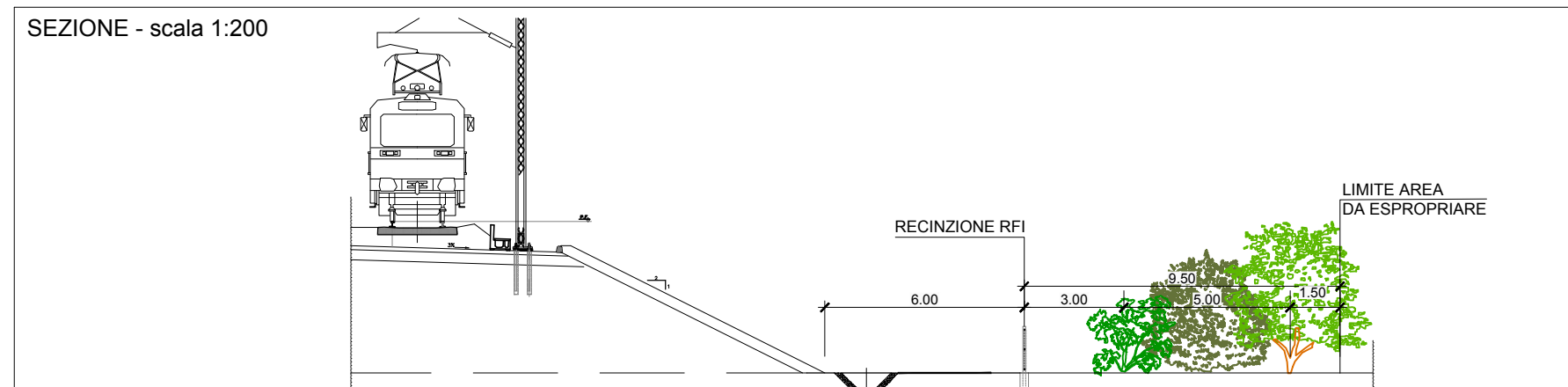
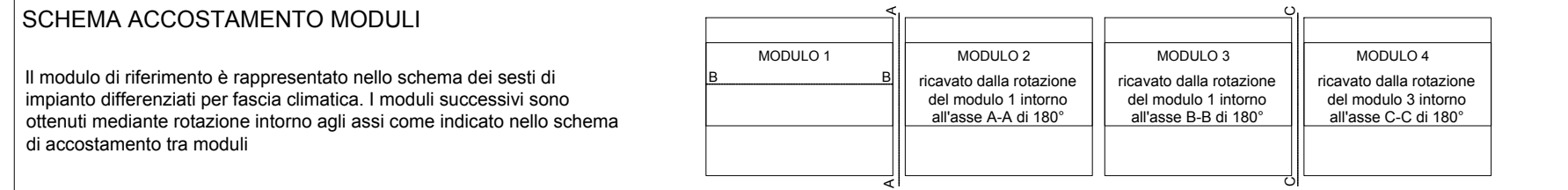
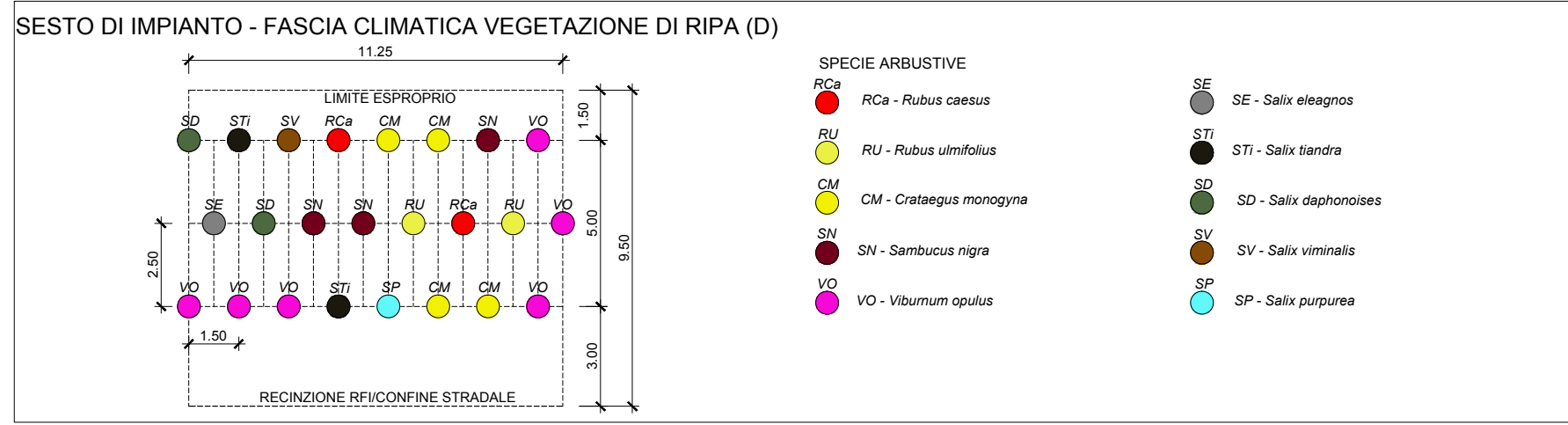
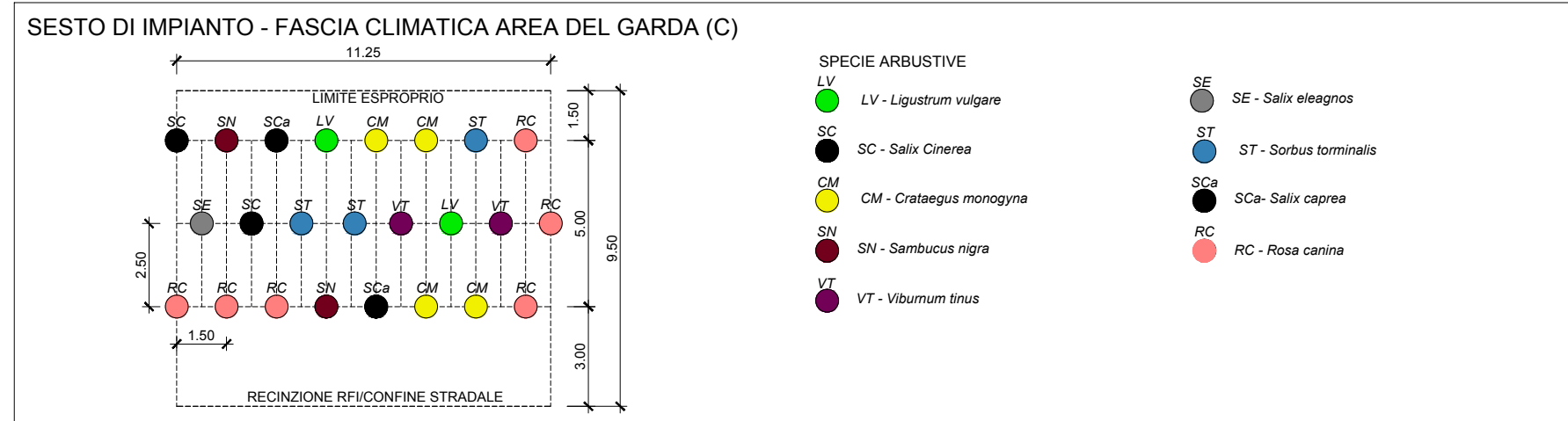
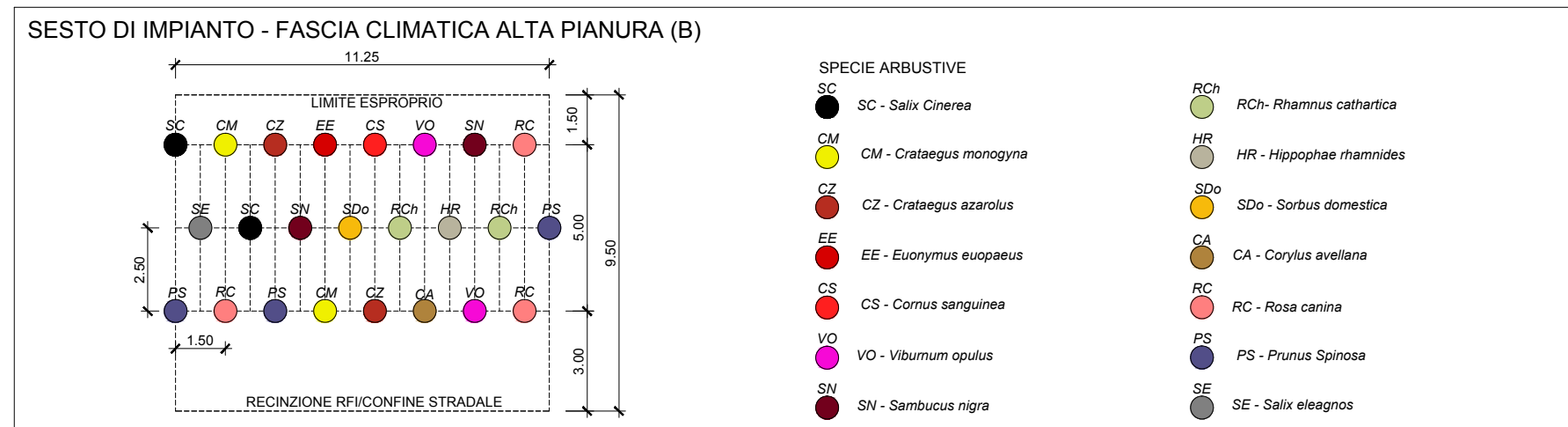

SM - SIEPE ARBOREO - ARBUSTIVA

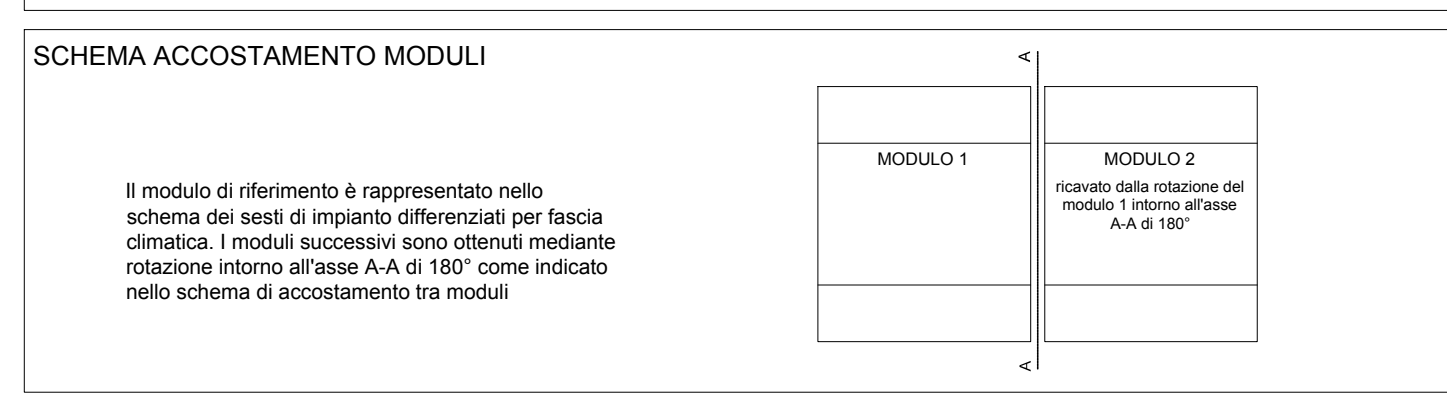
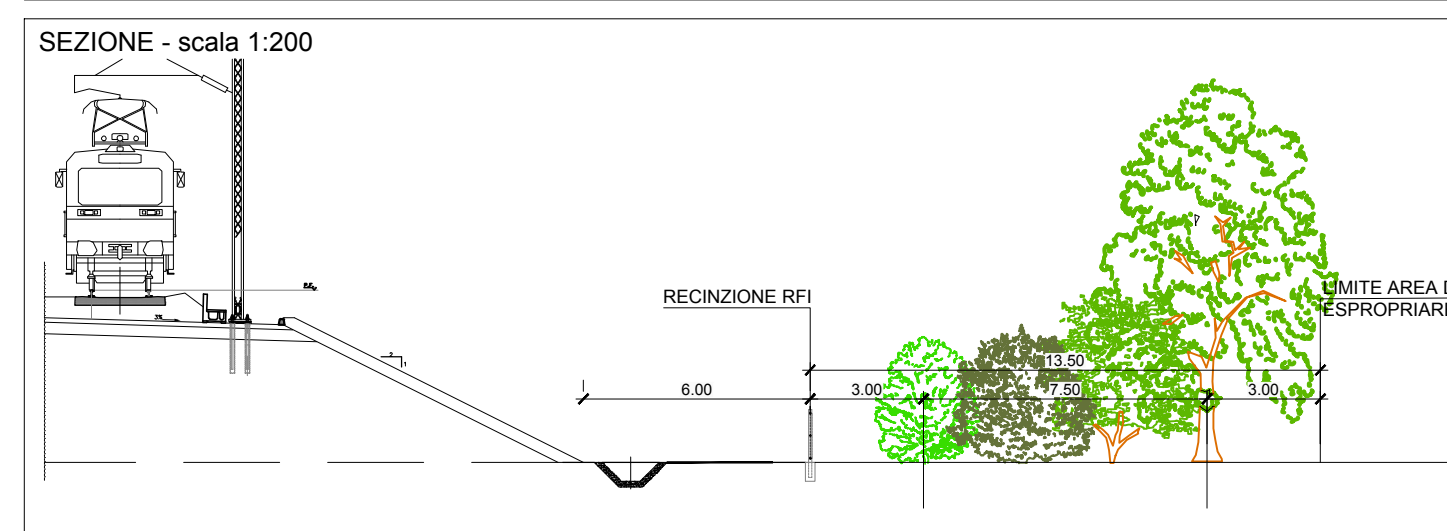
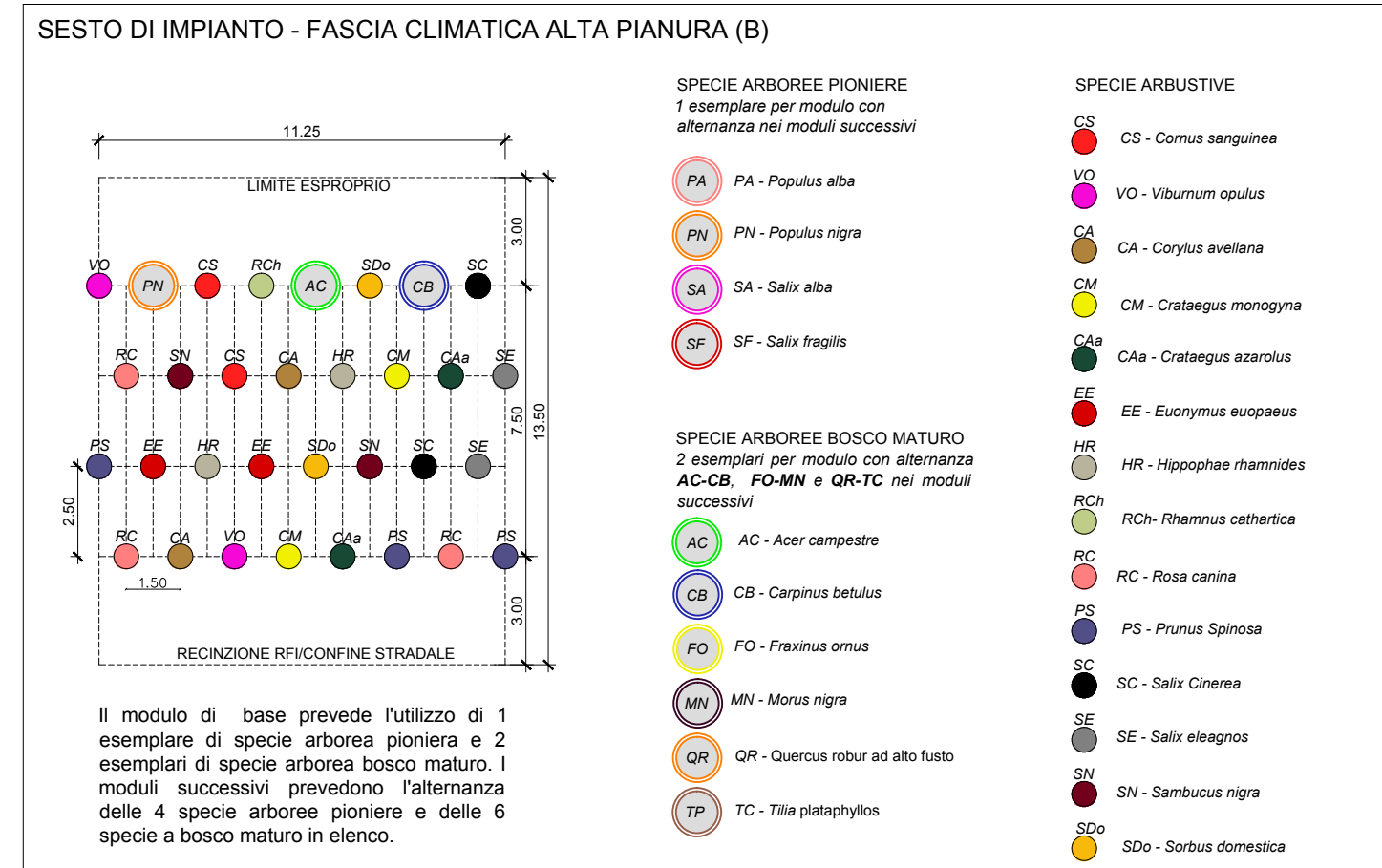

FB - FASCIA BOSCATA

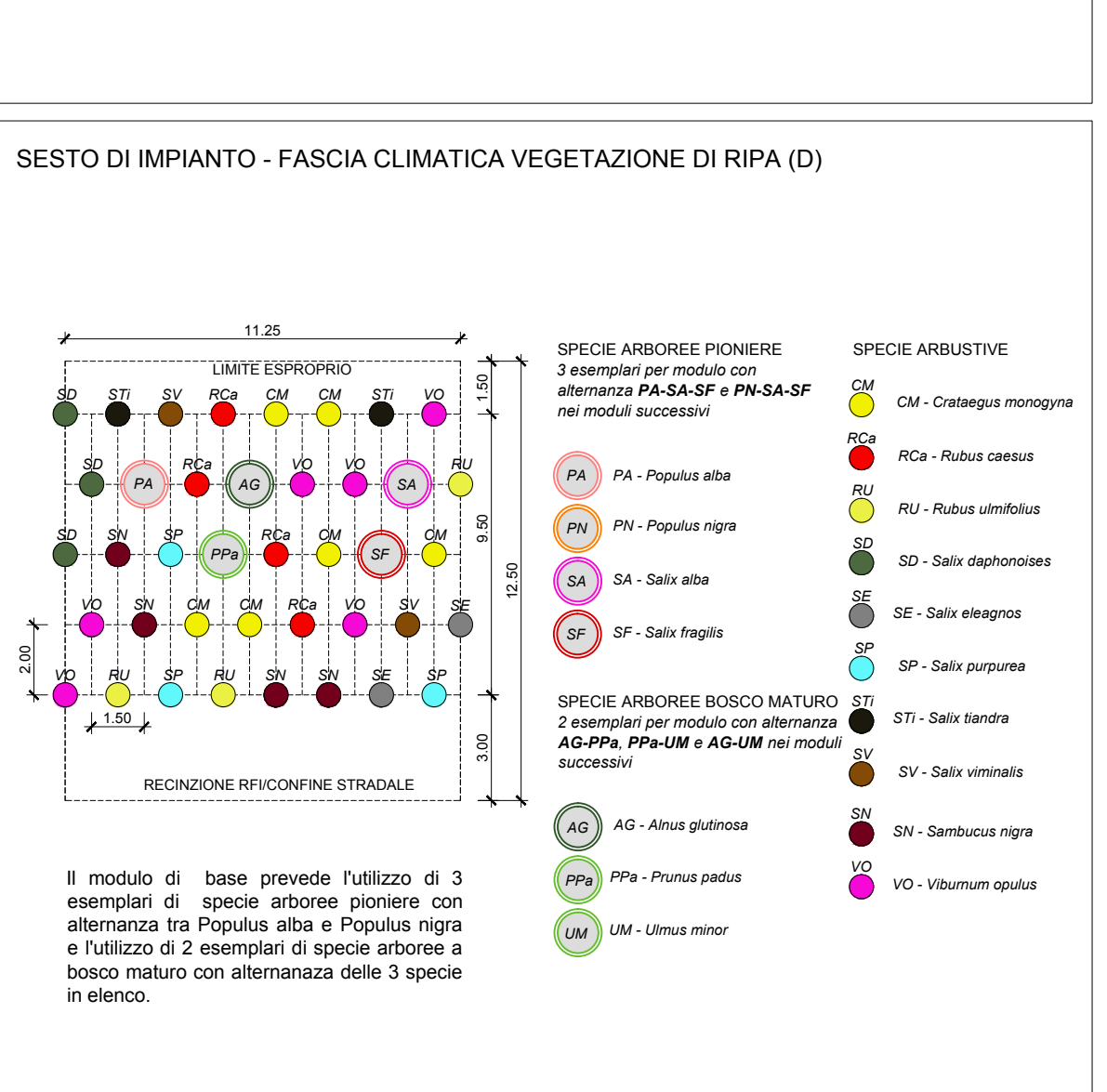
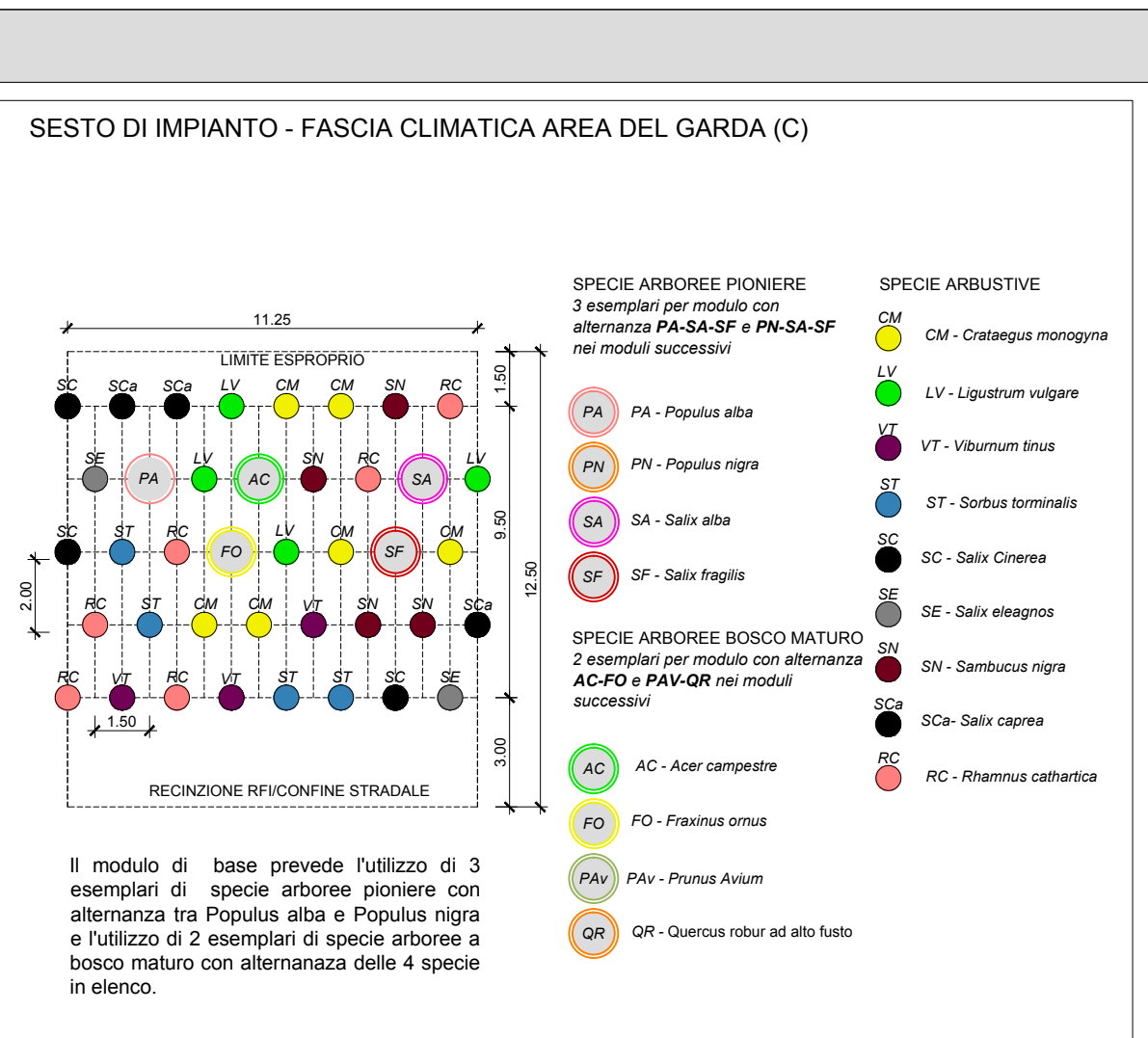
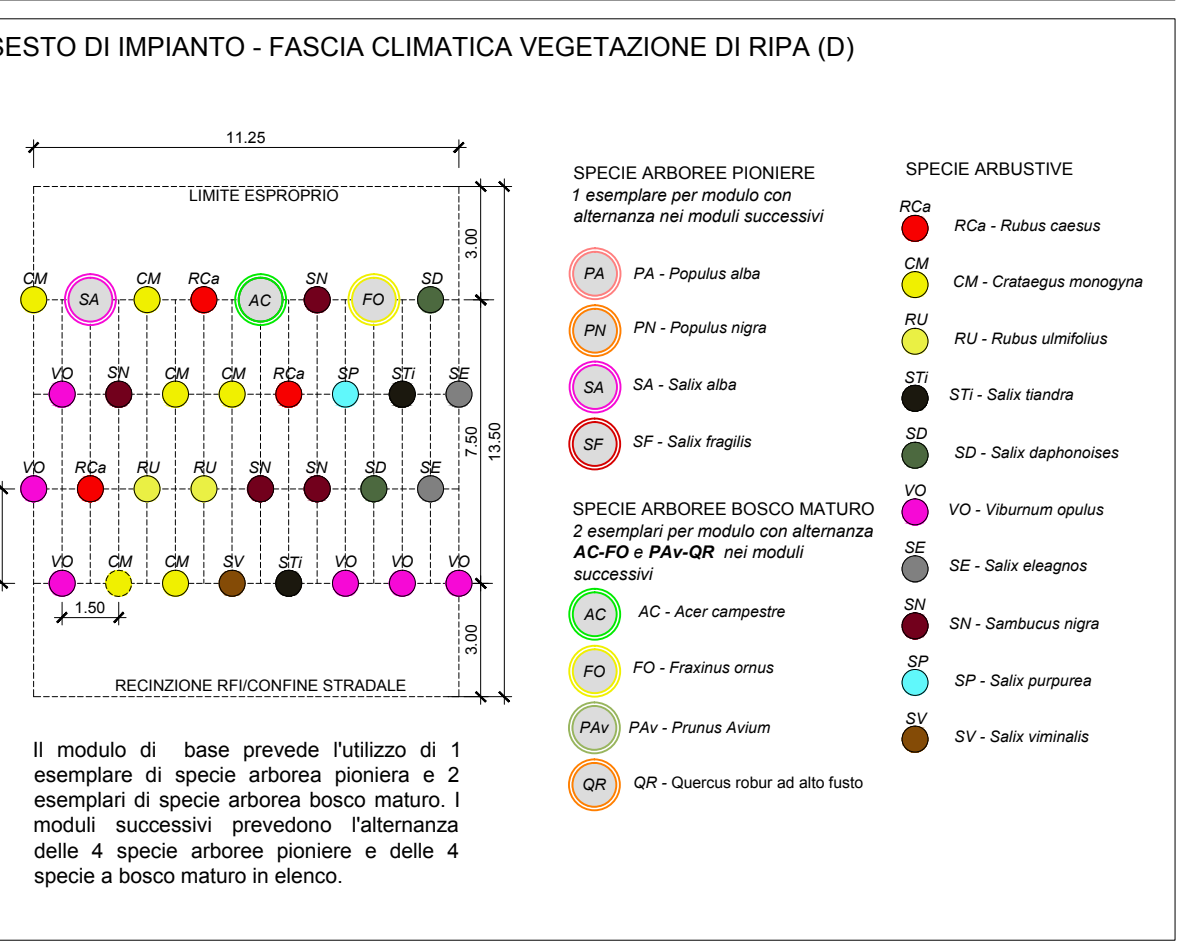
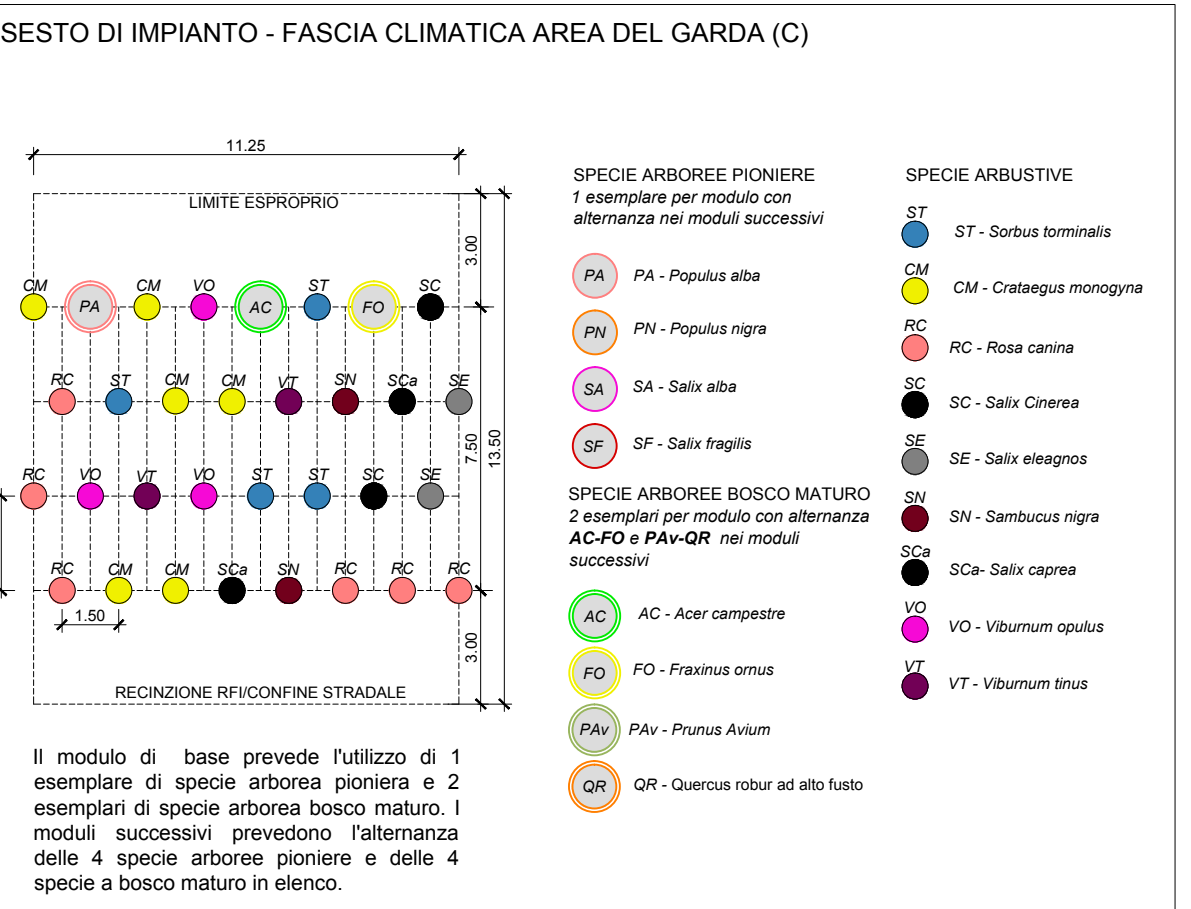
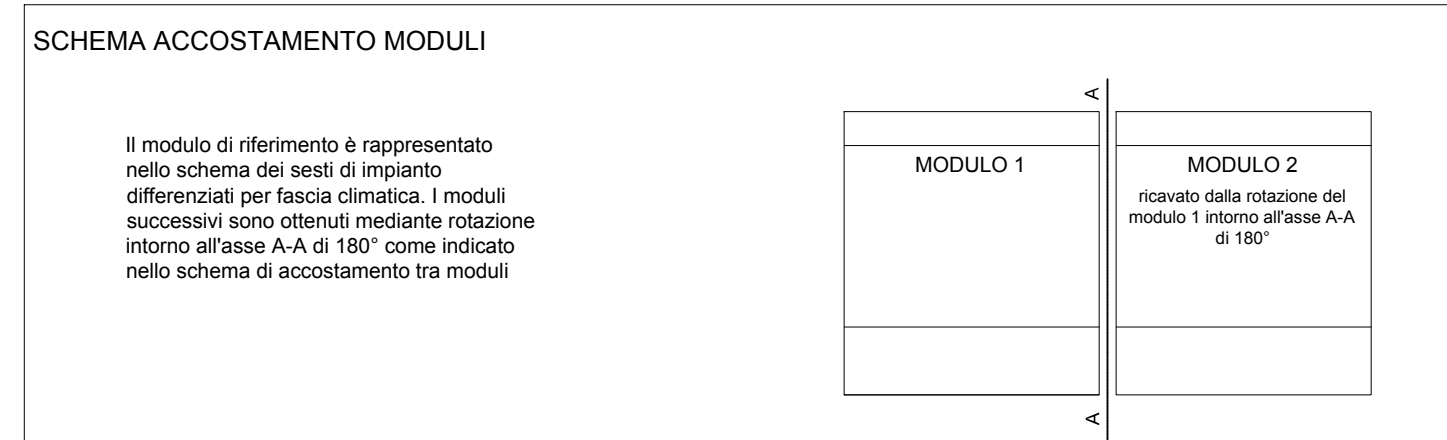
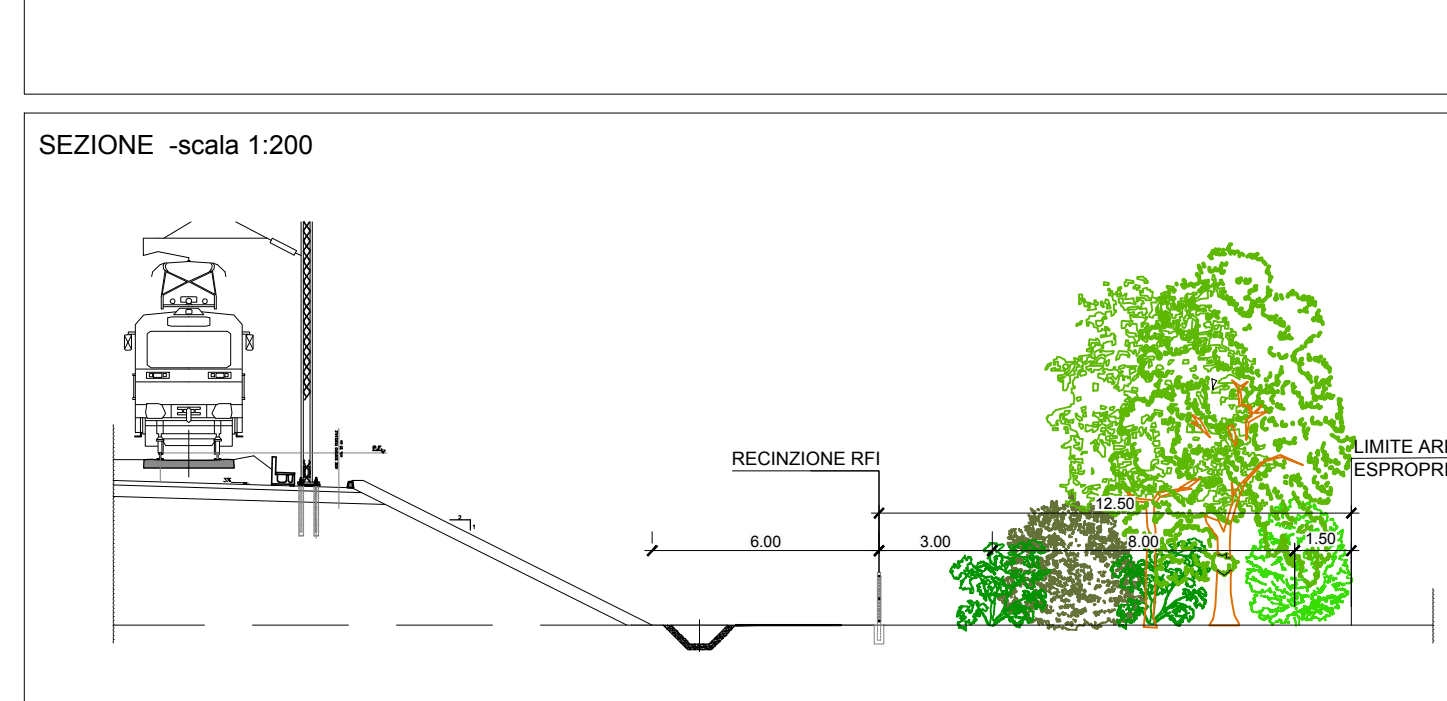
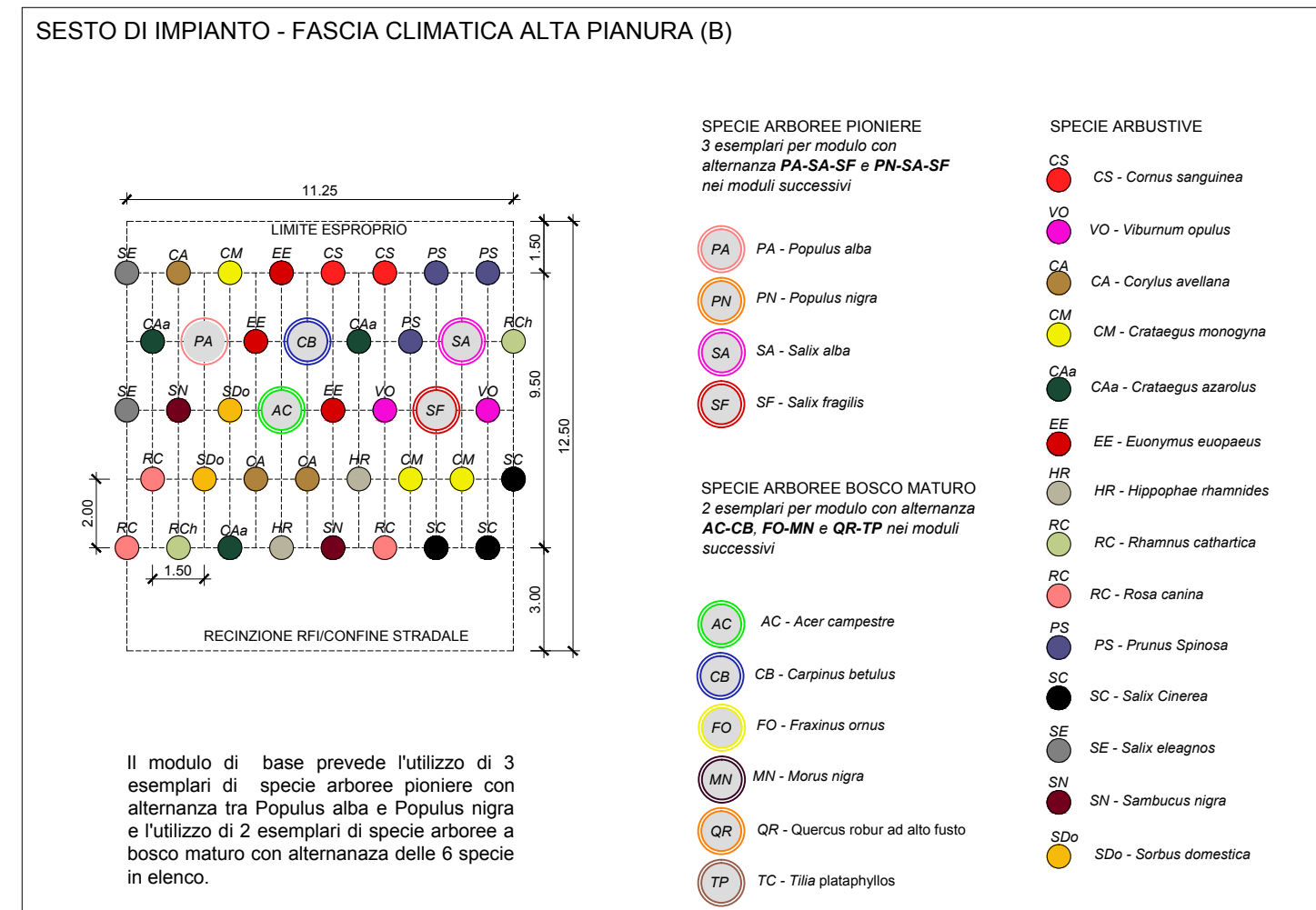

DISEGNI DI RIFERIMENTO

DESCRIZIONE CODICE

NOTE GENERALI

COMMITTENTE: **RFI RETE FERROVIARIA ITALIANA GRUPPO FERROVIE DELLO STATO**

ALTA SORVEGLIANZA: **ITALFERR GRUPPO FERROVIE DELLO STATO**

GENERAL CONTRACTOR: **Cepaw due** Consorzio ENI per l'Alta Velocità

INFRASTRUTTURE FERROVIARIE STRATEGICHE DEFINITE DALLA LEGGE OBIETTIVO N. 443/01

LINEA A.V. /A.C. TORINO - VENEZIA Tratta MILANO - VERONA
Lotto funzionale Brescia-Verona
PROGETTO ESECUTIVO
IA00 - MITIGAZIONI A VERDE
Sesti impianto opere di mitigazione a verde - tav 1/3

GENERAL CONTRACTOR: **Cepaw due**

DIRETTORE LAVORI: **VARIE**

SCALA: **VARIE**

Data: _____

COMMESSA LOTTO FASE ENTE TIPO DOC. OPERA/DISCIPLINA Progr. REV.

INOR 10 E E2 DZ IA0000 001 A

PROGETTAZIONE IL PROGETTISTA

Rev.	Descrizione	Redatto	Data	Verificato	Data	Progettista	Data
A	Emissione	la Spina	15/05/19	la Spina	15/05/19	Liani	15/05/19
B							
C							

ORDINE DI APPALTO PROVINCIA DI VERONA 15/05/19
File: INOR10E2DZIA000001A_10.dwg
Data: 15/05/19

CIG: 751447334A File: INOR10E2DZIA000001A_10.dwg

Progetto cofinanziato dalla Unione Europea
CUP: F81H9100000008

Scala di plot: 1:1