

## ARMATURA FONDAZIONI PILA 3 DX (SCALA 1 : 50)

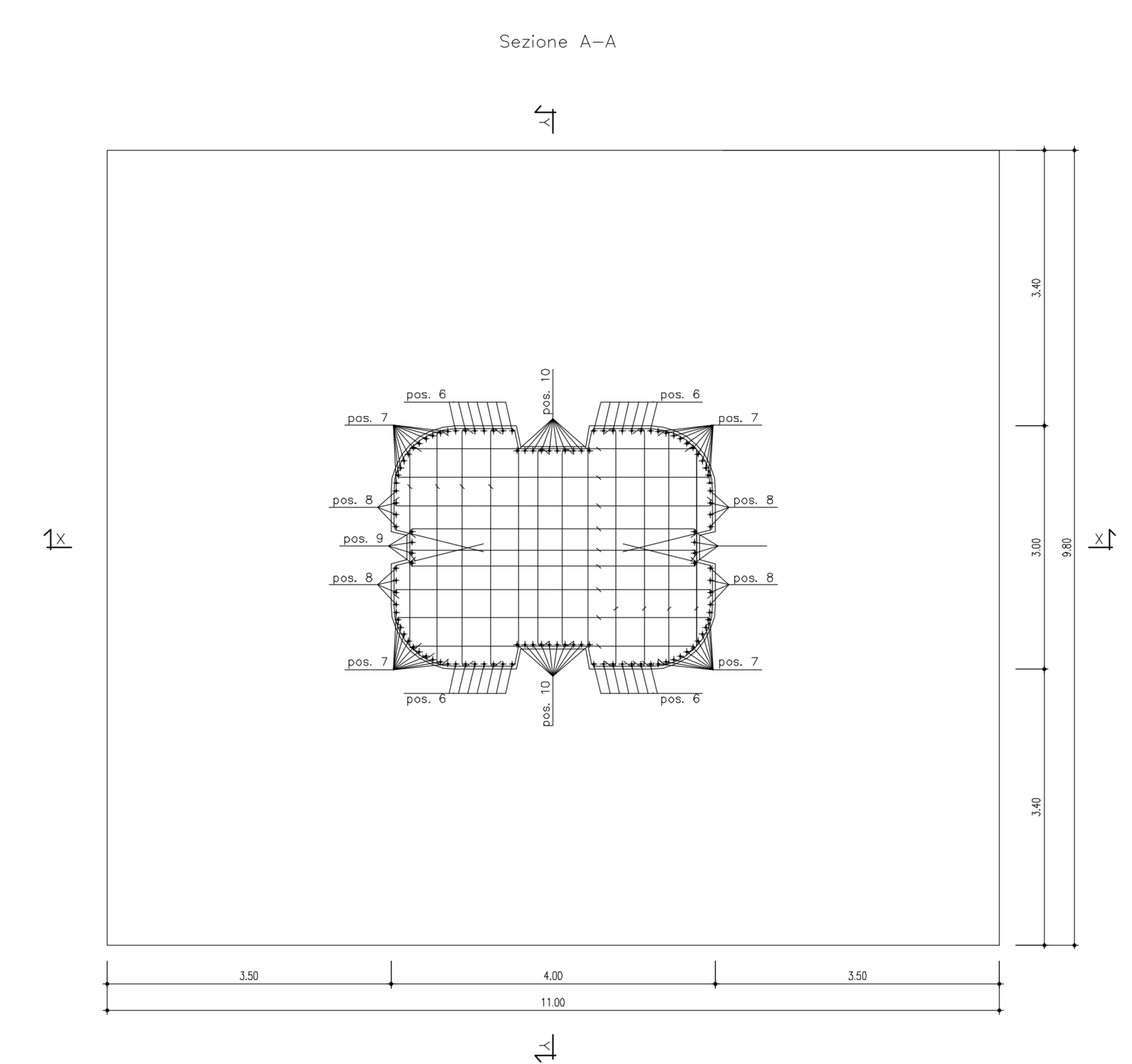
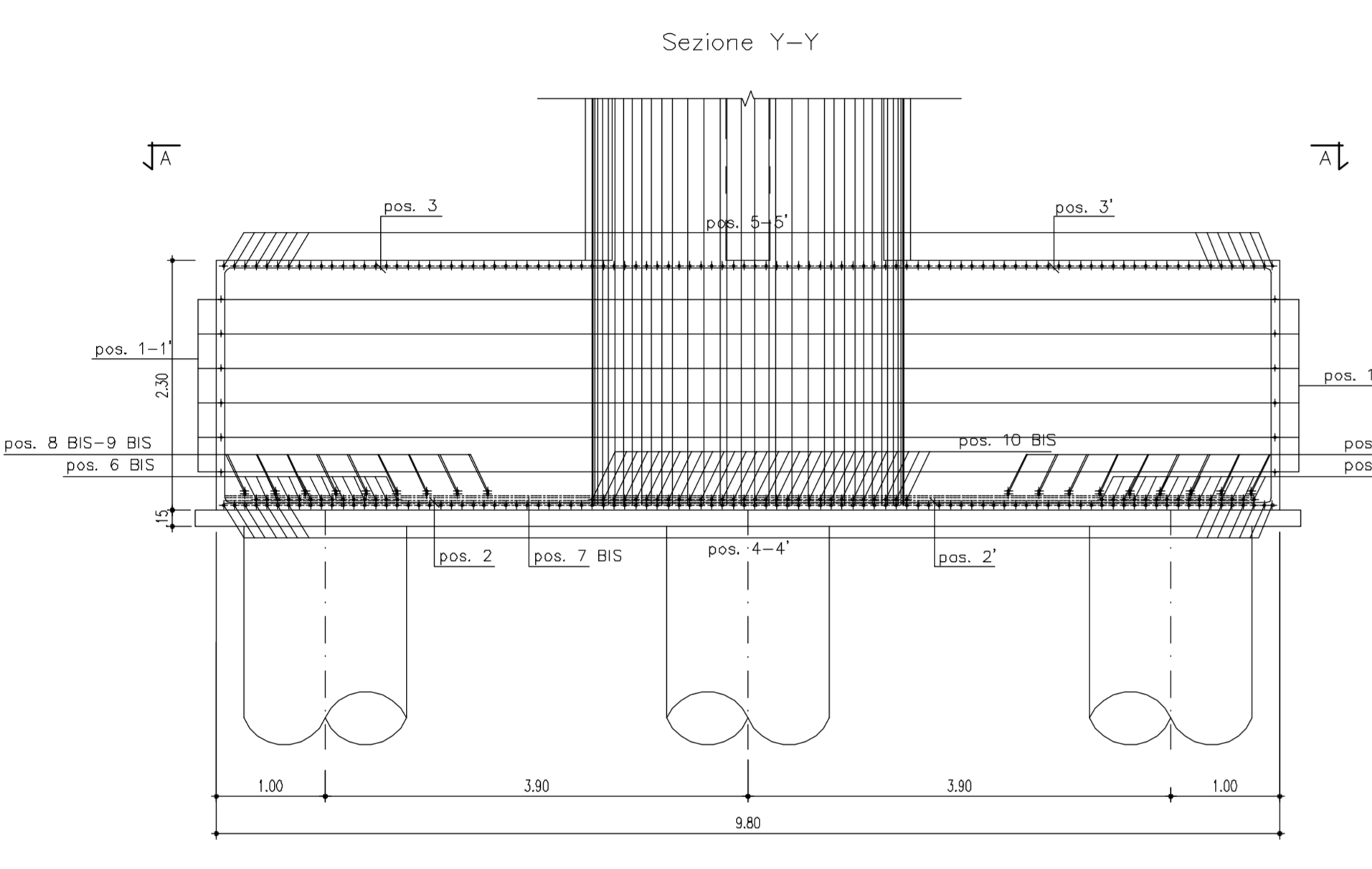
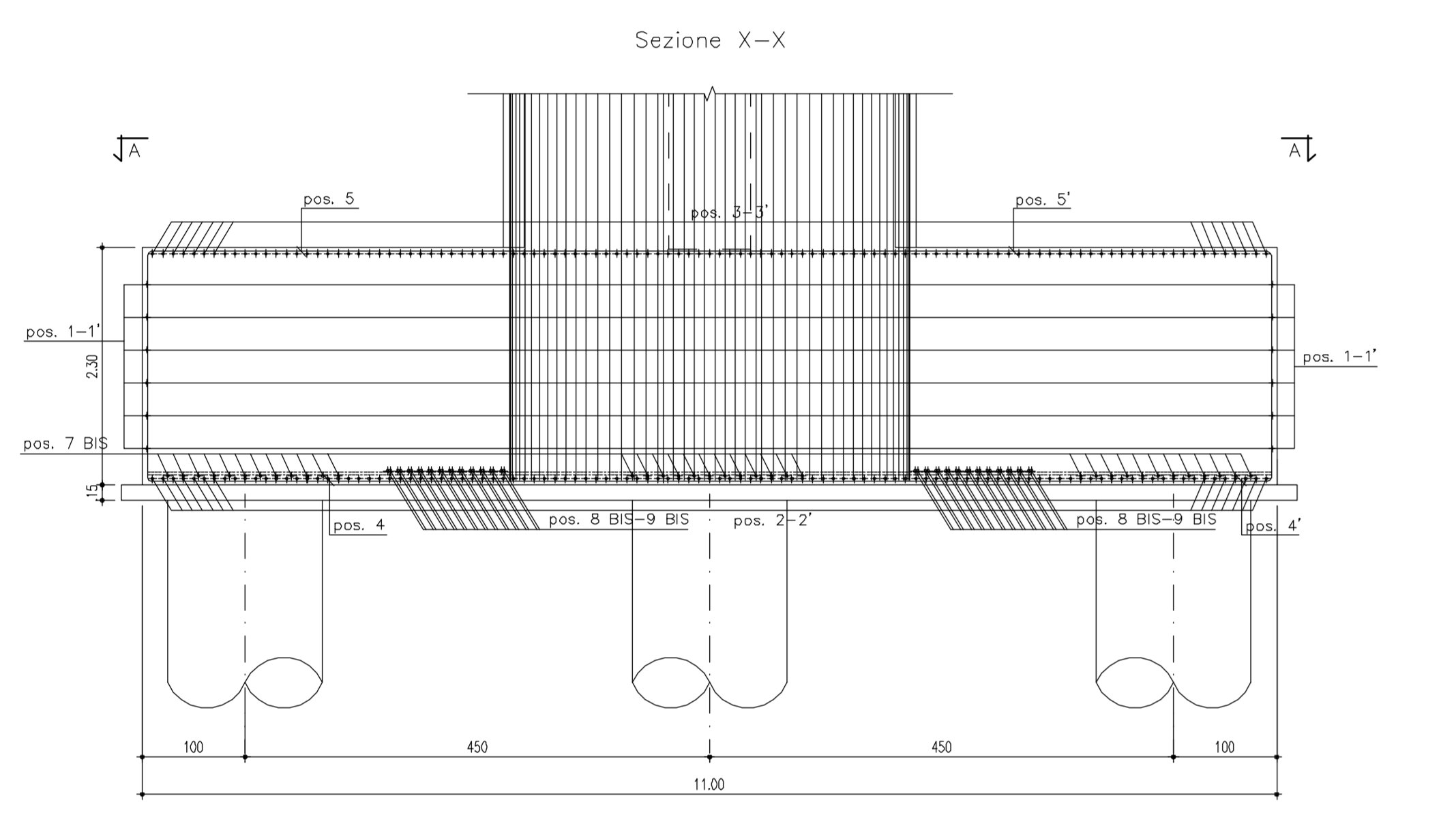
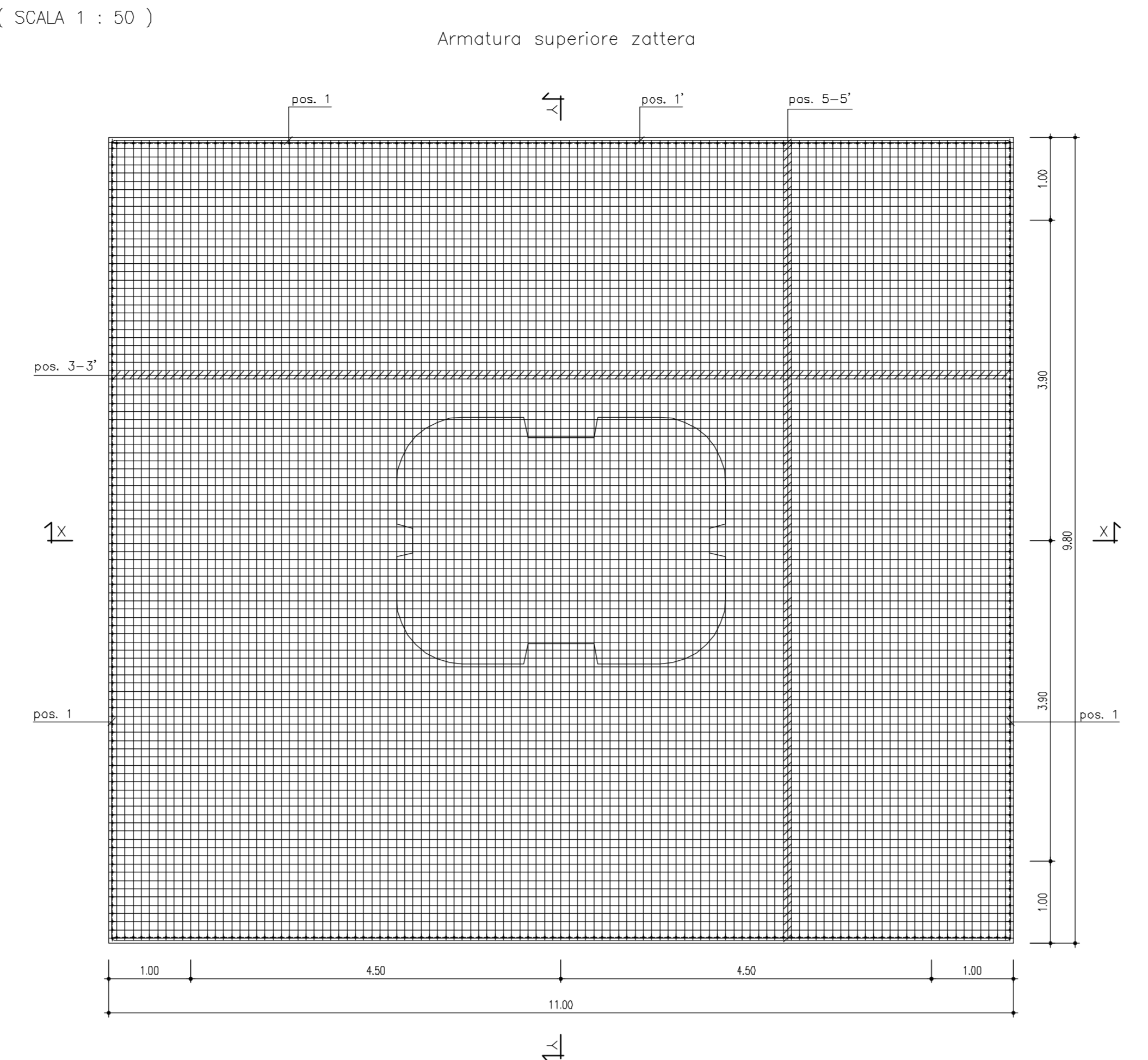
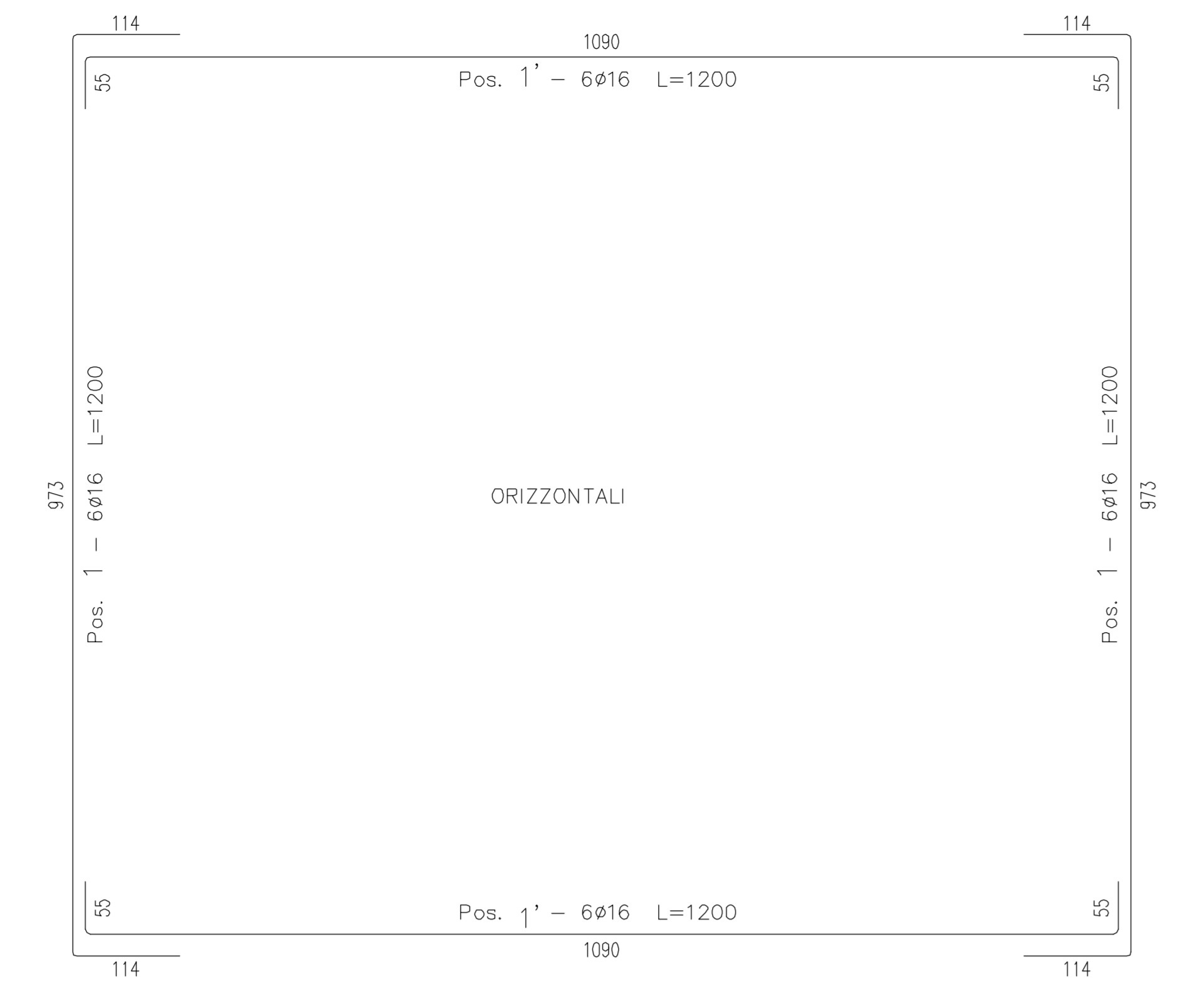
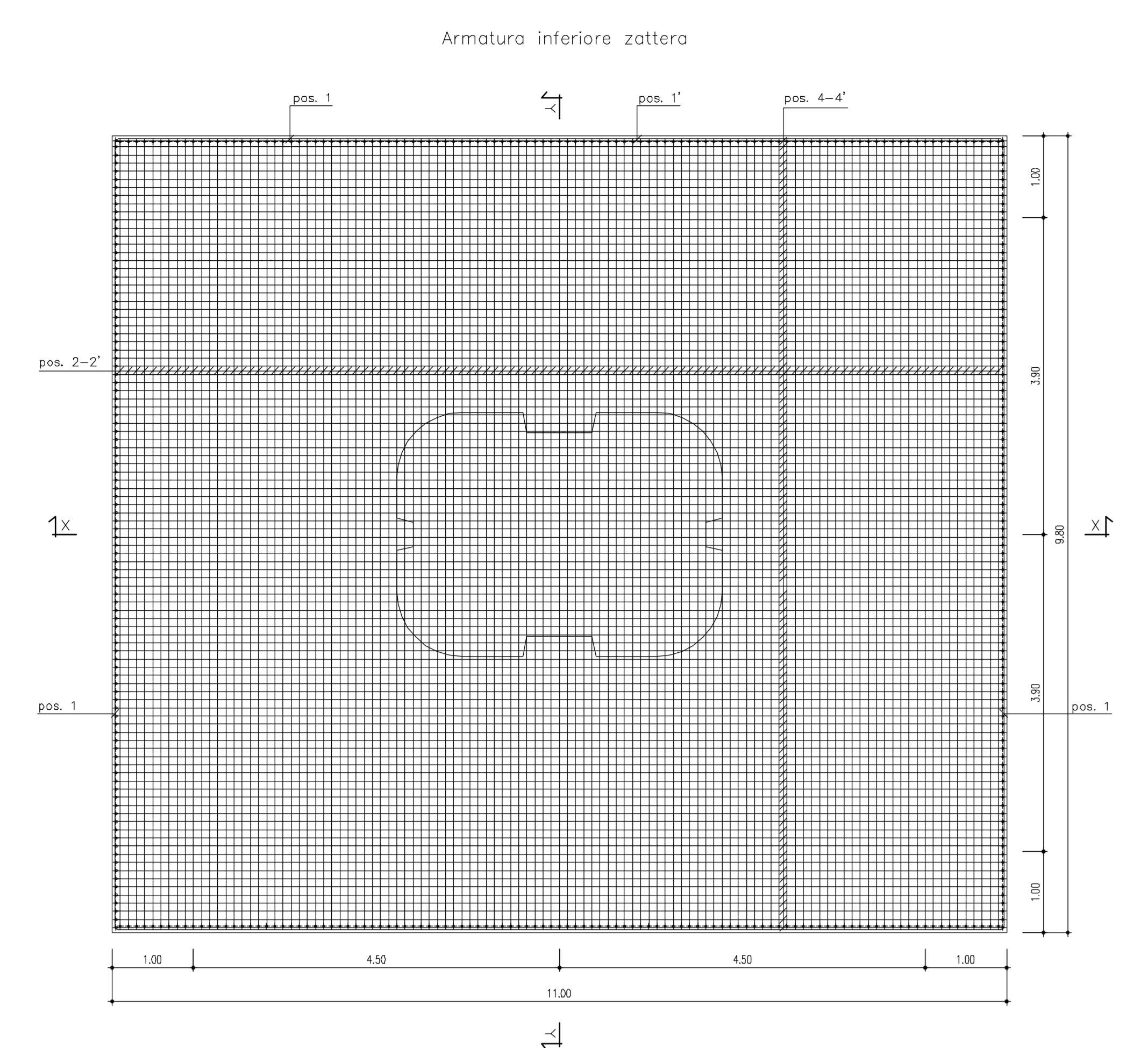

### Barre

| Sagoma | Pos. | φ (mm) | nb  | A (cm) | B (cm) | L (m)   | Ltot (m) |
|--------|------|--------|-----|--------|--------|---------|----------|
| 1      | 1    | 16     | 12  | 144    | 973    | 12.00   | 144.00   |
| 1'     | 1'   | 16     | 12  | 144    | 1090   | 12.00   | 144.00   |
| 2      | 2    | 26     | 109 | 223    | 427    | 6.48    | 103.08   |
| 2'     | 2'   | 26     | 109 | 223    | 477    | 9.00    | 981.00   |
| 3      | 3    | 26     | 97  | 223    | 547    | 7.70    | 746.90   |
| 4      | 4    | 26     | 97  | 223    | 677    | 9.00    | 873.00   |
| 5      | 5    | 22     | 109 | 110    | 790    | 9.00    | 981.00   |
| 5'     | 5'   | 22     | 97  | 110    | 430    | 5.40    | 523.80   |
| 6      | 6    | 26     | 28  | 25     | 375    | 4.00    | 112.00   |
| 7      | 7    | 26     | 44  | 25     | 375    | 4.00    | 116.00   |
| 8      | 8    | 26     | 16  | 25     | 375    | 4.00    | 64.00    |
| 9      | 9    | 26     | 8   | 25     | 375    | 4.00    | 32.00    |
| 10     | 10   | 26     | 20  | 25     | 375    | 4.00    | 80.00    |
| 12     | 12   | 26     | 272 | 1000   | 12.00  | 3264.00 |          |
| 13     | 13   | 26     | 272 | 1000   | 12.00  | 3264.00 |          |
| 14     | 14   | 26     | 272 | 1000   | 12.00  | 3264.00 |          |
| 11     | 11   | 26     | 272 | 565    | 150    | 7.15    | 1944.8   |
| 16     | 16   | 20     | 144 |        |        | 4.57    | 658.08   |

### Spirali

| Spirale | Pos. | R (cm) | H (m) | np | φ (mm) | S (cm) | Ltot (m) | Note |
|---------|------|--------|-------|----|--------|--------|----------|------|
|         | 15   | 70     | 35.00 | 8  | 12     | 28     | 6156.40  |      |

### Massa barre

| φ (mm) | M/L (kg/m) | Ltot (m)    | Mtot (kg)       |
|--------|------------|-------------|-----------------|
| 16     | 1.578      | 388         | 610.48          |
| 20     | 2.464      | 658.08      | 1622.83         |
| 22     | 2.984      | 2830.15     | 8445.17         |
| 26     | 4.168      | 14688.75    | 61222.71        |
|        |            | <b>Tot.</b> | <b>71745.17</b> |

### Massa spirali

| φ (mm) | M/L (kg/m) | Ltot (m) | Mtot (kg) |
|--------|------------|----------|-----------|
| 12     | 0.888      | 6156.40  | 5466.88   |

Massa totale acciaio : 77212.05 kg  
Ultima posizione : 16

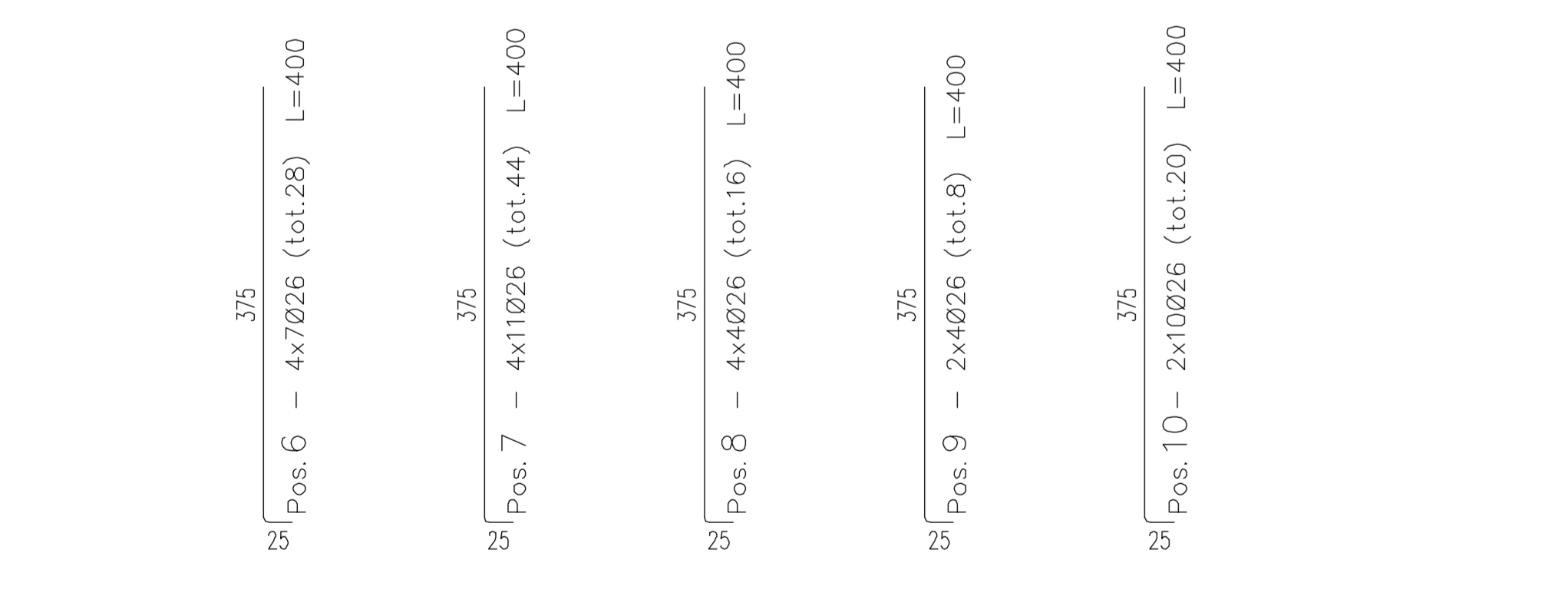
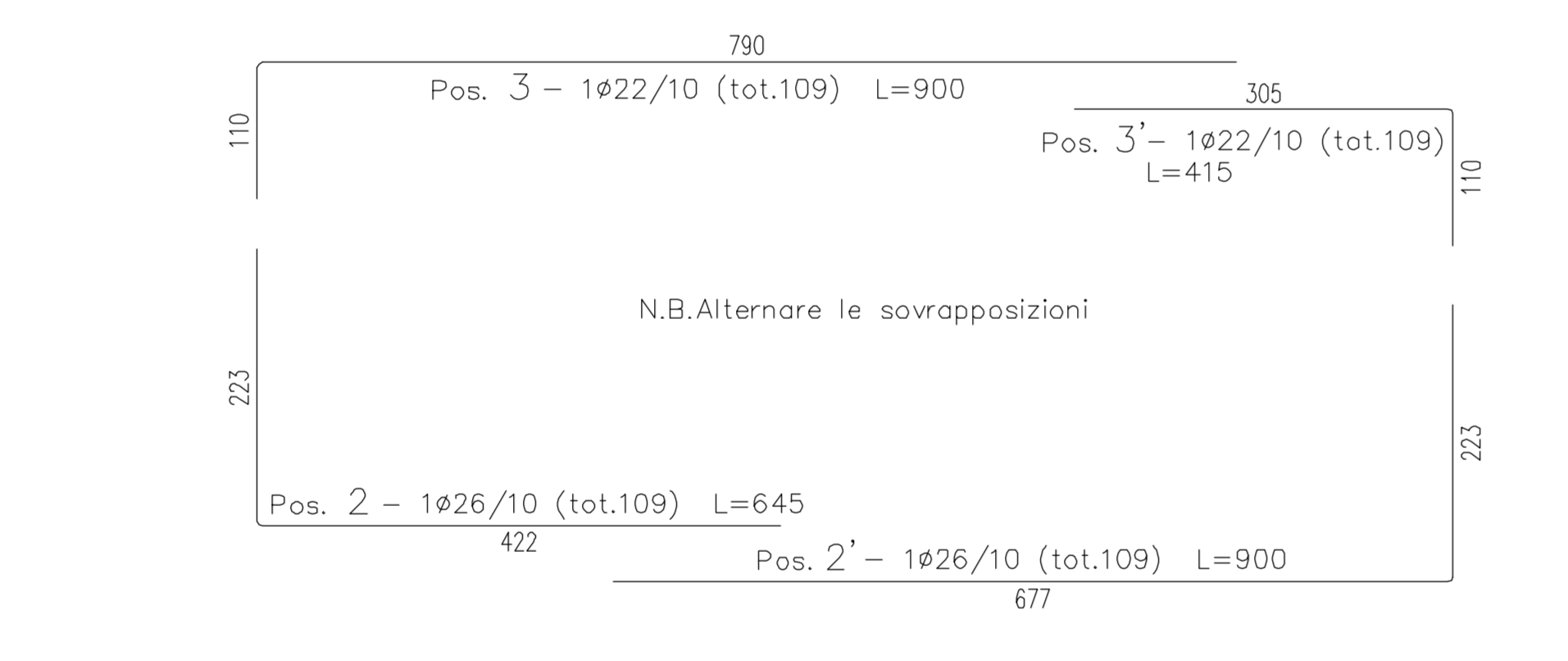
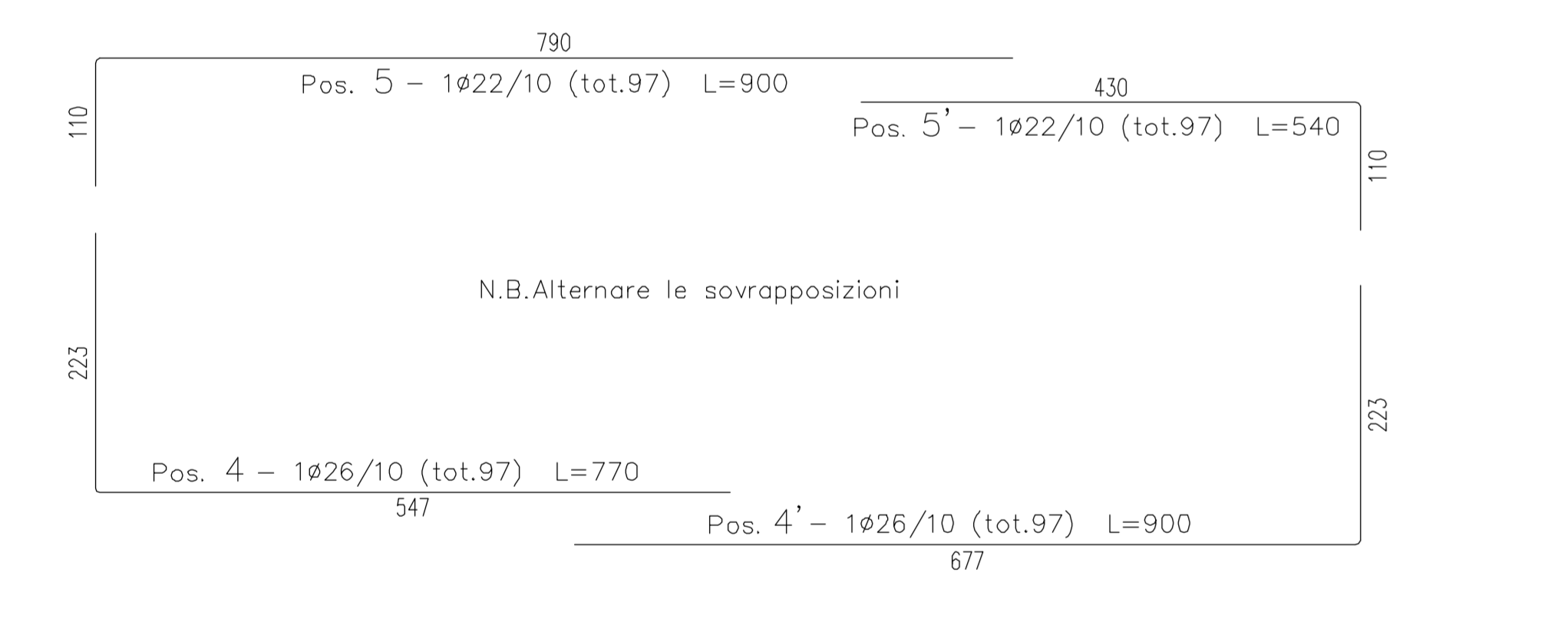

### Barre

| Sagoma | Pos.   | φ (mm) | nb | A (cm) | B (cm) | L (m) | Ltot (m) |
|--------|--------|--------|----|--------|--------|-------|----------|
| 6 BIS  | 6 BIS  | 26     | 30 | 110    | 1090   | 12.00 | 3600.00  |
| 7 BIS  | 7 BIS  | 26     | 36 | 50     | 970    | 10.20 | 3672.00  |
| 8 BIS  | 8 BIS  | 26     | 24 | 70     | 1030   | 11.00 | 2640.00  |
| 9 BIS  | 9 BIS  | 26     | 24 | 70     | 1030   | 11.00 | 2640.00  |
| 10 BIS | 10 BIS | 26     | 30 | 110    | 1090   | 12.00 | 3600.00  |

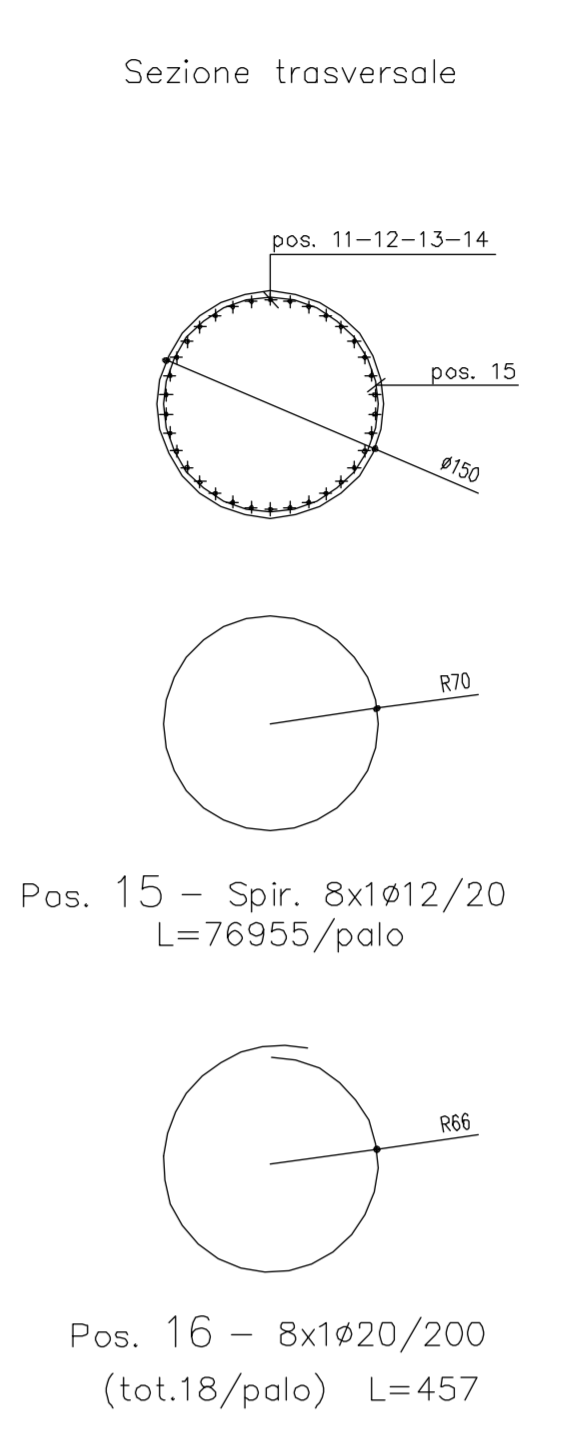
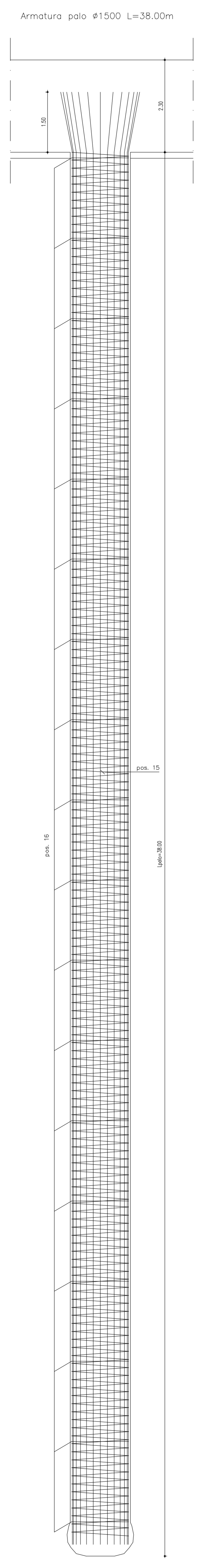
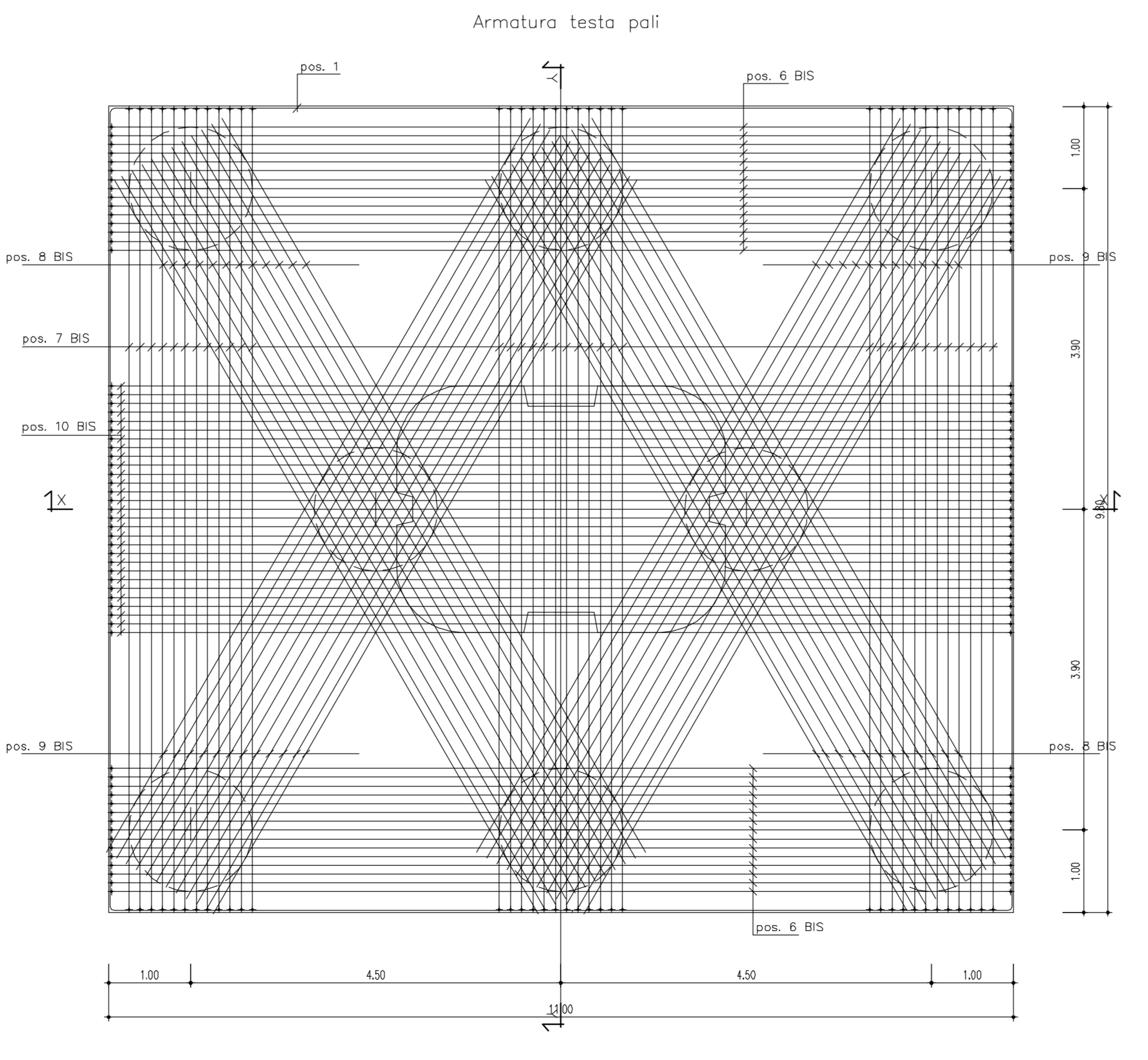

#### TRAVI PRESPALATE E TRAZZATE

... (small text)

#### CONCRETO

... (small text)

| DESCRIZIONE      | CANTONIERA | UNITA' | QUANTITA' | PREZZO UNITARIO | TOTALE |
|------------------|------------|--------|-----------|-----------------|--------|
| ... (small text) | ...        | ...    | ...       | ...             | ...    |

| DESCRIZIONE      | CANTONIERA | UNITA' | QUANTITA' | PREZZO UNITARIO | TOTALE |
|------------------|------------|--------|-----------|-----------------|--------|
| ... (small text) | ...        | ...    | ...       | ...             | ...    |

#### ARMATURE PER C.A.

... (small text)

PA 12/09

**CORRIDOIO PLURIMODALE TIRRENICO - NORD EUROPA**

**ITINERARIO AGRIGENTO - CALTANISSETTA - A19**

**S.S. N° 840 "DI PORTO EMPEDOCLE"**

**AMMODERNAMENTO E ADEGUAMENTO ALLA CAT. B DEL D.M. 5.11.2001**

Dal km 44+000 allo svincolo con l'A19

**PROGETTO ESECUTIVO**

**OPERE D'ARTE MAGGIORI**

**VIADOTTI**

Viadotto Busita I

**ARMATURA PILA 3 CARREGGIATA DX - FONDAZIONI**

|   |            |   |                    |
|---|------------|---|--------------------|
| Codice Unico Progetto (CUP) : F91B0900070001                              |            |   |                    |
| Codice Elaborato : PA12_09 - E 1 4 9 V I 2 0 6 V I 0 6 9 B B 0 5 6 B 1:50 |            |   |                    |
| F   |            |   |                    |
| E   |            |   |                    |
| D   |            |   |                    |
| C   |            |   |                    |
| B   | Luogo 2011 | Realizza a seguito di incarico con il contratto | M. LFTI P. FAGIOLI |
| A   | 012011     | EMMISSIONE                                      | M. LFTI P. FAGIOLI |
| REDAZIONE   | DATA       | ELABORAZIONE                                    | VERIFICATA         |
| REDAZIONE   | DATA       | ELABORAZIONE                                    | VERIFICATA         |

Progettato da

Coordinatore per la fase di progetto

Coordinatore per la fase di esecuzione

Disegnato da