

ARMATURA PULVINO E BAGGIOLI PILA 1 SX Tav. 2/2
(SCALA 1 : 50)

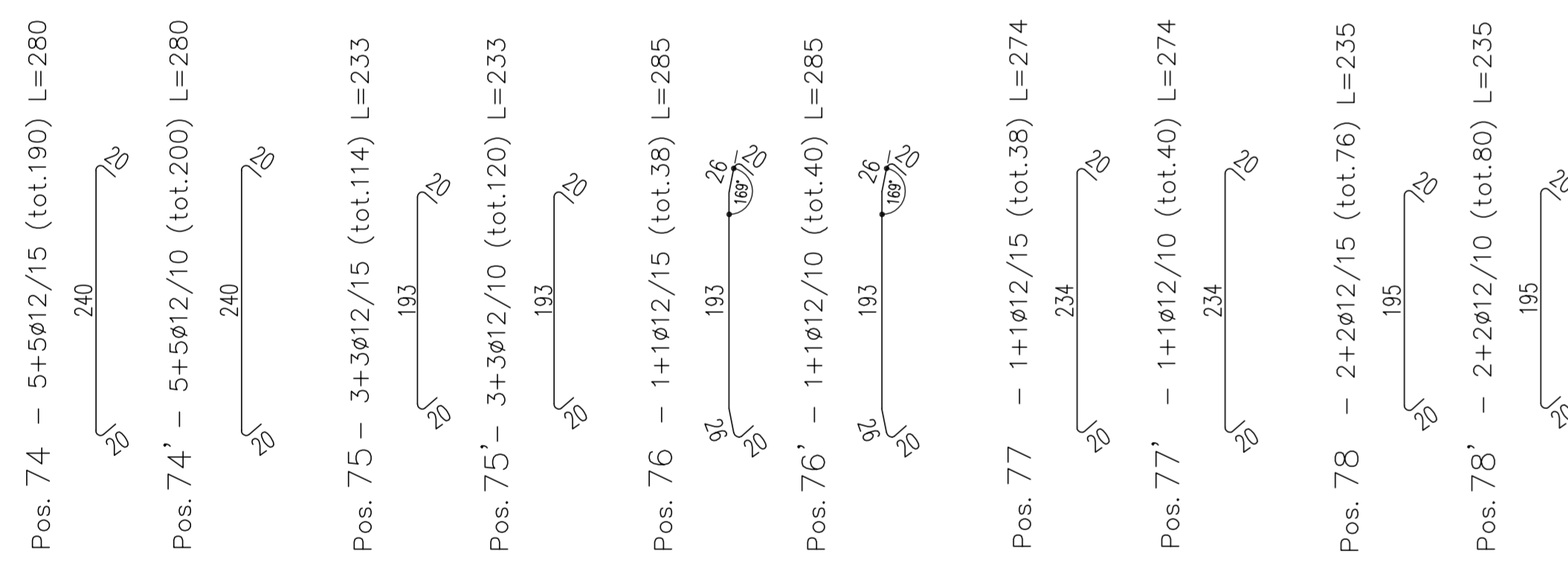
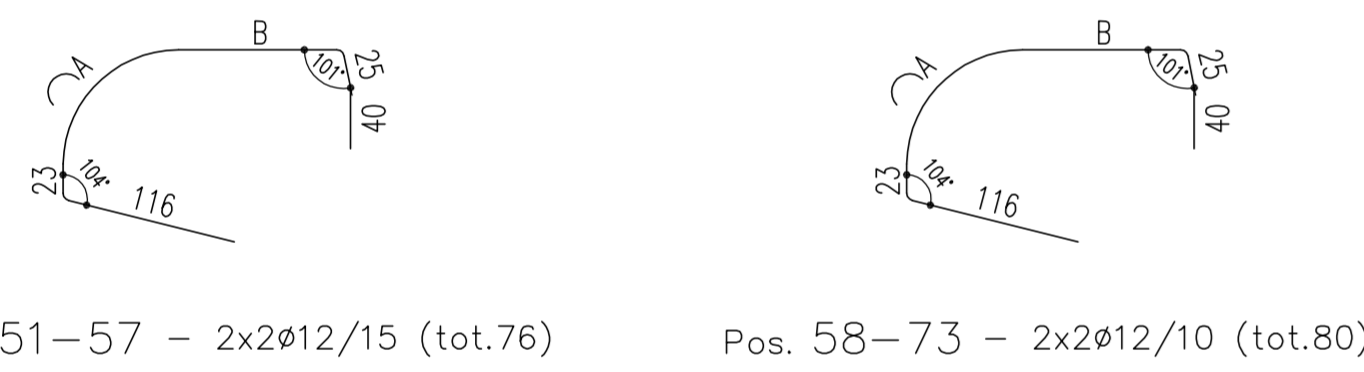
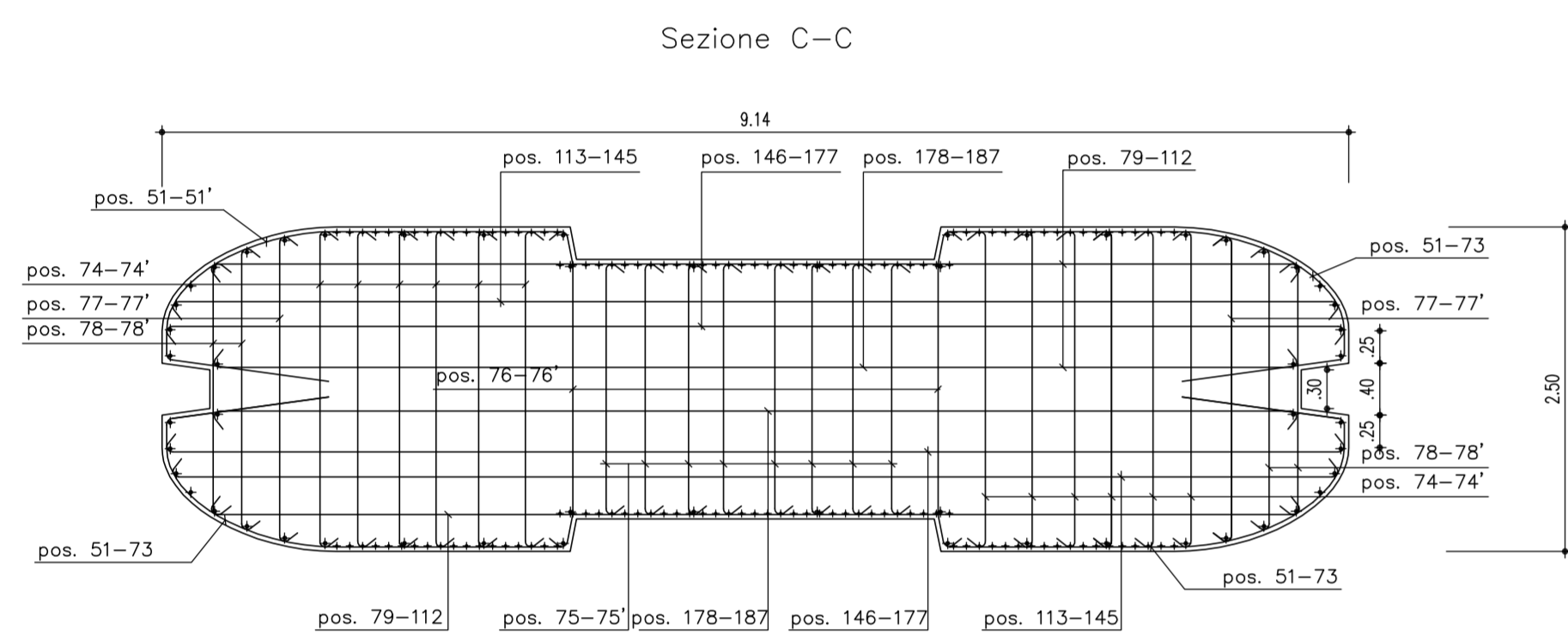
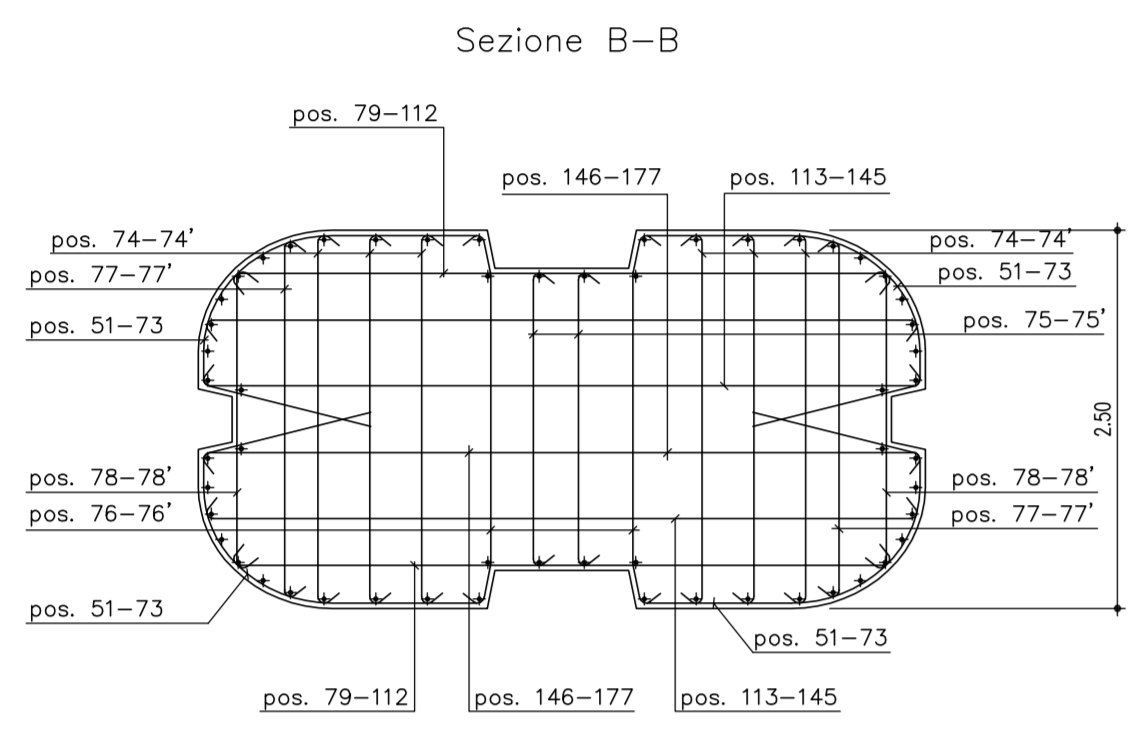
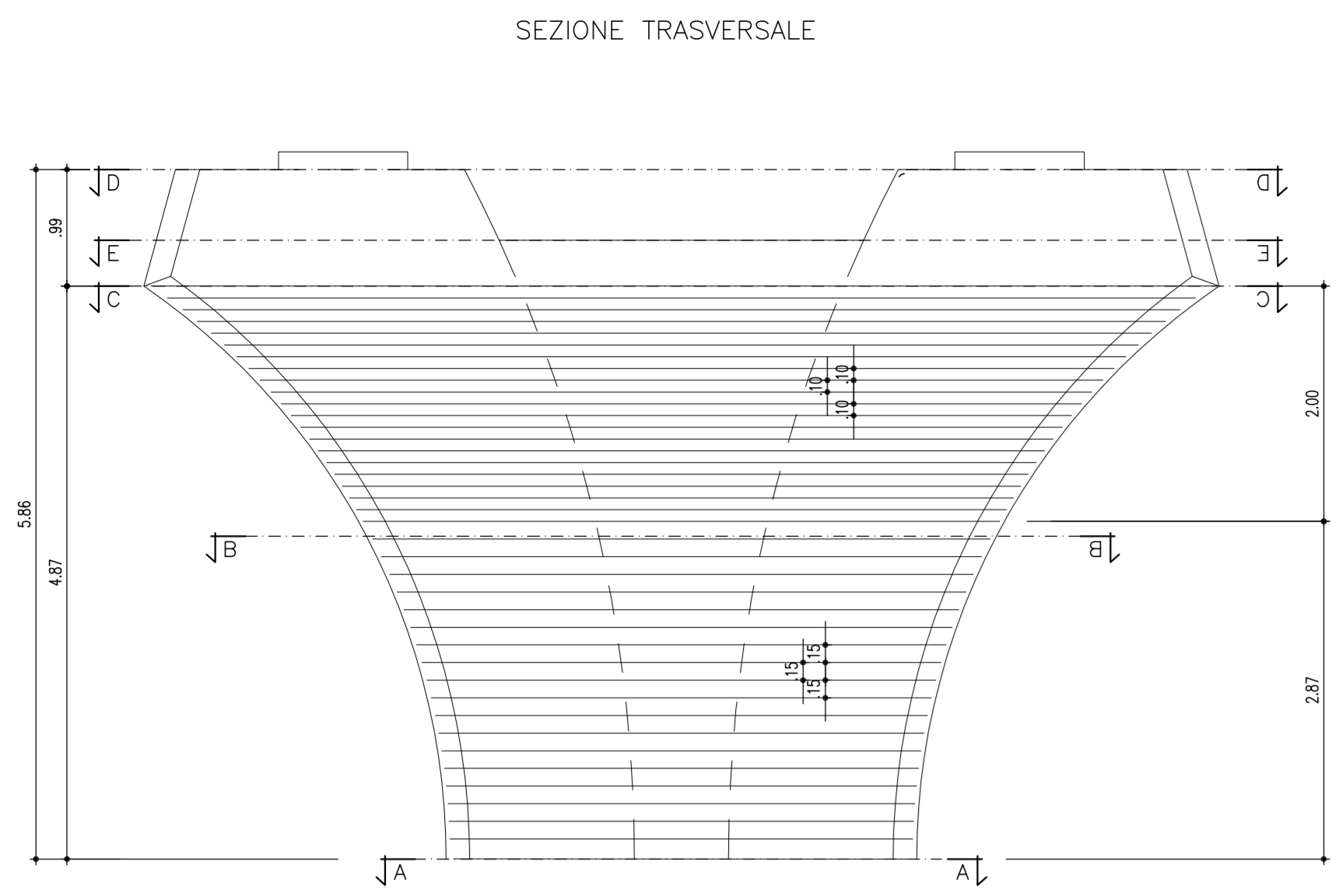

Sogomo	Pos.	φ (mm)	nb	A (cm)	B (cm)	C (cm)	D (cm)	E (cm)	F (cm)	L (cm)	Ltot (m)
	51	12	4	119	75	25	40	23	116	3.98	15.92
	52	12	3	120	76	25	40	23	116	4.00	12.00
	53	12	3	121	81	25	40	23	116	4.06	12.18
	54	12	3	123	86	25	40	23	116	4.13	12.39
	55	12	2	124	92	25	40	23	116	4.20	8.40
	56	12	2	125	98	25	40	23	116	4.27	8.54
	57	12	2	127	104	25	40	23	116	4.35	8.70
	58	12	2	128	109	25	40	23	116	4.41	8.82
	59	12	2	130	115	25	40	23	116	4.49	8.98
	60	12	2	132	121	25	40	23	116	4.57	9.14
	61	12	1	133	127	25	40	23	116	4.64	9.28
	62	12	1	135	133	25	40	23	116	4.72	4.72
	63	12	1	137	137	25	40	23	116	4.78	4.78
	64	12	1	138	141	25	40	23	116	4.83	4.83
	65	12	1	139	145	25	40	23	116	4.88	4.88
	66	12	1	141	149	25	40	23	116	4.94	4.94
	67	12	1	142	154	25	40	23	116	5.00	5.00
	68	12	1	144	159	25	40	23	116	5.07	5.07
	69	12	1	146	164	25	40	23	116	5.14	5.14
	70	12	1	148	169	25	40	23	116	5.21	5.21
	71	12	1	151	175	25	40	23	116	5.30	5.30
	72	12	1	154	180	25	40	23	116	5.38	5.38
	73	12	1	157	187	25	40	23	116	5.48	5.48
	74	12	190	240	20					2.80	532.00
	74'	12	200	240	20					2.80	560.00
	75	12	114	193	20					2.33	265.62
	75'	12	120	193	20					2.33	178.60
	77	12	38	234	20					2.74	104.12
	77'	12	40	234	20					2.74	109.60
	78	12	78	189	20					2.35	108.60
	78'	12	80	189	20					2.35	188.00
	79	12	2	355	20					3.95	7.90
	80	12	2	355	20					3.95	7.90
	81	12	2	355	20					3.95	7.90
	82	12	2	356	20					3.96	7.92
	83	12	2	357	20					3.97	7.94
	84	12	2	361	20					4.01	8.02
	85	12	2	363	20					4.03	8.06
	86	12	2	366	20					4.06	8.12
	87	12	2	371	20					4.11	8.22
	88	12	2	376	20					4.16	8.32
	89	12	2	382	20					4.22	8.44
	90	12	2	389	20					4.29	8.58
	91	12	2	397	20					4.37	8.74
	92	12	2	406	20					4.46	8.92
	93	12	2	435	20					4.75	9.50
	94	12	2	446	20					4.86	9.72
	95	12	2	458	20					4.98	9.96
	96	12	2	472	20					5.12	10.24
	97	12	2	486	20					5.26	10.52
	98	12	2	501	20					5.41	10.82
	99	12	2	517	20					5.57	11.14
	100	12	2	535	20					5.75	11.50
	101	12	2	553	20					5.93	11.86
	102	12	2	571	20					6.11	12.22
	103	12	2	594	20					6.34	12.68
	104	12	2	616	20					6.56	13.12
	105	12	2	640	20					6.80	13.60
	106	12	2	666	20					7.06	14.12
	107	12	2	693	20					7.33	14.66
	108	12	2	722	20					7.62	15.24
	109	12	2	754	20					7.94	15.88
	110	12	2	787	20					8.27	16.54
	111	12	2	823	20					8.63	17.26
	112	12	2	862	20					9.02	18.04
	113	12	2	900	20					9.43	18.86
	114	12	2	939	20					9.82	19.64
	115	12	2	982	20					10.24	20.48
	116	12	2	993	20					10.33	8.66
	117	12	2	996	20					10.36	8.72
	118	12	2	999	20					10.39	8.78
	119	12	2	1004	20					10.44	8.88
	120	12	2	1009	20					10.49	8.98
	121	12	2	1014	20					10.54	9.02
	122	12	2	1021	20					10.61	9.22
	123	12	2	1028	20					10.68	9.36
	124	12	2	1036	20					10.76	9.52
	125	12	2	1045	20					10.85	9.70
	126	12	2	1055	20					10.95	9.90
	127	12	2	1066	20					11.06	10.12
	128	12	2	1078	20					11.18	10.36
	129	12	2	1090	20					11.30	10.60
	130	12	2	1104	20					11.44	10.88
	131	12	2	1119	20					11.59	11.18
	132	12	2	1134	20					11.74	11.48
	133	12	2	1150	20					11.90	11.80
	134	12	2	1166	20					12.08	12.18
	135	12	2	1182	20					12.26	12.56
	136	12	2	1200	20					12.48	12.98
	137	12	2	1218	20					12.71	13.42
	138	12	2	1234	20					12.94	13.88
	139	12	2	1250	20					13.18	14.38
	140	12	2	1265	20					13.43	14.90
	141	12	2	1280	20					13.68	15.48
	142	12	2	1295	20					13.94	16.10
	143	12	2	1308	20					14.21	16.76
	144	12	2	1320	20					14.48	17.46
	145	12	2	1332	20					14.76	18.24
	146	12	2	1345	20					15.05	19.08
	147	12	2	1355	20					15.35	19.98
	148	12	2	1365	20					15.66	20.94
	149	12	2	1375	20					15.98	21.96
	150	12	2	1385	20					16.31	23.04
	151	12	2	1395	20					16.65	24.18
	152	12	2	1405	20					17.00	25.38
	153	12	2	1414	20					17.36	26.64
	154	12	2	1424	20					17.73	27.96
	155	12	2	1434	20					18.11	29.34
	156	12	2	1442	20					18.50	30.78
	157	12	2	1450	20					18.90	32.28
	158	12	2	1458	20					19.31	33.84
	159	12	2	1465	20					19.73	35.46
	160	12	2	1471	20					20.16	37.14
	161	12	2	1478	20					20.60	38.88
	162	12	2	1484	20					21.05	40.68
	163	12	2	1490	20					21.51	42.54
	164	12	2	1495	20					21.98	44.46
	165	12	2	1500	20					22.46	46.44
	166	12	2	1505	20					22.94	48.48
	167	12	2	1510	20					23.43	50.58
	168	12	2	1514	20					23.93	52.74
	169	12	2	1518	20					24.44	54.96
	170	12	2	1522	20					24.96	57.24
	171	12	2	1525	20					25.49	59.58
	172	12	2	1528	20					26.03	61.98
	173	12	2	1531	20					26.58	64.44
	174	12	2	1534	20					27.14	66.96
	175	12	2	1537	20					27.71	69.54
	176	12	2	1540	20					28.29	72.18
	177	12	2	1543	20					28.88	74.88
	178	12	2	1545	20					29.48	77.64
	179	12	2	1548	20					30.09	80.46
	180	12	2	1550	20					30.71	83.34
	181	12	2	1552	20					31.34	86.28
	182	12	2	1554	20					31.98	89.28
	183	12	2	1556	20					32.63	92.34
	184	12	2	1558	20					33.29	95.46
	185	12	2	1560	20					33.96	98.64
	186	12	2	1562	20					34.64	101.88
	187	12	2	1564	20					35.33	105.18
	76	12	38	193	20					2.85	108.30
	78'	12	40	193	20					2.85	114.00