

ARMATURA PALO 1200 - L=22,0 m
PILA P09,P10, P19 CARR DX
SCALA 1:50

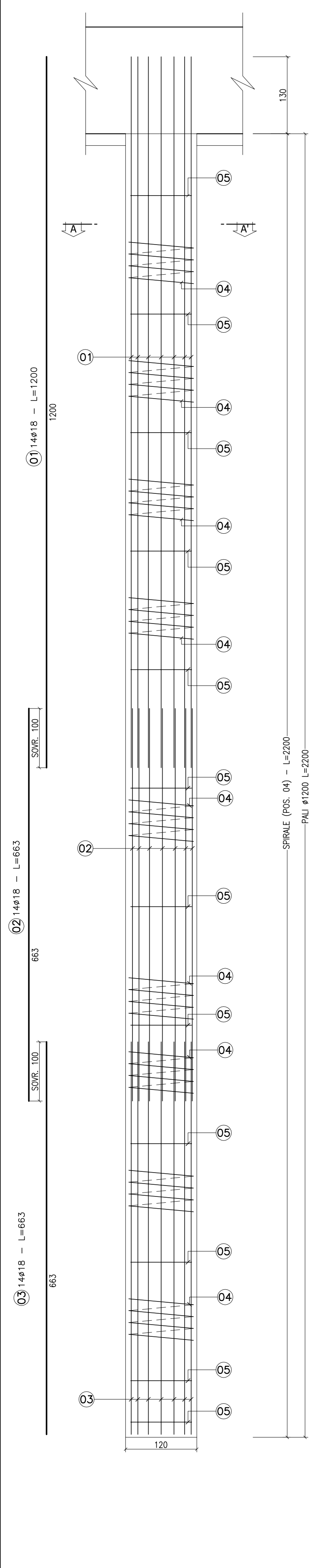

ARMATURA PALO 1200 - L=24,0 m
PILA P01,P09,P10,P18 CARR SX ; PILA P07,P08,P13,P18 CARR DX
SCALA 1:50

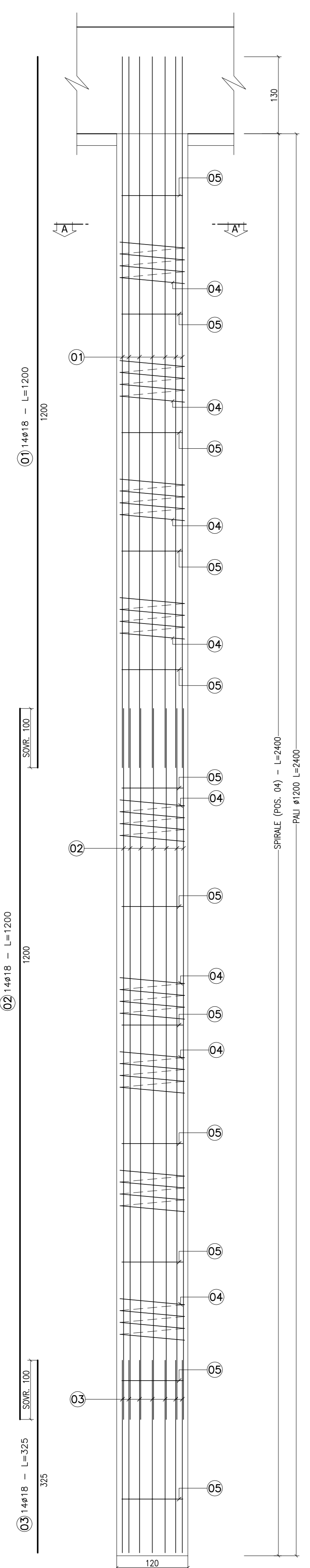

ARMATURA PALO 1200 - L=25,0 m
PILA P11,P12,P17 CARR SX ; PILA P01,P11,P12,P14 CARR DX
SCALA 1:50

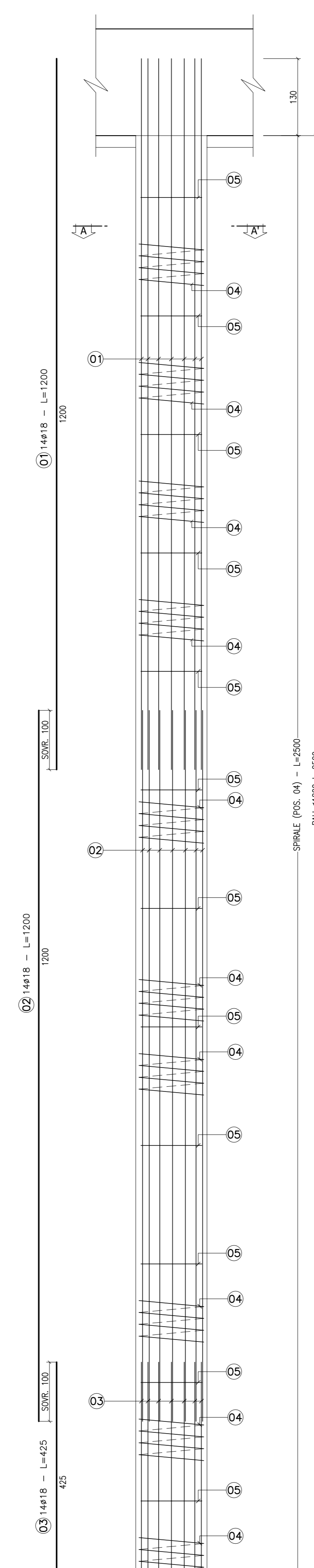

ARMATURA PALO 1200 - L=26,0 m
PILA P02,P07,P13 CARR SX ; PILA P02 CARR DX
SCALA 1:50

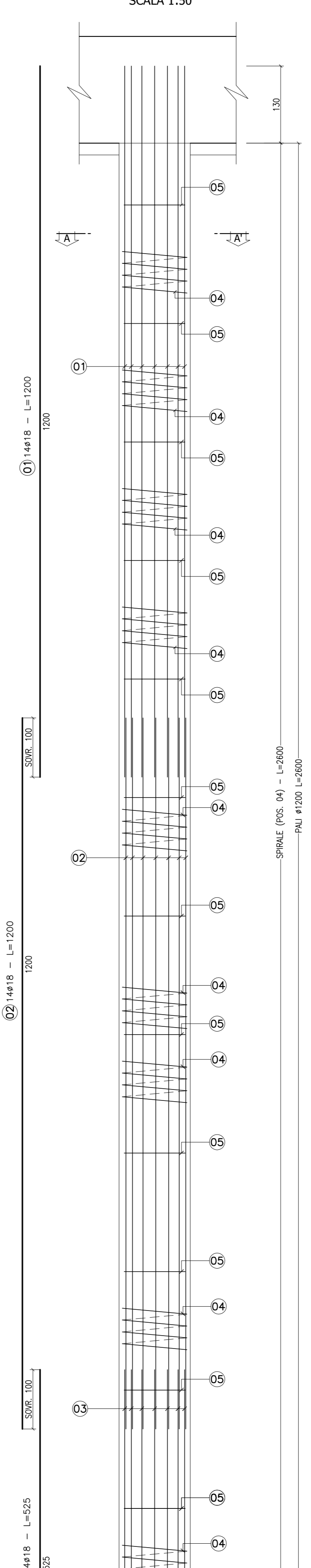

ARMATURA PALO 1200 - L=27,0 m
PILA P03,P14,P15,P16 CARR SX ; PILA P06 CARR DX
SCALA 1:50

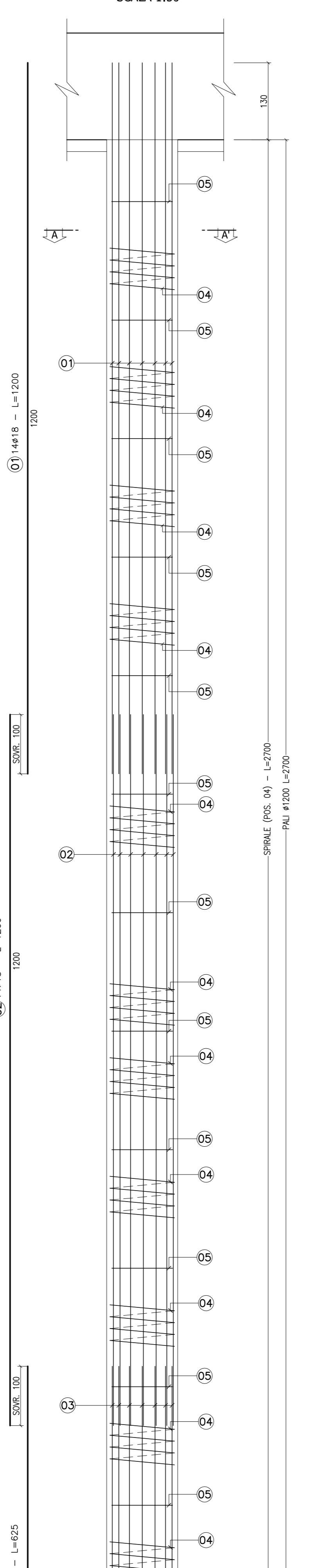

ARMATURA PALO 1200 - L=28,0 m
PILA P04,P05,P06,P08 CARR SX ; PILA P03,P04,P05,P15,P16,P17 CARR DX
SCALA 1:50

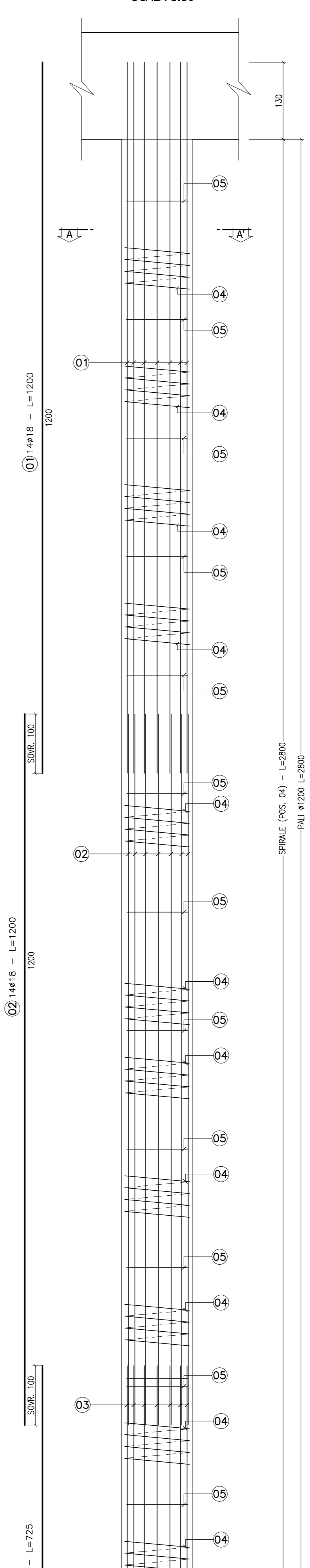

SEZIONE A-A'
ARMATURA
SCALA 1:20

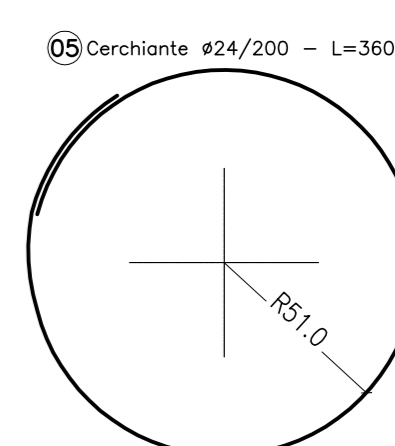
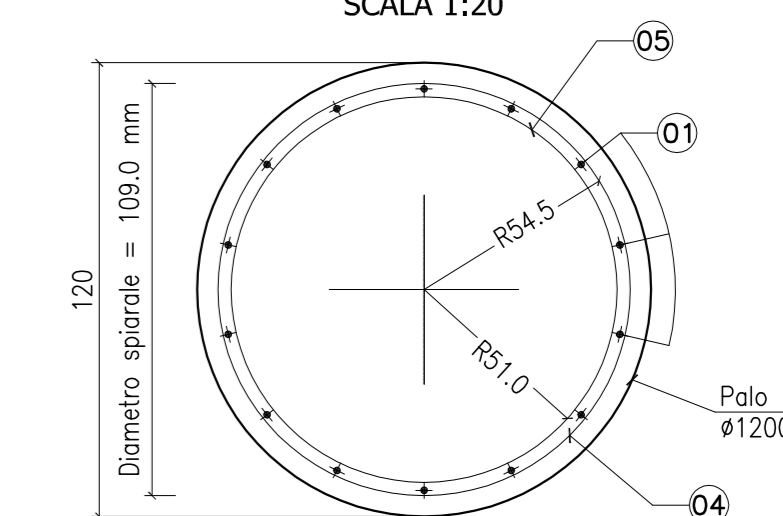

04 Spirale #10/30 - L=1200

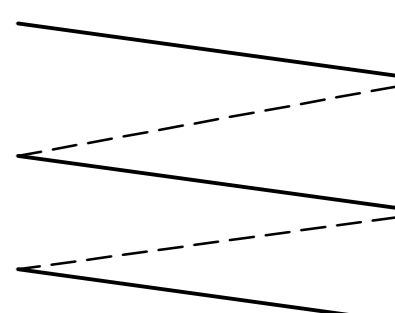

Sovrap. spirali L=70 cm

SEZIONE A-A'
ARMATURA
SCALA 1:20

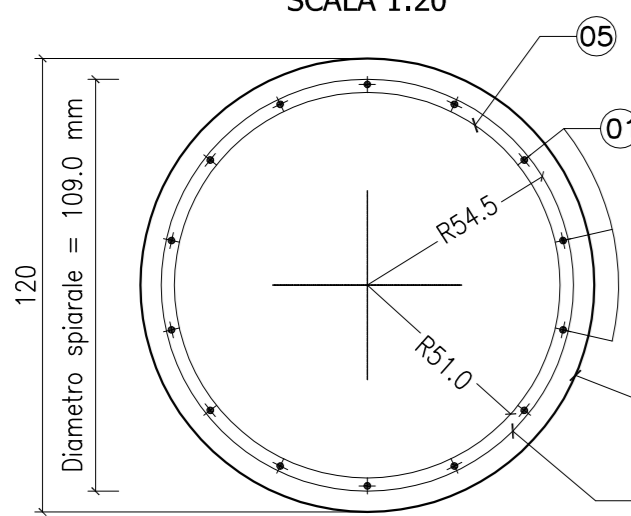

05 Cerchiate #24/200 - L=360

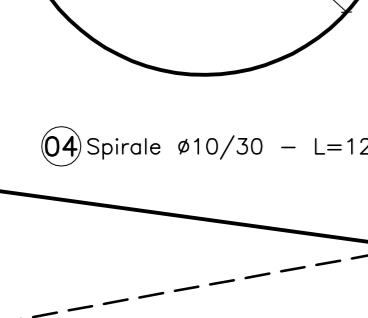
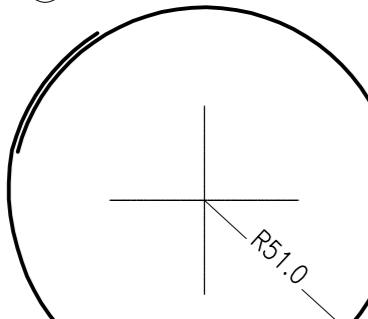

Sovrap. spirali L=70 cm

SEZIONE A-A'
ARMATURA
SCALA 1:20

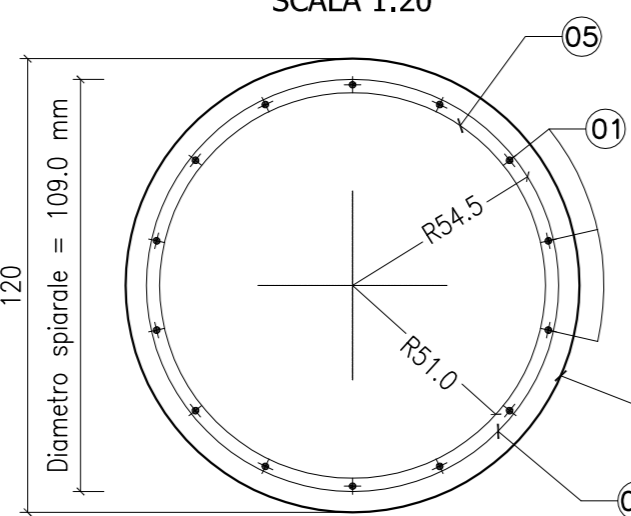

05 Cerchiate #24/200 - L=360

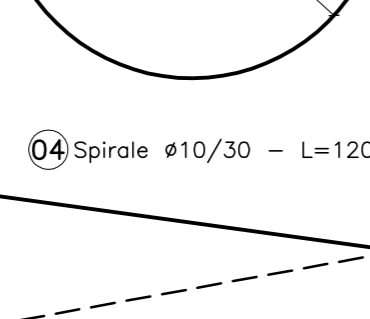
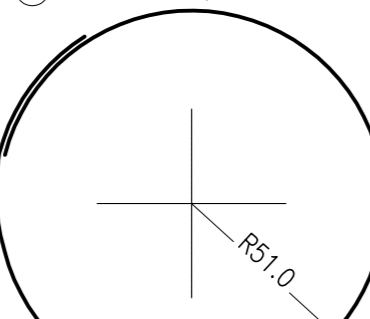

Sovrap. spirali L=70 cm

SEZIONE A-A'
ARMATURA
SCALA 1:20

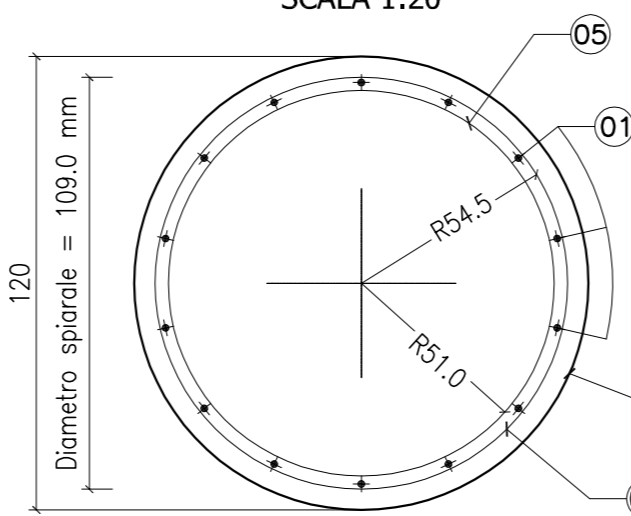

05 Cerchiate #24/200 - L=360

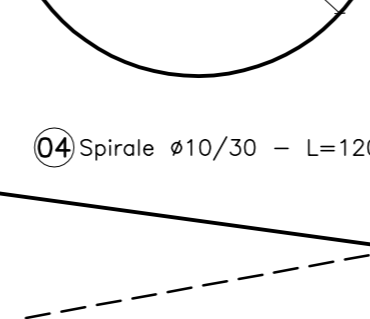
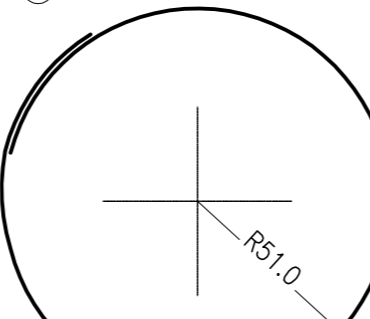

Sovrap. spirali L=70 cm

SEZIONE A-A'
ARMATURA
SCALA 1:20

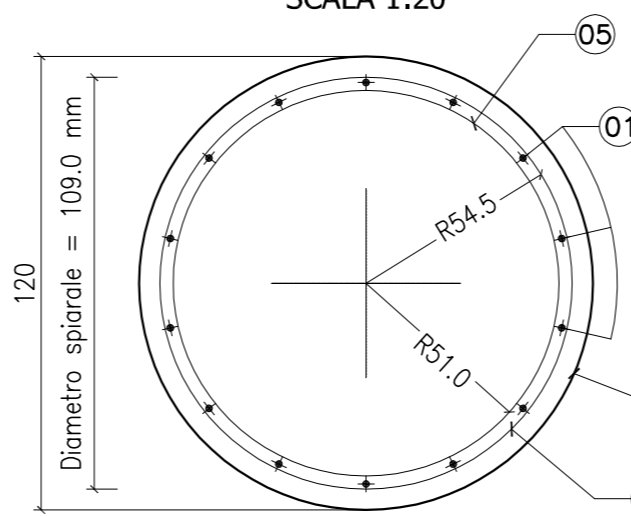

05 Cerchiate #24/200 - L=360

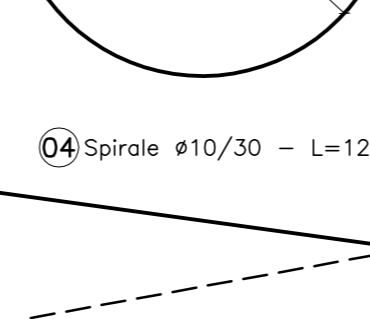
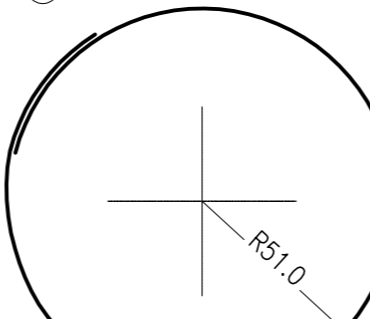

Sovrap. spirali L=70 cm

SEZIONE A-A'
ARMATURA
SCALA 1:20

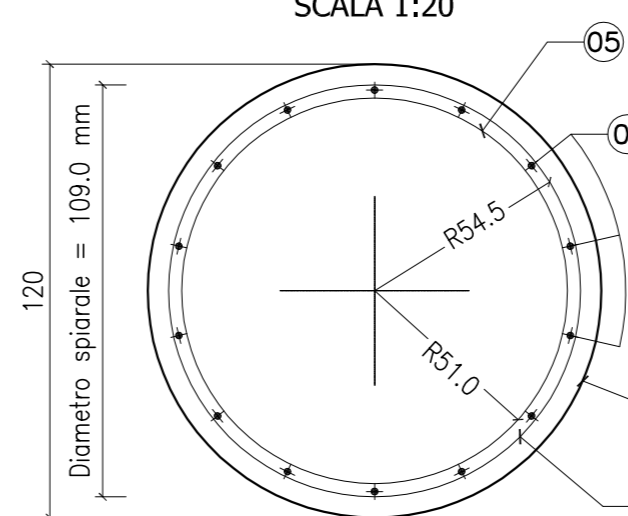

05 Cerchiate #24/200 - L=360

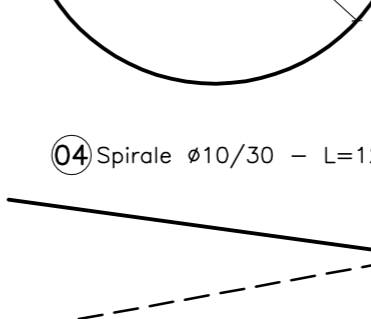
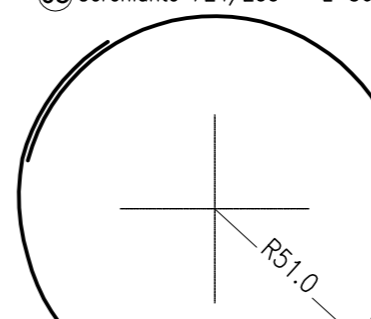

Sovrap. spirali L=70 cm



PA 12/09
CORRIDOIO PLURIMODALE TIRRENICO - NORD EUROPA
ITINERARIO AGRIGENTO - CALTANISSETTA - A19
S.S. N° 640 "DI PORTO EMPEDOCLE"
AMMODERNAMENTO E ADEGUAMENTO ALLA CAT. B DEL D.M. 5.11.2001
Dal km 44+000 allo svincolo con l'A19

PROGETTO ESECUTIVO



OPERE D'ARTE MAGGIORI
VIADOTTI
Viadotto Arenella III
Armatura pali di fondazione Pile

Codice Unico Progetto (CUP) : F91B0900070001

Codice Elaborato:
PA12_09 - E 1 5 7 V I 2 1 4 V I 1 4 8 B X 0 8 0 C VARIE

REV.	DATA	DESCRIZIONE	REDATTO	VERIFICATO	APPROVATO	AUTORIZZATO
C	Settembre 2011	Aggiornamento Progettuale	T. FASOLO	F. NIGRELLI	M. LITI	P. PAGLINI
B	Luglio 2011	Revisione a seguito di incontri con il Committente	T. FASOLO	F. NIGRELLI	M. LITI	P. PAGLINI
A	Aprile 2011	EMISSIONE	T. FASOLO	F. NIGRELLI	M. LITI	P. PAGLINI

Responsabile del procedimento: Ing. MAURIZIO ARAMIN

