

BANCHINA DI RIVA
SEZIONE A - A (SCALA 1:200)

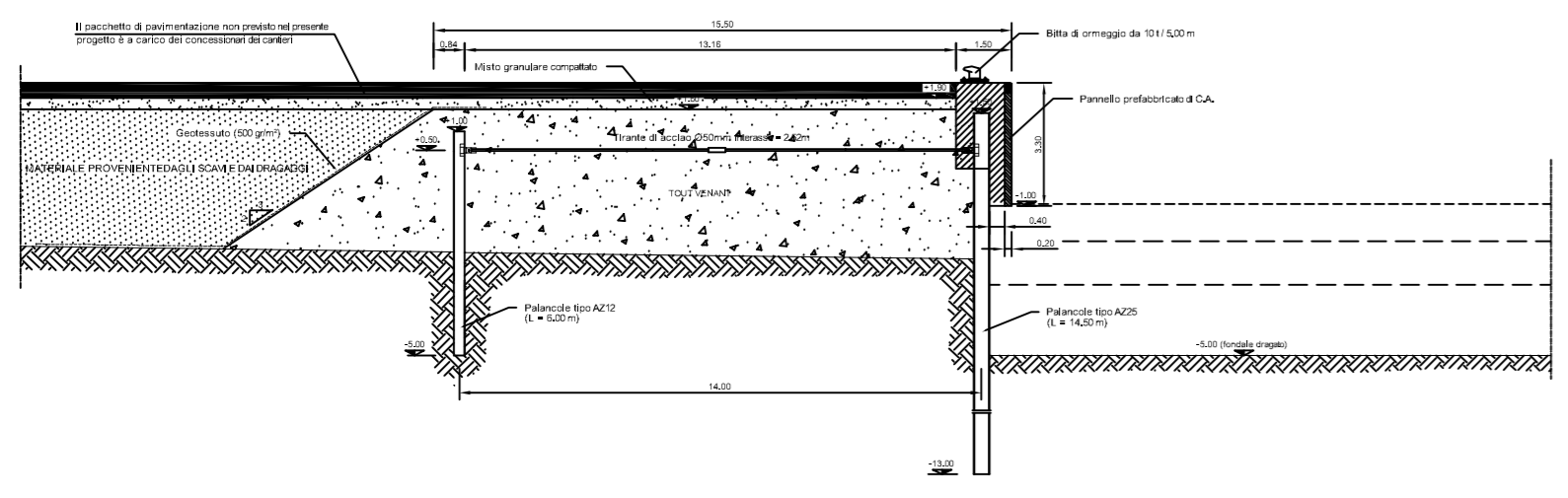

MOLO DI PROTEZIONE OVEST
SEZIONE E-E (SCALA 1:200)

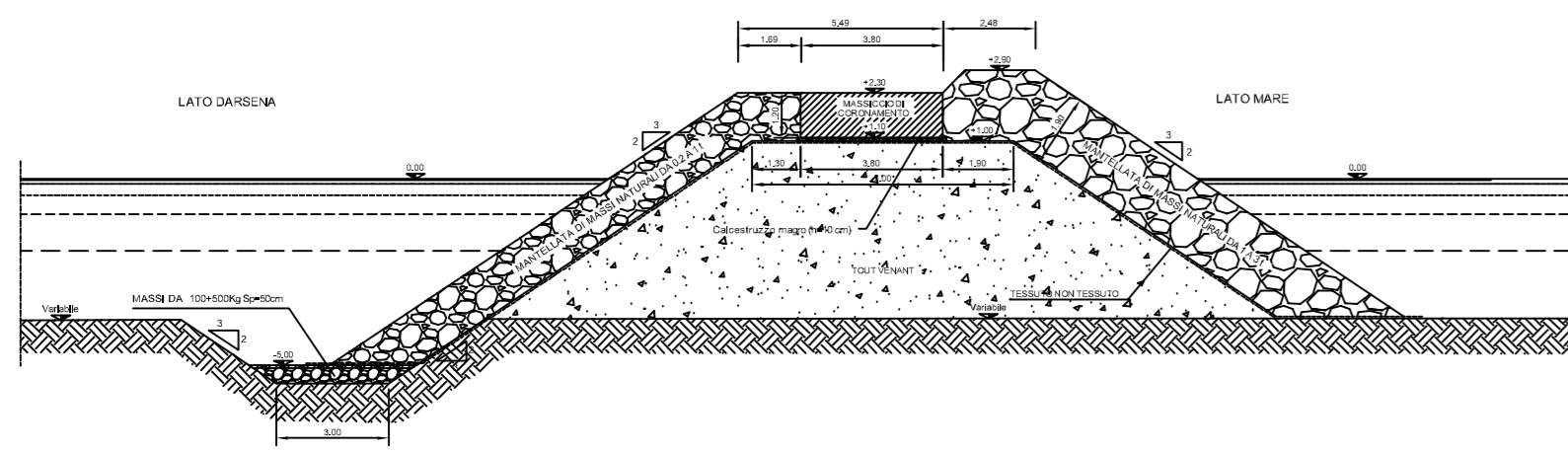

SEZIONE C - C
(SCALA 1:200)

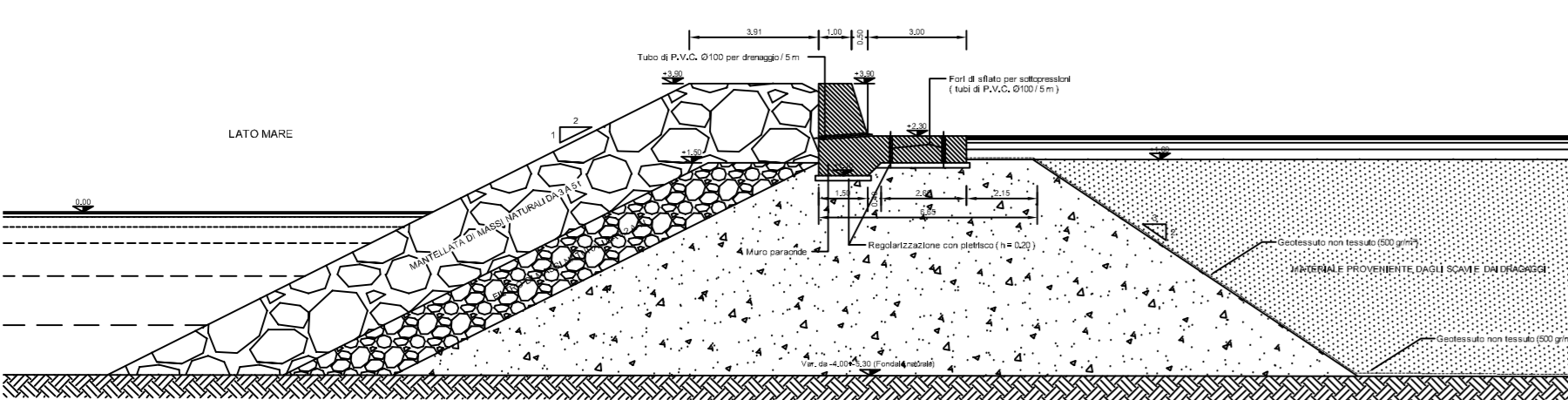

SEZIONE B-B (Fase 2)
(SCALA 1:200)

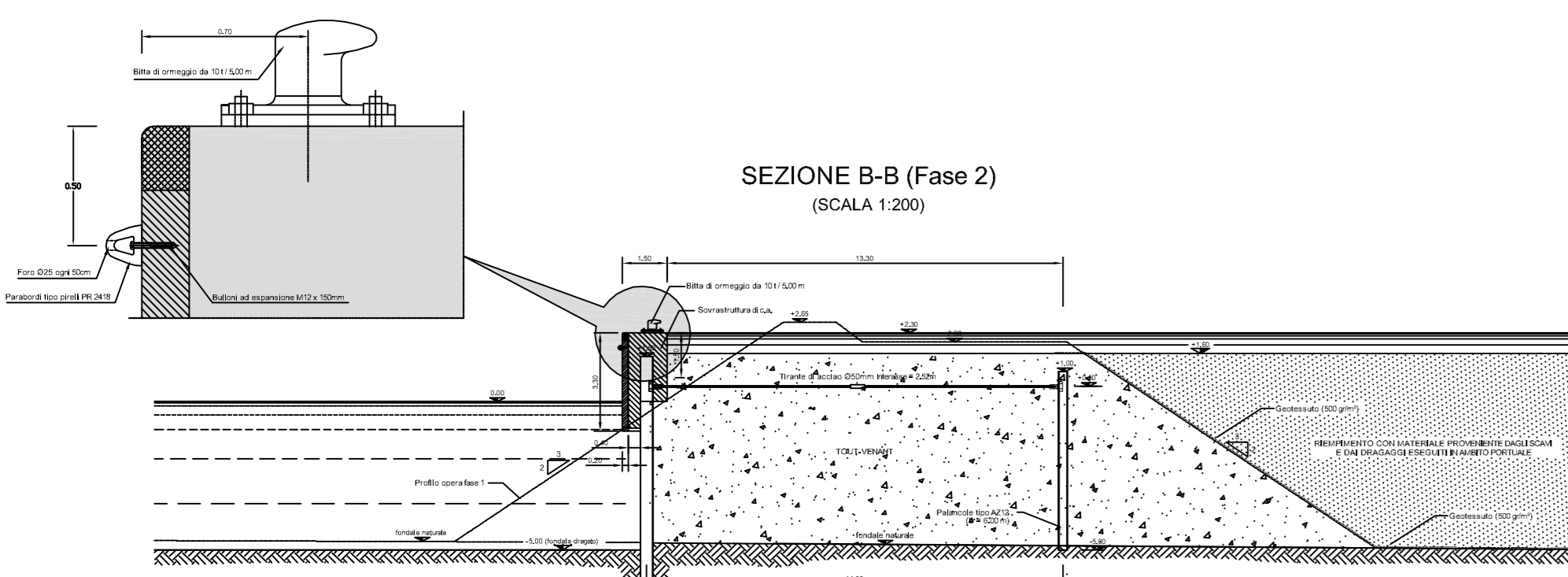

PENNELLO DI PROTEZIONE VARCO DI TRANSITO
SEZIONE D - D (SCALA 1:200)

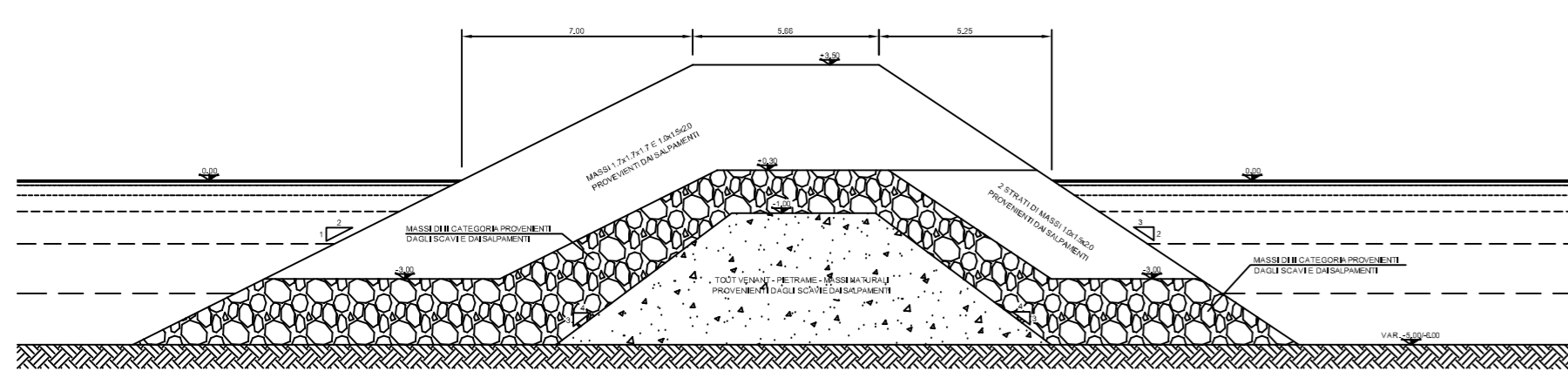

STRALCIO PLANIMETRICO

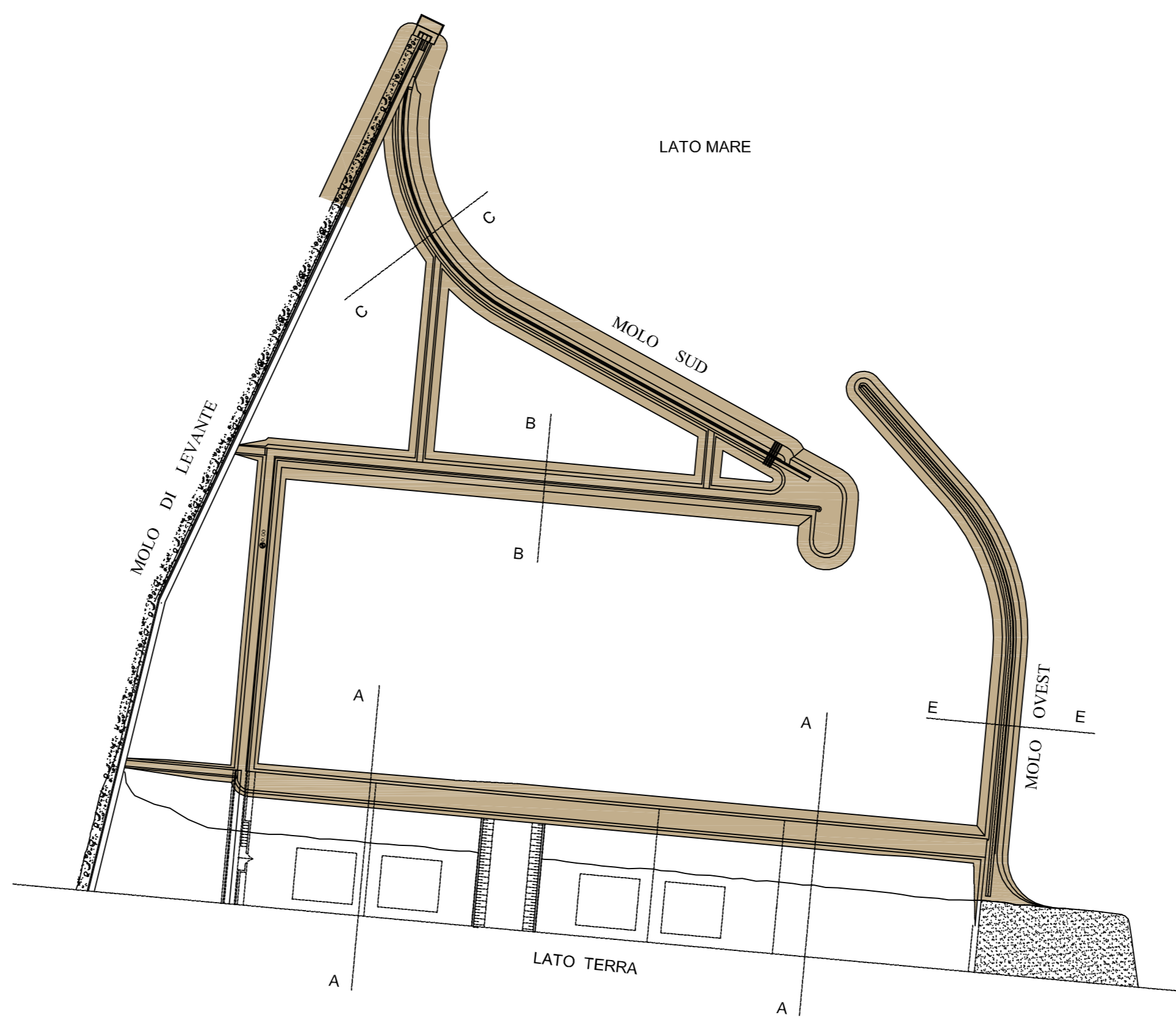
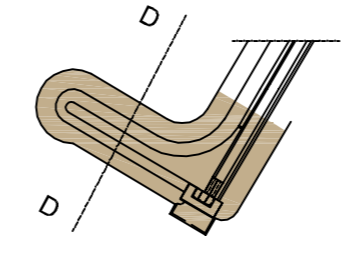

PIANTA CANALE INTERNO
(SCALA 1:1.500)

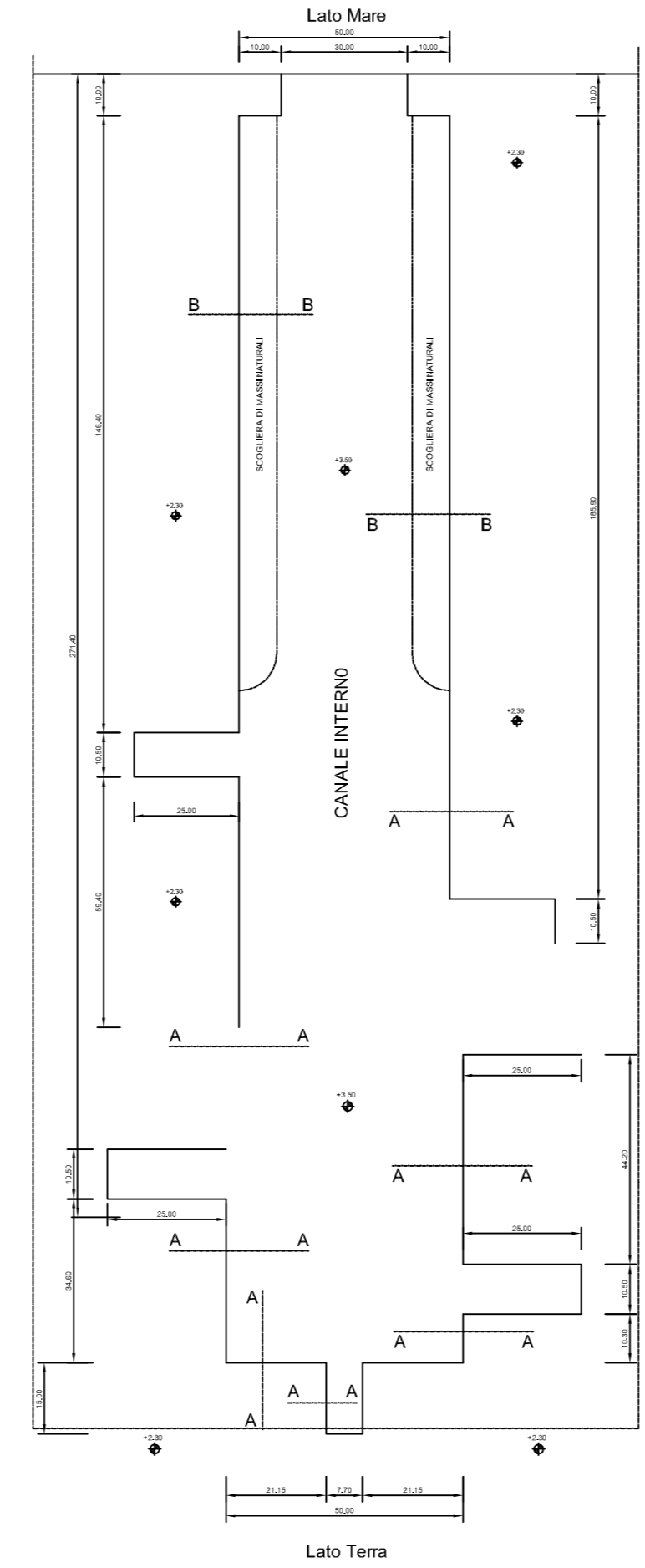

BANCHINA CANALE INTERNO
SEZIONE A - A (SCALA 1:200)

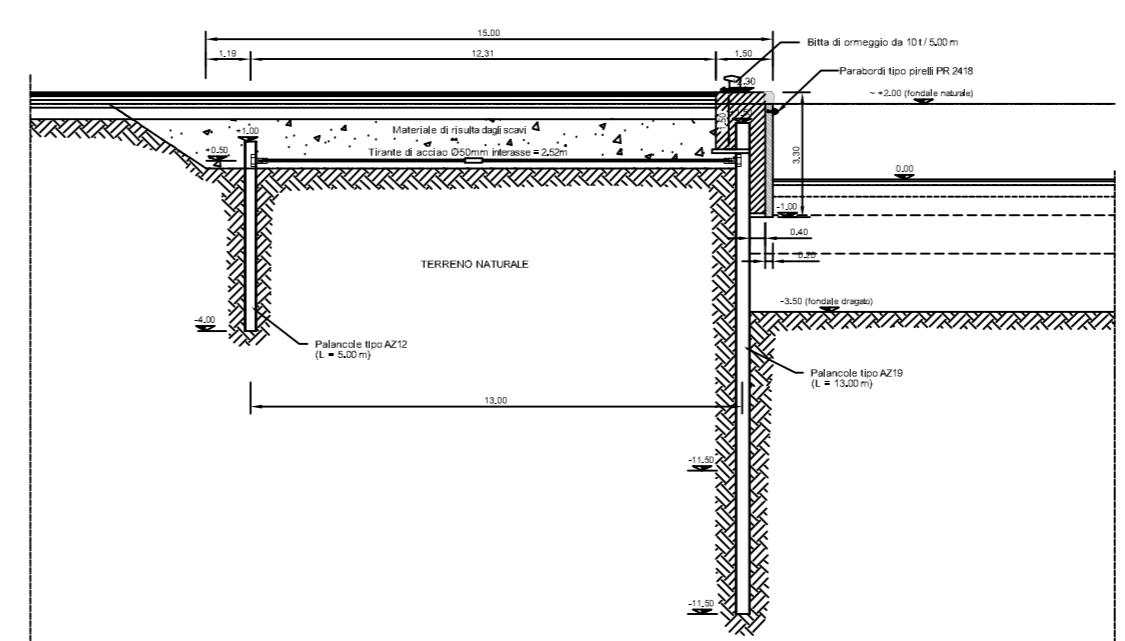

SEZIONE SCOGLIERA CANALE INTERNO
SEZIONE B-B (SCALA 1:200)

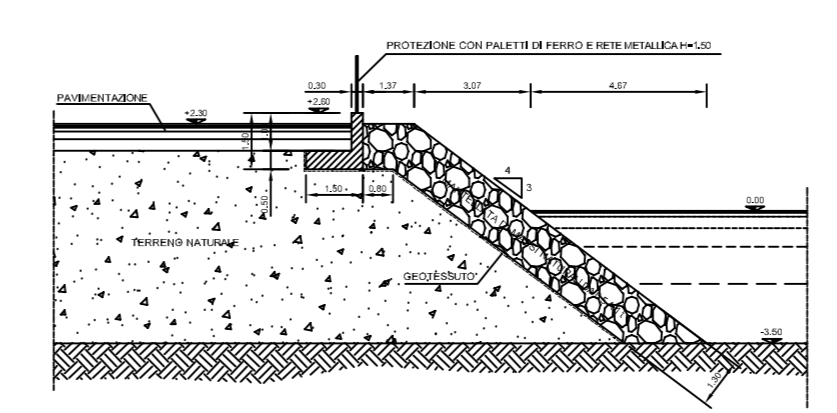

DETTAGLIO PAVIMENTAZIONE
SEZIONE TIPO (SCALA 1:200)

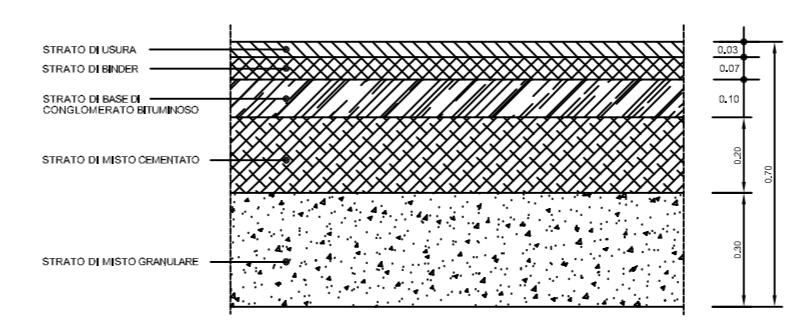

AUTORITA' PORTUALE DI CAGLIARI

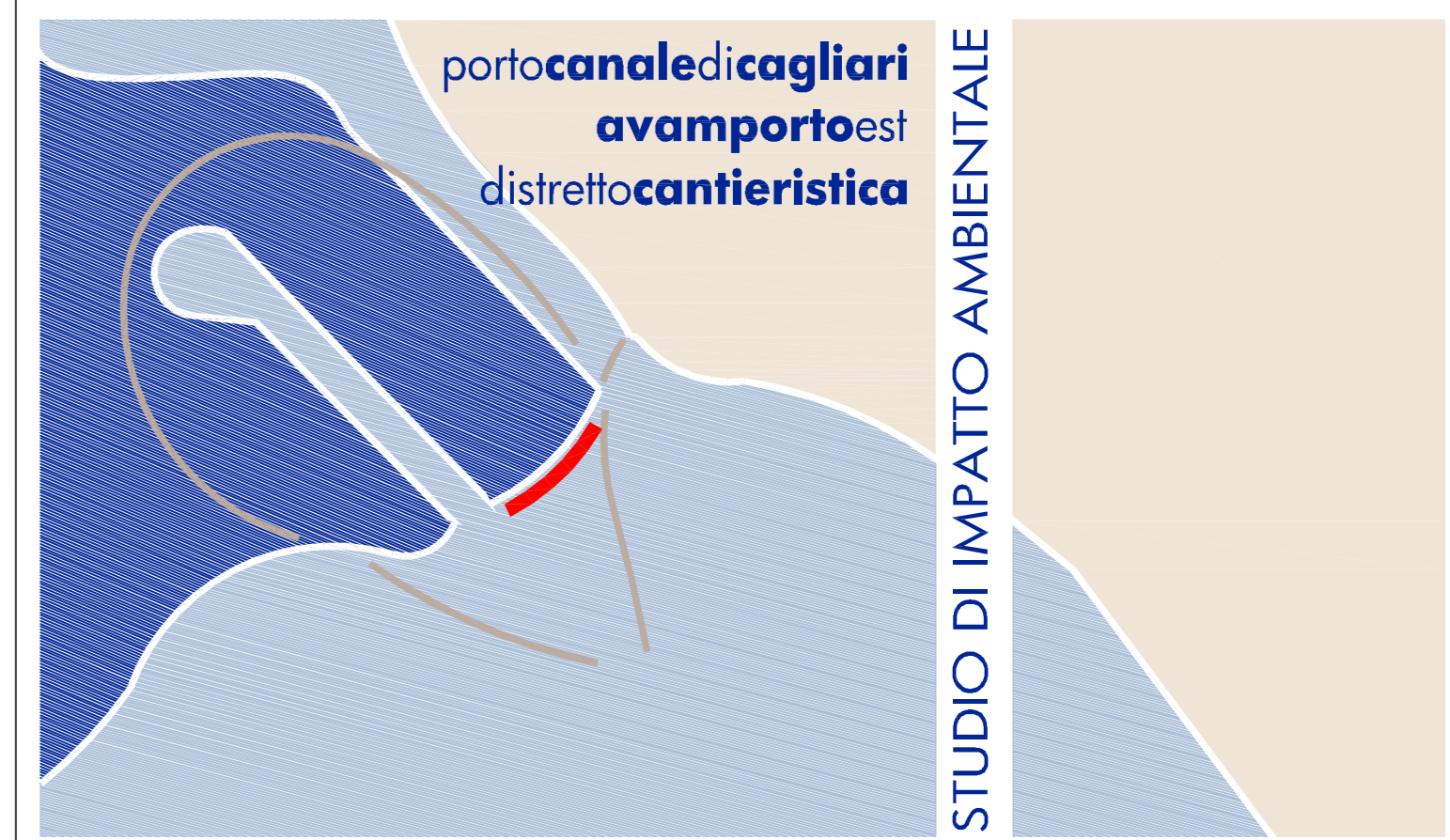

portocanaledicagliari
avamportoest
distrettocantieristica

STUDIO DI IMPATTO AMBIENTALE

QUADRO DI RIFERIMENTO PROGETTUALE
SEZIONI TIPO

Data: Gennaio 2012

CADC QPGT 04

Scala: VARIE



Ing. Francesco Ventura
14660

