

ARMATURA SOLETTA DI FONDAZIONE STRADALE
scala 1:200





TABELLA FERRI						
POS.	Num.	Ø [mm]	Lunghezza [cm]	TOTALE [m]	PESO [kg]	
27a	133	20	1200	1596.00	3935.97	
27b	133	20	1200	1596.00	3935.97	
27c	133	20	340	452.20	1115.19	
27d	133	20	1200	1596.00	3935.97	
27e	133	20	1200	1596.00	3935.97	
27f	133	20	818	1087.94	2683.02	
27g	133	20	580	771.40	1902.39	
27h	133	20	1200	1596.00	3935.97	
27i	133	20	1200	1596.00	3935.97	
28a	133	20	340	452.20	1115.19	
28b	133	20	1200	1596.00	3935.97	
28c	133	20	1200	1596.00	3935.97	
28d	133	20	1200	1596.00	3935.97	
28e	133	20	1200	1596.00	3935.97	
28f	133	20	818	1087.94	2683.02	
28g	133	20	1200	1596.00	3935.97	
28h	133	20	1200	1596.00	3935.97	
28i	133	20	580	771.40	1902.39	
29	3300	22	160	5280.00	15755.74	
30a	413	22	1200	4956.00	14788.91	
30b	413	22	605	2498.65	7456.07	
30c	413	22	1200	4956.00	14788.91	
30d	413	22	480	1982.40	5915.56	
31a	413	22	1200	4956.00	14788.91	
31b	413	22	605	2498.65	7456.07	
31c	413	22	1200	4956.00	14788.91	
31d	413	22	480	1982.40	5915.56	
32	1660	20	63	1045.80	2579.10	
33	1485	12	0	0.00	13632.30	
				Totale Kg =	176498.95	

ARMATURA SOLETTA DI FONDAZIONE STRADALE - RIVESTIMENTO DIAFRAMMI Sezione D-D
scala 1:100

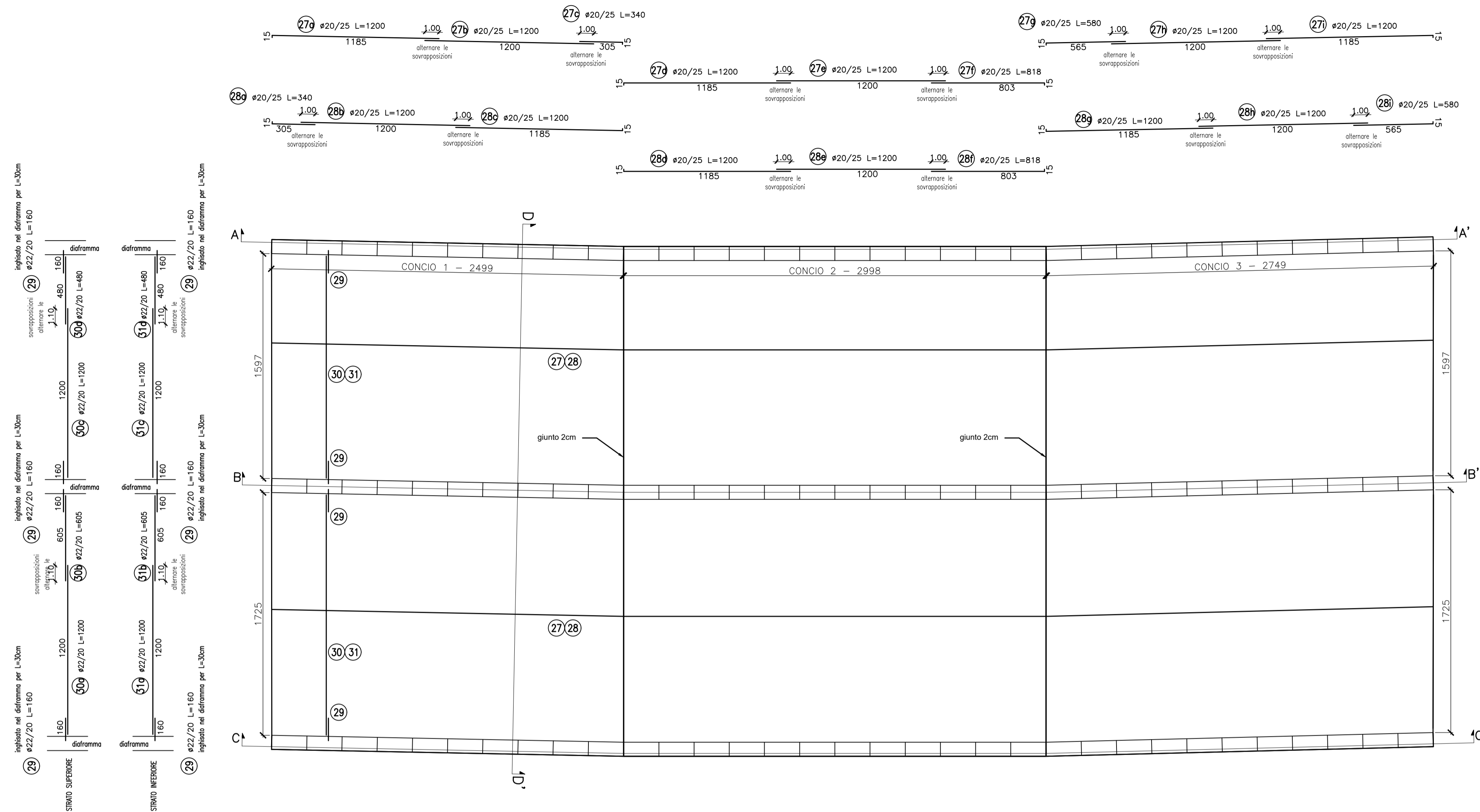
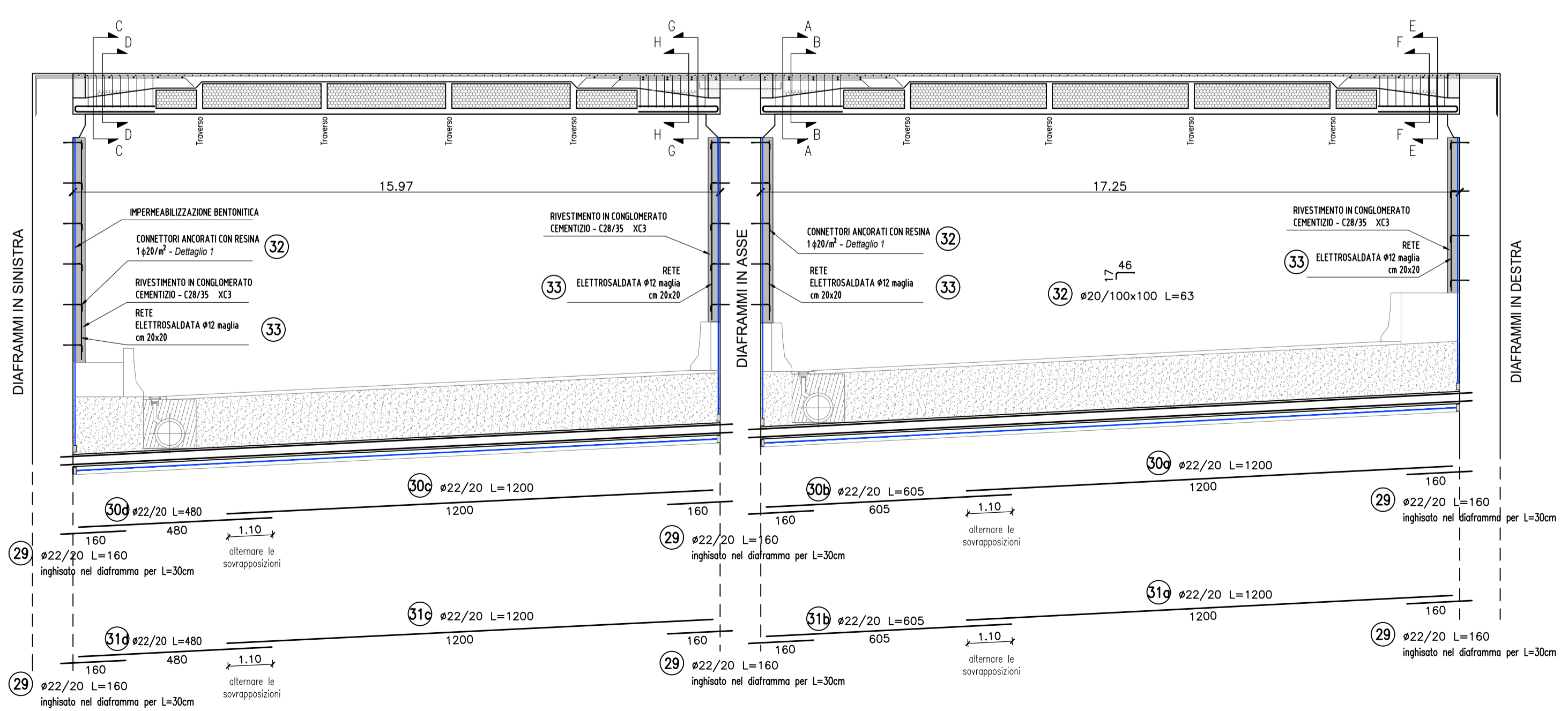
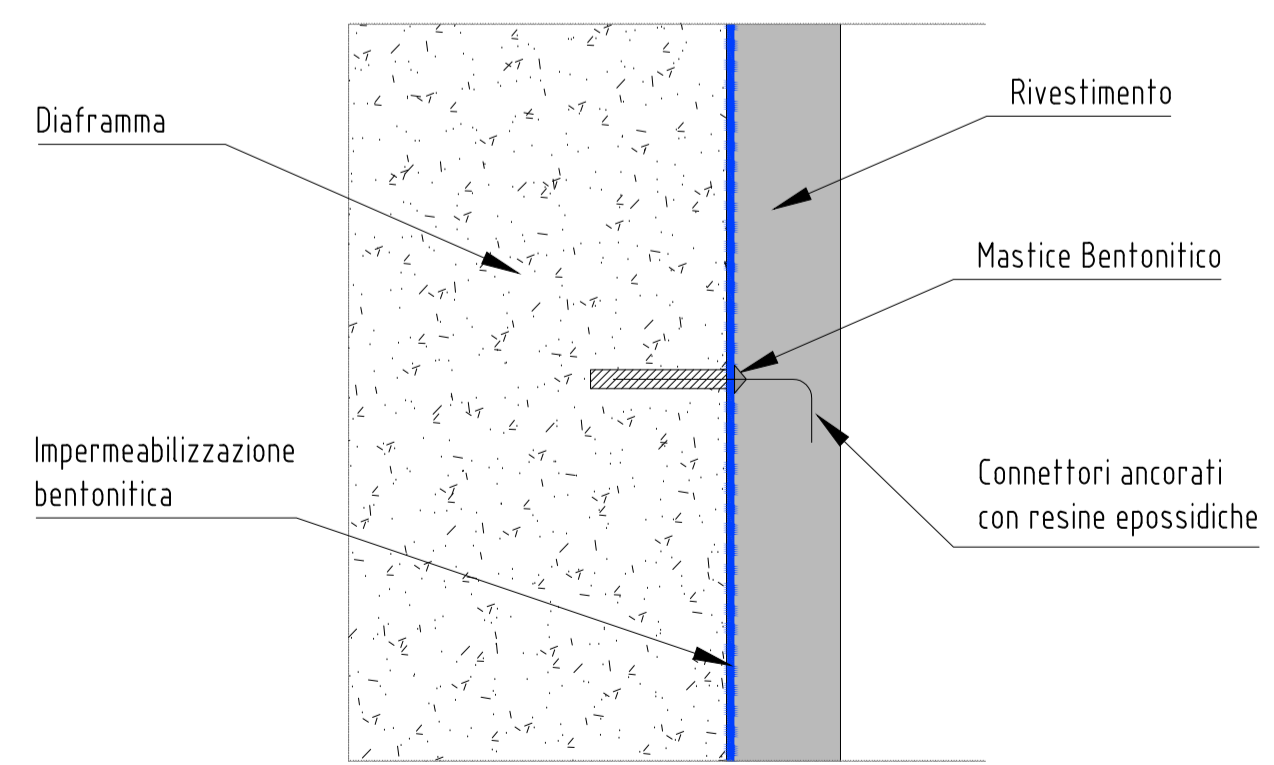

FERRI DI ANCORAGGIO
DETTAGLIO 1
scala 1:20













ANAS S.p.A.
Direzione Progettazione e Realizzazione Lavori

NUOVA S.S. 341 "GALLARATESE" - TRATTO DA SAMARATE A CONFINE
CON LA PROVINCIA DI NOVARA - TRATTO NORD

**STRALCIO FUNZIONALE DAL KM 6+500 (SVINCOLO S.S. 336 NORD)
AL KM 8+844 (SVINCOLO AUTOSTRADA A8)
"BRETTELLA DI GALLARATE"**

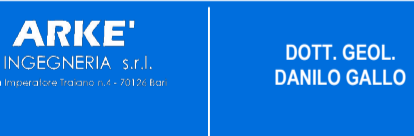
PROGETTO ESECUTIVO

 Ing. Valerio Bajetti Codice Reg. Ing. 6 Rovato (BS) - P.A. 02011	 Ing. Renato Del Prete Codice Reg. Ing. 47 Bari (BA) - P.A. 0303	 Arch. Nicoletta Frattini Codice Reg. Ing. 6 Rovato (BS) - P.A. 02011	 Ing. Gabriele Inceduto Codice Reg. Ing. 6 Rovato (BS) - P.A. 02011
 Ing. Renato Vaira Codice Reg. Ing. 6 Torino (TO) - P.A. 01101	 Prof. Ing. Luigi Monterisi Codice Reg. Ing. 6 Bari (BA) - P.A. 0303	 Ing. Giacchino Argenaro Codice Reg. Ing. 6 Rovato (BS) - P.A. 02011	 Dott. Geol. Danilo Gallo Codice Reg. Ing. 6 Rovato (BS) - P.A. 02011

VISTO: IL RESPONSABILE DEL PROCEDIMENTO:  **ING. RENATO DEL PRETE**

RESPONSABILE INTEGRAZIONE DELLE PRESTAZIONI SPECIALISTICHE:  **ING. VALERIO BAJETTI**

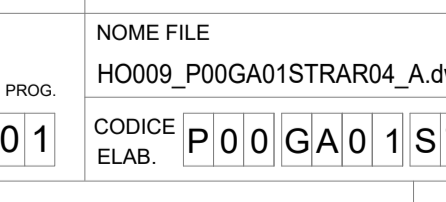
IL PROGETTISTA FIRMATARIO DELLA PRESTAZIONE:  **PROF. ING. LUIGI MONTERISI**

GEOLOGO:  **DOTT. GEOL. DANILLO GALLO**

COORDINATORE DELLA SICUREZZA IN FASE DI PROGETTAZIONE:  **ING. GAETANO RANIERI**

H-PROGETTO STRUTTURALE OPERE PRINCIPALI
HO - GA05 - GALLERIA ARTIFICIALE PROG. 6+840
Armatura Pianta e Sezione - Soletta di fondazione stradale

CODICE PROGETTO		NOME FILE		REVISIONE	SCALA:
PROGETTO	LIV. PROG.	N. PROG.	HO009_P00GA01STRAR04_A.dwg		
M I 5 3 3	E	1 8 0 1	CODICE ELAB.	P 0 0 G A 0 1 S T R A R 0 4	A
D					
C					
B					
A	EMISSIONE		MARZO 2021	PROF. ING. LUIGI MONTERISI	ING. VALERIO BAJETTI
REV.	DESCRIZIONE		DATA	REDDATTO	VERIFICATO
					ING. RENATO DEL PRETE
					APPROVATO