

M Contorno delle previsioni tecniche di Progetto Tecnico "Adeguamento e messa in sicurezza della S.131 - Risoluzione nodi critici 2°stratrico del km 108+300 al km 140+300"

Table with 2 columns: M (Metric) and 1.000 (Description). Contains detailed technical specifications and project requirements for the S.131 road improvement project.

M Contorno delle previsioni tecniche di Progetto Tecnico "Adeguamento e messa in sicurezza della S.131 - Risoluzione nodi critici 2°stratrico del km 108+300 al km 140+300"

Table with 2 columns: M (Metric) and 1.000 (Description). Contains detailed technical specifications and project requirements for the S.131 road improvement project.

S10 - Accesso al Km 140+490



S12 - Accessi dal Km 143+215 al Km 143+900

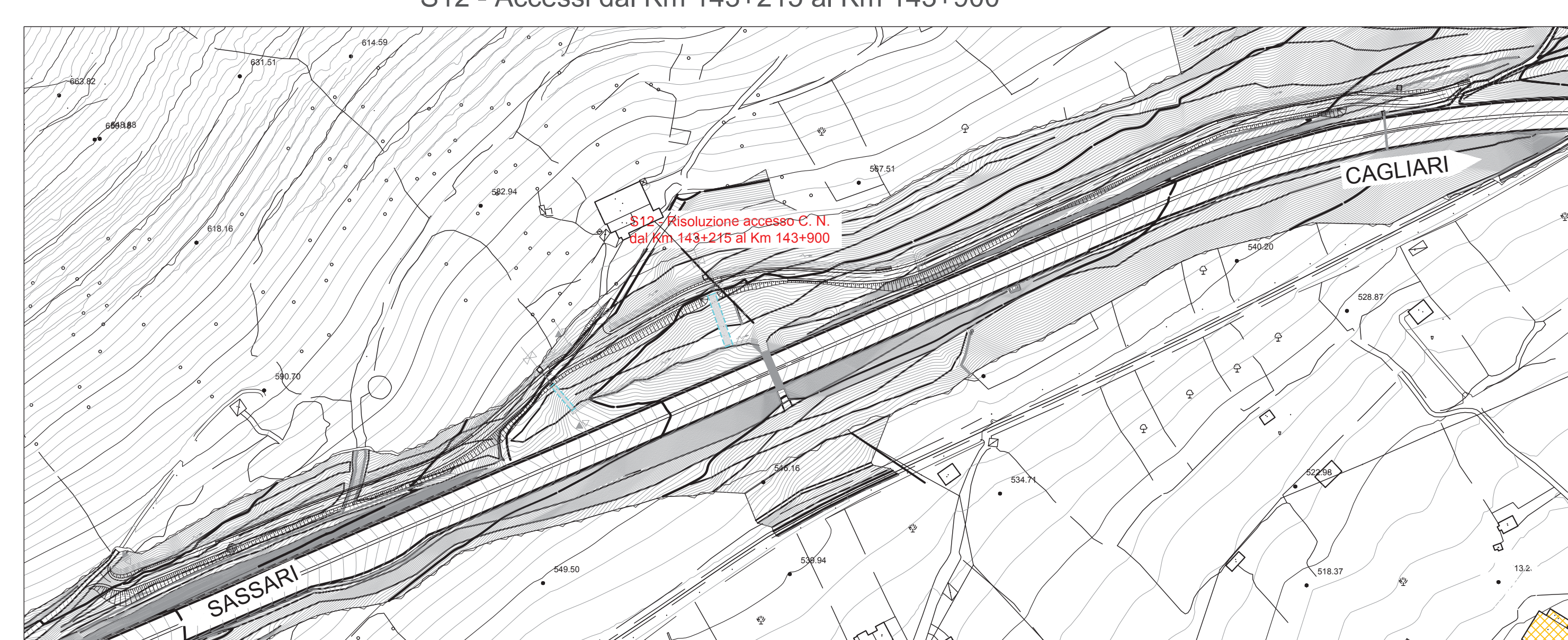

S11 - Accesso al Km 141+235

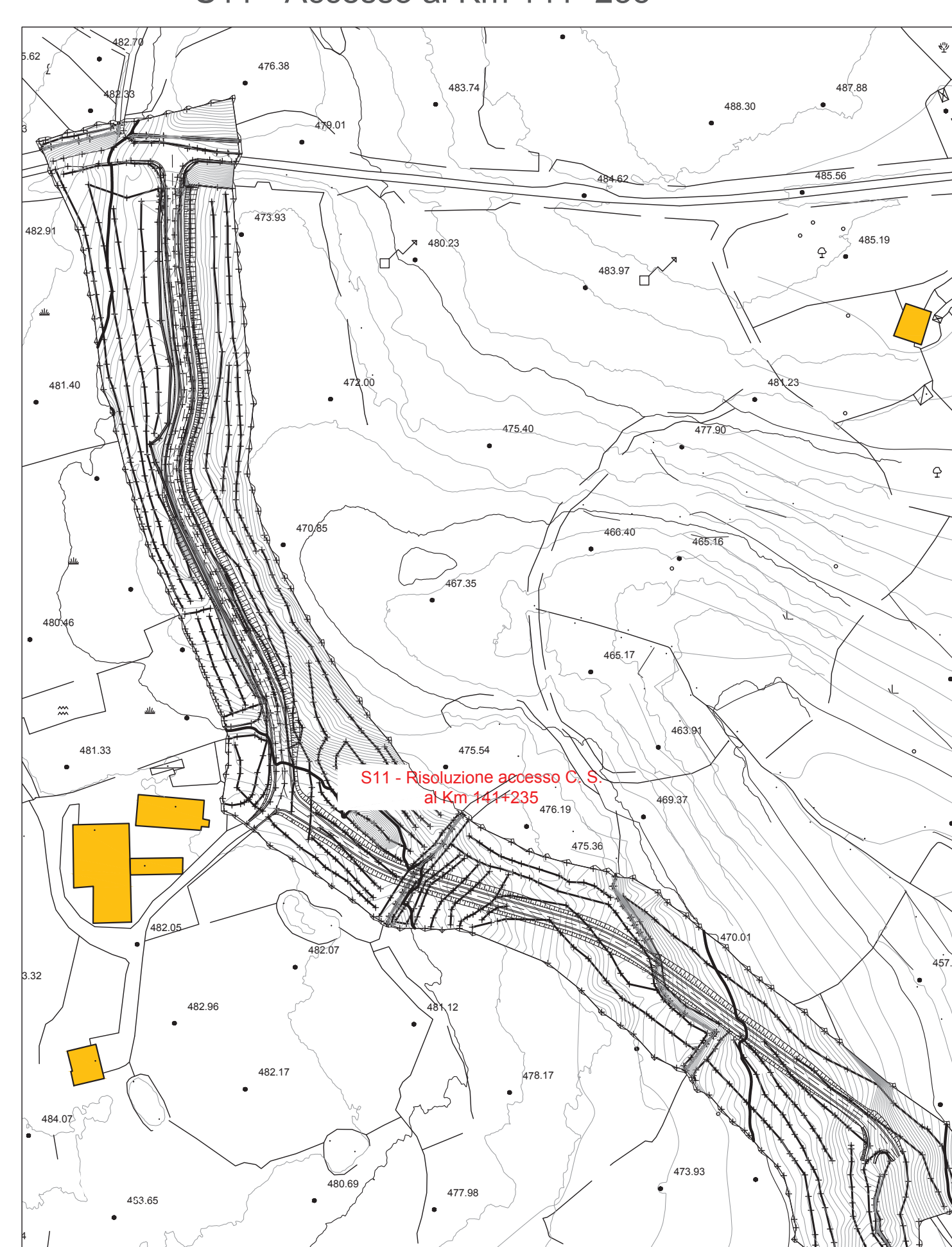

S14 - Accesso al Km 146+780

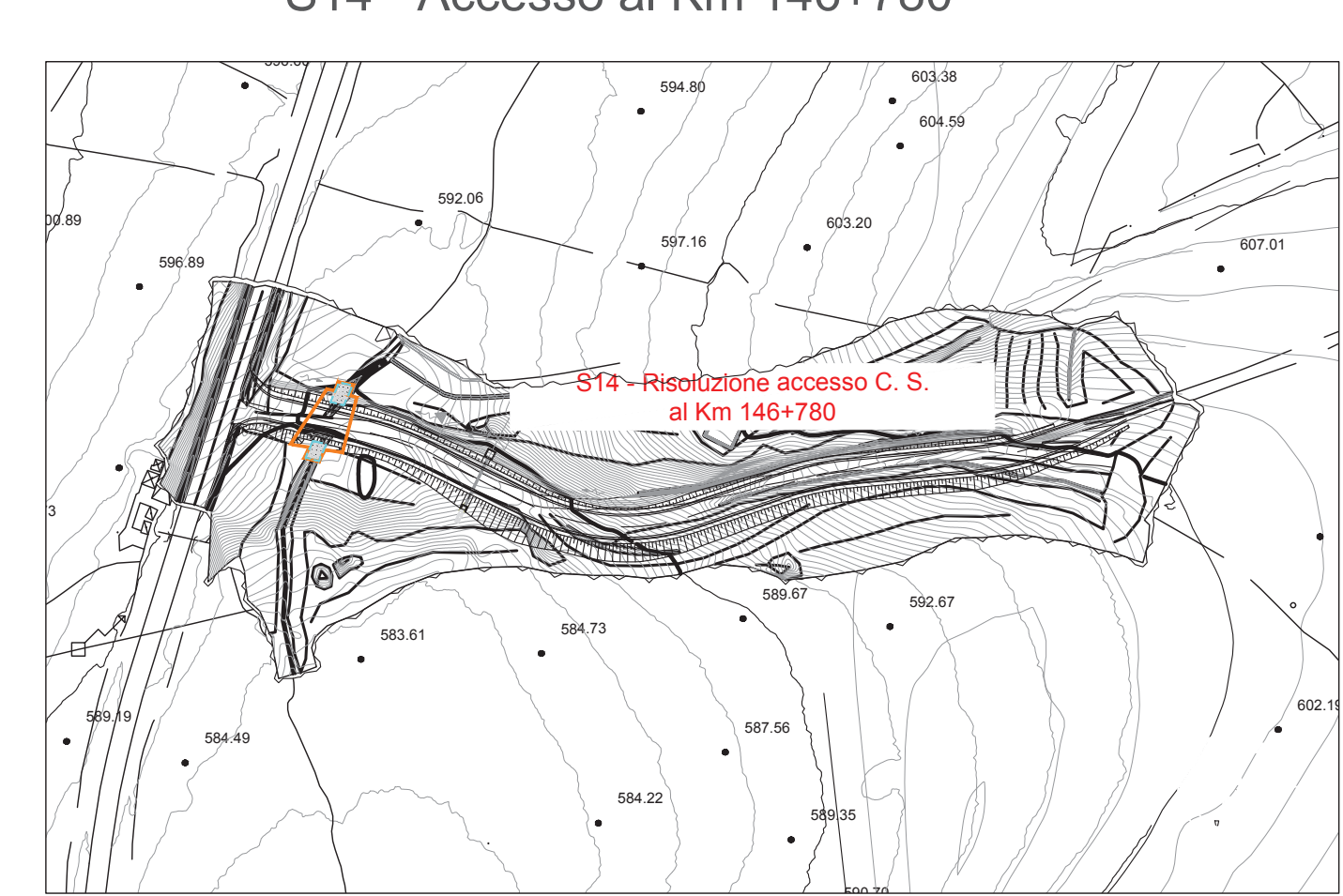

S13 - Accessi dal Km 144+760 al Km 145+950

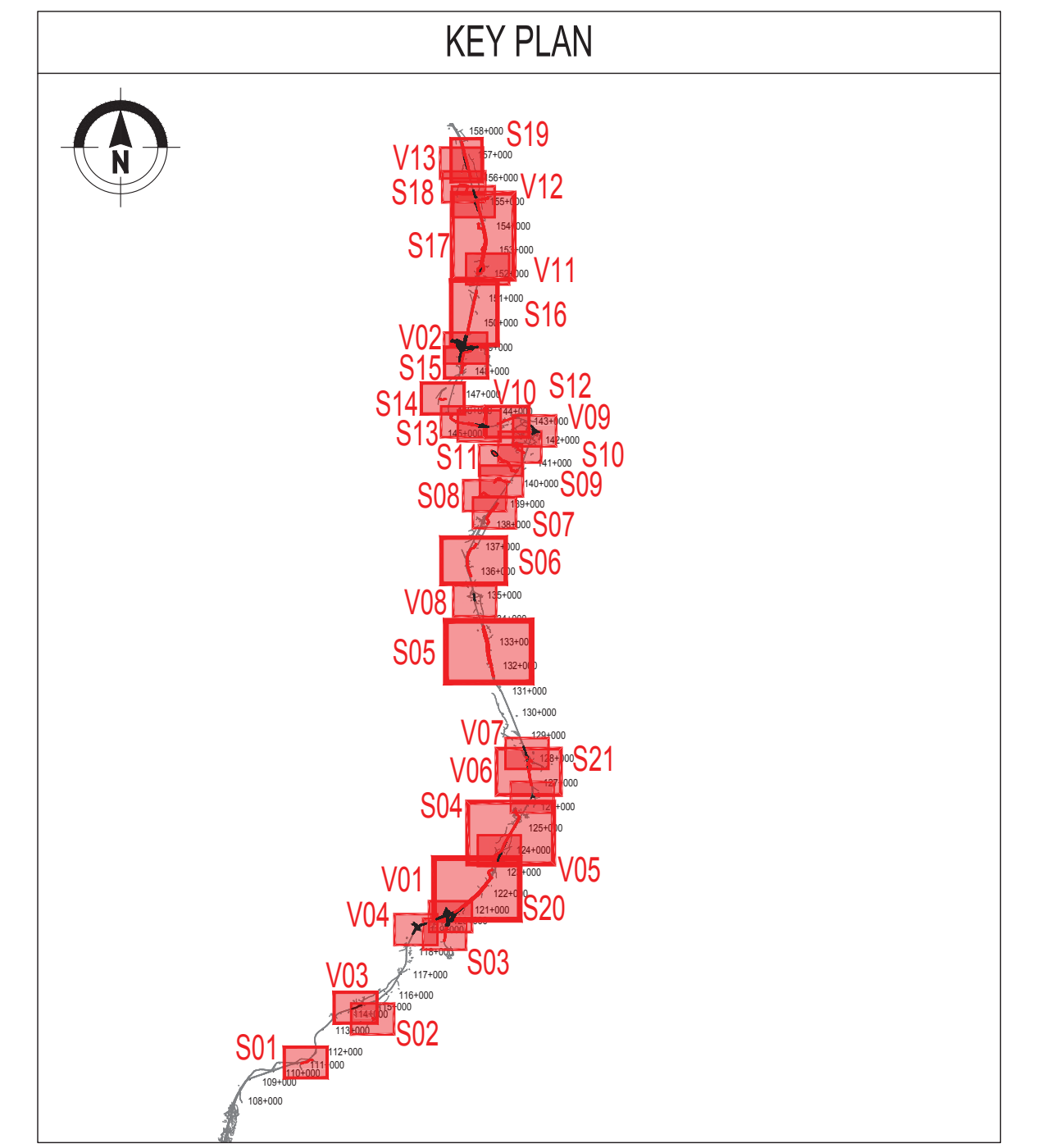
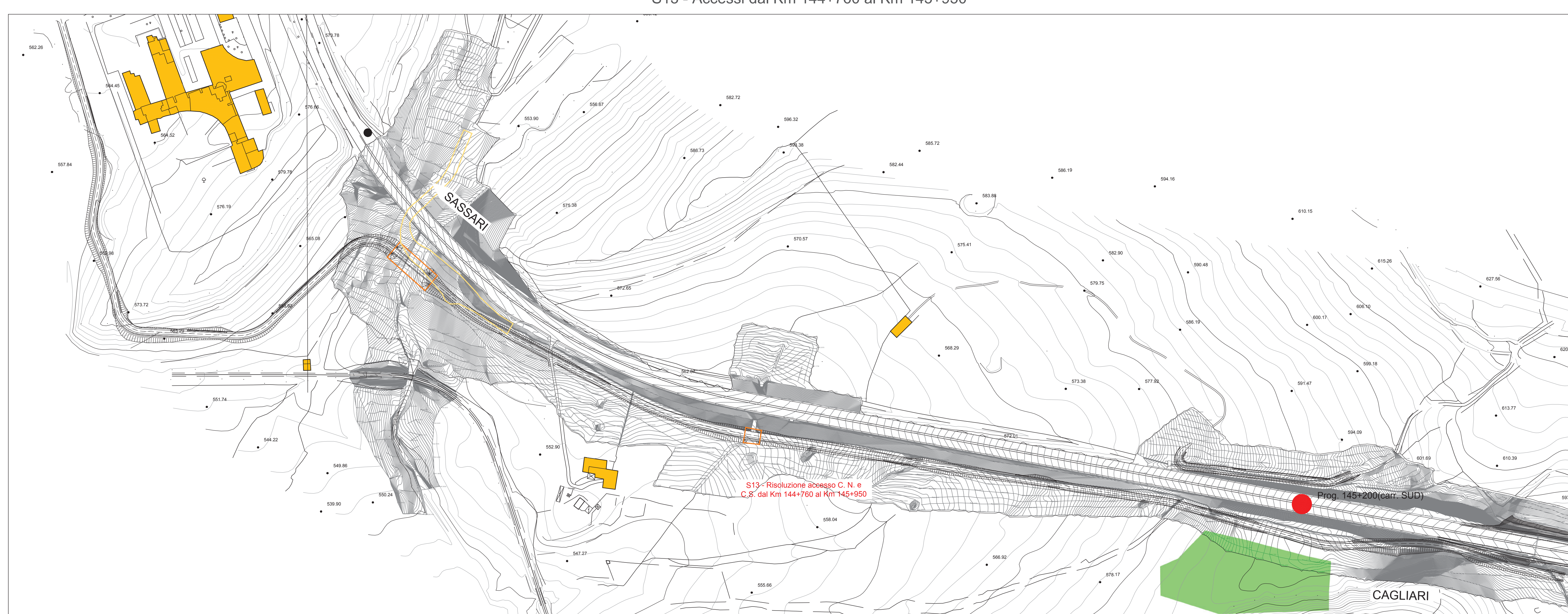

Project information block including: Logo of Anas Gruppo FS Italiane; Project name 'S.S.131 DI "CARLO FELICE" Adeguamento e messa in sicurezza della S.131'; Client 'Mandataria PROITER'; Designer 'Mandante TOIADOPEN19A'; and a table for 'VERIFICA DI OTTEMPERANZA TAVOLA SINOTTICA DI OTTEMPERANZA'.