

Coppella Tipo 1    Prospetto Lato A    Prospetto Lato B

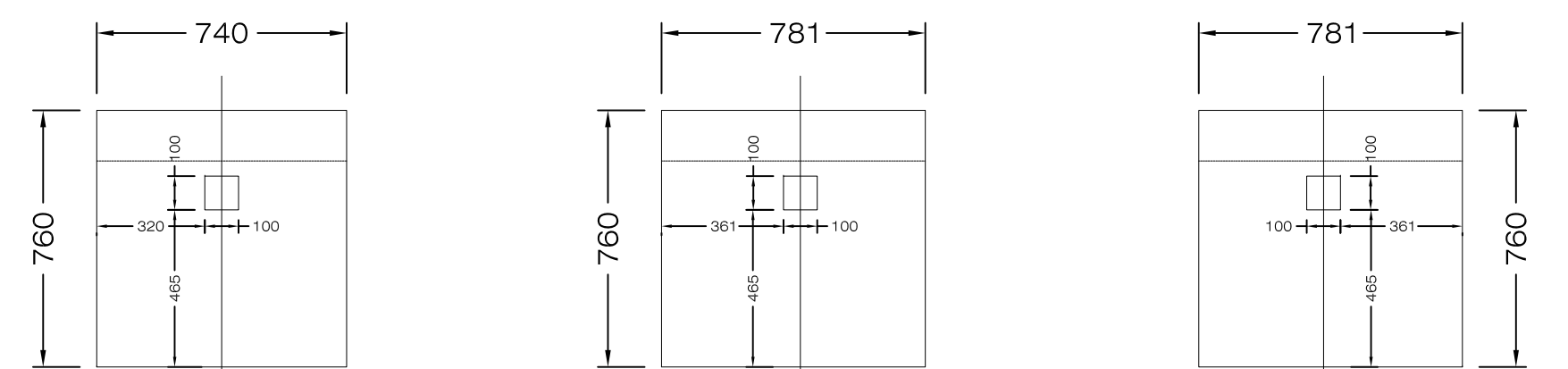

**COPPELLE PREFABBRICATE**  
Scala 1:20

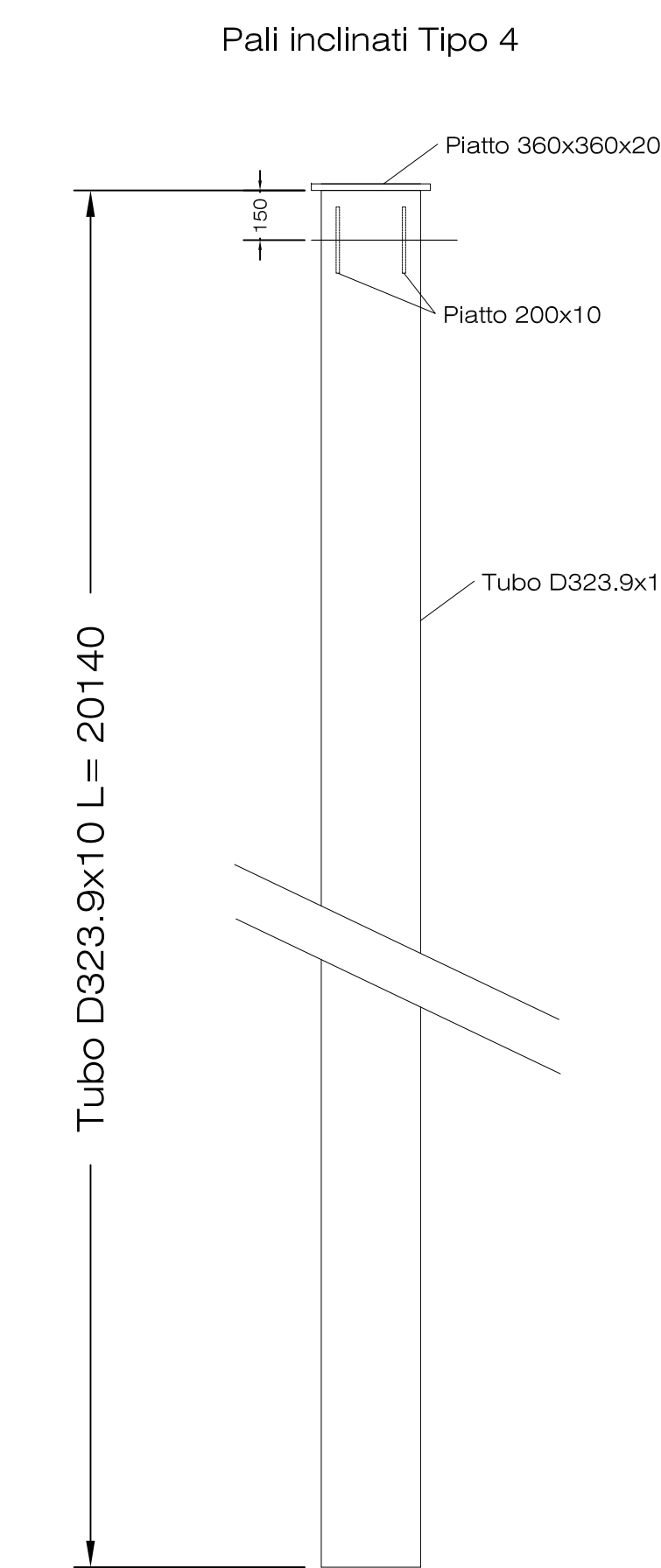
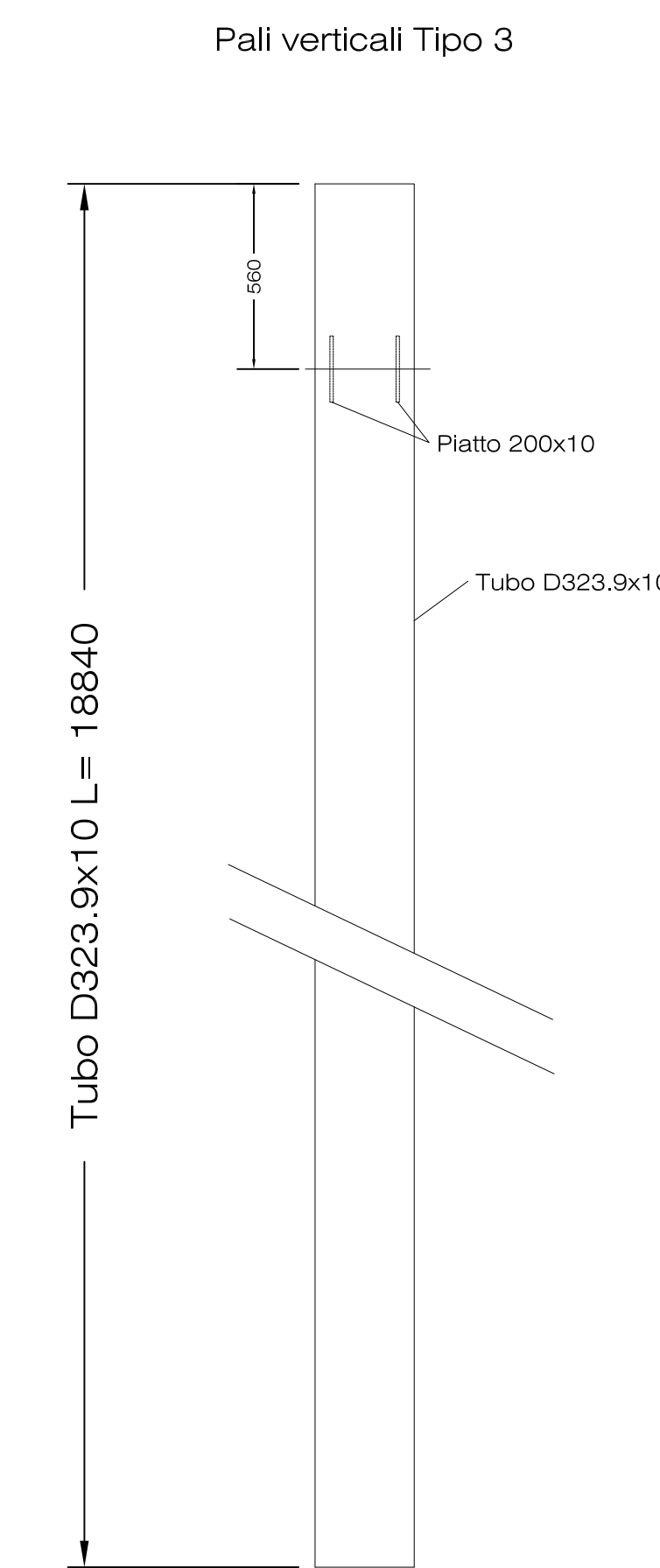
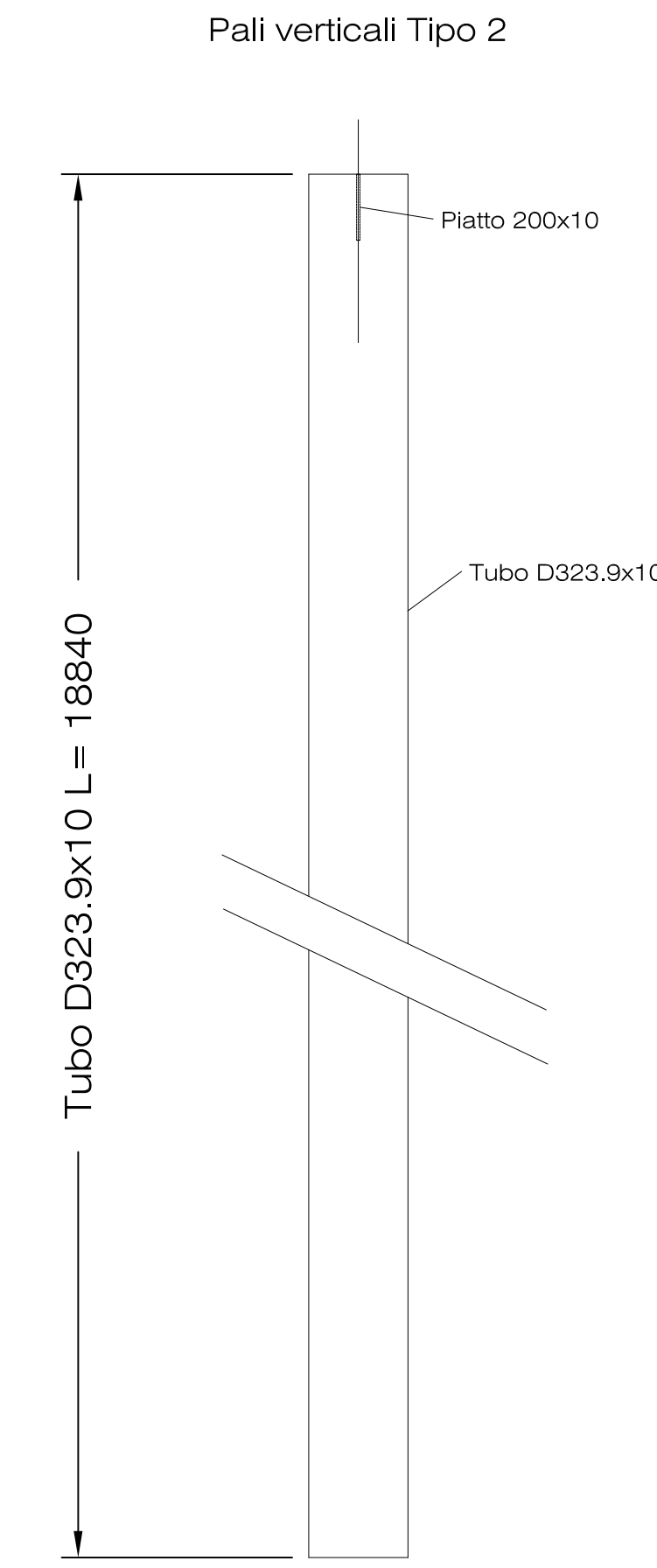
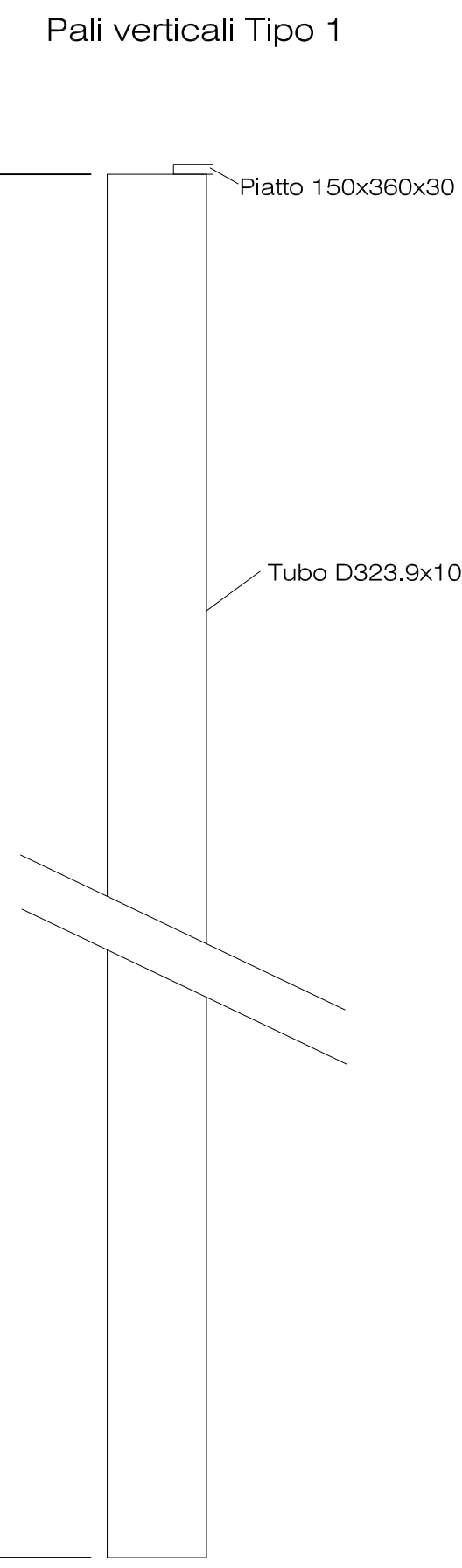
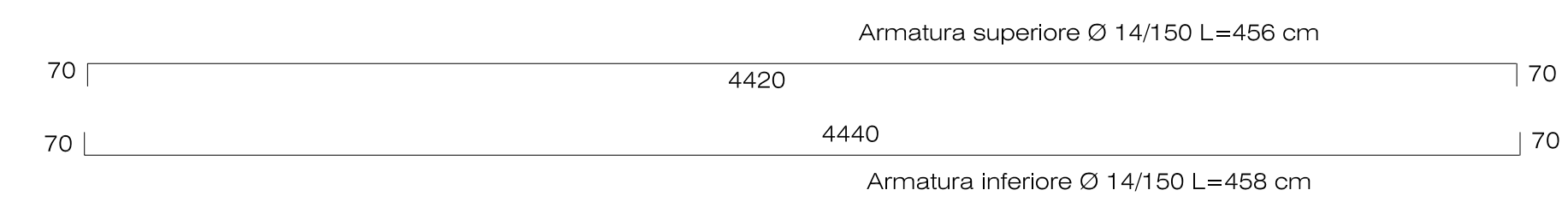
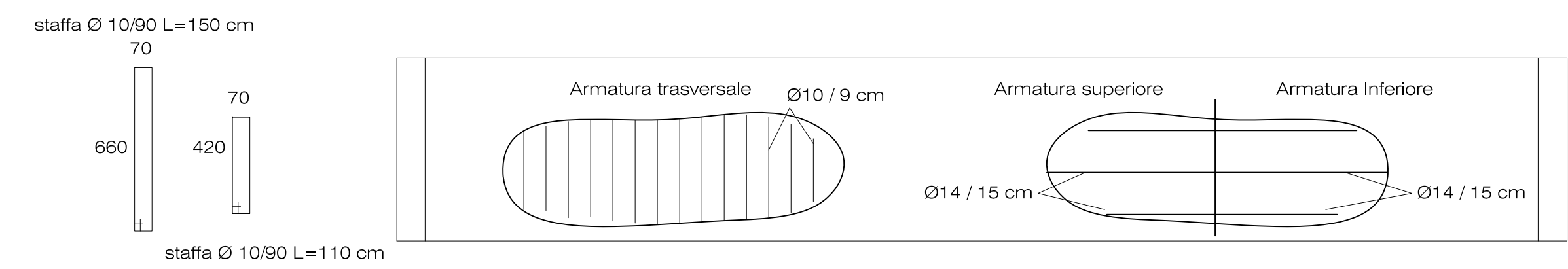
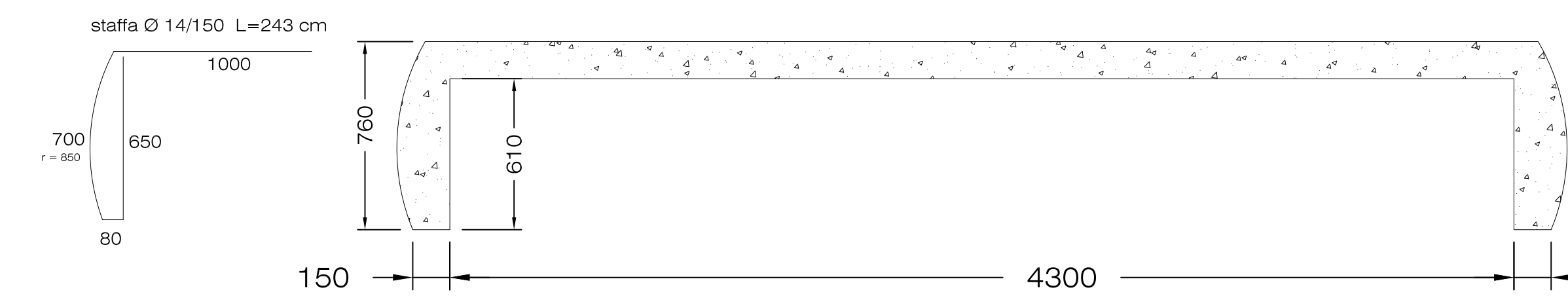

**TIPOLOGIE PALI**  
Scala 1:20

1) LE DIMENSIONI SONO ESPRESSE IN MILLIMETRI

2) MATERIALI

- CALCESTRUZZO:  
CLASSE DI ESPOSIZIONE : XS1  
DOSAGGIO MINIMO DI CEMENTO: 340Kg/mc  
CLASSE DI RESISTENZA fck/Rck: 32/40 N/mm<sup>2</sup>  
RAPPORTO A/C MAX: 0.50  
DIMENSIONE MAX AGGREGATI: DIAM MAX 16mm  
CLASSE DI CONSISTENZA: S4
- FERRI DI ARMATURA:  
TIPO: B450C  
TENSIONE CARATTERISTICA DI SNERVAMENTO: fyk > 450N/mm<sup>2</sup>  
TENSIONE CARATTERISTICA DI ROTTURA: ftk > 540N/mm<sup>2</sup>
- COPRIFERRO: 40 mm
- ACCIAIO PER CARPENTERIE METALLICHE:  
TRAVI E PIATTI: S235JR UNI EN 10027  
TUBOLARI LAMINATI A CALDO: S235JRH EN 10210

Particolare 1 - Tipico

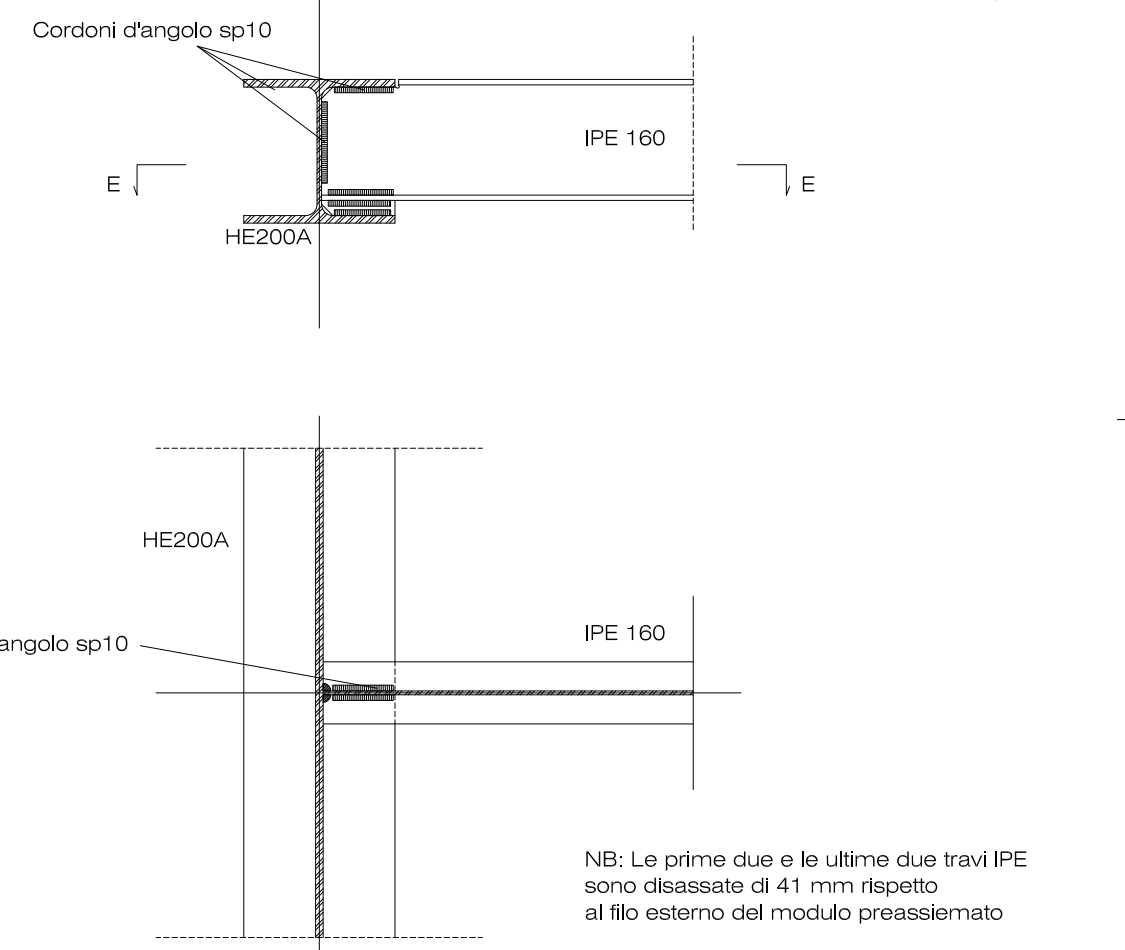

Vista E-E

Particolare 2 - Tipico

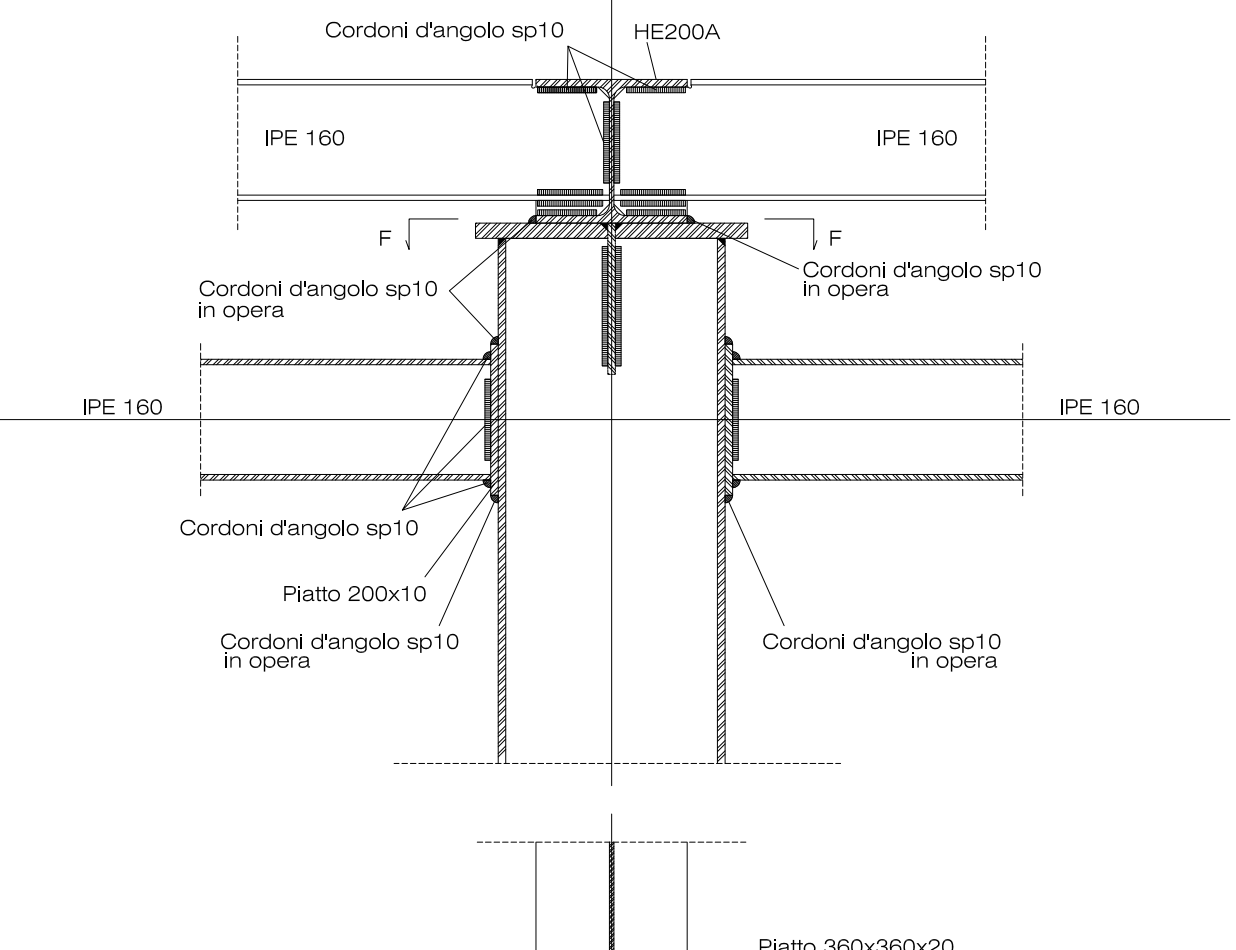

Vista F-F

Particolare 3 - Tipico

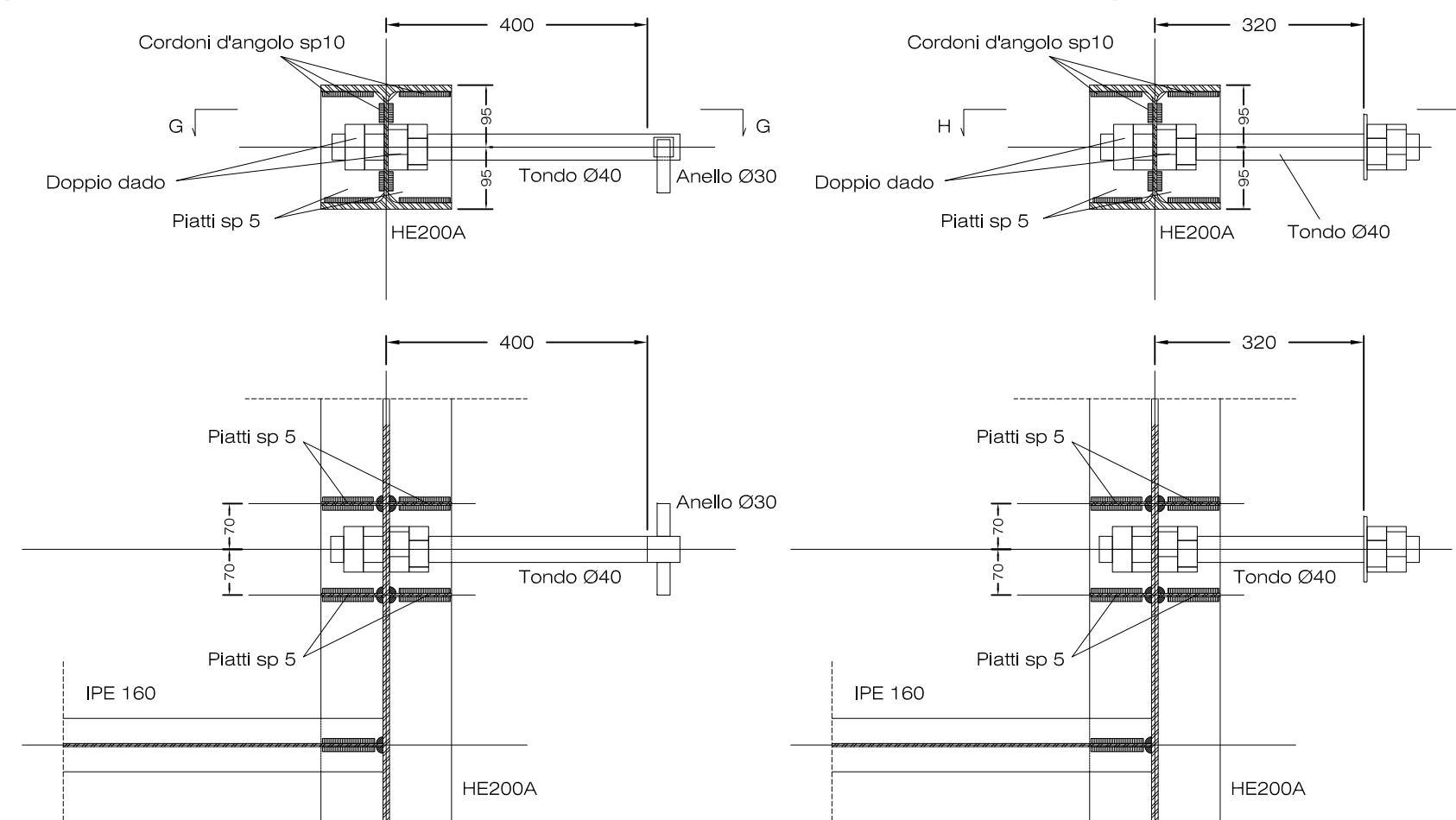

Vista G-G

Vista H-H

Particolare 5 - Tipico

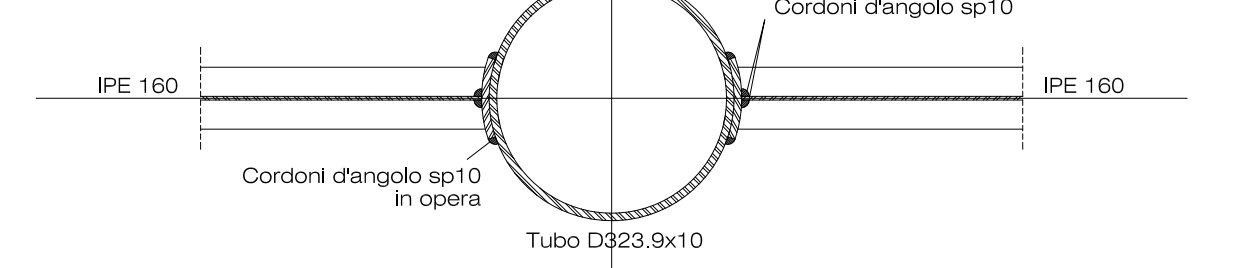

**PARTICOLARI IMPALCATO**  
Scala 1:100

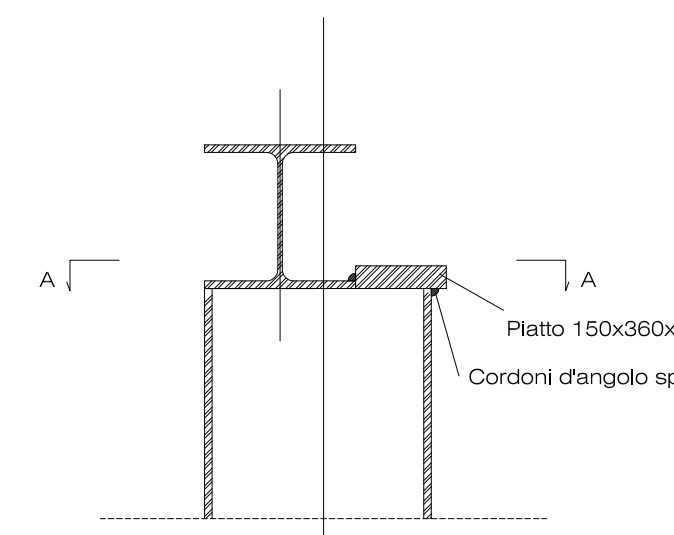

Palo tipo 1: Testa

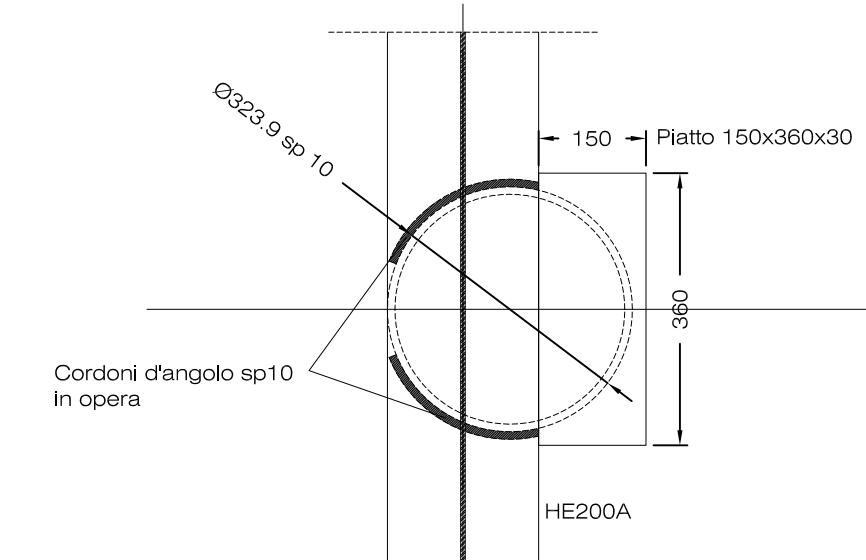

Palo tipo 1: Vista A-A

Palo tipo 1,2,3 e 4: Fondo

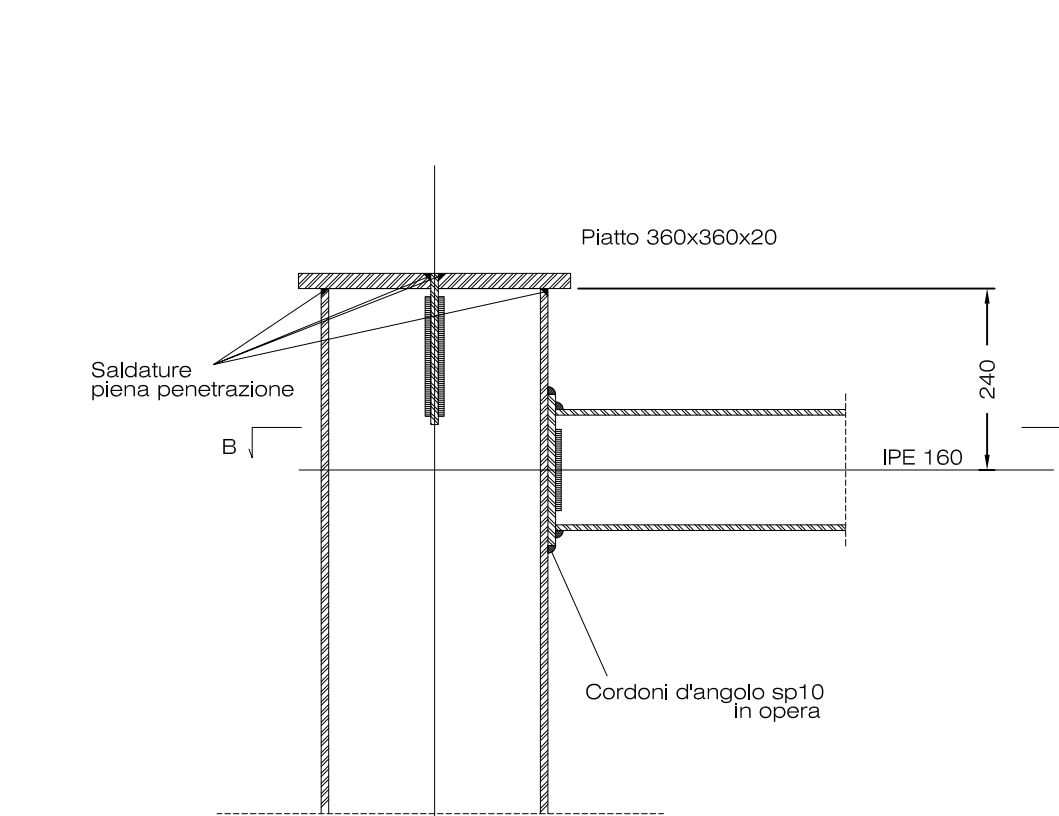

Palo tipo 2: Testa

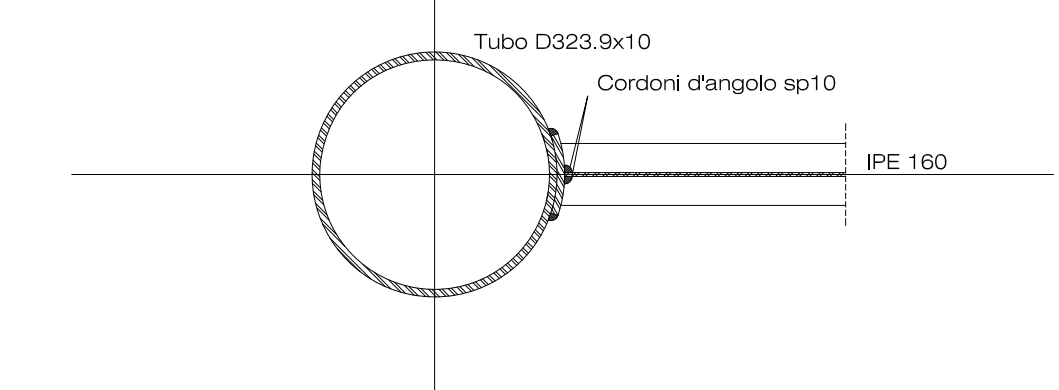

Palo tipo 2: Vista B-B

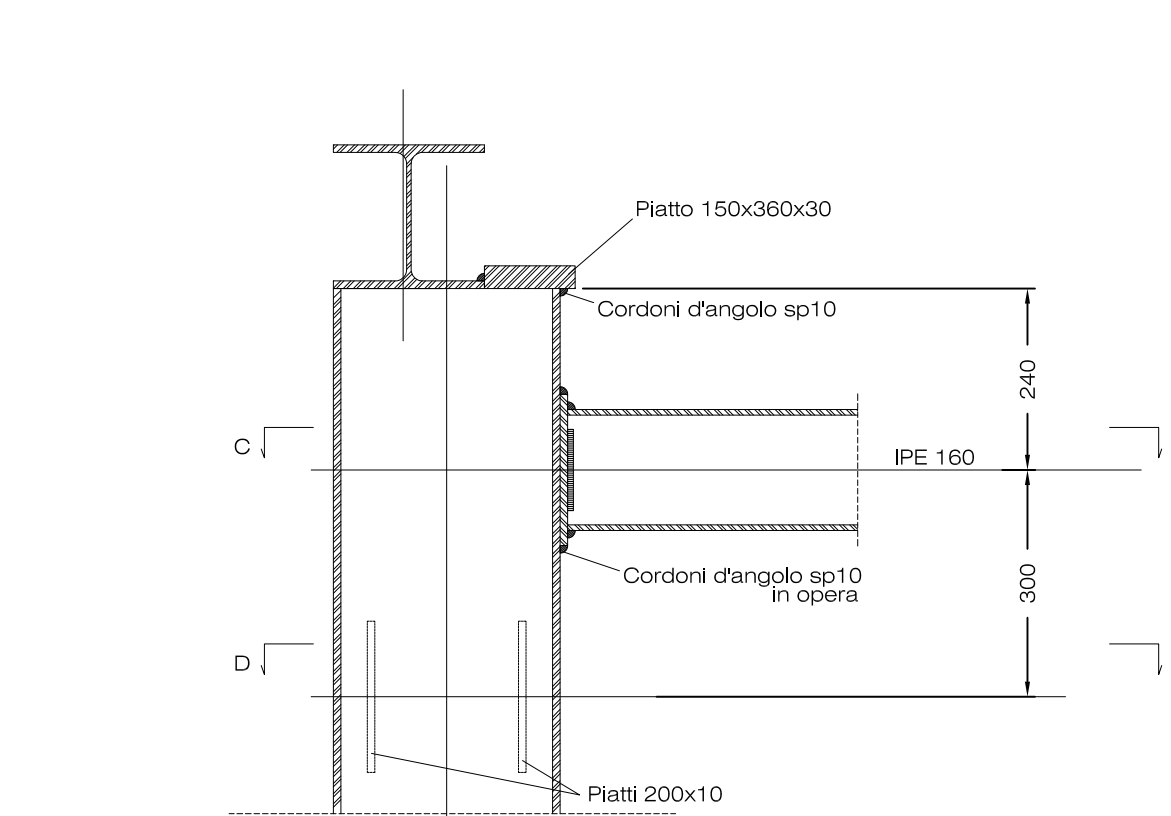

Palo tipo 3: Testa

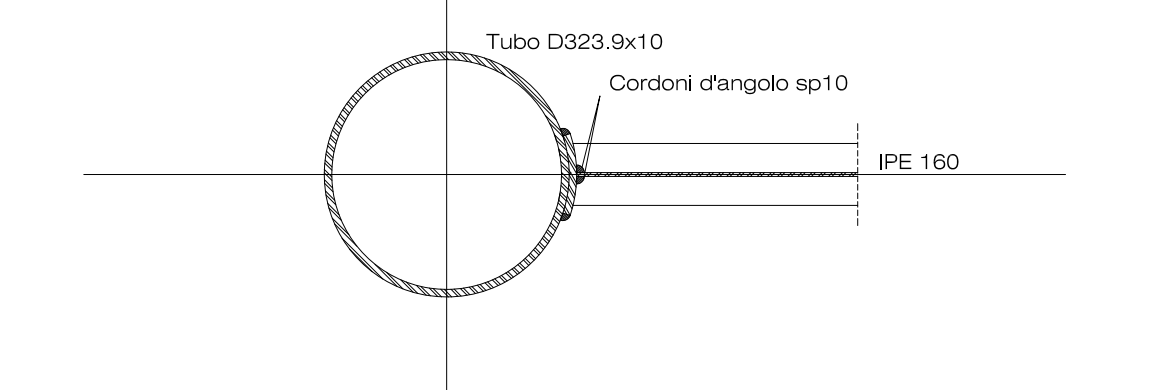

Palo tipo 3: Vista C-C

**PARTICOLARI PALI**  
Scala 1:10

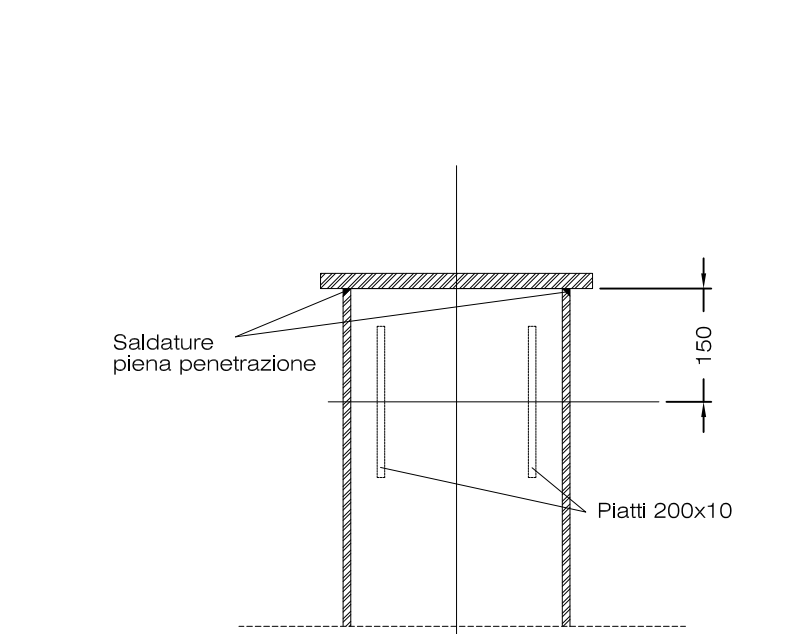

Palo tipo 4: Testa

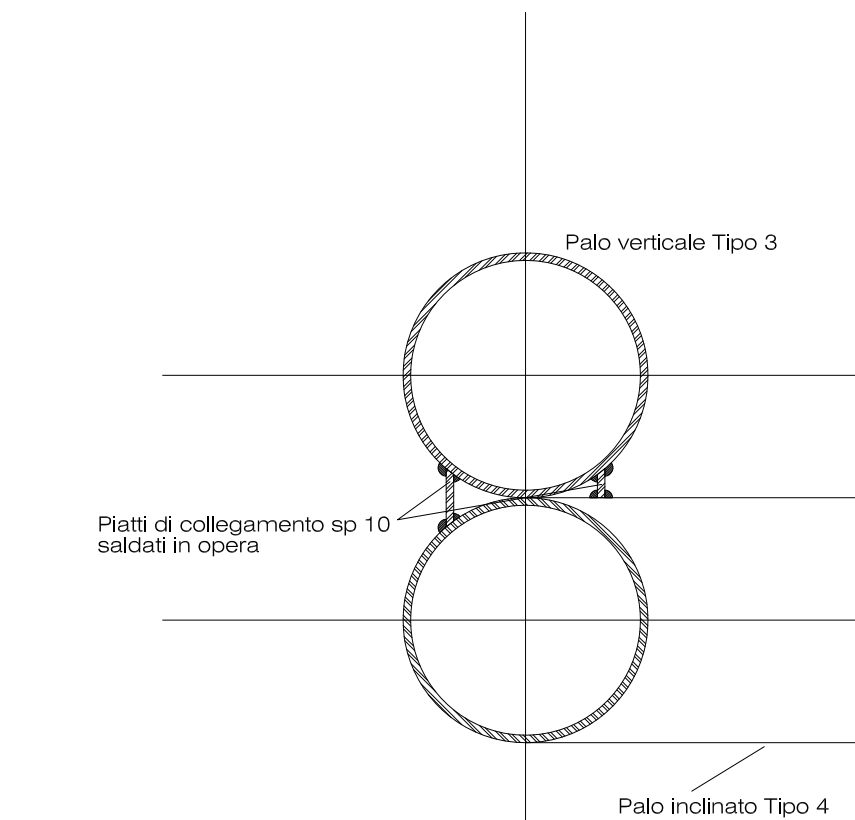

Particolare 4  
Palo tipo 3 e 4: Vista D-D

CADI s.r.l.

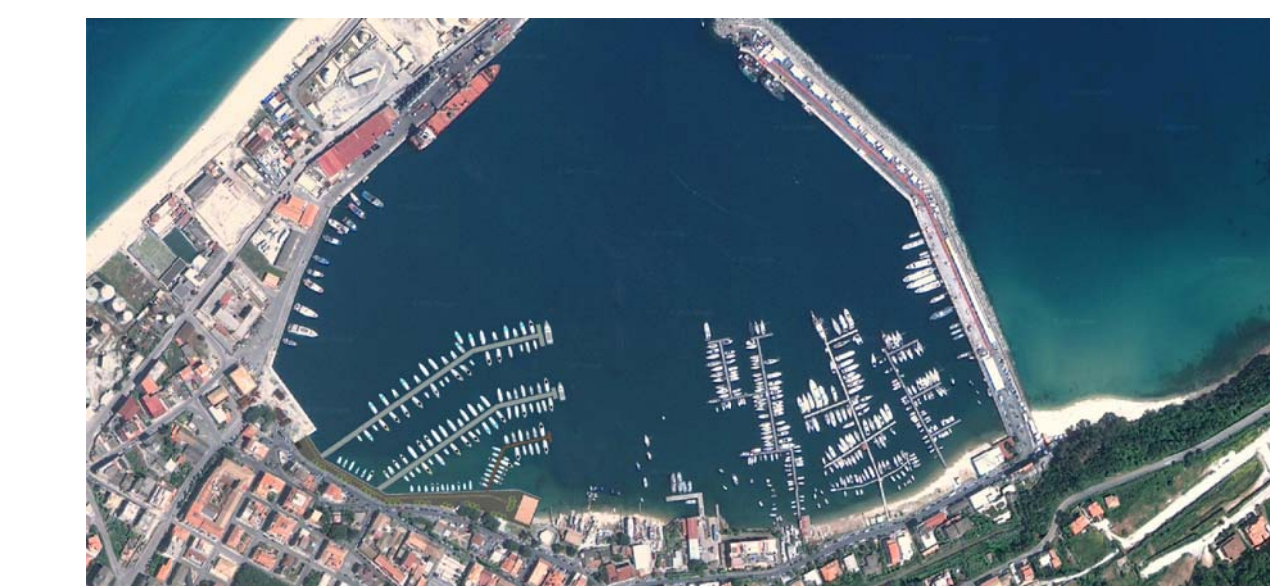

Porto Turistico "Marina Resort"

PROGETTO DEFINITIVO

Elaborato:	Tav.
<b>PARTICOLARI COSTRUTTIVI PONTILI "A" e "B"</b>	<b>T9</b>
	Scala: varia

I progettisti:  
Ing. Gianluca CANTISANI  
Ing. Alberto BORSANI

Data:	Febbraio 2015	Revisioni:			
-------	---------------	------------	--	--	--