

Q2 = 820,24
Q3 = 820,24
Q4 = 820,24
Q5 = 820,24
Q6 = 820,24
Q7 = 820,24
Q8 = 820,24
Q9 = 820,24
Q10 = 820,24
Q11 = 820,24
Q12 = 820,24
Q13 = 820,24
Q14 = 820,24
Q15 = 820,24
Q16 = 820,24
Q17 = 820,24
Q18 = 820,24
Q19 = 820,24
Q20 = 820,24
Q21 = 820,24
Q22 = 820,24
Q23 = 820,24
Q24 = 820,24
Q25 = 820,24
Q26 = 820,24
Q27 = 820,24
Q28 = 820,24
Q29 = 820,24
Q30 = 820,24
Q31 = 820,24
Q32 = 820,24
Q33 = 820,24
Q34 = 820,24
Q35 = 820,24
Q36 = 820,24
Q37 = 820,24
Q38 = 820,24
Q39 = 820,24
Q40 = 820,24
Q41 = 820,24
Q42 = 820,24
Q43 = 820,24
Q44 = 820,24
Q45 = 820,24
Q46 = 820,24
Q47 = 820,24
Q48 = 820,24
Q49 = 820,24
Q50 = 820,24
Q51 = 820,24
Q52 = 820,24
Q53 = 820,24
Q54 = 820,24
Q55 = 820,24
Q56 = 820,24
Q57 = 820,24
Q58 = 820,24
Q59 = 820,24
Q60 = 820,24
Q61 = 820,24
Q62 = 820,24
Q63 = 820,24
Q64 = 820,24
Q65 = 820,24
Q66 = 820,24
Q67 = 820,24
Q68 = 820,24
Q69 = 820,24
Q70 = 820,24
Q71 = 820,24
Q72 = 820,24
Q73 = 820,24
Q74 = 820,24
Q75 = 820,24
Q76 = 820,24
Q77 = 820,24
Q78 = 820,24
Q79 = 820,24
Q80 = 820,24
Q81 = 820,24
Q82 = 820,24
Q83 = 820,24
Q84 = 820,24
Q85 = 820,24
Q86 = 820,24
Q87 = 820,24
Q88 = 820,24
Q89 = 820,24
Q90 = 820,24
Q91 = 820,24
Q92 = 820,24
Q93 = 820,24
Q94 = 820,24
Q95 = 820,24
Q96 = 820,24
Q97 = 820,24
Q98 = 820,24
Q99 = 820,24
Q100 = 820,24

Q2 = 916,01
Q3 = 916,01
Q4 = 916,01
Q5 = 916,01
Q6 = 916,01
Q7 = 916,01
Q8 = 916,01
Q9 = 916,01
Q10 = 916,01
Q11 = 916,01
Q12 = 916,01
Q13 = 916,01
Q14 = 916,01
Q15 = 916,01
Q16 = 916,01
Q17 = 916,01
Q18 = 916,01
Q19 = 916,01
Q20 = 916,01
Q21 = 916,01
Q22 = 916,01
Q23 = 916,01
Q24 = 916,01
Q25 = 916,01
Q26 = 916,01
Q27 = 916,01
Q28 = 916,01
Q29 = 916,01
Q30 = 916,01
Q31 = 916,01
Q32 = 916,01
Q33 = 916,01
Q34 = 916,01
Q35 = 916,01
Q36 = 916,01
Q37 = 916,01
Q38 = 916,01
Q39 = 916,01
Q40 = 916,01
Q41 = 916,01
Q42 = 916,01
Q43 = 916,01
Q44 = 916,01
Q45 = 916,01
Q46 = 916,01
Q47 = 916,01
Q48 = 916,01
Q49 = 916,01
Q50 = 916,01
Q51 = 916,01
Q52 = 916,01
Q53 = 916,01
Q54 = 916,01
Q55 = 916,01
Q56 = 916,01
Q57 = 916,01
Q58 = 916,01
Q59 = 916,01
Q60 = 916,01
Q61 = 916,01
Q62 = 916,01
Q63 = 916,01
Q64 = 916,01
Q65 = 916,01
Q66 = 916,01
Q67 = 916,01
Q68 = 916,01
Q69 = 916,01
Q70 = 916,01
Q71 = 916,01
Q72 = 916,01
Q73 = 916,01
Q74 = 916,01
Q75 = 916,01
Q76 = 916,01
Q77 = 916,01
Q78 = 916,01
Q79 = 916,01
Q80 = 916,01
Q81 = 916,01
Q82 = 916,01
Q83 = 916,01
Q84 = 916,01
Q85 = 916,01
Q86 = 916,01
Q87 = 916,01
Q88 = 916,01
Q89 = 916,01
Q90 = 916,01
Q91 = 916,01
Q92 = 916,01
Q93 = 916,01
Q94 = 916,01
Q95 = 916,01
Q96 = 916,01
Q97 = 916,01
Q98 = 916,01
Q99 = 916,01
Q100 = 916,01

Q2 = 11772,83
Q3 = 11772,83
Q4 = 11772,83
Q5 = 11772,83
Q6 = 11772,83
Q7 = 11772,83
Q8 = 11772,83
Q9 = 11772,83
Q10 = 11772,83
Q11 = 11772,83
Q12 = 11772,83
Q13 = 11772,83
Q14 = 11772,83
Q15 = 11772,83
Q16 = 11772,83
Q17 = 11772,83
Q18 = 11772,83
Q19 = 11772,83
Q20 = 11772,83
Q21 = 11772,83
Q22 = 11772,83
Q23 = 11772,83
Q24 = 11772,83
Q25 = 11772,83
Q26 = 11772,83
Q27 = 11772,83
Q28 = 11772,83
Q29 = 11772,83
Q30 = 11772,83
Q31 = 11772,83
Q32 = 11772,83
Q33 = 11772,83
Q34 = 11772,83
Q35 = 11772,83
Q36 = 11772,83
Q37 = 11772,83
Q38 = 11772,83
Q39 = 11772,83
Q40 = 11772,83
Q41 = 11772,83
Q42 = 11772,83
Q43 = 11772,83
Q44 = 11772,83
Q45 = 11772,83
Q46 = 11772,83
Q47 = 11772,83
Q48 = 11772,83
Q49 = 11772,83
Q50 = 11772,83
Q51 = 11772,83
Q52 = 11772,83
Q53 = 11772,83
Q54 = 11772,83
Q55 = 11772,83
Q56 = 11772,83
Q57 = 11772,83
Q58 = 11772,83
Q59 = 11772,83
Q60 = 11772,83
Q61 = 11772,83
Q62 = 11772,83
Q63 = 11772,83
Q64 = 11772,83
Q65 = 11772,83
Q66 = 11772,83
Q67 = 11772,83
Q68 = 11772,83
Q69 = 11772,83
Q70 = 11772,83
Q71 = 11772,83
Q72 = 11772,83
Q73 = 11772,83
Q74 = 11772,83
Q75 = 11772,83
Q76 = 11772,83
Q77 = 11772,83
Q78 = 11772,83
Q79 = 11772,83
Q80 = 11772,83
Q81 = 11772,83
Q82 = 11772,83
Q83 = 11772,83
Q84 = 11772,83
Q85 = 11772,83
Q86 = 11772,83
Q87 = 11772,83
Q88 = 11772,83
Q89 = 11772,83
Q90 = 11772,83
Q91 = 11772,83
Q92 = 11772,83
Q93 = 11772,83
Q94 = 11772,83
Q95 = 11772,83
Q96 = 11772,83
Q97 = 11772,83
Q98 = 11772,83
Q99 = 11772,83
Q100 = 11772,83

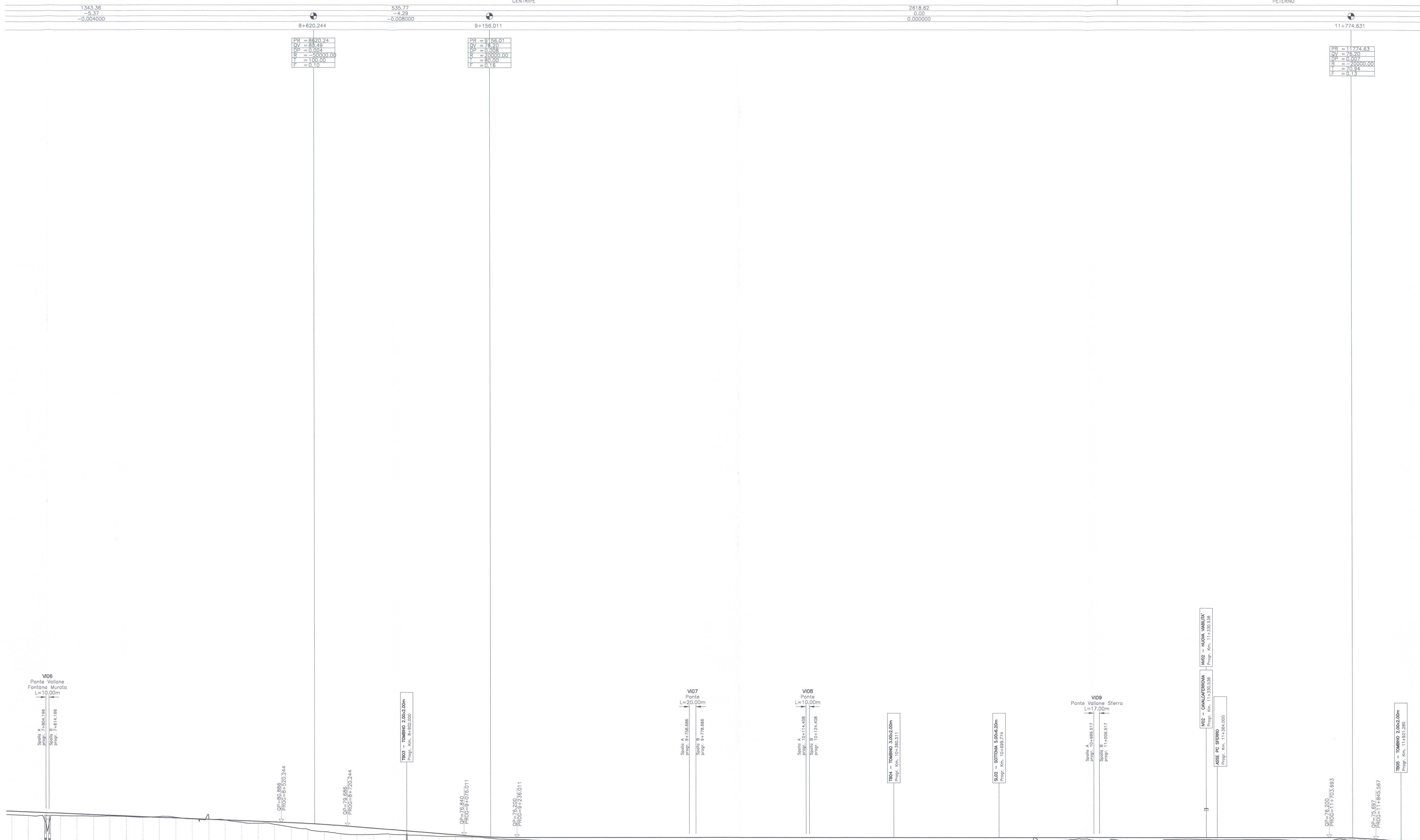

NUMERO SEZIONE	52
QUOTE PROGETTO	84,167
QUOTE TERRENO	83,076
ETIMETRICHE	7+750,00
DIST. PARZUAI	80,00
PROGRESSIVE	7+750,00
ANDAMENTO PLANIMETRICO	7+750,00

COMMITENTE:

PROGETTAZIONE:

U.O. AMBIENTE E ARCHEOLOGIA
INFRASTRUTTURE FERROVIARIE STRATEGICHE DEFINITE DALLA
LEGGE OBIETTIVO N. 443/01

PROGETTO PRELIMINARE
NUOVO COLLEGAMENTO PALERMO - CATANIA
RADDOPPIO DELLA TRATTA BICOCCA - CATENANUOVA

STUDIO DI IMPATTO AMBIENTALE
QUADRO DI RIFERIMENTO PROGETTUALE

Profili longitudinali di progetto 3/10

COMMESSA	LOTTO	FASE	ENTE	TIPO DOC.	OPERA/DISCIPLINA	PROGR.	REV.
RSJ1	01	R	22	F5	SA000G	003	B

Rev.	Descrizione	Redatto	Data	Verificato	Data	Approvato	Data	Autorizzato	Data
B	EMMISSIONE ESECUTIVA	M. Castaldi	04/06/2011	G. Mattucci	04/06/2011	R. Sciacca	04/06/2011	A. Manno	04/06/2011