

PROVINCIA
LIVELLETTE
COMUNE
DISL. L = m
p = m
PROGR. LIVELLETTE

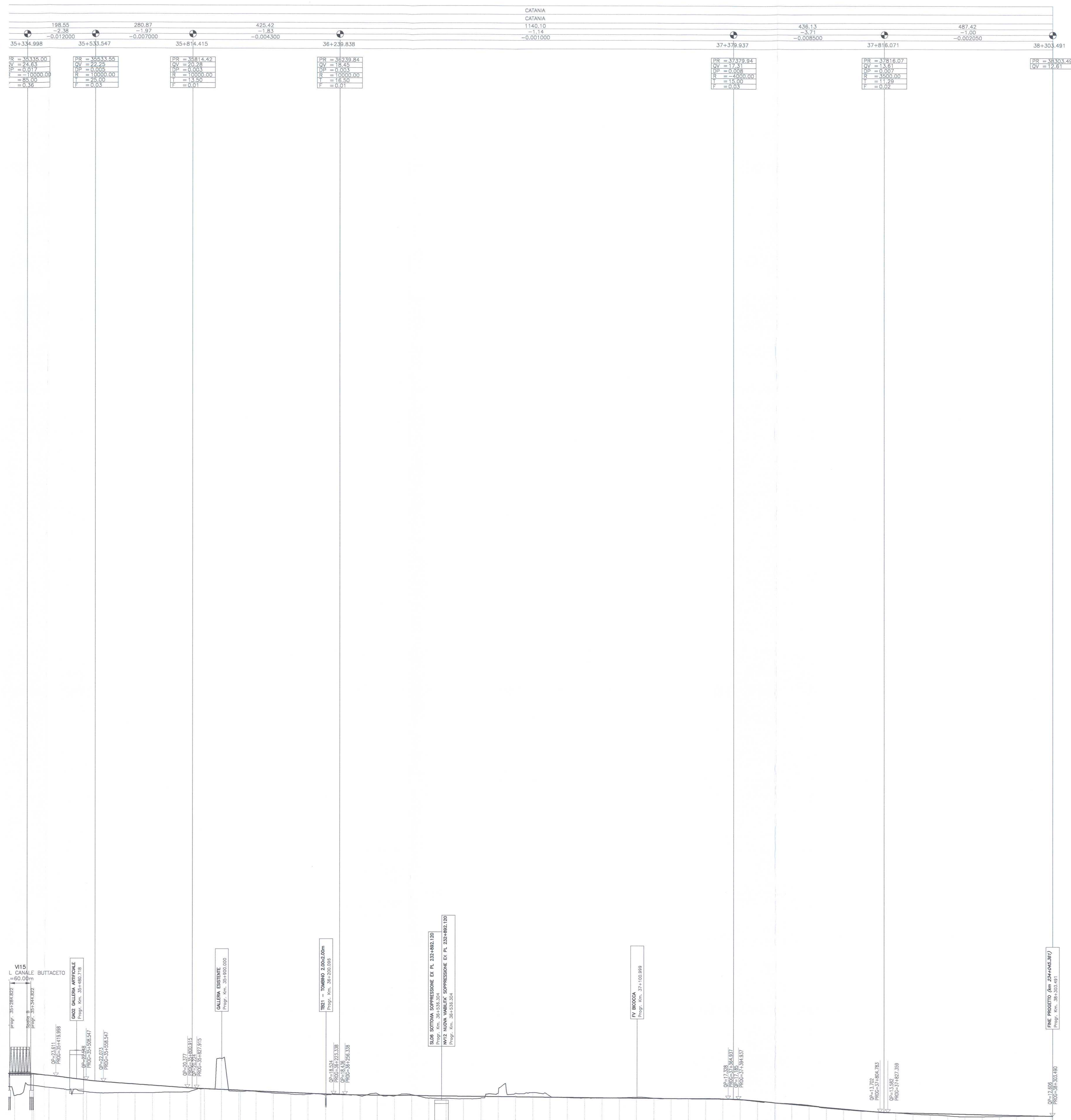

1:500
Q.R.=0.00 M

NUMERO SEZIONE	QUOTE PROGETTO	QUOTE TERRENO
35+300.00	24.331	17.876
35+400.00	24.580	20.227
35+500.00	23.831	23.386
35+600.00	23.251	19.778
35+700.00	22.851	18.473
35+800.00	22.137	18.820
35+900.00	21.793	18.615
36+000.00	21.433	18.554
36+100.00	21.083	18.537
36+200.00	20.733	18.103
36+300.00	20.383	18.134
36+400.00	20.033	18.039
36+500.00	19.683	18.336
36+600.00	19.333	18.351
36+700.00	18.983	18.888
36+800.00	18.633	18.586
36+900.00	18.283	18.579
37+000.00	17.933	18.340
37+100.00	17.583	18.600
37+200.00	17.233	18.765
37+300.00	16.883	18.137
37+400.00	16.533	18.439
37+500.00	16.183	17.503
37+600.00	15.833	17.430
37+700.00	15.483	17.562
37+800.00	15.133	17.583
37+900.00	14.783	18.146
38+000.00	14.433	18.968
38+100.00	14.083	18.073
38+200.00	13.733	18.171
38+300.00	13.383	17.622
38+400.00	13.033	17.816
38+500.00	12.683	17.710
38+600.00	12.333	17.646
38+700.00	11.983	17.587
38+800.00	11.633	17.482
38+900.00	11.283	17.395
39+000.00	10.933	18.575
39+100.00	10.583	18.000
39+200.00	10.233	18.484
39+300.00	9.883	14.612
39+400.00	9.533	14.021
39+500.00	9.183	14.167
39+600.00	8.833	13.800
39+700.00	8.483	13.506
39+800.00	8.133	13.131
39+900.00	7.783	12.837
40+000.00	7.433	12.660
40+100.00	7.083	12.479
40+200.00	6.733	12.420
40+300.00	6.383	12.514
40+400.00	6.033	12.292
40+500.00	5.683	12.646
40+600.00	5.333	12.618
40+700.00	4.983	12.618
40+800.00	4.633	12.618
40+900.00	4.283	12.618

ETOMETRICHE	DIST. PARZIALI	PROGRESSIVE	ANDAMENTO PLANIMETRICO
35+300.00	05.00	35+300.00	604.00 L=236.01
35+400.00	45.00	35+400.00	R=40.00
35+500.00	110.00	35+500.00	R=40.00
35+600.00	40.00	35+600.00	R=106.67
35+700.00	50.00	35+700.00	R=106.67
35+800.00	40.00	35+800.00	R=106.67
35+900.00	115.00	35+900.00	R=106.67
36+000.00	43.09	36+000.00	R=154.54
36+100.00	50.00	36+100.00	R=740.00
36+200.00	50.00	36+200.00	R=740.00
36+300.00	50.00	36+300.00	R=142.49
36+400.00	50.00	36+400.00	R=66.67
36+500.00	50.00	36+500.00	R=66.67
36+600.00	50.00	36+600.00	R=73.33
36+700.00	50.00	36+700.00	R=73.33
36+800.00	50.00	36+800.00	R=176.24
36+900.00	50.00	36+900.00	R=176.24
37+000.00	50.00	37+000.00	R=360.00
37+100.00	50.00	37+100.00	R=360.00
37+200.00	50.00	37+200.00	R=210.81
37+300.00	50.00	37+300.00	R=210.81
37+400.00	50.00	37+400.00	R=28.00
37+500.00	50.00	37+500.00	R=28.00
37+600.00	50.00	37+600.00	R=550.00
37+700.00	50.00	37+700.00	R=550.00
37+800.00	50.00	37+800.00	R=119.78
37+900.00	50.00	37+900.00	R=90.01
38+000.00	50.00	38+000.00	R=550.00
38+100.00	50.00	38+100.00	R=550.00
38+200.00	50.00	38+200.00	R=550.00
38+300.00	50.00	38+300.00	R=550.00
38+400.00	50.00	38+400.00	R=550.00
38+500.00	50.00	38+500.00	R=550.00
38+600.00	50.00	38+600.00	R=550.00
38+700.00	50.00	38+700.00	R=550.00
38+800.00	50.00	38+800.00	R=550.00
38+900.00	50.00	38+900.00	R=550.00
39+000.00	50.00	39+000.00	R=550.00
39+100.00	50.00	39+100.00	R=550.00
39+200.00	50.00	39+200.00	R=550.00
39+300.00	50.00	39+300.00	R=550.00
39+400.00	50.00	39+400.00	R=550.00
39+500.00	50.00	39+500.00	R=550.00
39+600.00	50.00	39+600.00	R=550.00
39+700.00	50.00	39+700.00	R=550.00
39+800.00	50.00	39+800.00	R=550.00
39+900.00	50.00	39+900.00	R=550.00
40+000.00	50.00	40+000.00	R=550.00
40+100.00	50.00	40+100.00	R=550.00
40+200.00	50.00	40+200.00	R=550.00
40+300.00	50.00	40+300.00	R=550.00
40+400.00	50.00	40+400.00	R=550.00
40+500.00	50.00	40+500.00	R=550.00
40+600.00	50.00	40+600.00	R=550.00
40+700.00	50.00	40+700.00	R=550.00
40+800.00	50.00	40+800.00	R=550.00
40+900.00	50.00	40+900.00	R=550.00

COMMITTENTE:
 RFI
RETE FERROVIARIA ITALIANA
GRUPPO FERROVIE DELLO STATO

PROGETTAZIONE:
 ITALFERR
GRUPPO FERROVIE DELLO STATO

U.O. AMBIENTE E ARCHEOLOGIA
INFRASTRUTTURE FERROVIARIE STRATEGICHE DEFINITE DALLA
LEGGE OBIETTIVO N. 443/01

PROGETTO PRELIMINARE
NUOVO COLLEGAMENTO PALERMO - CATANIA
RADDOPPIO DELLA TRATTA BICOCCA - CATENANUOVA

STUDIO DI IMPATTO AMBIENTALE
QUADRO DI RIFERIMENTO PROGETTUALE

Profili longitudinali di progetto 10/10
SCALA: 1:5000/500

COMMESSA	LOTTO	FASE	ENTE	TIPO DOC.	OPERA/DISCIPLINA	PROGR.	REV.
RSJ1	01	R	22	F5	SA000G	010	B

Rev.	Descrizione	Redatto	Data	Verificato	Data	Approvato	Data	Autorizzato/Data
B	EMISSIONE ESECUTIVA	H. Castelli G. Martelli	02/09/2011	V. Marrelli R. Scacchi	02/09/2011	B. Spiganti	02/09/2011	F. Maglio 02/09/2011