

TABELLE FERRI

Galleria artificiale - fondazioni						
POSIZIONE	N. PEZZI	φ [mm]	L [cm]	L. TOT [m]	PESO [kg]	SCHEMA PIEGATURA [cm] (misure al filo esterno)
1	228	26	630	1436.4	5986.9	[Diagram]
2	228	20	600	1368.0	3373.5	[Diagram]
3	76	20	1200	912.0	2249.0	[Diagram]
4	76	20	1200	912.0	2249.0	[Diagram]
5	76	20	335	254.6	627.8	[Diagram]
6	12	16	1160	139.2	219.7	[Diagram]
7	12	16	1200	144.0	227.2	[Diagram]
8	12	16	150	18.0	28.4	[Diagram]
9	12	16	425	51.0	80.5	[Diagram]
10	190	20	400	760.0	1874.2	[Diagram]
11	228	20	270	616.7	1520.9	[Diagram]
12	228	26	300	684.0	2850.9	[Diagram]
13	20	20	270	54.1	133.4	[Diagram]
14	16	20	270	43.3	106.7	[Diagram]
15	152	20	265	402.6	992.9	[Diagram]
16	16	16	425	68.0	107.3	[Diagram]
28	38	20	400	152.1	375.1	[Diagram]
29	38	20	400	152.1	375.1	[Diagram]
58	12	16	425	51.0	80.5	[Diagram]
					23459.0	

Galleria artificiale - parete						
POSIZIONE	N. PEZZI	φ [mm]	L [cm]	L. TOT [m]	PESO [kg]	SCHEMA PIEGATURA [cm] (misure al filo esterno)
17	228	20	845.0	1926.6	4751.0	[Diagram]
18	228	26	924.5	2107.9	8785.6	[Diagram]
19	20	20	780.0	156.0	384.7	[Diagram]
20	228	20	300.0	684.0	1686.7	[Diagram]
21	228	26	320.4	730.5	3044.8	[Diagram]
22	228	26	350.5	799.1	3350.8	[Diagram]
23	16	20	194.0	31.0	76.5	[Diagram]
24	1350	14	150.2	2027.1	2448.7	[Diagram]
25	228	14	120.2	273.9	330.9	[Diagram]
26	228	14	129.2	294.5	355.7	[Diagram]
27	224	12	178.5	399.8	355.1	[Diagram]
30	72	20	1200.0	864.0	2130.6	[Diagram]
31	72	20	1200.0	864.0	2130.6	[Diagram]
32	72	20	300.0	216.0	532.7	[Diagram]
33	72	16	1200.0	864.0	1363.4	[Diagram]
34	72	16	1200.0	864.0	1363.4	[Diagram]
35	72	16	259.9	187.1	295.3	[Diagram]
36	10	20	1200.0	120.0	295.9	[Diagram]
37	10	20	1200.0	120.0	295.9	[Diagram]
38	10	20	240.0	24.0	59.2	[Diagram]
39	10	16	1200.0	120.0	189.4	[Diagram]
40	10	16	1200.0	120.0	189.4	[Diagram]
41	10	16	199.9	20.0	31.5	[Diagram]
42	10	20	1200.0	120.0	295.9	[Diagram]
					40204.9	

Galleria artificiale - parete						
POSIZIONE	N. PEZZI	φ [mm]	L [cm]	L. TOT [m]	PESO [kg]	SCHEMA PIEGATURA [cm] (misure al filo esterno)
43	10	20	1200.0	120.0	295.9	[Diagram]
44	10	20	163.0	16.3	40.2	[Diagram]
45	6	20	1200.0	72.0	177.6	[Diagram]
46	6	20	1200.0	72.0	177.6	[Diagram]
47	6	20	163.0	9.8	24.1	[Diagram]
48	16	20	1200.0	192.0	473.5	[Diagram]
49	16	20	1200.0	192.0	473.5	[Diagram]
50	16	20	163.0	26.1	64.3	[Diagram]
51	16	20	780.0	124.8	307.8	[Diagram]
52	12	20	194.0	23.3	57.4	[Diagram]
53	296	20	256.1	758.0	1869.2	[Diagram]
54	24	20	226.1	54.3	133.8	[Diagram]
55	24	20	256.1	61.5	151.6	[Diagram]
56	4	12	1200.0	48.0	42.6	[Diagram]
57	4	12	1120.0	44.8	39.8	[Diagram]
59	5	20	400.0	20.0	49.3	[Diagram]
60	6	26	1200.0	72.0	300.1	[Diagram]
72	5	20	400.0	20.0	49.3	[Diagram]
73	17	26	399.5	67.9	283.1	[Diagram]
81	12	26	600.0	72.0	300.1	[Diagram]
82	30	16	360.0	108.0	170.4	[Diagram]
					40204.9	

Galleria artificiale - soletta						
POSIZIONE	N. PEZZI	φ [mm]	L [cm]	L. TOT [m]	PESO [kg]	SCHEMA PIEGATURA [cm] (misure al filo esterno)
61	210	26	372	781.2	3256.0	[Diagram]
62	105	26	1200	1260.0	5251.7	[Diagram]
63	8	26	372	29.8	124.0	[Diagram]
64	4	26	1200	48.0	200.1	[Diagram]
65	42	16	1200	504.0	795.3	[Diagram]
66	42	16	400	168.0	265.1	[Diagram]
67	228	20	400	912.0	2249.0	[Diagram]
68	114	20	1200	1368.0	3373.5	[Diagram]
69	228	26	600	1367.2	5698.4	[Diagram]
70	114	26	800	912.0	3801.2	[Diagram]
71	228	26	400	912.0	3801.2	[Diagram]
74	24	16	285	68.4	107.9	[Diagram]
75	12	16	1200	144.0	227.2	[Diagram]
76	138	16	1200	1656.0	2613.2	[Diagram]
77	138	16	1140	1573.2	2482.5	[Diagram]
78	6	20	1200	72.0	177.6	[Diagram]
79	1449	14	250	3618.9	4371.6	[Diagram]
80	1449	14	180	2608.2	3150.7	[Diagram]
84	138	14	218	301.0	363.6	[Diagram]
85	441	14	215	949.5	1147.0	[Diagram]
86	85	14	155	131.7	159.2	[Diagram]
87	170	14	102	173.4	209.5	[Diagram]
88	170	14	102	173.4	209.5	[Diagram]
					45564.0	

Galleria artificiale - soletta						
POSIZIONE	N. PEZZI	φ [mm]	L [cm]	L. TOT [m]	PESO [kg]	SCHEMA PIEGATURA [cm] (misure al filo esterno)
89	3	14	205	6.2	7.4	[Diagram]
90	3	14	400	12.0	14.5	[Diagram]
91	6	14	1200	72.0	87.0	[Diagram]
92	3	14	680	20.4	24.6	[Diagram]
93	3	14	400	12.0	14.5	[Diagram]
94	2	14	1200	24.0	29.0	[Diagram]
95	2	14	680	13.6	16.4	[Diagram]
96	115	14	210	241.5	291.7	[Diagram]
97	230	14	132	304.7	368.1	[Diagram]
98	230	14	132	304.7	368.1	[Diagram]
100	4	14	202	8.1	9.8	[Diagram]
101	4	14	203	8.1	9.8	[Diagram]
102	8	14	1200	96.0	116.0	[Diagram]
103	8	14	1145	91.6	110.6	[Diagram]
104	2	14	1198	24.0	28.9	[Diagram]
105	2	14	900	18.0	21.7	[Diagram]
106	2	14	450	9.0	10.9	[Diagram]
					45564.0	

DETTAGLIO ARMATURA INTERRUZIONE PER PASSAGGIO IMPIANTI
Scala 1:20

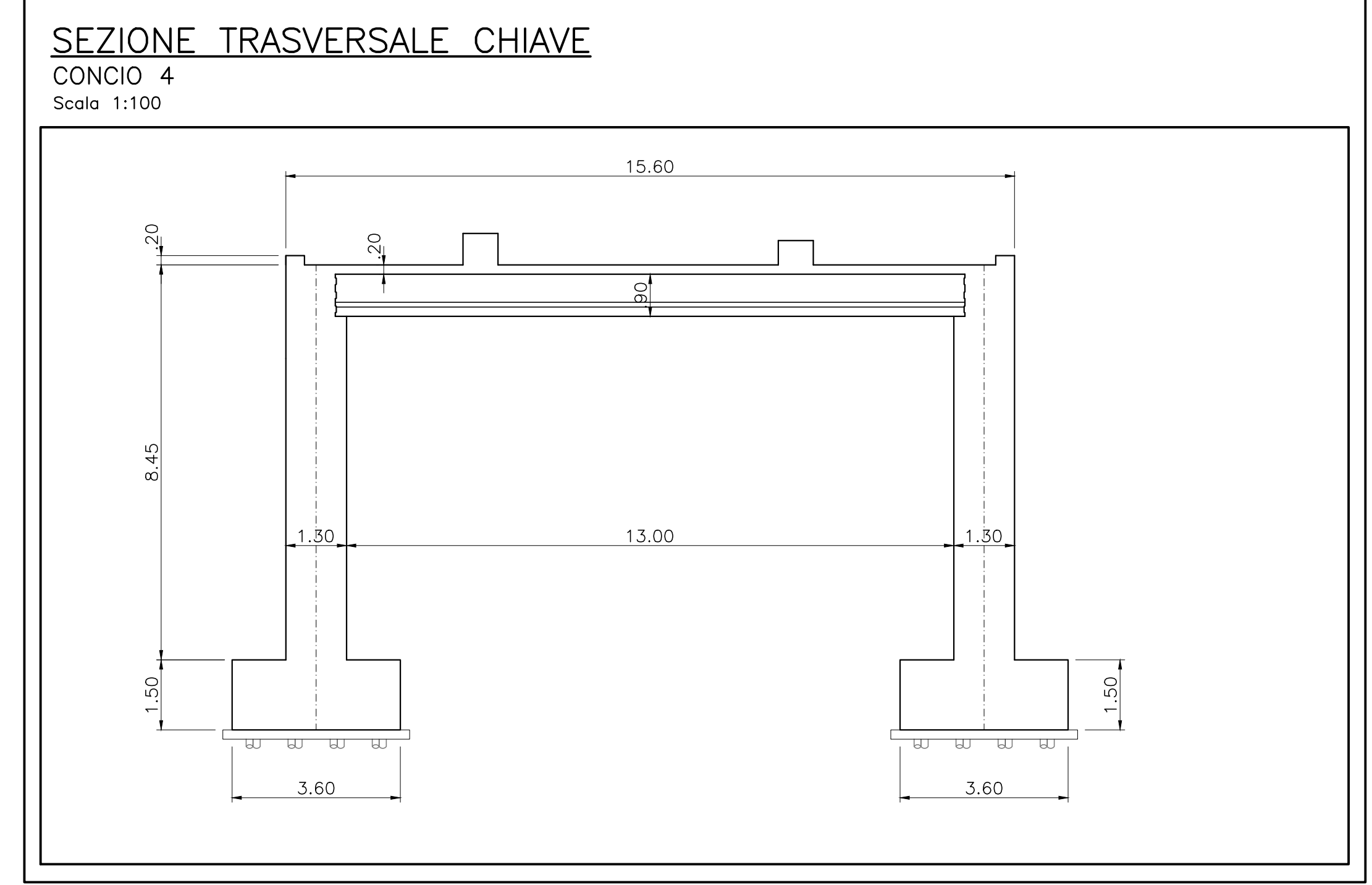
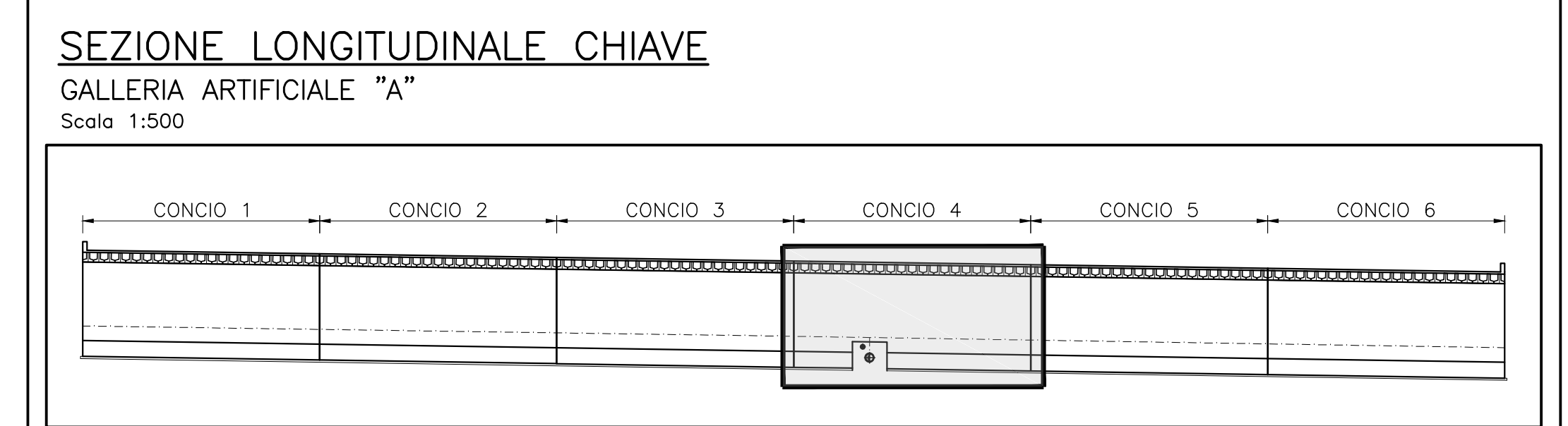
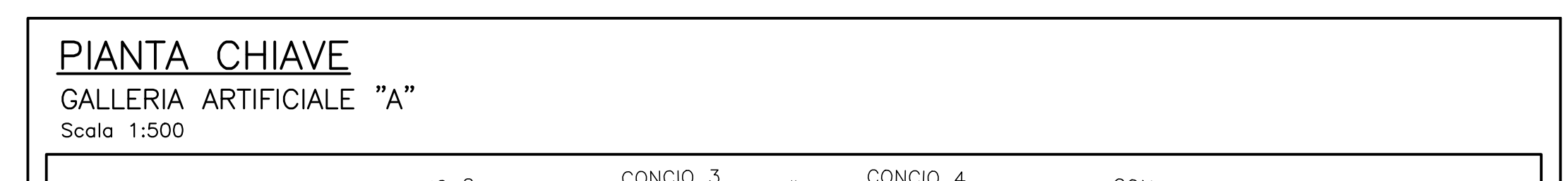
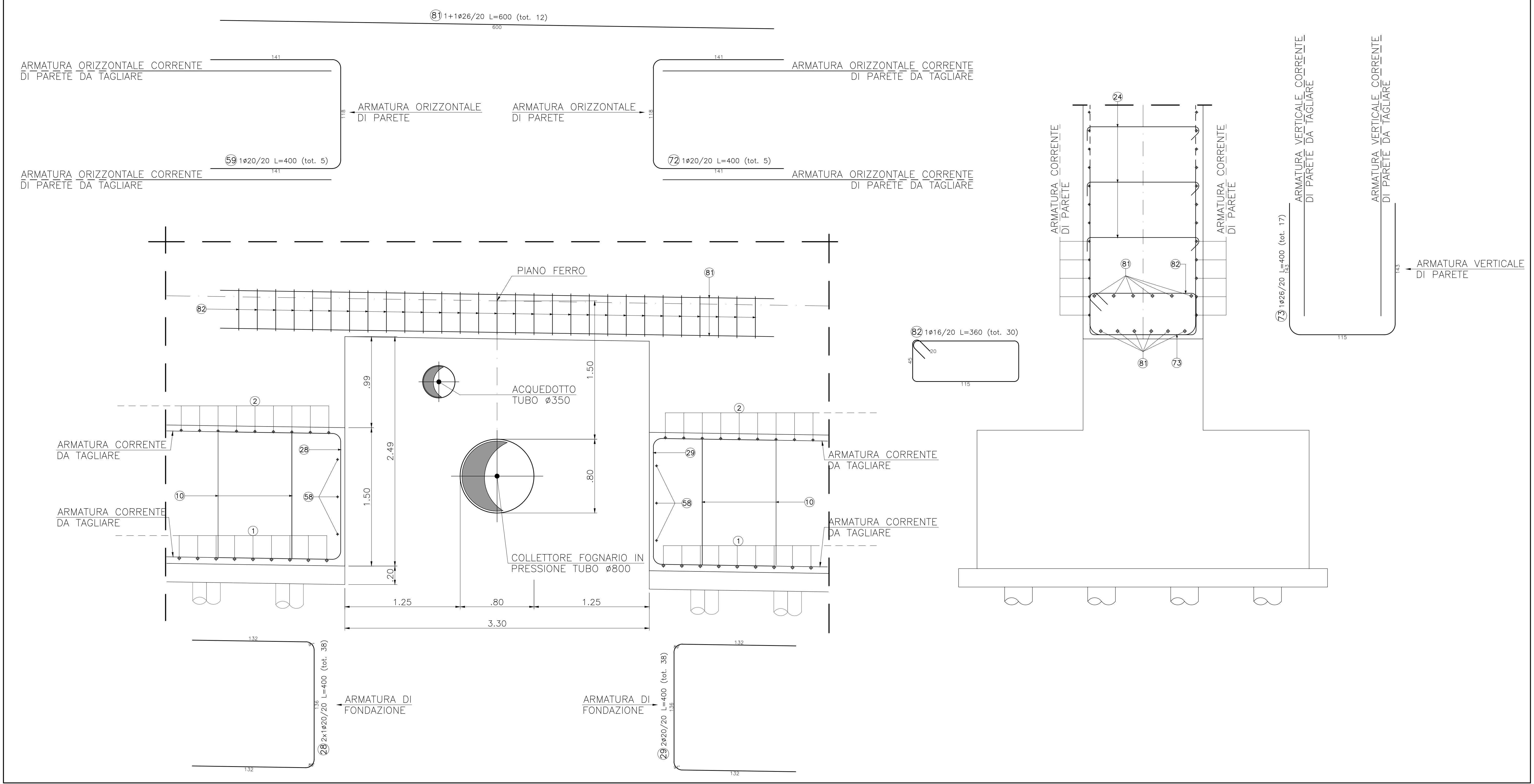

Sanas
GRUPPO FS ITALIANE
Direzione Progettazione e Realizzazione Lavori

S.S.291 "Della Nurra"
Lavori di costruzione del Lotto 1 da Alghero ad Olmedo, in località bivio cantoniera di Rudas (completamento collegamento Alghero-Sassari) e del Lotto 4 tra bivio Olmedo e l'aeroporto di Alghero-Fertilia (bretella per l'aeroporto)

PROGETTO ESECUTIVO COD. CAD9

PROGETTAZIONE: Ats VA - SERING - VDP - BRENG

PROGETTISTA E RESPONSABILE DELL'INTEGRAZIONE DELLE PRESTAZIONI SPECIALISTICHE:
[List of project team members]

RESPONSABILE D'AREA:
[List of area responsible members]

COORDINATORE SICUREZZA IN FASE DI PROGETTAZIONE:
[List of safety coordinator members]

COORDINATORE ATTIVITA' DI PROGETTAZIONE:
[List of design activity coordinator members]

VISTO IL RESPONSABILE DEL PROCEDIMENTO:
[List of procedure responsible members]

GALLERIE ARTIFICIALI
GALLERIA ARTIFICIALE FERROVIA "A"
ARMATURA CONCIO 4 - Tav. 2 di 2

CODICE PROGETTO	LV. PROJ. MANO	NOME FILE	REVISIONE	SCALA
DPICAO029	E 21	TO1_GAO1_STR_AR09_A	A	VARIE
D	-	-	-	-
C	-	-	-	-
B	-	-	-	-
A	EMISSIONE	02/09/2023	E. ROSSO	G. CARONNI
REV.	DESCRIZIONE	DATA	REDATTO	VERIFICATO APPROVATO