

PIANTA FONDAZIONI - Scala 1:50

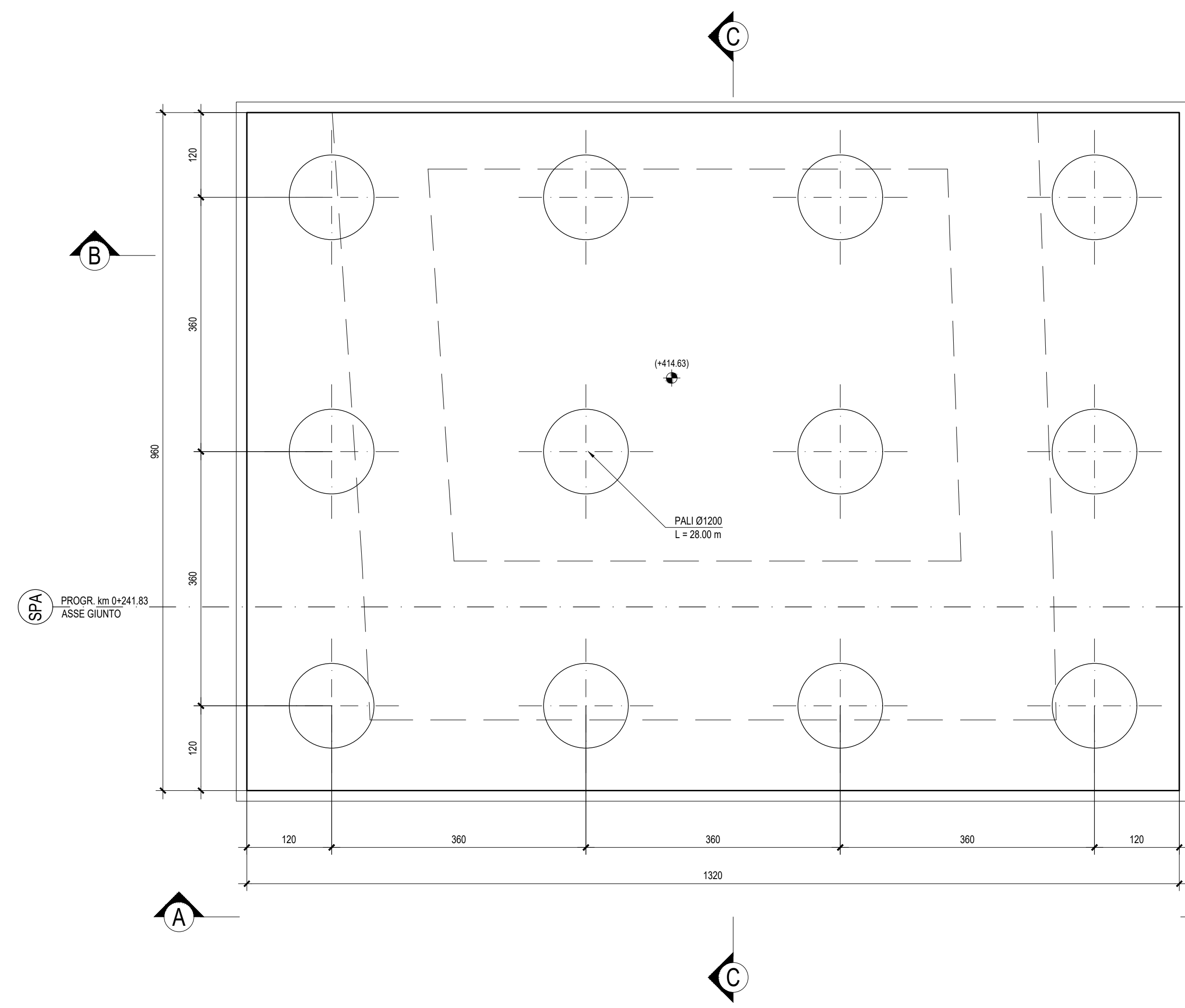

PIANTA SPICCATO - Scala 1:50

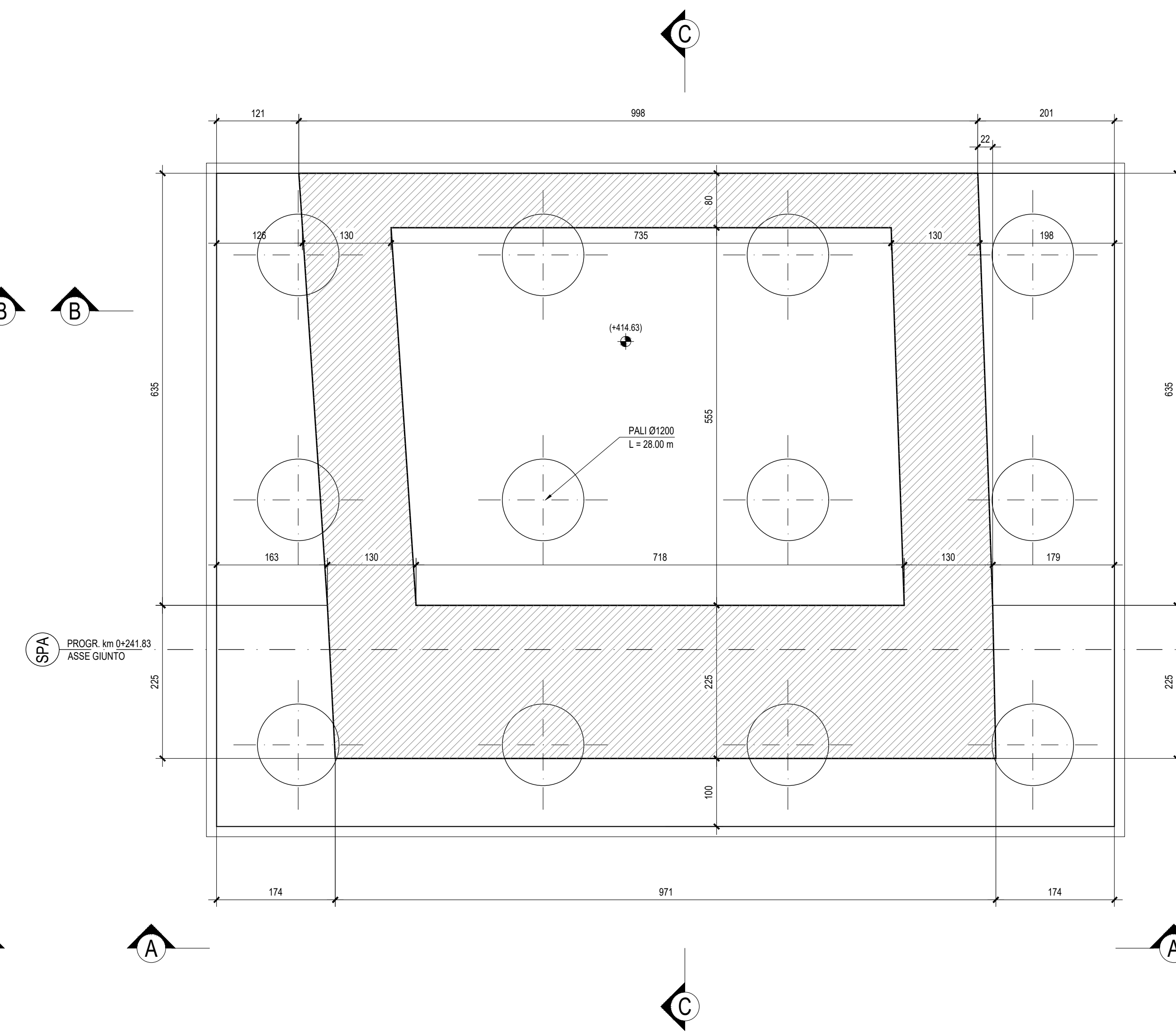

VISTA DALL'ALTO - Scala 1:50

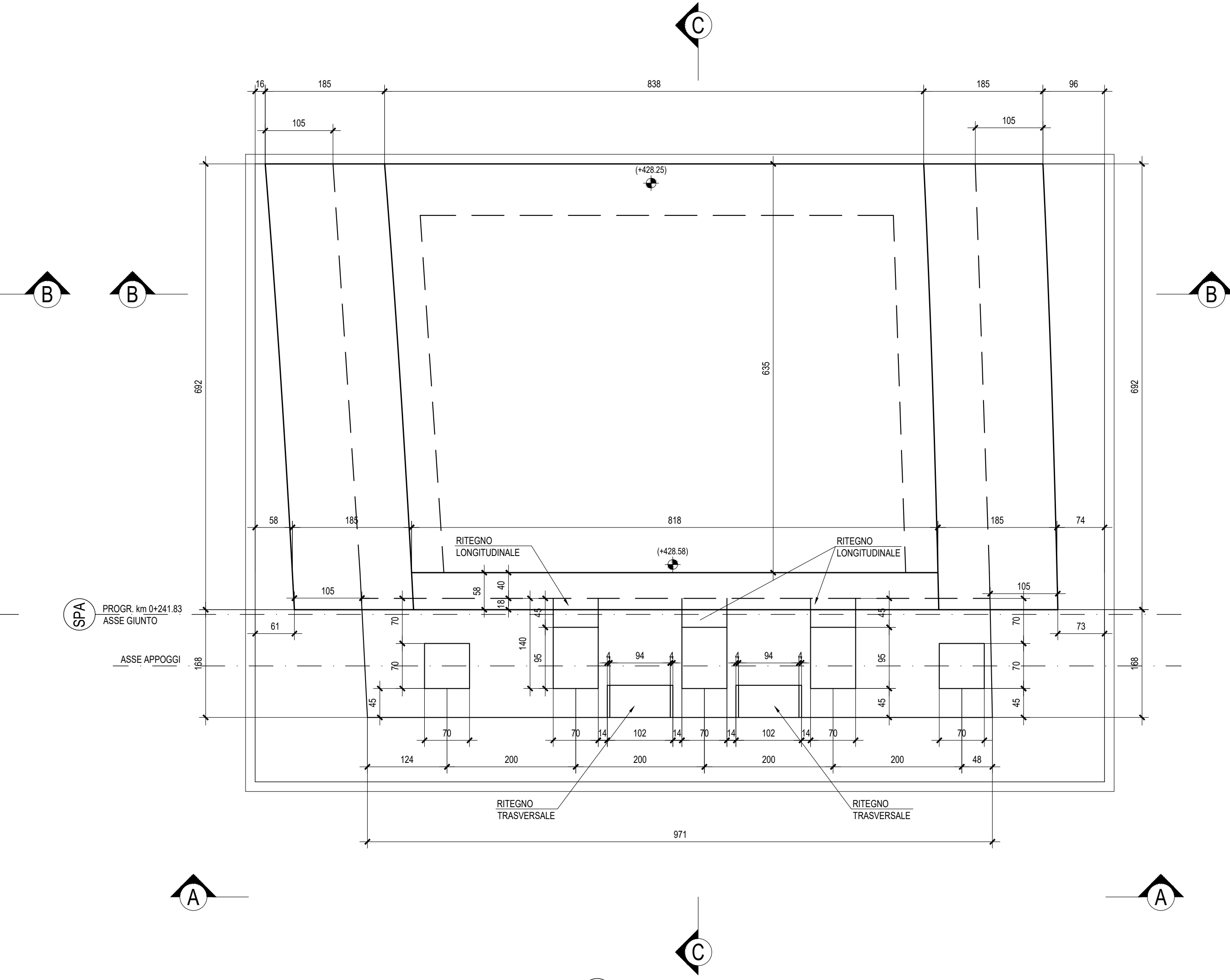

VISTA A-A - Scala 1:50

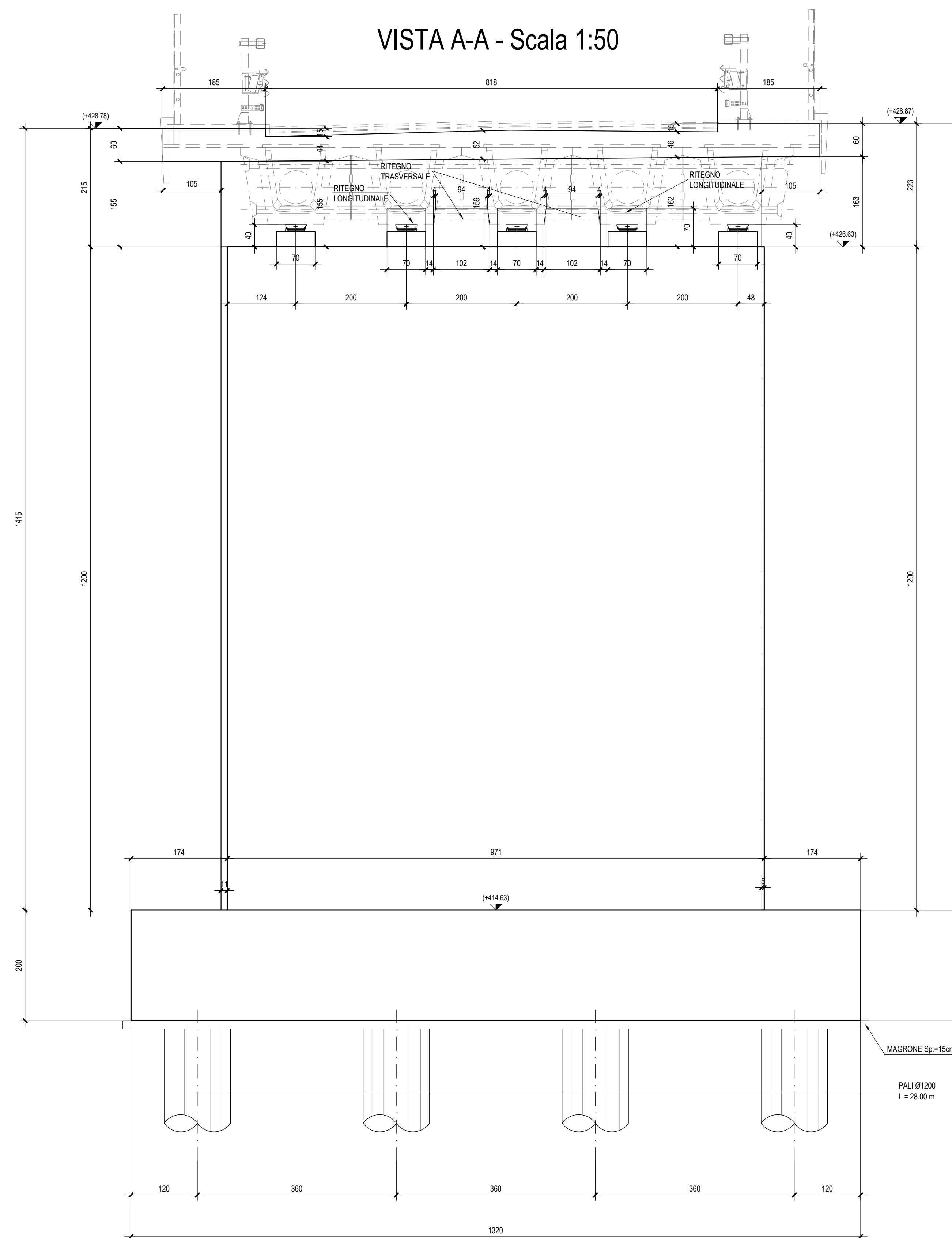

SEZIONE B-B - Scala 1:50

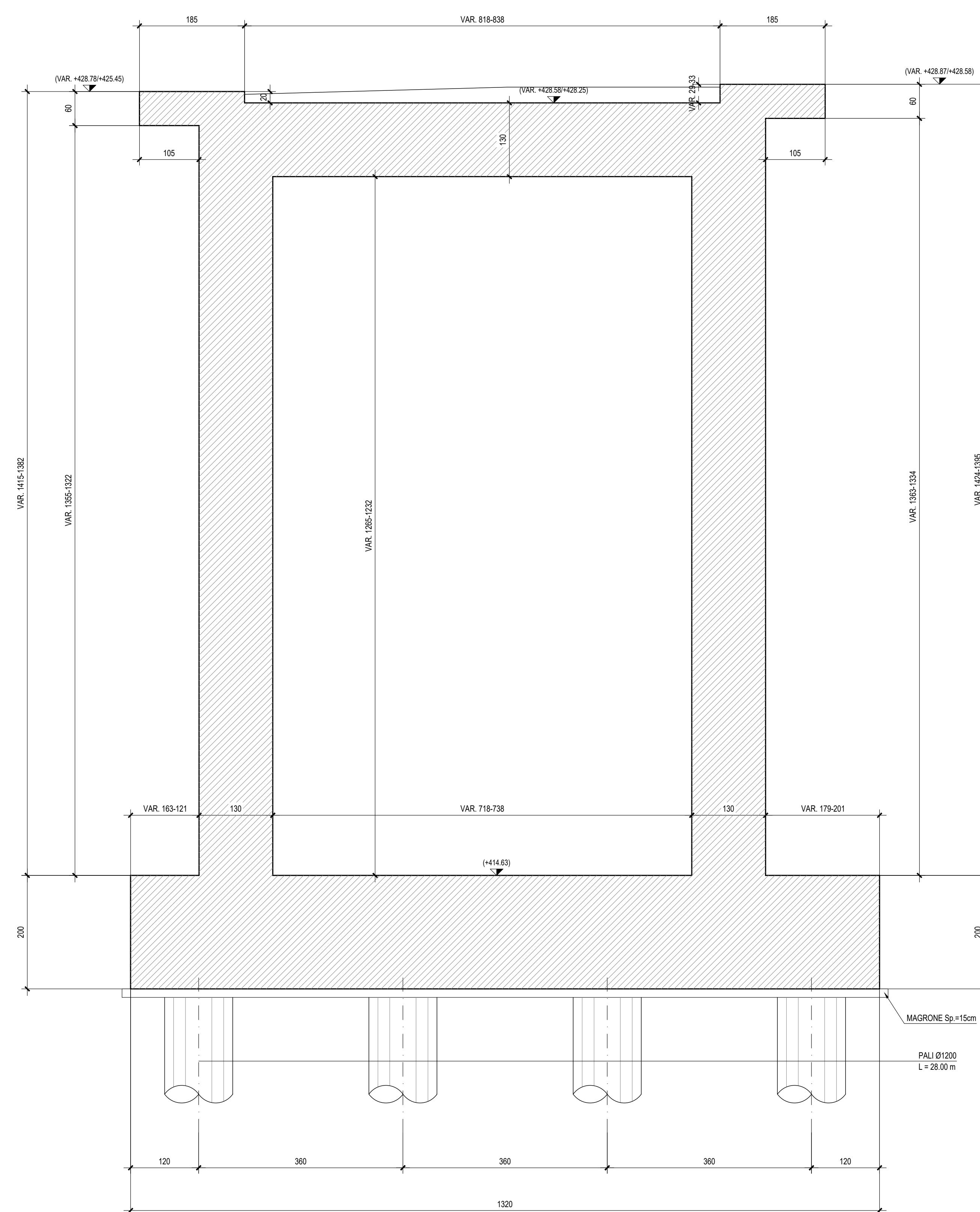

SEZIONE C-C - Scala 1:50

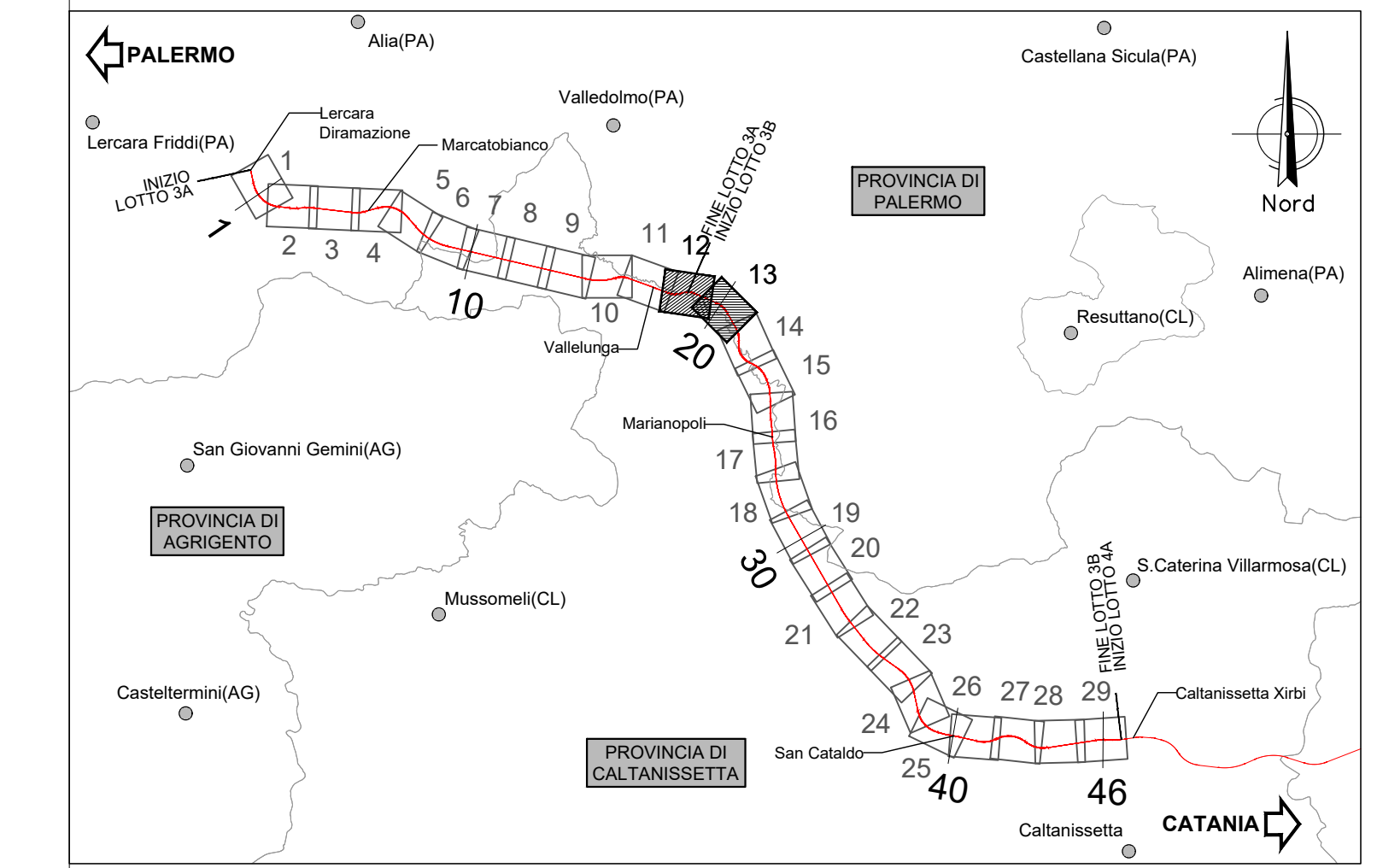
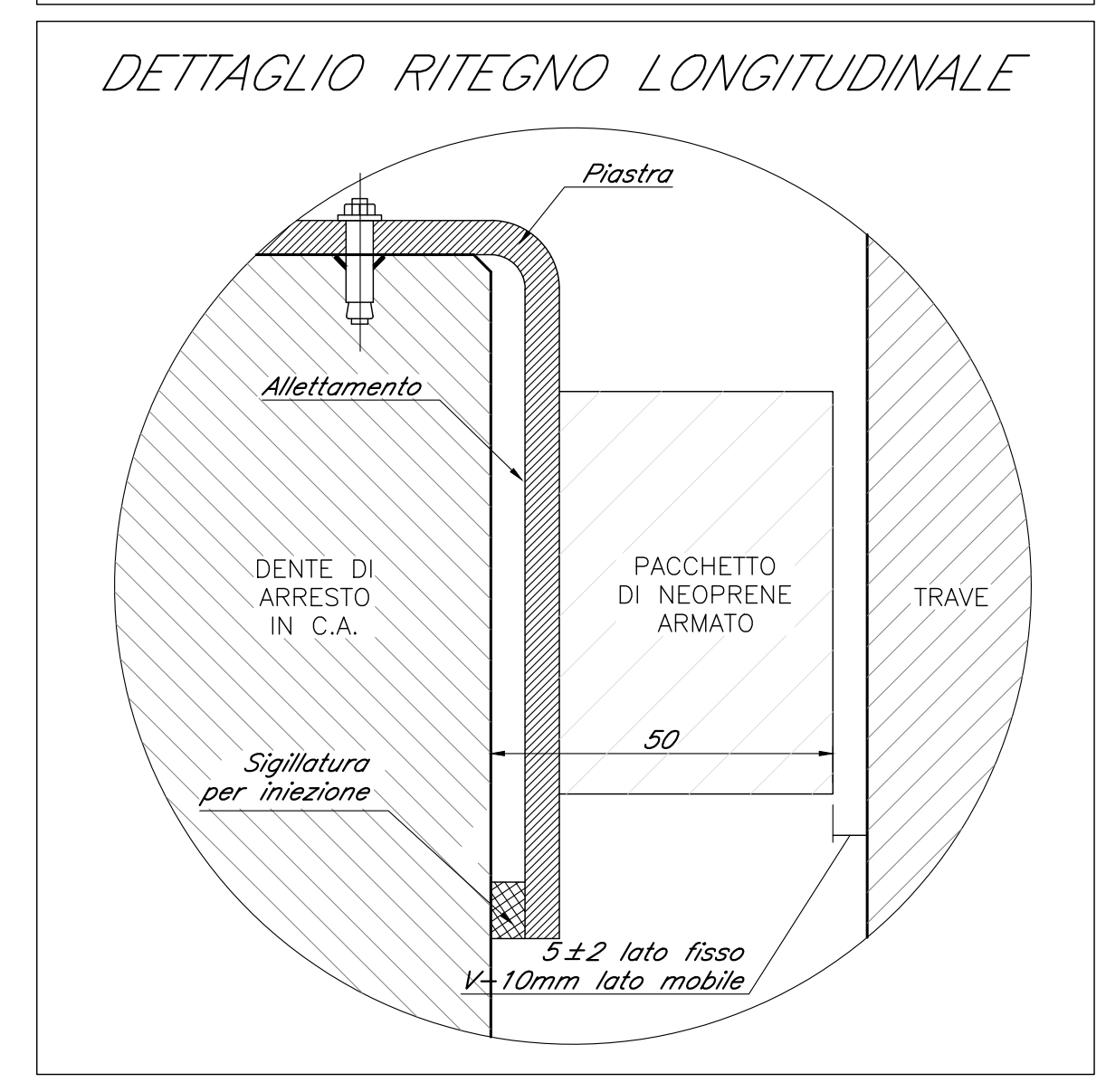
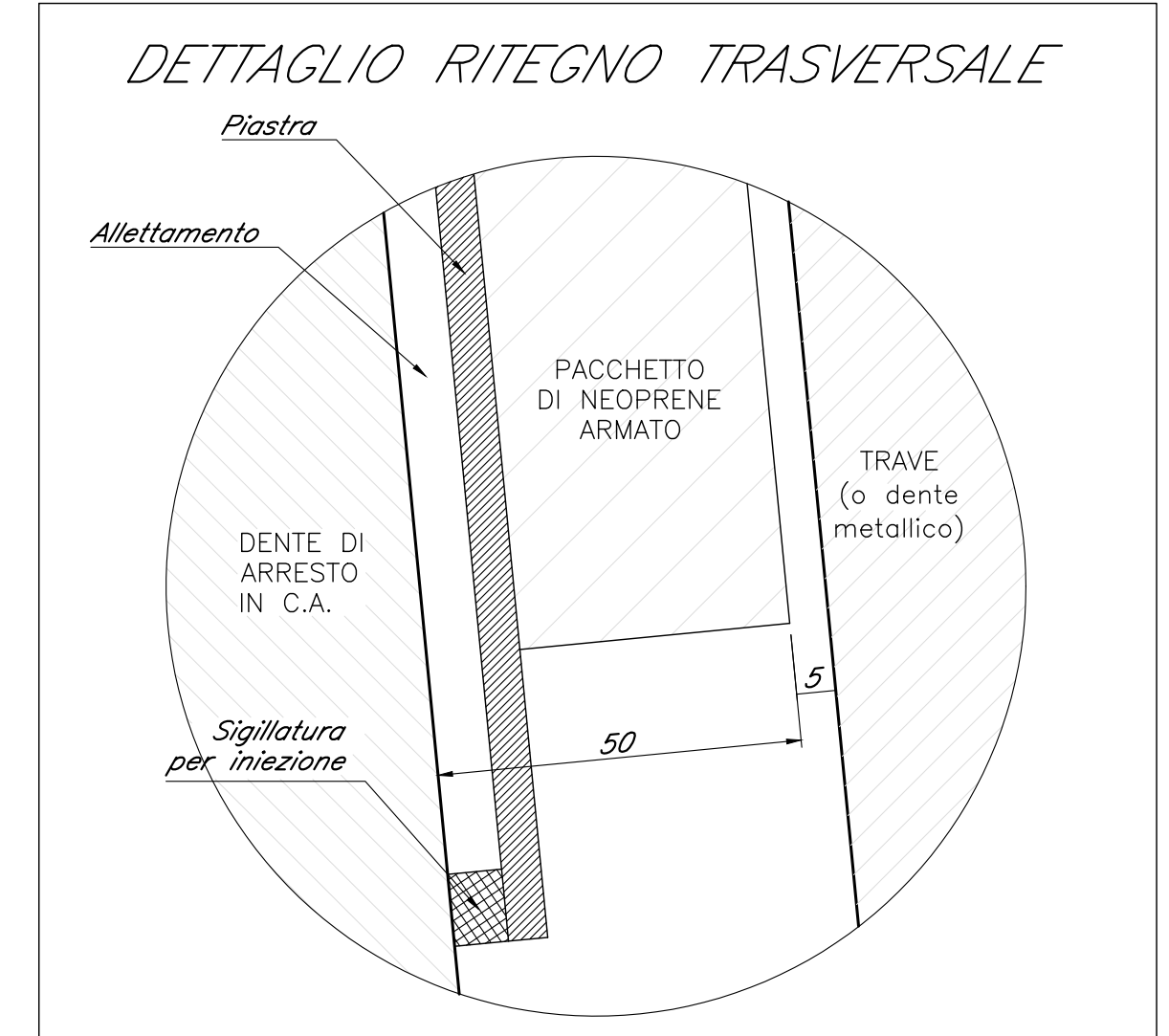
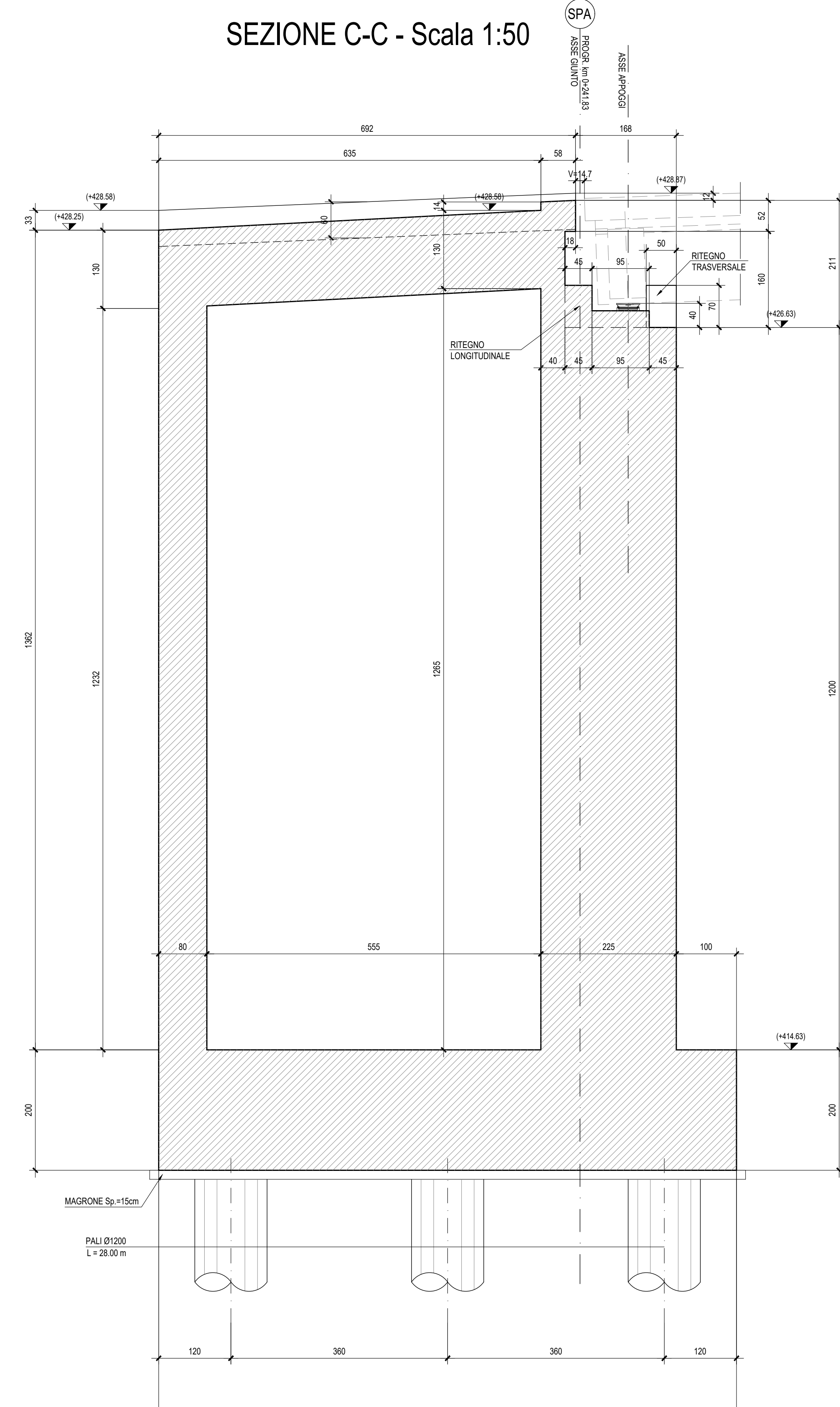

NB: Per la tabella materiali rimanda all'elaborato "RSST.3.0.D.09.TT.VI.00.0.0.001.A"

COMMITTENTE: **RFI** RETE FERROVIARIA ITALIANA GRUPPO FERROVIE DELLO STATO ITALIANO

PROGETTAZIONE: **ITALFERR** GRUPPO FERROVIE DELLO STATO ITALIANO

DIRETTRICE FERROVIARIA MESSINA - CATANIA - PALERMO

NUOVO COLLEGAMENTO PALERMO - CATANIA

U.O. OPERE CIVILI E GESTIONE DELLE VARIANTI

PROGETTO DEFINITIVO

TRATTA LERCARA DIR. - CALTANISSETTA XIRBI (LOTTO 3)

VIADOTTI IN INTERFERENZA  
IV02 - CAVALCAFERROVIA SU NV51  
Carpenteria Spalla A

SCALA: 1:50

Rev.	Descrizione	Redatto	Data	Verificato	Data	Approvato	Data	Autorizzato Data
A	Emissione Esecutiva	AV/001	09/2020	A/001	09/2020	A/001	09/2020	
B	Emissione Esecutiva	AV/001	09/2020	A/001	09/2020	A/001	09/2020	

File: RSST.3.0.D.09.BB.IV.02.0.0.001.B in. Elab.: 09.610