

PIANTA SPICCATO - Scala 1:50

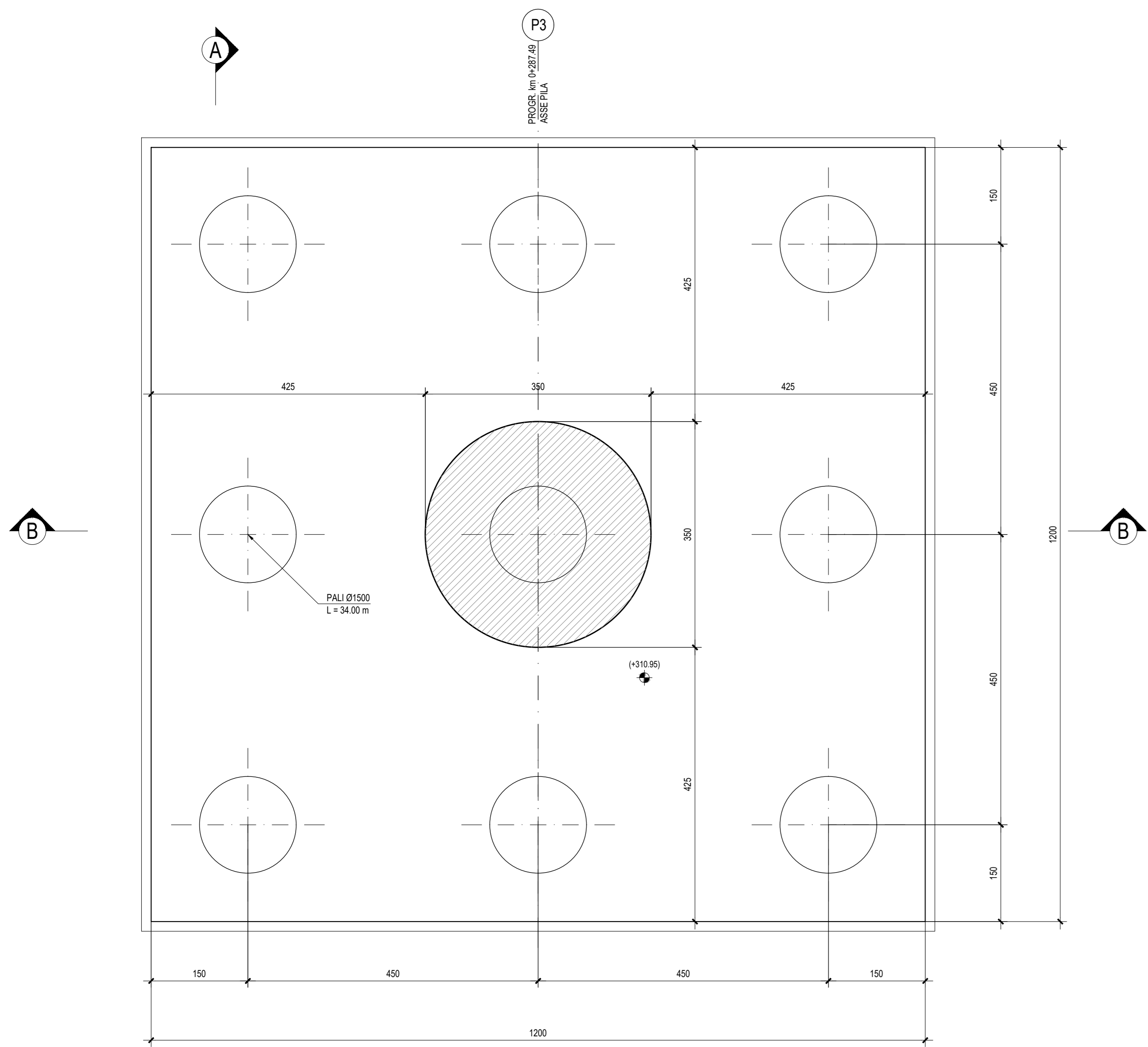

VISTA A-A - Scala 1:50

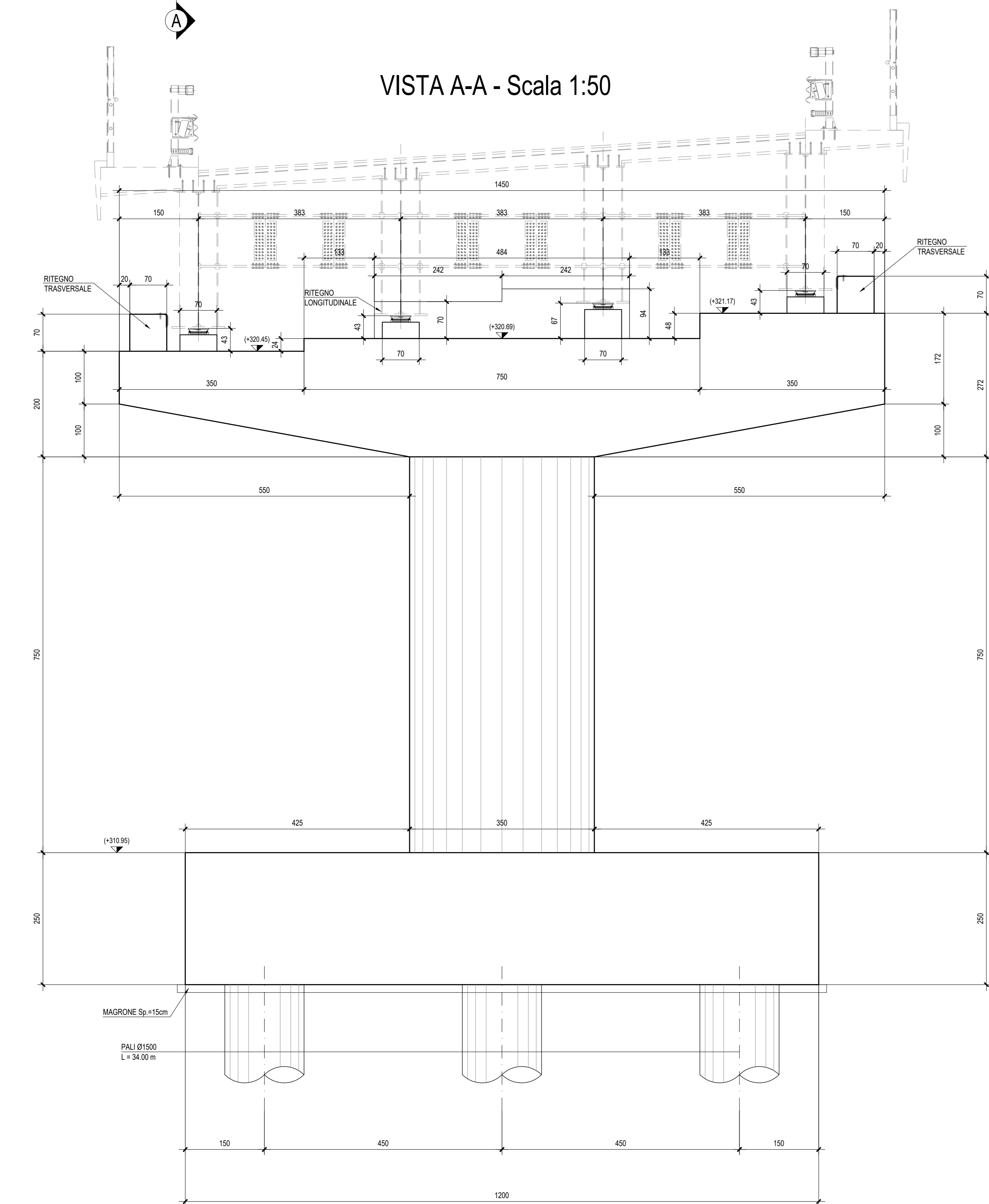

PIANTA PULVINO - Scala 1:50

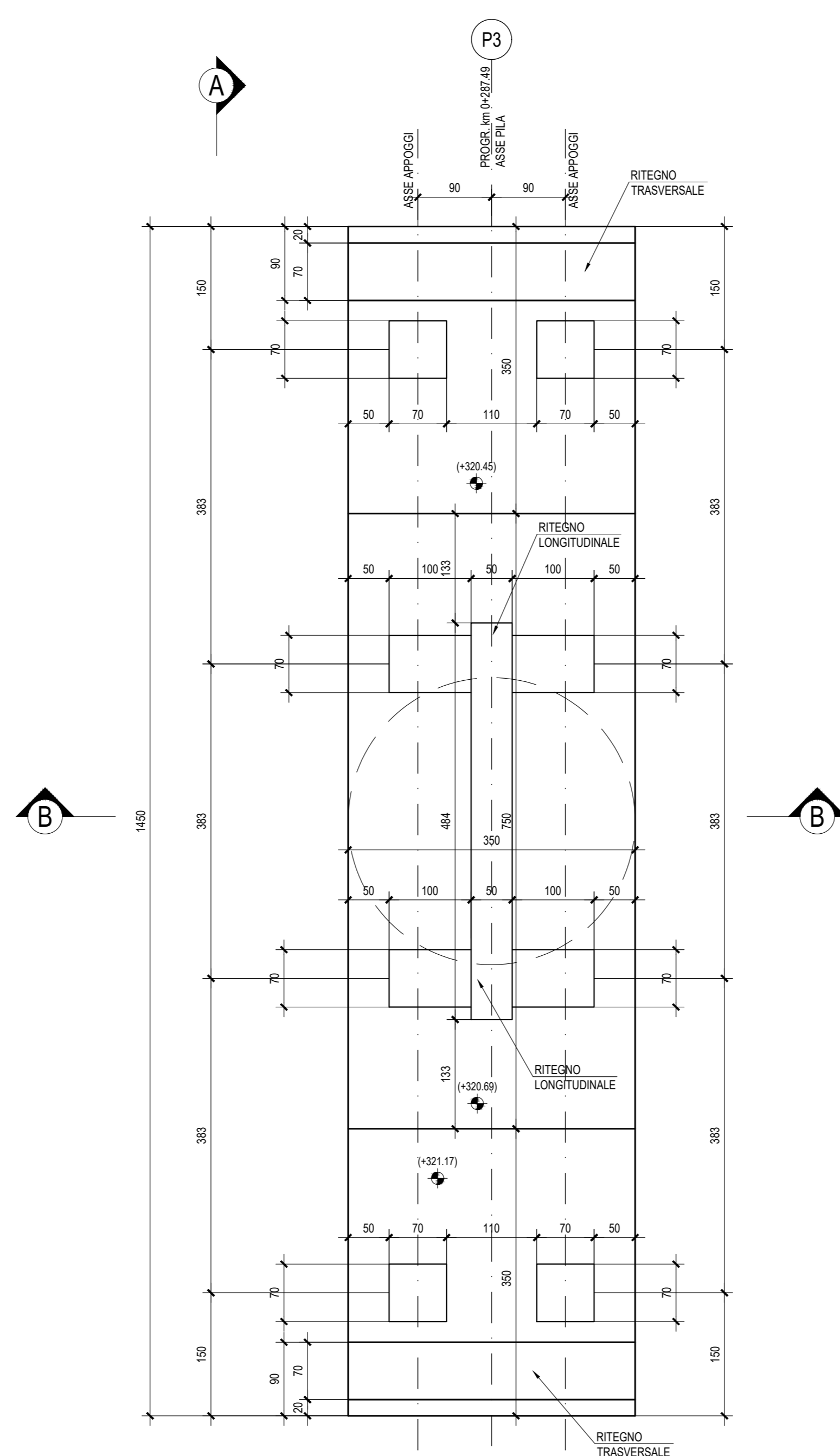

SEZIONE B-B - Scala 1:50

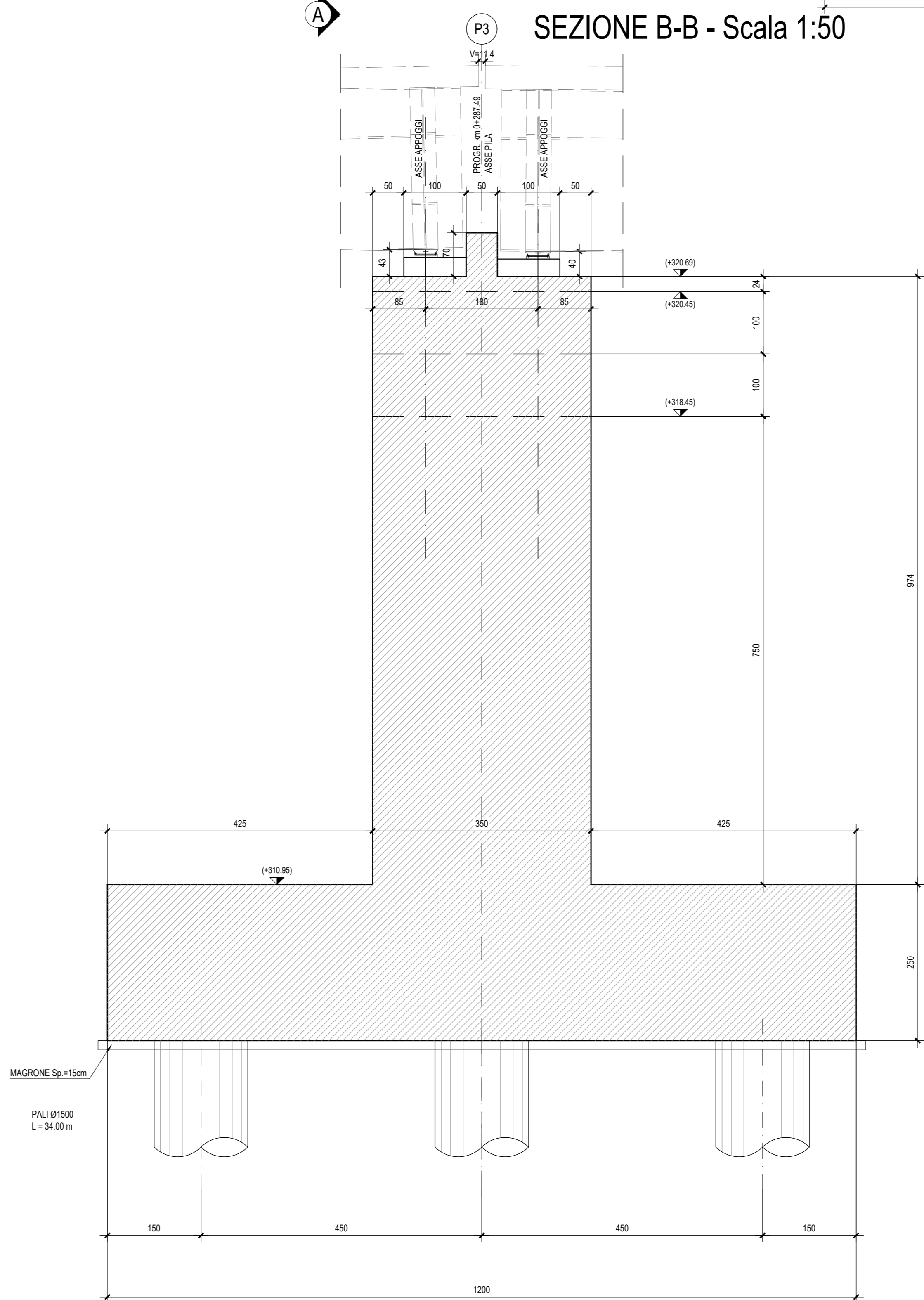

VISTA LATERALE - Scala 1:50

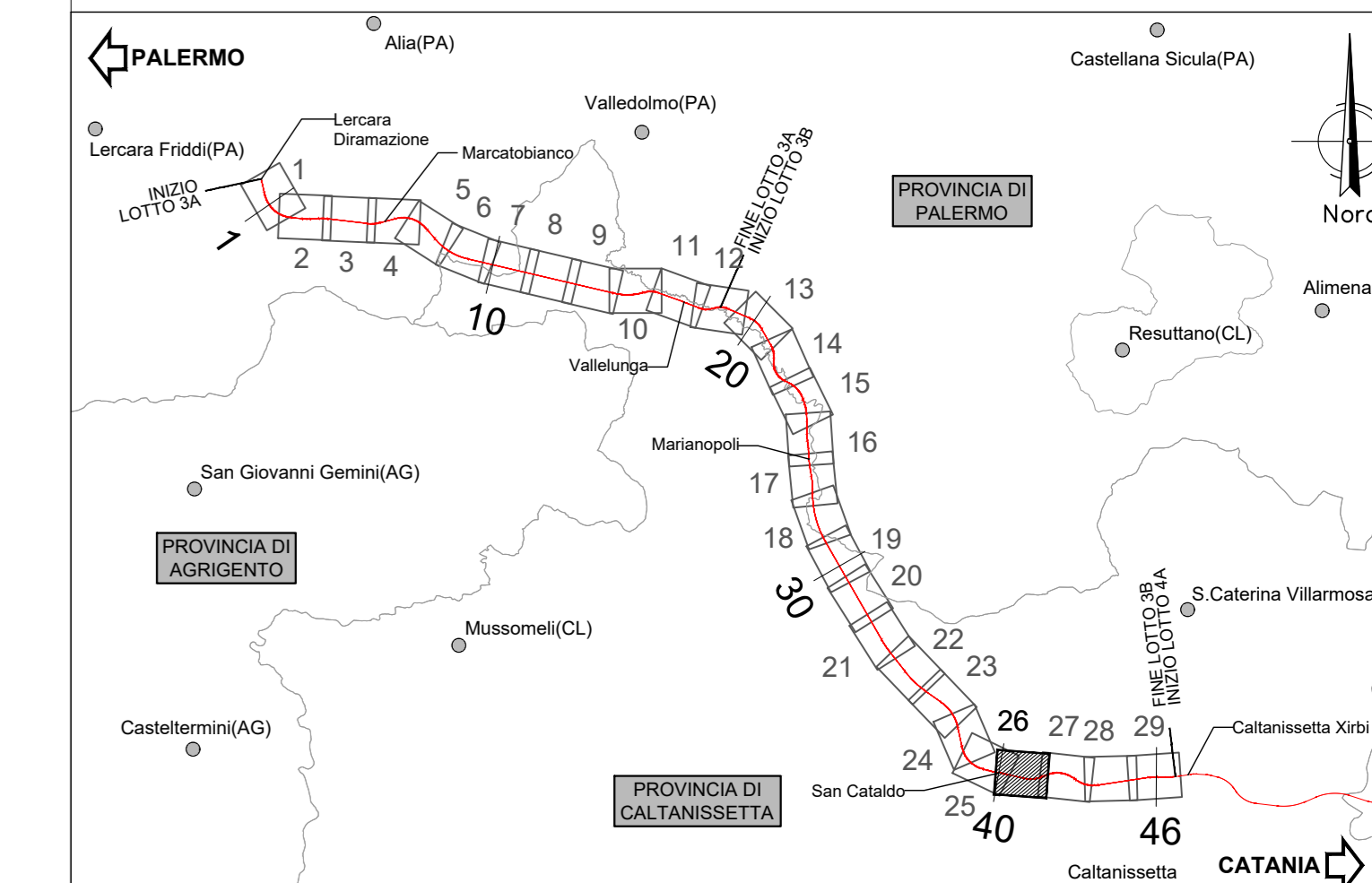
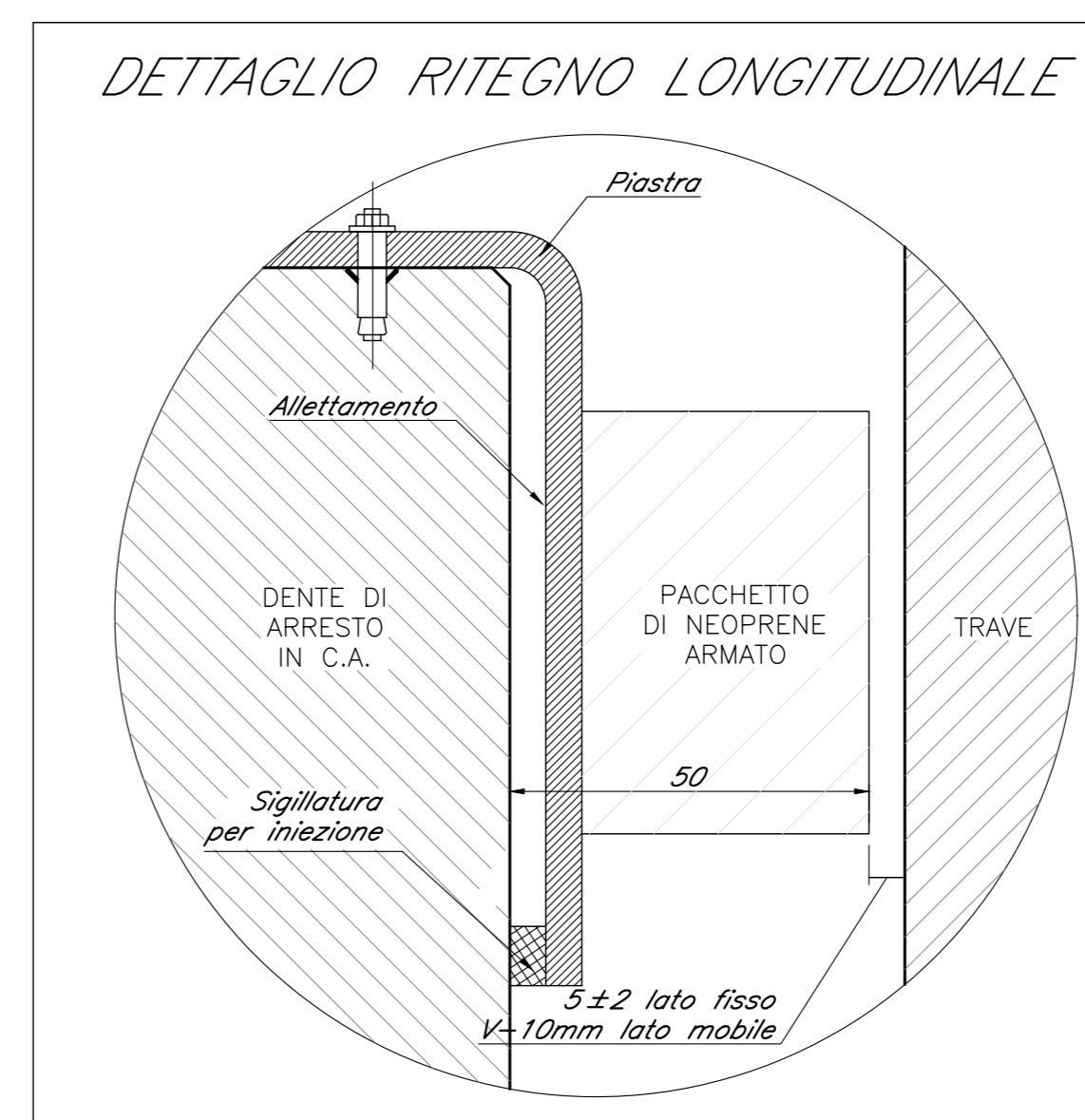
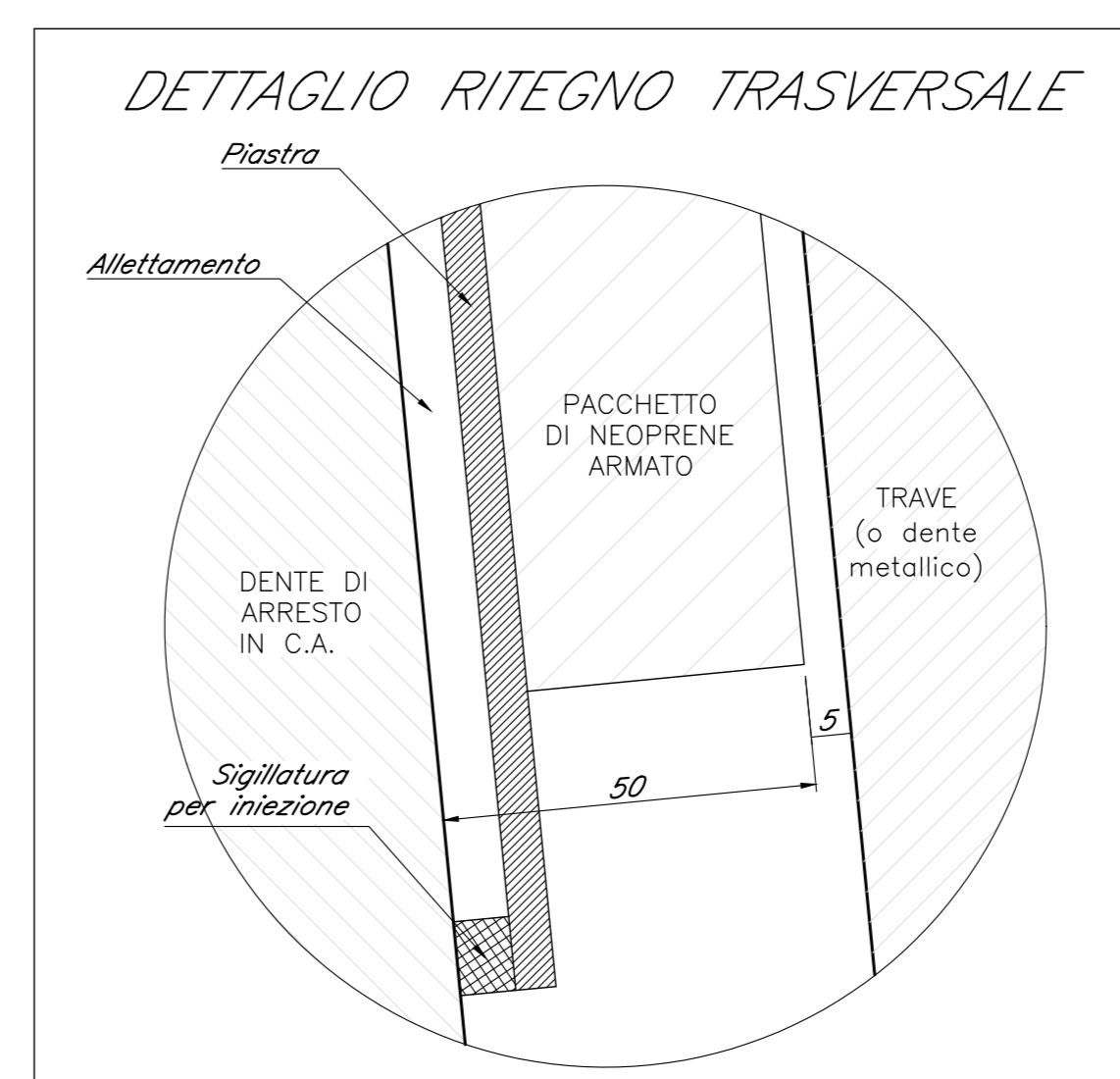
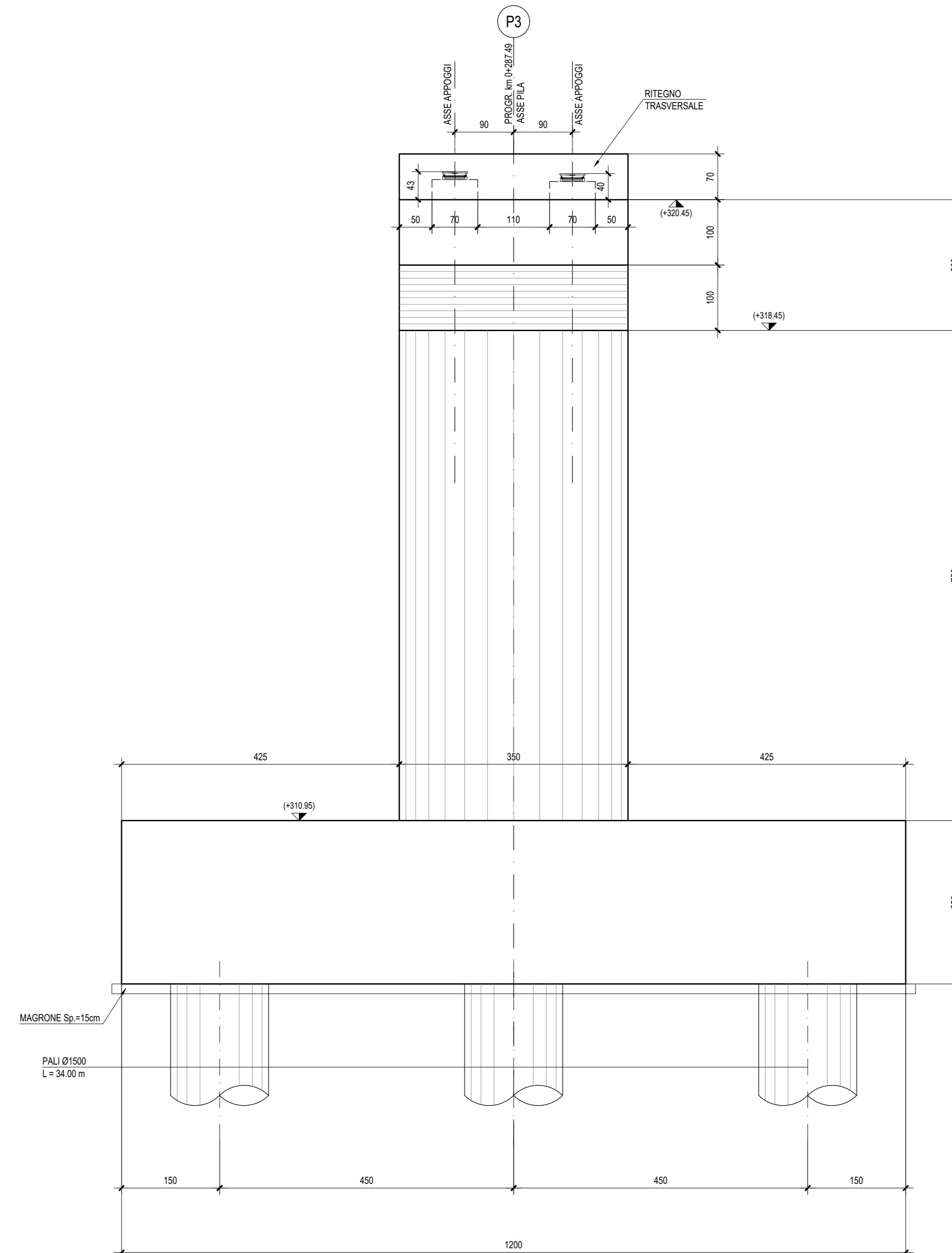

NB: Per la tabella materiali rimanda all'elaborato "RS3T.3.0.D.09.TT.VI.00.0.0.001.A"

COMMITTENTE: **RFI** RETE FERROVIARIA ITALIANA GRUPPO FERROVIE DELLO STATO ITALIANE

PROGETTAZIONE: **ITALFERR** GRUPPO FERROVIE DELLO STATO ITALIANE

DIRETTRICE FERROVIARIA MESSINA - CATANIA - PALERMO  
**NUOVO COLLEGAMENTO PALERMO - CATANIA**

U.O. OPERE CIVILI E GESTIONE DELLE VARIANTI

PROGETTO DEFINITIVO  
**TRATTA LERCARA DIR. - CALTANISSETTA XIRBI (LOTTO 3)**

VIADOTTI IN INTERFERENZA  
 IV03 - CAVALCAFERROVIA SU NV62C  
 Carpenteria Pila 3

SCALA: 1:50

| Rev. | Descrizione         | Redatto | Data     | Verificato | Data     | Approvato | Data     | Autore |
|------|---------------------|---------|----------|------------|----------|-----------|----------|--------|
| A    | Emissione Esecutiva | ...     | Gen-2009 | ...        | Gen-2009 | ...       | Gen-2009 | ...    |
| B    | Emissione Esecutiva | ...     | Mag-2009 | ...        | Mag-2009 | ...       | Mag-2009 | ...    |

File: RS3T.3.0.D.09.BB.IV.03.0.0.004.B n. Elab.: 09\_629