

ARMATURA SOLETTA DI FONDAZIONE STRADALE  
scala 1:200





TABELLA FERRI					
POS.	Num.	Ø [mm]	Lunghezza [cm]	TOTALE [m]	PESO [kg]
27a	133	20	1200	1596.00	3935.97
27b	133	20	1200	1596.00	3935.97
27c	133	20	340	452.20	1115.19
27d	133	20	1200	1596.00	3935.97
27e	133	20	1200	1596.00	3935.97
27f	133	20	818	1087.94	2683.02
27g	133	20	580	771.40	1902.39
27h	133	20	1200	1596.00	3935.97
27i	133	20	1200	1596.00	3935.97
28a	133	20	340	452.20	1115.19
28b	133	20	1200	1596.00	3935.97
28c	133	20	1200	1596.00	3935.97
28d	133	20	1200	1596.00	3935.97
28e	133	20	1200	1596.00	3935.97
28f	133	20	818	1087.94	2683.02
28g	133	20	1200	1596.00	3935.97
28h	133	20	1200	1596.00	3935.97
28i	133	20	580	771.40	1902.39
29	3300	22	160	5280.00	15755.74
30a	413	22	1200	4956.00	14788.91
30b	413	22	605	2498.65	7456.07
30c	413	22	1200	4956.00	14788.91
30d	413	22	480	1982.40	5915.56
31a	413	22	1200	4956.00	14788.91
31b	413	22	605	2498.65	7456.07
31c	413	22	1200	4956.00	14788.91
31d	413	22	480	1982.40	5915.56
32	1660	20	63	1045.80	2579.10
33	1485	12	0	0.00	13632.30
Totale Kg =					176498.95

ARMATURA SOLETTA DI FONDAZIONE STRADALE - RIVESTIMENTO DIAFRAMMI Sezione D-D  
scala 1:100

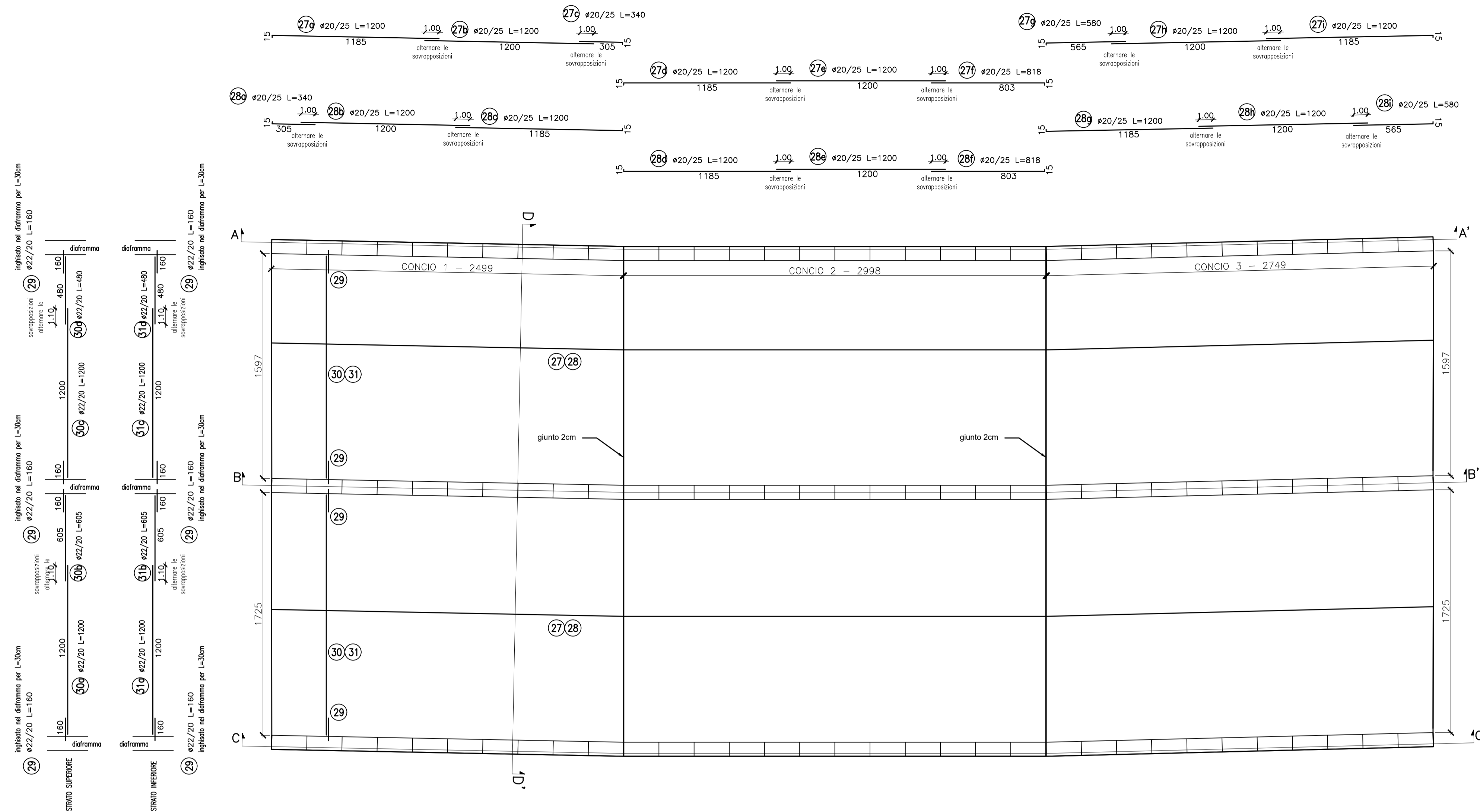
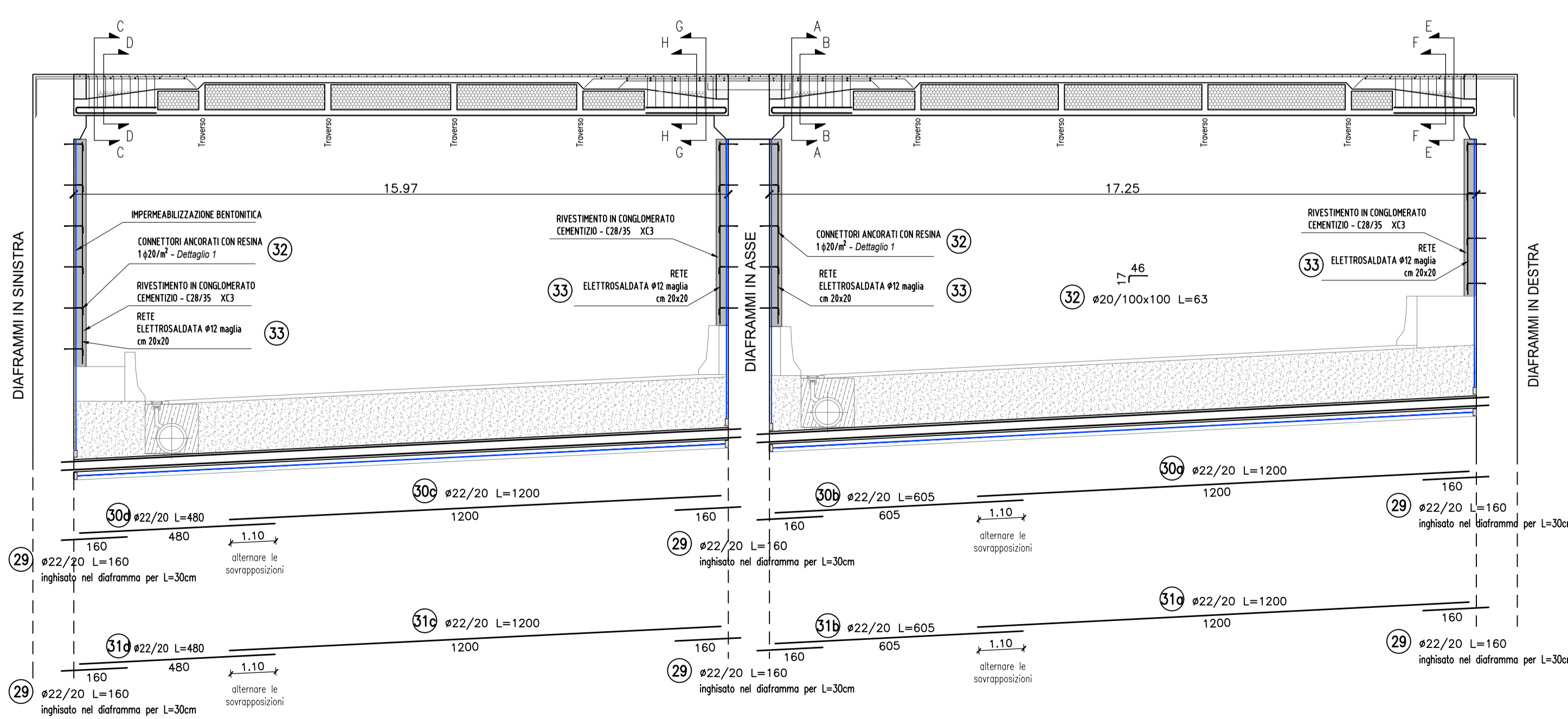
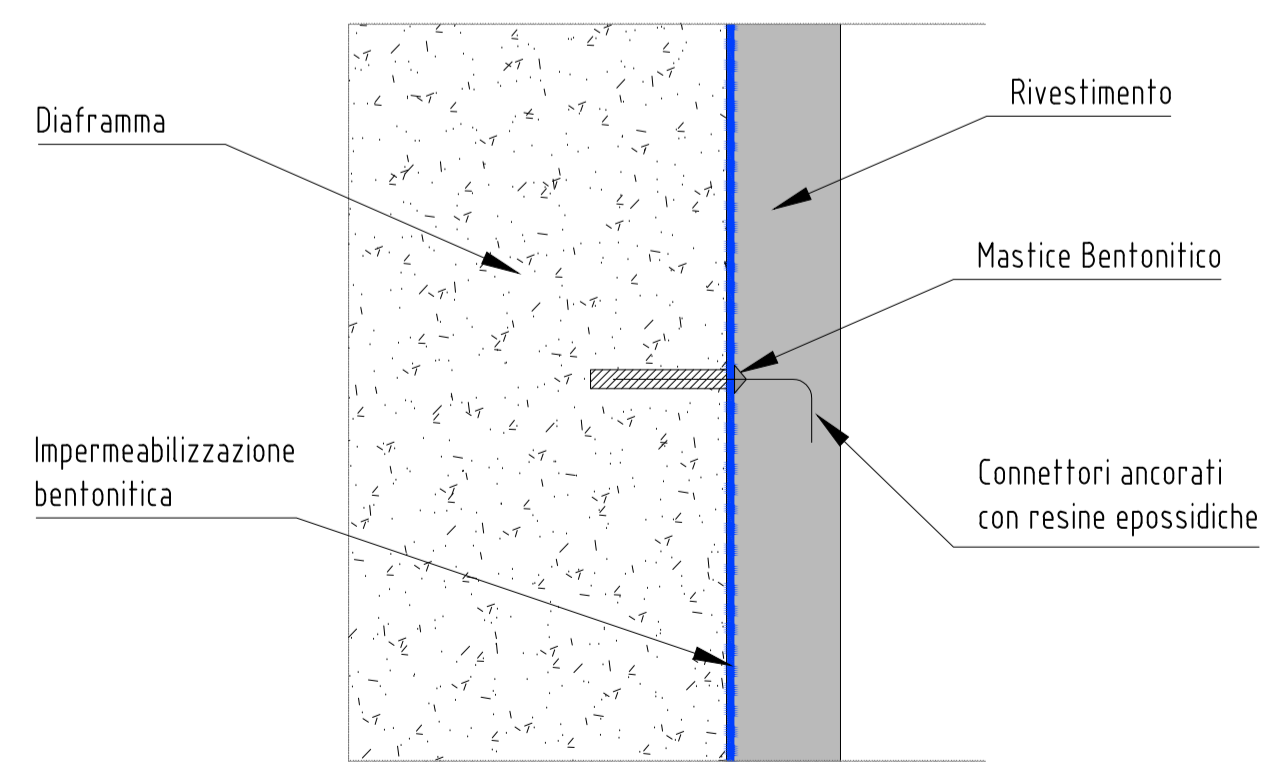

FERRI DI ANCORAGGIO  
DETTAGLIO 1  
scala 1:20













**ANAS S.p.A.**  
Direzione Progettazione e Realizzazione Lavori

NUOVA S.S. 341 "GALLARATESE" - TRATTO DA SAMARATE A CONFINE  
CON LA PROVINCIA DI NOVARA - TRATTO NORD

**STRALCIO FUNZIONALE DAL KM 6+500 (SVINCOLO S.S. 336 NORD)  
AL KM 8+844 (SVINCOLO AUTOSTRADA A8)  
"BRETTELLA DI GALLARATE"**

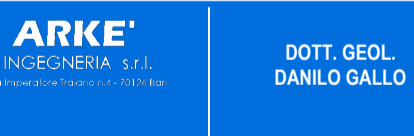
**PROGETTO ESECUTIVO**

 Ing. Valerio Bajetti Codice Prof. Ing. 6 Riviera di Genova P.A. 20211	 Ing. Renato Del Prete Codice Prof. Ing. 47 Bari in provincia P.A. 20211	 Arch. Nicoletta Frattini Codice Prof. Ing. 6 Riviera di Genova P.A. 20211	 Ing. Gabriele Inceduto Codice Prof. Ing. 6 Riviera di Genova P.A. 20211
 Ing. Renato Vaira Codice Prof. Ing. 6 Torino e Provincia P.A. 20211	 Prof. Ing. Luigi Monterisi Codice Prof. Ing. 6 Bari in provincia P.A. 20211	 Ing. Giacchino Argenaro Codice Prof. Ing. 6 Bari in provincia P.A. 20211	 Dott. Geol. Danilo Gallo Codice Prof. Ing. 6 Riviera di Genova P.A. 20211

VISTO: IL RESPONSABILE DEL PROCEDIMENTO:   
Dott. Ing. Giancarlo LUONGO

RESPONSABILE INTEGRAZIONE DELLE PRESTAZIONI SPECIALISTICHE:   
Ing. Valerio BAJETTI

IL PROGETTISTA FIRMATARIO DELLA PRESTAZIONE:   
Prof. Ing. Geol. Luigi MONTERISI

GEOLOGO:   
Dott. Geol. Danilo GALLO

COORDINATORE DELLA SICUREZZA IN FASE DI PROGETTAZIONE:   
Ing. Gaetano RANIERI

**H-PROGETTO STRUTTURALE OPERE PRINCIPALI**  
**HO - GA05 - GALLERIA ARTIFICIALE PROG. 6+840**  
Armatura Pianta e Sezione- Soletta di fondazione stradale

CODICE PROGETTO		NOME FILE		REVISIONE	SCALA:
PROGETTO	LIV. PROG.	N. PROG.	HO009_P00GA01STRAR04_A.dwg		
M I 5 3 3	E	1 8 0 1	CODICE ELAB.	P 0 0 G A 0 1 S T R A R 0 4	A
D					
C					
B					
A	EMISSIONE	MARZO 2021	PROF. ING. LUIGI MONTERISI	ING. VALERIO BAJETTI	ING. RENATO DEL PRETE
REV.	DESCRIZIONE	DATA	REDATTO	VERIFICATO	APPROVATO