

PIANTA SPICCATO FONDAZIONI  
Scala 1:100

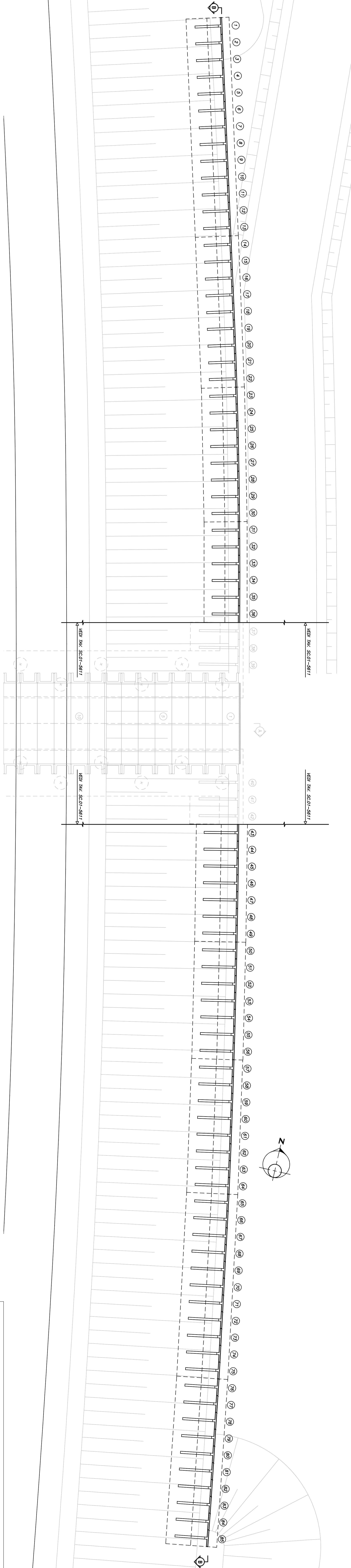

SEZIONE TIPO  
MURO DI SOSTEGNO SERIE TM

TABLE showing dimensions and characteristics for the 'MURO DI SOSTEGNO SERIE TM' wall. It lists parameters like height (H), width (C), and other dimensions for various wall heights from 3.00m to 5.00m.

SEZIONE TIPO  
MURO DI SOSTEGNO SERIE NM

TABLE showing dimensions and characteristics for the 'MURO DI SOSTEGNO SERIE NM' wall. It lists parameters like height (H), width (C), and other dimensions for various wall heights from 1.50m to 5.00m.

CARATTERISTICHE DEI MATERIALI

- Technical specifications for concrete (C25/30, C32/36, C38/52, etc.), reinforcement (B4, B5, B6), and other materials used in the wall construction.

NOTE GENERALI

General notes regarding the drawing, including project information and specific instructions for the construction of the retaining wall.

Project information including the company name 'Anas SPA', project title 'S.S. N. 9 "Via Emilia"', and the role of the engineer 'PROGETTO DEFINITIVO'.

Table with columns for 'REVISIONI', 'DATA', and 'PRODOTTO' detailing the stages and dates of the project's development.

Administrative forms for project registration, including fields for code (MU01 5811), date (MARCO 2009), and signature.