

PROSELA ODDOROMILE ASSE 96

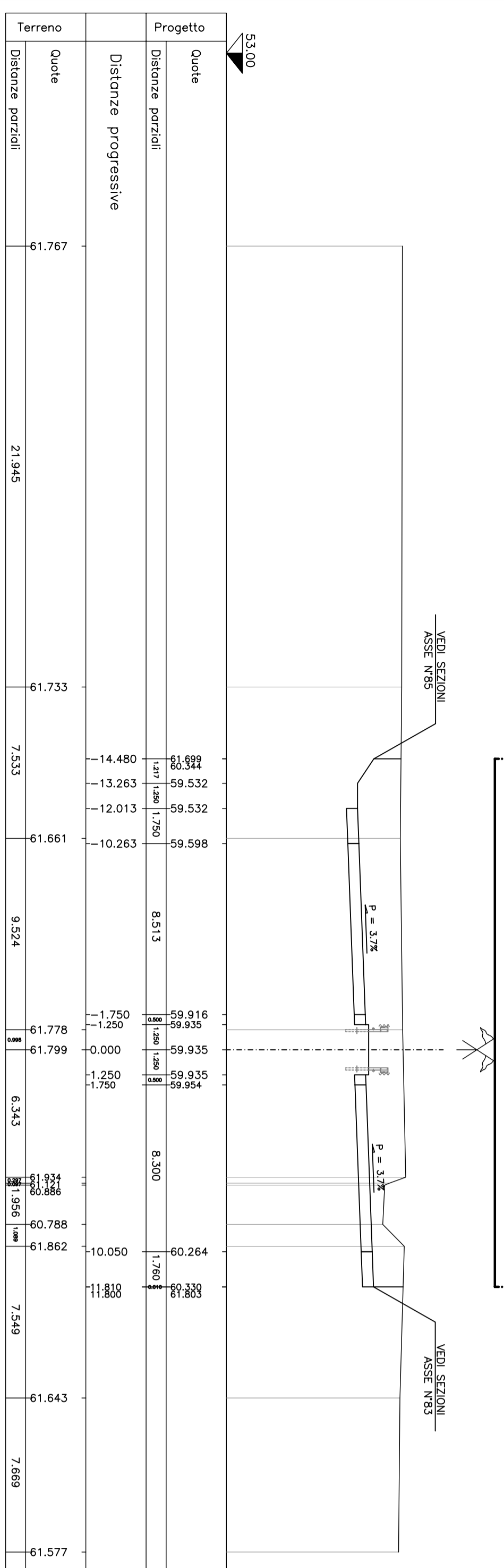

A-267
PROGR. 6375,371
PARZ. 22,295

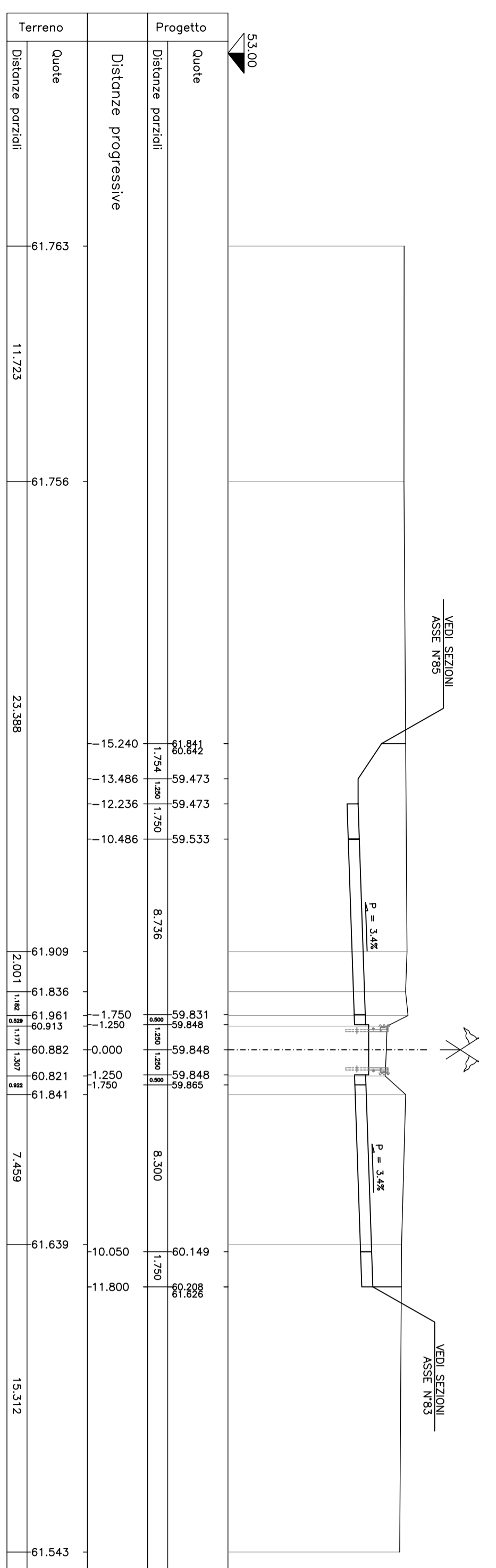

A-268
PROGR. 6425,371
PARZ. 27,705

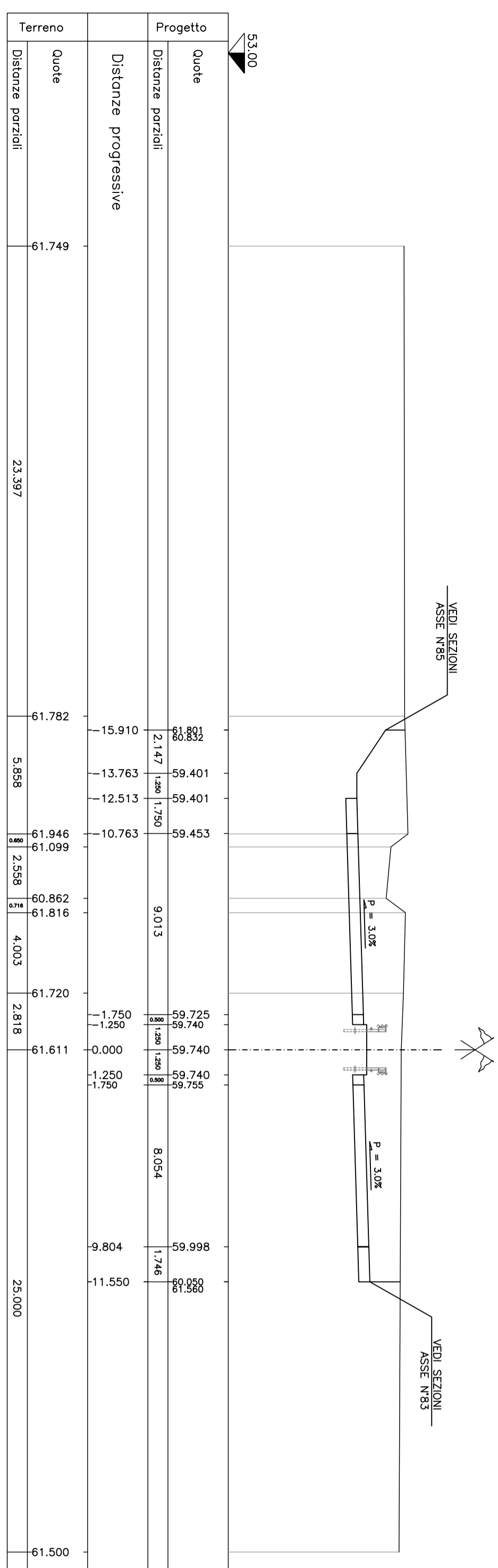

A-269
PROGR. 6450,371
PARZ. 25,000

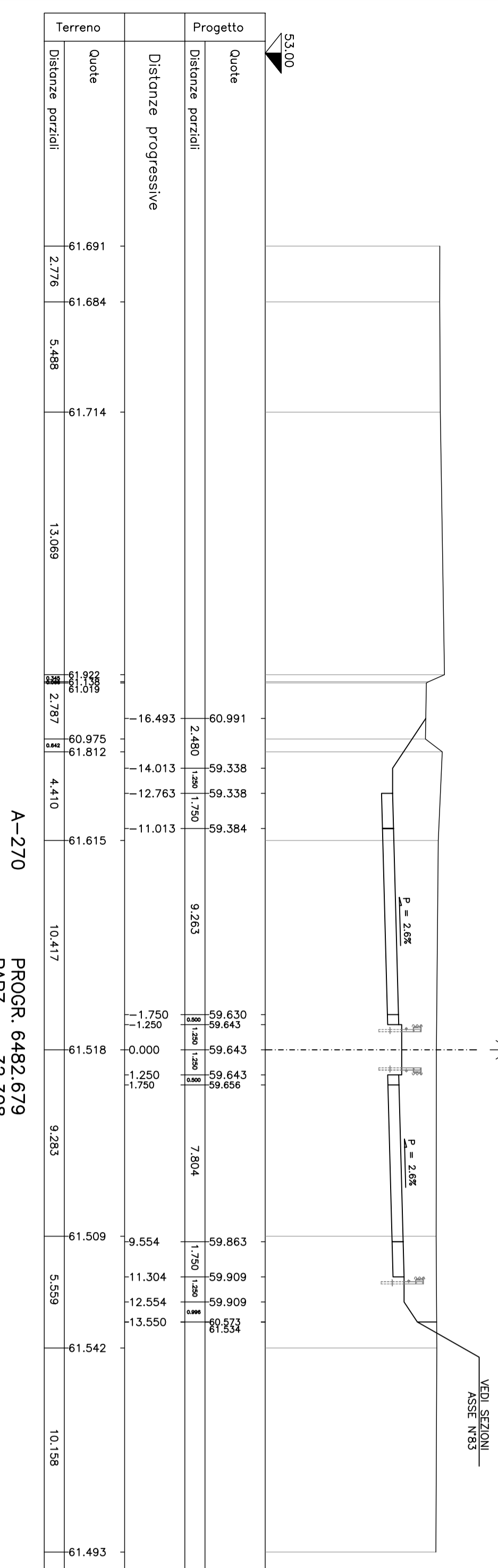

A-270
PROGR. 6482,679
PARZ. 32,308

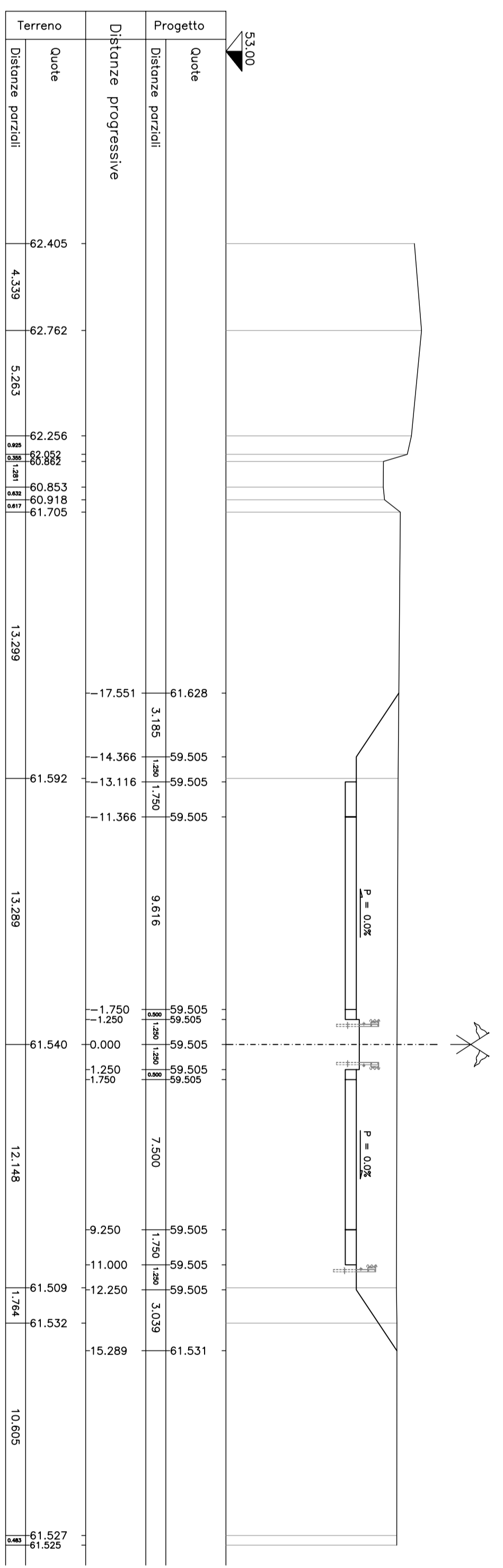
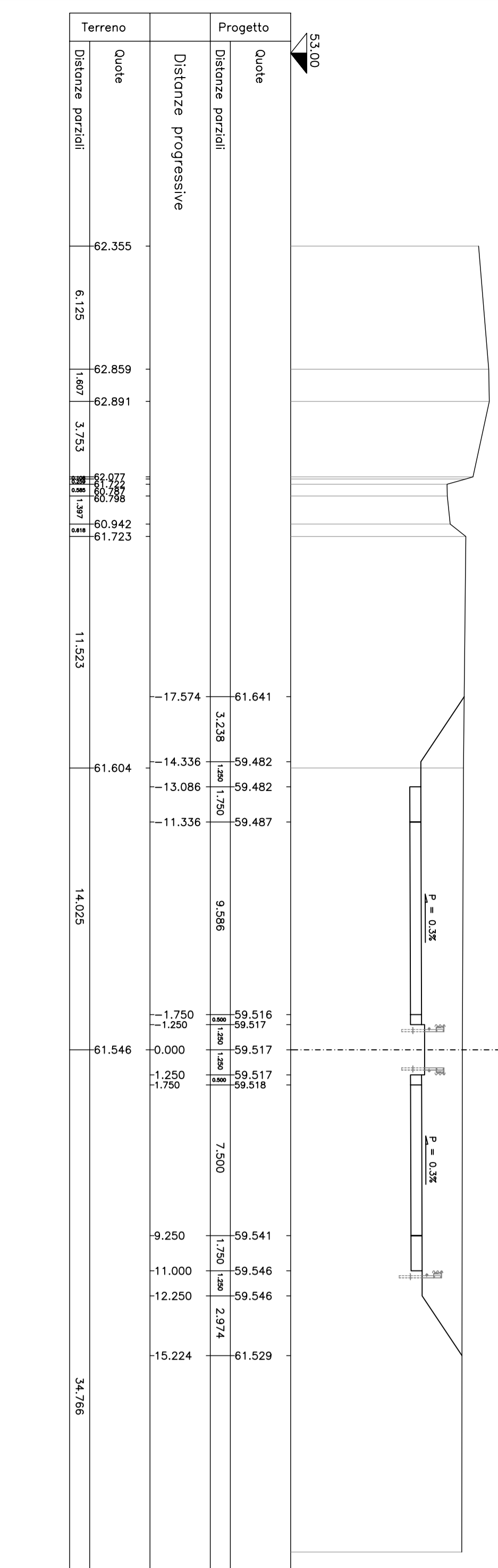

SEZ.NUM. A-271A
PROGR. 6511,667
PARZ. 28,198

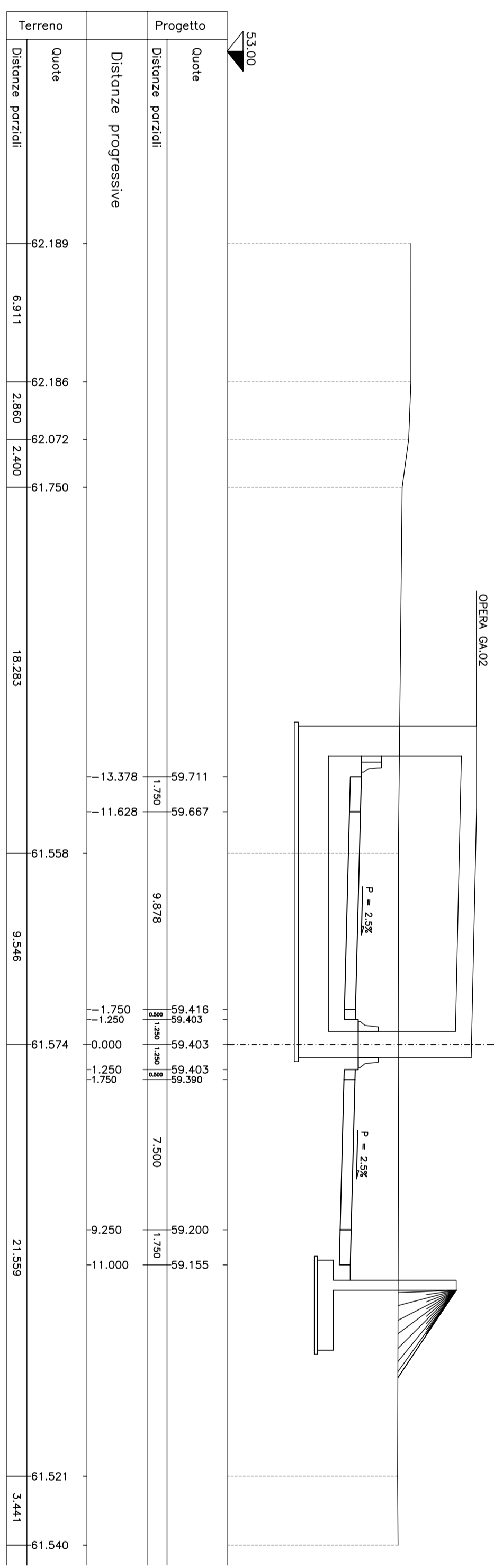

SEZ.NUM. A-271B
PROGR. 6515,972
PARZ. 4,105

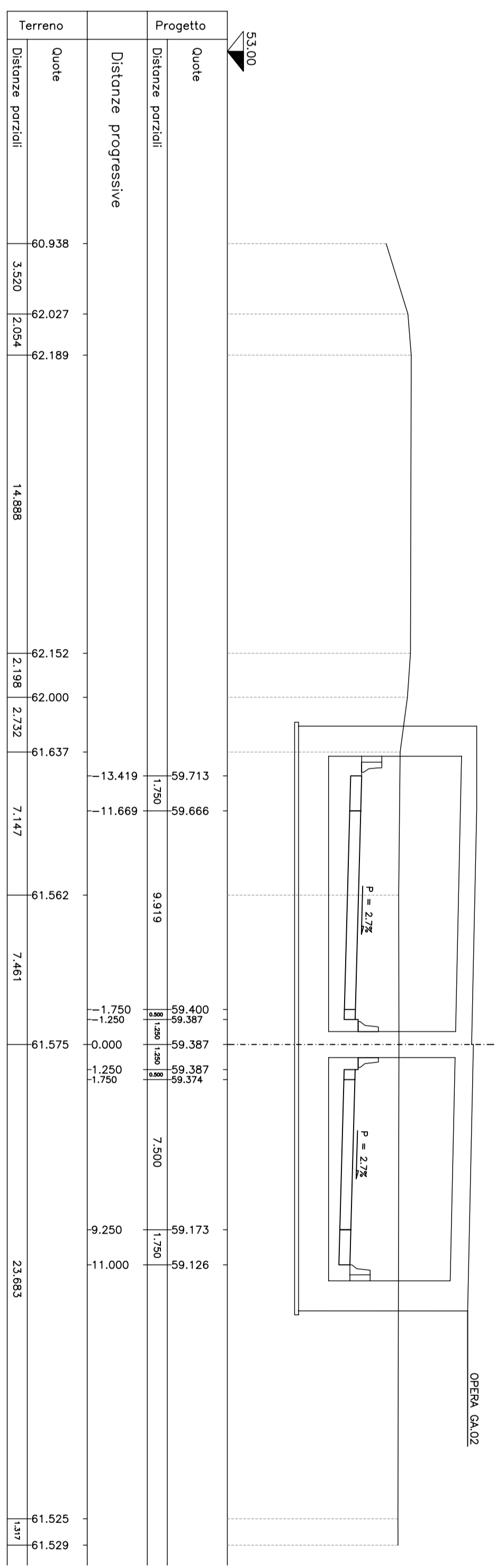

SEZ.NUM. A-272
PROGR. 6523,967
PARZ. 7,995

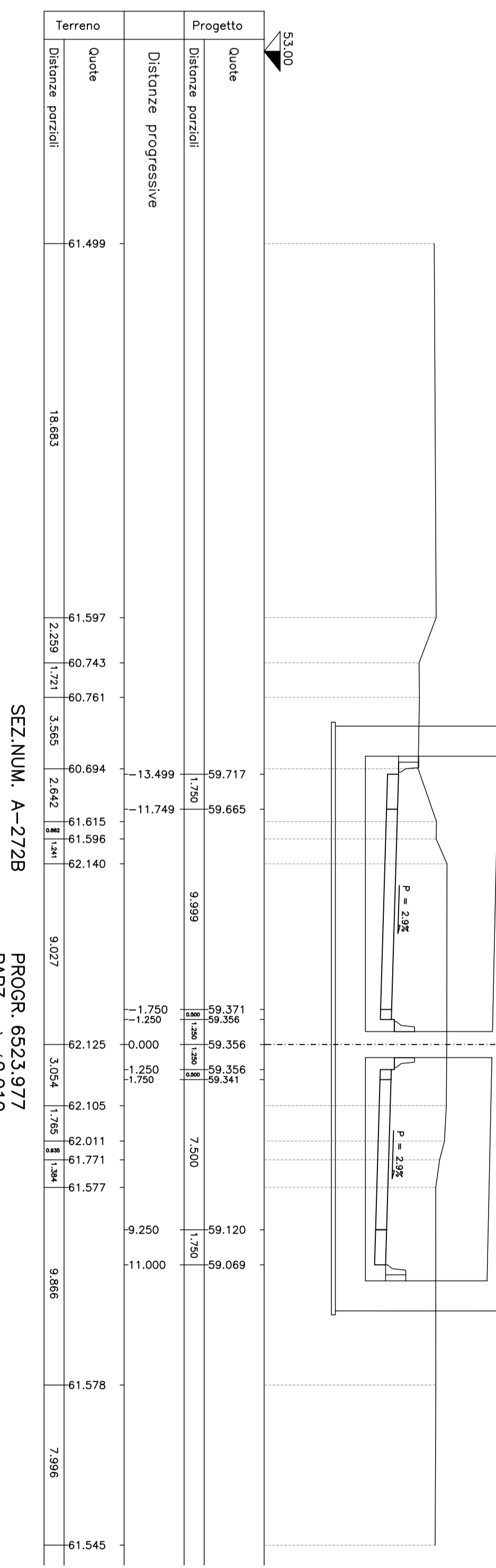

SEZ.NUM. A-272B
PROGR. 6523,977
PARZ. 40,070

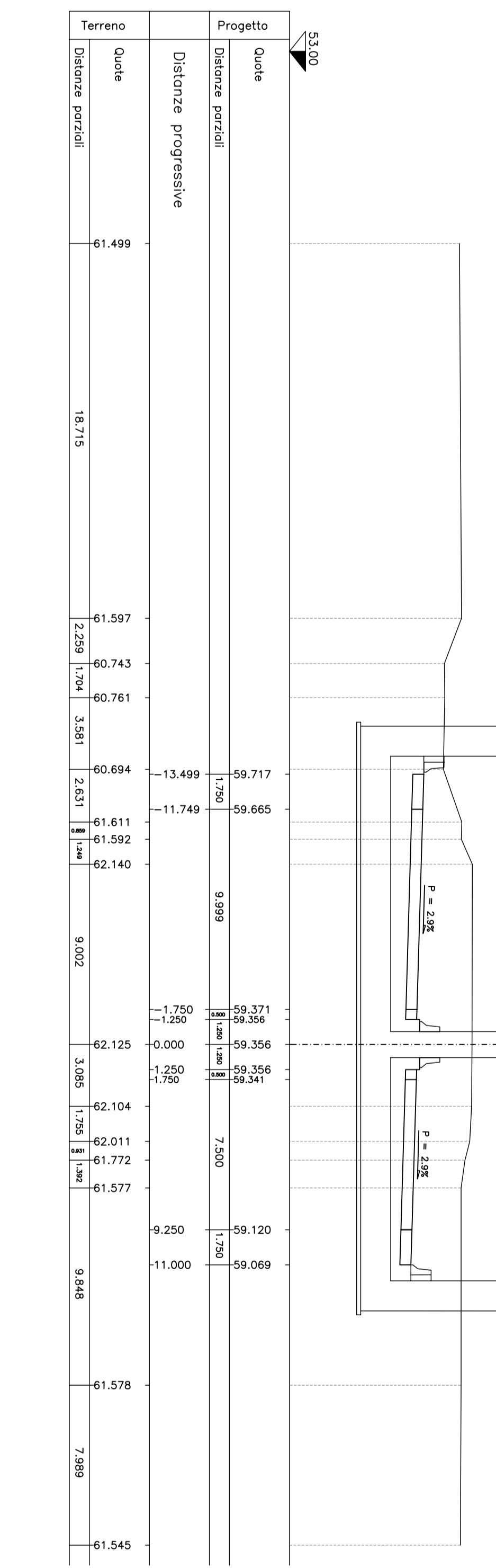

Anas SPA
DIREZIONE CENTRALE PROGETTAZIONE
S.S. N. 9 "Via Emilia"
Variante di Casalpusterleno ed eliminazione
passaggio a livello sulla SP ex S.S. N. 234
PROGETTO DEFINITIVO

CONTRIBUTI SPECIALISTICI

INGEGNERIA	INGEGNERIA
STRUTTURALE	STRUTTURALE
GEOMETRICA	GEOMETRICA
PAESAGGISTICA	PAESAGGISTICA
... (and other specialties)	... (and other specialties)

SEZIONI TRASVERSALI ASSE 01 DA SEZ. A-266 A SEZ. A-272 B

SEZIONE	DATA	PRODOTTORE
A-266
A-267
A-268
A-269
A-270
A-271
A-271A
A-271B
A-272
A-272A
A-272B

SA05 1529
FEBBRAIO 2011
C 01-01