

PIANTA SPICCATO - Scala 1:50

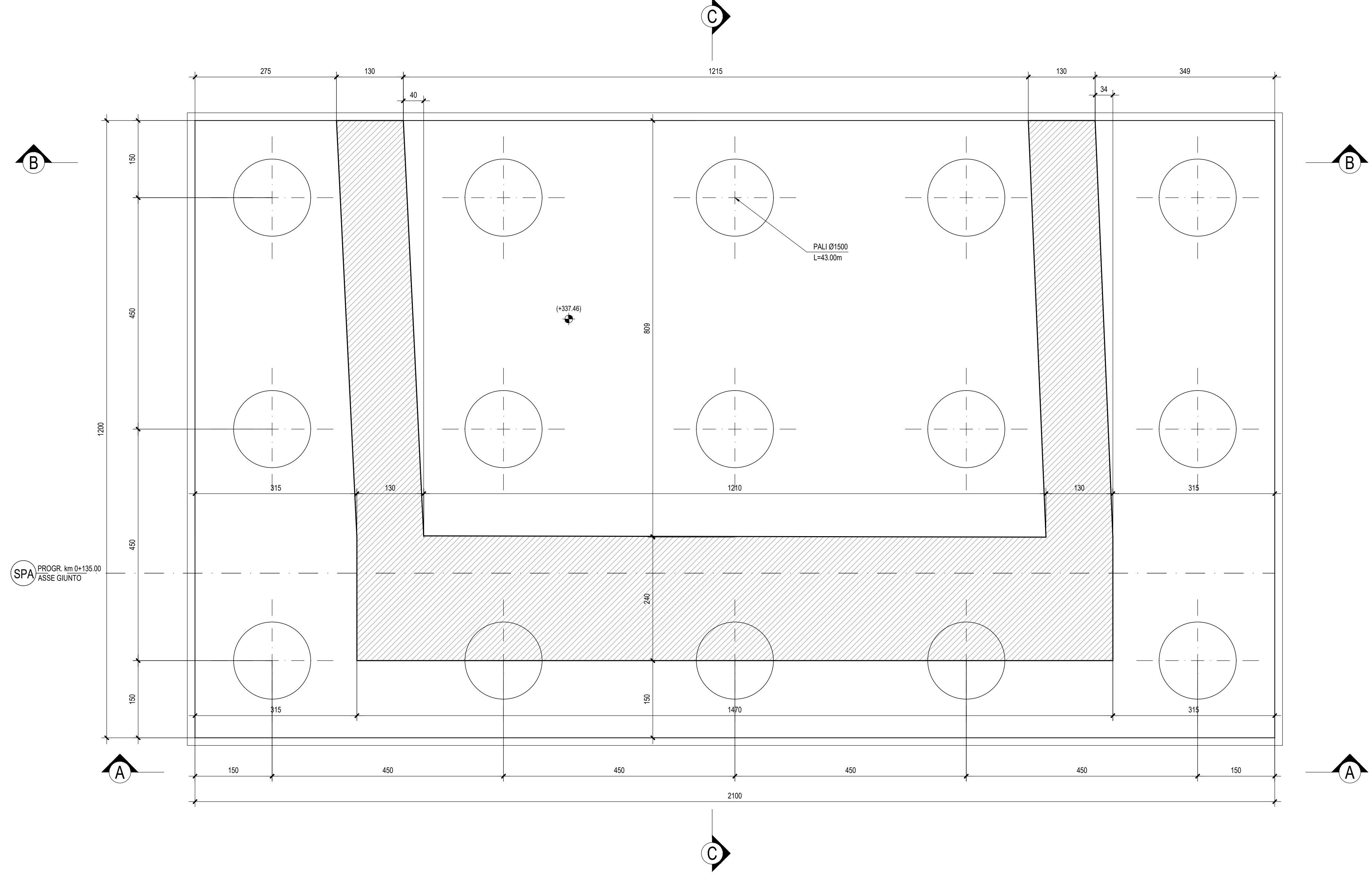

VISTA DALL'ALTO - Scala 1:50

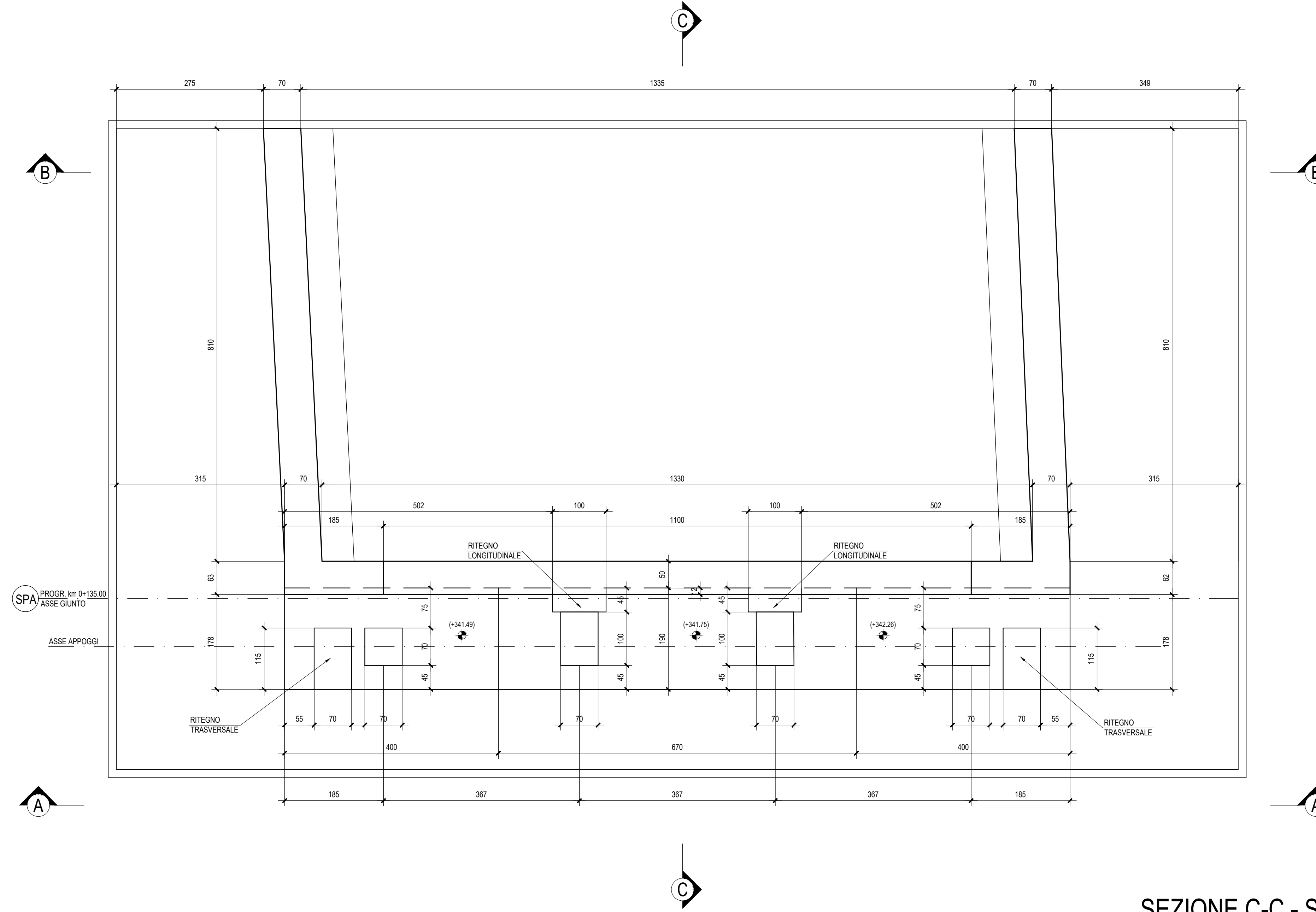

SEZIONE C-C - Scala 1:50

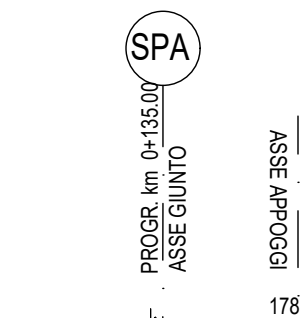

VISTA A-A - Scala 1:50

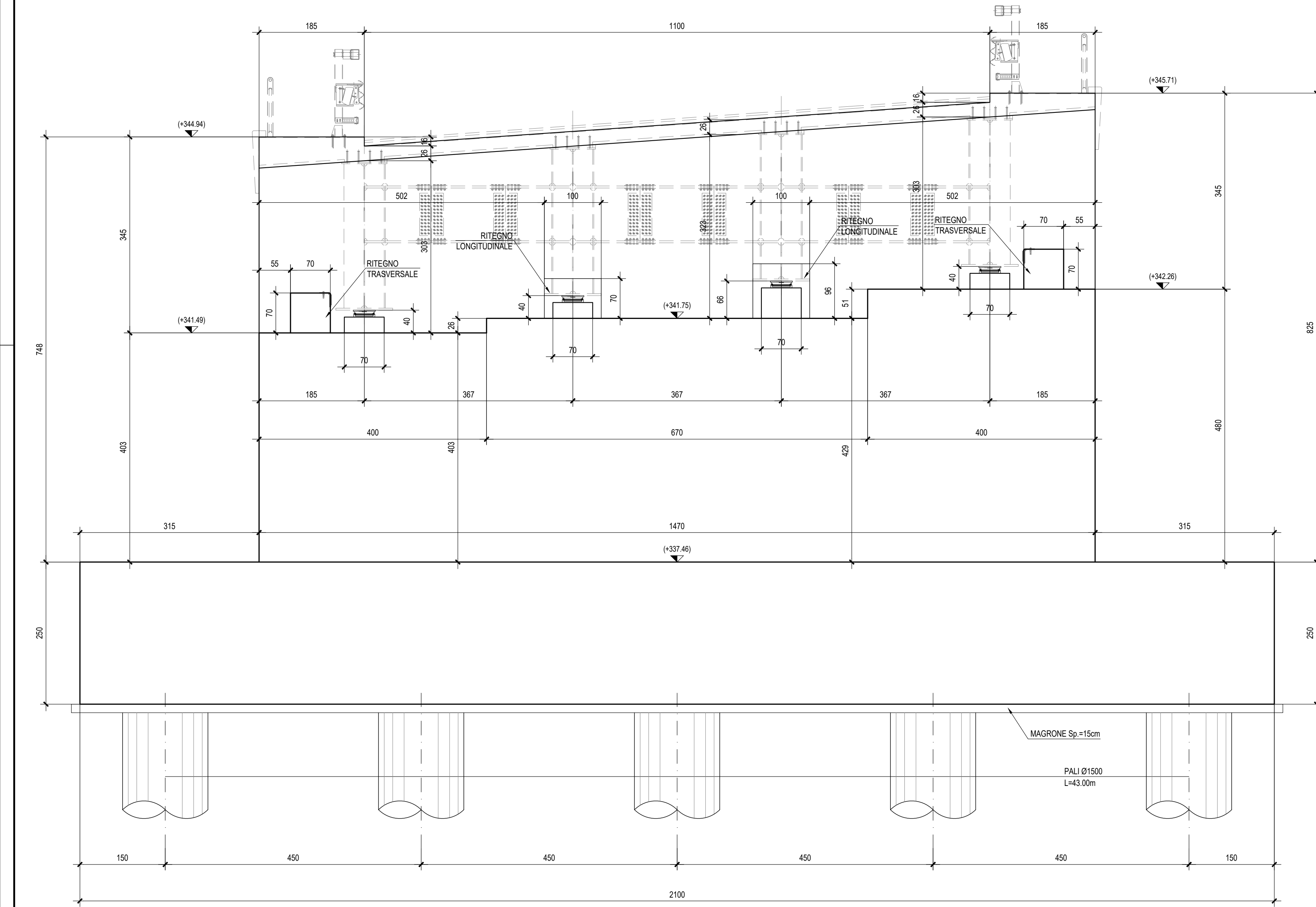

SEZIONE B-B - Scala 1:50

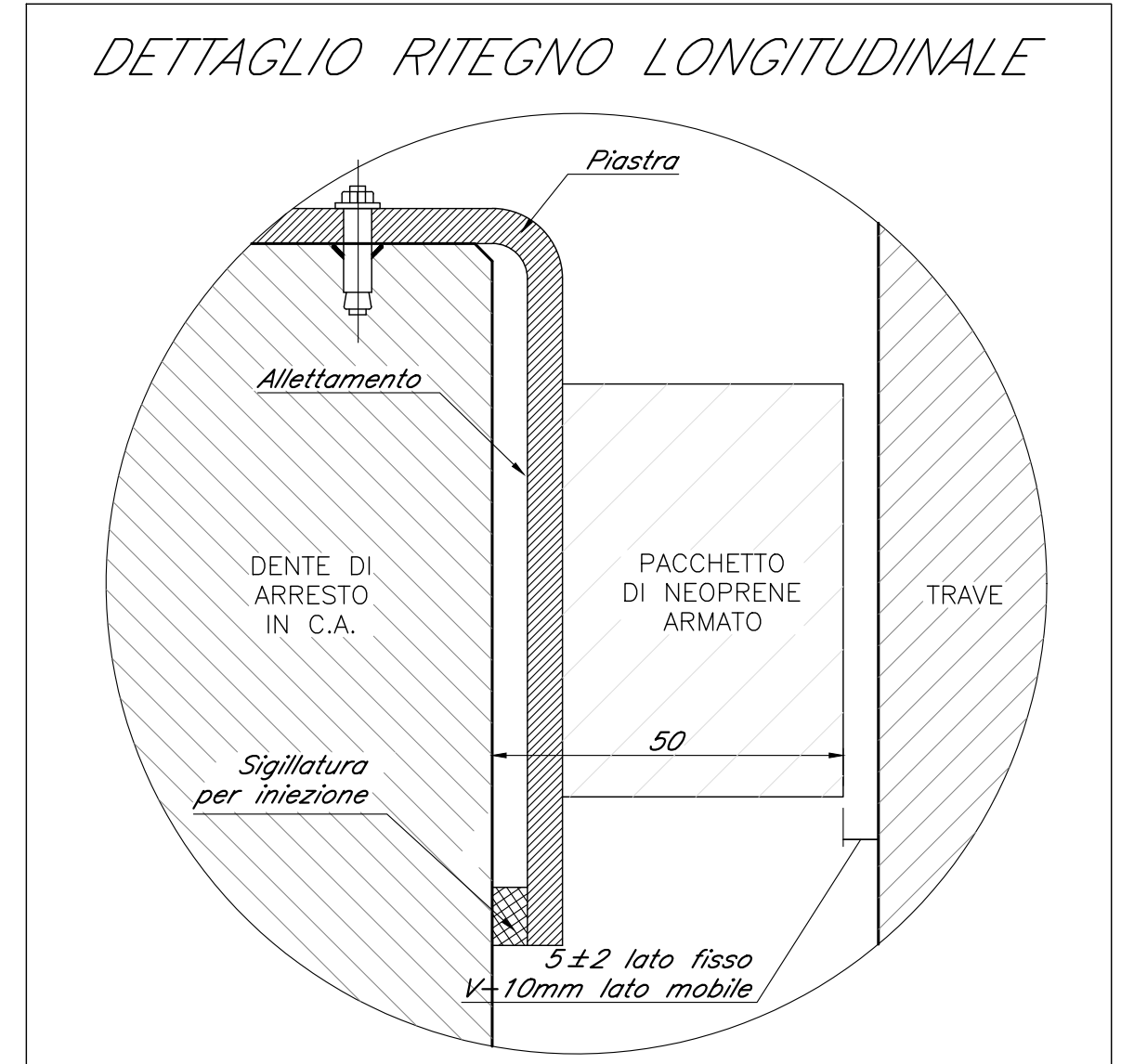
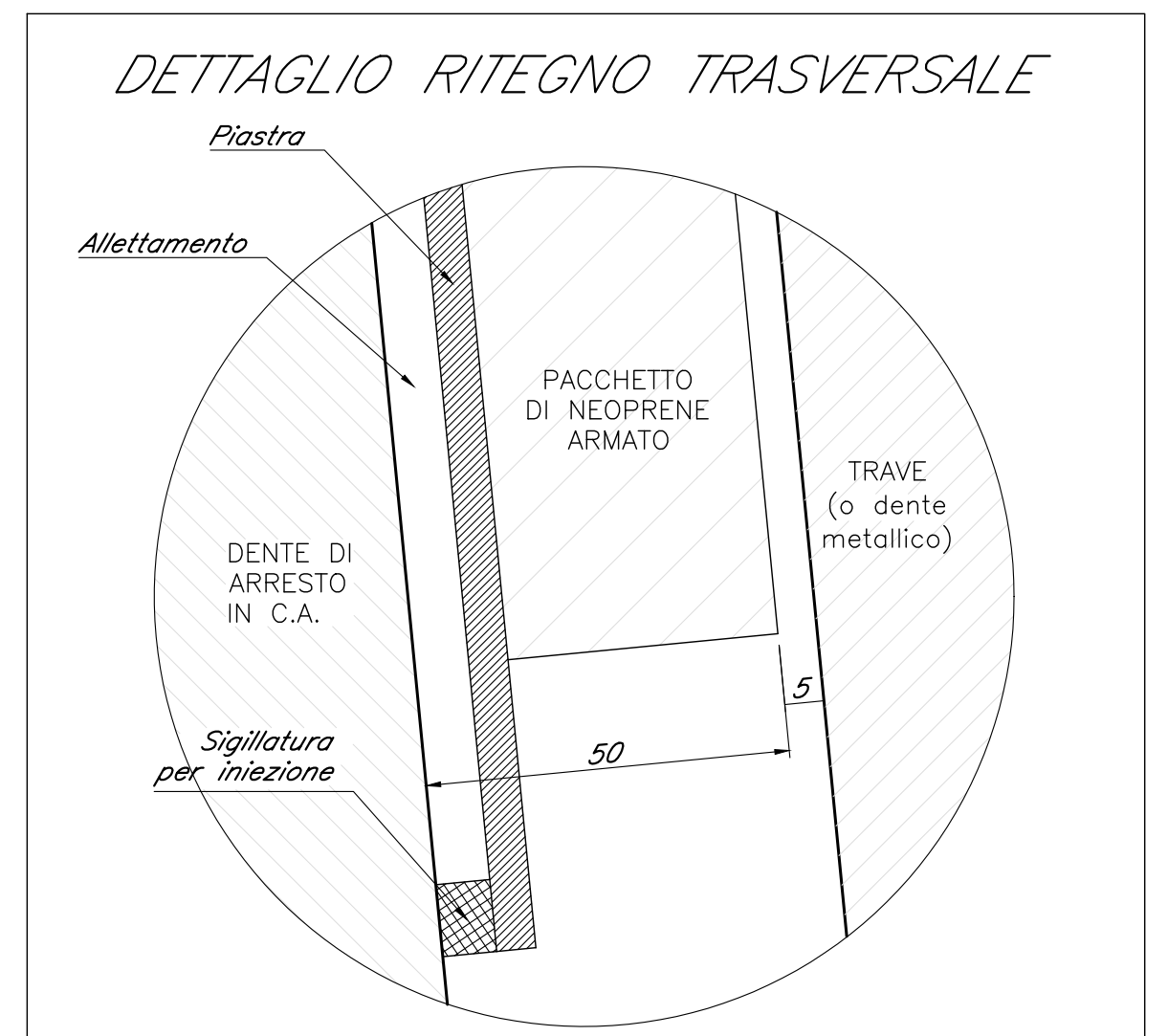
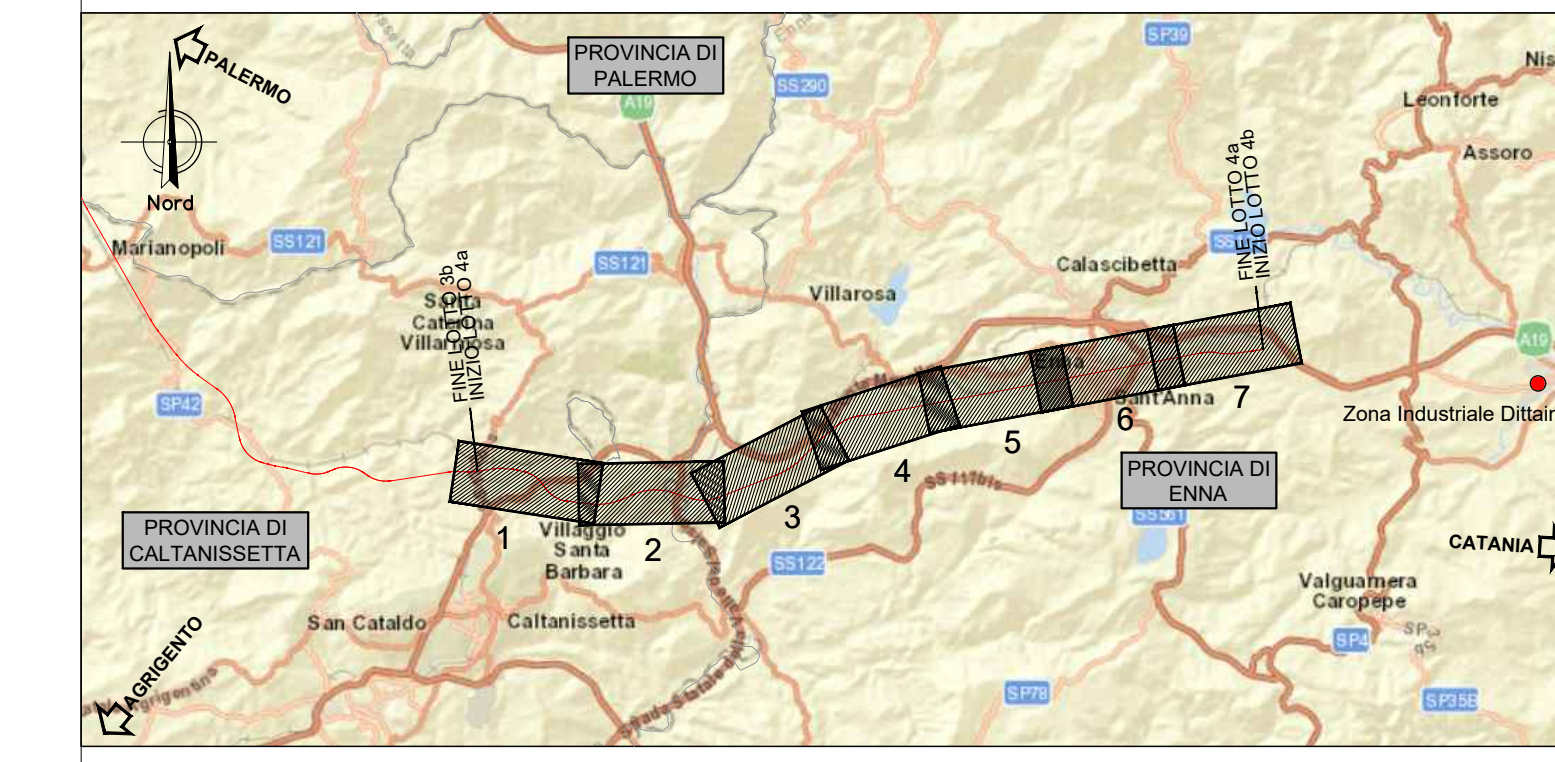
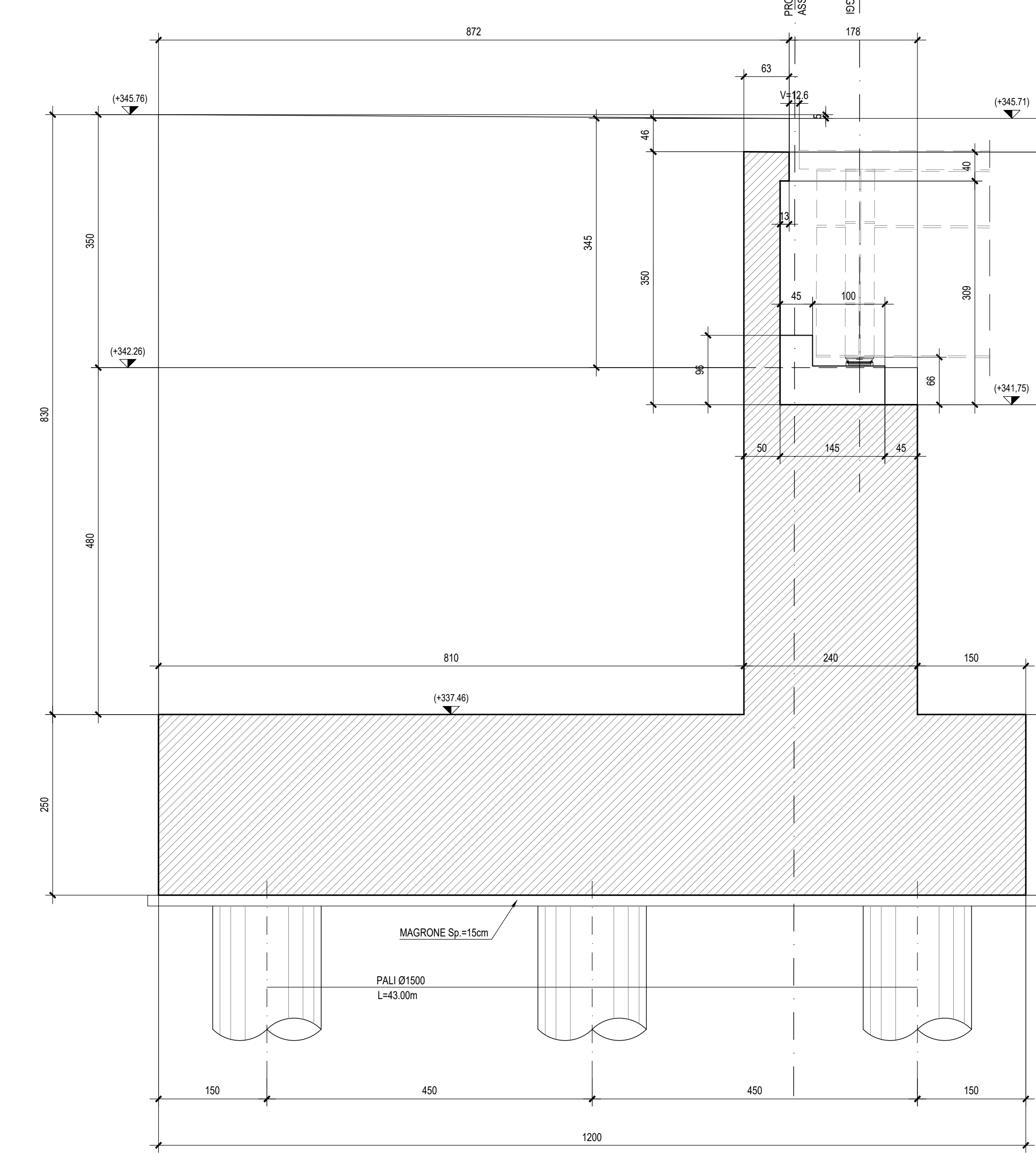
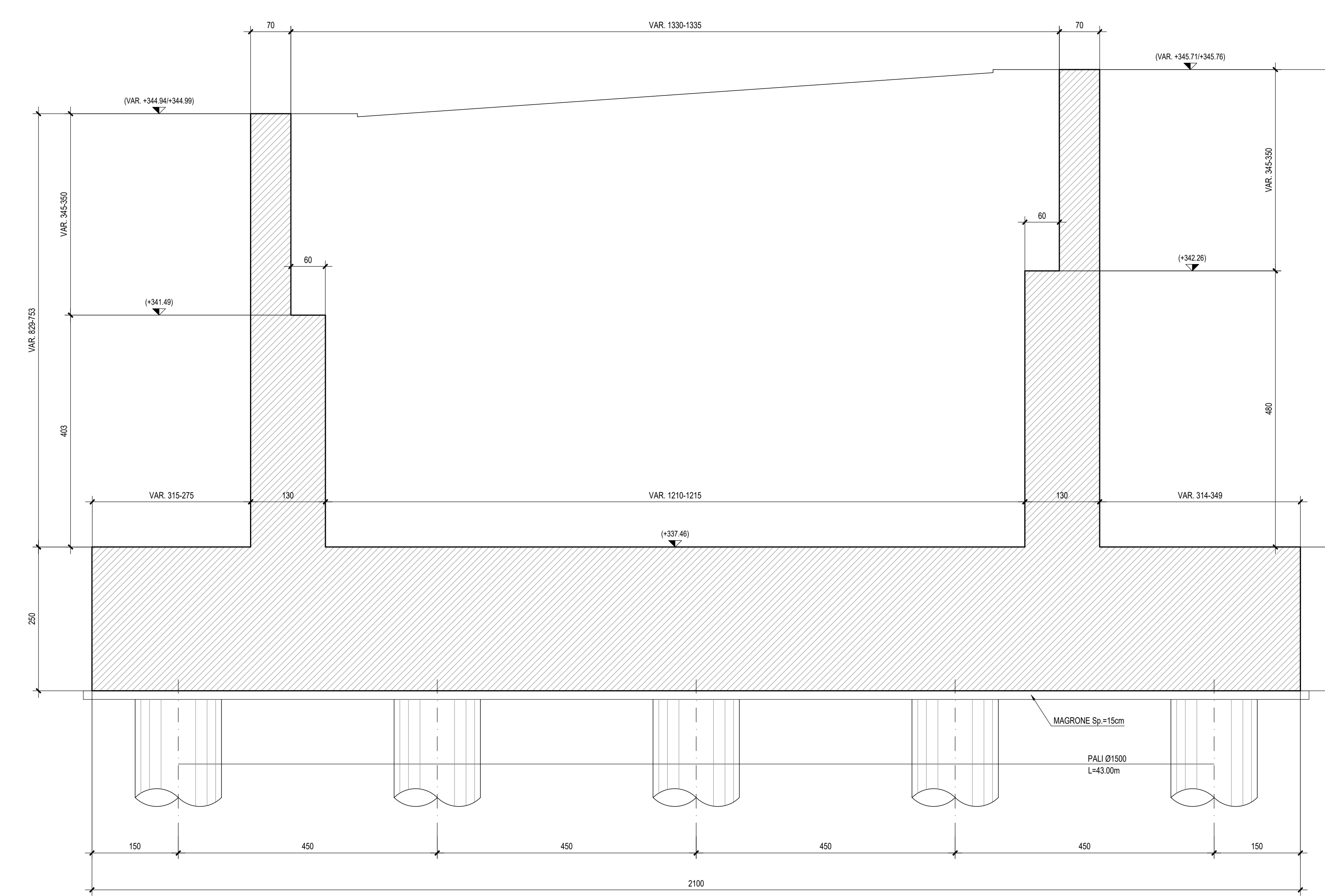

NB: Per la tabella materiali rimanda all'elaborato "RSU 4.0.D.09.TT.VI.00.0.0.001.A"

COMMITENTE:
RFI
 RETE FERROVIARIA ITALIANA
 GRUPPO FERROVIE DELLO STATO ITALIANO

PROGETTAZIONE:
ITALFERR
 GRUPPO FERROVIE DELLO STATO ITALIANO

DIRETTRICE FERROVIARIA MESSINA - CATANIA - PALERMO
NUOVO COLLEGAMENTO PALERMO - CATANIA

U.O. OPERE CIVILI E GESTIONE DELLE VARIANTI

PROGETTO DEFINITIVO

TRATTA CALTANISSETTA XIRBI - NUOVA ENNA (LOTTO 4A)

VIABILITA' - VIADOTTI
 NW02 - VIADOTTO STRADALE SU NV97
 Carpenteria Spalla A

SCALA:
1:50

Rev.	Descrizione	Redatto	Data	Verificato	Data	Approvato	Data	Autorizzato Data
A	Emissione Esecutiva	[Signature]	09/2020	[Signature]	11/2020	[Signature]	01/2021	01/2021
B	Emissione Esecutiva	[Signature]	05/2021	[Signature]	05/2021	[Signature]	05/2021	05/2021

File: RSU.4.0.D.09.BB.NW.02.0.0.001.B | n. Elab.: 09_252