

PIANTA SPICCATO - Scala 1:50

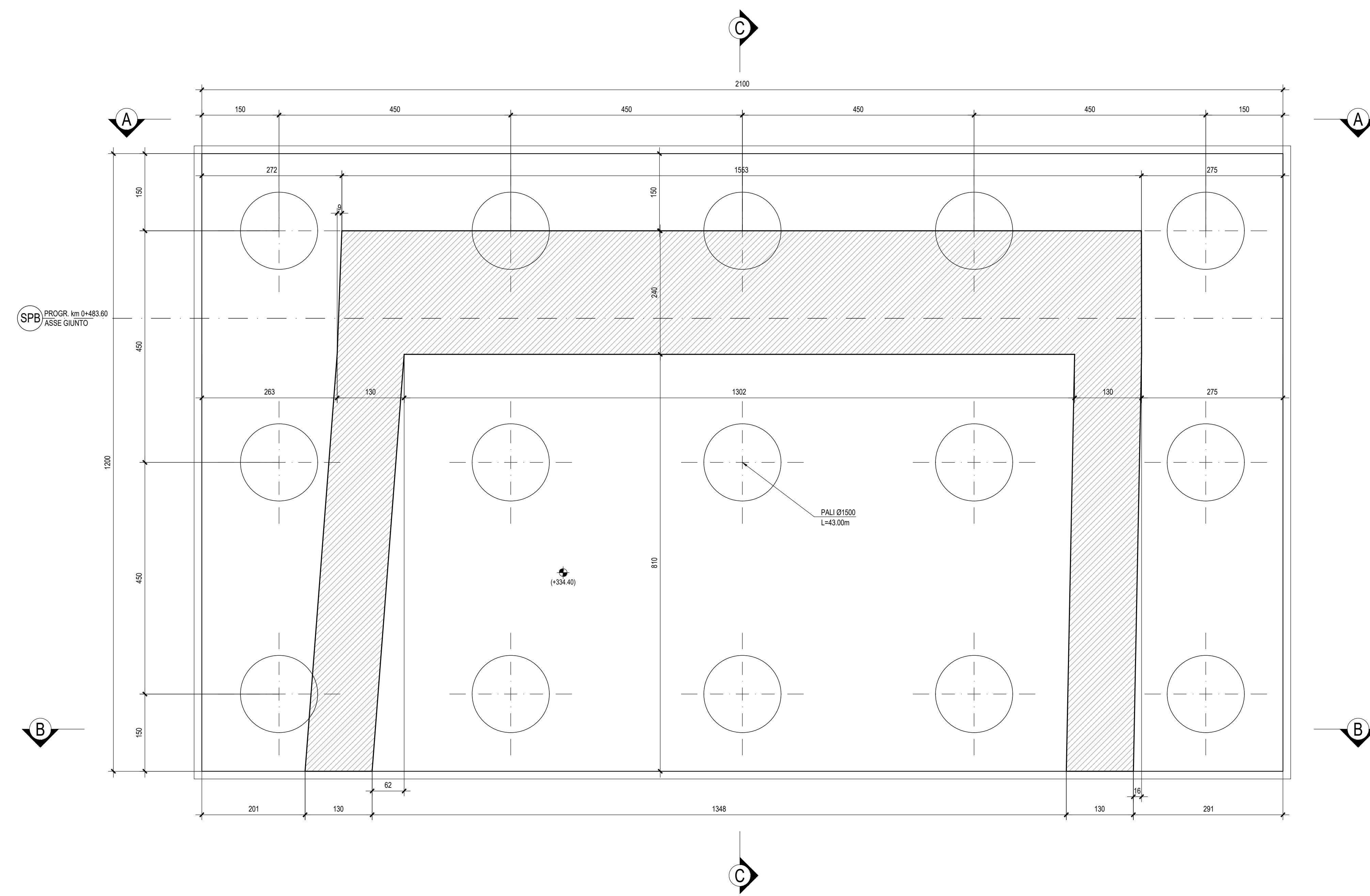

VISTA DALL'ALTO - Scala 1:50

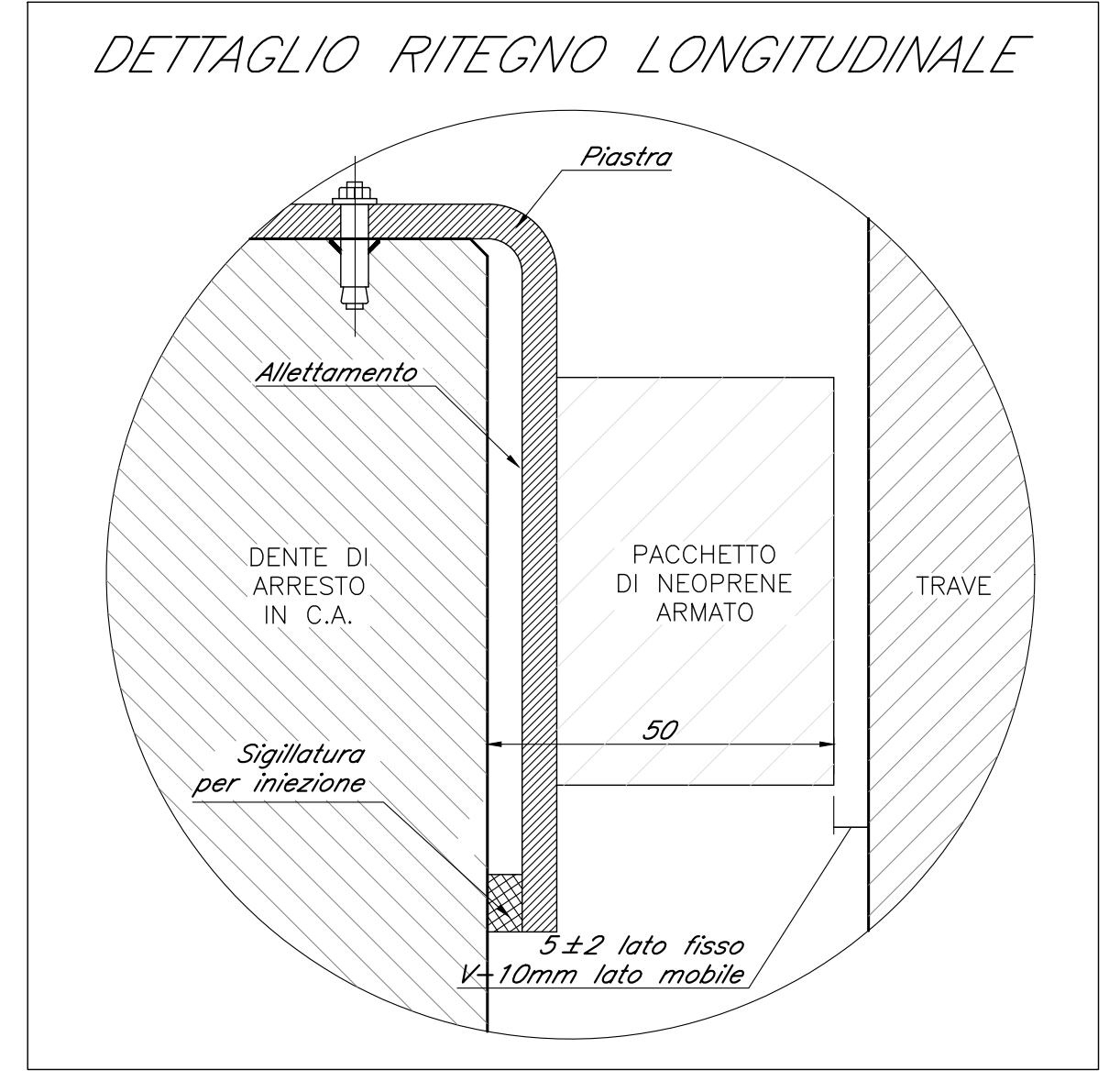
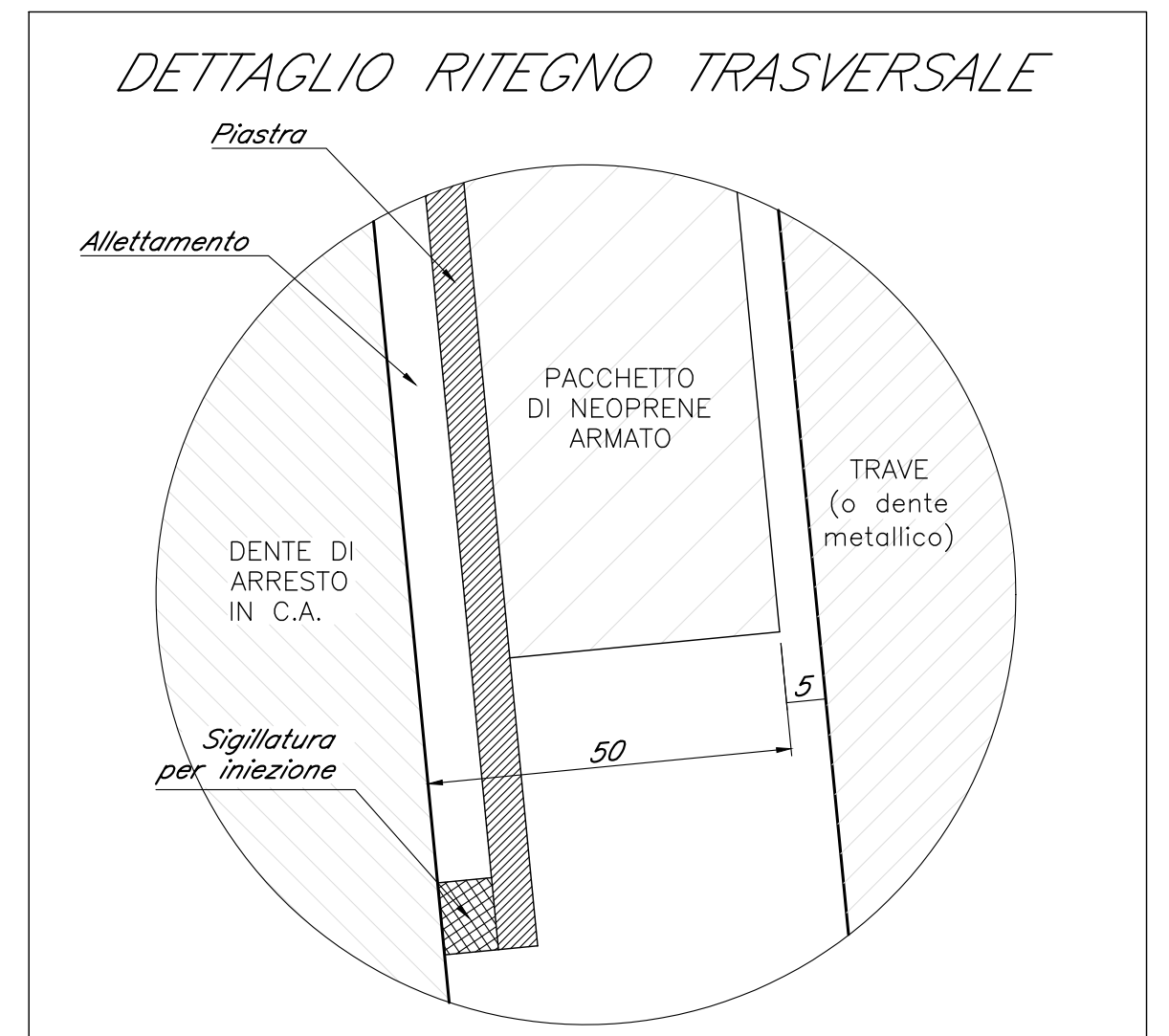
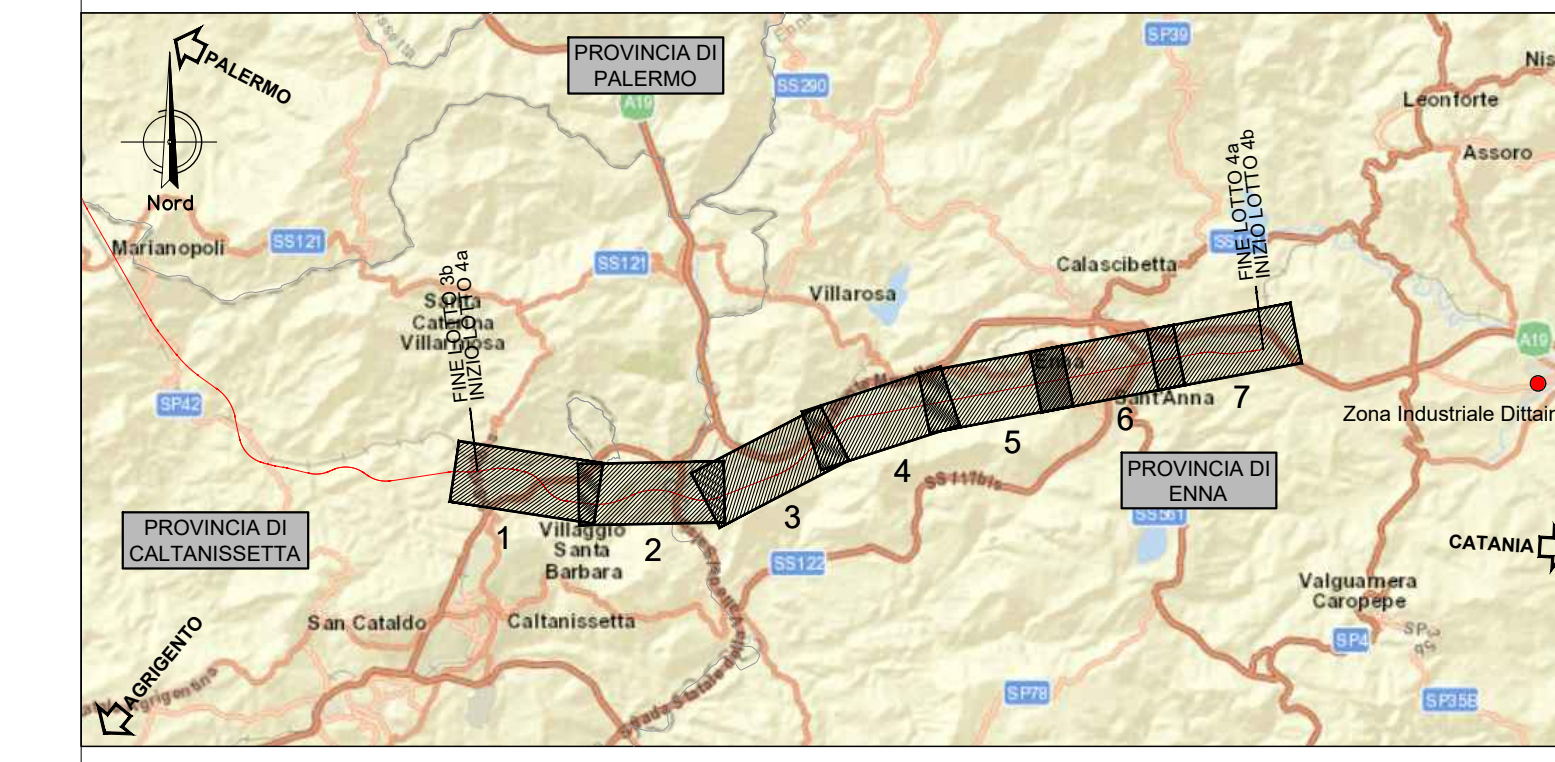
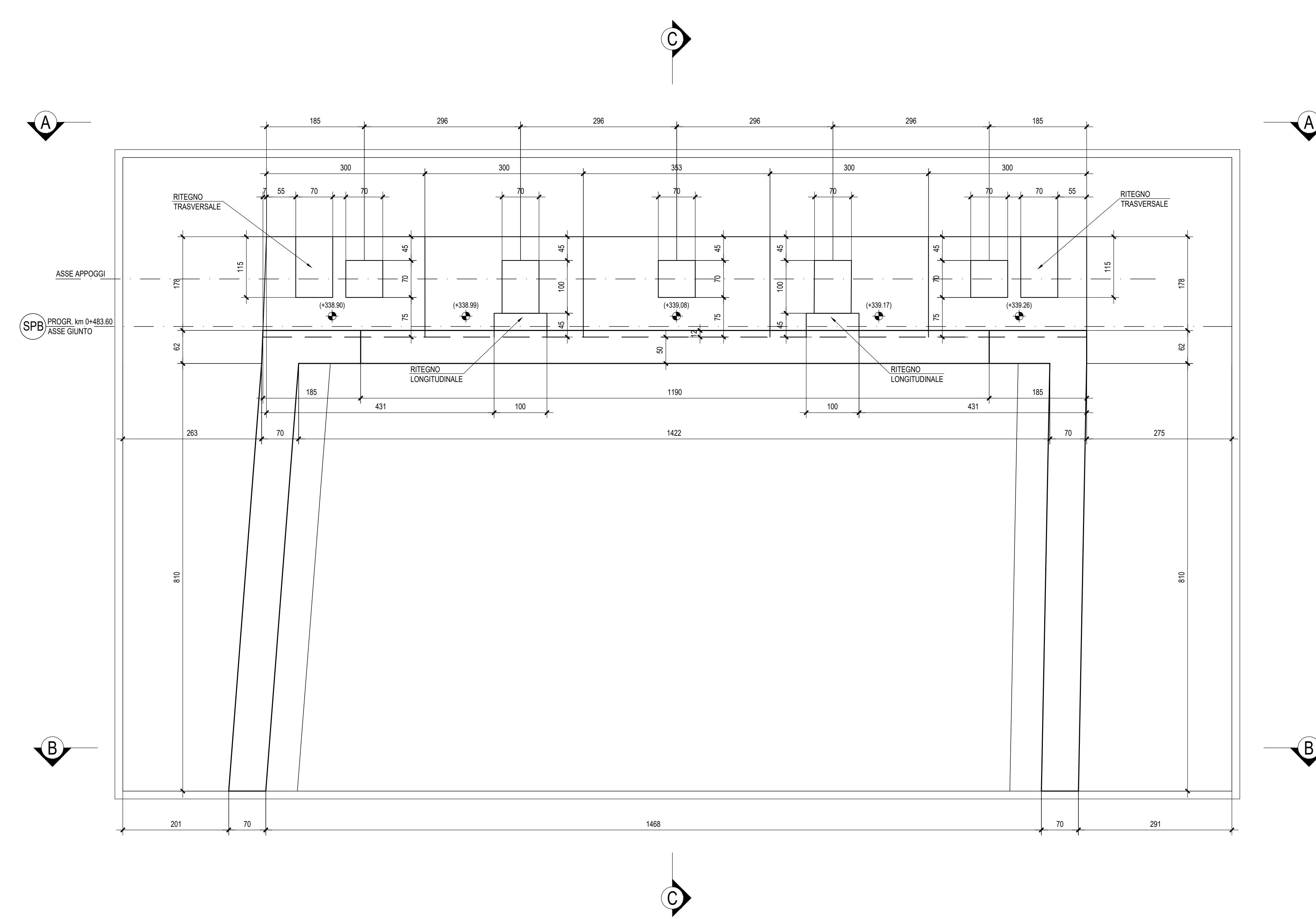

SEZIONE C-C - Scala 1:50

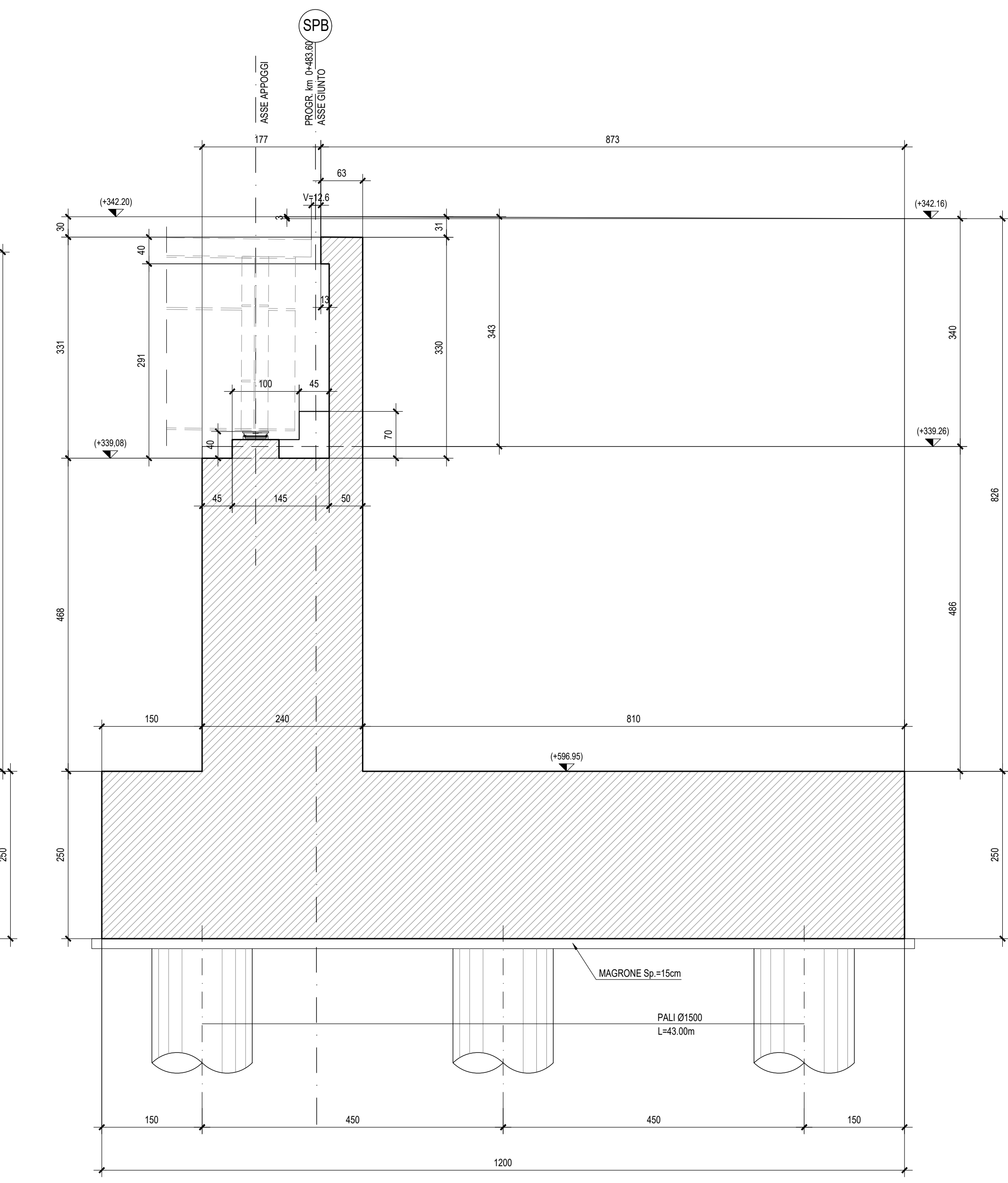

SEZIONE B-B - Scala 1:50

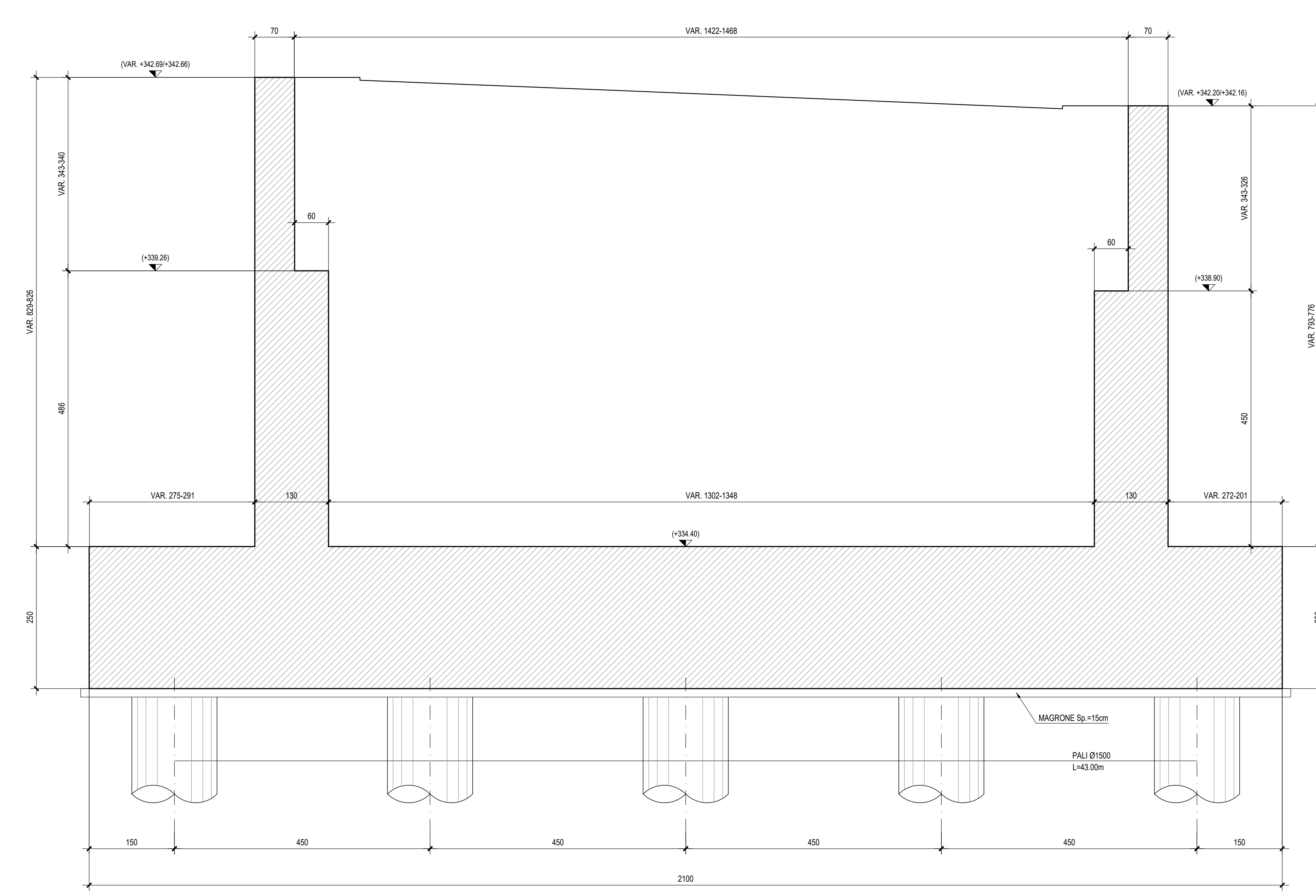

VISTA A-A - Scala 1:50

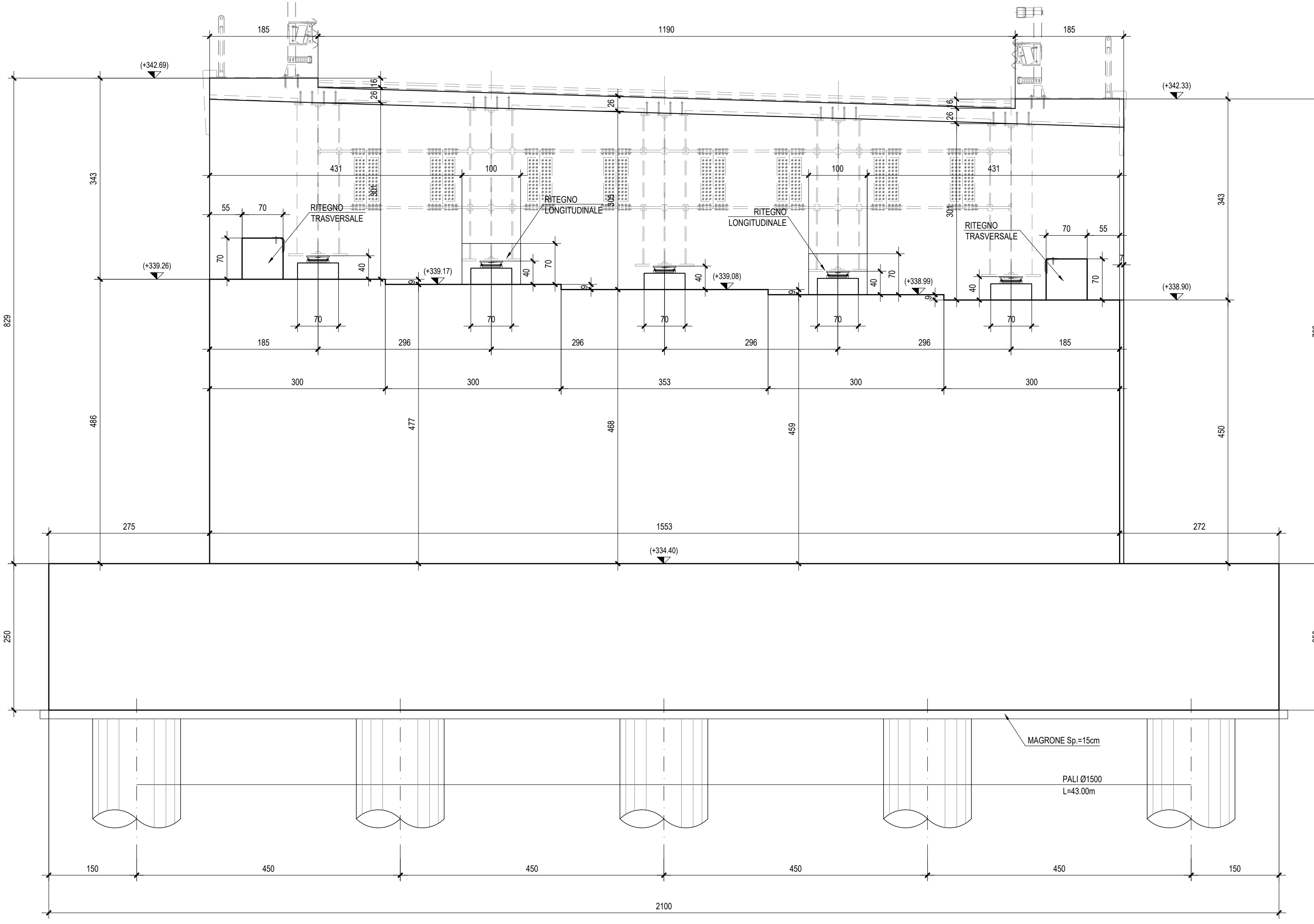

NB: Per la tabella materiali rimanda all'elaborato "RSU 4.0.D.09.TT.VI.00.0.0.001.A"

COMMITTENTE: **RFI** RETE FERROVIARIA ITALIANA GRUPPO FERROVIE DELLO STATO ITALIANO

PROGETTAZIONE: **ITALFERR** GRUPPO FERROVIE DELLO STATO ITALIANO

DIRETTRICE FERROVIARIA MESSINA - CATANIA - PALERMO
NUOVO COLLEGAMENTO PALERMO - CATANIA

U.O. OPERE CIVILI E GESTIONE DELLE VARIANTI

PROGETTO DEFINITIVO
TRATTA CALTANISSETTA XIRBI - NUOVA ENNA (LOTTO 4A)

VIABILITA' - VIADOTTI
 NW02 - VIADOTTO STRADALE SU NV97
 Carpentaria Spalla B

SCALA: 1:50

Rev.	Descrizione	Redatto	Data	Verificato	Data	Approvato	Data	Autorizzato Data
A	Emissione Esecutiva	AV/SP/02	09/2020	AV/SP/02	09/2020	AV/SP/02	09/2020	09/2020
B	Emissione Esecutiva	AV/SP/02	10/2020	AV/SP/02	10/2020	AV/SP/02	10/2020	10/2020
C	Emissione Esecutiva	AV/SP/02	11/2020	AV/SP/02	11/2020	AV/SP/02	11/2020	11/2020

File: RSU.4.0.D.09.BB.NW.02.0.0.008.C | n. Elab.: 09_257