

CARTA GEOLOGICA E PROFILO GEOLOGICO NV01

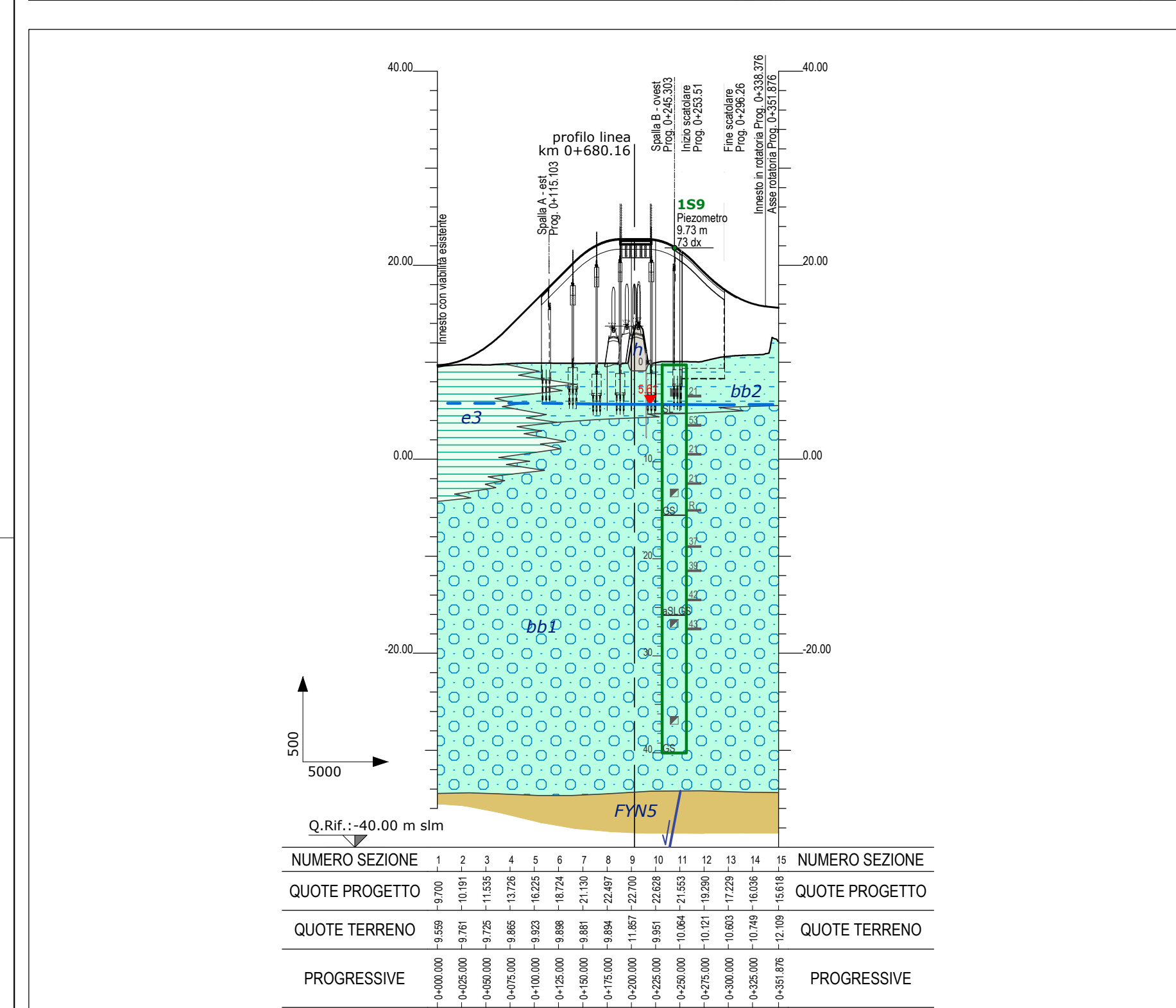

CARTA GEOLOGICA E PROFILO GEOLOGICO NV02

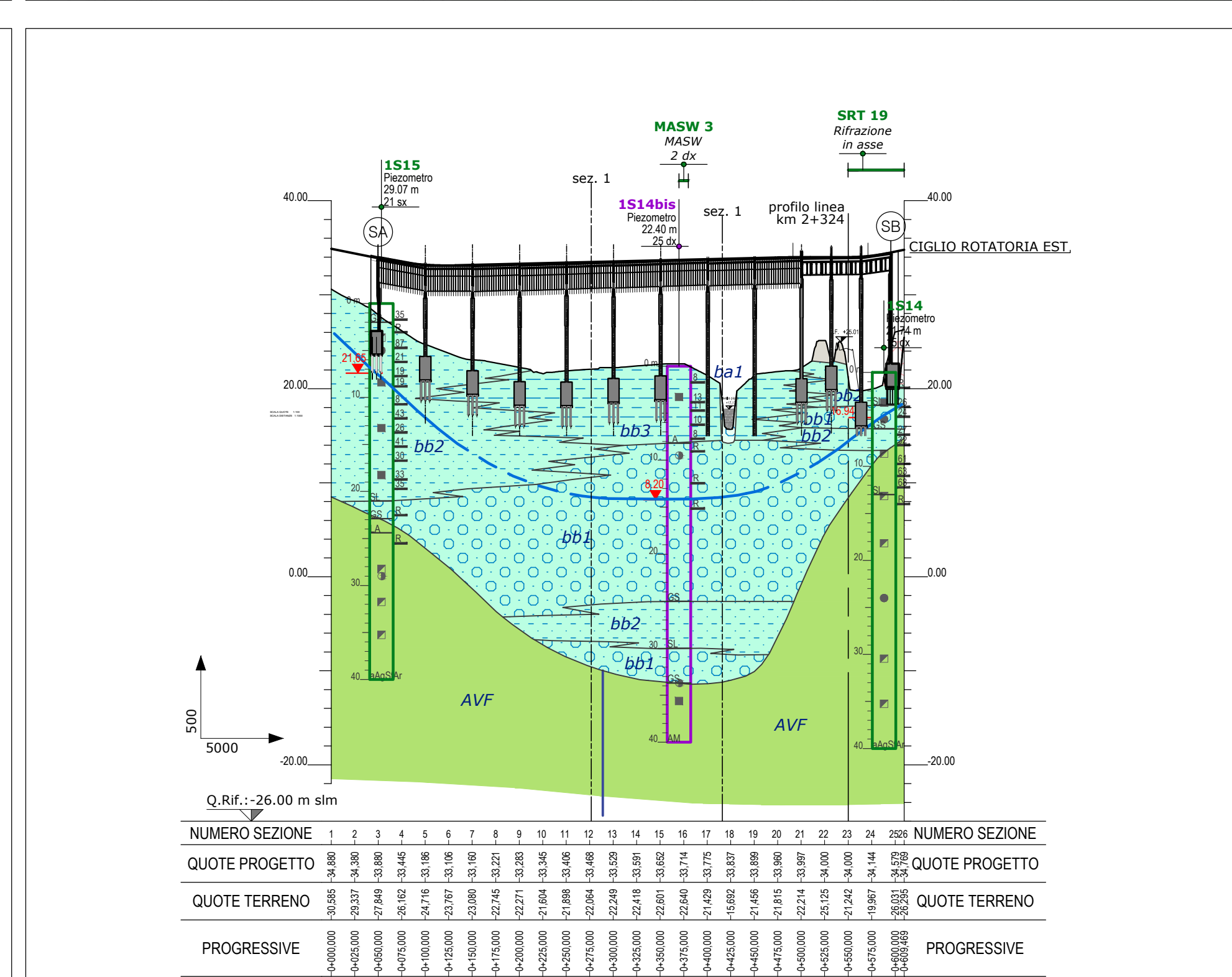
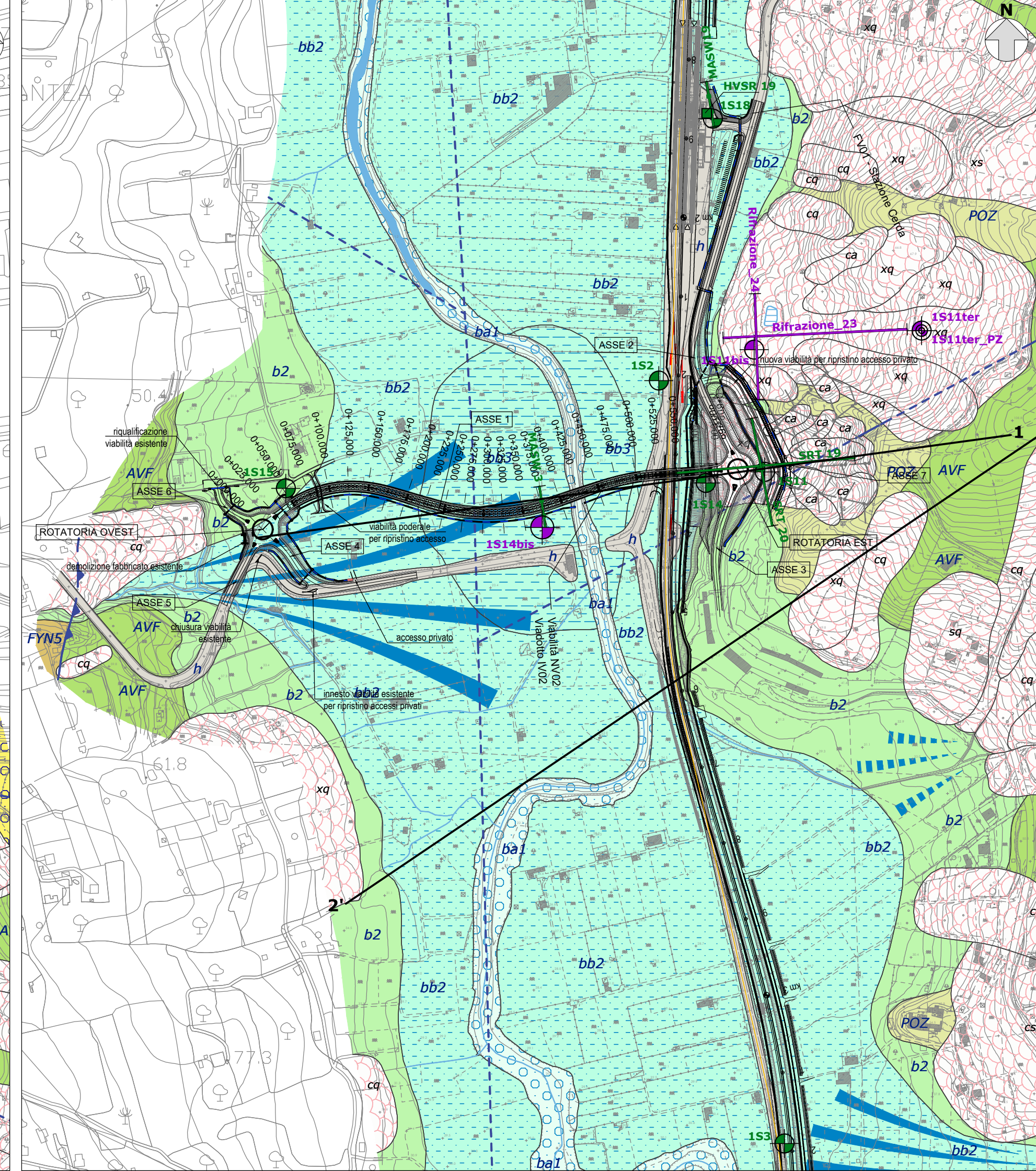

CARTA GEOLOGICA E PROFILO GEOLOGICO NV04

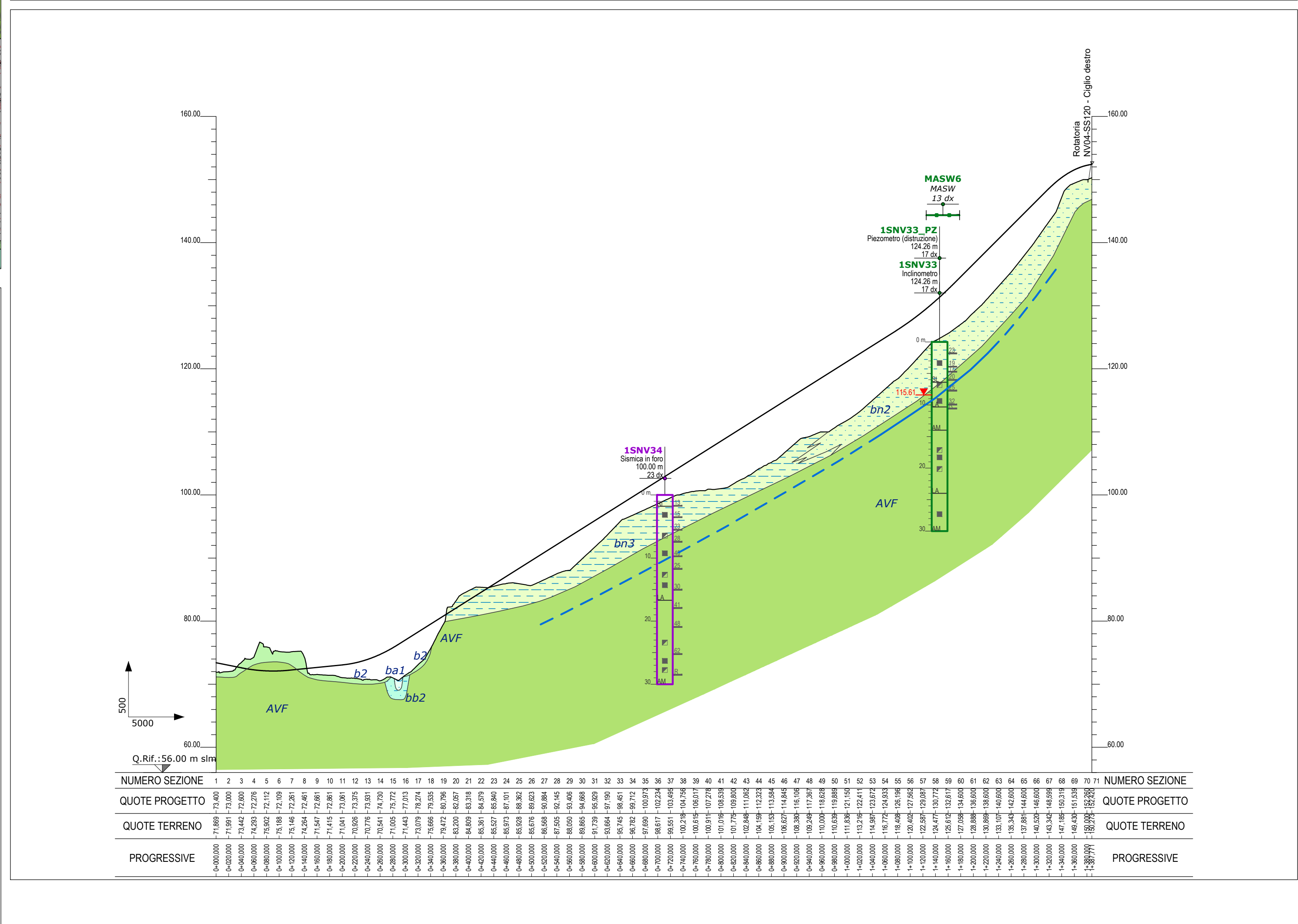
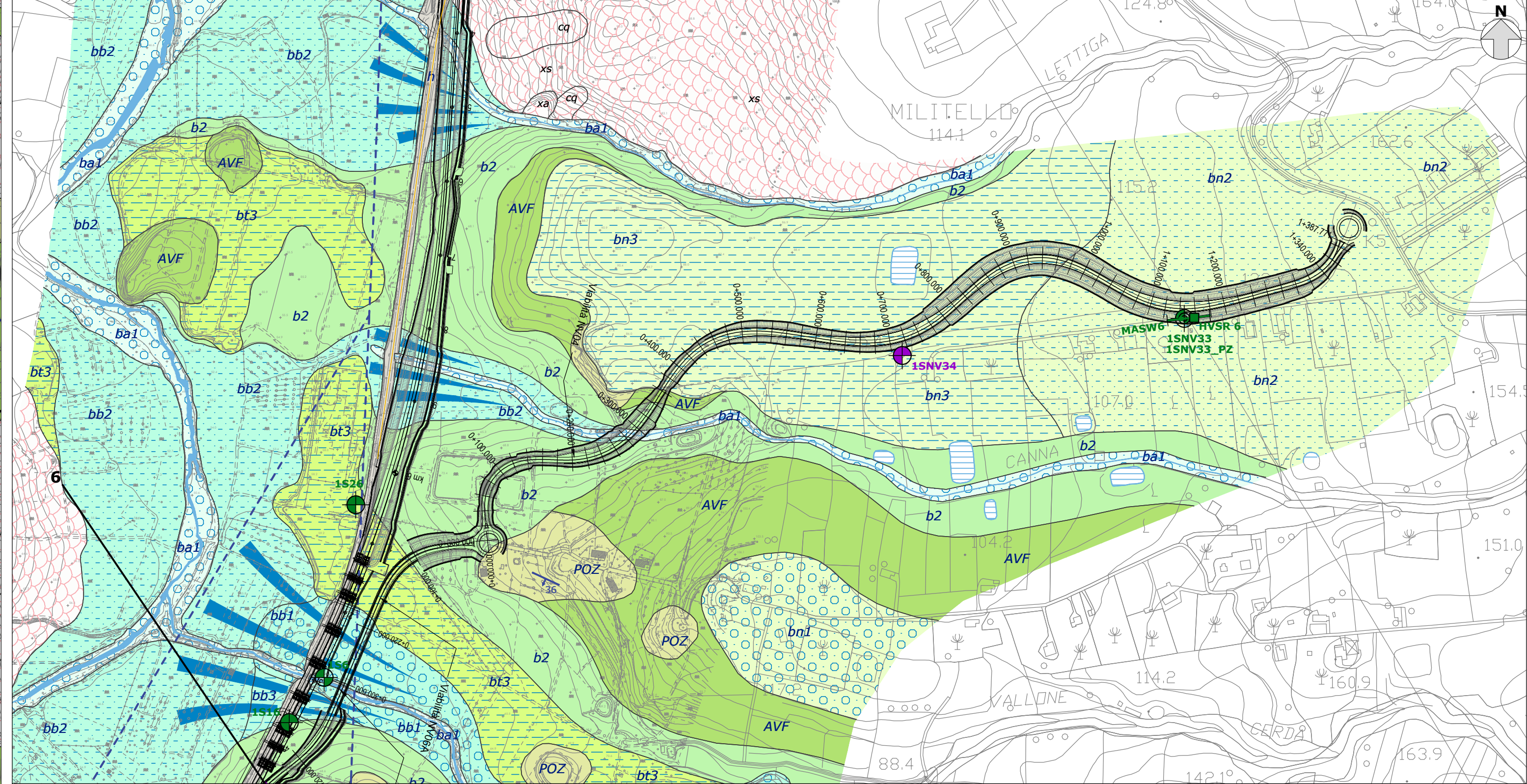

CARTA GEOLOGICA NV06A - NV06B

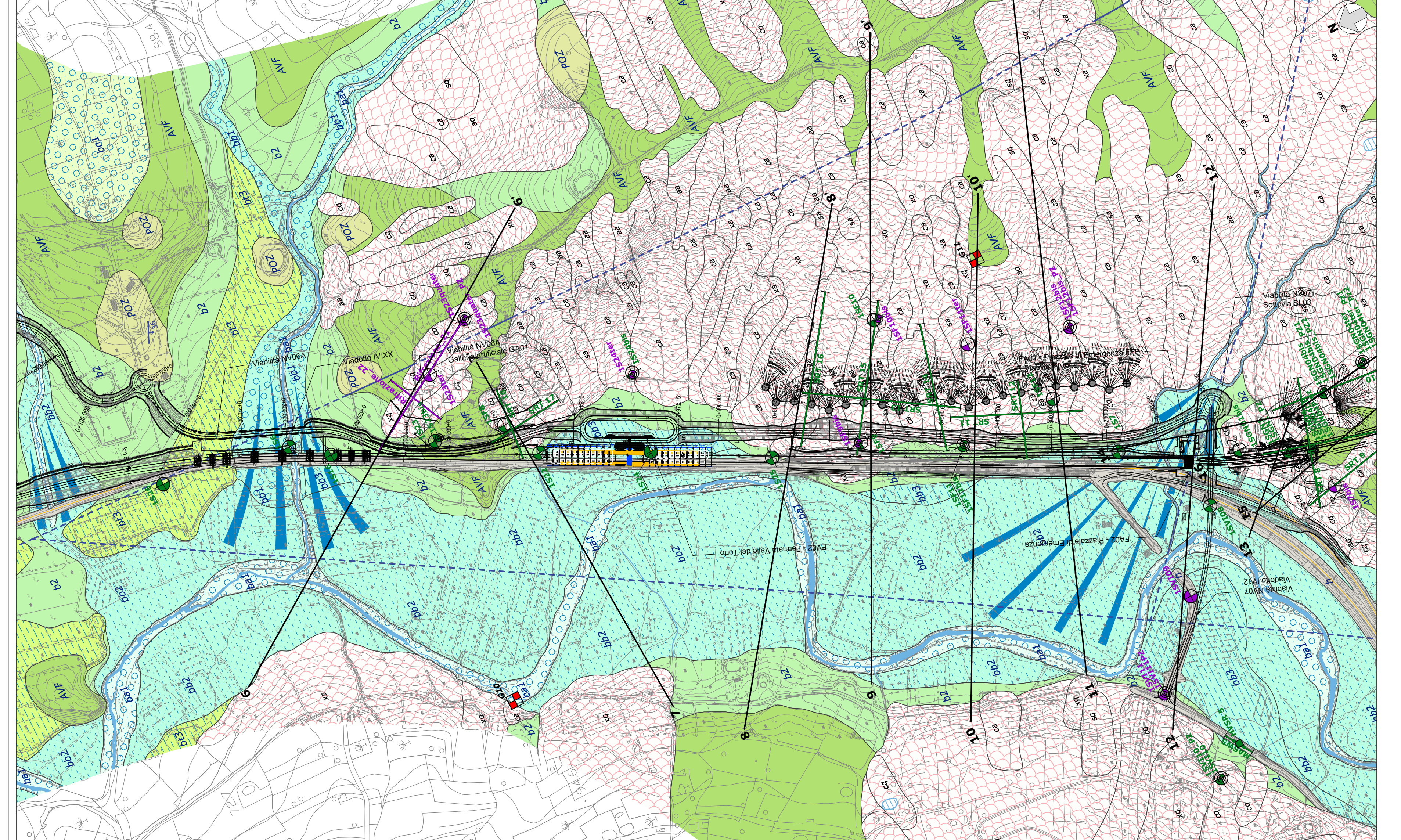

CARTA GEOLOGICA E PROFILO GEOLOGICO NV07

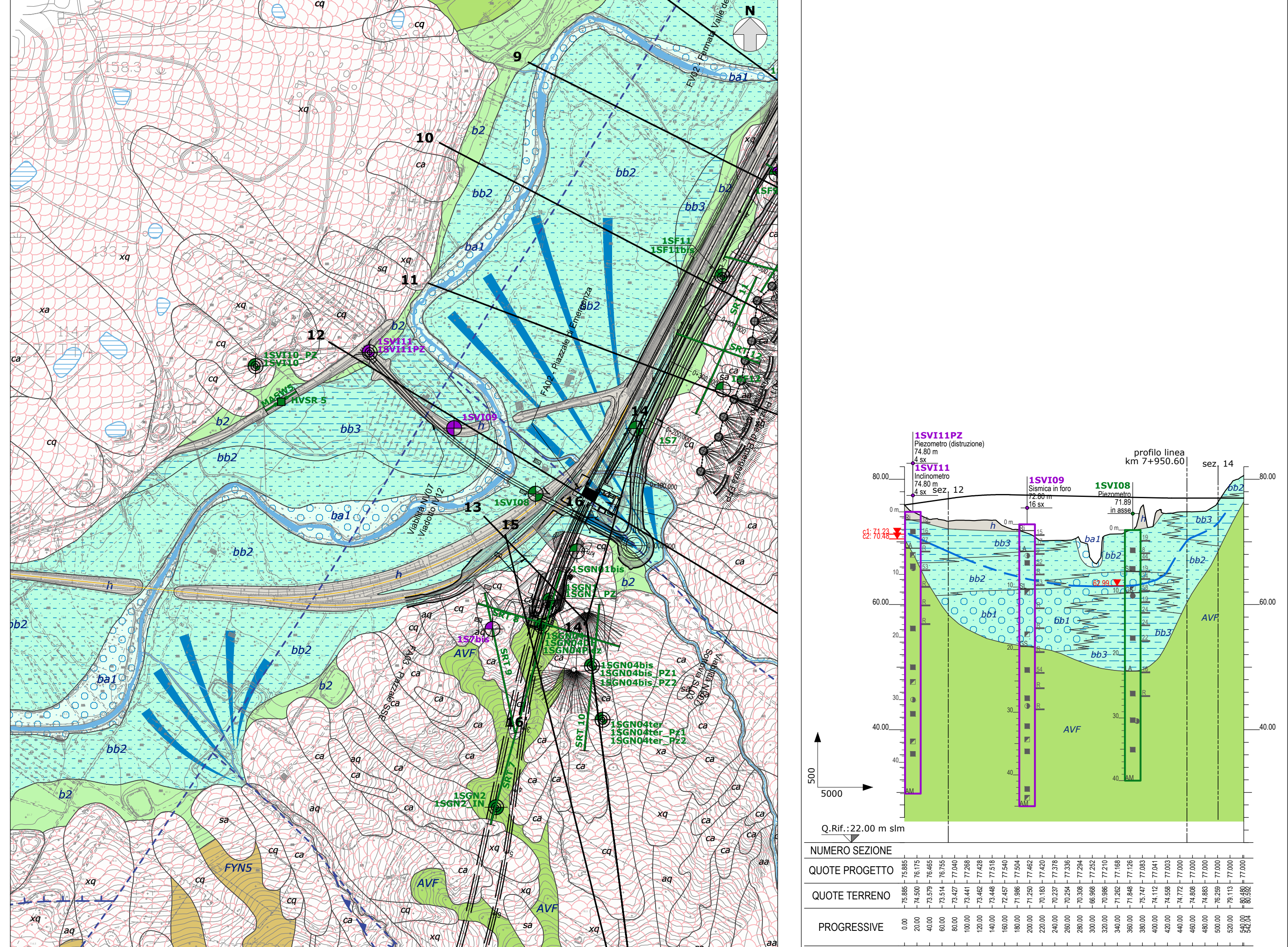

LEGENDA

Table with 2 columns: Simbologia (Symbol) and Descrizione (Description). It lists various geological symbols and their corresponding descriptions, such as 'Depositi continentali' and 'Litoformazioni glacio-sabbie'. A second table below it lists 'Litoformazioni e schema indagini in profilo' with columns for 'Sigla' and 'Litoformazione'.

DEPOSITI MARINI E TRANSIZIONALI

Table with 2 columns: Simbologia (Symbol) and Descrizione (Description). It lists symbols for marine and transitional deposits, such as 'Finess Numidico' and 'Formazione Polizzi'.

SUCCESSIONI SEDIMENTARE MESO-CENOZOICHE

Table with 2 columns: Simbologia (Symbol) and Descrizione (Description). It lists symbols for Mesozoic and Cenozoic successions, such as 'Finess Numidico' and 'Formazione Polizzi'.

DEPOSITI DEL DOMINIO SICILIANO

Table with 2 columns: Simbologia (Symbol) and Descrizione (Description). It lists symbols for Sicilian domain deposits, such as 'Argille Varicolori inferiori' and 'Litoformazioni calcareo-marnose'.

SIMBOLOGIA

Table with 2 columns: Simbologia (Symbol) and Descrizione (Description). It lists various symbols used in the geological maps, such as 'Corso d'acqua', 'Specchio d'acqua', 'Limite stratigrafico', etc. A second table below it lists 'Stato di attività' with columns for 'Movimento', 'Attivo', and 'Stabilito'.

PIEZOMETRIA

Table with 2 columns: Simbologia (Symbol) and Descrizione (Description). It lists symbols for piezometry, such as 'Stazione geologica', 'Stazione geologica con rilievo geomatico', etc.

Table with 2 columns: Simbologia (Symbol) and Descrizione (Description). It lists symbols for investigations, such as 'Sondaggio a carotaggio continuo', 'Sondaggio a carotaggio continuo attrezzato con piezometro', etc.

Litoformazioni e schema indagini in profilo

Table with 2 columns: Sigla (Code) and Litoformazione (Lithology). It lists codes for different lithological units, such as 'AVF Argilla marrone', 'CS Ghiaie e sabbie', etc.

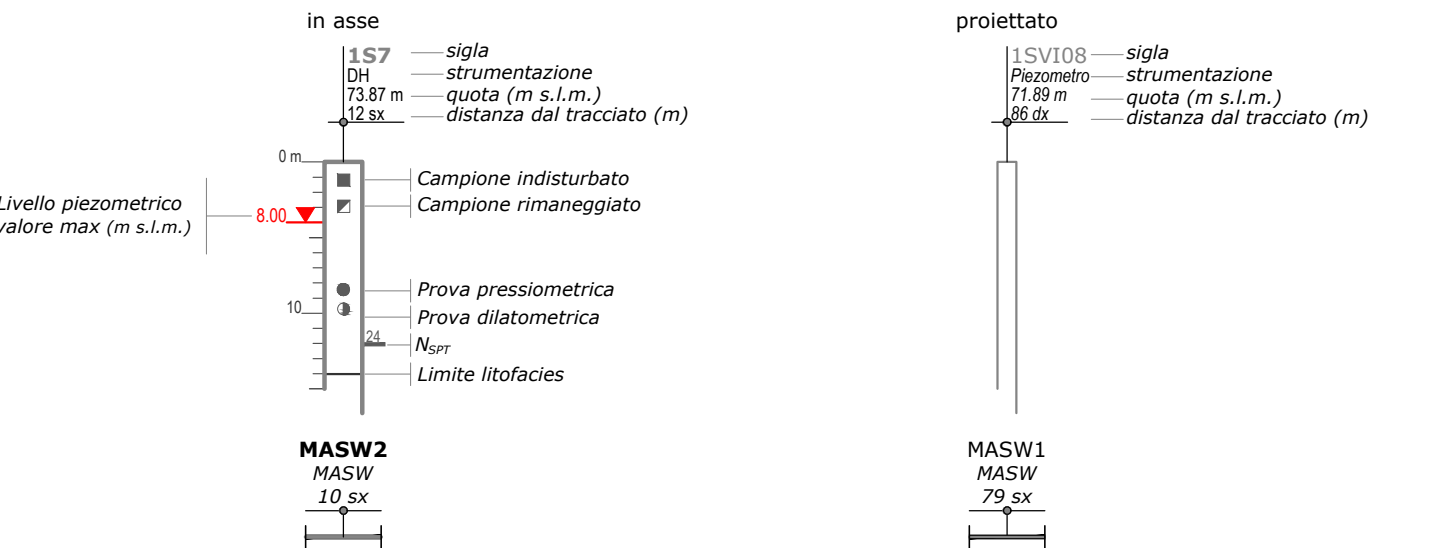

COMMITTENTE: RFI - R.F. FERROVIARIA ITALIANA GRUPPO FERROVIE DELLO STATO ITALIANE

PROGETTATE: ITALFERR - ITALFERR VIPO FERROVIE DELLO STATO ITALIANE

U.O. GEOLOGIA TECNICA, DELL'AMBIENTE E DEL TERRITORIO

PROGETTO DEFINITIVO

DIRETTRICE FERROVIARIA MESSINA - CATANIA - PALERMO NUOVO COLLEGAMENTO PALERMO - CATANIA

RADDOPPIO TRATTA FIUMETORTO - LERCARA DIRAMAZIONE LOTTO 1+2

CARTA GEOLOGICA NV06 CARTA GEOLOGICA E PROFILO GEOLOGICO NV01 - NV02 - NV04 - NV07

SCALA: 1:5000/500

COMMESSA LOTTO FASE ENTE TIPO COD. OPERADISCIPLINA PROG. REV.

RS3Z 00 D 69 L5 GE0001 012 C

Table with 7 columns: Rev., Descrizione, Redatto, Data, Verificato, Data, Approvato, Data. It contains a table of revision history and approval dates for the project.

File: In. Etich. 09\_16