

STRALCIO PLANIMETRICO - PROG. 0+269.595 (A)  
SCALA 1:200

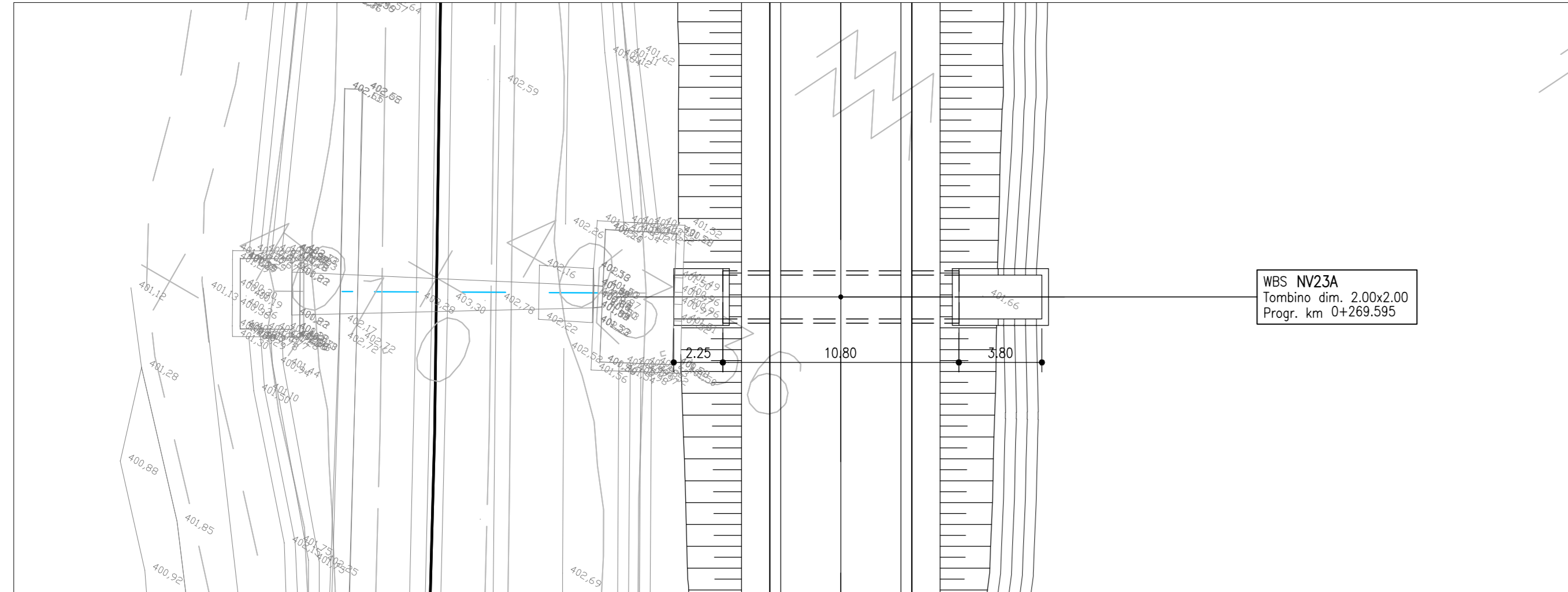

SEZIONE LONGITUDINALE - PROG. 0+269.595 (A)  
SCALA 1:100

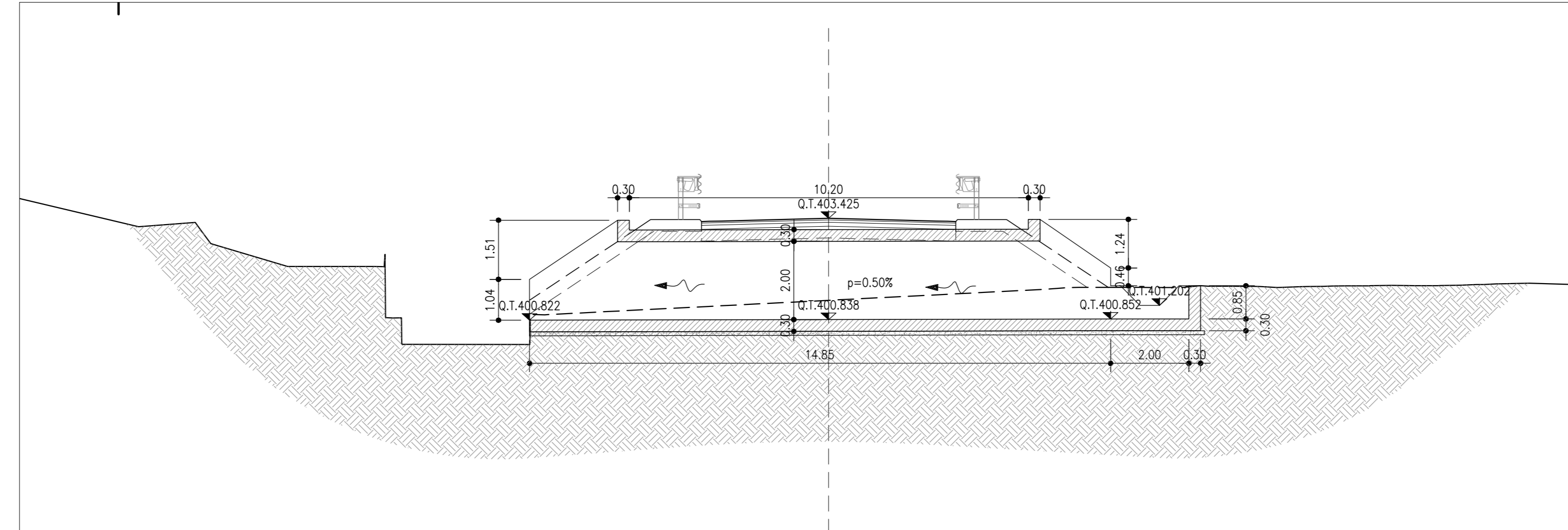

SEZIONE TRASVERSALE - PROG. 0+269.595 (A)  
SCALA 1:100

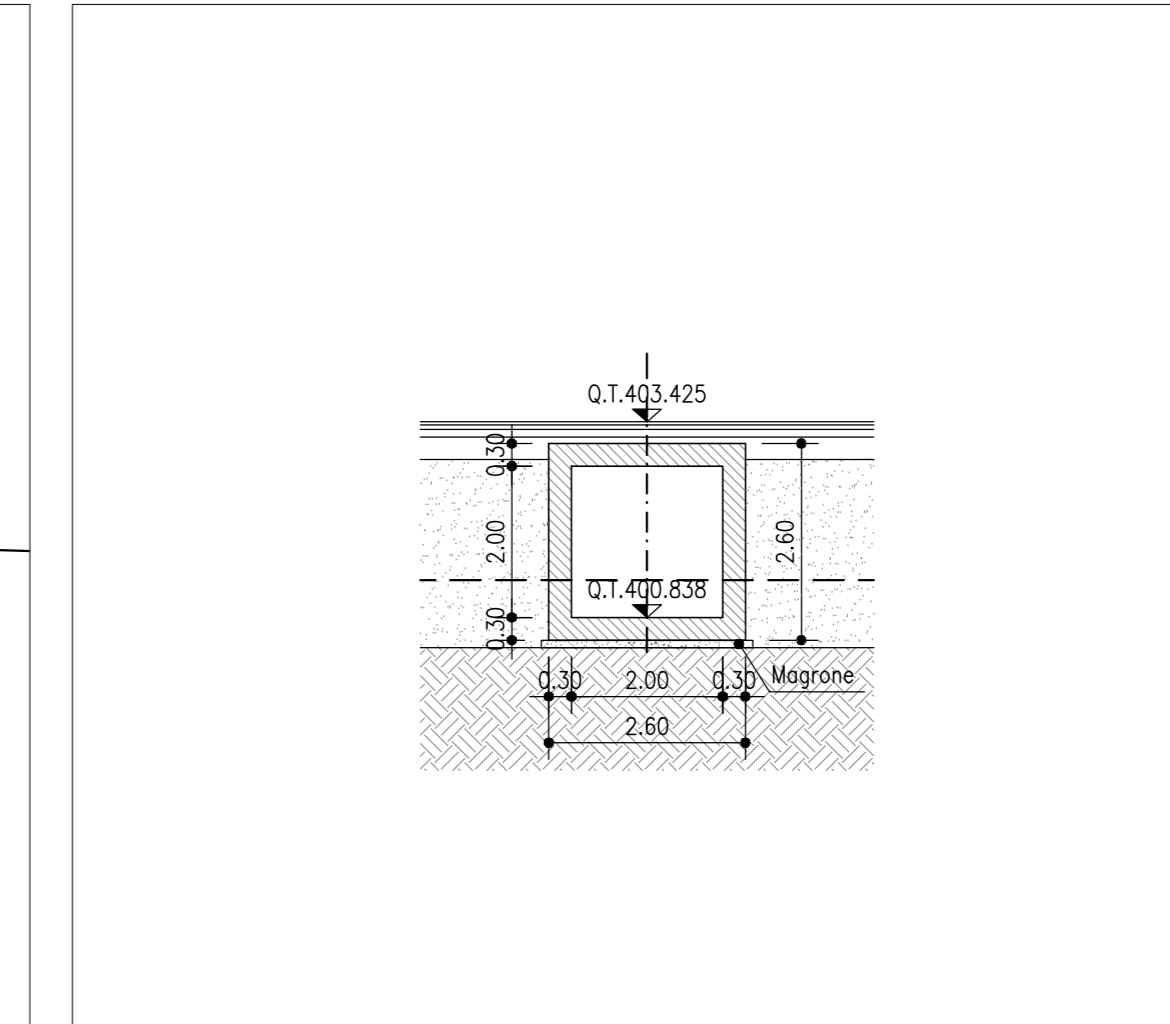

STRALCIO PLANIMETRICO - PROG. 0+610.969 (A)  
SCALA 1:200

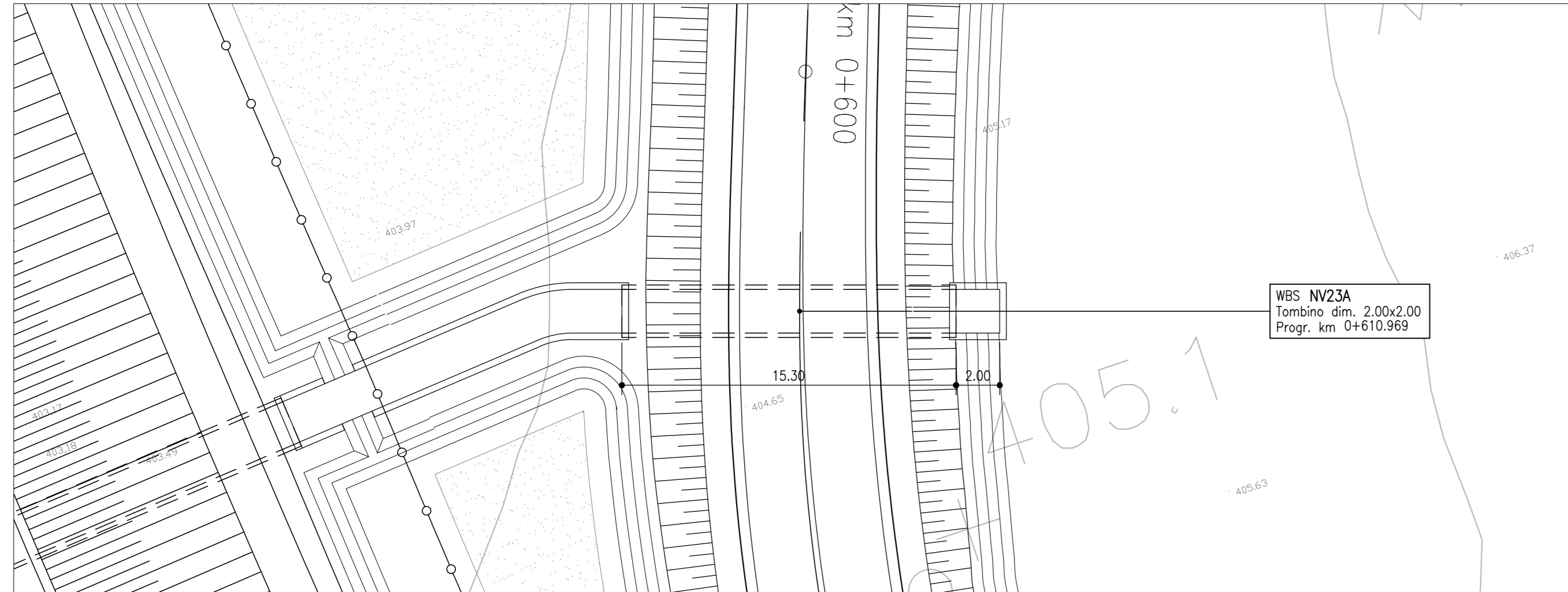

SEZIONE LONGITUDINALE - PROG. 0+610.969 (A)  
SCALA 1:100

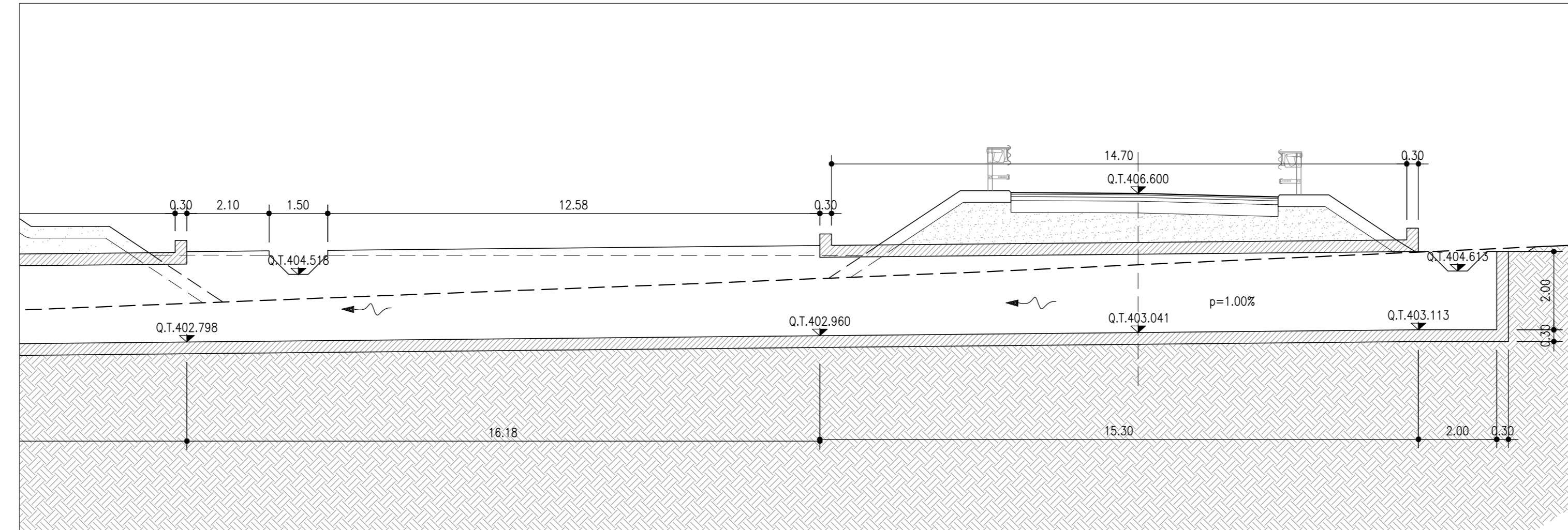

SEZIONE TRASVERSALE - PROG. 0+610.969 (A)  
SCALA 1:100

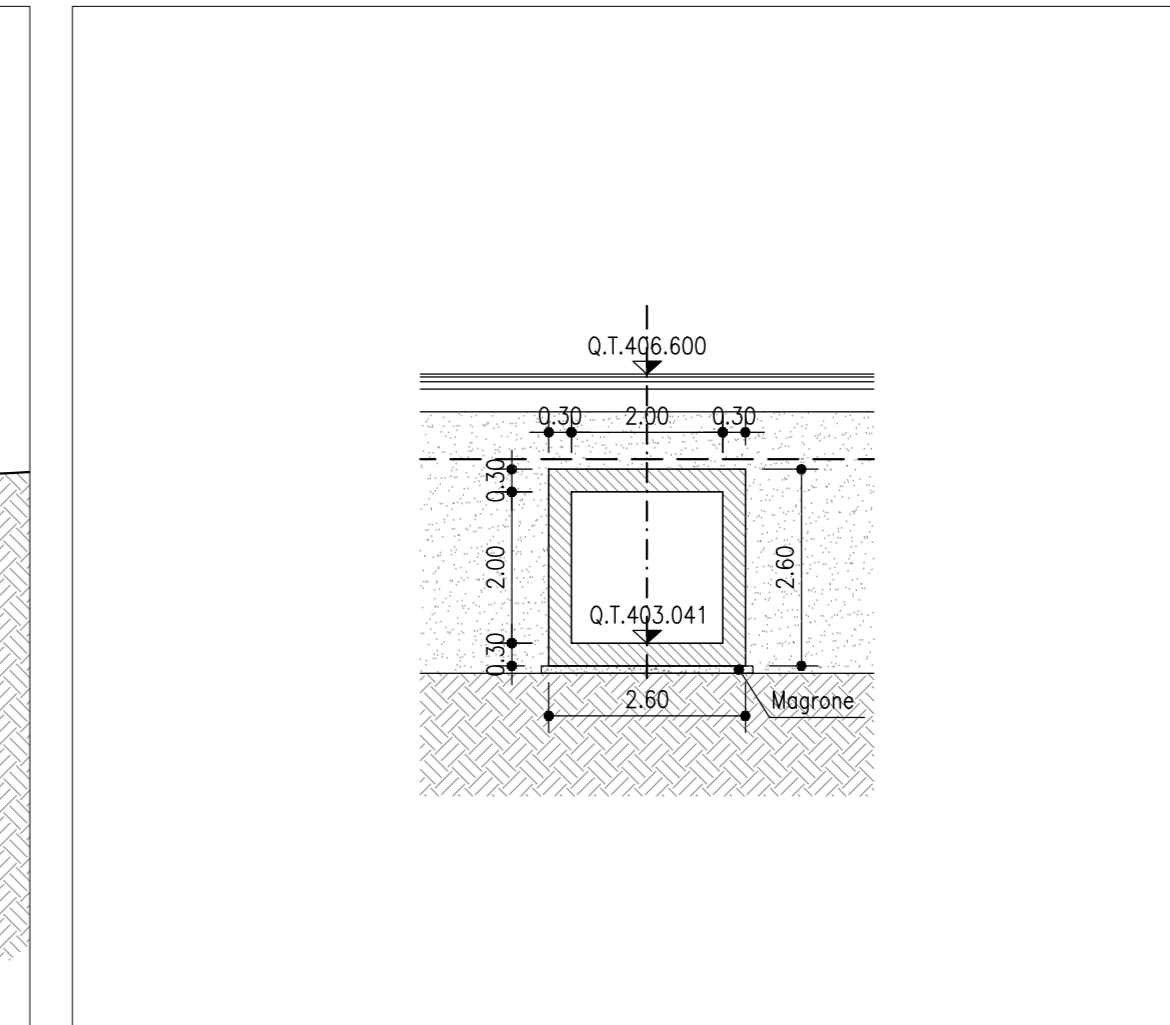

STRALCIO PLANIMETRICO - PROG. 0+817.730 (A)  
SCALA 1:200

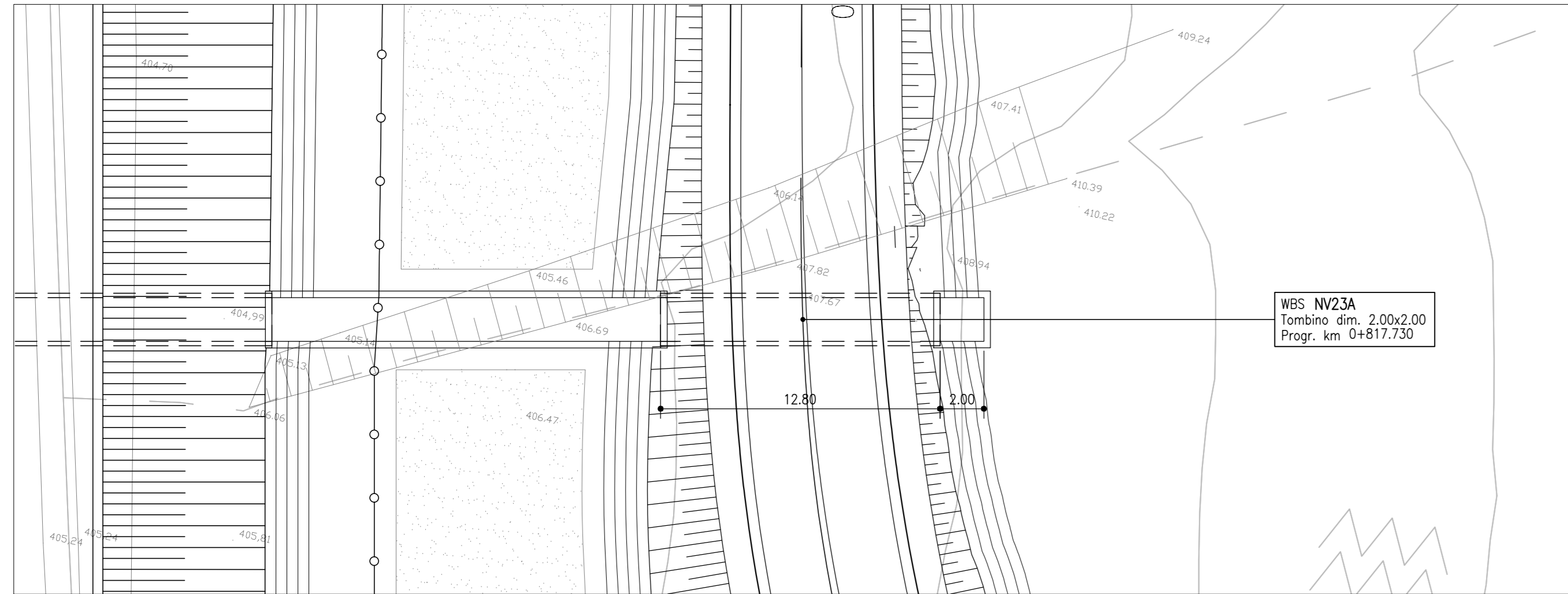

SEZIONE LONGITUDINALE - PROG. 0+817.730 (A)  
SCALA 1:100

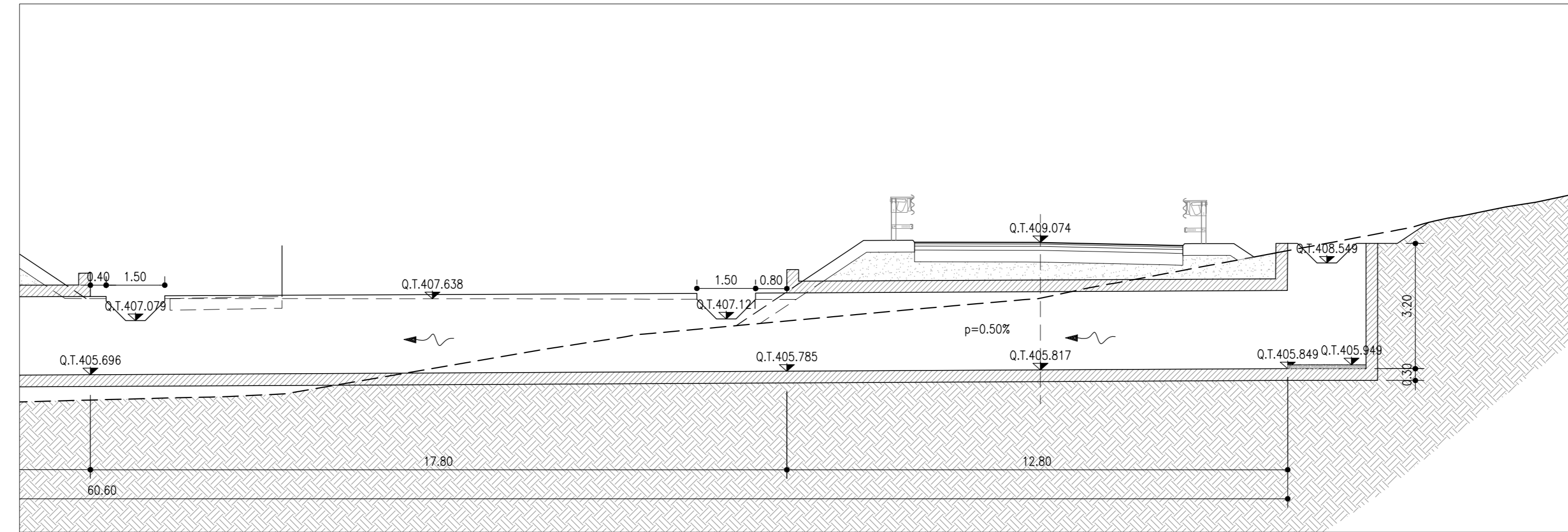

SEZIONE TRASVERSALE - 0+817.730 (A)  
SCALA 1:100

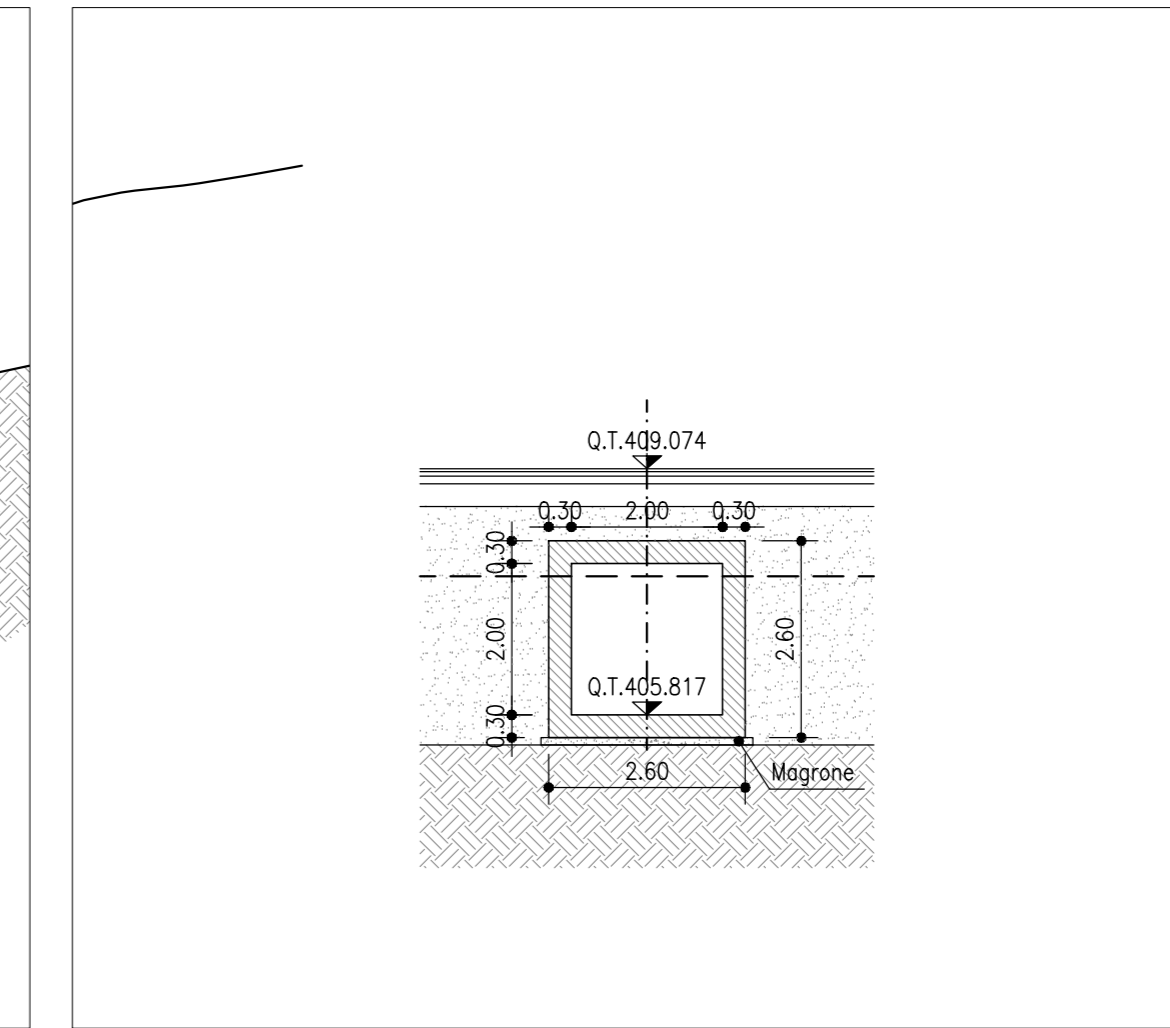

STRALCIO PLANIMETRICO - PROG. 0+008.328 (C)  
SCALA 1:200

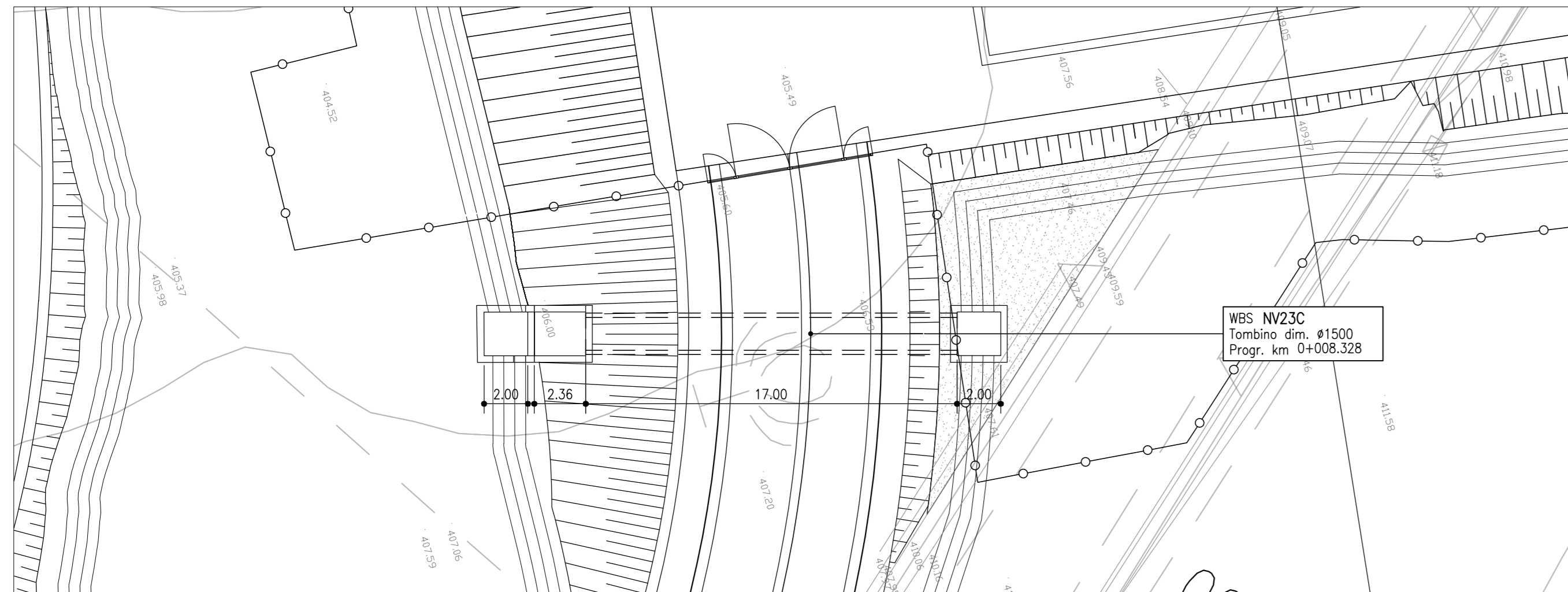

SEZIONE LONGITUDINALE - PROG. 0+008.328 (C)  
SCALA 1:100

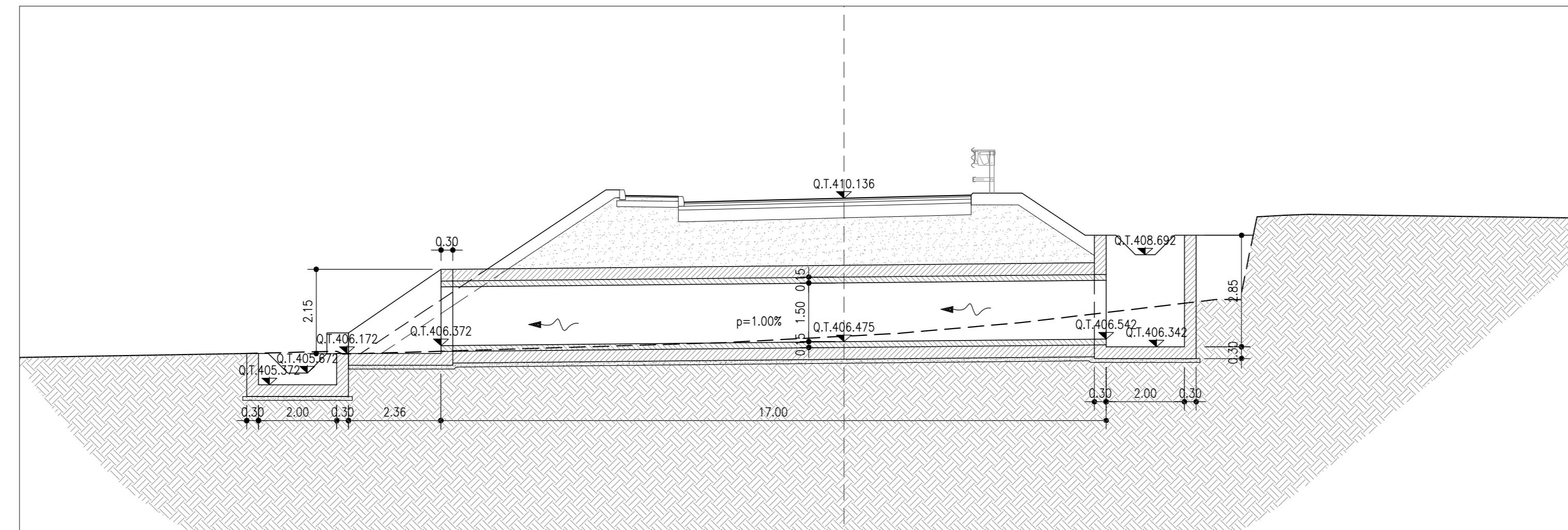

SEZIONE TRASVERSALE - 0+008.328 (C)  
SCALA 1:100

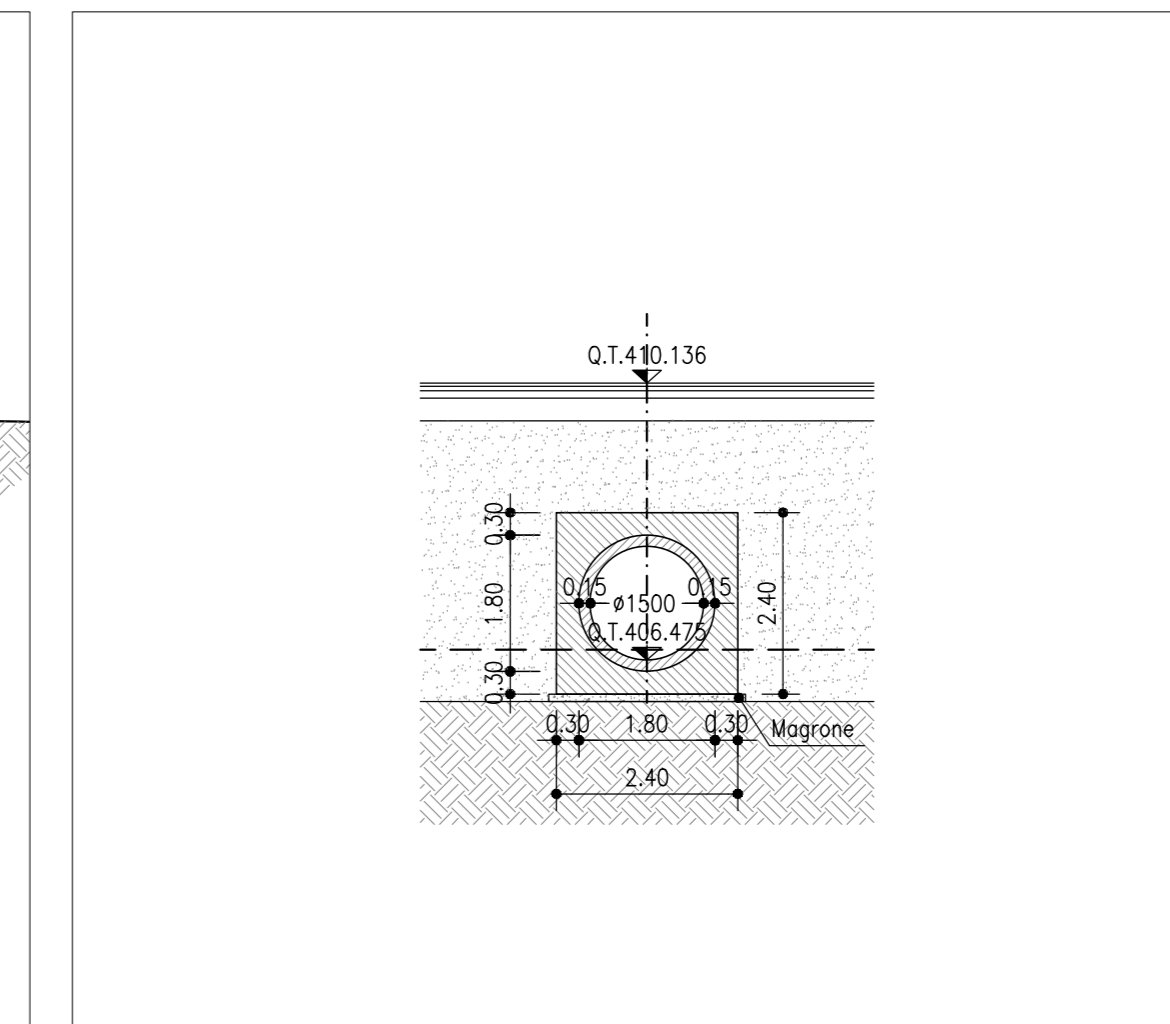

COMMITTENTE: 

PROGETTAZIONE: 

**U.O. INFRASTRUTTURE NORD**

**PROGETTO DEFINITIVO**

**DIRETTRICE FERROVIARIA MESSINA - CATANIA - PALERMO**  
**NUOVO COLLEGAMENTO PALERMO - CATANIA**

**RADDOPPIO TRATTA FIUMETORTO - LERCARA DIRAMAZIONE**  
**LOTTO 1+2**

**VIABILITA'**  
NV23 - Viabilità di accesso Area di sicurezza  
Planimetria sistemazione tombini idraulici

SCALA: VARIE

Rev.	Descrizione	Redatto	Data	Verificato	Data	Approvato	Data	Autorizzato Data
A	EMISSIONE ESECUTIVA	C. INTERRA	Gennaio 2020	M. VIGORITA	Gennaio 2020	A. SERRA	Gennaio 2020	
B	1° AGG. A CONSEGNA CGL/IF	C. INTERRA	Maggio 2020	M. VIGORITA	Maggio 2020	A. SERRA	Maggio 2020	

File: H330002020P23303018.DWG n. Elab: 1