

PLAN VIEW

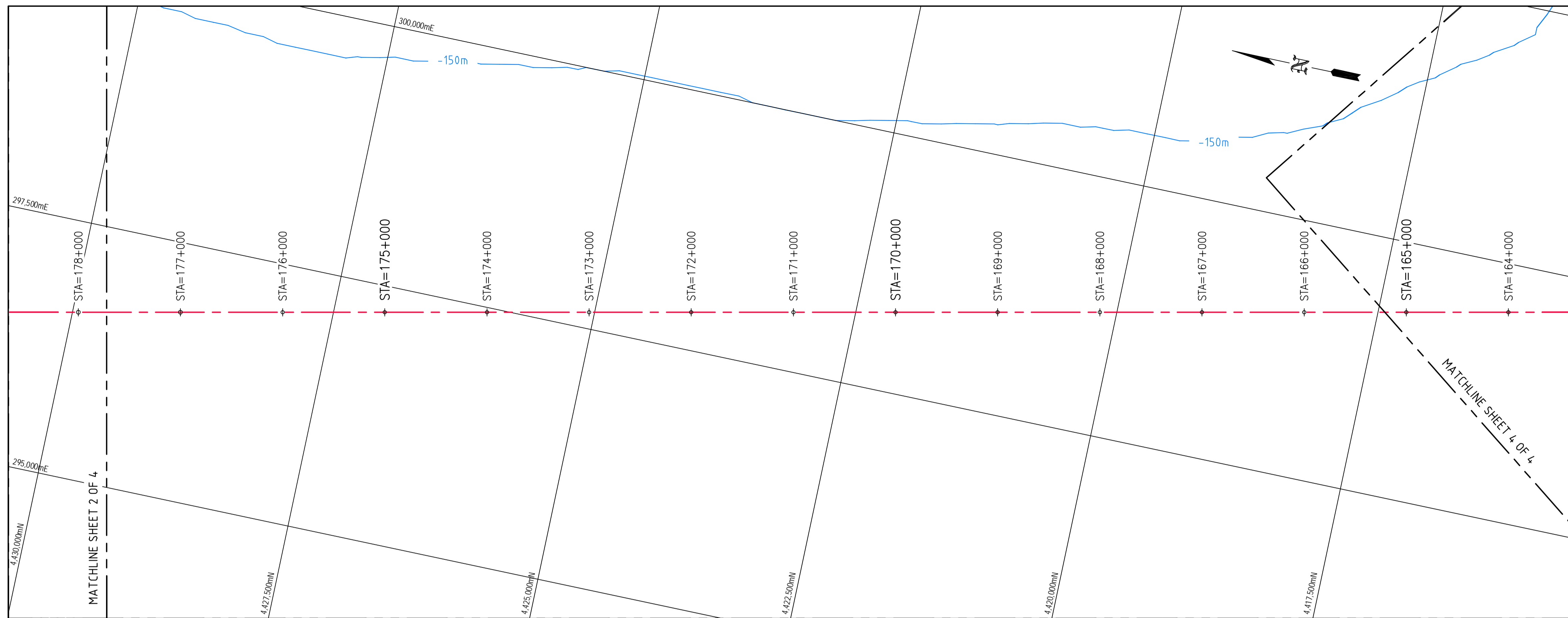

NOTES

- BATHYMETRY INSIDE SURVEY LIMITS IS FROM 2000 SURVEY BY GAS. BATHYMETRY OUTSIDE LIMIT OF 2000 SURVEY AREA IS BASED ON GTOPO30 DIGITAL ELEVATION DATA (30 ARCSEC) OBTAINED FROM USGS'S EROS DATA CENTER.
- GEOGRAPHIC COASTLINE DATA OBTAINED FROM NATIONAL GEOGRAPHIC DATA CENTER'S COASTLINE EXTRACTOR, WORLD VECTOR SHORELINE DATA (DESIGNED FOR 1 : 250,000)
- CABLE ALIGNMENTS FROM:
  - ITALIAN HYDROGRAPHIC CHART No.920
  - ITALY-GREECE SUBMARINE HVDC INTERCONNECTOR - GENERAL OVERVIEW & KEY MAP.
  - SUBMARINE FIBRE-OPTIC LINK ATRANTO (ITALY) - FTELIA (GREECE) MARINE SURVEY.
- PIPELINE DESIGN SUMMARY FROM PRELIMINARY DESIGN REPORT-MAR-1255-007.

ROUTE DEFINITION

Base case Route B	Northing (m)	Easting (m)	Latitude	Longitude	Radius (m)
SLF	4,355,789	438,525	39° 20' 58" N	20° 17' 12" E	
IP-1A	4,350,964	428,321	39° 18' 18" N	20° 10' 07" E	4000
IP-2A	4,351,058	414,087	39° 18' 17" N	20° 00' 13" E	4000
IP-5B	4,345,238	399,213	39° 15' 02" N	19° 49' 55" E	4000
IP-6B	4,380,850	346,382	39° 33' 49" N	19° 12' 42" E	4000
IP-B7B1	4,410,079	307,087	39° 49' 08" N	18° 44' 46" E	4000
IP-B7B2	4,413,861	300,042	39° 51' 04" N	18° 39' 46" E	4000
IP-10	4,441,467	294,169	40° 05' 54" N	18° 35' 07" E	4000
IP-11B	4,447,945	297,153	40° 09' 27" N	18° 37' 06" E	2000
IP-12B	4,448,777	287,364	40° 09' 45" N	18° 30' 11" E	1300
EXIT POINT	4,447,455	287,208	40° 09' 02" N	18° 30' 06" E	
OLF-1	4,446,993	287,153	40° 08' 47" N	18° 30' 05" E	
ENTRANCE	4,446,914	287,143	40° 08' 44" N	18° 30' 04" E	

LEGEND

- BASE CASE ROUTE
- GTOPO30 CONTOURS (C.I.= 50m)
- SUBMARINE CABLE
- ORIGINAL SURVEY CORRIDOR

PROJECTION PARAMETERS

HOR. COORDINATE SYSTEM	: WGS 84 / UTM ZONE 34
PROJECTION	: UNIVERSAL TRANSVERSE MERCATOR (UTM)
Central Meridian (CM)	: 21° 00' 00" East
Latitude of Origin	: 00° 00' 00" North
False Easting	: 500,000 m
False Northing	: 0 m
Scale factor at CM	: 0.999600

SCALE

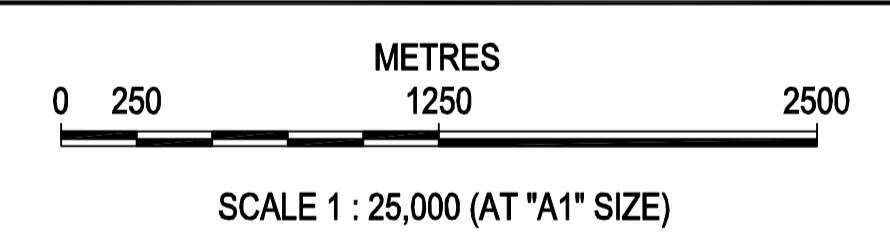

PRELIMINARY PROFILE ALONG ROUTE B

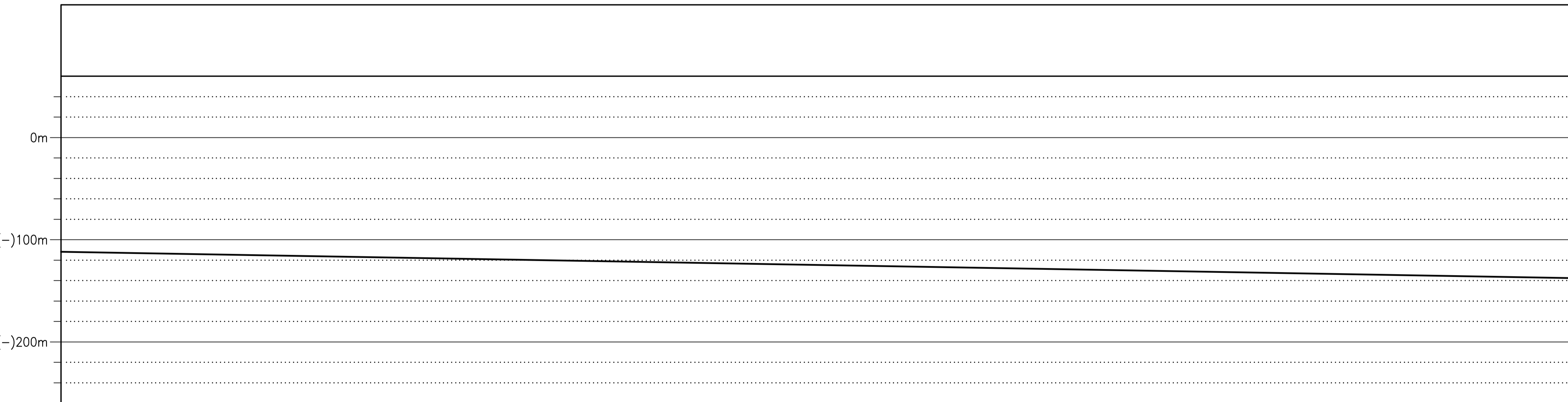

PIPELINE DESIGN SUMMARY FOR SINGLE PIPELINE OPTION

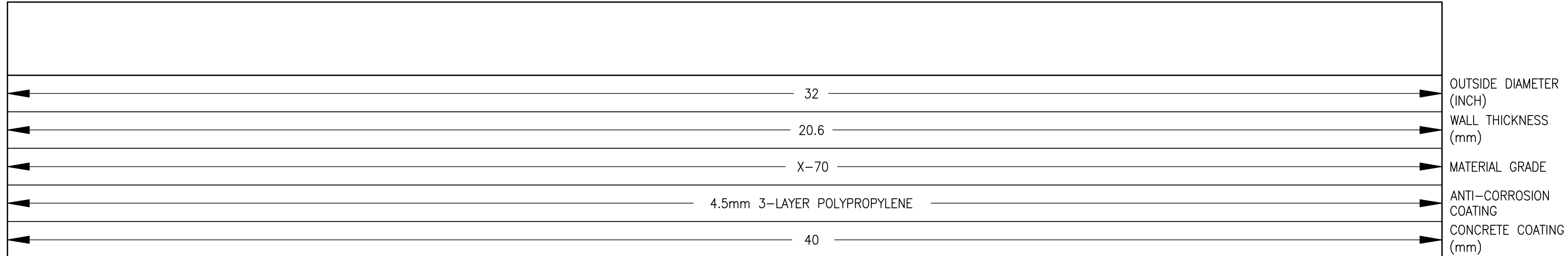

0	07/11/07	FINAL	FAK	MVD	MVD			
A	07/11/07	FOR INTERNAL REVIEW	FAK	MVD	MVD			
Αριθ.	ΗΜΕΡΟΜΗΝΙΑ	Περιγραφή	Ετοιμάστηκε	Ελεγχος	Εγκρ. PM	Εγκρ. PD	ΗΜΕΡΟΜ.	Εγκριση
Rev. No.	Date	Description	Prepared	Checked	Appr. PM	Appr. PD	Date	Approved
			ΜΗΧΑΝΙΚΟΣ / CONTRACTOR			ΠΕΛΑΤΗΣ / COMPANY		
		<b>IGI INTERCONNECTOR GREECE - ITALY TECHNICAL FEASIBILITY STUDY</b>						
		GRANT AGREEMENT WITH EU TEN-E/2003/5.7100/Z/03-009 OCTOBER 2004						
		Τίτλος / Title <b>ITALIAN ROUTE SECTION ALIGNMENT CHART 3 OF 4</b>						
Αντιπρόσωπος Πελάτη	Κλίμακα	Κωδικός Περιοχής	Φύλλο					
Client Representative	Scale	Area Code	Sheet					
Κωδικός Αναφοράς Πελάτη	Κωδικός	Σχέδιο-Νο	Αριθ.					
Client Reference	Contract No.	Project Identification	Drawing-No.					
Αντιπρόσωπος Μηχανικού	31030508	0101-DRW-00-006	0					
Engineer Representative	DEPA Contract	Unit Number	Size	Sec.				
Document Originator	Frank van Kulk	Identification						