

CABINA DI CONSEGNA - SCALA 1:20

VISTA FRONTALE  
FRONT VIEW

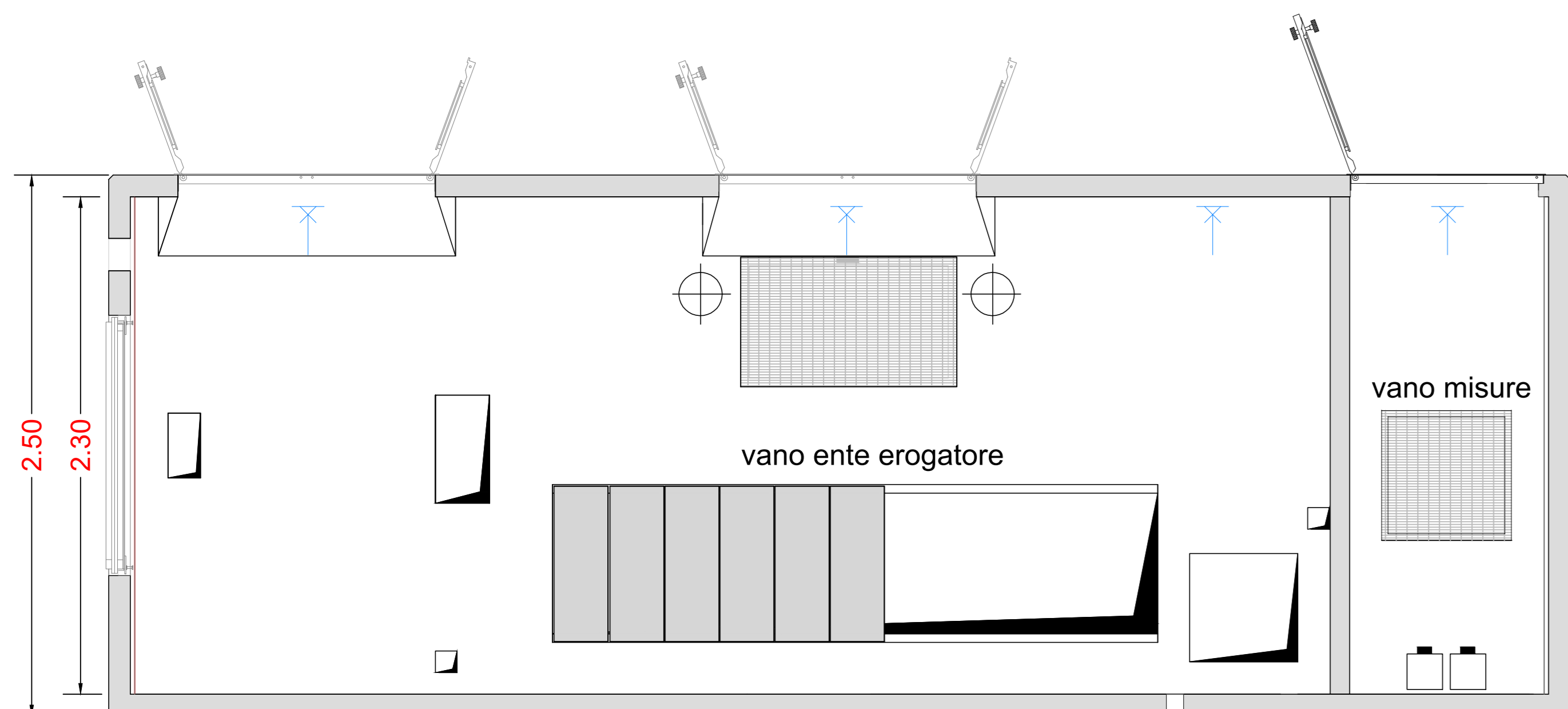
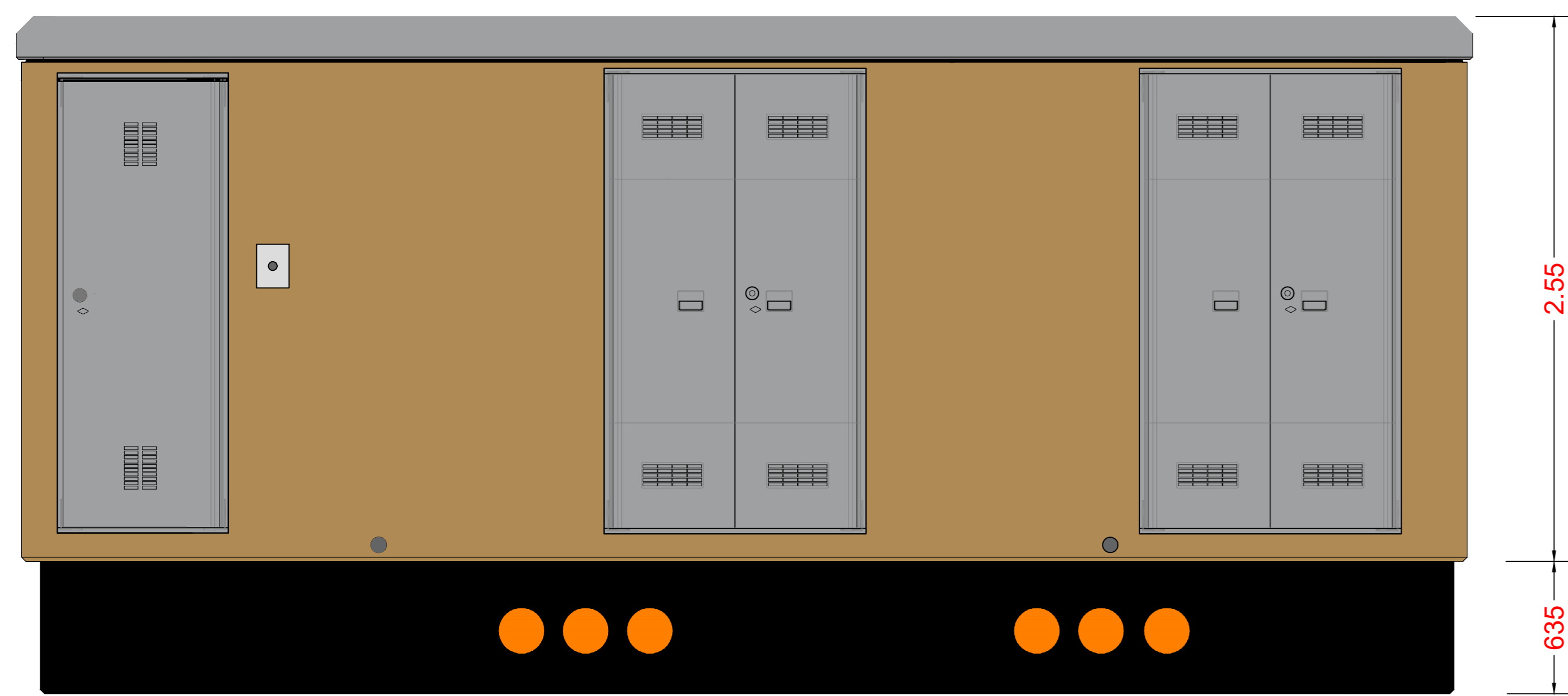

VISTA SU PIANTA DELLA CABINA P67 ENEL MISURE  
STATION PLANT VIEW

DG2092 Ed 03

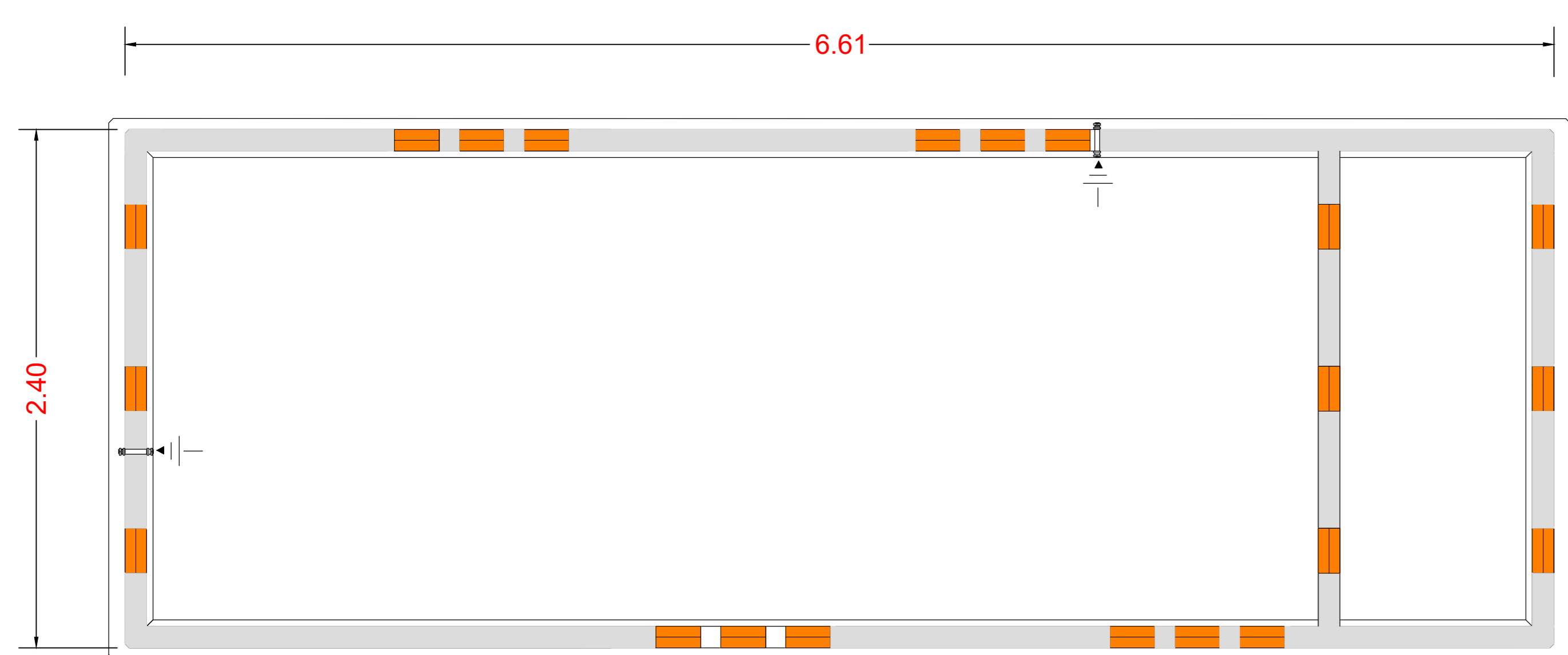

VISTA SU PIANTA DELLA VASCA  
BASEMENT PLANT VIEW

CABINA UTENTE (MT+TSA) - SCALA 1:20

VISTA FRONTALE  
FRONT VIEW

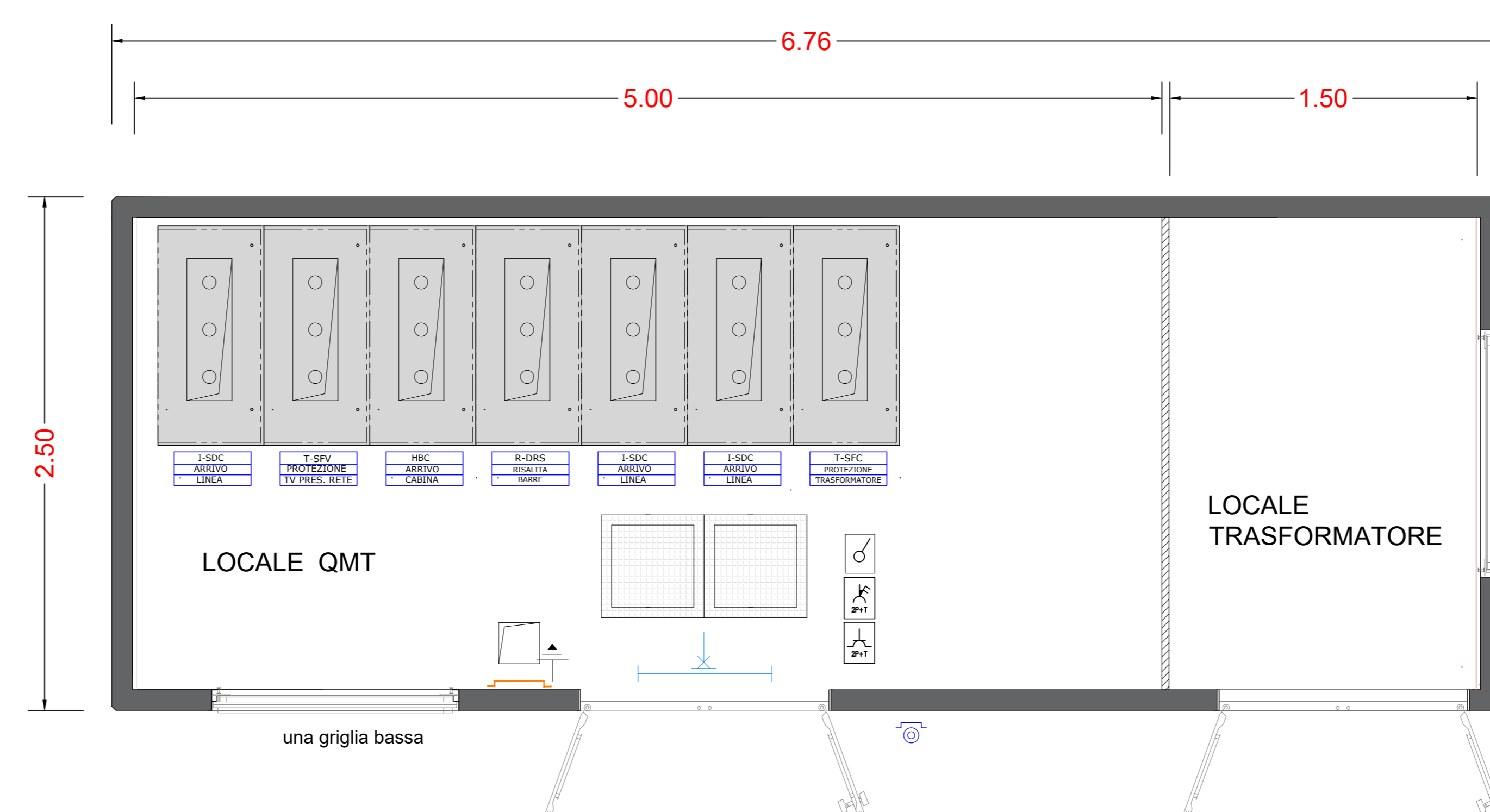
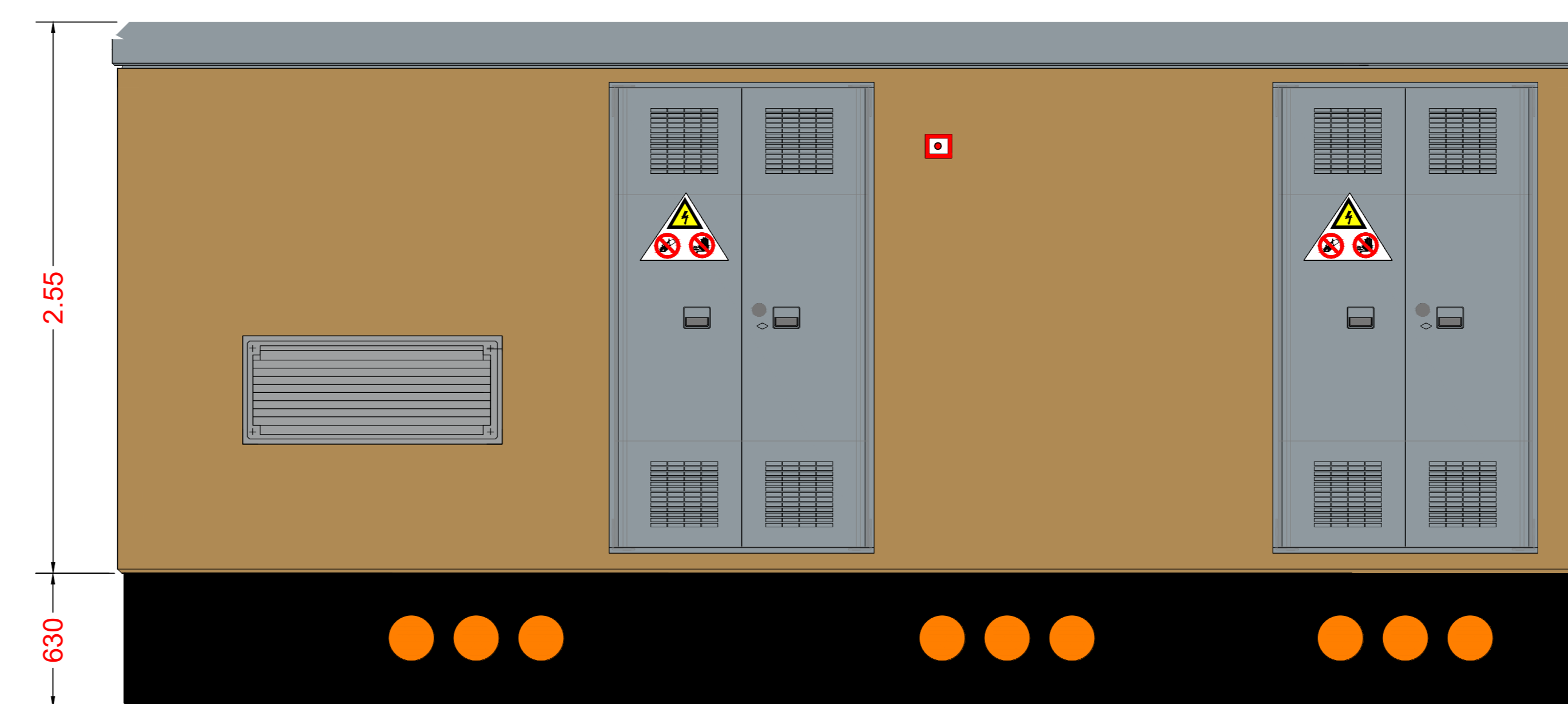

VISTA SU PIANTA DELLA CABINA P67 UTENTE  
STATION PLANT VIEW

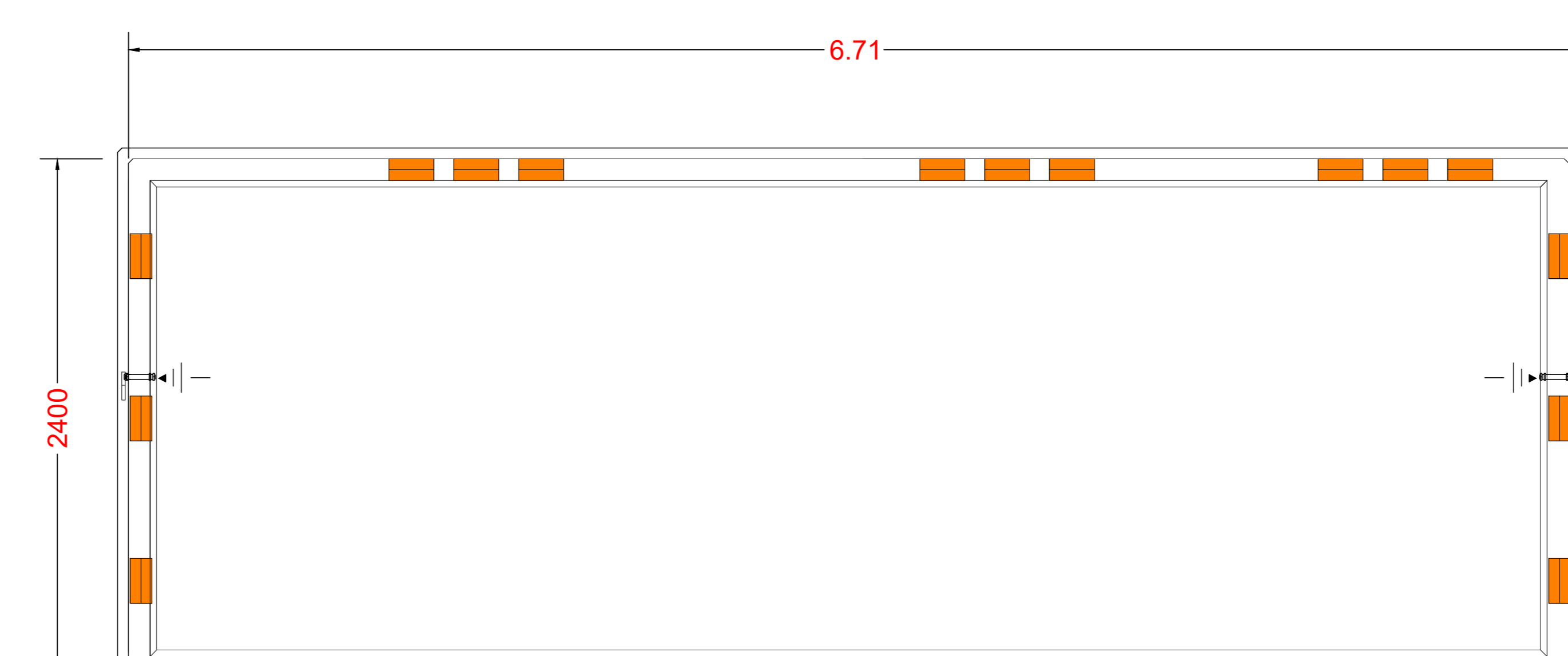

VISTA SU PIANTA DELLA VASCA  
BASEMENT PLANT VIEW

CABINA DI SEZIONAMENTO - SCALA 1:20

Frontale

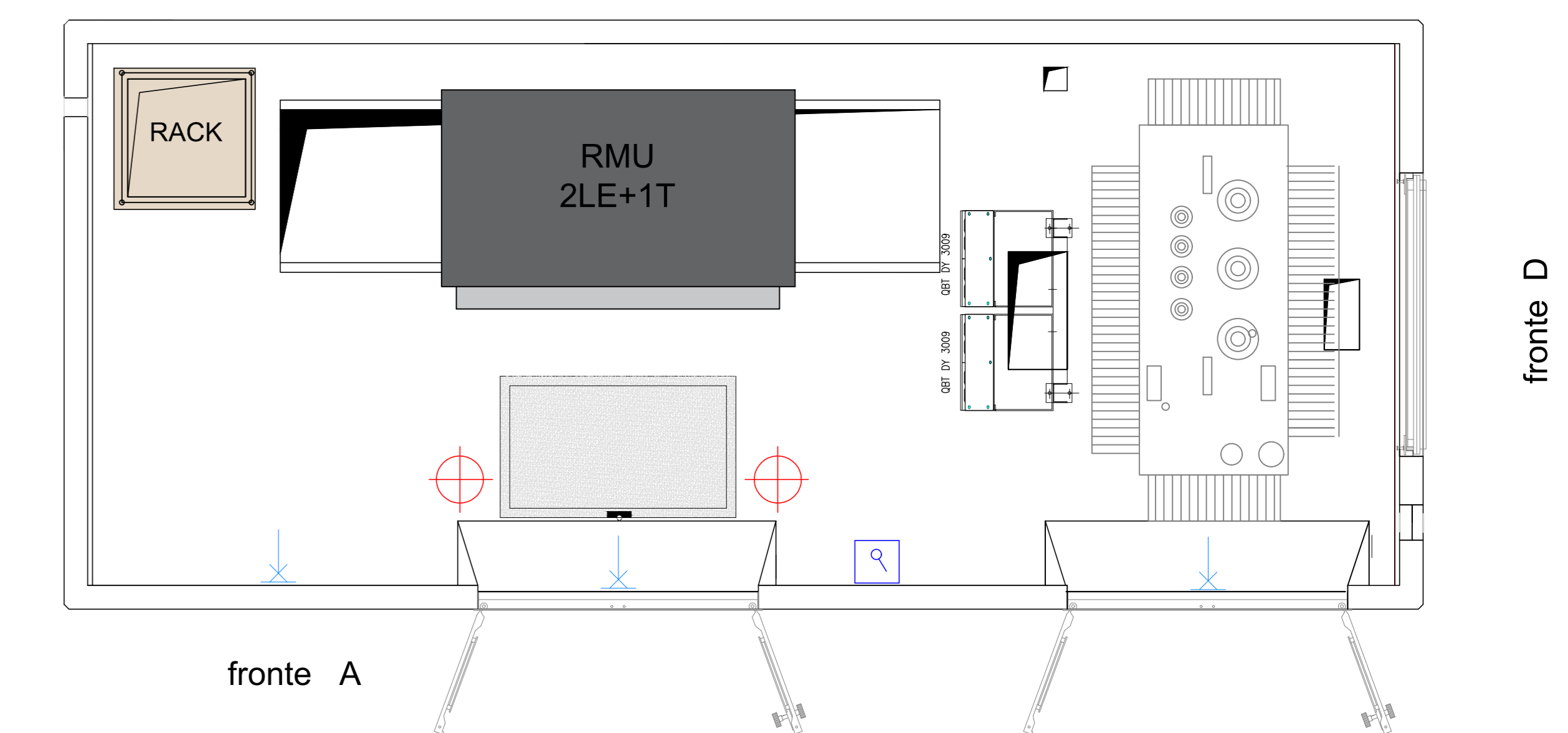
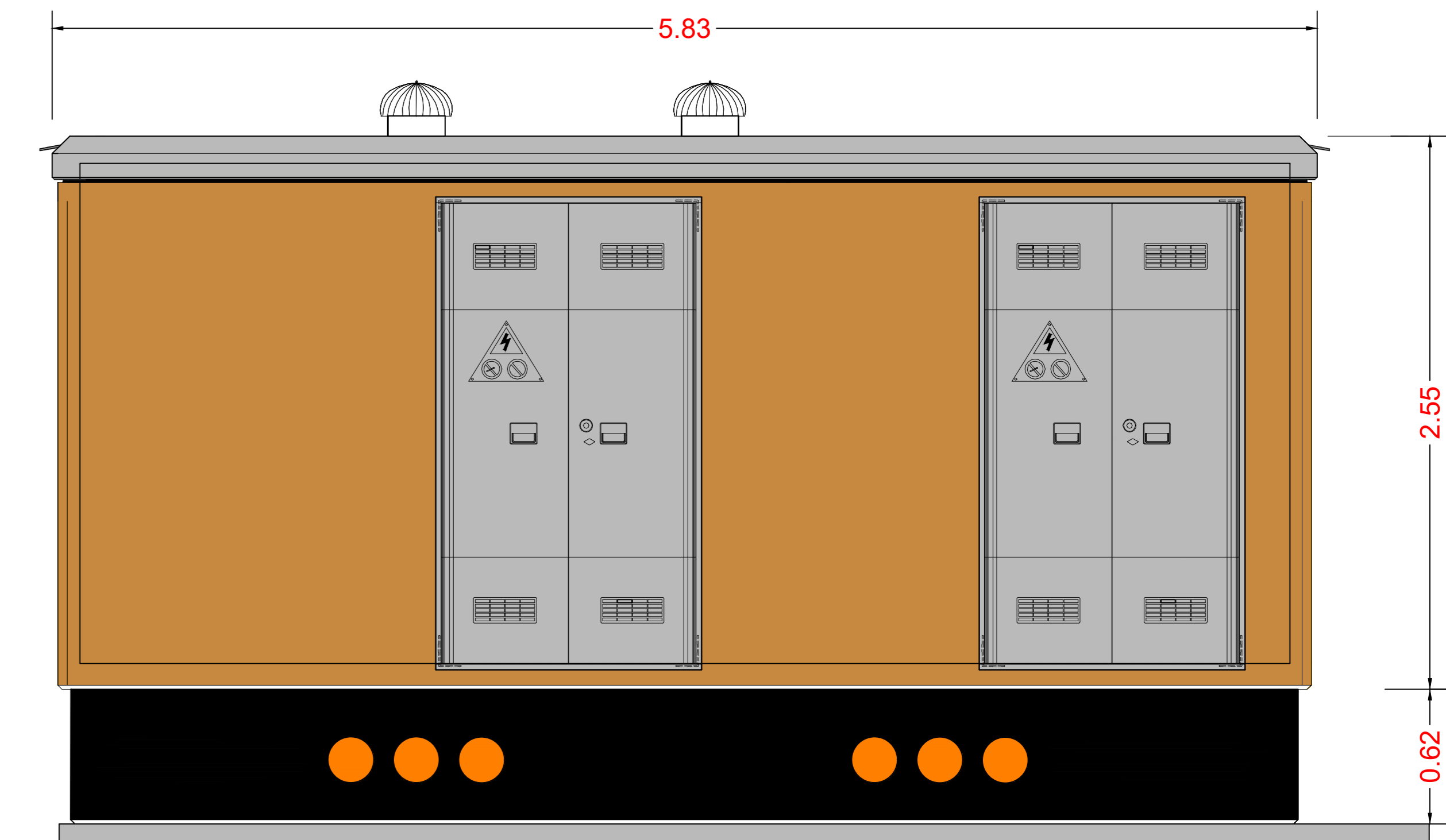

VISTA SU PIANTA CON APPARECCHIATURE

DG2061

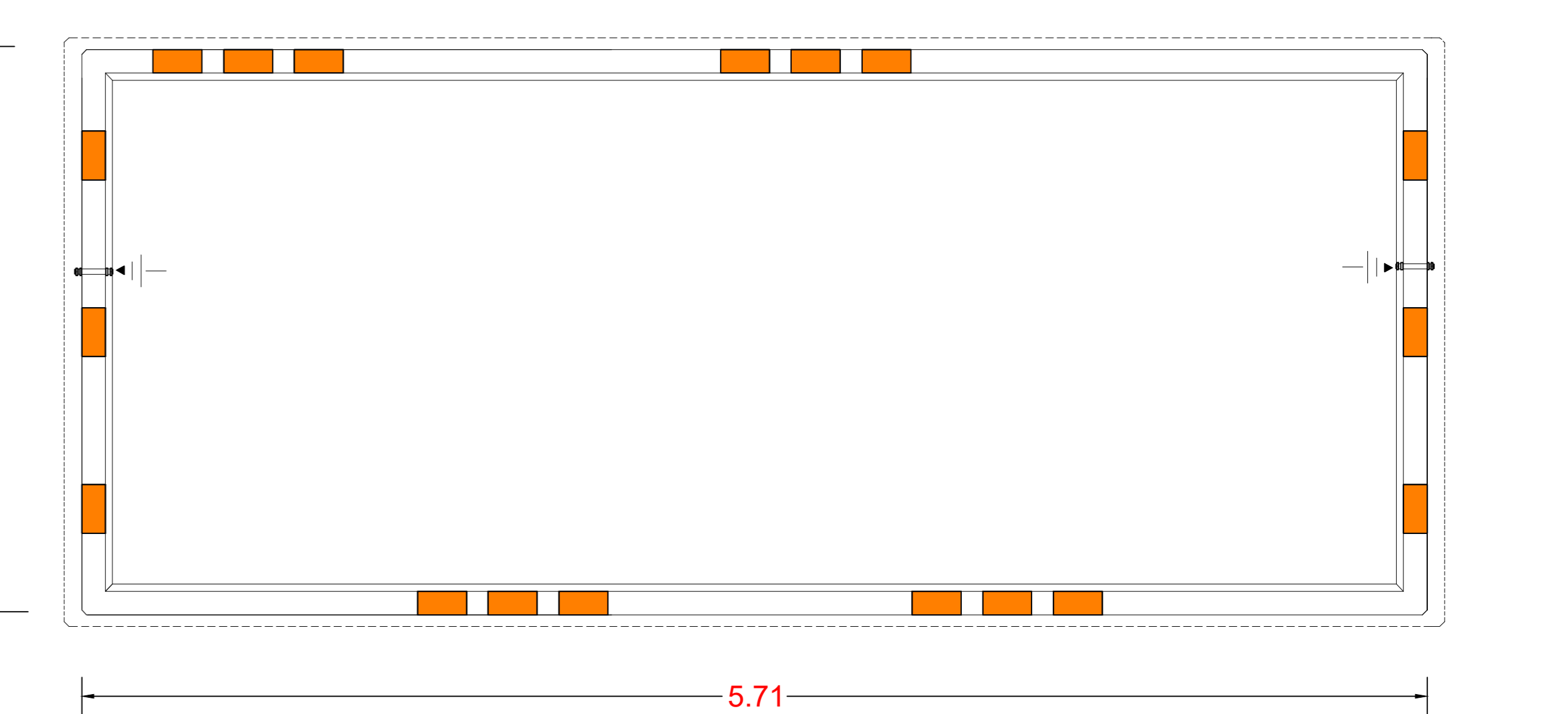

Vista su pianta vasca

VISTA FRONTALE  
FRONT VIEW

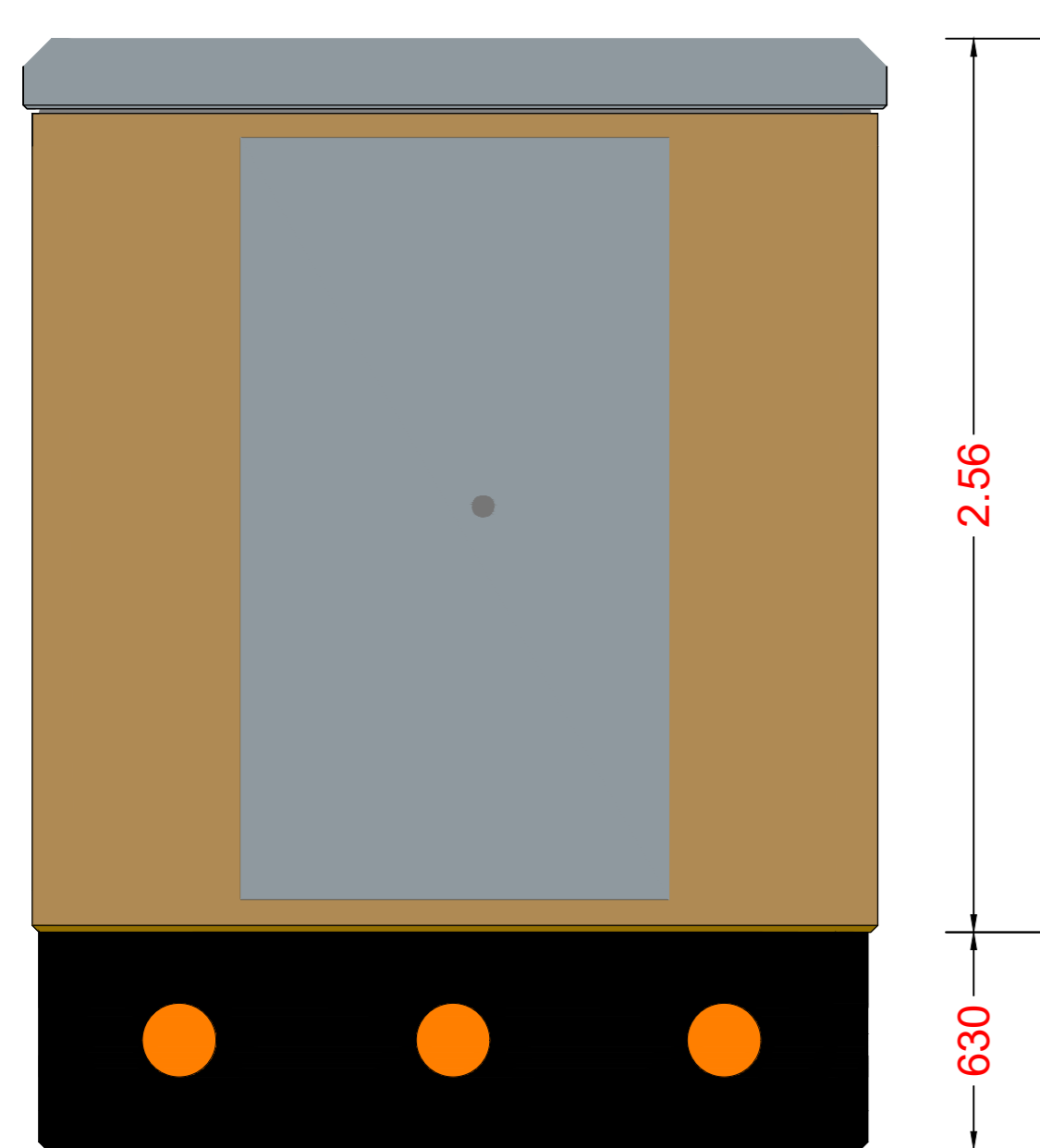

VISTA SU PIANTA DELLA CABINA P25 UTENTE  
STATION PLANT VIEW

CABINA UTENTE (BT+SCADA) - SCALA 1:20

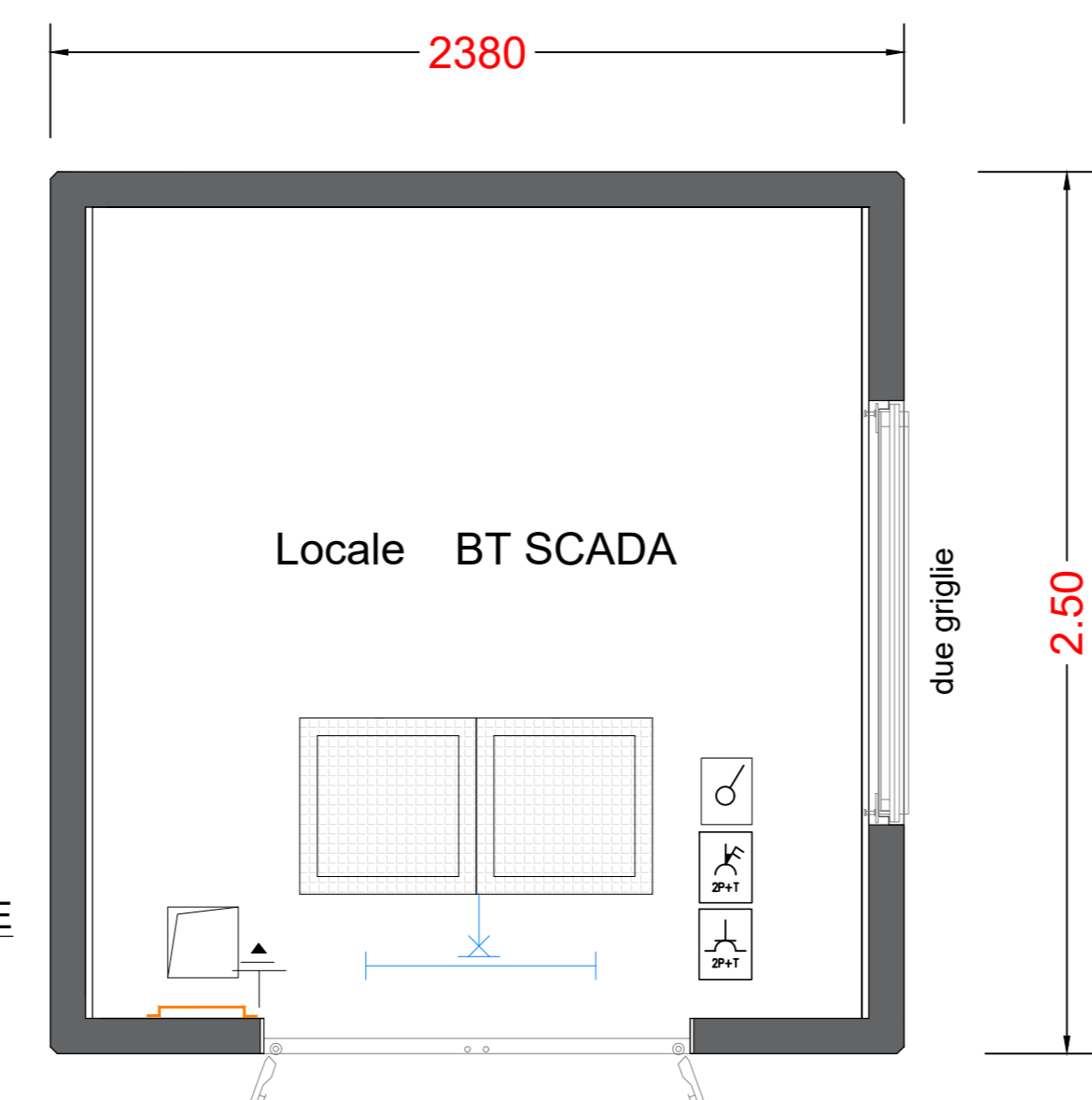

VISTA SU PIANTA DELLA VASCA  
BASEMENT PLANT VIEW

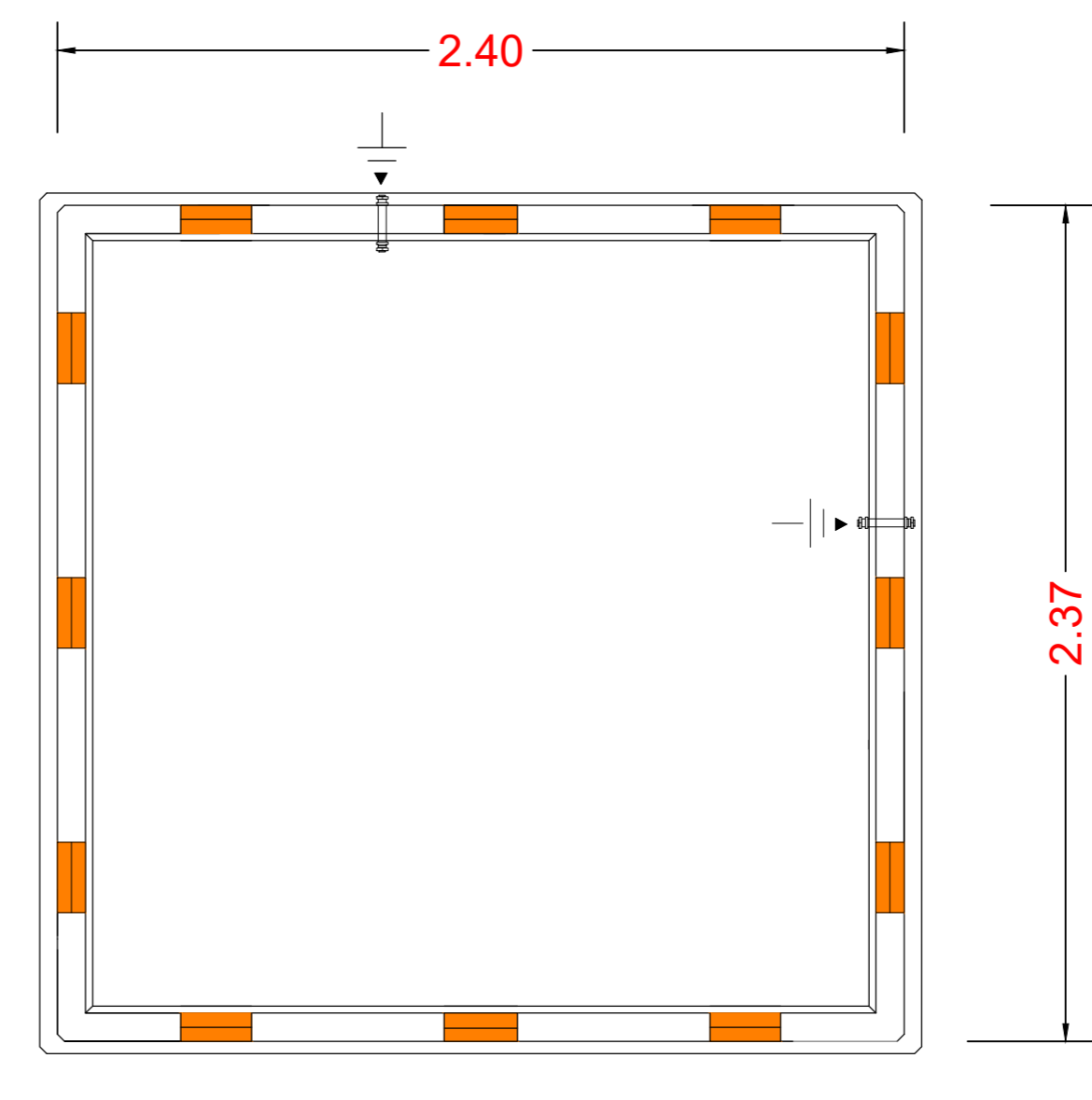

00	28/04/2021	EMISSIONE	SCS Ingegneria	SCS Ingegneria	SCS Ingegneria
REV.	DATE	DESCRIPTION	PROVENED	CAVIGLIO	APPROVED
DIRETTORE TECNICO: Federico Specchia ING. FEDERICA SPECCHIA			FIRMATA E INVIATA (AUTENTICA ELETTRONICA) Technical Director: Federico Specchia		
NOME INTERNO/PROGETTO: Cabine secondarie		DATA: 09/04/2021	SCALA DEL PRODOTTO: Drawing scale: 1:1 1 di 1		
PROGETTO: Impianto fotovoltaico della potenza di 10,275 MWp con integrazione agricola, ubicato nel Comune di Grottaglie (TA), Località: Contrada Angiulli SNC			SCHEMI: SCHEMI: Cabine secondarie - pianta prospetti - sezioni		
PROGETTO: Grottaglie (2051)			CODICE: SCSDESRELEITAP205107000		